

Line-Mounting Body, Size SAE 10 / NG 8

Type: 10 Series - 2.5-Way

1 Technical data

Ordering code	Description	Material	Maximum operating pressure	Weight	Port 1	Port 2	Port 3
08TA	30136	Aluminum	3000 psi [210 bar]	0.645 lbs [0.30 kg]	SAE-8	SAE-8	SAE-4
08TS	30142	Steel	5000 psi [350 bar]	1.880 lbs [0.85 kg]	SAE-8	SAE-8	SAE-4
10TA	30137	Aluminum	3000 psi [210 bar]	0.618 lbs [0.28 kg]	SAE-10	SAE-10	SAE-4
10TS	30143	Steel	5000 psi [350 bar]	1.801 lbs [0.82 kg]	SAE-10	SAE-10	SAE-4

Available on request for quantities > 100 pieces/year.

03BA	30134	Aluminum	3000 psi [210 bar]	0.663 lbs [0.30 kg]	G 3/8" -19 BSPP	G 3/8" -19 BSPP	G 1/4" -19 BSPP
03BS	30140	Steel	5000 psi [350 bar]	1.931 lbs [0.88 kg]	G 3/8" -19 BSPP	G 3/8" -19 BSPP	G 1/4" -19 BSPP
04BA	30135	Aluminum	3000 psi [210 bar]	0.636 lbs [0.29 kg]	G 1/2" -14 BSPP	G 1/2" -14 BSPP	G 1/4" -19 BSPP
04BS	30141	Steel	5000 psi [350 bar]	1.851 lbs [0.84 kg]	G 1/2" -14 BSPP	G 1/2" -14 BSPP	G 1/4" -19 BSPP

2 Dimensions & sectional view

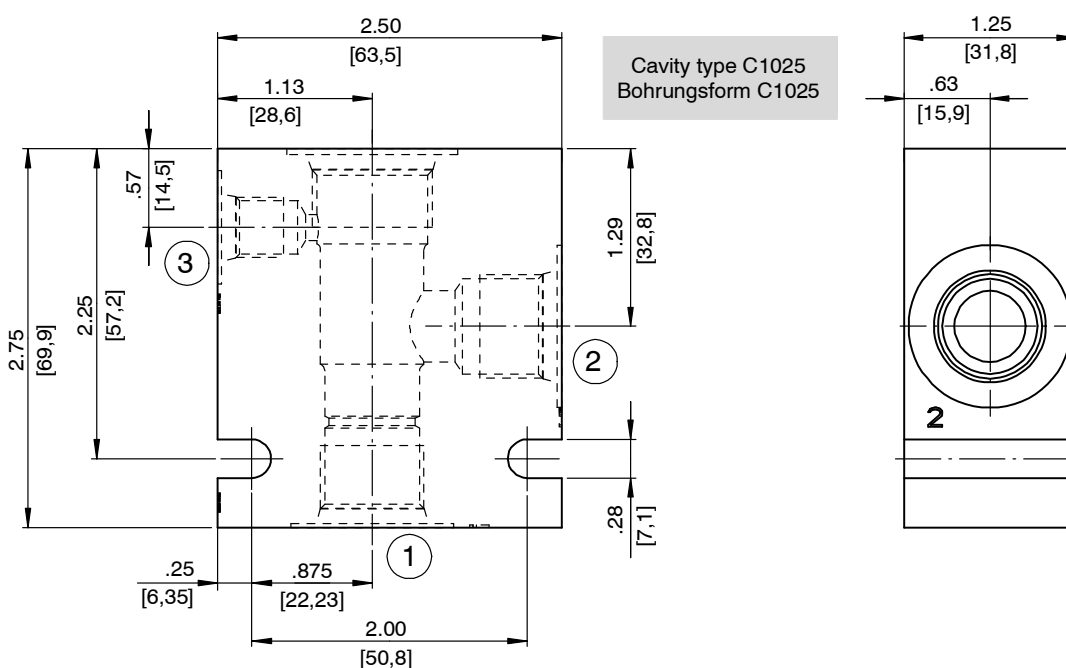

3 Related data sheets

Reference	(Old no.)	Description
520-P-000220	(0-022.0)	Cavity type C1025

info.el@bucherhydraulics.com

www.bucherhydraulics.com/commoncavity

© 2018 by Bucher Hydraulics, Inc., 2545 Northwest Parkway, Elgin, Illinois 60124, USA

All rights reserved.

Data is provided for the purpose of product description only, and must not be construed as warranted characteristics in the legal sense. The information does not relieve users from the duty of conducting their own evaluations and tests. Because the products are subject to continual improvement, we reserve the right to amend the product specifications contained in this catalogue.

Classification: 430.395.-.-.-.