

**Z407 BLUETOOTH®
COMPUTER SPEAKERS
WITH SUBWOOFER**

具有重低音音箱的 Z407 藍牙 電腦音箱

**서브우퍼를 탑재한 Z407 블루투스
PC 스피커**

**Z407 BLUETOOTH® SPEAKER
KOMPUTER DENGAN SUBWOOFER**

Setup Guide | 設定指南
설치 가이드 | Panduan Pengaturan

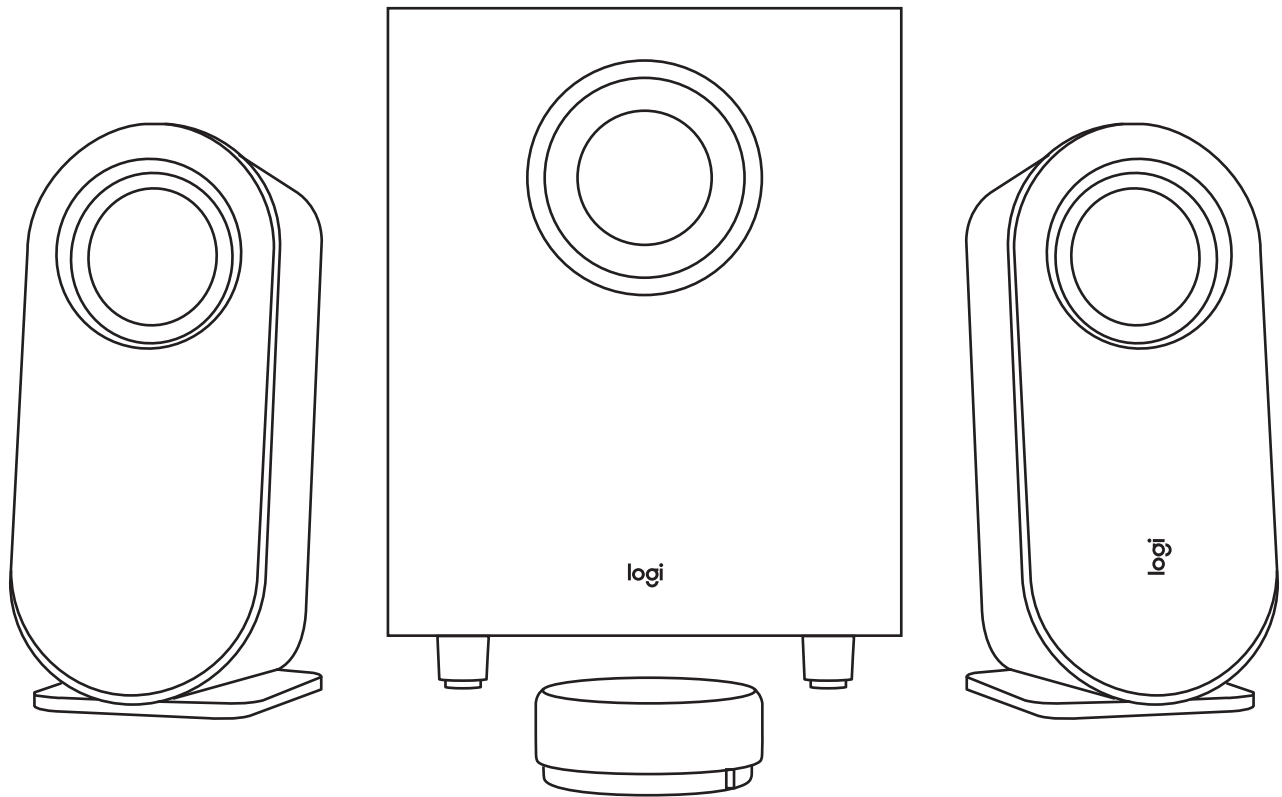

logitech®

CONTENTS

English3

繁體中文 11

한국어 19

Indonesia 27

KNOW YOUR PRODUCT

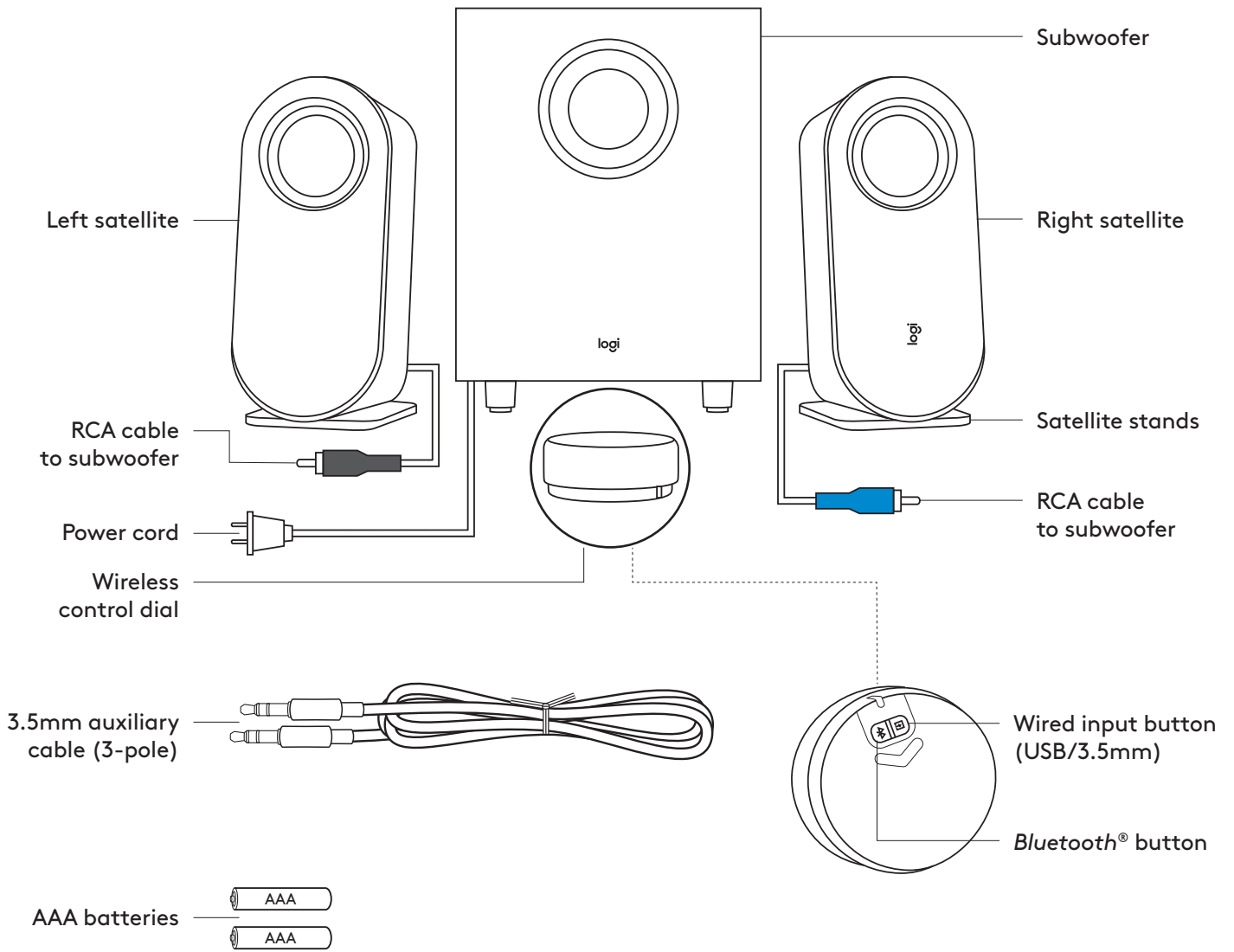

BOX CONTENT

1. Left satellite
2. Right satellite
3. Subwoofer
4. Wireless control dial
5. 2 AAA batteries
6. Satellite stands
7. 3.5 mm cable
8. User documentation

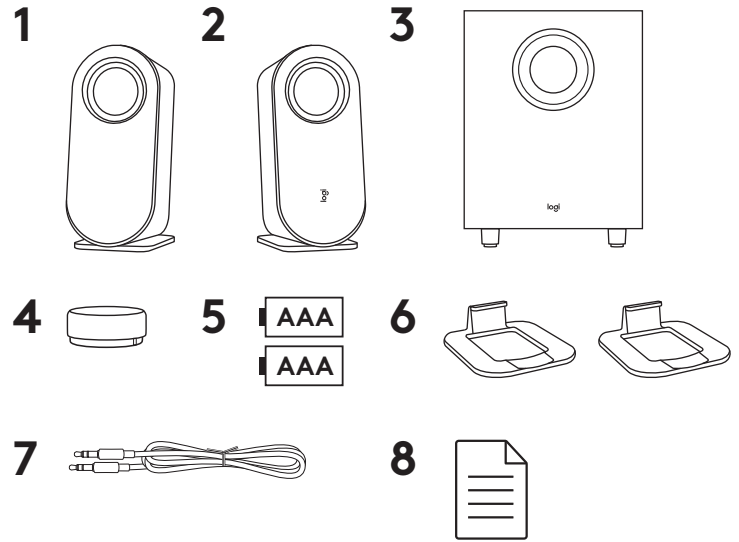

CONNECT THE SPEAKERS

Place the stands to each satellite separately. Lay the speakers vertically or horizontally as per your preference. Make sure that the stands fit tightly in the speakers.

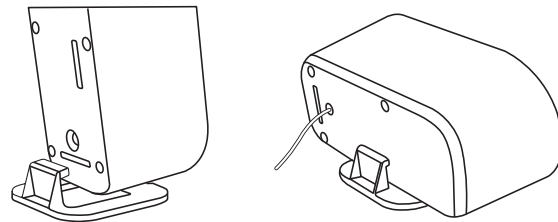

Vertical placement

Horizontal placement

- Plug the right satellite cable into the blue subwoofer jack.
- Plug the left satellite cable into the gray subwoofer jack.

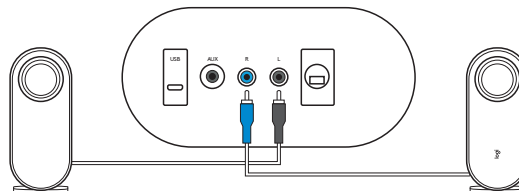

Plug the power cord into an electrical outlet. You will hear a welcome notification sound.

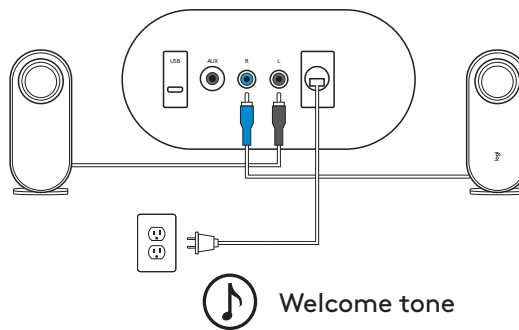

CONNECT THE SPEAKERS (CONT'D)

Long press and push downwards to open the back lid, place two AAA batteries to the corresponding space.

Do not mix using alkaline battery with rechargeable battery.

Do not mix using new and old batteries.

Do not leave the batteries unused in the product for extended periods.

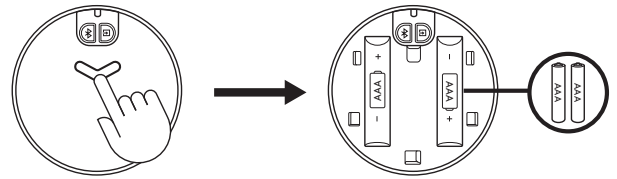

The LED indicator will then start blinking in blue. Once the wireless control dial is successfully connected to the speaker, the LED will turn into a steady blue light.

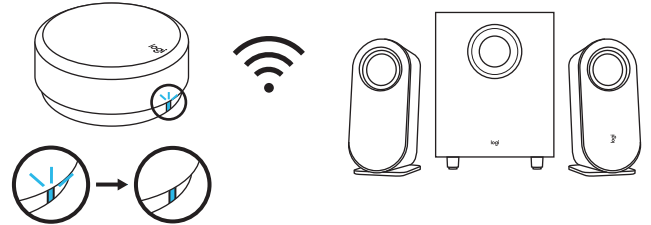

CONNECT TO AUDIO SOURCE

The LED on the control dial will change correspondingly when connected to different connectivity.

- The LED will turn blue when connected via *Bluetooth*.
- The LED will turn purple when connected via 3.5 mm.
- The LED will turn white when connected via USB.

CONNECT VIA **BLUETOOTH**

Make sure *Bluetooth* is activated on the source device.

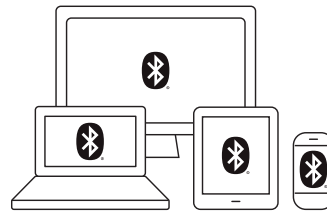

- Press and hold (2sec.) the *Bluetooth* button on the bottom of the dial to activate pairing mode.
- The LED indicator will blink quickly. You will start to hear a pairing sound notification.

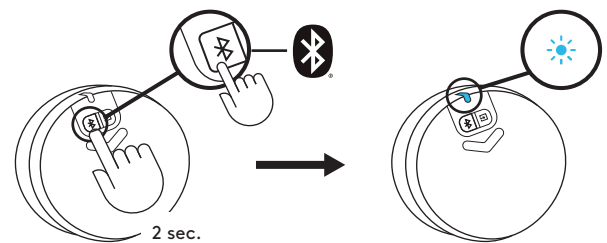

Select and connect to "Logi Z407" on your *Bluetooth* device list. You will hear a connected tone.

The LED will turn into a steady blue light.

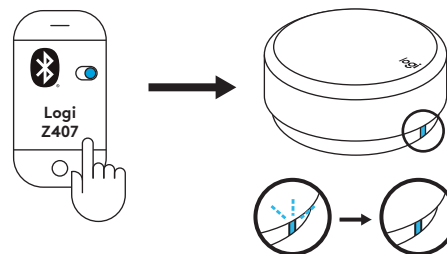

CONNECT VIA 3.5MM CABLE

Connect one end of the provided 3.5 mm cable to the auxiliary input on the back of the subwoofer. Then connect the other end of the cable to the 3.5 mm audio jack on your device.

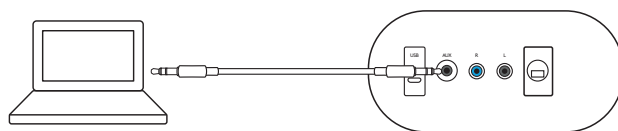

The default connectivity is *Bluetooth*®. To play through 3.5 mm connectivity, press the wired input button on the back of the dial. The LED light will turn purple.

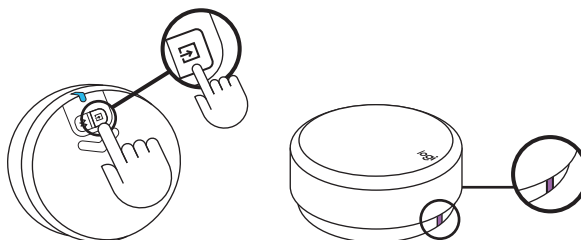

CONNECT VIA USB CABLE

Connect one end of the USB cable to the micro USB input on the back of the subwoofer. Then connect the other end of the cable to USB-A input on your device.

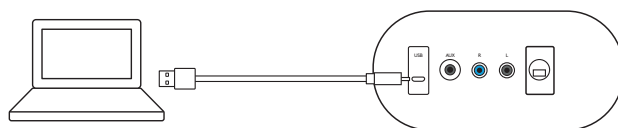

NOTE: USB cable is not included in the box and must be purchased separately.

The default connectivity is *Bluetooth*®. To play through USB connectivity, press the wired input button on the back of the dial. The LED light will turn white.

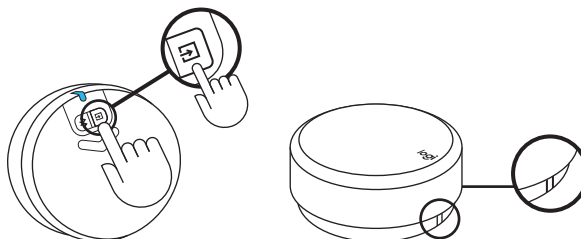

CONNECT TO THREE DEVICES SIMULTANEOUSLY

Connect up to three devices at the same time through the micro USB input, 3.5 mm input on the back of the subwoofer, and *Bluetooth*[®].

You can pair up to eight *Bluetooth*[®] source devices with your speakers.

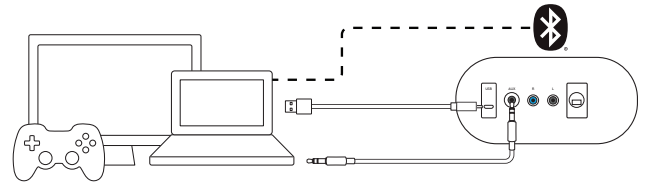

To switch between wired and wireless audio sources, press the *Bluetooth*[®] button and the wired input button on the back of the wireless control dial.

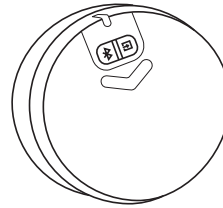

SWITCH BETWEEN DIFFERENT AUDIO SOURCES

SWITCH BETWEEN TWO WIRED CONNECTIVITY

To switch between wired connection (3.5 mm and USB), press wired input button on the bottom of the dial. The LED color will change correspondingly.

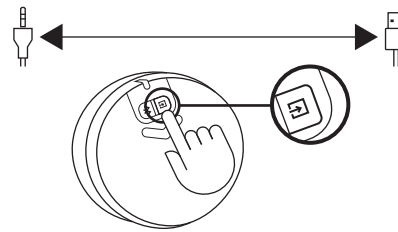

SWITCH BETWEEN WIRED AND WIRELESS CONNECTIVITY

To switch from wired connection to wireless connection (*Bluetooth*[®]), press *Bluetooth*[®] button on the bottom of the dial.

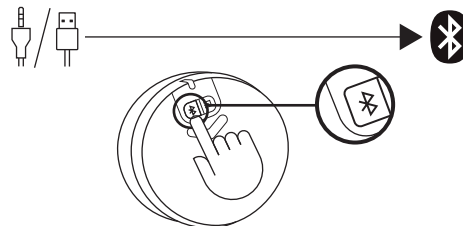

To switch from wireless connection to wired connection, press wired input button on the bottom of the dial.

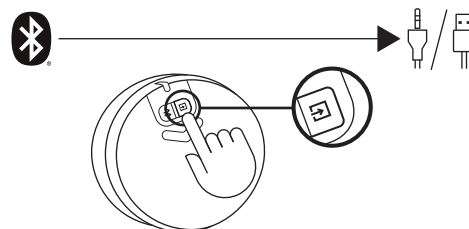

CONTROL YOUR AUDIO CONTENT

ADJUST THE VOLUME

- To adjust the volume of the speaker, rotate the wireless dial control clockwise (counterclockwise) to increase (decrease) the volume.
- When reaching to MAX volume, you will hear a notification tone.

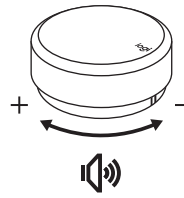

 Max volume

ADJUST THE BASS

- To adjust the bass level, long press the dial for 2 sec. and enter bass mode, you will hear a notification sound. Rotate clockwise (counterclockwise) to increase (decrease) the bass volume.
- Long press 2 sec. to exit bass mode, you will hear an exit notification sound.
- If you did not exit bass mode after adjusting the bass, the system will automatically change back to volume mode after 15 seconds without using.
- You will hear a notification sound when you reach Max and Min bass level.

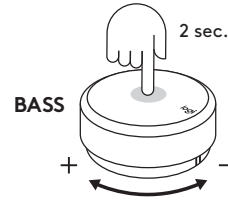

 Enter bass
Exit bass
Max bass volume
Min bass volume

PLAY/PAUSE (MUTE/UNMUTE)

- Press once on the dial to play/pause (mute/unmute) your audio content.
- Play/pause (Mute/unmute) will only be activated when the speaker is connected via *Bluetooth*® or USB input (3.5 mm).

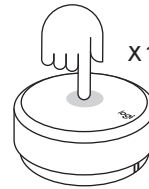

SKIP

- Press twice on the dial to skip your current track.
- Skip will only be activated when the speaker is connected via *Bluetooth*® or USB input.

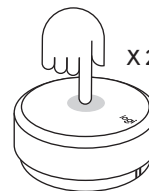

REWIND

- Triple press on the dial to replay the soundtrack.
- Rewind will only be activated when the speaker is connected via *Bluetooth*® or USB input.

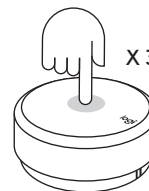

RESET ALL SETTINGS

Long press the *Bluetooth*[®] button and the wired input button at the same time for 8 sec. to reset the system.

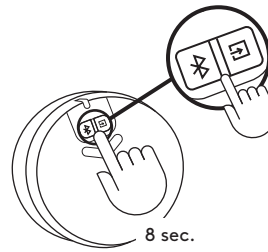

The LED will start to fast blink twice and then you will hear a reset tone. The LED will turn to solid blue after you successfully reset the speaker system.

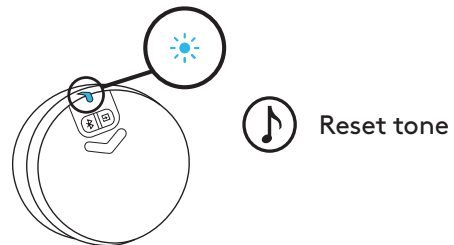

CONTROL DIAL EXPERIENCE

	Usage	Description	LED Status	LED Color	Sonification	Actions
1	Connection (Dial - Speaker)	Default connected to the speaker	Solid	Blue		
2		Waiting for connection to the speaker	Slow blink	Blue		
3		Dial link lost	Slow blink	White (USB) / Blue (BT) / Purple (AUX)		
4		New dial connects to the speaker	Solid	Blue	V	
5	Connection (Speaker - Device)	Connected / Normal Operation	Solid	White (USB) / Blue (BT) / Purple (AUX)		Long press <i>Bluetooth</i> button for 2 sec.
6		<i>Bluetooth</i> pairing to device	Fast blinking	Blue	V	
7		<i>Bluetooth</i> connected	Solid	Blue	V	
8		<i>Bluetooth</i> disconnected	Solid	Blue	V	
9	Media controls	Play / Pause	Solid	White (USB) / Blue (BT)		One press
10		Mute / Unmute		Purple (AUX)		One press
11		Track forward		White (USB) / Blue (BT)		Double press
12		Rewind (Track backward)		White (USB) / Blue (BT)		Triple press
13	Volume controls	Adjust the system volume	Solid	White (USB) / Blue (BT) / Purple (AUX)		Rotate the dial
14		Adjust the bass volume				Long press 2 sec. to enter and exit bass mode
15		Max volume				V
16		Max bass				V
17	System	Low Battery	Solid	Red		
18		Extreme low battery	Fast blink	Red		
19		Reset all settings	Fast blink → Solid	Status color → Blue	V	Press & hold BT and wired input button for 8 sec.

www.logitech.com/support/Z407

瞭解您的產品

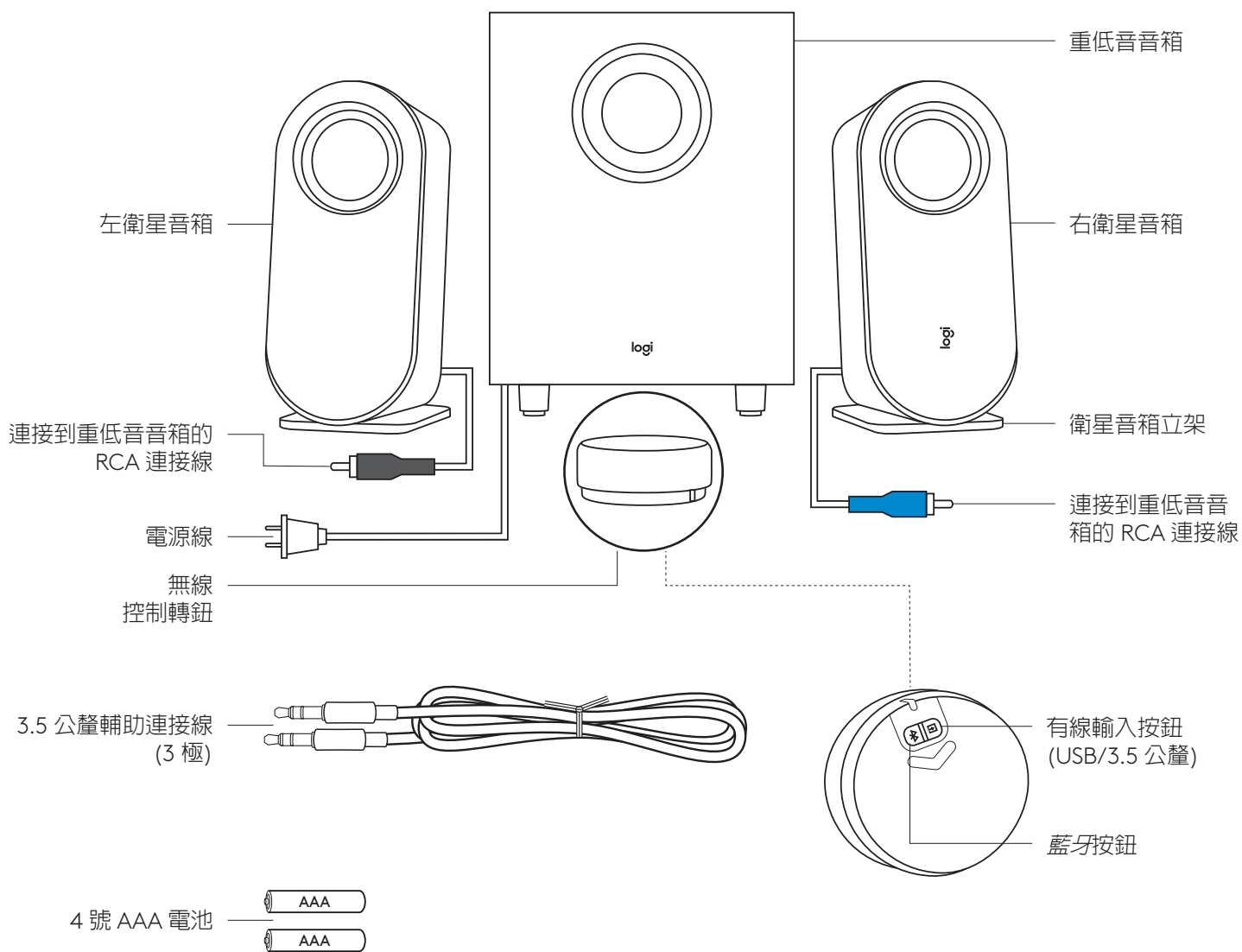

包裝內容

1. 左衛星音箱
2. 右衛星音箱
3. 重低音音箱
4. 無線控制轉鈕
5. 2 個 4 號 AAA 電池
6. 衛星音箱立架
7. 3.5 公釐連接線
8. 使用者文件

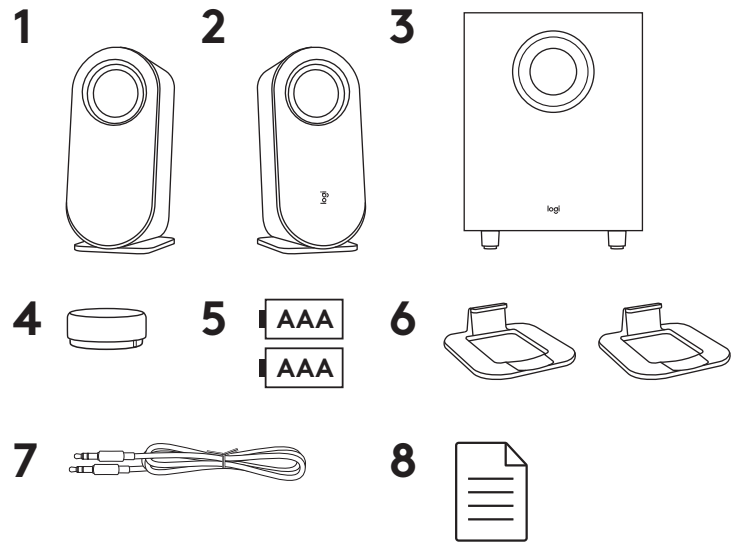

連接音箱

將支架分別與放置到每個衛星音箱上。依照您的喜好垂直或水平放置音箱。確認支架緊密貼合音箱。

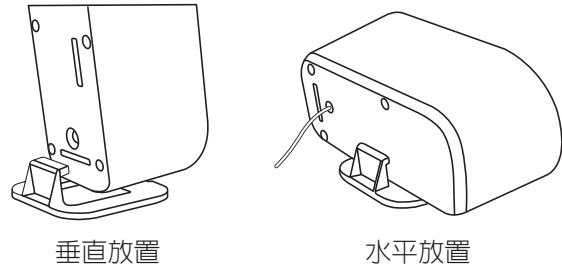

- 將右衛星音箱連接線插入藍色的重低音音箱插孔。
- 將左衛星音箱連接線插入灰色的重低音音箱插孔。

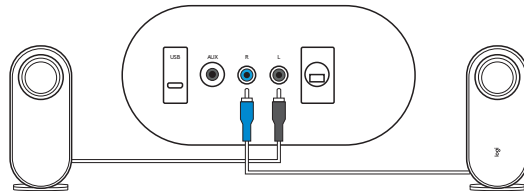

將電源線插入到電氣插座。
您會聽到歡迎提示音。

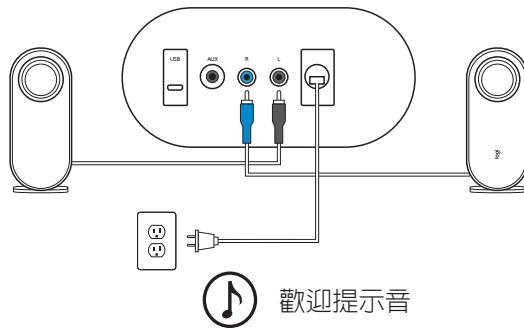

連接音箱 (續)

長按並向下按壓以開啓背蓋，將兩個 4 號 AAA 電池放入到對應的空間。

切勿混合使用鹼性電池與充電電池。

切勿混合使用新舊電池。

長時間不使用產品時切勿將電池留在其中。

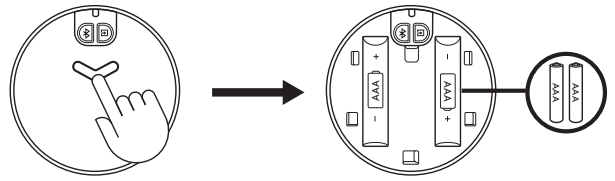

然後 LED 指示燈會開始閃爍藍燈。當無線控制轉鈕成功連線到音箱後，LED 指示燈會穩定亮起藍燈。

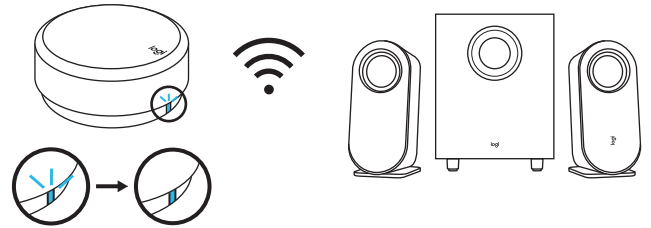

連接到音訊來源

控制轉鈕上的 LED 指示燈會隨著使用不同連線方式連接時相應變化。

- 當透過藍牙連線時，LED 指示燈會亮起藍燈。
- 當透過 3.5 公釐連線時，LED 指示燈會亮起紫燈。
- 當透過 USB 公釐連線時，LED 指示燈會亮起白燈。

透過藍牙連線

請確定音源裝置上的藍牙功能已經啓用。

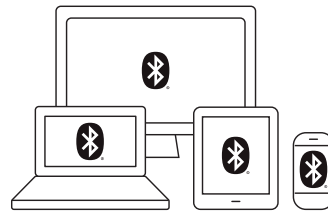

- 按住轉鈕底部的藍牙按鈕 (2 秒)，以啓動配對模式。
- LED 指示燈會快速閃爍。您會開始聽到配對提示音。

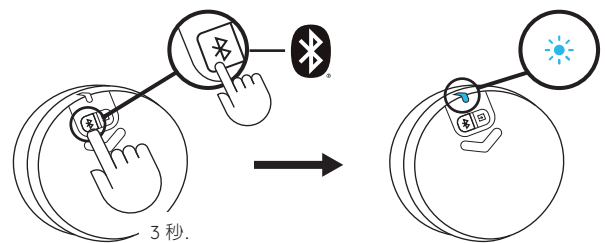

在您的藍牙裝置清單中，選擇並連線到「Logi Z407」。您會聽到歡迎提示音。

LED 指示燈會變成穩定藍燈。

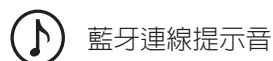
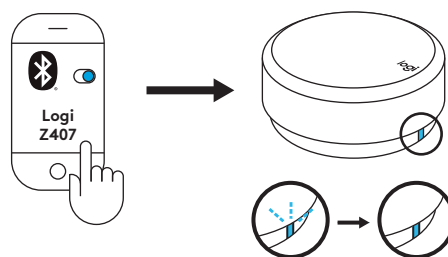

透過 3.5 公釐連接線連接

將隨附的 3.5 公釐連接線的一端，連接到重低音音箱背面的輔助輸入埠。
然後將連接線的另一端，連接到裝置上的 3.5 公釐音訊插孔。

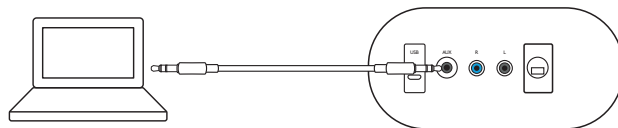

預設的連線方式是藍牙。若要透過 3.5 公釐連線播放，請按下轉鈕背面的有線輸入按鈕。
LED 指示燈會變成紫燈。

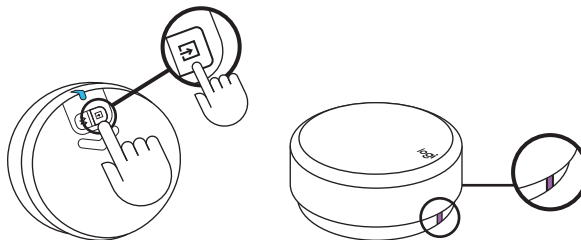

透過 USB 連接線連接

將 USB 連接線的一端連接到重低音音箱背面的 Micro USB 輸入插孔。
然後將連接線的另一端，連接到裝置上的 USB-A 輸入插孔。

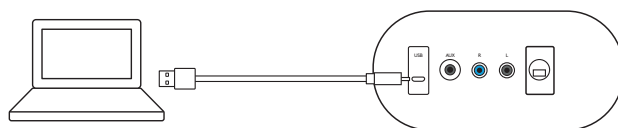

注意：包裝盒內未隨附 USB 連接線，需另購。

預設的連線方式是藍牙。若要透過 USB 連線播放，請按下轉鈕背面的有線輸入按鈕。
LED 指示燈會變成白燈。

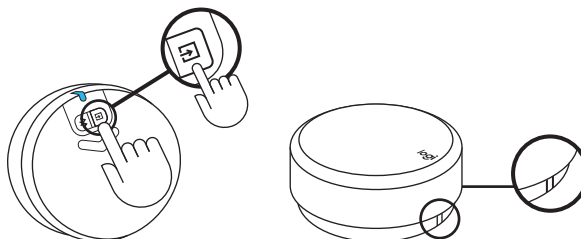

最多可同時連線三台裝置

透過重低音音箱背面的 Micro USB 輸入插孔、3.5 公釐輸入插孔，以及藍牙功能，可同時連線到三台裝置。

您可以將音箱與最多八個藍牙音源裝置配對。

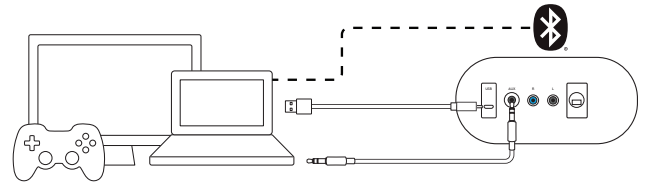

若要切換有線和無線音訊來源，請按下藍牙按鈕以及無線控制轉鈕背面的有線輸入按鈕。

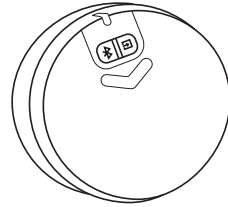

切換不同的音訊來源

在兩個有線連線間切換

若要在有線連線 (3.5 公釐和 USB) 間切換，請按下轉鈕背面的有線輸入按鈕。

LED 指示燈顏色會依照不同連接方式改變亮燈顏色。

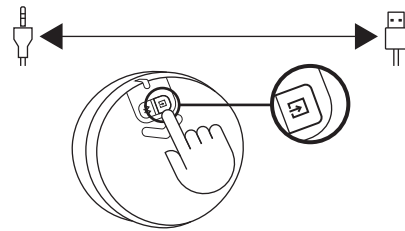

切換有線和無線連線

若要從有線連線切換到無線連線 (藍牙)，請按下轉鈕下方的藍牙按鈕。

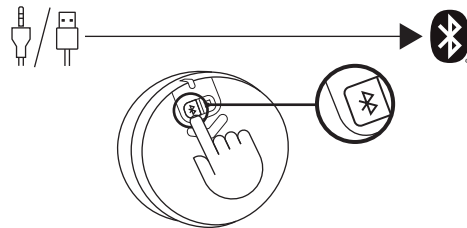

若要從無線連線切換到有線連線，請按下轉鈕背面的有線輸入按鈕。

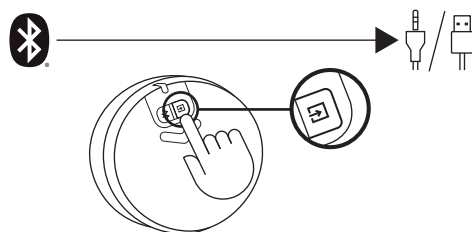

控制音訊內容

調整音量

- 若要調整音箱音量，請順時針 (逆時針) 方向旋轉無線控制轉鈕以調高 (調低) 音量。
- 到達最大音量時，會聽到提示音。

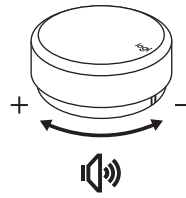

調整低音

- 要調整低音音量，請長按轉鈕 2 秒進入低音模式，然後您會聽到提示音。順時針 (逆時針) 旋轉可增加 (減少) 低音音量。
- 長按 2 秒退出低音模式，您會聽到提示音。
- 如果沒有在調整低音後退出低音模式，系統會在靜置 15 秒後自動變更回音量模式。
- 當到達最大和最小低音音量時，會聽到通知音效。

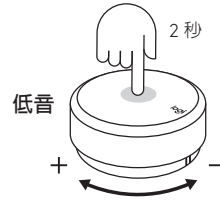

進入低音模式
退出低音模式
最大低音音量
最小低音音量

播放/暫停 (靜音/取消靜音)

- 按一下控制轉鈕可播放/暫停 (靜音/取消靜音) 您的音訊內容。
- 播放/暫停 (靜音/取消靜音) 僅會在音箱透過藍牙或 USB 輸入 (3.5 公釐) 連線時啟用。

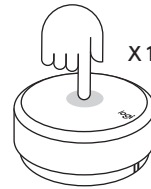

跳過

- 按兩下轉鈕可跳過目前的歌曲。
- 跳過僅會在音箱透過藍牙或 USB 輸入連線時啟用。



倒轉

- 按三下轉鈕可重播歌曲。
- 倒轉僅會在音箱透過藍牙或 USB 輸入連線時啟用。

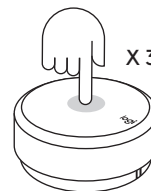

重設所有設定

同時長按藍牙按鈕與有線輸入按鈕 8 秒可重設系統。

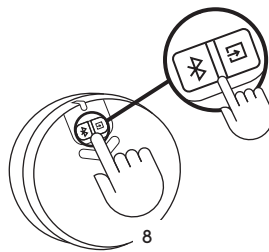

LED 指示燈會快速閃爍兩次，然後您會聽到重設提示音。
LED 指示燈會在成功重設音箱系統後呈藍燈恆亮。

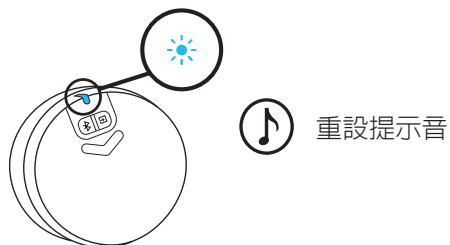

控制轉鈕體驗

	用途	說明	LED 狀態指示燈	LED 指示燈顏色	提示音	動作	
1	連線 (轉鈕 - 音箱)	預設連線到音箱	恆亮	藍燈			
2		等待連線到音箱	緩慢閃爍	藍燈			
3		轉鈕連結喪失	緩慢閃爍	白燈 (USB) / 藍燈 (藍牙) / 紫燈 (輔助輸入)			
4		新轉鈕連線到音箱	恆亮	藍燈	V		
5	連線 (音箱 - 裝置)	已連線 / 正常操作	恆亮	白燈 (USB) / 藍燈 (藍牙) / 紫燈 (輔助輸入)			
6		藍牙配對到裝置	快速閃爍	藍燈	V		長按藍牙按鈕 2 秒。
7		藍牙已連線	恆亮	藍燈	V		
8		藍牙已中斷連線	恆亮	藍燈	V		
9	媒體控制鍵	播放/暫停	恆亮	白燈 (USB) / 藍燈 (藍牙)		按一下	
10		靜音/取消靜音		紫燈 (輔助輸入)		按一下	
11		曲目向前快轉		白燈 (USB) / 藍燈 (藍牙)		按兩下	
12		倒轉 (歌曲倒帶)		白燈 (USB) / 藍燈 (藍牙)		按三下	
13	音量控制	調整系統音量	恆亮	白燈 (USB) / 藍燈 (藍牙) / 紫燈 (輔助輸入)		旋轉轉鈕	
14		調整低音音量				長按 2 秒可進入和退出低音模式	
15		最大音量				V	
16		最大低音音量				V	
17	系統	電池電量偏低	恆亮	紅燈			
18		電池電量嚴重不足	快速閃爍	紅燈			
19		重設所有設定	快速閃爍 → 恆亮	狀態指示燈顏色 → 藍色	V	同時按住藍牙與有線輸入按鈕 8 秒	

www.logitech.com/support/Z407

제품 설명

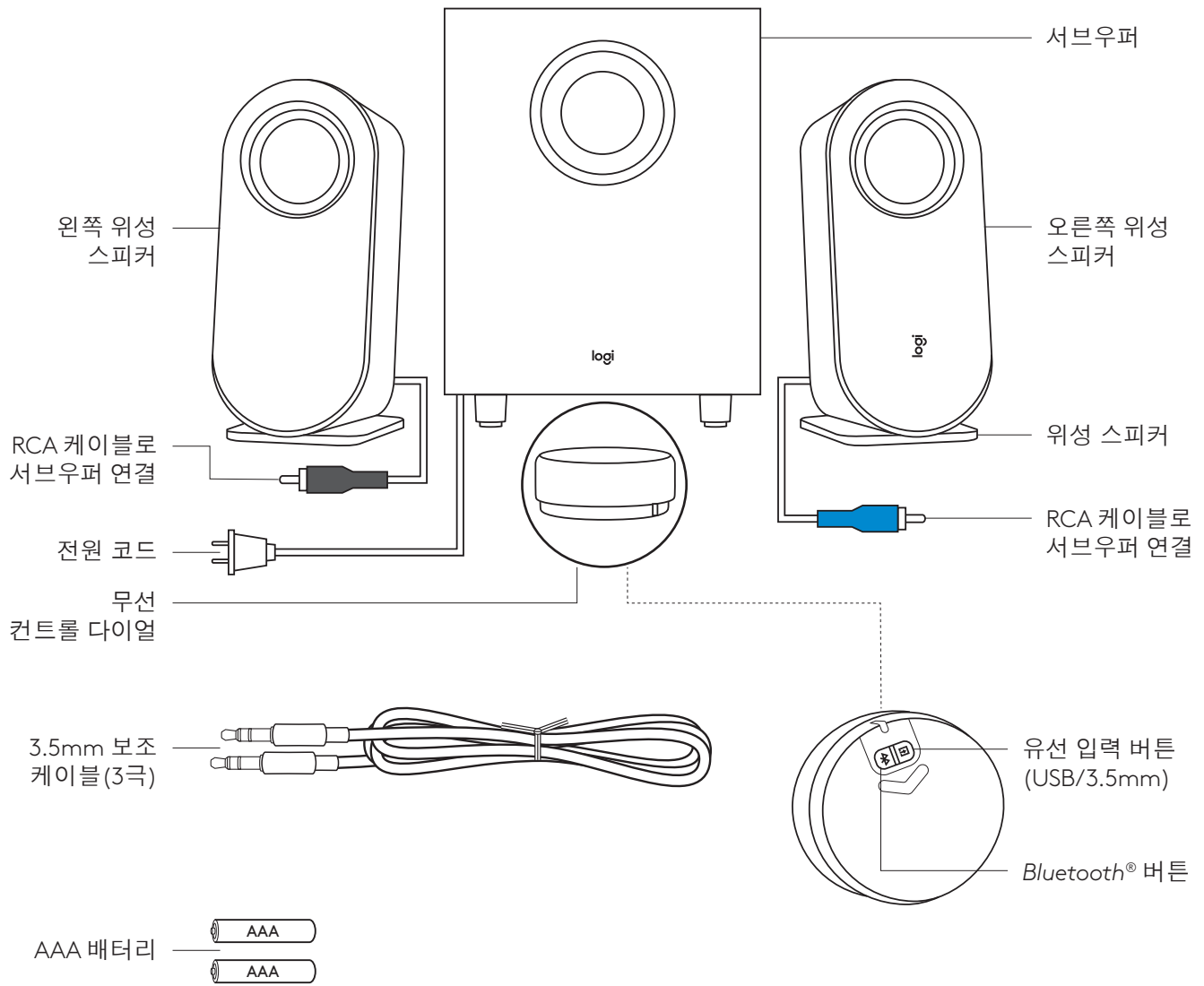

박스 구성품

1. 왼쪽 위성 스피커
2. 오른쪽 위성 스피커
3. 서브우퍼
4. 무선 컨트롤 다이얼
5. AAA 배터리 2개
6. 스피커 스탠드
7. 3.5 mm 케이블
8. 사용 설명서

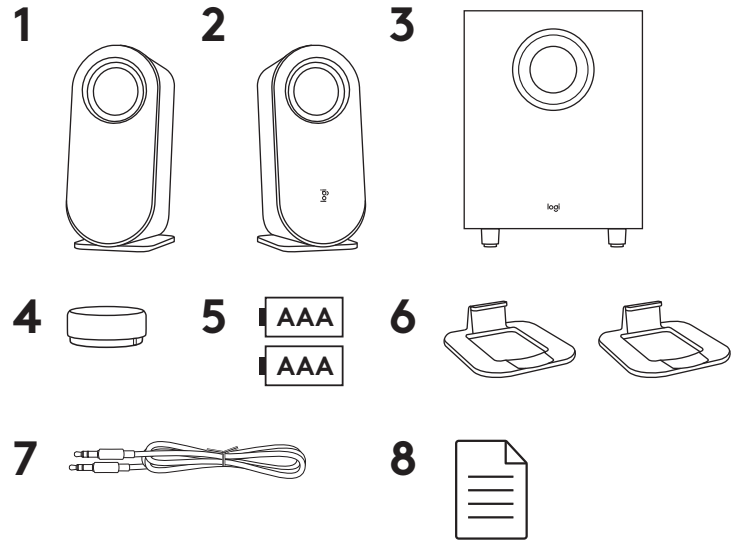

스피커 연결

스피커 스탠드에 위성 스피커를 원하는 방향으로 배치합니다. 스탠드에 스피커를 완전히 고정하십시오.

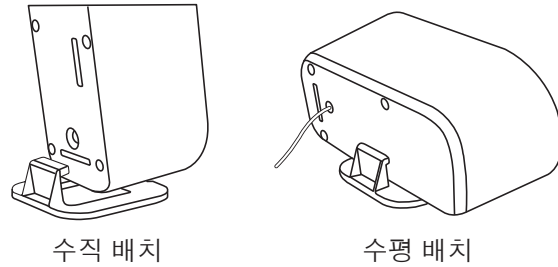

- 오른쪽 위성 스피커 케이블을 파란색 서브우퍼 잭에 연결합니다.
- 왼쪽 위성 스피커 케이블을 회색 서브우퍼 잭에 연결합니다.

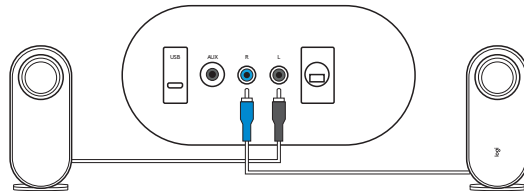

전원 코드를 전기 콘센트에 연결합니다.
전원이 켜지면 신호음이.

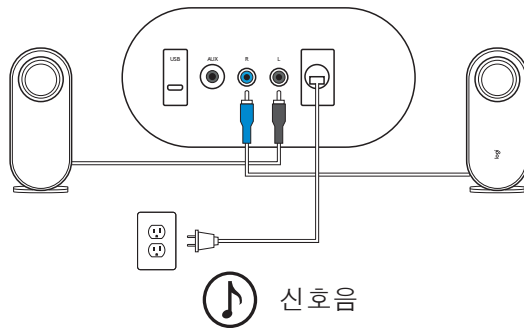

스피커 연결(계속)

길게 아래쪽으로 눌러 뒤쪽 뚜껑을 연 뒤, AAA 배터리 2개를 해당 공간에 넣습니다.

알칼리 전지를 충전식 배터리와 함께 사용하지 마십시오.
 새 배터리와 오래된 배터리를 함께 사용하지 마십시오.
 장기간 사용하지 않는 제품에 배터리를 넣어두지 마십시오.

LED 표시등이 파란색으로 깜빡이기 시작합니다.
 무선 컨트롤 다이얼이 스피커에 성공적으로 연결되면
 파란색 LED가 켜집니다.

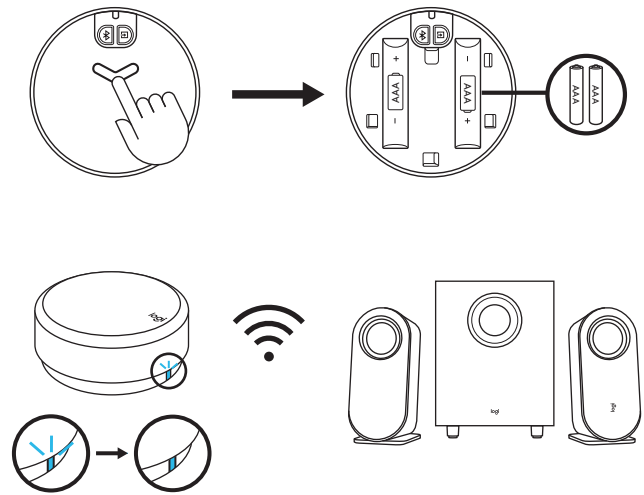

오디오 소스 연결

오디오 소스에 따라 LED 색상이 변경됩니다.

- Bluetooth를 통해 연결하면 LED가 파란색으로 켜집니다.
- 3.5mm를 통해 연결하면 LED가 보라색으로 켜집니다.
- USB를 통해 연결하면 LED가 하얀색으로 켜집니다.

BLUETOOTH®로 연결

연결하고자 하는 기기에 Bluetooth®가 활성화되어 있는지 확인합니다.

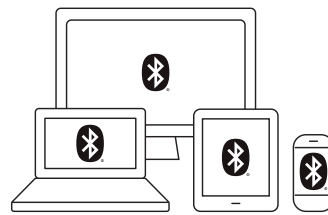

- 페어링 모드를 활성화하려면 다이얼 하단의 Bluetooth® 버튼을 길게 누릅니다(2초).
- LED 표시등이 빠르게 깜빡입니다. 페어링 알림음이 들립니다.

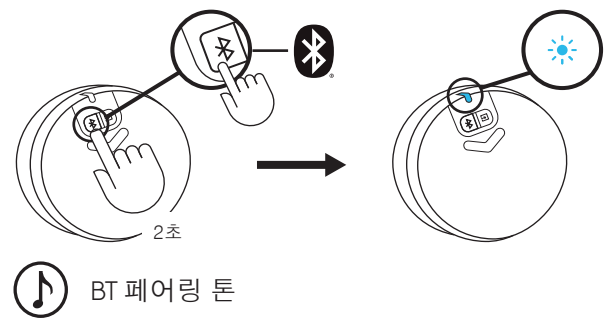

Bluetooth® 장치 목록에서
 "Logi Z407"을 선택 및 연결합니다. 연결음이 들립니다.

LED가 파란색으로 유지됩니다.

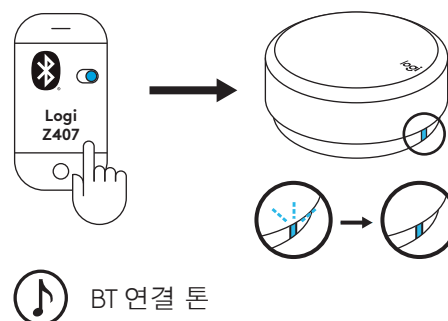

3.5MM 케이블 연결

제공된 3.5mm 케이블의 한 쪽 케이블을 서버우퍼 뒷면에 있는 보조 입력에 연결합니다.
그다음 케이블의 다른 쪽 케이블을 장치의 3.5mm 오디오 잭에 연결하십시오.

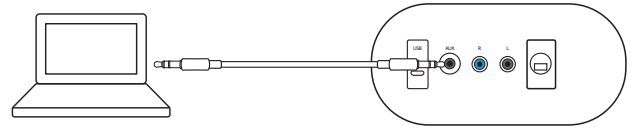

기본 연결은 Bluetooth®입니다. 3.5mm 연결을 통해 플레이하려면 다이얼 후면의 유선 입력 버튼을 누릅니다. LED 표시등이 보라색으로 변합니다.

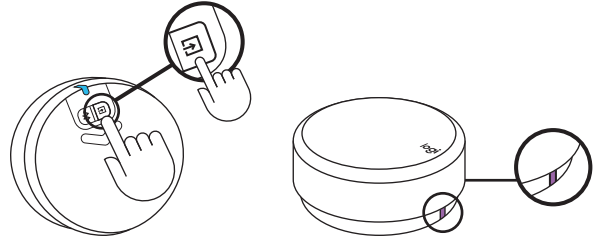

USB 케이블 연결

USB 케이블의 한 쪽 케이블을 서버우퍼의 뒤쪽에 있는 마이크로 USB 입력에 연결하십시오.
그다음 케이블의 다른 쪽 끝을 장치의 USB-A 입력에 연결하십시오.

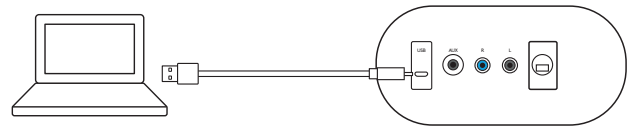

참고: USB 케이블은 박스에 동봉되어있지 않습니다.
별도로 구매하십시오.

기본 연결은 Bluetooth®입니다. USB 연결을 통해 플레이하려면 다이얼 후면의 유선 입력 버튼을 누릅니다. LED 표시등이 하얀색으로 변합니다.

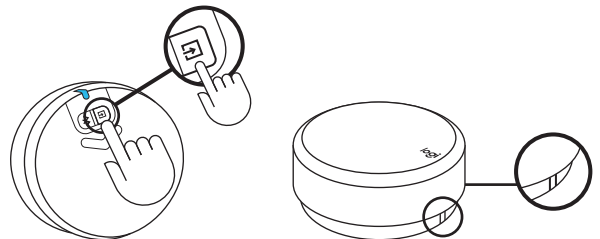

최대 3개 장치를 동시에 연결할 수 있습니다

마이크로 USB 입력, 서브우퍼 뒤쪽의 3.5mm 입력, Bluetooth®를 통해 최대 3대의 장치를 동시에 연결할 수 있습니다.

최대 8개의 Bluetooth® 소스 장치를 스피커와 페어링할 수 있습니다.

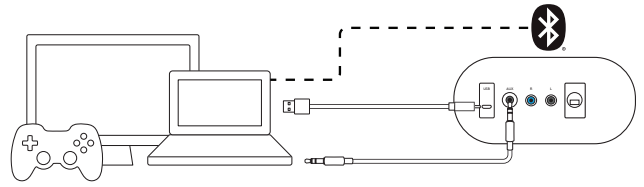

유선 및 무선 오디오 소스에서 전환하려는 경우, Bluetooth® 버튼과 무선 컨트롤 다이얼의 유선 입력 버튼을 누릅니다.

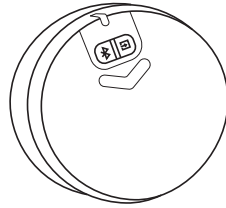

다른 오디오 소스의 전환

두 개의 유선 연결의 전환

유선 연결 (3.5mm 및 USB)을 전환하려면 다이얼 하단의 유선 입력 버튼을 누릅니다. LED 색상이 그에 따라 변경됩니다.

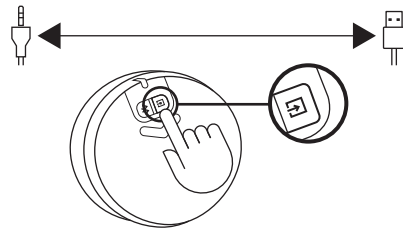

유선 및 무선 연결의 전환

유선 연결에서 무선 연결 (Bluetooth®)로 전환하려면 다이얼 하단의 Bluetooth® 버튼을 누릅니다.

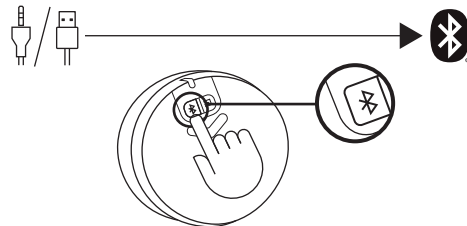

무선 연결에서 유선 연결로 전환하려면 다이얼 하단의 유선 입력 버튼을 누릅니다.

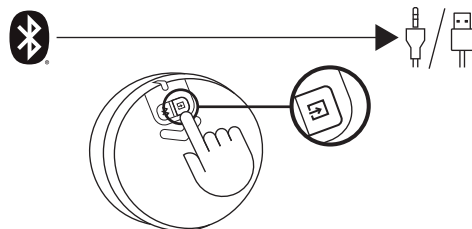

오디오 콘텐츠 제어

음량 조절

- 스피커의 볼륨을 조절하려면 무선 다이얼 컨트롤을 사용합니다. 시계 방향으로 돌리면 볼륨이 높아집니다(낮추려면 시계 반대 방향).
- 최대 볼륨에 도달하는 경우 알림음이 들립니다.

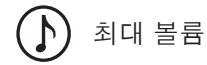
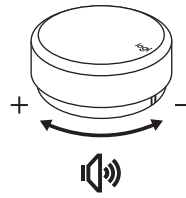

최대 볼륨

베이스 조절

- 베이스 레벨을 조절하려면 다이얼을 2초간 길게 눌러 베이스 모드로 전환합니다. 알림음이 들립니다. 시계 방향으로 돌리면 베이스 볼륨이 높아집니다(낮추려면 시계 반대 방향).
- 베이스 모드를 나가려면 2초간 길게 누릅니다. 종료 알림음이 들립니다.
- 베이스를 조절한 뒤 베이스 모드를 나가지 않는 경우, 사용하지 않은 뒤 15초 후에 시스템에서 자동으로 볼륨 모드로 나갑니다.
- 최대 및 최소 베이스 레벨에 도달하면 알림음이 들립니다.

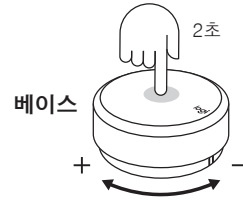

베이스 모드 시작
베이스 모드 종료
최대 베이스 볼륨
최소 베이스 볼륨

재생/일시 중지(음소거/음소거 해제)

- 다이얼을 한 번 눌러 오디오 콘텐츠를 재생/일시 중지(음소거/음소거 해제)합니다.
- 재생/일시 중지(음소거/음소거 해제)는 스피커가 Bluetooth® 또는 USB 입력(3.5 mm)을 통해 연결된 경우에만 활성화됩니다.

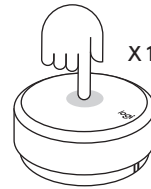

건너뛰기

- 다이얼을 두 번 누르면 현재 트랙을 건너뜁니다.
- 건너뛰기는 스피커가 Bluetooth® 또는 USB 입력을 통해 연결된 경우에만 활성화됩니다.

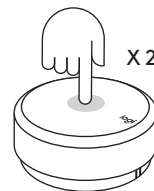

되감기

- 다이얼을 세 번 누르면 사운드 트랙을 다시 재생합니다.
- 되감기는 스피커가 Bluetooth® 또는 USB 입력을 통해 연결된 경우에만 활성화됩니다.

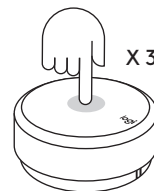

모든 설정 초기화

Bluetooth® 버튼과 유선 입력 버튼을 동시에 8초간 길게 누르면, 시스템이 초기화됩니다.

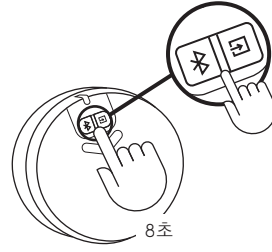

LED가 빠르게 깜박이기 시작하며 초기화 톤이 들립니다. 스피커 시스템을 성공적으로 초기화하면 LED가 파란색으로 켜집니다.



다이얼 경험 제어

	용도	설명	LED 상태	LED 색상	언어 지원	동작	
1	연결 (다이얼 - 스피커)	스피커 기본 연결	계속 켜짐	파란색			
2		스피커 연결 대기 중	느리게 깜박임	파란색			
3		다이얼 링크 끊어짐	느리게 깜박임	하얀색(USB) / 파란색(BT) / 보라색(AUX)			
4		스피커에 새로운 다이얼 연결	계속 켜짐	파란색	V		
5	연결 (스피커 - 장치)	연결 / 정상 작동	계속 켜짐	하얀색(USB) / 파란색(BT) / 보라색(AUX)			
6		장치에 Bluetooth 페어링	빠르게 깜박임	파란색	V		2초간 Bluetooth 버튼을 길게 누름.
7		Bluetooth 연결	계속 켜짐	파란색	V		
8		Bluetooth 연결 해제	계속 켜짐	파란색	V		
9	미디어 컨트롤	재생 / 일시 정지	계속 켜짐	하얀색(USB) / 파란색(BT)		한 번 누르기	
10		음소거/음소거 해제		보라색(AUX)		한 번 누르기	
11		트랙 앞으로		하얀색(USB) / 파란색(BT)		두 번 누르기	
12		뒤감기(트랙 뒤로)		하얀색(USB) / 파란색(BT)		세 번 누르기	
13	볼륨 컨트롤	시스템 볼륨 조절	계속 켜짐	하얀색(USB) / 파란색(BT) / 보라색(AUX)		다이얼 회전	
14		베이스 볼륨 조절				2초간 길게 눌러 베이스 모드 진입 및 퇴장	
15		최대 볼륨				V	
16		최대 베이스				V	
17	시스템	배터리 부족	계속 켜짐	빨간색			
18		충전 필요	빠르게 깜박임	빨간색			
19		모든 설정 초기화	빠르게 깜박임 → 계속 켜짐	상태 색 → 파란색	V	8초간 BT 및 유선 입력 버튼을 길게 누름	

www.logitech.com/support/Z407

MENGENAL PRODUK

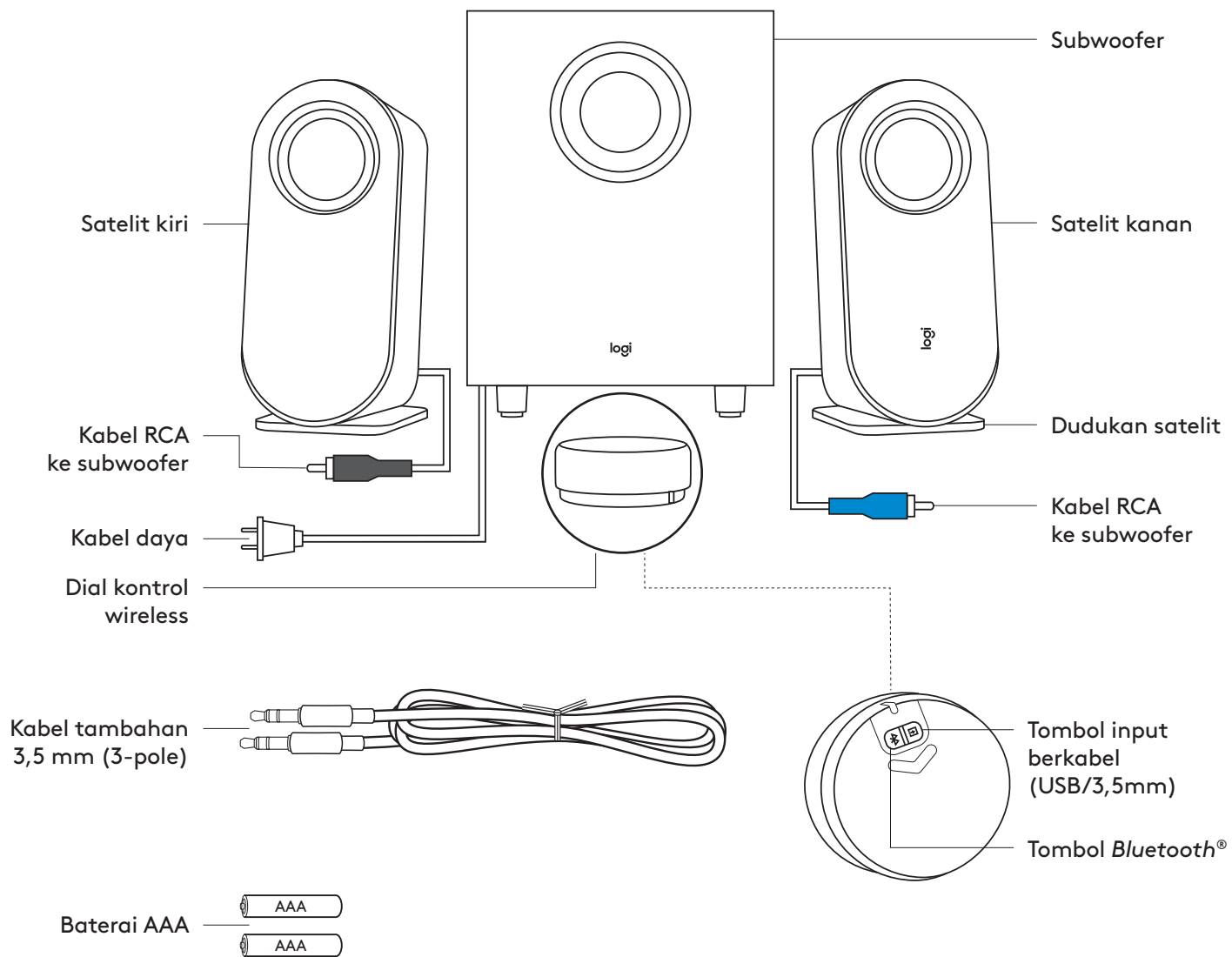

ISI KOTAK

1. Satelit kiri
2. Satelit kanan
3. Subwoofer
4. Dial kontrol wireless
5. 2 baterai AAA
6. Dudukan satelit
7. Kabel 3,5 mm
8. Dokumentasi pengguna

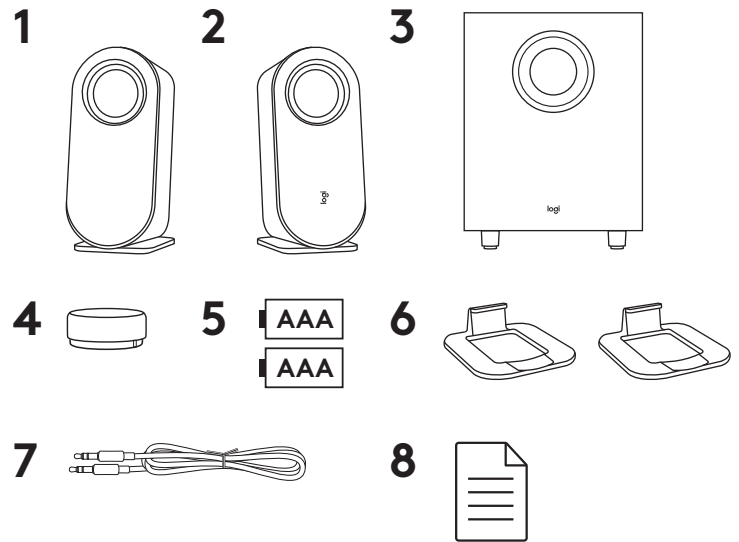

MENGHUBUNGAN SPEAKER

Letakkan dudukan setiap satelit secara terpisah. Letakkan speaker secara vertikal atau horizontal sesuai keinginan Anda. Pastikan speaker sudah terpasang baik di dudukan.

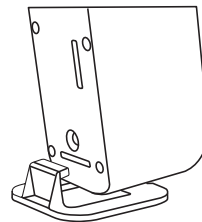

Penempatan vertikal

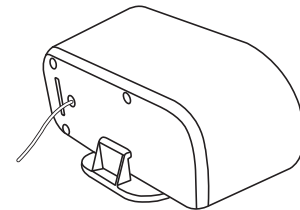

Penempatan horizontal

- Tancapkan kabel satelit kanan ke jack subwoofer biru.
- Tancapkan kabel satelit kiri ke jack subwoofer abu-abu.

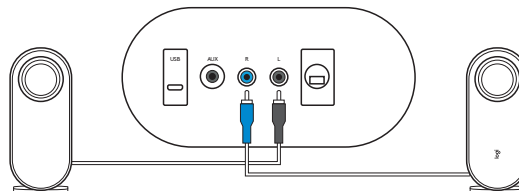

Tancapkan kabel daya ke stopkontak listrik. Anda akan mendengar suara notifikasi penyambutan.

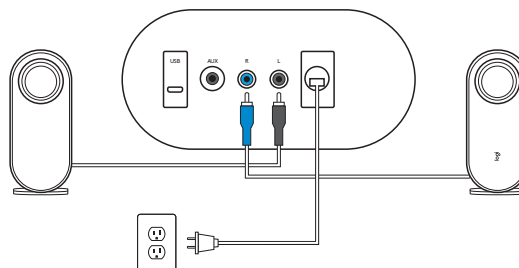

🎵 Nada selamat datang

MENGHUBUNGKAN SPEAKER (LANJUTAN)

Tekan yang lama dan dorong ke bawah untuk membuka tutup belakang, masukkan dua baterai AAA ke dalam kompartemen yang sesuai.

*Jangan gabungkan baterai alkaline dengan baterai yang dapat diisi ulang.
Jangan gabungkan baterai baru dengan yang lama.
Jangan tinggalkan baterai dalam produk yang tidak digunakan untuk periode waktu yang lama.*

Indikator LED akan mulai berkedip biru. Setelah dial kontrol wireless berhasil terhubung dengan speaker, LED akan berubah menjadi cahaya biru stabil.

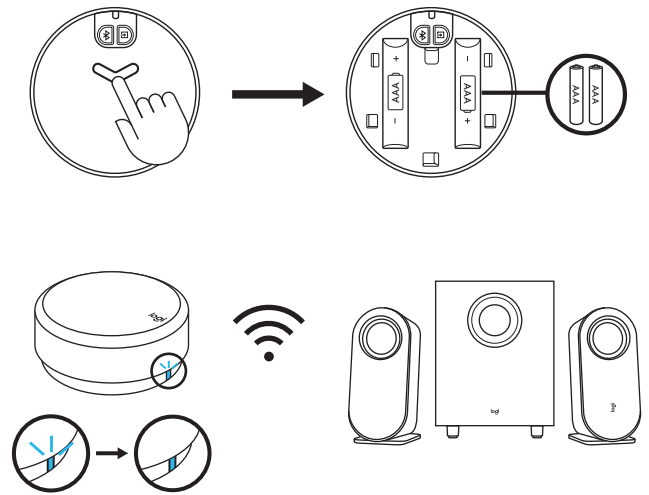

MENGHUBUNGKAN KE SUMBER AUDIO

LED di dial kontrol akan berubah ketika terhubung dengan konektivitas yang berbeda.

- LED akan menjadi biru saat terhubung via *Bluetooth*.
- LED akan menjadi ungu saat terhubung via 3,5 mm.
- LED akan menjadi putih saat terhubung via USB.

TERHUBUNG VIA *BLUETOOTH*[®]

Pastikan *Bluetooth*[®] sudah diaktifkan di perangkat sumber.

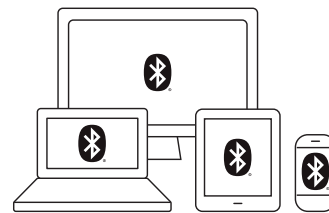

- Tekan dan tahan (2 detik) tombol *Bluetooth*[®] di bagian bawah dial untuk mengaktifkan mode pairing.
- Indikator LED akan berkedip cepat. Anda akan mulai mendengar notifikasi suara pairing.

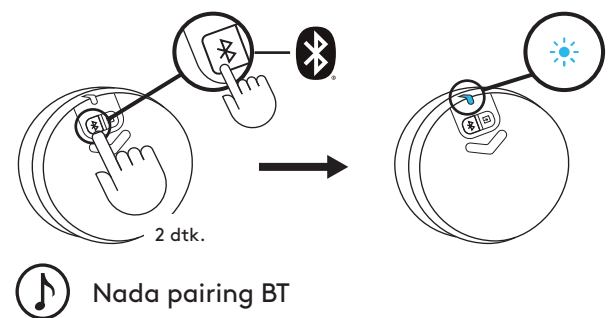

Pilih dan terhubung ke "Logi Z407" di daftar perangkat *Bluetooth*[®] Anda. Anda akan mendengar nada perangkat sudah terhubung.

LED akan berubah menjadi biru stabil.

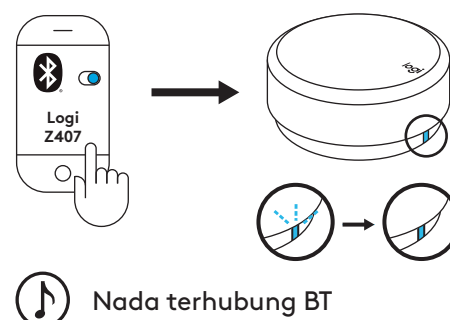

TERHUBUNG VIA KABEL 3,5 MM

Hubungkan salah satu ujung kabel 3,5 mm yang disediakan ke input tambahan di belakang subwoofer. Kemudian hubungkan ujung kabel lainnya ke jack audio 3,5 mm di perangkat Anda.

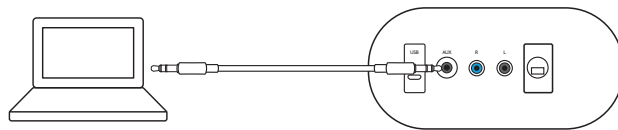

Konektivitas standar adalah *Bluetooth*®. Untuk menggunakan konektivitas 3,5 mm, tekan tombol input berkabel di bagian belakang dial. LED akan berubah ungu.

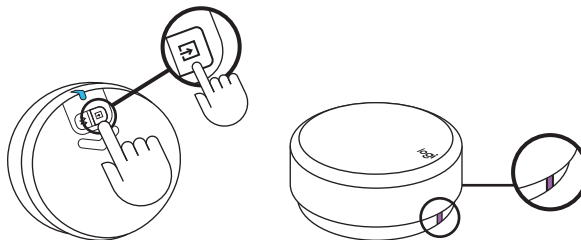

TERHUBUNG VIA KABEL USB

Hubungkan salah satu ujung kabel USB ke input micro USB di belakang subwoofer. Kemudian hubungkan ujung kabel lainnya ke input USB-A di perangkat Anda.

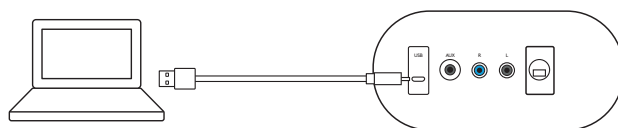

CATATAN: Kabel USB tidak disertakan di dalam kemasan dan harus dibeli terpisah.

Konektivitas standar adalah *Bluetooth*®. Untuk menggunakan konektivitas USB, tekan tombol input berkabel di bagian belakang dial. Cahaya LED akan berubah putih.

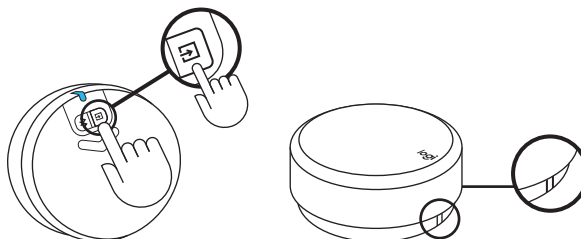

TERHUBUNG KE TIGA PERANGKAT SECARA BERSAMAAN.

Terhubung hingga tiga perangkat secara bersamaan melalui input micro USB, input 3,5 mm di bagian belakang subwoofer, dan Bluetooth®.

Anda dapat melakukan pairing hingga maksimal delapan perangkat sumber Bluetooth® dengan speaker Anda.

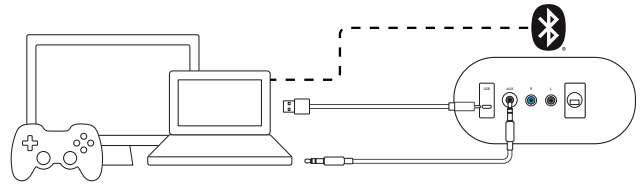

Untuk berganti-ganti antara sumber audio berkabel dan wireless, tekan tombol Bluetooth® dan tombol input berkabel di bagian belakang dial kontrol wireless.

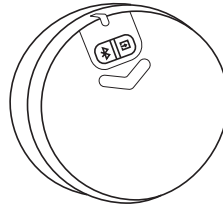

BERGANTI-GANTI ANTARA BEBERAPA SUMBER AUDIO

BERGANTI-GANTI ANTARA DUA KONEKTIVITAS BERKABEL

Untuk berganti-ganti antara koneksi berkabel (3,5 mm dan USB), tekan tombol input berkabel di bagian bawah dial.

Warna LED akan berubah sesuai koneksi.

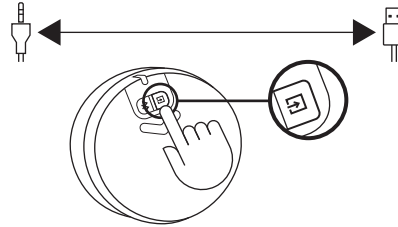

BERGANTI-GANTI ANTARA KONEKTIVITAS BERKABEL DAN WIRELESS.

Untuk berganti dari koneksi berkabel ke koneksi wireless (Bluetooth®), tekan tombol Bluetooth® di bagian bawah dial.

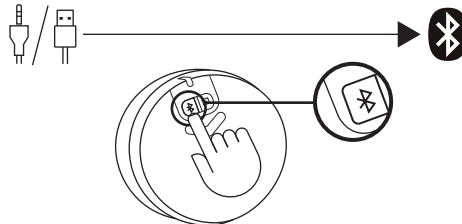

Untuk berganti dari koneksi wireless ke koneksi berkabel, tekan tombol input berkabel di bagian bawah dial.

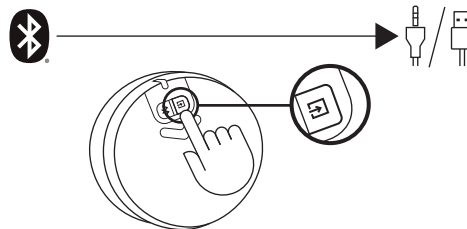

MENGONTROL KONTEN AUDIO ANDA

MENYESUAIKAN VOLUME

- Untuk menyesuaikan volume speaker, putar kontrol dial wireless searah jarum jam (atau berlawanan arah jarum jam) untuk memperbesar (mengecilkan) volume.
- Ketika sudah sampai volume MAKS, Anda akan mendengar nada notifikasi.

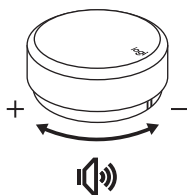

 Volume maks

MENYESUAIKAN BASS

- Untuk menyesuaikan level bass, tekan dial yang lama sekitar 2 dtk, kemudian masuk ke mode bass, Anda akan mendengar suara notifikasi. Putar searah jarum jam (melawan arah jarum jam) untuk memperbesar (mengecilkan) volume bass.
- Tekan 2 dtk lamanya untuk keluar dari mode bass, Anda akan mendengar suara notifikasi keluar.
- Jika Anda tidak langsung keluar dari mode bass setelah menyesuaikan bass, sistem akan secara otomatis berganti kembali ke mode volume setelah tidak digunakan selama 15 detik.
- Anda akan mendengar suara notifikasi ketika mencapai level bass Maks. dan Min.

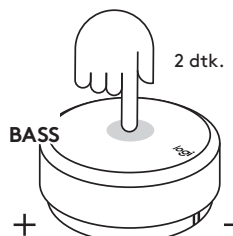

 Masuk bass
Keluar bass
Volume bass maks.
Volume bass min.

PLAY/PAUSE (MUTE/UNMUTE)

- Tekan dial sekali untuk play/pause (mute/unmute) konten audio Anda.
- Play/pause (Mute/unmute) hanya akan diaktifkan ketika speaker terhubung via input *Bluetooth*[®] atau USB (3,5 mm).

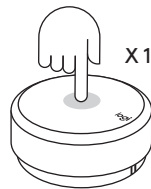

SKIP

- Tekan dial dua kali untuk skip track yang sedang diputar.
- Skip hanya akan diaktifkan ketika speaker terhubung via input *Bluetooth*[®] atau USB.

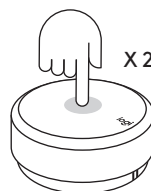

REWIND

- Tekan dial tiga kali untuk mengulangi soundtrack.
- Rewind hanya akan diaktifkan ketika speaker terhubung via input *Bluetooth*[®] atau USB.



RESET SEMUA PENGATURAN

Tekan tombol *Bluetooth*[®] dan tombol input berkabel pada saat yang bersamaan yang lama sekitar 8 dtk untuk mereset sistem.

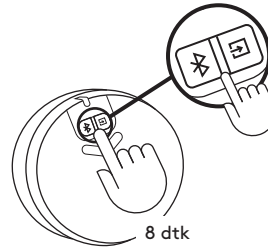

LED akan mulai berkedip cepat dua kali kemudian Anda akan mendengarkan nada reset. LED akan berubah biru solid setelah sukses me-reset sistem speaker.

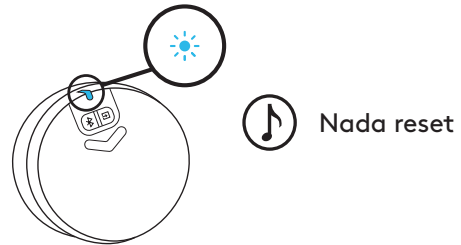

PENGALAMAN DIAL KONTROL

	Penggunaan	Deskripsi	Status LED	Warna LED	Sonification	Tindakan	
1	Koneksi (Dial - Speaker)	Default terhubung ke speaker	Stabil	Biru			
2		Menunggu koneksi dengan speaker	Berkedip perlahan	Biru			
3		Hubungan dial hilang	Berkedip perlahan	Putih (USB) / Biru (BT) / Ungu (AUX)			
4		Dial baru terhubung ke speaker	Stabil	Biru	V		
5	Koneksi (Speaker - Perangkat)	Terhubung / Operasi Normal	Stabil	Putih (USB) / Biru (BT) / Ungu (AUX)		Tahan tombol <i>Bluetooth</i> sekitar 2 dtk	
6		<i>Pairing Bluetooth</i> ke perangkat	Berkedip cepat	Biru	V		
7		<i>Bluetooth</i> terhubung	Stabil	Biru	V		
8		Koneksi <i>Bluetooth</i> terputus	Stabil	Biru	V		
9	Kontrol media	Play / Pause	Stabil	Putih (USB) / Biru (BT)		Sekali tekan	
10		Mute / Unmute		Ungu (AUX)		Sekali tekan	
11		Track maju		Putih (USB) / Biru (BT)		Tekan dua kali	
12		Rewind (Track mundur)		Putih (USB) / Biru (BT)		Tekan tiga kali	
13	Kontrol volume	Sesuaikan volume sistem	Stabil	Putih (USB) / Biru (BT) / Ungu (AUX)		Putar dial	
14		Sesuaikan volume bass				Tekan lama 2 dtk untuk masuk dan keluar mode bass	
15		Volume maks				V	
16		Bass maks				V	
17	Sistem	Daya Baterai Rendah	Stabil	Merah			
18		Daya baterai hampir habis	Berkedip cepat	Merah			
19		Reset semua pengaturan	Berkedip cepat → Stabil	Warna status → Biru	V	Tekan & tahan BT dan tombol input berkabel selama 8 dtk	

www.logitech.com/support/Z407