

Z333 SPEAKER SYSTEM WITH SUBWOOFER

Complete Setup Guide
完整设置指南

完整設定指南
설치 가이드

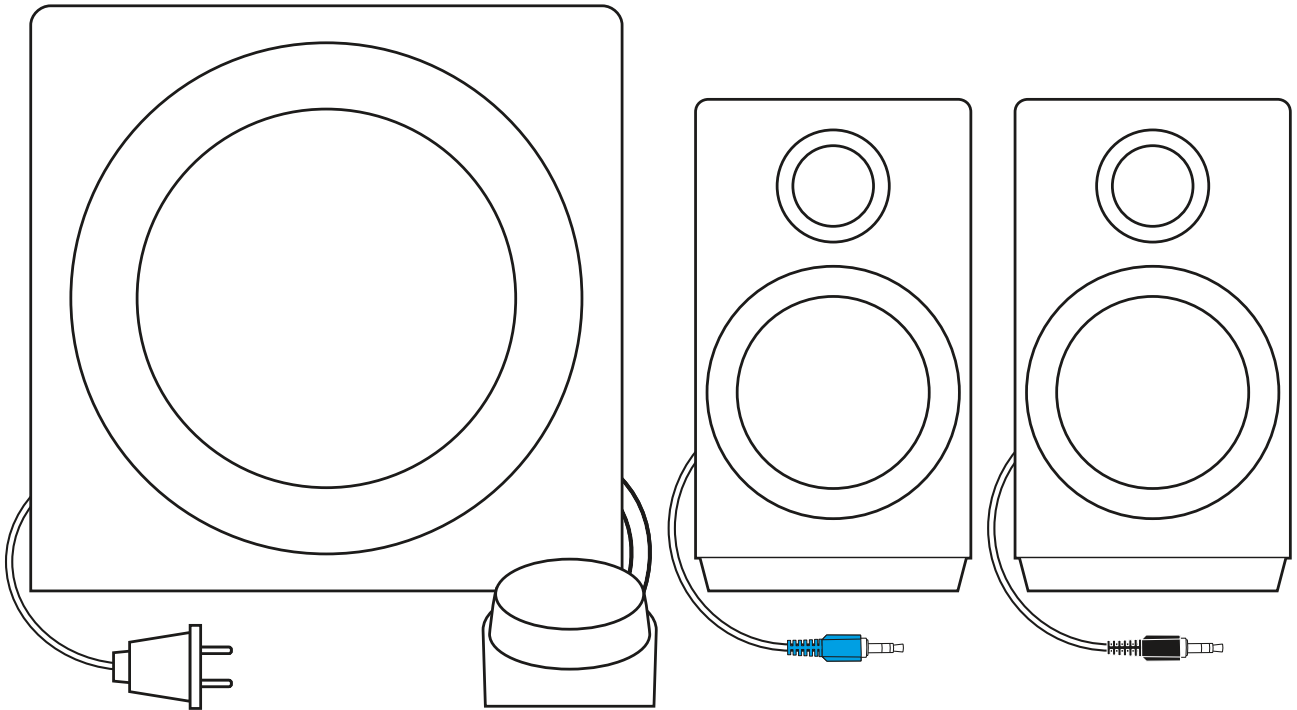

logitech®

CONTENTS

English3

简体中文7

繁體中文 11

한국어 15

KNOW YOUR PRODUCT

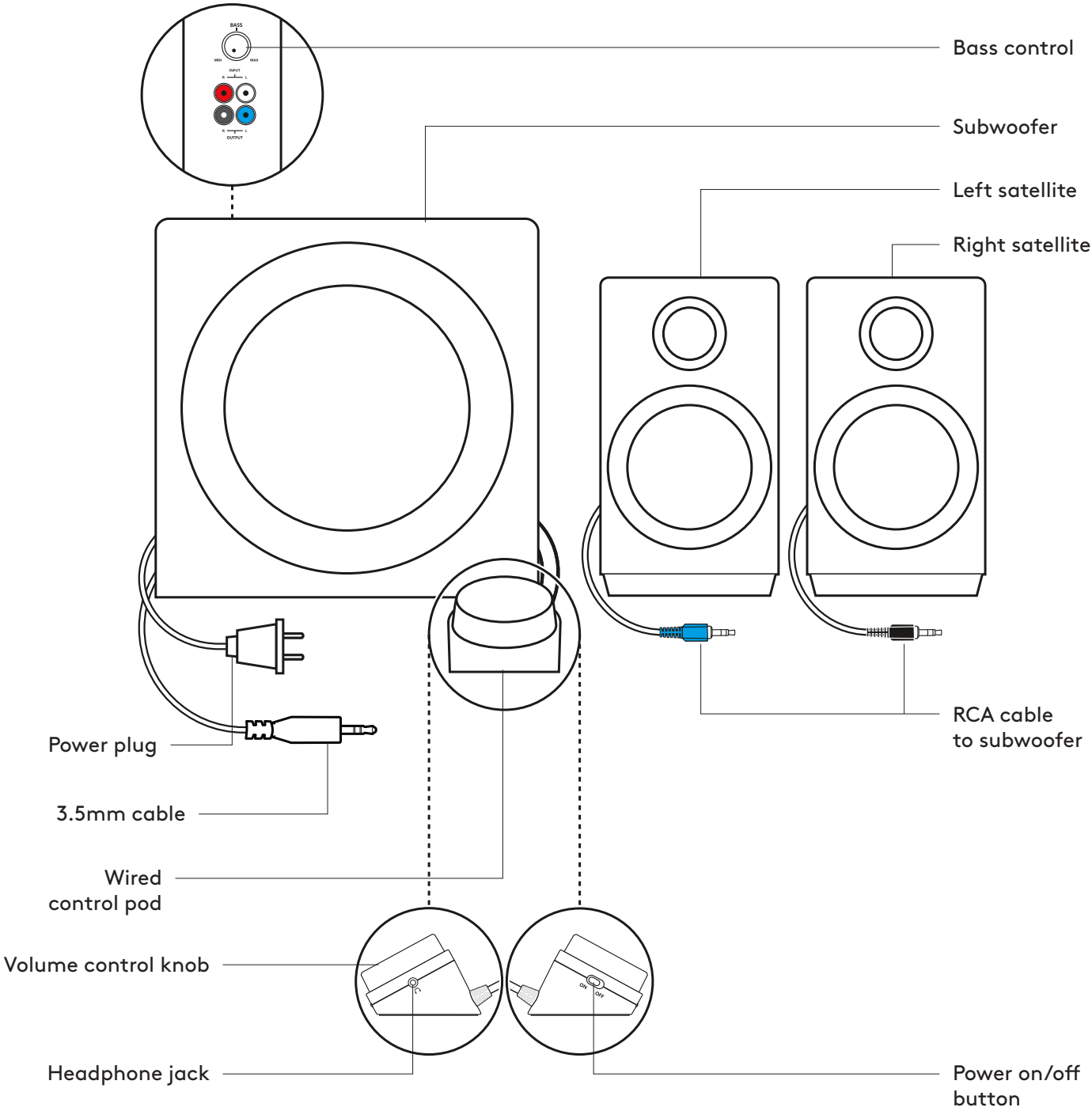

CONNECT THE SPEAKERS

1. Plug the black RCA connector on the right satellite into the black subwoofer jack.
2. Plug the blue RCA connector on the left satellite into the blue subwoofer jack.
3. Plug the power plug into an electrical outlet.

1

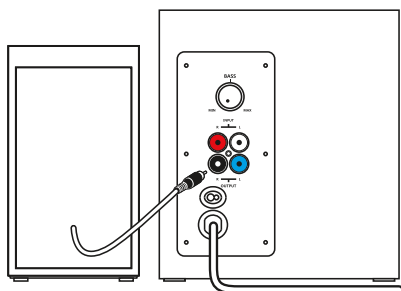

2

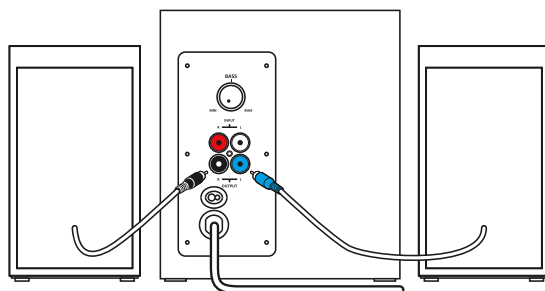

3

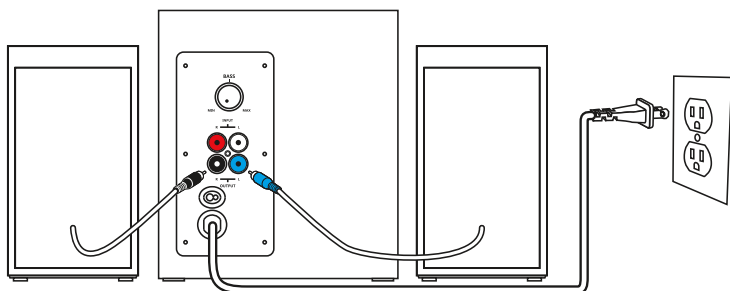

CONNECT TO AUDIO SOURCE

1A. For 3.5 mm connection:

Connect the 3.5mm plug from the subwoofer to the audio jack on your device (computer, tablet, smartphone, etc.)

1B. For RCA connection:

Connect one end of the RCA cable to the corresponding RCA jack on the back of the subwoofer.

Insert the other end of the RCA cable into the RCA outlet on your device (TV, Gaming Console, etc)

Note: The RCA cable is not included in the box and must be purchased separately.

2. Plug your headphones into the headphone jack on the control pod. Adjust the volume either from the control pod or the audio source.

3. Power speakers on/off by sliding the power on/off button on the wired control pod.

1A

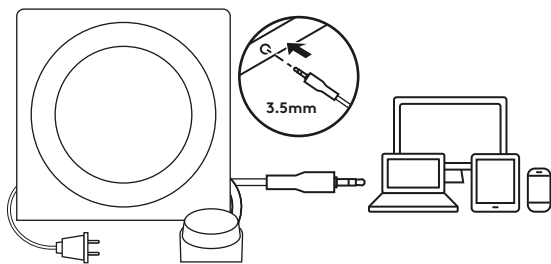

1B

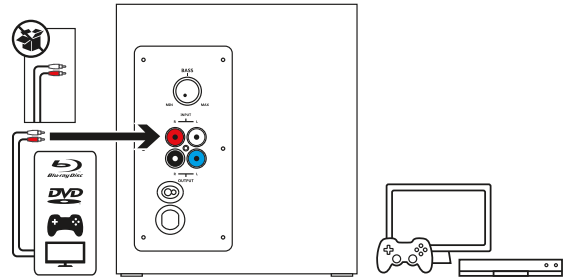

2

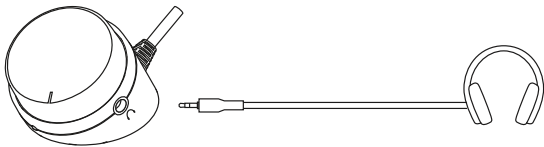

3

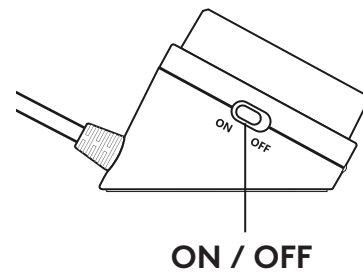

CONNECT TO TWO DEVICES SIMULTANEOUSLY

1. Connect to two devices at the same time through the RCA connector on the back of the subwoofer and the 3.5mm cable on the subwoofer.
2. To switch between audio sources just pause audio on one connected device and play audio from the other connected device.

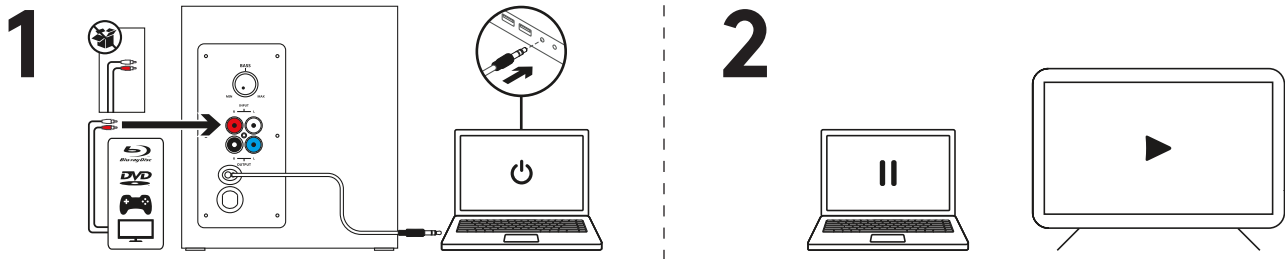

ADJUST THE VOLUME

1. Adjust the volume of Z333 with the knob on the control pod.
 - Turn the knob clockwise (to the right) to increase volume.
 - Turn the knob counter-clockwise (to the left) to decrease volume.

ADJUST THE BASS

2. Adjust the bass level by turning the bass control knob located at the back of your subwoofer.
 - Turn bass knob to the right for deeper bass or to the left for less bass.

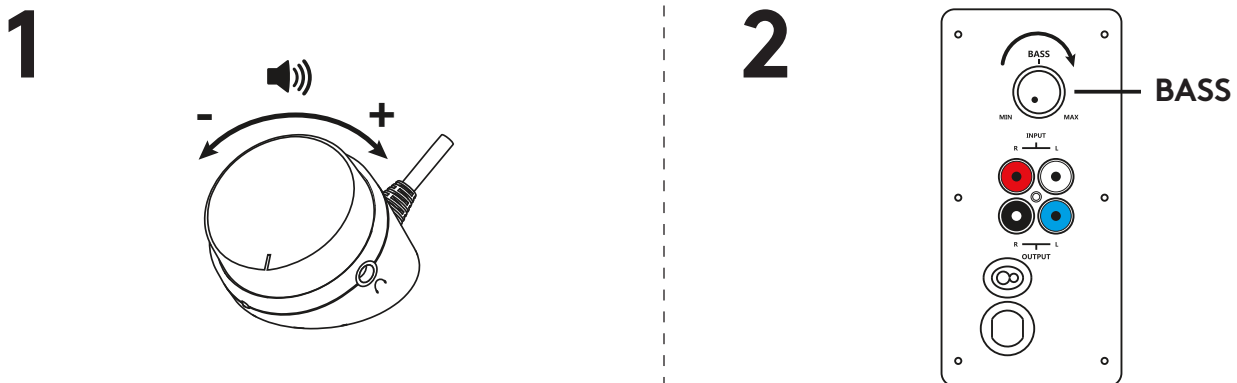

了解您的产品

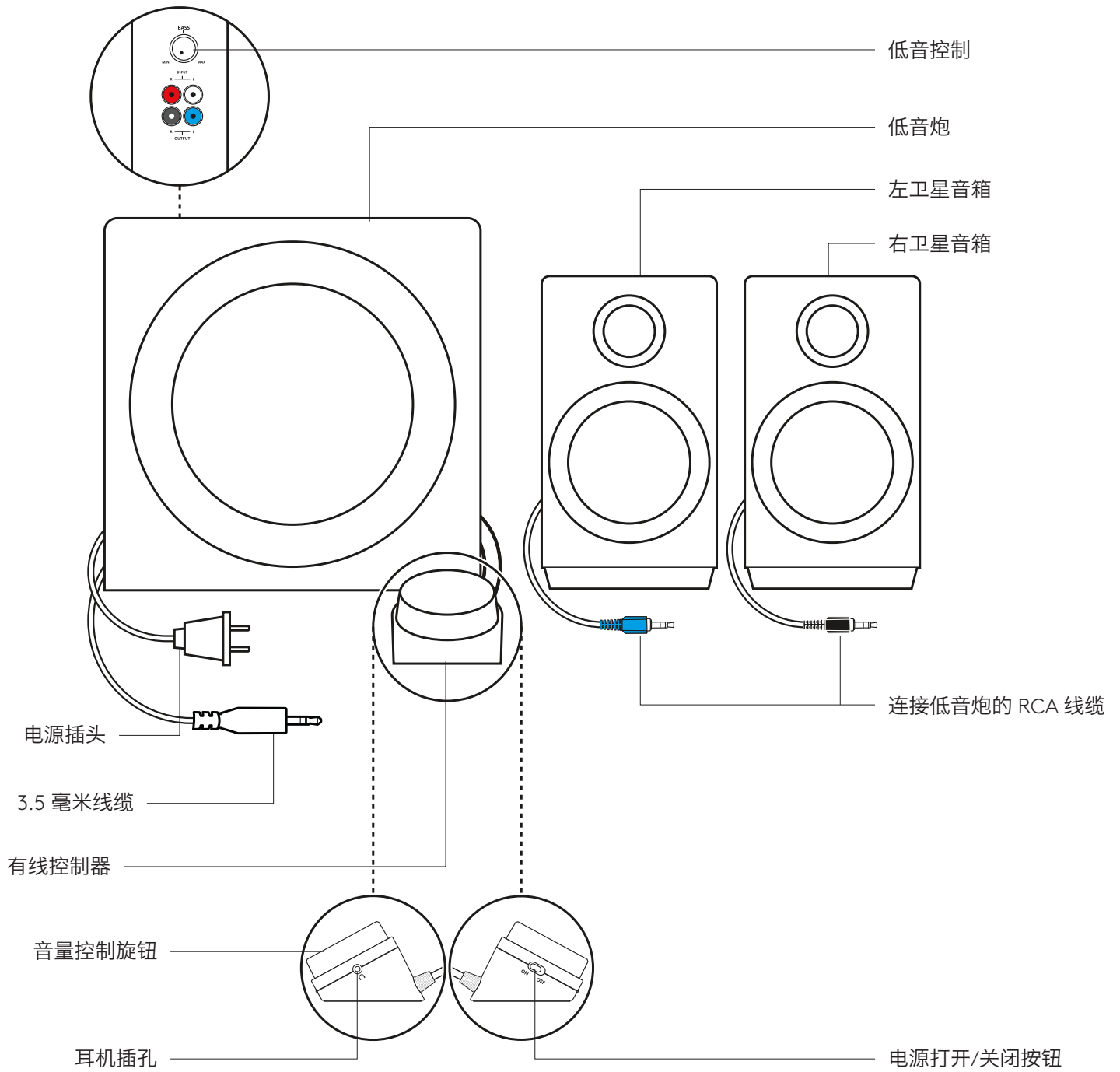

连接音箱

1. 将右侧卫星音箱上的黑色 VGA 插头插入黑色低音炮端口。
2. 将左侧卫星音箱上的蓝色 VGA 插头插入蓝色低音炮端口。
3. 将电源线插入电源插座。

1

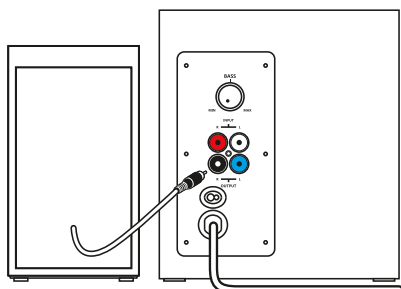

2

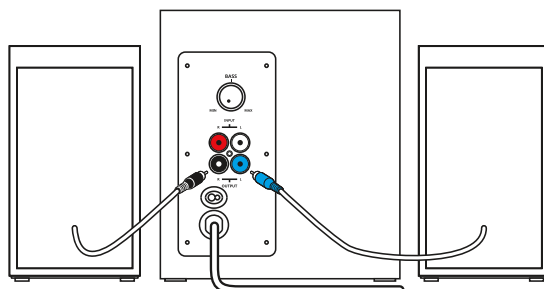

3

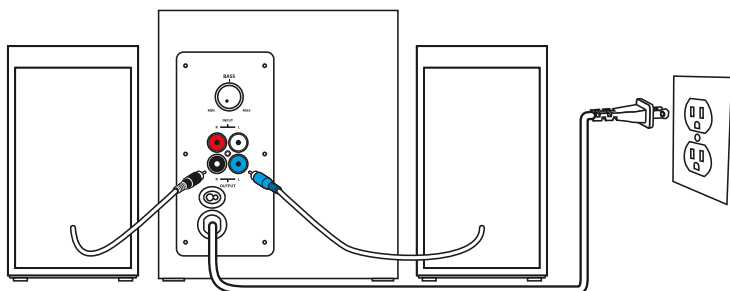

连接音源

1A. 3.5 毫米连接:

将低音炮的 3.5 毫米插头连接到设备的音频插孔 (电脑、平板电脑、智能手机等)

1B. RCA 连接:

将 RCA 线缆的一端连接到低音炮背面的相应 RCA 插孔。

将 RCA 线缆的另一端插入设备的 RCA 插孔 (电视、游戏主机等)

请注意: RCA 线缆未随附, 需另购。

2. 将耳机插入控制器上的耳机插孔。通过控制器或音源调节音量。
3. 滑动有线控制器上的电源开关按钮打开或关闭音箱。

1A

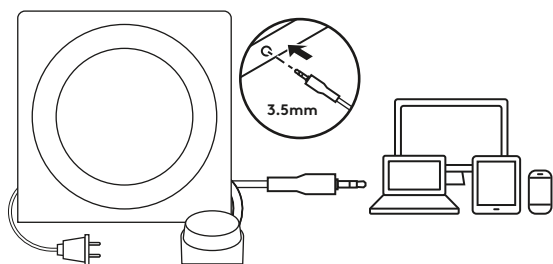

1B

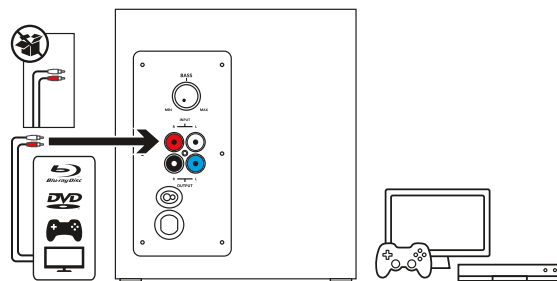

2

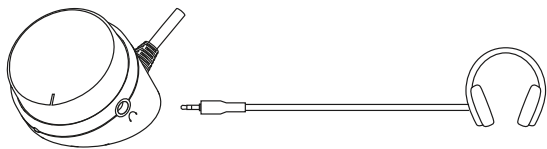

3

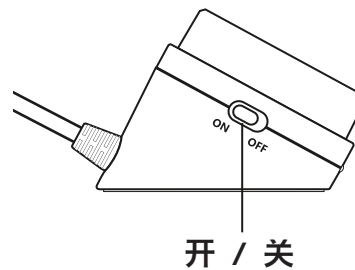

同时连接两台设备

1. 通过低音炮背面的 RCA 端口和低音炮上的 3.5 毫米线缆同时连接两个设备。
2. 要在音源之间切换, 只需暂停一台连接设备上的音频, 然后播放来自其他连接设备的音频。

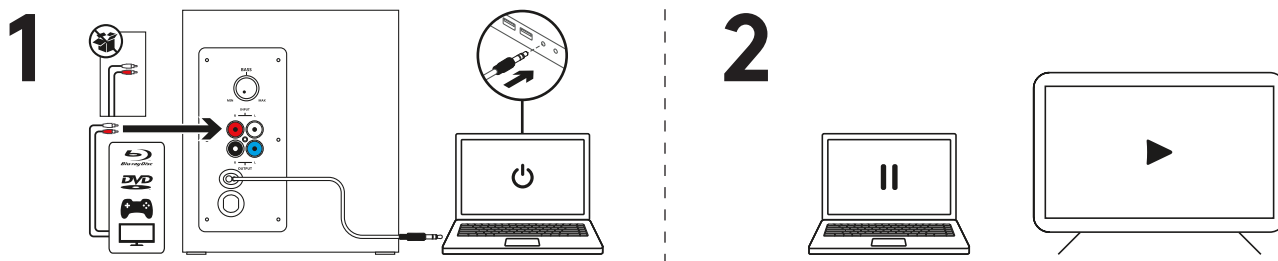

调节音量

1. 使用控制器旋钮调节 Z333 音量。
顺时针 (向右) 旋转旋钮可提高音量。
逆时针 (向左) 旋转旋钮可降低音量。

调节低音

2. 使用低音炮背面的低音控制旋钮可调节低音音量。
将低音旋钮向右旋转可获得更低沉的低音, 向左旋转可获得较少的低音。

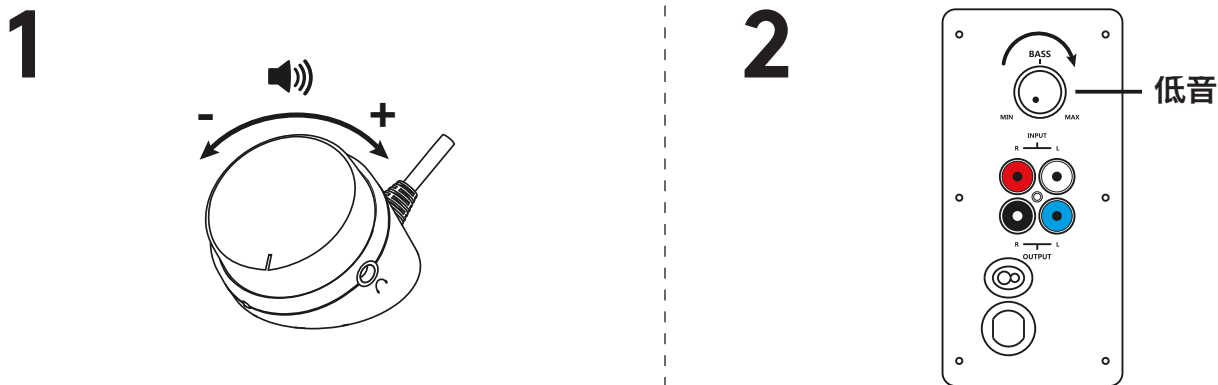

瞭解您的產品

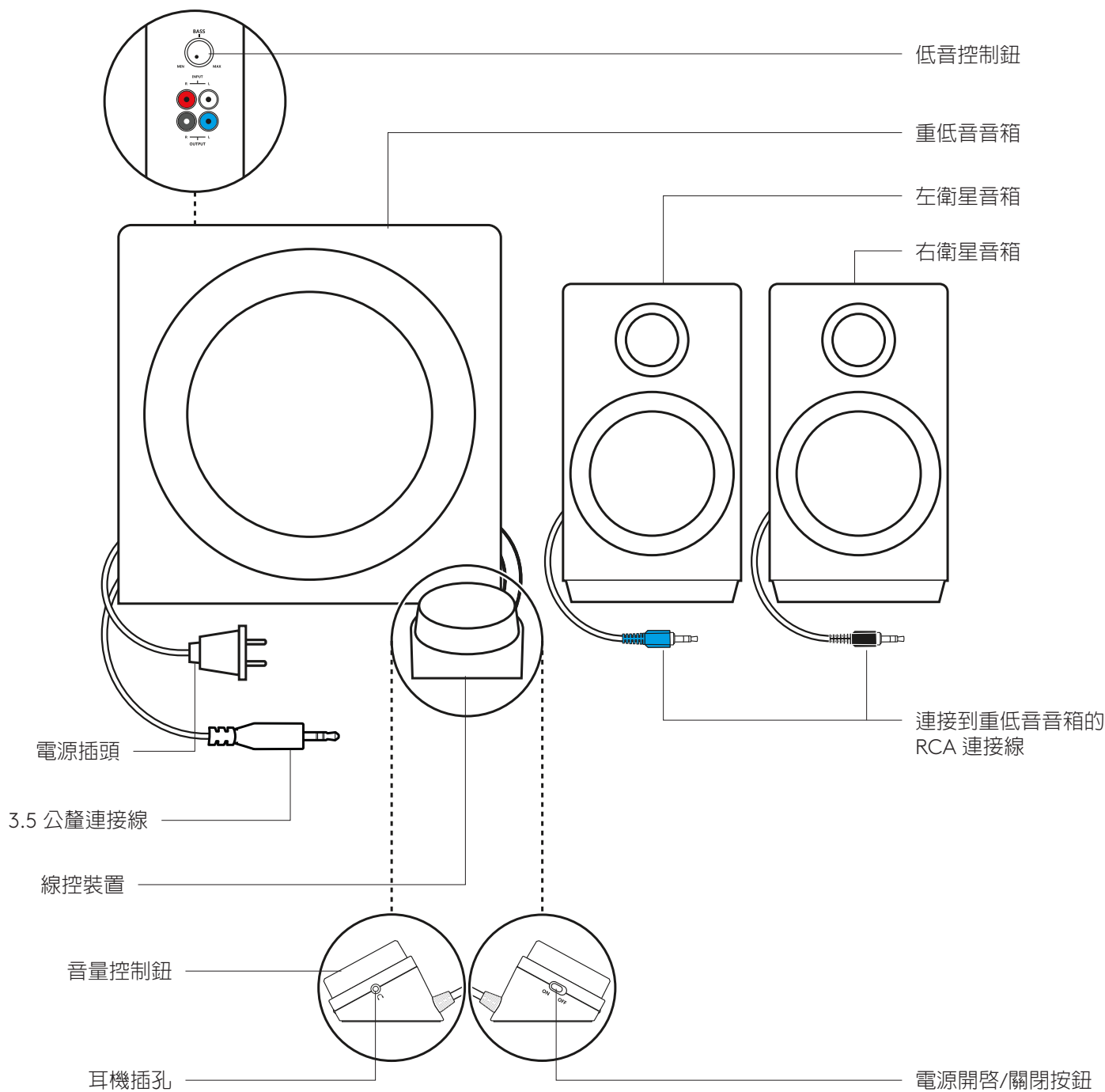

連接音箱

1. 將右衛星音箱的黑色 RCA 接頭插入到黑色重低音音箱插孔。
2. 將右衛星音箱的藍色 RCA 接頭插入到藍色重低音音箱插孔。
3. 將電源插頭插入到電氣插座。

1

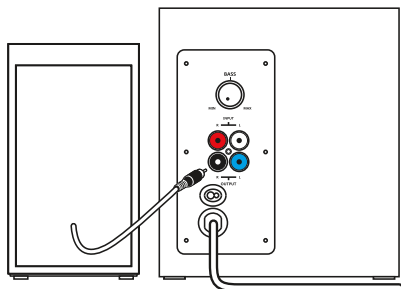

2

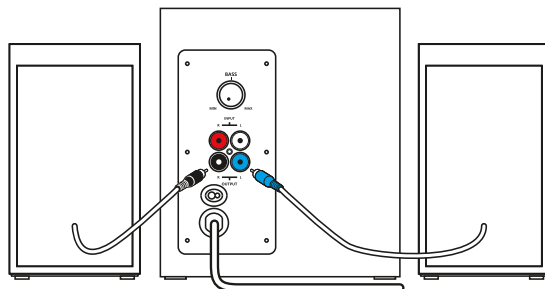

3

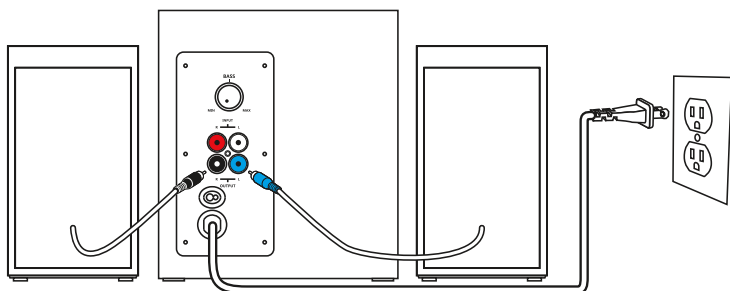

連接到音訊來源

1A. 3.5 公釐連接

將 3.5 公釐插頭從重低音音箱插入到裝置 (電腦、平板電腦、智慧型手機等) 的音訊插孔。

1B. RCA 連接:

將 RCA 連接線的一端連接到相應的重低音音箱上相應的 RCA 插孔。

將 RCA 連接線的另一端，插入到裝置 (電視、遊戲主機等) 上的 RCA 插孔。

注意：包裝盒內未隨附 RCA 連接線，需另購。

2. 將耳機插入到線控裝置上的耳機插孔。利用線控裝置或音訊來源調整音量。
3. 撥動線控裝置上的電源開啓/關閉按鈕，開啓/關閉音箱電源。

1A

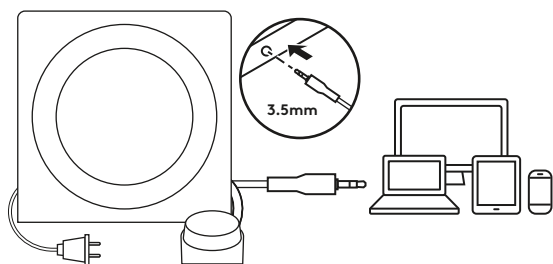

1B

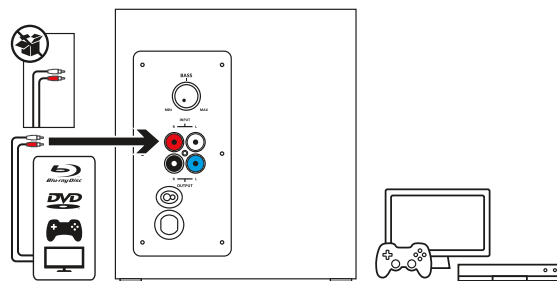

2

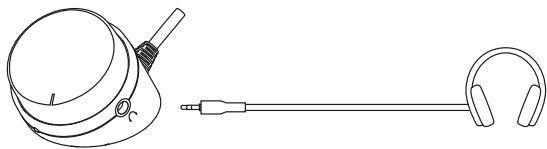

3

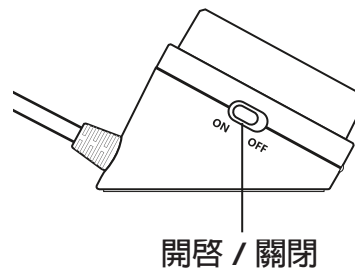

可同時連線到兩台裝置

1. 透過重低音音箱背面的 RCA 接頭和重低音音箱上的 3.5mm 連接線，可同時連接到兩個裝置。
2. 若要切換音訊來源，只須暫停一個已連接之裝置上的音訊，然後從另一個已連接的裝置播放音訊。

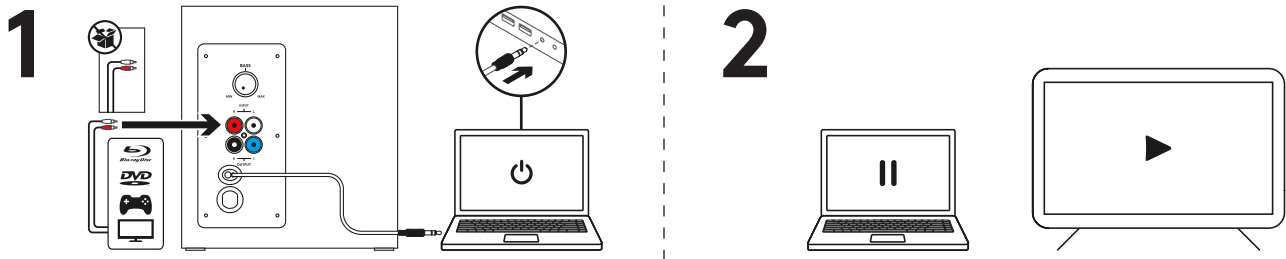

調整音量

1. 使用線控裝置上的控制鈕調整 Z333 的音量。
順時針 (向右) 轉動轉鈕可增加音量。
逆時針 (向左) 轉動轉鈕可減少音量。

調整低音

2. 使用重低音音箱背面的低音控制旋鈕可調整低音強度。
向右轉動控制鈕可加強低音，向左轉動可減少低音。

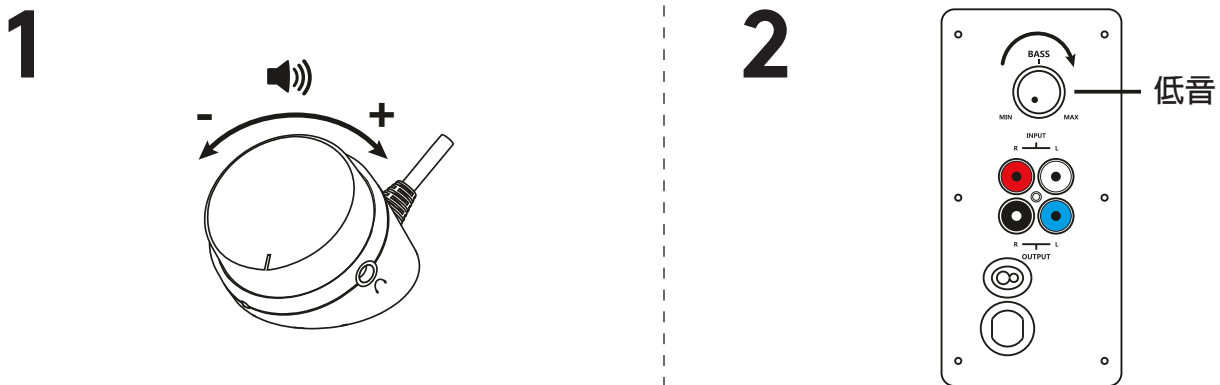

제품 설명

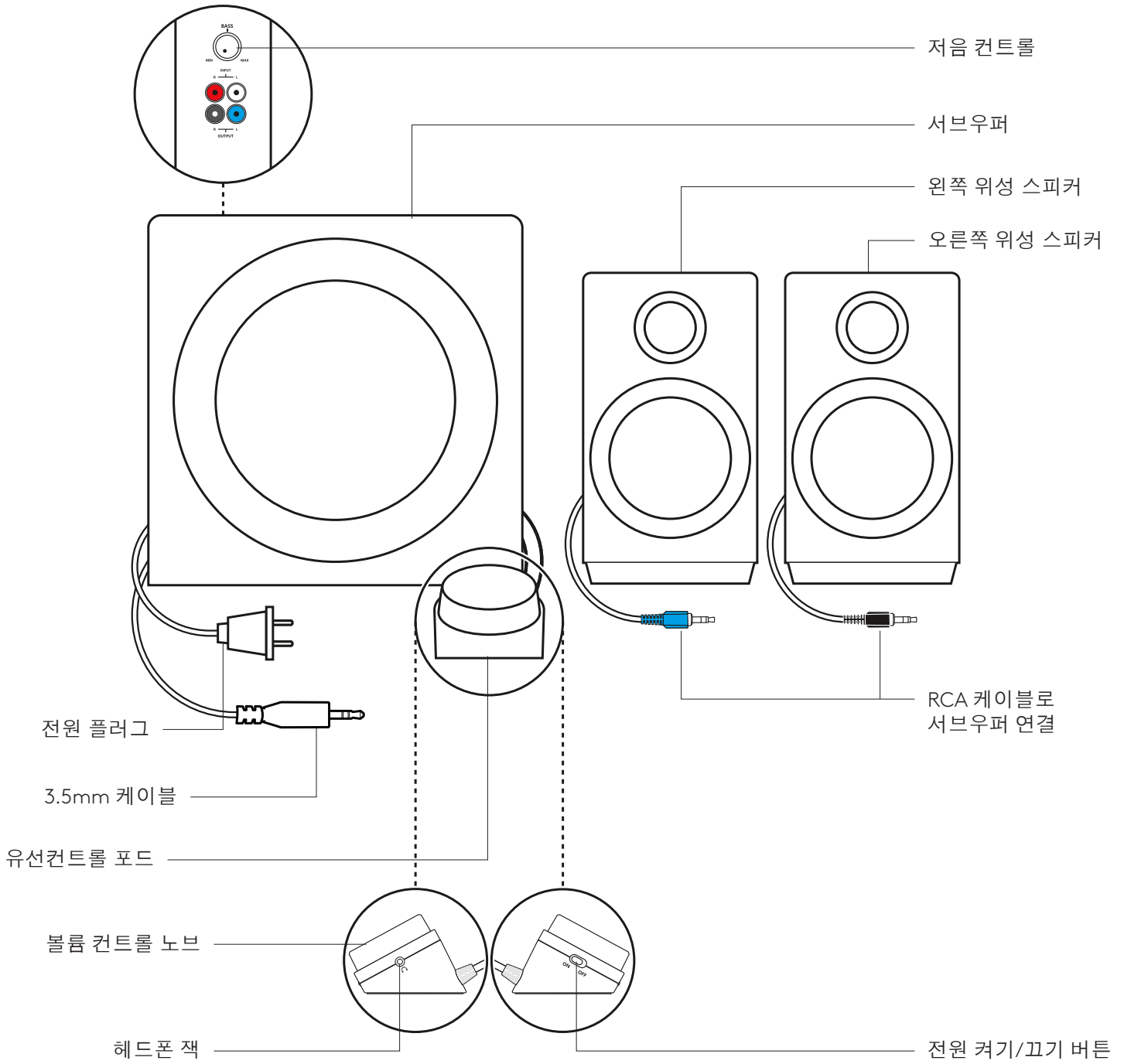

스피커 연결

1. 검은색 서브우퍼 잭에 우측 스피커의 검은색 RCA 커넥터를 연결합니다.
2. 파란색 서브우퍼 잭에 좌측 스피커의 파란색 RCA 커넥터를 연결합니다.
3. 전원 플러그를 전기 콘센트에 연결합니다.

1

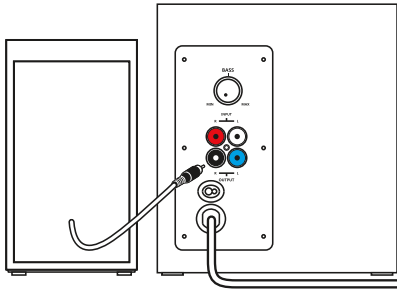

2

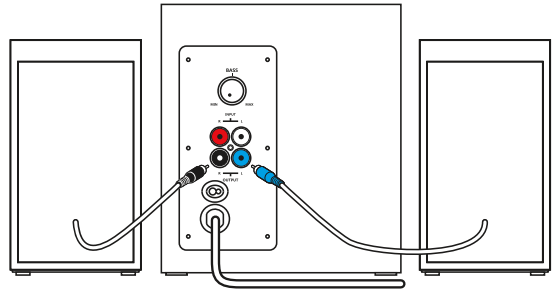

3

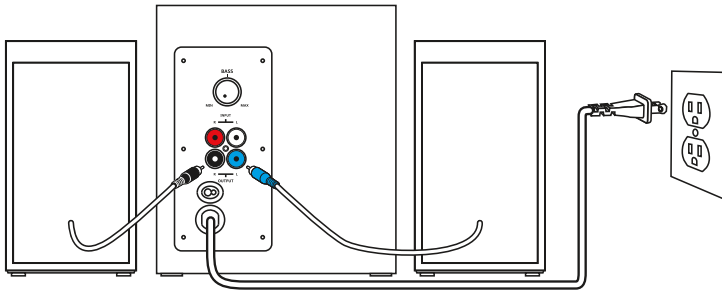

오디오 소스 연결

1A. 3.5mm 연결의 경우:

서브우퍼의 3.5mm 플러그를 장치(컴퓨터, 태블릿, 스마트폰 등)의 오디오 잭에 연결합니다.

1B. RCA 연결의 경우:

RCA 케이블의 한쪽 끝을 서브우퍼의 뒤쪽에 있는 해당 RCA 잭에 연결하십시오.

RCA 케이블의 다른 쪽 끝을 장치의 RCA 콘센트에 삽입하십시오(TV, 게임 콘솔 등).

참고: RCA 케이블은 박스에 포함되지 않으며 따로 구매하셔야 합니다.

2. 컨트롤 포드의 헤드폰 잭에 헤드폰을 연결합니다. 컨트롤 포드 또는 오디오 소스에서 볼륨을 조절하십시오.

3. 유선 컨트롤 포드의 전원 켜기/끄기 버튼을 눌러 전원 스피커를 켜거나 끕니다.

1A

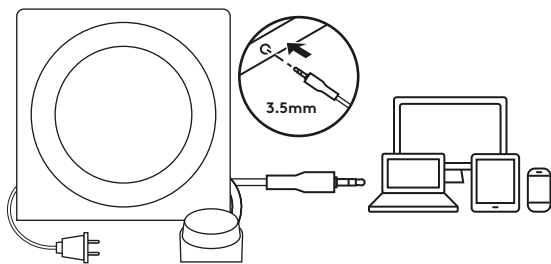

1B

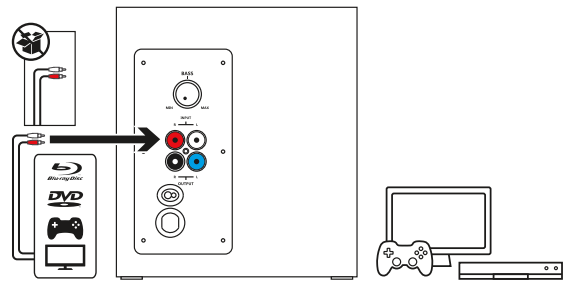

2

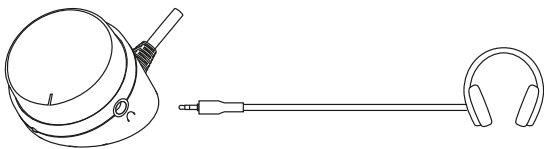

3

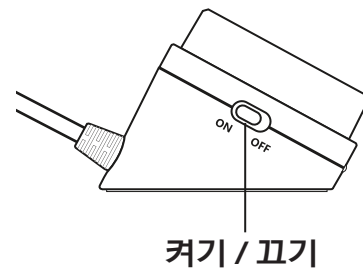

2개 장치에 동시 연결

1. 서브우퍼 후면의 RCA 커넥터와 서브우퍼의 3.5mm 케이블로 동시에 두 장치에 연결하십시오.
2. 오디오 소스 사이를 전환하려면 연결된 장치 중 하나의 오디오를 일시 중지하고 연결된 다른 장치에서 오디오를 재생하십시오.

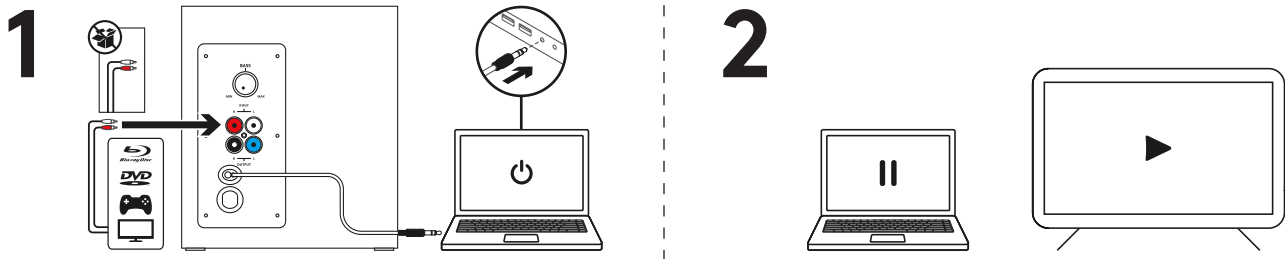

볼륨 조절

1. 컨트롤 포드의 노브를 사용하여 Z333의 볼륨을 조절하십시오.
볼륨을 높이려면 노브를 시계 방향(오른쪽)으로 돌리십시오.
볼륨을 줄이려면 노브를 시계 반대 방향(왼쪽)으로 돌리십시오.

저음 조절

2. 서브우퍼 뒷면에 있는 저음 조절 노브를 사용하여 저음을 조절합니다.
저음 노브를 오른쪽으로 돌리면 저음이 커지며 왼쪽으로 돌리면 작아집니다.

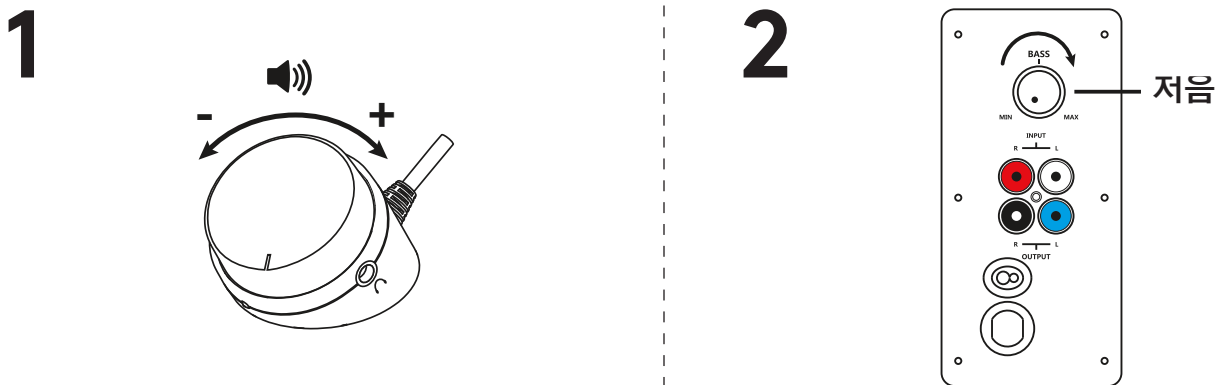

www.logitech.com/support/Z333

© 2019 Logitech. Logitech, Logi and other Logitech marks are owned by Logitech and may be registered. All other trademarks are the property of their respective owners. Logitech assumes no responsibility for any errors that may appear in this manual. Information contained herein is subject to change without notice.

WEB-621-001260.002

logitech®