



Polaris RZR Pro Seat Installation 2020+ FRONT ONLY

1. Remove your stock seats

Remove your stock seats by releasing the two plastic tabs on the back of the seat. You may need to remove the stock harnesses depending on which model you have.

2. Remove the metal tube

Remove the metal tube marked "15" from the stock seat. Retain the 2 screws from the stock seats that hold the metal tube in place.

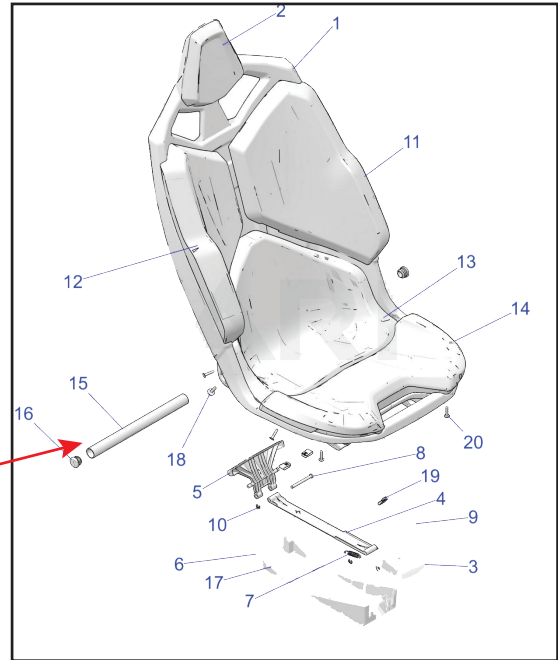

3. Mount Included Brackets

Mount the included brackets with the carriage bolts that are in the hardware kit. There is adjustment with the brackets depending on if you would like to sit back further or sit closer. The stock slider will remain functional. Leave carriage bolts loose until the next step is complete. (IMPORTANT) Daytona Seats Require Spacers. Apex Seats to not

4. Mount Metal Tube

Use part "15" and the screws that were removed from step 2 to mount to the included brackets.

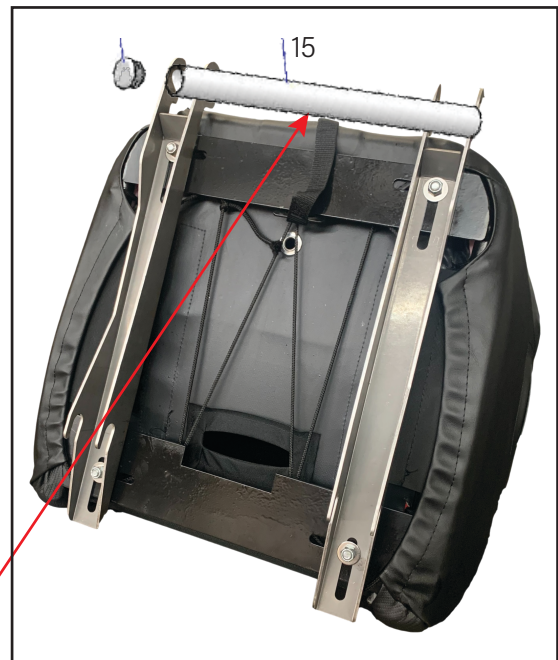

5. Tighten Carriage Bolts

Tighten all carriage bolts and mount seats into your Polaris PRO

Any Questions?

Info@Aces-Racing.com

(714) 321-5107

Mon-Fri 8-4pm PST

