

## STEP A Cut Out Acorn Nut Protectors For Step 1

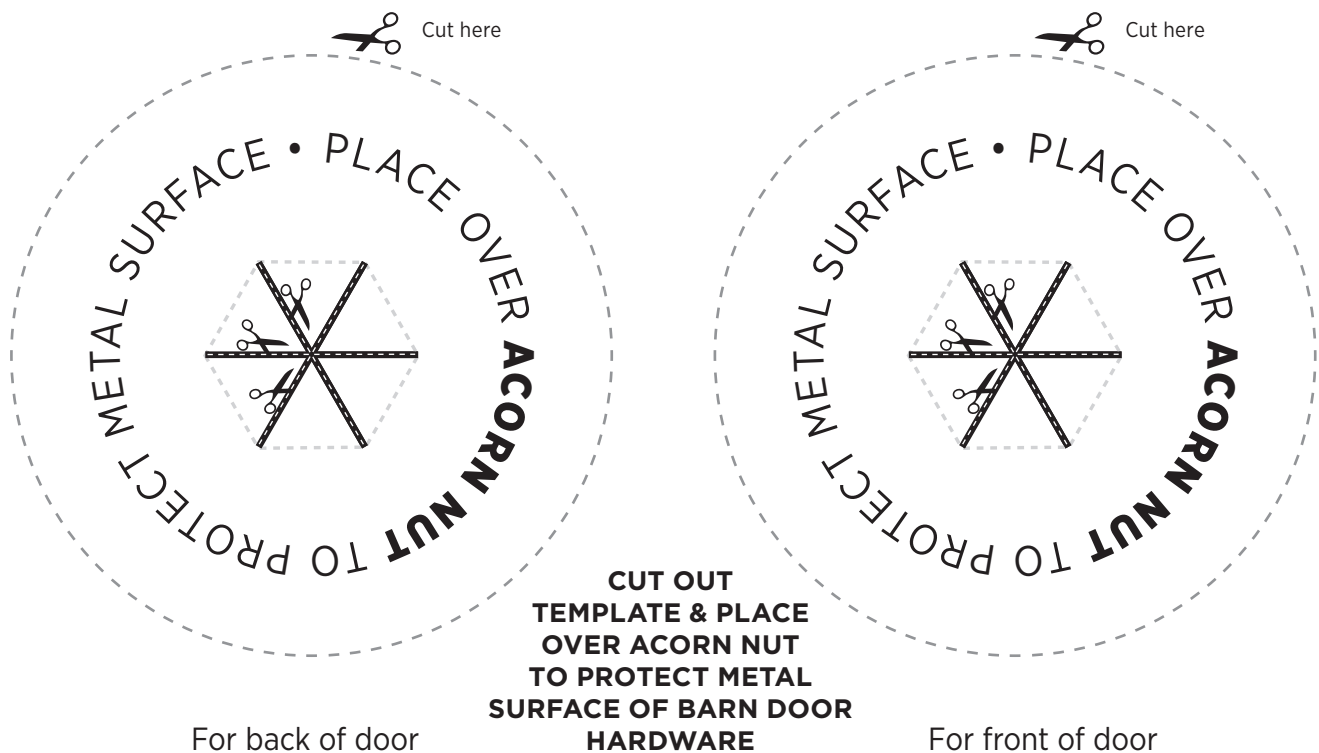

## STEP B Cut Out Handle Installation Template For Step 5

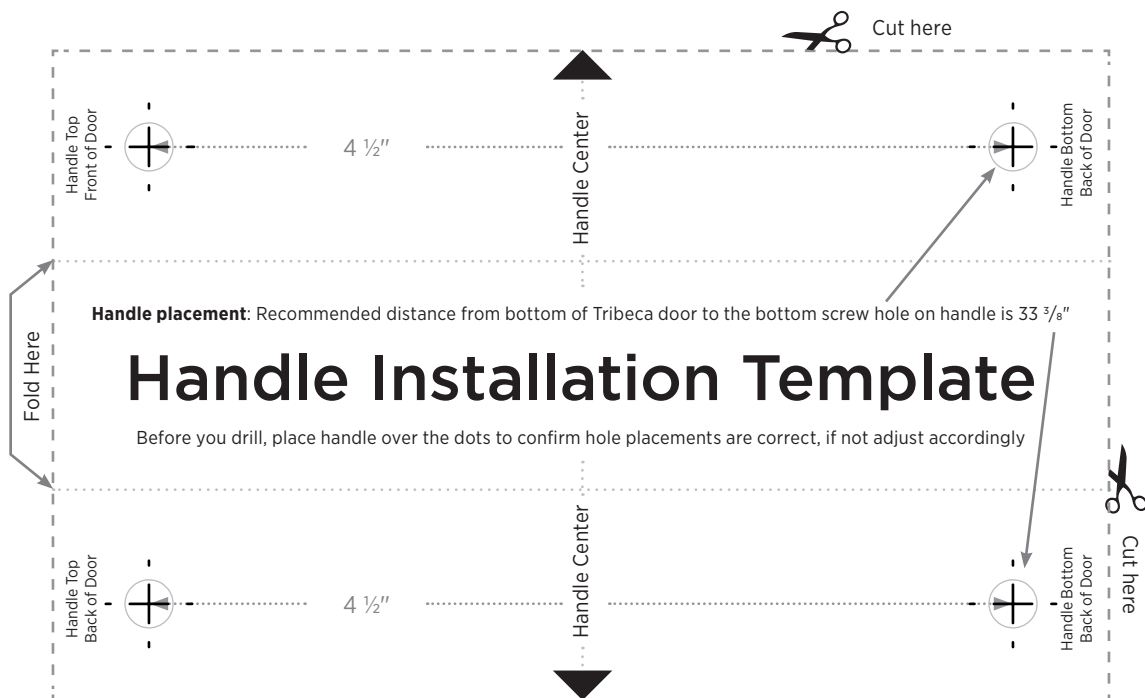

## TOOLS REQUIRED (NOT PROVIDED)

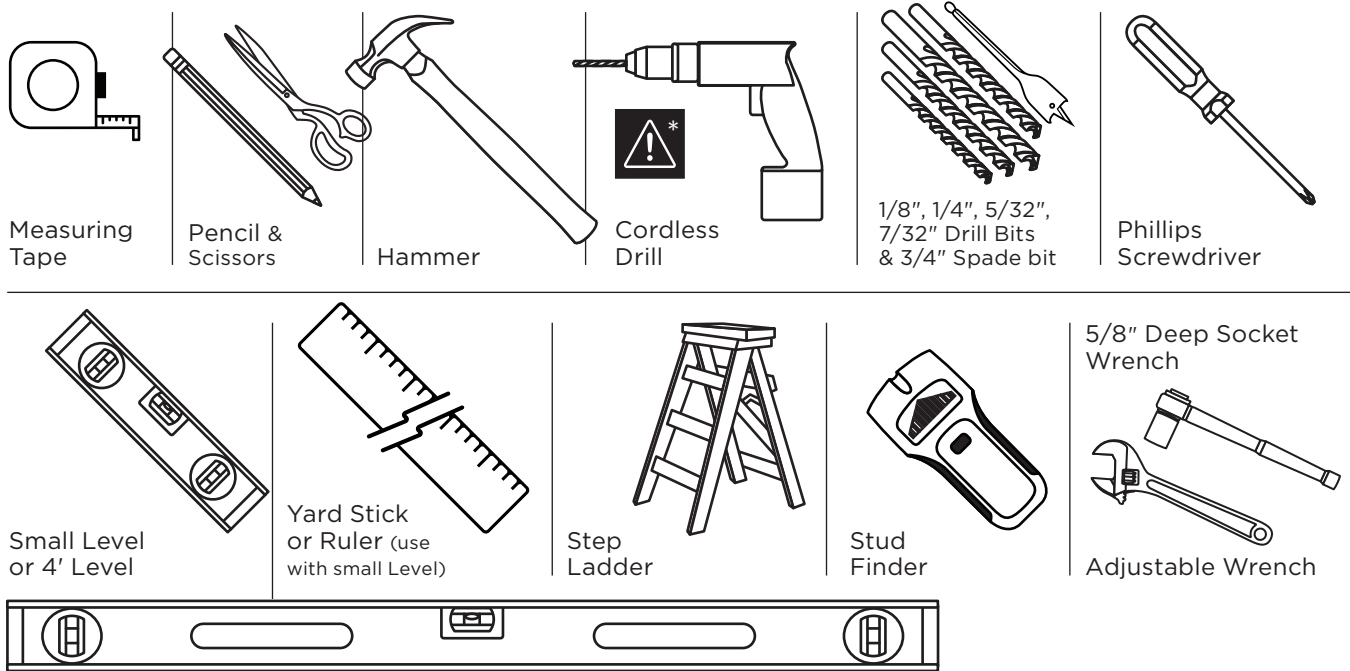

## STEP 1 Install The Hanger Straps

### Securing the Hanger Strap hardware to the door

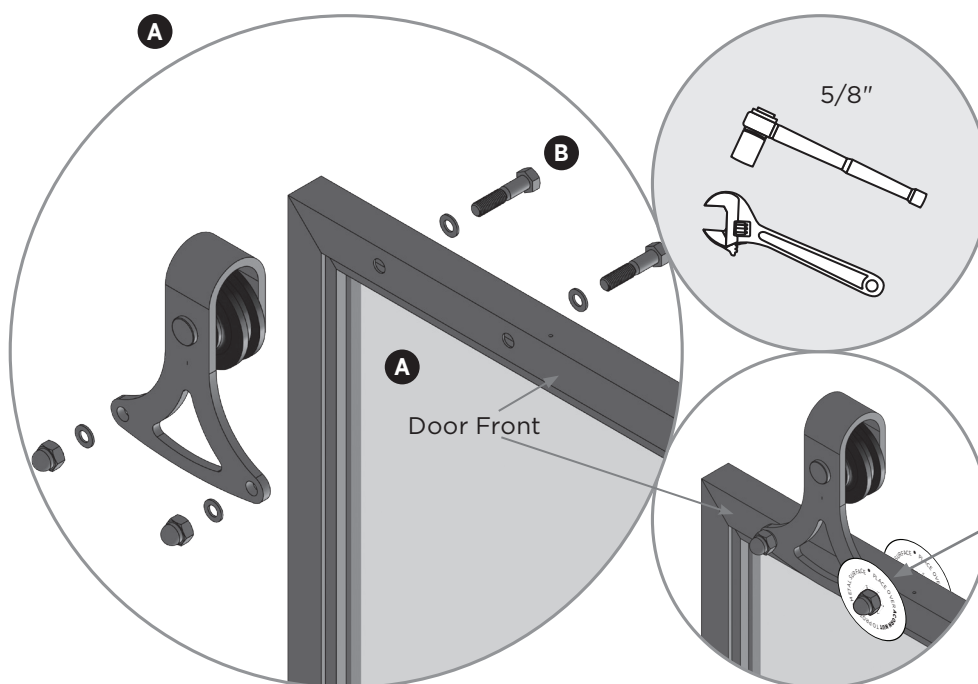

**A)** Determine the front side of the door by the texture of the glass insert, the glossy side to the front, the matte finish to the back.

**B)** From the back of the door, insert Strap Bolts and Washers. From the front of the door, position the strap so the wheel is located to the back as shown, attach Washers and Acorn Nuts and tighten to secure the hardware.

**C)** Repeat above **Steps A** and **B** for the second Hanger Strap hardware.

**Note 1:** Cut out and use the two supplied templates on the back of the cover page (**Step A - on page 2**) to protect the metal surface of the Acorn Nut and Strap.

**Note 2:** Do not over tighten to avoid distorting the Tribeca door frame.

## STEP 2 Installing the Anti-Jump Blocks on the door

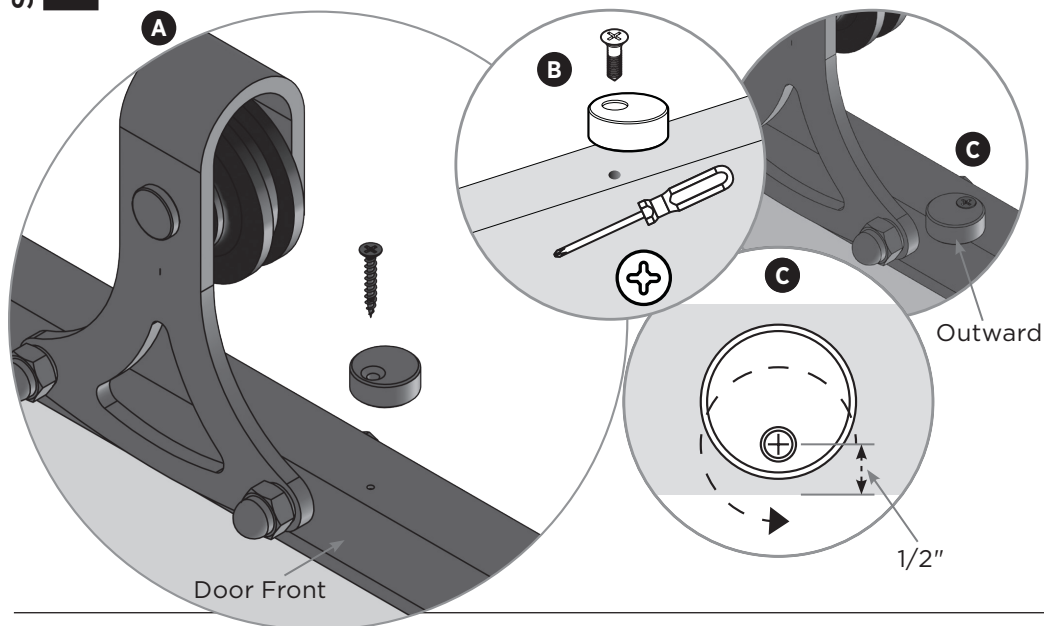

- A)** Affix an Anti-Jump Block and screw into the pre drilled holes located appx. 9" from each edge and toward the front face of the rail.
- B)** Screws should be tightened just enough to hold the anti-jump from spinning freely, but still be able to be rotated for door installation and securing.
- C)** Rotate the blocks outward (towards the front of door) to allow the door to be mounted onto the Track.

## STEP 3 Pick Your Door Opening Location

Determine what direction your door will be opening

### A) Door opens to the right

These instructions will focus on right opening doors

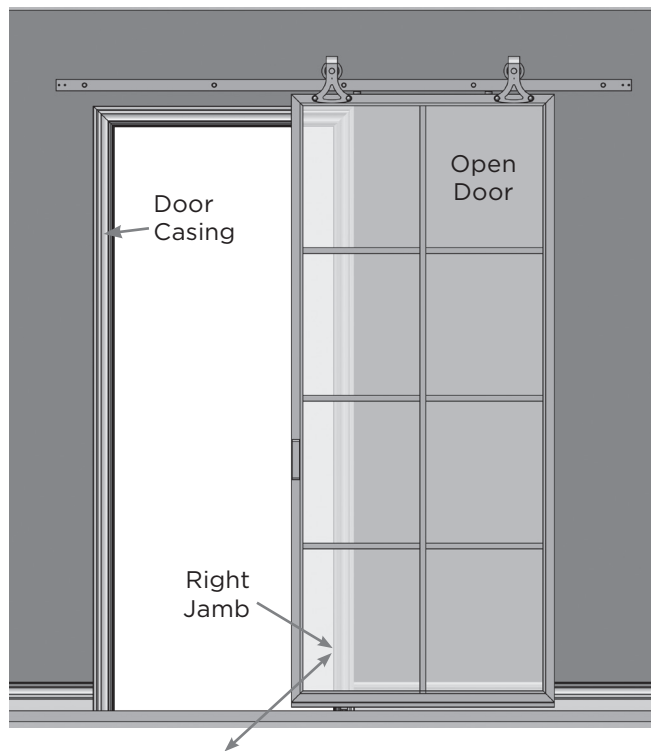

Instructions will be referring to this side of the door jamb

### B ) Door opens to the left

For this application work from the left jamb

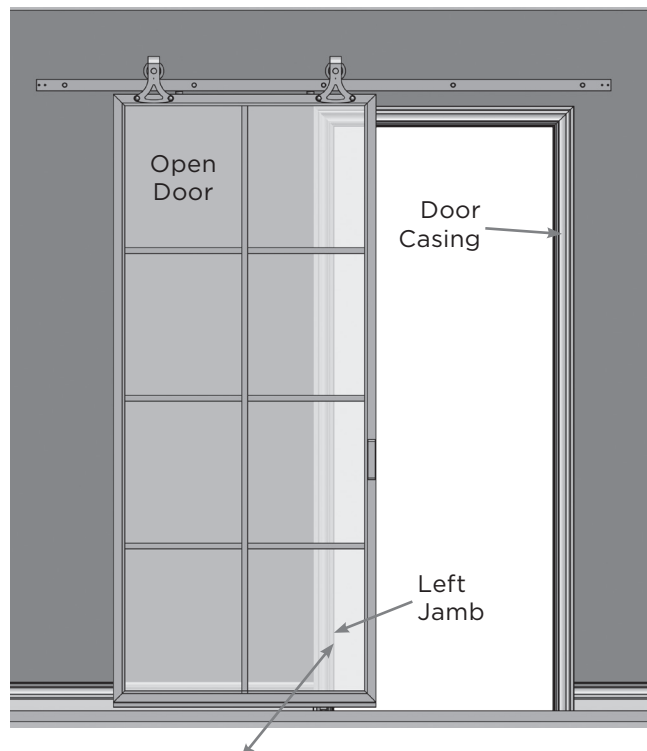

If you have a left opening door, all your measurements will be focusing on this door jamb

## STEP 4 Install The Handle

Template available below

### Installing the Handle on the Barn Door

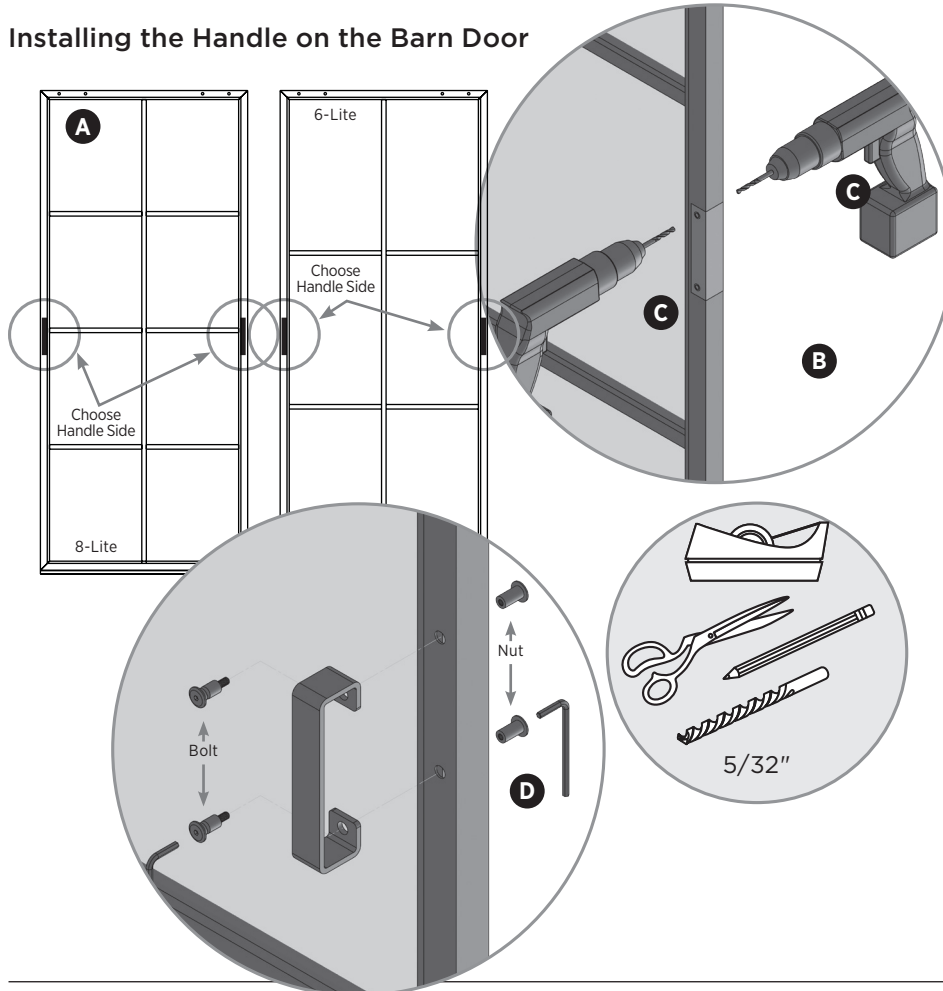

**A)** Determine which direction your door will be opening. If your door opens to the right, your handle will be installed on the left side. If your door opens to the left, your handle will be installed on the right side as per the image.

**B)** Cut out the handle template from (**Step B - on page 2**) with a pair of scissors and fold along the 2 dotted lines. Place the template onto the appropriate side of the door (determined in Step 3a) so the bottom hole positioned 33-3/8" from the bottom of the door and affix with masking tape front and back.

**C)** Drill a hole through the front wall of the stile using a 1/4" drill bit at each hole location. Repeat the hole drilling on the back wall of the stile.

**D)** Insert a Barrel Nut through each handle hole, then through the drilled holes in the front face of the door. Insert a Barrel Nut through each drilled hole in the back face of the door and tighten with the Allen keys provided until tight.

**Note 1:** DO NOT over tighten.

## STEP 5 Check For Level Floor

- A)** Use a Level to check if your floor is uneven before making measurements.
- B)** Select the highest point on the floor and measure up 85-3/4" from that point.
- C)** Make a light pencil X mark on the wall

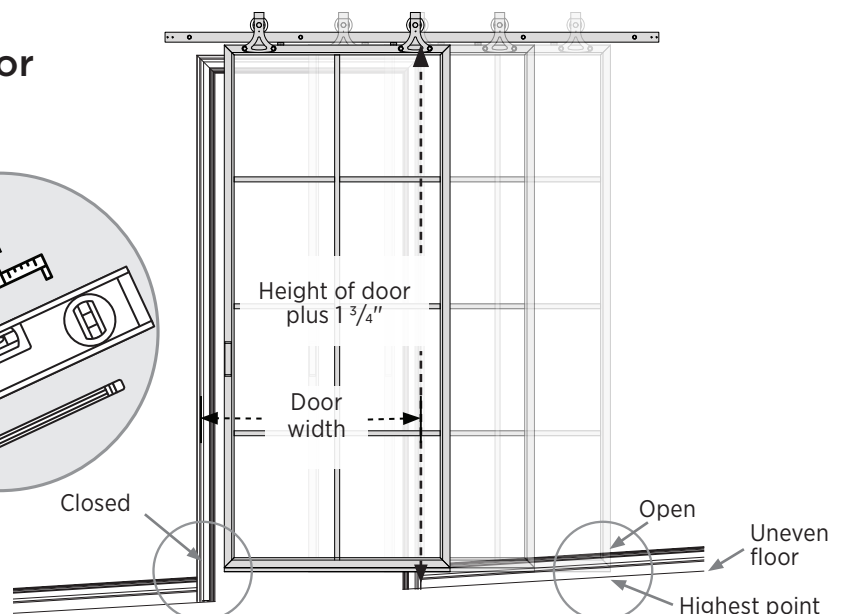
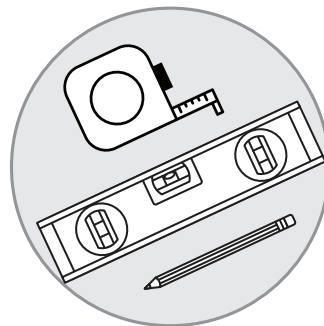

## STEP 6 Measure And Center The Track Location Onto The Wall

Mark track location

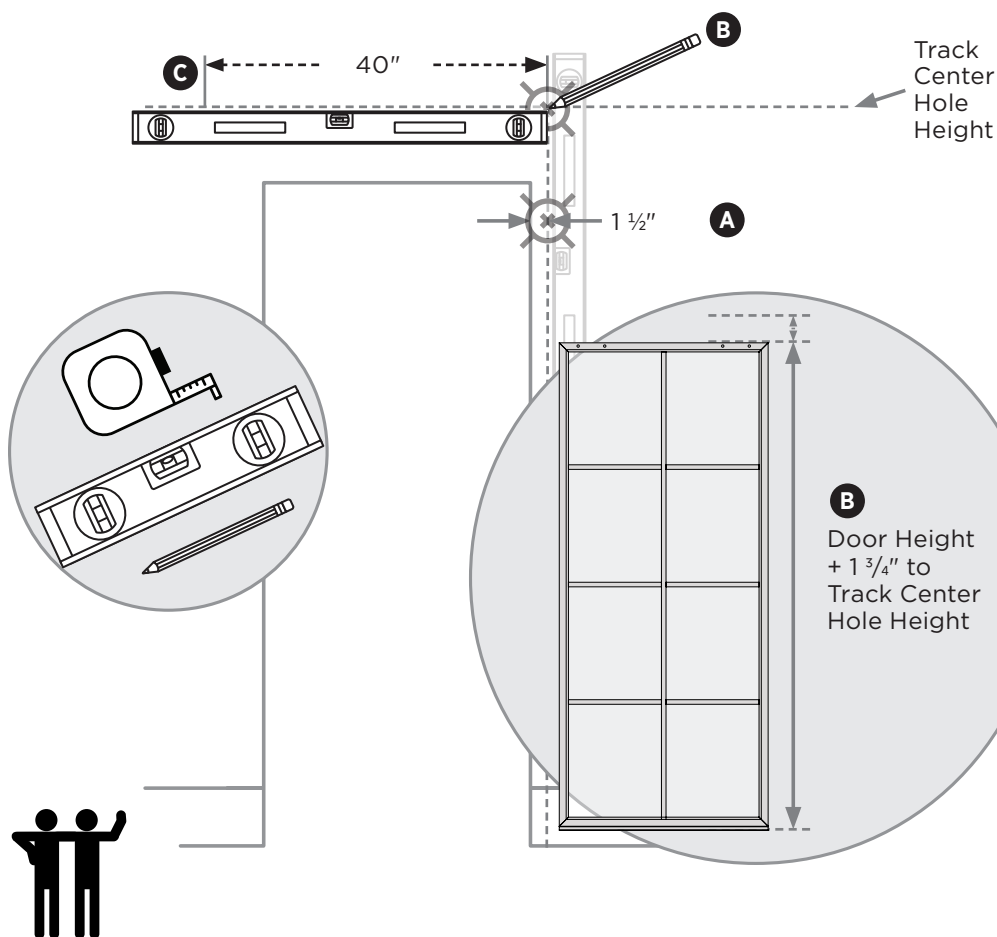

**A)** Once you determine which side of the opening your door will open to, measure  $1\frac{3}{4}$ " (4.5 cm) to the right and mark your center point then draw a light vertical line (roughly) 6" upward past the door opening (this determines the vertical center of the Track).

**Note 1:** For this instruction we are working on a door opening to the right (**Step 3-A**)

**B)** Measure up from the floor, (at the location determined in **Step 5**) the height of your door (84") plus  $1\frac{3}{4}$ " (4.5 cm), then make a light pencil X mark on the wall.

**Note 2:** Make sure **Step 4-B** "X" mark is Vertically aligned with **Step 4-A** "X" mark

**C)** Use a 4' level, lightly draw a horizontal pencil line approximately 40" long on each side of the (**B**) "X" mark.

## STEP 7 Locate And Mark The Studs And Header

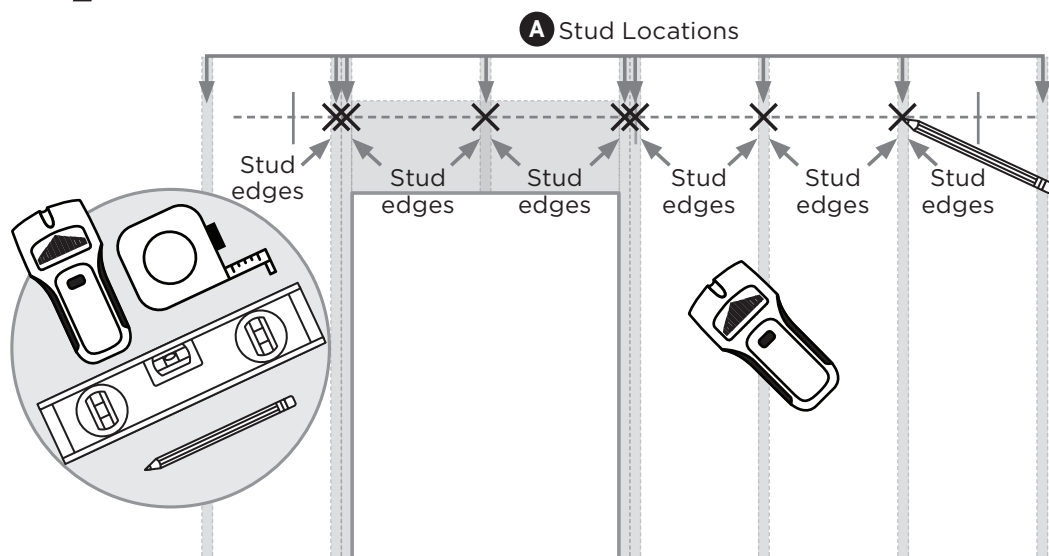

**A)** Use a stud finder to locate and mark the center and edges of each stud and mark with an "X", as well as the top of the door frame header to ensure it is at least 1" above the line drawn.

## STEP 8 Mark The Track Position

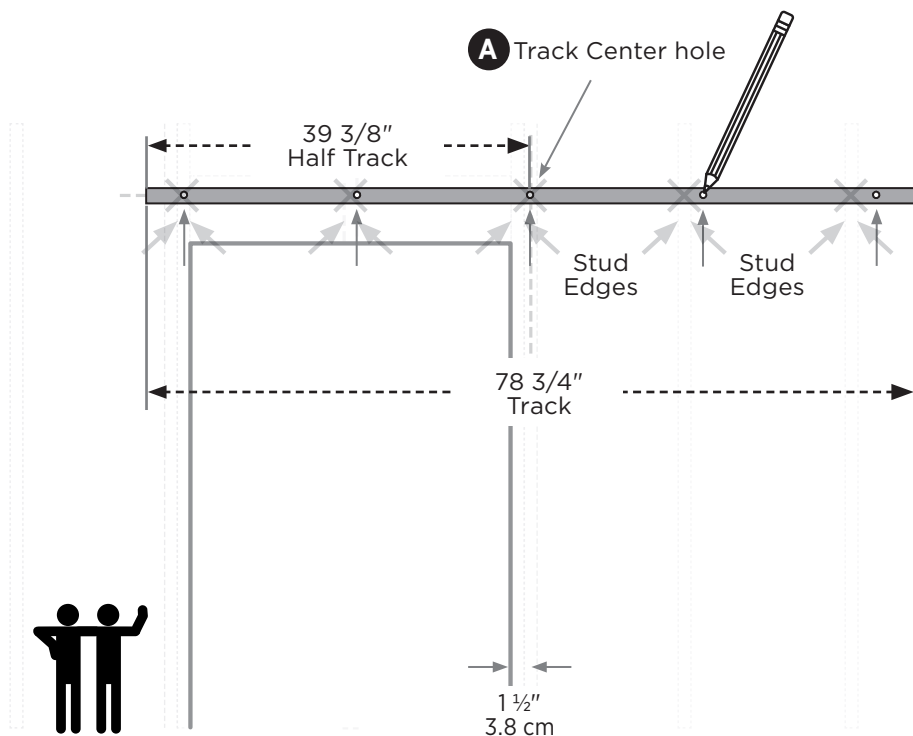

**A)** Using the track as a template, position the track's center hole over the drawn horizontal line's center "x" mark (**Step 5-C**).

**Note 1:** The center track hole **MUST** hit a stud center or Header.

**(B)** Using the marked studs (**Step 6**) for position - move the track center hole slightly left or right until it is centered on the stud (the track has a couple inches extra on both sides to compensate)

**(C)** Check if any of the other track holes align with the edge of a stud - if so - move the Track so it aligns close to the center or misses the stud by approximately 1", without affecting the other holes alignments.

**Note 2:** At this point you will need a helping hand.

**D)** Once all track holes are in safe positions, Mark the holes accordingly for stud/header or wall anchor drilling.

## STEP 9 Affixing Track Center With Lag Screw

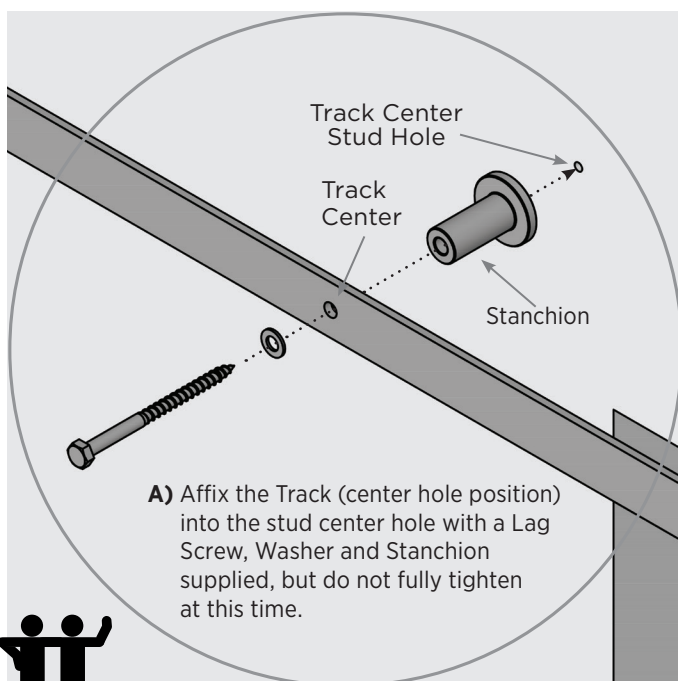

**Note:** The Stanchion should be oriented as shown between the track and the wall with the flange of the Stanchion against the wall.

## STEP 10 Slide End Stops onto Track

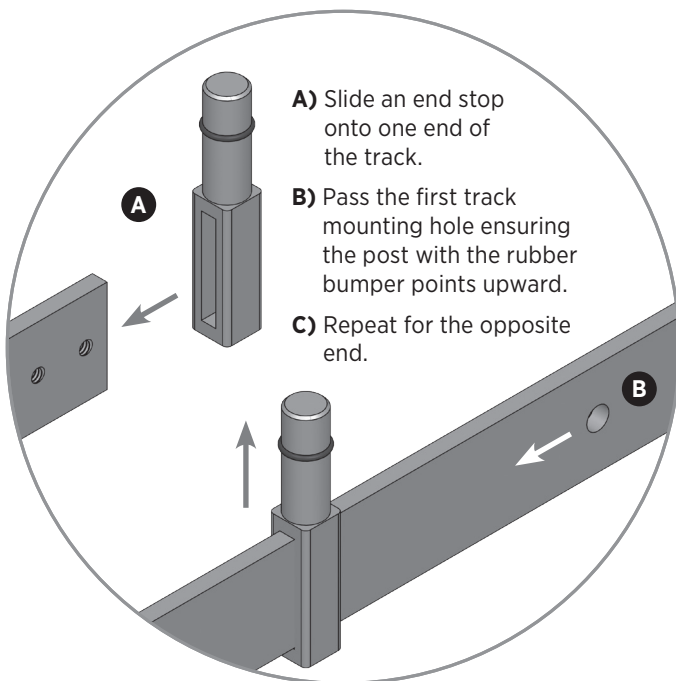

## STEP 11 Place Door On Track

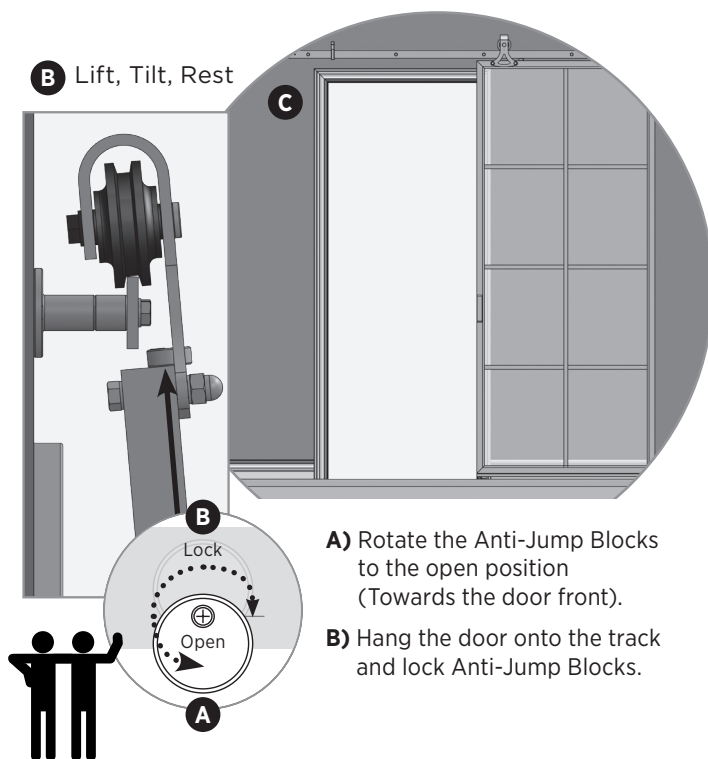

## STEP 12 Finish Affixing The Track To The Wall

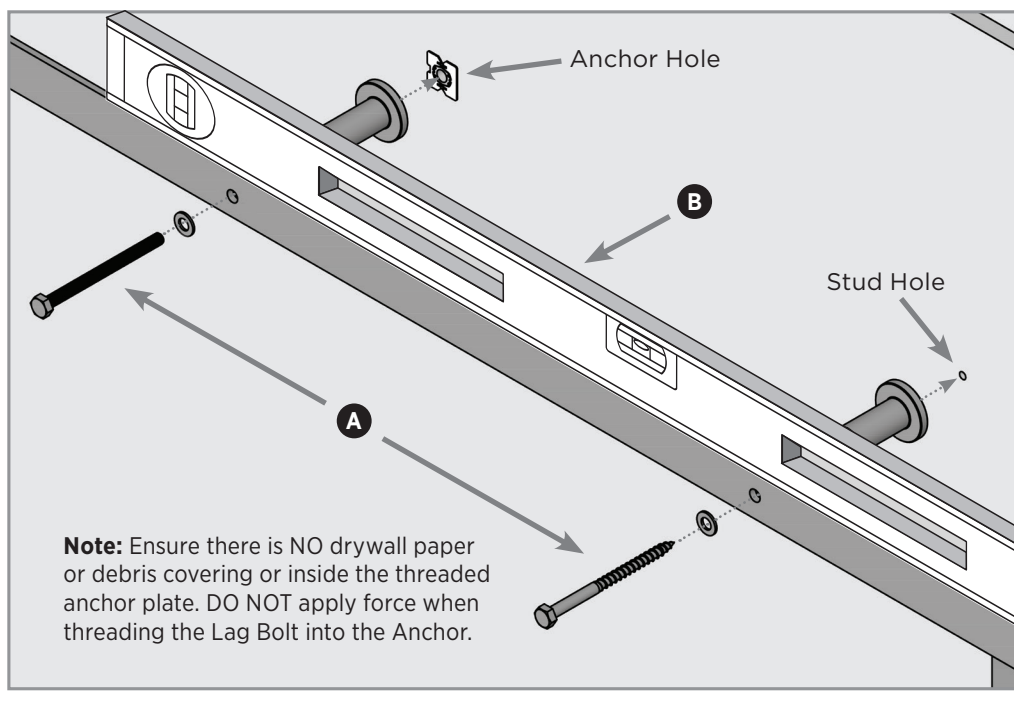

**A)** Finish affixing the track to the wall with the appropriate remaining fasteners (Lag Screws or Lag Bolts) along with Washers and Stanchions as shown.

**Note 1:** Do not fully tighten at this time.

**B)** Use a level to check the track is level, and adjust accordingly.

**C)** Tighten all 5 fasteners.

**Note 2:** Do not over tighten, fasteners should be snug.

# STEP 13 Installing the Door Guide

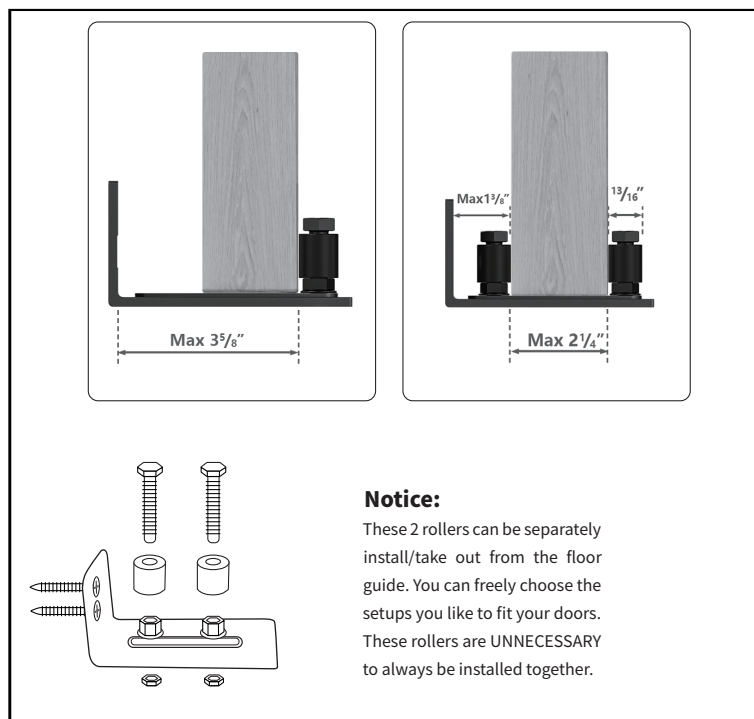



## Package Included

Unit: inch

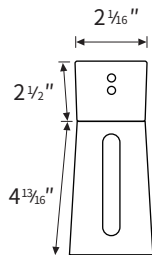

L Bracket(x2)

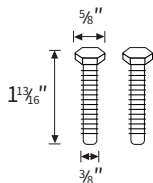

Long Bolt(x4)

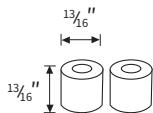

Small Roller(x4)

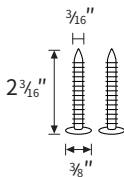

Lag Bolt(x4)



Thick Threaded  
Hex Jam Nut(x4)



Flange Nut(x4)

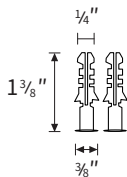

Wall Plugs ( x4)

- Our products are made of high-quality materials, and each process and parts also pursue exquisite workmanship.

## Installation