



Wireless Speaker

MROCK 101

USER MANUAL



Har Pal Ke Liye



MROCK 101 User Manual

Thank you for purchasing the Mobilla MRock Series. This product is designed to provide high quality wireless sound for your ipod, Mobile Phones, Computer, PDA or other audio devices. This instruction booklet explains the basic operation and care of the unit. Please read them carefully and keep for future reference.

Function



Alarm Setting



Clock Setting



SWITCH MODE



PREVIOUS TRACK/
VOLUME DOWN



PLAY/PAUSE



NEXT TRACK
VOLUME UP

How to Pair MROCK 101

1. Click on the 'M button' on MRock 101 to switch on the Bluetooth mode.
2. Turn on the Bluetooth of your phone or tablet or PC or other device to connect.
3. Go to 'available devices to pair' on your phone or tablet or PC and select MRock 101.
4. Your device is paired with the beep.

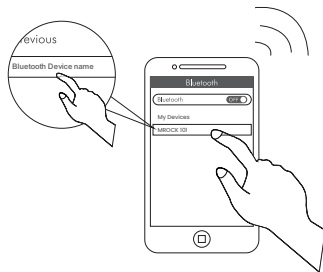

Specifications:

- Receiving range: 10 meters (No blocking)
- Power Supply: DC 5V
- Rated Power: 10W (5W*2)
- Drive Unit: Ø52mm*2
- Frequency Response: 60HZ-18KHZ
- Battery Capacity: 1200mAh
- THD: ≤ 0.5%
- SNR: ≥ 80dB
- Item Size: L200*W60*H76mm

First Use

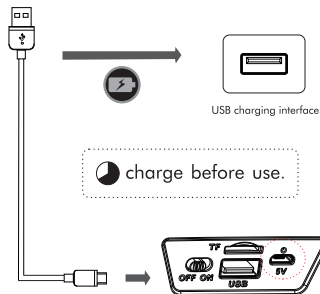

Setting The Alarm:

1. Turn on the speaker, press and hold the "⏸" button until the alarm clock flashes in the display.
2. Press the "⏸" button to switch from "hours setting" to "minutes setting" & to turn the alarm clock ON & OFF.
3. Press "—/+ " to set the desired alarm time.

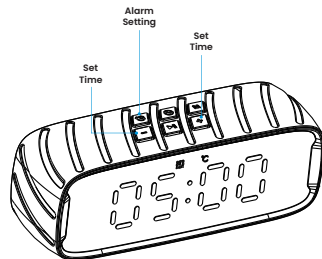

Setting The Clock:

1. Turn on the speaker, press and hold the "⏸" button until the clock flashes in the display.
2. Press "—/+ " to set the time.
3. Press the "⏸" button to switch from

"hours setting" to "minutes setting"

4. Press the "⏸" button again to store the new clock setting.

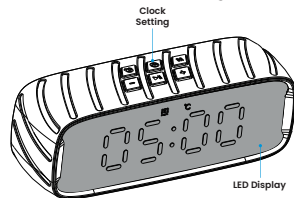

Setting for Temperature Display:

1. Turn on the speaker, press and hold the "⏸" button until "Temperature Digit" flashes in the display.
2. Press and hold the "⏸" button until "Temperature Digit" disappears in the display to turn off temperature display.

