

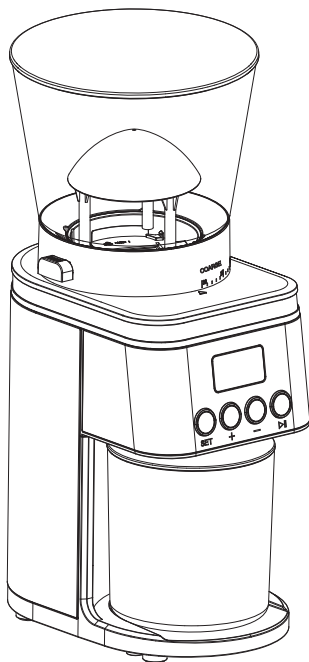

Instruction Manual

Coffee Grinder



BRAND: amzchef
MODEL NO.: AZ-BG709S

PLEASE READ INSTRUCTIONS CAREFULLY BEFORE ASSEMBLY
RETAIN THIS MANUAL FOR FUTURE REFERENCE

Contents

Section I: Safety Instructions	1
Section II: Features	3
Section III: Operating Instructions	4
Section IV: Cleaning & Maintenance	8
Section V: Technical Information	9
Section VI: Warranty	10

Section I: Safety Instructions

IMPORTANT SAFEGUARDS

Please read the safety instructions and the operating instructions in full. To avoid danger you must follow the safety and operating instructions.

- Appliance can be used by children aged from 8 years and above and persons with reduced physical, sensory or mental capabilities or lack of experience and knowledge if they have been given supervision or instruction concerning use of the appliance in a safe way and understand the hazards involved.
- Children shall not play with the appliance. Keep the appliance and its cord out of reach of children. Cleaning and user maintenance shall not be made by children without supervision.
- If the supply cord is damaged, it must be replaced by the manufacturer, its service agent or similarly qualified persons in order to avoid a hazard.
- Switch off the appliance and disconnect from supply before changing accessories or approaching parts that move in use.

This appliances is designed to be used in households and for similar uses such as:

- In kitchens for employees in shops, offices and other commercial areas.
- In agricultural businesses.
- In motels, hotels and other residential facilities and in bed and breakfast guesthouses.



Any other use is considered improper and can lead to personal injury and property damage.

Manufacturer shall not be liable for damage resulting from improper use.

Please note the following information to avoid injuries caused by misuse:

1. The appliance must not be in a cupboard during use.
2. The appliance must be connected to a properly installed earthed socket.
3. The appliance must always be disconnected from the mains supply when left unattended and before assembly, disassembly or cleaning.
4. Before use, make sure that there are no foreign objects in the bean container of the coffee grinder.

5. Do not remove the lid of the bean container until the grinder has come to a complete stop.
6. Never place your fingers or hands near the grinder mechanism and/or ground coffee chute when the grinder is in use.
7. Do not reach into the ground coffee chute during use.
8. Do not allow the power cord to come into contact with hot surfaces.
9. Do not use the appliance if the power cord is damaged.
10. Never immerse the appliance in water.
11. Do not clean parts that come into contact with food with aggressive detergents or scouring milk. Remove detergent residues with clean water. Further information on cleaning can be found under "Cleaning and Care".
12. Do not clean parts of the coffee grinder in the dishwasher.
13. Always use a soft brush to clean the grinder mechanism. Do not use water or soap for cleaning.
14. The appliance may be used by persons with reduced physical, sensory or mental abilities or lack of experience and/or knowledge if they are supervised or have been instructed in the safe use of the appliance and have understood the hazards involved.
15. Do not allow children to play with the appliance.
16. Replacement of the power cable and any other repairs must only be carried out by manufacturer.
17. Use of accessories not recommended or sold by the manufacturer may result in fire, electric shock, or personal injury.
18. The appliance must not be used by children. Keep the appliance and its power cord away from children.

Section II: Features

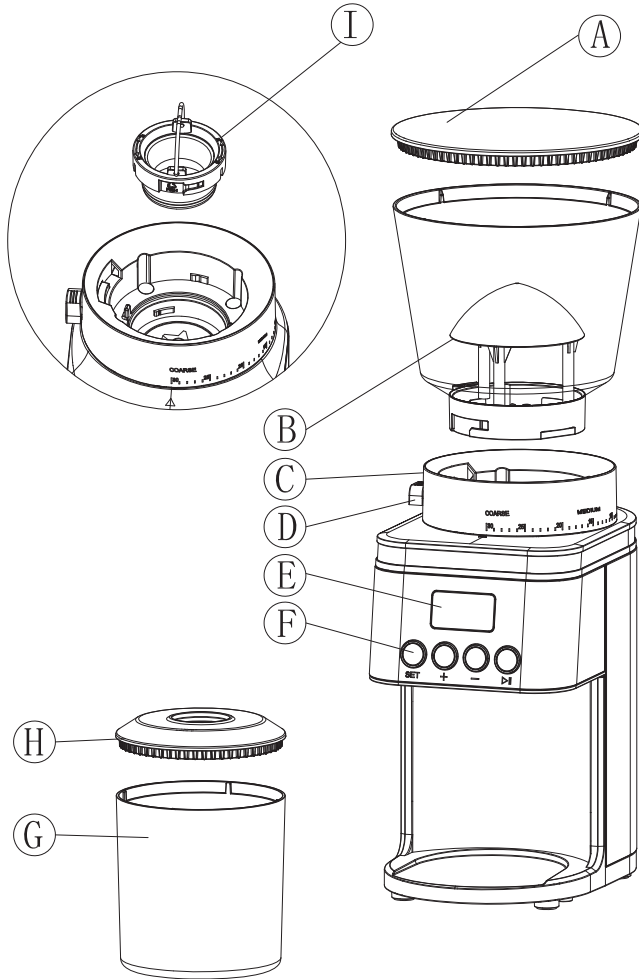

- A. Coffee Bean Hopper lid
- B. Coffee Bean Hopper
- C. Coarseness Selector Knob
- D. Button
- E. Display
- F. Function Selection Button
- G. Ground Coffee Container
- H. Ground Coffee Container lid
- I. Removable Upper Burr Blade

Section III: Operating Instructions

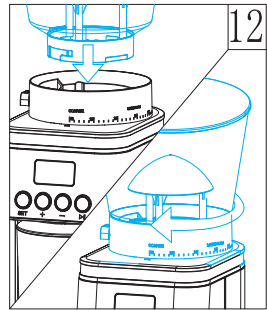
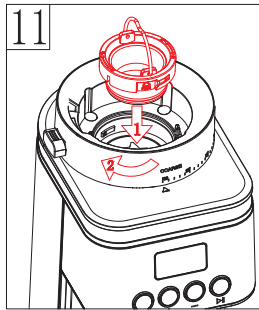
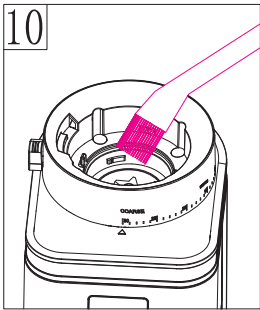
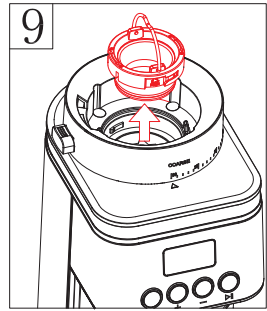
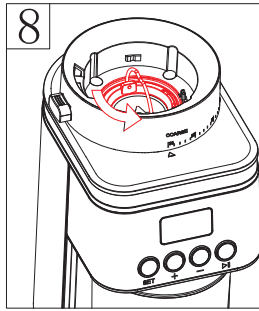
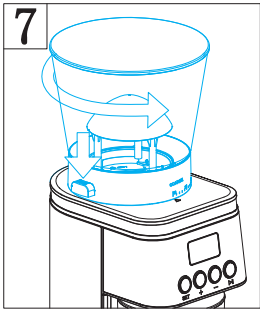
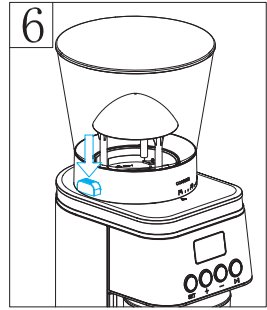
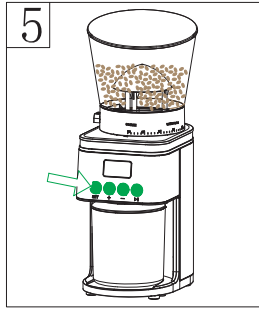
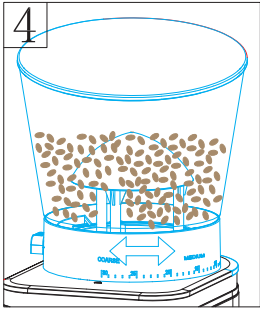
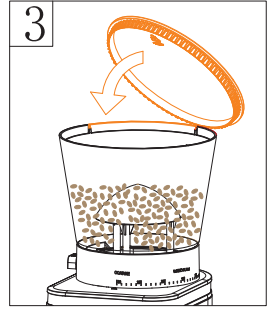
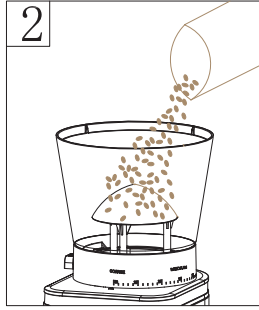
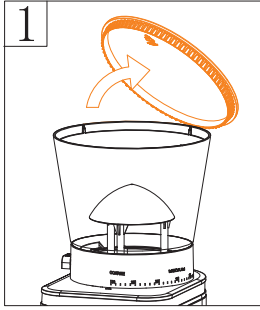

Before First Use:

1. Remove all packaging.
2. All appliances are tested to ensure that they are in perfect working order during manufacture. As a result, ground coffee residues may remain in the appliances.
3. Wash hopper, ground coffee container, container lid in warm soapy water and dry thoroughly. Wipe exterior of grinder with a soft damp cloth and dry thoroughly.
4. Place the appliance on a dry, level and stable surface.
5. Make sure that the mains voltage in your household corresponds to the information on the product label on the base of the appliance.
6. Connect the appliance to the power supply.

Energy Saving Feature:

- The grinder will automatically switch off if not used for 15 minutes.
- To reactivate the machine while in POWER SAVING/SLEEP MODE, press any key on the grinder control panel.

Using Your Coffee Grinder:

- The appliance has various features to ensure ease of use and the perfect coffee.
- These features are explained below.

Filling The Coffee Beans:

1. Remove the lid on the bean container (Fig①).
2. Fill the bean container with the required quantity of coffee beans (Fig②). The fill capacity is approx. 300g.
3. Replace the lid on the bean container (Fig③).



Note: The coffee grinder is only suitable for grinding coffee beans. Make sure that there are no other objects or food inside the appliance.

To ensure that the grinder works properly, do not use caramel coffee beans. Please do not fill the bean container with ground coffee.

Set Grind Level:

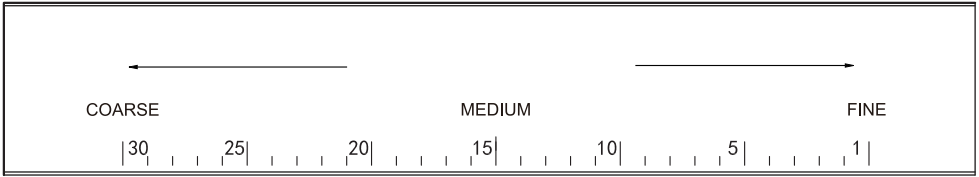

Filling The Coffee Beans:

1. Depending on your individual taste, up to 30 different grind levels can be set to suit the required preparation method - e.g. espresso, filter coffee or French press.
2. To adjust the grind level, turn the bean container with light pressure to the required position (Fig④).
3. Depending on the preparation method, select a grind level from fine (Fine) to coarse (Coarse).

Please refer to the following table for recommended settings:

Method	Espresso	Pour Over, Filter Coffee, Cold Brew	French Press
Recommended grind level	Fine	Medium	Coarse
Grind level setting	1-8	9-21	22-30

Choosing A Grind Programme:

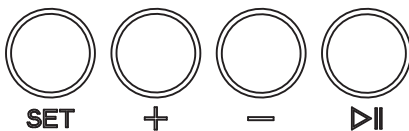

SET - time/cups selection

+ - increase time/cups

- - reduce time/cups

▶|| - start/stop

Select The Grinding Cups:

- There are 1-12 cups select range. If set to 12, it will grind enough coffee to serve approximately 12 cups. This should be used as a guide only, as it will vary depending upon preferred taste, type and roast of bean and the grind selected.
- Press the **SET** key and choose the cup programme, the  symbol appears on the display.
- With the **+** key or the **=** key you can set the number of cups from 1 to 12. Hold the button down to fast forward.
- Press the **▶||** key, the grinding process starts.
- As soon as the preset number of cups is reached, the grinder switches off. The grinding process can be stopped at any time by press the **▶||** key.
- The last number of cups set remain stored even after unplugging from the main power supply.

Select The Grinding Time:

- There are 1-40 seconds select range. If set to 30, it will grind enough coffee to serve approximately 12 cups. This should be used as a guide only, as it will vary depending upon preferred taste, type and roast of bean and the grind selected.
- When setting the grinding level to Coarse, it is recommended that the grinding time does not exceed 30 seconds.
- Press the **SET** key, the **SEC** symbol appears on the display.
- With the **+** key or the **=** key you can set the grind time from 1 to 40 seconds. Hold the button down to fast forward.
- Press the **▶||** key, the grinding process starts.
- As soon as the preset grind time is reached, the grinder switches off. The grinding process can be stopped at any time by press the **▶||** key.
- The last grind time set remain stored even after unplugging from the main power supply.



Note: After use, the appliance must be unplugged. Remove the Ground Coffee Container and use the grounds as you desire.

Tips

- Fresh beans will yield the best flavor and aroma.
- Only fill the bean container with the quantity of coffee beans that you intend to use in the near future.
- The required grind quantity depends on the coffee quantity and preparation method. Different amounts are used for the different preparation methods.
- The actual grind size for a particular setting will vary depending on many factors, including: degree of roast (light vs. dark), freshness, humidity, type of bean, oil content, etc. With use, you will discover which setting best meets your taste, brewing style and other personal coffee-making preferences.

Section IV: Cleaning & Maintenance

ATTENTION: Always disconnect the mains plug before cleaning!

- For the best coffee results, we recommend that you clean the bean container, grinder and ground coffee chute regularly. Clean when the grinder is completely empty.
- The bean container can be removed from the machine for cleaning. To do this, press and hold the button at the bottom edge of the bean container in the open position. At the same time, turn the bean container anti-clockwise until it stops and remove it from the machine. Remove coffee residues from the bean container with a soft, damp cloth.
- The outer grinder ring can be removed to clean the grinding mechanism. To do this, lift the clamp upwards and unlock the grinder ring by turning it anticlockwise. Remove the grinder ring.
- Clean the grinding mechanism with the brush provided. Remaining coffee residues can be shaken out or removed using a vacuum cleaner.
- Replace the grinder ring in the appliance and turn it clockwise until it locks into place. It is completely locked when the grinder ring can no longer be pulled up and out.
- Ground coffee residues on ground coffee chute and on the housing can be removed with the enclosed brush and/or a soft, damp cloth.
- To insert the bean container, place it on the appliance and turn clockwise until it clicks into place. In this position, the markings on the housing and on the bean container are vertically one above the other. The coffee grinder can only be used if the bean container is correctly inserted.
- The ground coffee container and the lid of the bean container can be cleaned with a damp cloth.
- Never clean the coffee grinder and its removable parts in the dishwasher.

Section V: Technical Information

- The appliance has an overload protection for the grinding mechanism, this protects against damage by foreign objects. If you hear a loud, rattling, previously unknown noise during the grinding process, press the on/off button and clean the grinding mechanism as described under "Clean & Maintenance".
- When the appliance is not in use it switches off after 15 minutes.

Product Name	Coffee Grinder
Model	AZ-BG709S
Rated Voltage	120V
Rated Frequency	60Hz
Rated Power	160W
Weight	1.98 KGS/4.4 LB

Manufacturer: Foshan Ultra Electrical Appliances Co.,Ltd
Add: No. 6 Road 11 Science & Technology Industrial Park, Xingtan, Shunde, Foshan, Guangdong, China
Contact: Emily Tel: +1 (838) 910 8317 E-Mail: info@iamzchef.com



1-YEAR WARRANTY

Thank you for choosing **AMZCHEF** product. We sincerely hope that you are satisfied with it.

This product is warranted against any electronic or mechanical defects for a period of 1 year from the date of original purchase by the consumer. Replacement unit/parts will be warranted for the remaining portion of the original warranty period.

Questions? Problems? Concerns?

If you need any help, please feel free to contact us, via our website: www.iamzchef.com or email: info@iamzchef.com. Problem + Order number+ a photo or a video attached in the email would help us solve the problem better and faster. We will get back to you within 24 hours once we received the email.

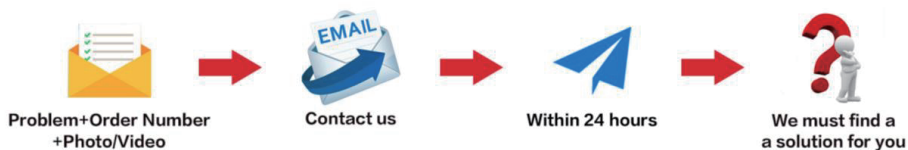

Agent/Distributor is welcome to contact us. Email:info@iamzchef.com