



**JUNGLE JUMPAROO**  
1349 S 500 E STE. 240  
American Fork, UT 84403  
contact@junglejumperoo.com  
888-980-JUMP (5867)

---

**CONGRATULATIONS on your new Mini Jungle Jumperoo!** We are so excited that you are now a part of the Jungle Jumperoo family! We hope you have years of fun ahead with your new Mini Jungle Jumperoo! Below you will find assembly instructions and tips on care for your Mini Jungle Jumperoo.

**ASSEMBLY AND DISASSEMBLY:**

Before you begin to assemble your Mini Jungle Jumperoo, please note the following: Do not over tighten the bolts, this can damage the treads making it impossible to take your Mini Jungle Jumperoo apart and reassembling at another time. To move your Mini Jungle Jumperoo through a doorway simply remove the tube from the cage, remove the set screw in the base and remove the 2 base connectors. When walking through the doorway simply pinch the 2 sections together.

**GAMES:**

Kids love to use their imagination on the Mini Jungle Jumperoo, it is more than just a jump toy! Because it forms a circle it can be used for social play as well. Some of the popular games for the Mini Jungle Jumperoo include: King of the Jumperoo, Marco/Polo, Chasing game by running around the bars in one direction, musical Jumperoo (musical chairs, but using each pole color as the "chair") Color pole play with each pole representing something (fire, Ice, nature and sun) and Simon Says. If you have a fun game that you like to play on your Jungle Jumperoo we would love to hear tag us on Social Media @junglejumperoo or email us at [contact@JungleJumperoo.com](mailto:contact@JungleJumperoo.com)!

**ADD ONS:**

We offer additional accessories for your Jungle Jumperoo on our website [www.JungleJumperoo.com](http://www.JungleJumperoo.com)! Our most popular accessories include: The Rope Swing with its easy to adjust length allowing all ages to swing safely, the Turret sprinkler, to beat the summer heat and last the Tube Cover which adds a bright colorful finish look to the Jungle Jumperoo!

**WARNING:**

Jump safely! Always have an adult present when in use. Do not flip or invert. Do not wear items that can damage the Mini Jungle Jumperoo inner tube (cleats, heels etc.) Place Mini Jungle Jumperoo on a flat area with padding, carpet, rug or grass. Do not place the Mini Jungle Jumperoo on cement or directly on hardwood floors. Do not place Mini Jungle Jumperoo on a hill or incline, this presents a tipping hazard. Pull Mini Jungle Jumperoo away from walls or other hazards when in use. Do not climb to the top of the cage or attempt to pull the cage over. Always keep both hands on the bars when jumping, do not use the rope swing when jumping. Do not put any part of the body through the hexagon. If used outdoors the inner tube can become very hot, please use caution. If stored outside keep the Mini Jungle Jumperoo covered when not in use.

**WARRANTY:**

The Mini Jungle Jumperoo frame is under warranty for 1 year. Warranty does not cover defects or damage due to improper installation, cosmetic imperfection or damage caused by normal outdoor use of products that have been damaged by nature, negligence, misuse, accidents or events beyond Jungle Jumperoo's control. The Mini Jungle Jumperoo Inner Tube, although the inner tube should last for years, we cannot warranty the inner tube for daily use. If you find a defect with the inner tube at the time of purchase, we will happily replace the defective item. Please see page 3 for more information regarding the Inner Tube. You can also find our warranty information on our website at: <https://junglejumperoo.com/pages/warranty> and Jungle Jumperoo Care and Maintenance at: <https://junglejumperoo.com/pages/jungle-jumperoo-care>

---

**PARTS INCLUDED:**

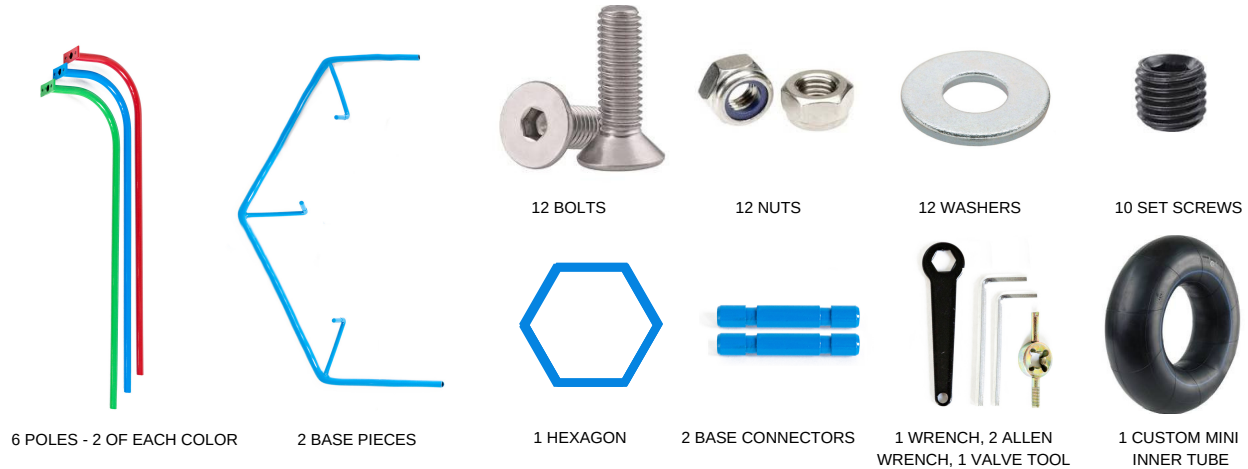

**ASSEMBLY INSTRUCTIONS**

**ASSEMBLE BASE**

- a. Connect the two large base pieces with the small base connectors, with the base laying flat carefully insert the small blue base connector into the base piece align the groove of the connector with the hole on the bottom of the base
- b. Install 4 black set screw with small allen wrench to secure screwing in until flush and tight

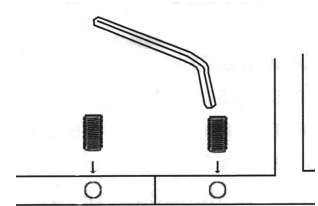
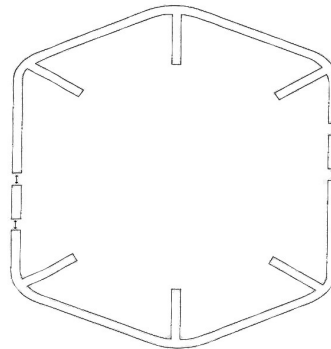

**INSTALL THE POLES**

- a. Place poles onto the prongs on the base in desired color pattern, ensure each pole is lowered completely onto the base prong



**INSTALL OCTAGON TOP**

- a. Install each flat bolt with washer and locking nut on hexagon for each pole. Screw should not be tightened fully until assembly is complete.

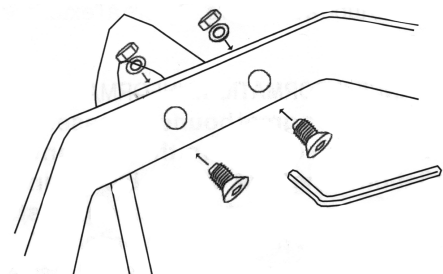

### TIGHTEN SCREWS

- a. Once all poles are secured to the hexagon begin tightening the bolts alternating bolts that are across from one another
- b. Secure each pole at the base with 6 remaining black set screws until flush with pole

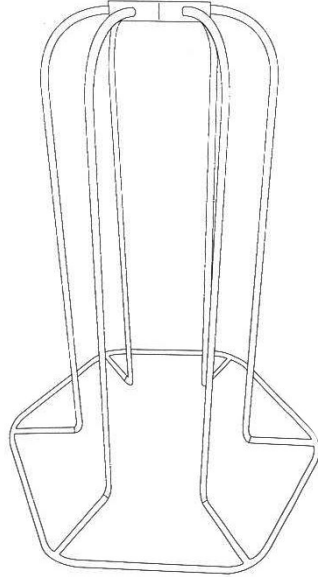

### INSTALL TUBE

- a. Inflate inner tube to 12-14 inches high using start stop method (*see below for detailed instructions*)
- b. Once inflated slide inner tube down poles with valve stem facing down

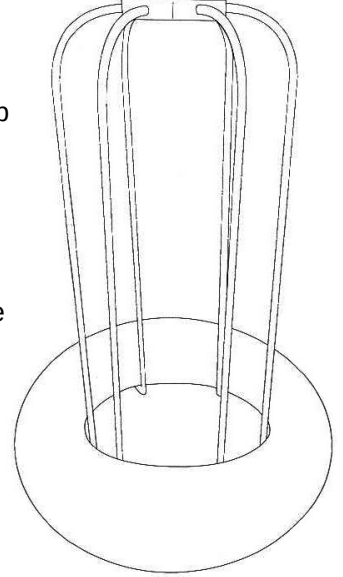

### IMPORTANT INFORMATION:

To inflate your Inner Tube, you will need a standard air compressor, to ensure proper inflation we recommend using the start/stop method; small burst of air then stop, continue until full. This keeps the tube round and helps the air disperse within the tube evenly. Tube will be firm to the touch when inflated. PLEASE NOTE: There is no PSI reading on the tube since there is not an outer tire. The tube will stand about 12-14 inches high when properly inflated. During inflation If you notice any asymmetry in your tube remove any air in the tube and re-inflate slowly using the stop and start air flow method to prevent bulging. Due to the heavy rubber compound it can take a few weeks for your tube to break-in and may require more air, we recommend filling the tube slowly and adding more as needed. Over inflation of the tube can cause bulging, decreases the life of the tube and can cause it to pop prematurely. If you encounter a slow leak in your new inner tube it is likely due to the inner valve stem core. If this part is not tightened all the way it will allow air to slowly leak over time. Use a small part of tweezers or the valve tool that came with your Jungle Jumparoo to tighten this part by turning the inner pin in the valve stem clock-wise (to the right) until it stops. You can also remove this part to deflate the inner tube quickly by unscrewing this part counter-clockwise (to the left).

There are a few key steps you can take to ensure the longevity of your Inner Tube:

- Avoid abrasive or corrosive chemicals, such as pool treatment chemicals, motor oil, industrial cleaning solutions, sharp objects, high heels, sports cleats, weed whackers lawn mowers etc.
- Avoid Sunlight/UV exposure using a tarp or All-Weather cover when unit is not in use. The Jungle Jumparoo Tube cover will also add a layer of protection and protect little feet from a hot tube but is not UV/Weather resistant and will need to be covered when not in use when used outdoors.
- Avoid extreme temperatures hot and cold, removing air for the hotter summer months. Leaving the tube in direct sunlight or hot temperatures can cause the tube to rupture.
- Under inflation or Over inflation Extended periods of disuse (such as seasonal storage) Inner tubes that are used often will last longer as this maintains the elasticity and flexibility of the rubber. Regular use causes the inner tube to flex and compress, pushing this protective substance to the surface. This doesn't happen in an unused inner tube, so the rubber is more vulnerable to damage from ozone and oxidation.
- Over inflation, storage in direct sunlight, improper inflation which caused bulging and contact with sharp objects is not covered by warranty and will significantly decrease the lifespan of the tube. It is recommended that air be removed from the tube during hotter months.



**JUNGLE JUMPAROO**  
1349 S 500 E STE. 240  
American Fork, UT 84403  
contact@junglejumperoo.com  
888-980-JUMP (5867)

---

## **JUNGLE JUMPAROO CARE AND MAINTENANCE**

### **BEFORE EACH USE:**

- Inspect and tighten all bars and bolts as needed
- Visually inspect the inner tube for proper inflation
  - Over inflation, storage in direct sunlight and improper inflation which caused bulging is not covered by warranty and will significantly decrease the lifespan of the tube. It is recommended that air be removed from the tube during hotter months to avoid tube rupture.
- Check for any signs of visible damage or wear to the tube

### **BEGINNING OF EACH SEASON:**

- Tighten all hardware
- Check all bolts and set screws to ensure they are screwed together tight and properly, set screws should be flush with bar
- Replace any missing bolts or set screws as needed
- Check tube for wear or rubber rot, add or remove air as needed for proper inflation. It is recommended that air be removed from the tube for hotter summer months if used outdoors as heat can cause the tube to rupture if it does not have proper room to expand.
- Many people do not understand why their tube will suddenly not hold air after being packed away all winter long, the answer is simple. When rubber is not in use it begins to breakdown causing rubber rot. The best thing you can do to prolong the use of your tube is to use it as often as possible!
- Use a UV protectant on your inner tube to increase the lifespan of the tube
- If using the Mini Jungle Jumperoo outdoors, we recommend wiping the Mini Jungle Jumperoo down with CRL or a similar product then applying a clear sealant coat on the powder coating every season to seal any cracks or wear that may developed over time and use.

### **END OF THE SEASON:**

- Bring the Mini Jungle Jumperoo indoors at the end of the outdoor season, or when temperatures drop below 40 degrees Using the Mini Jungle Jumperoo year-round will increase the life of your Inner Tube substantially
- If using the Mini Jungle Jumperoo outdoors, we recommend wiping the Mini Jungle Jumperoo down with CRL or a similar product then applying a clear sealant coat on the powder coating every season to seal any cracks or wear that may developed over time and use.
- Leaving the Mini Jungle Jumperoo outdoors in cold temperatures can cause the powder coating to fade, chip and will drastically reduce the lifespan of the tube

Visit us at <https://junglejumperoo.com/pages/jungle-jumperoo-care>  
for additional care and maintenance of your Jungle Jumperoo!

---