

KIMO

INSTRUCTION MANUAL

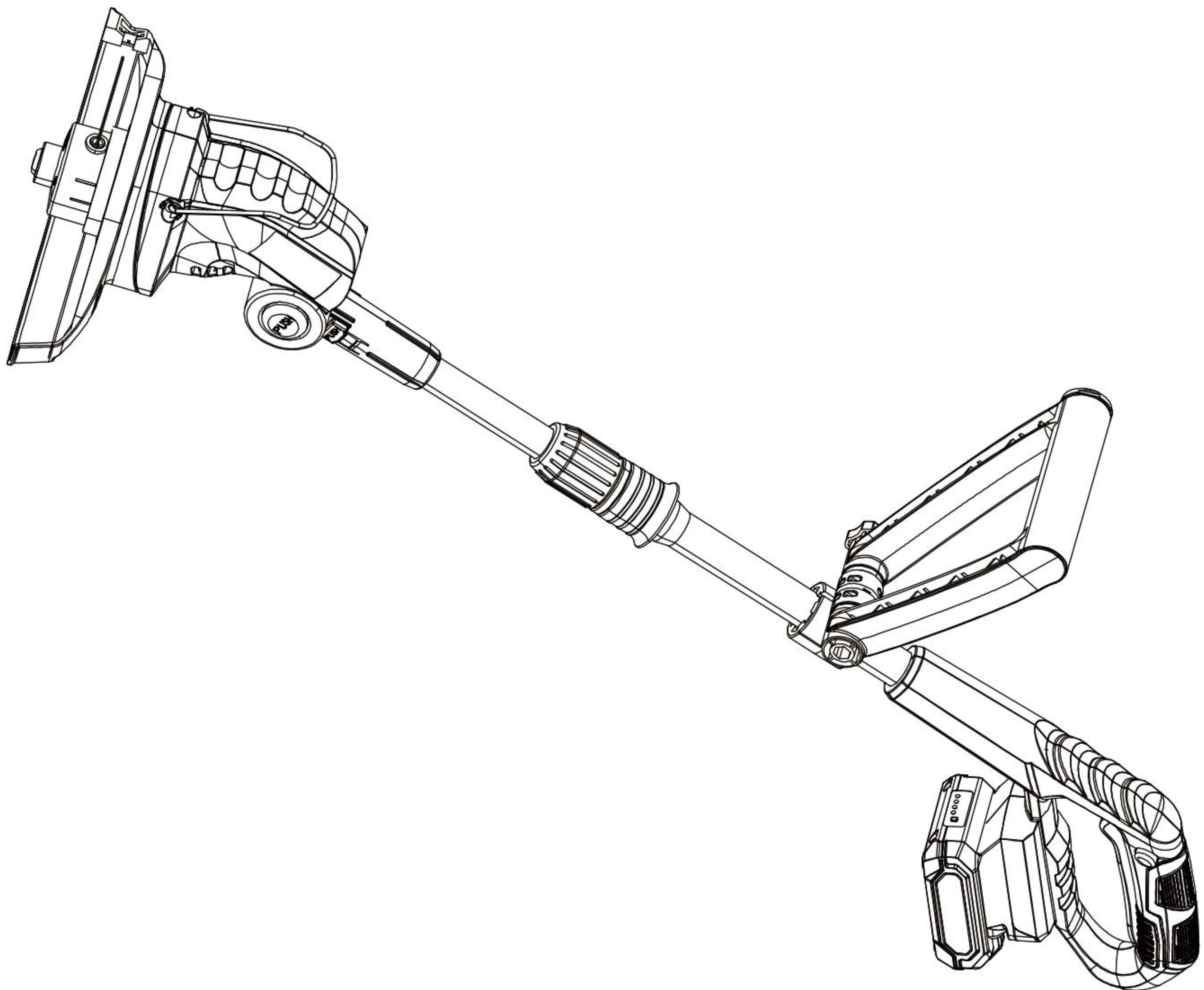

CATALOG NUMBER ET1610

20V STRING TRIMMER

www.kimotool.com

If you have questions or comments, contact us at

service@kimotools.com

Content Table

GENERAL SAFETY RULES	1
IMPORTANT SAFETY FOR ALL BATTERY PACKS	7
SPECIFIC SAFETY FOR LITHIUM-ION	9
IMPORTANT SAFETY FOR ALL BATTERY CHARGERS	10
COMPONENTS AND SPECIFICATIONS	12
SPECIFIC INSTRUCTIONS	14
• Installing and Removing the Battery Pack from the Tool	14
• Tool Assembly	15
• Installing Guard	15
• Installing Mounting Front Handle	16
• Operation	17
• Setting the Operation Length	17
• Setting the Angle of Operation Handle	17
• Setting the Position and Angle of Front Handle	18
• Adjusting the Cutting Width	18
• Switch On/Off	19
• Operating the Trimmer	19
CHARGING PROCEDURE	21
TROUBLESHOOTING	24
MAINTENANCE	25
• Replace the Spool	25
• Refill the Line	27
WARRANTY	28
EXTENDED WARRANTY REGISTRATION	29

SAVE THIS INSTRUCTIONAL MANNUAL FOR FUTURE REFERENCE.

Definitions: Safety Guidelines

The definitions below describe the level of severity for each signal word. Please read the manual and pay attention to these symbols.

WARNING: Indicates a potentially hazardous situation which, if not avoided, **could** result in **death or serious injury**.

CAUTION: Indicates a potentially hazardous situation which, if not avoided, **may** result in **minor or moderate injury**.

NOTE: Indicates a practice not related to personal injury which, if not avoided, **may** result in **property damage**.



WARNING! Read and understand all instructions. Failure to follow all instructions listed below may result in electric shock, fire and/or serious personal injury.

GENERAL SAFETY RULES

WORK AREA SAFETY

- **Keep your work area clean and well lit.** Cluttered benches and dark areas invite accidents.
- **Do not operate power tools in explosive atmospheres, such as in the presence of flammable liquids, gases, or dust.** Power tools create sparks which may ignite the dust or fumes.

- **Keep bystanders, children, and visitors away while operating a power tool.** Distractions can cause you to lose control.
- **Do not allow to be used as a toy.** Close attention is necessary when used by or near a child. Not recommended for use by children.

INTENDED USE

It is intended for cutting weed, grass or similar soft vegetation in areas that are hard to reach, e.g. under bushes, on slopes and edges. It may not be used to work on unusual thick, dry or wet grass, e.g. pasture grass, or to shred leaves.

For safety reasons it is essential to read the entire instruction manual before first operation and to observe all the instructions therein.

This product is intended for private domestic use only, not for any commercial trade use. It must not be used for any purposes other than those described.

ELECTRICAL SAFETY

- **Do not expose power tools to rain or wet conditions.** Water entering a power tool will increase the risk of electric shock.
- **Do not immerse any part of the unit in liquid.**
- **Do not handle charger, including charger plug, and charger terminals with wet hands.**
- **The chargers power plug must match the outlet.** Never modify the plug or plug the tool into outlets that do not match the plug.

- **Avoid contacting with grounded elements such as metal tables, pipes, ranges or refrigerators.** Contact with these elements can put you at a risk of electrical shock.
- **Always inspect electrical cord for damage before and after use.** A damaged cord can cause electrical shock.

PERSONAL SAFETY

- **Stay alert, watch what you are doing and use common sense when operating a power tool.** Do not use tool while tired or under the influence of drugs, alcohol, or medication. A moment of inattention while operating power tools may result in serious personal injury.
- **Dress properly. Do not wear loose clothing or jewelry. Contain long hair. Keep your hair, clothing, and gloves away from moving parts.** Loose clothing, jewelry, or long hair can be caught in moving parts. Air vents often cover moving parts and should also be avoided.
- **Use personal protective equipment.** Always wear safety glasses with side shields marked to comply with ANSI Z87.1. Everyday glasses have only impact resistant lenses. They are NOT safety glasses. Following this rule will reduce the risk of eye injury. Use face mask if operation is dusty.
- **Do not operate the equipment while barefoot or when wearing sandals or similar lightweight footwear.** Wear protective footwear that will protect your feet and improve your footing on slippery surfaces.
- **Avoid accidental starting. Be sure switch is off before plugging in.** Carrying tools with your finger on the switch or plugging in tools that have the switch on invites accidents.

- **Do not overreach.** Keep proper footing and balance at all times.
- **If devices are provided for the connection of dust extraction and collection facilities, ensure these are connected and properly used.** Use of dust collection can reduce dust-related hazards.
- **Avoid prolonged use.** The tool's repetitive motion and vibration can cause harm to your hands or arms. The user can use gloves for extra cushion; take frequent breaks and limits daily use to prevent this issue.

POWER TOOL USE AND CARE

- **Know this tool.** Read this manual carefully; learn its applications and limitations, as well as the specific potential hazards related to this tool.
- **Use the right unit.** Do not use this unit for any job except that for which it is intended.
- **Use only as described in this manual.** Use only manufacturer's recommended attachments.
- **Use only accessories that are recommended by the manufacturer for your model.** Accessories that may be suitable for one tool may become hazardous when used on another tool.
- **Always have a firm footing and grip on the tool to counteract any force that may be enacted during the operation of the tool.**
- **Never point the tool at the user or others in the work area.** This could cause serious injury.
- **Do not use tool if switch does not turn it on or off.** Any tool that cannot be controlled with the switch is dangerous and must be repaired.

- **Do not force tool. Use the correct tool for your application.** The correct tool will do the job better and safer at the rate for which it is designed.
- **Store idle tools out of reach of children and other untrained persons.** Tools are dangerous in the hands of untrained users.
- **Check for misalignment or binding of moving parts, break- age of parts, and any other condition that may affect the tool's operation.** If damaged, have the tool serviced before using. Many accidents are caused by poorly maintained tools.
- **Before making adjustments, changing accessories, or storing the tool, please disconnect the tool from the battery.** This will reduce the risk of injury from the power tool.
- **Maintain the tool with care.** A properly maintained tool will function more smoothly and prevent binding, making it easier to use.
- **Check operation of the tool before use.** Do not use the tool if the workpiece contact mechanism is not working correctly as accidental blowing may occur.
- **Do not use the tool if the trigger does not actuate properly.** Any tool that cannot be controlled with the trigger is dangerous and must be repaired.
- **Do not drop or throw this tool. Dropping or throwing the tool can result in damage that will make the tool unusable or unsafe.** If the tool has been dripped or thrown, examine the tool closely for bent, cracked or broken parts. STOP and repair before using or serious injury could occur.

BATTERY USE AND CARE

- **Only use batteries that are recommended for this tool by the manufacturer.** Use any other battery may cause risk of injury or fire.
- **Recharge only with the charger specified by the manufacturer.** A charger that is suitable for one type of battery pack may create a risk of fire when used with another battery pack.
- **When battery pack is not in use, keep it away from other metal objects like paper clips, coins, keys, nails, screws, or other small metal objects that can make a connection from one terminal to another.** Shorting the battery terminals together may cause burns or a fire.
- **Under abusive conditions, liquid may be ejected from the battery; avoid contact. If contact accidentally occurs, flush with water. If liquid contacts eyes, additionally seek medical help.** Liquid ejected from the battery may cause irritation or burns.
- **Do not use a battery pack or tool that is damaged or modified.** Damaged or modified batteries may exhibit unpredictable behavior resulting in fire, explosion or risk of injury.
- **Do not expose a battery pack or tool to fire or excessive temperature.** Exposure to fire or temperature above 265°F (130°C) may cause explosion.
- **Follow all charging instructions and do not charge the battery pack or tool outside the temperature range specified in the instructions.** Charging improperly or at temperatures outside the specified range may damage the battery and increase the risk of fire.
- **Before cleaning the charger, make sure to unplug it from any power source.** This will reduce the risk of an electrical shock.

- **Never attempt to open the batter pack for any reason.**
If the battery pack case is damaged or cracked, do not insert it in to the charger.
- When ordering replacement battery packs, be sure to include the catalog number and voltage. **Consult us at service@kimotools.com.**

TOOL SERVICE

- **Recharge only with the charger specified by the manufacturer.**
A charger that is suitable for one type of battery pack may create a risk of fire when used with another battery pack.
- **Never service damaged battery packs.** Service of battery packs should only be performed by the manufacturer or authorized service providers.
- **Tool service must only be performed by qualified repair personnel.**



WARNING! If any parts are missing, do not operate this tool until the missing parts are replaced. Failure to do so may result in serious personal injury. Please contact us for the missing parts.

IMPORTANT SAFETY FOR ALL BATTERY PACKS

The battery pack is not fully charged out of the carton. Before using the battery pack and charger, read the safety instructions below and then follow charging procedures outlined.

- **Do not charge or use the battery pack in explosive atmospheres, such as in the presence of flammable liquids, gases or dust.** Inserting or removing the battery pack from the charger may ignite the dust or fumes.
- **NEVER force the battery pack into the charger. Do not modify the battery pack in any way to fit into a non-compatible charger as battery pack may rupture causing serious personal injury.**
- Charge the battery packs only in designated **KIMO** chargers.
- **DO NOT** splash or immerse in water or other liquids.
- **Do not store or use the tool and battery pack in locations where the temperature may reach or exceed 104 °F (40 °C) (such as outside sheds or metal buildings in summer).** For best life store battery packs in a cool, dry location.

NOTE: Do not store the battery packs in a tool with the trigger switch locked on. Never tape the trigger switch in the **ON** position.



WARNING! Fire hazard. Never attempt to open the battery pack for any reason. If the battery pack case is cracked or damaged, do not insert into the charger. Do not crush, drop or damage the battery pack. Do not use a battery pack or charger that has received a sharp blow, been dropped, run over or damaged in any way (e.g., pierced with a nail, hit with a hammer, stepped on). Damaged battery packs should be returned to the service center for recycling.



WARNING! Fire hazard. Do not store or carry the battery pack so that metal objects can contact exposed battery terminals. For example, do not place the battery pack in aprons, pockets, tool boxes, product kit boxes, drawers, etc., with loose nails, screws, keys, etc. **Transporting batteries can possibly cause fires if the battery terminals inadvertently come in contact with conductive materials such as keys, coins, hand tools and the like.** The US Department of Transportation Hazardous Material Regulations (HMR) actually prohibits transporting batteries in commerce or on airplanes (e.g., packed in suitcases and carry-on luggage) UNLESS they are properly protected from short circuits. So when transporting individual battery packs, make sure that the battery terminals are protected and well insulated from materials that could contact them and cause a short circuit.

SPECIFIC SAFETY FOR LITHIUM-ION

- **Do not incinerate the battery pack even if it is severely damaged or is completely worn out.** The battery pack can explode in a fire. Toxic fumes and materials are created when lithium ion battery packs are burned.
- **If battery contents come into contact with the skin, immediately wash area with mild soap and water.** If battery liquid gets into the eye, rinse water over the open eye for 15 minutes or until irritation ceases. If medical attention is needed, the battery electrolyte is composed of a mixture of liquid organic carbonates and lithium salts.
- **Contents of opened battery cells may cause respiratory irritation.** Provide fresh air. If symptoms persist, seek medical attention.



WARNING! Burn hazard. Battery liquid may be flammable if exposed to spark or flame.

IMPORTANT SAFETY FOR ALL BATTERY CHARGERS

- **DO NOT attempt to charge the battery pack with any chargers other than the ones in this manual.** The charger and battery pack are specifically designed to work together.
- **These chargers are not intended for any uses other than charging KIMO rechargeable batteries.** Any other uses may result in risk of fire, electric shock or electrocution.
- **Do not expose the charger to rain or snow.**
- **Pull by the plug rather than the cord when disconnecting the charger.** This will reduce the risk of damage to the electric plug and cord.
- **Make sure that the cord is located so that it will not be stepped on, tripped over or otherwise subjected to damage or stress.**
- **Do not use an extension cord unless it is absolutely necessary.** Use of improper extension cord could result in risk of fire, electric shock or electrocution.
- **When operating a charger outdoors, always provide a dry location and use an extension cord suitable for outdoor use.** Use of a cord suitable for outdoor use reduces the risk of electric shock.
- **Do not place any object on top of the charger or place the charger on a soft surface that might block the ventilation slots and result in excessive internal heat.** Place the charger in a position away from any heat source. The charger is ventilated through slots in the top and the bottom of the housing.
- **Do not operate the charger with a damaged cord or plug.**

- **Do not operate the charger if it has received a sharp blow, been dropped or otherwise damaged in any way.** Contact us immediately.
- **Do not disassemble the charger; take it to an authorized service center when service or repair is required.** Incorrect reassembly may result in a risk of electric shock, electrocution or fire.
- **Disconnect the charger from the outlet before attempting any cleaning.** This will reduce the risk of electric shock. Removing the battery pack will not reduce this risk.
- **NEVER** attempt to connect 2 chargers together.
- **The charger is designed to operate on standard 120V household electrical power. Do not attempt to use it on any other voltage.** This does not apply to the vehicular charger.



WARNING! Shock hazard. Do not allow any liquid to get inside the charger. Electric shock may result.



CAUTION! Burn hazard. To reduce the risk of injury, charge only KIMO rechargeable battery packs. Other types of batteries may overheat and burst resulting in personal injury and property damage.

NOTE:

Under certain conditions, with the charger plugged into the power supply, the charger can be shorted by foreign material. Foreign materials of a conductive nature, such as, but not limited to, grinding dust, metal chips, steel wool, aluminum foil or any buildup of metallic particles should be kept away from the charger cavities. Always unplug the charger from the power supply when there is no battery pack in the cavity. Unplug the charger before attempting to clean.



WARNING! Never modify the power tool or any part of it. Damage or personal injury could result.

COMPONENTS AND SPECIFICATIONS

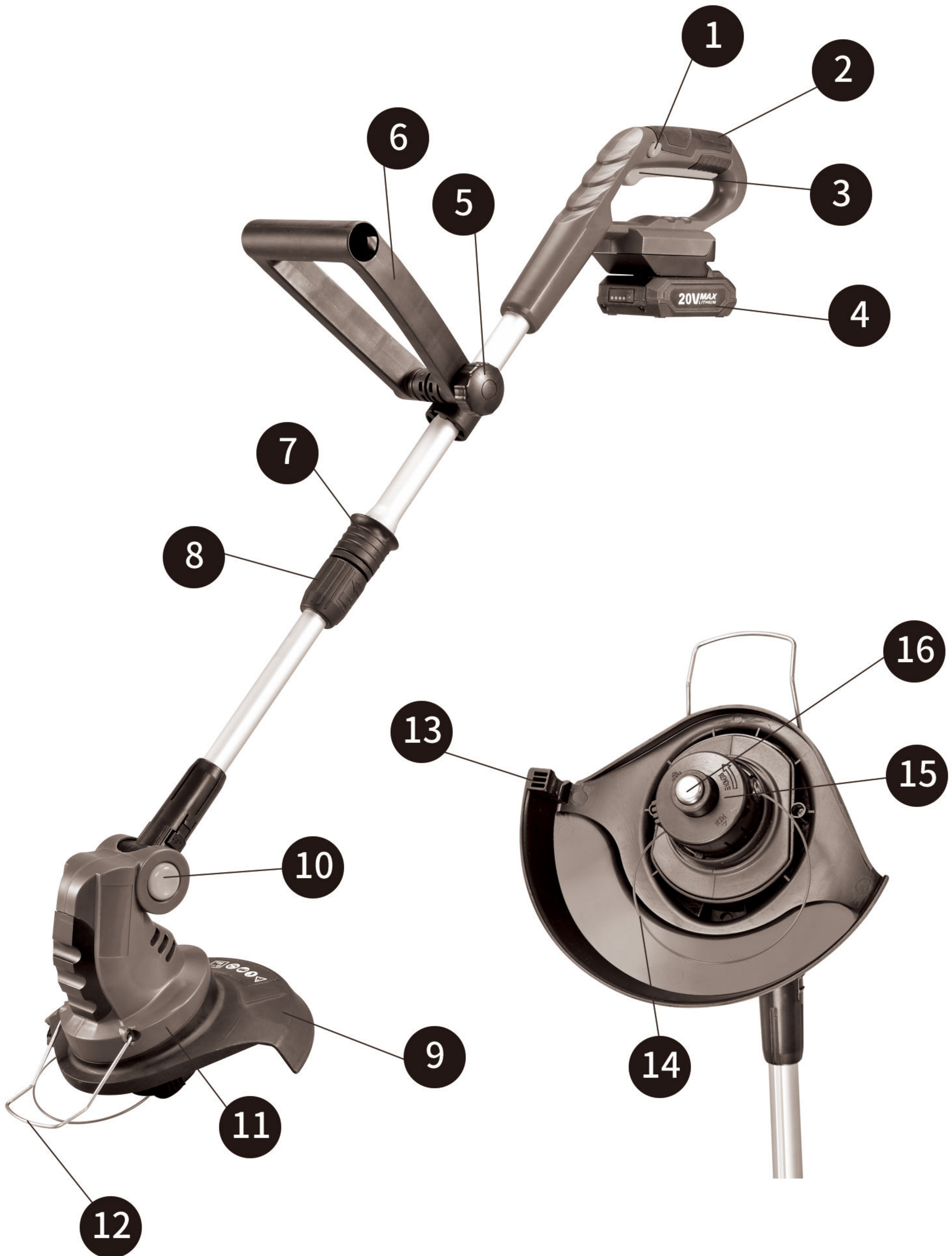

- | | |
|---|--|
| 1. Lock Off Button | 9. Protection Guard |
| 2. Operation Handle | 10. Locking Knob
(for the Cutting Head) |
| 3. On/Off Switch | |
| 4. Battery Pack | 11. Cutting Head |
| 5. Locking Knob
(for the Front Handle) | 12. Plant Guard |
| | 13. Line Blade |
| 6. Front Handle | 14. Cutting Line |
| 7. Locking Knob
(for the Operation Handle) | 15. Line Spool |
| | 16. Spool Button |
| 8. Telescopic Knob | |

Model	ET1610
Voltage	20V
Battery Specification	Li-ion, 2.0 Ah, 2000mAh
Input	100-240VAC 50-60Hz 15W
Output	21VDC 400mA
Motor Speed	0~20,000 RPM
Charging Time	90 Mins
No-Load Speed	8000/min
Cutting Width	9" (230mm)
Line Diameter	0.065"(1.6mm)

SPECIFIC INSTRUCTIONS

Installing and Removing the Battery Pack from the Tool

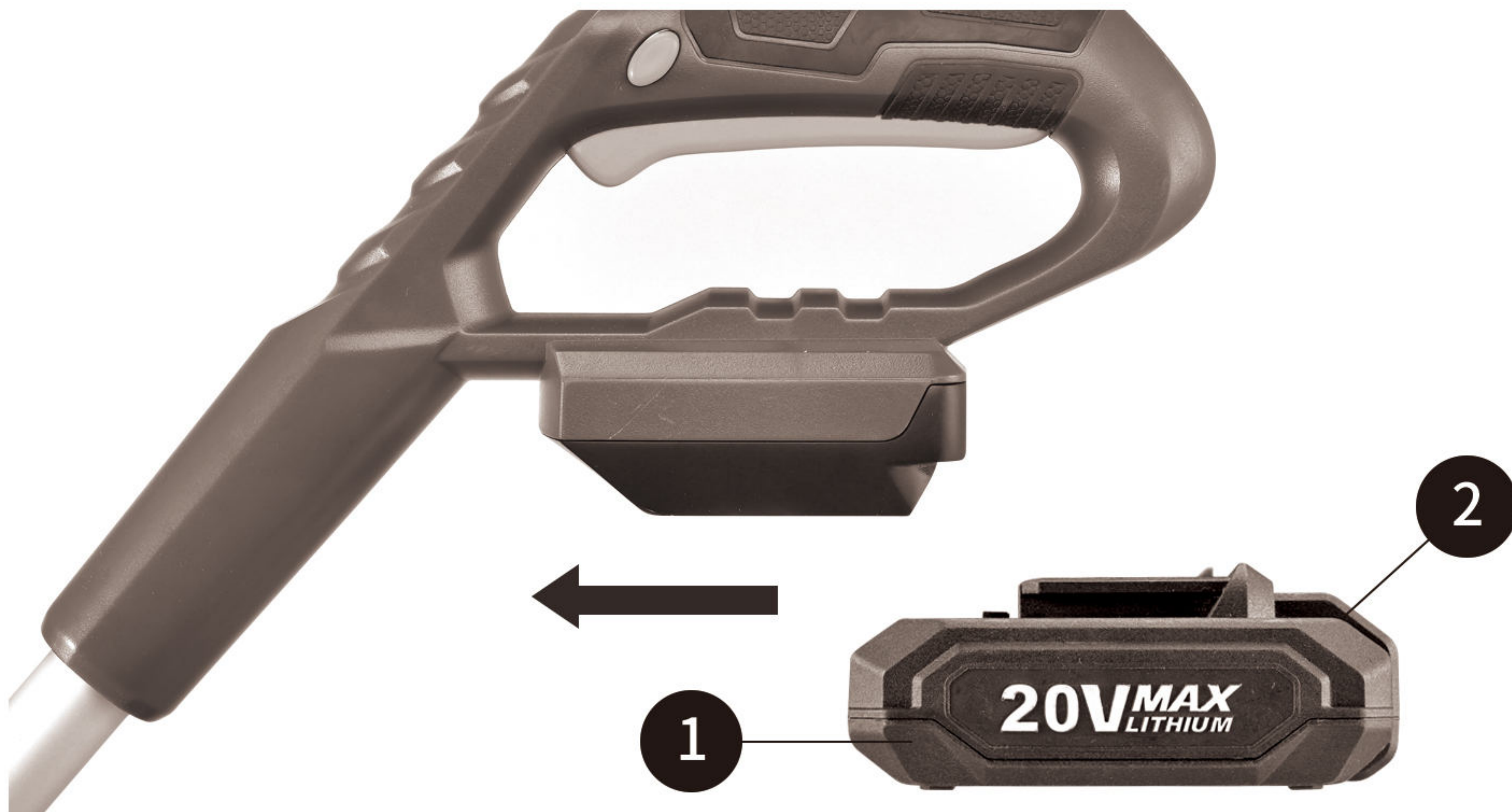

NOTE: For best results, make sure your battery pack is fully charged. (The image of battery shown here is indicative only. If there is inconsistency between the image and the actual product, the actual product shall govern.)

NOTE: Operating temperature of this tool is 19 ° to 104 °F (-7 ° to +40 °C). Using the tool outside of this temperature range will decrease the life of the tool.

To install the battery pack (①) into the tool handle, align the battery pack with the rails inside the tool's handle and slide it into the handle until the battery pack is firmly seated in the tool and ensure that it does not disengage.

To remove the battery pack from the tool, press the release button (②) and firmly pull the battery pack out of the tool handle. Insert it into the charger as described in the charger section of this manual.

Tool Assembly



CAUTION! Ensure the battery is removed before attaching or removing the tube. The tube must be attached to the housing before use.

Installing Guard



WARNING! To avoid injury, always remove the battery pack before installing the guard, changing a cutting line, or making any adjustments. If the guard is damaged, do not use the grass trimmer/edger until it is replaced.

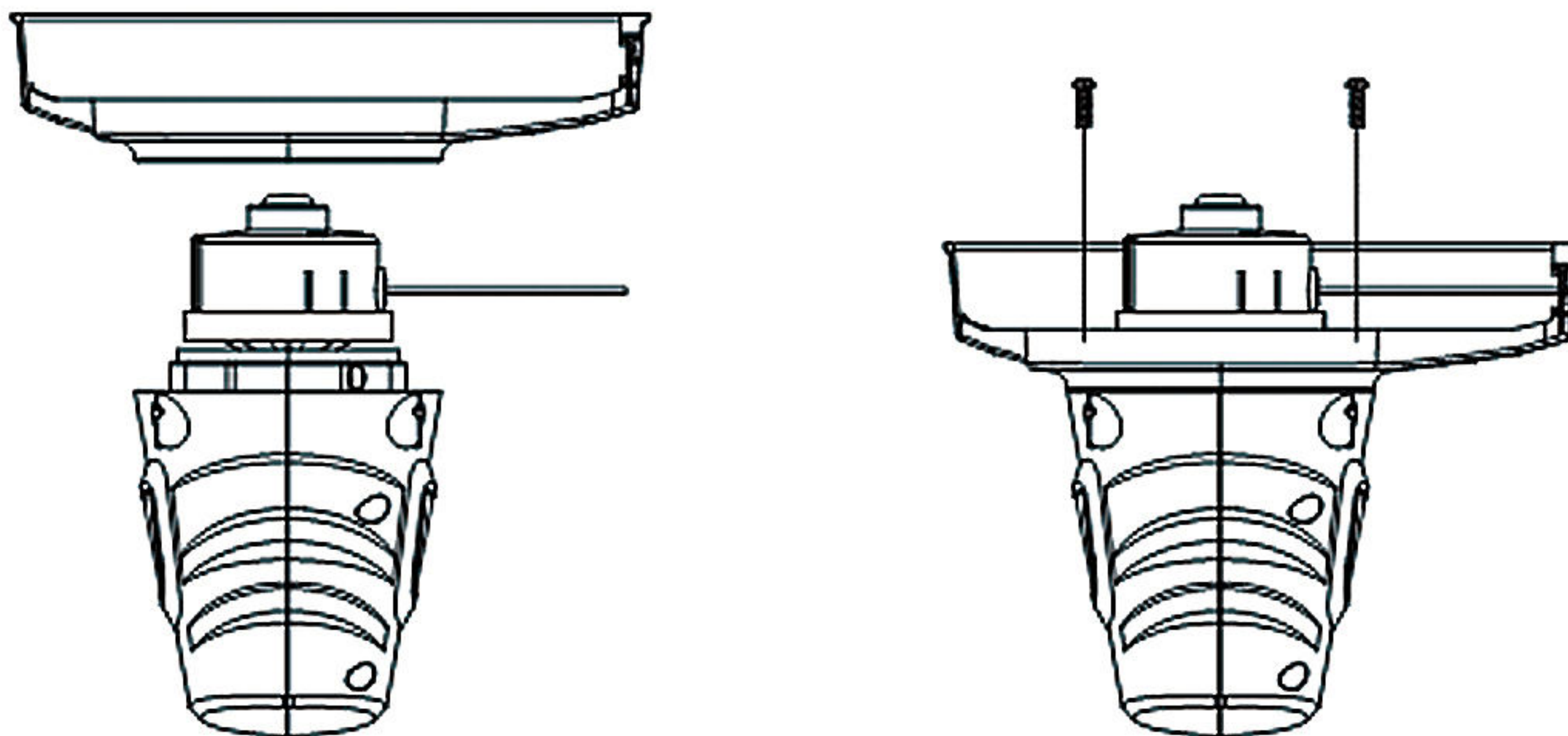

1. Remove the battery pack.
2. Remove two screws from the motor housing.
3. Reinstall two screws into the guard and tighten.



CAUTION! Remove the warning label before use. Take great care when ripping off the label as there is a sharp line blade(13) on the guard.



Installing Mounting Front Handle

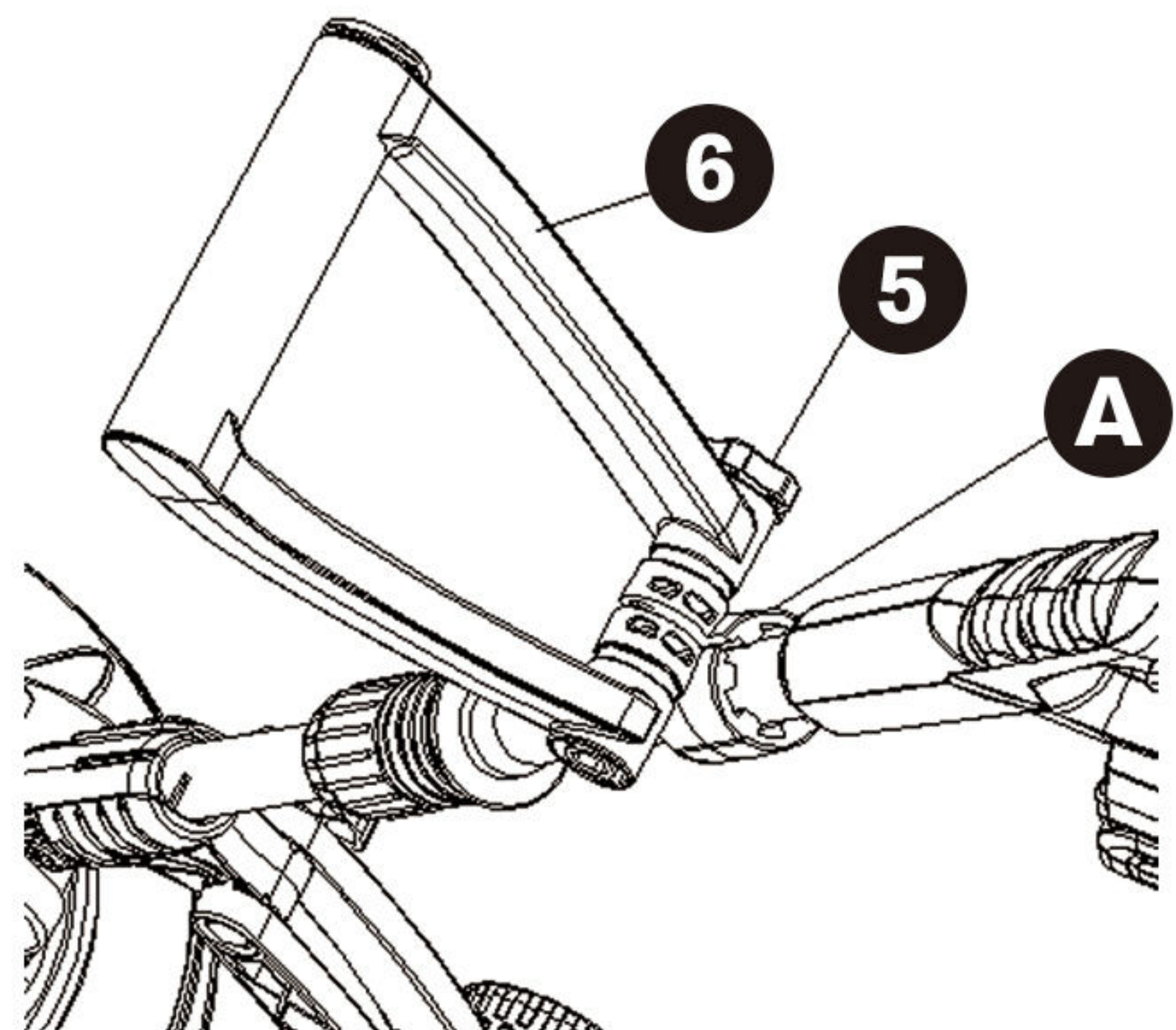
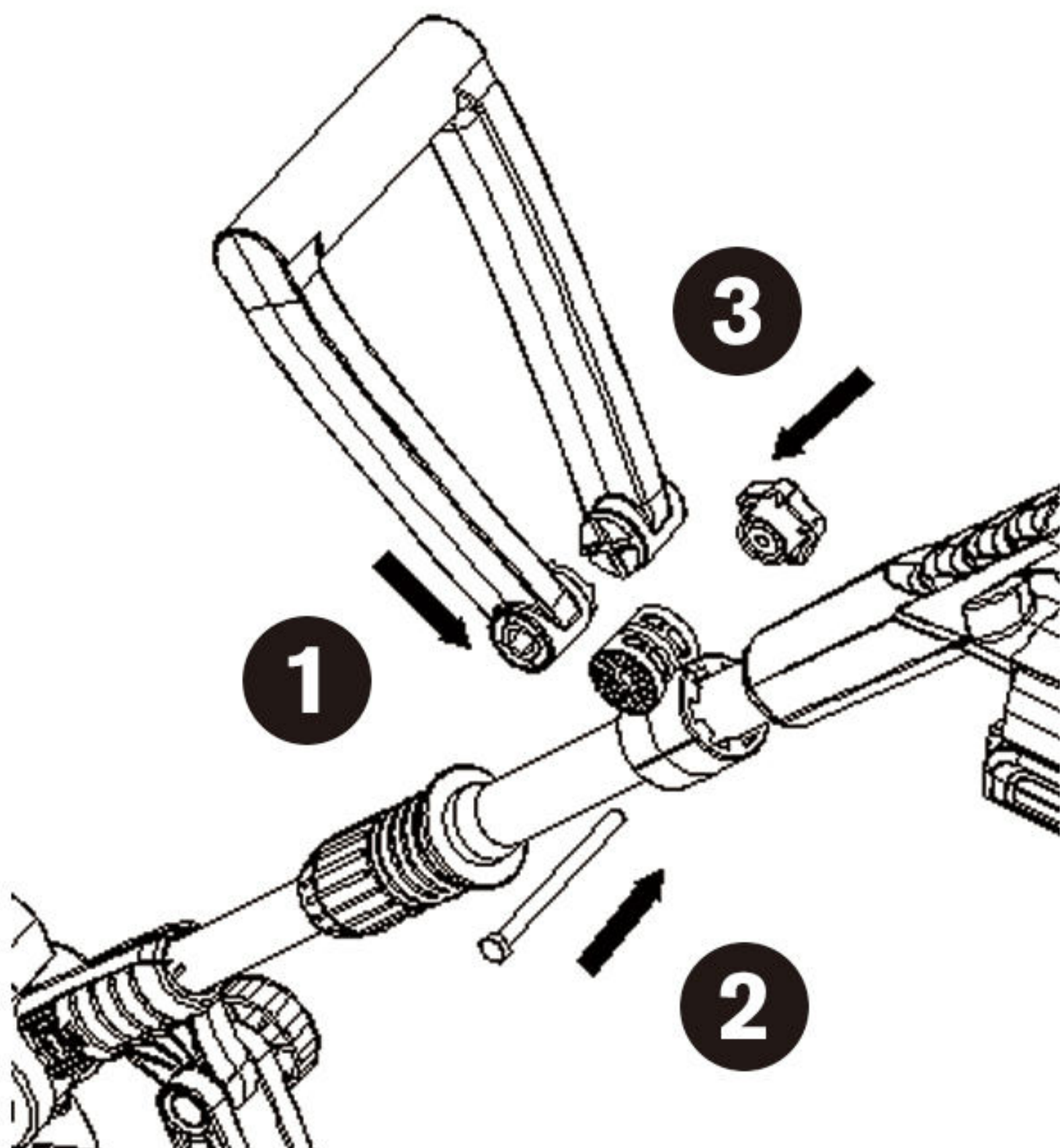

- 1.** Put the front handle (6) to the clamp (A) and align the mounting holes with holes on the clamp.
- 2.** insert the bolt through the mounting holes and tighten the locking knob (5)

Operation

Setting the Operation Length

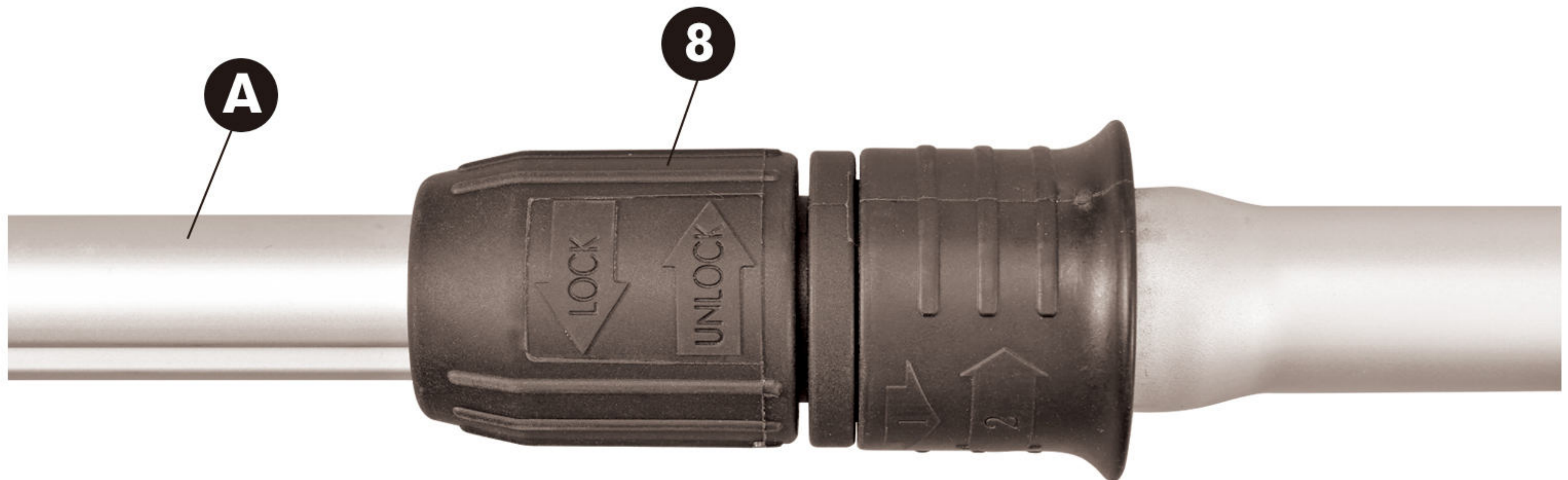

1. Turn the Telescopic Knob (8) aligning the “UNLOCK” direction.
2. Pull the telescopic pole (A) to the desired length.
3. Turn the Telescopic Knob (8) aligning the “LOCK” direction to lock the telescopic pole (A).

Setting the Angle of Operating Handle



1. Pull back the locking knob (7).
2. Rotate the operating handle clockwise 90°.
3. Release the locking Knob (7) and it will return to the original position automatically and lock the operating handle.

Setting the Position and Angle of Front Handle

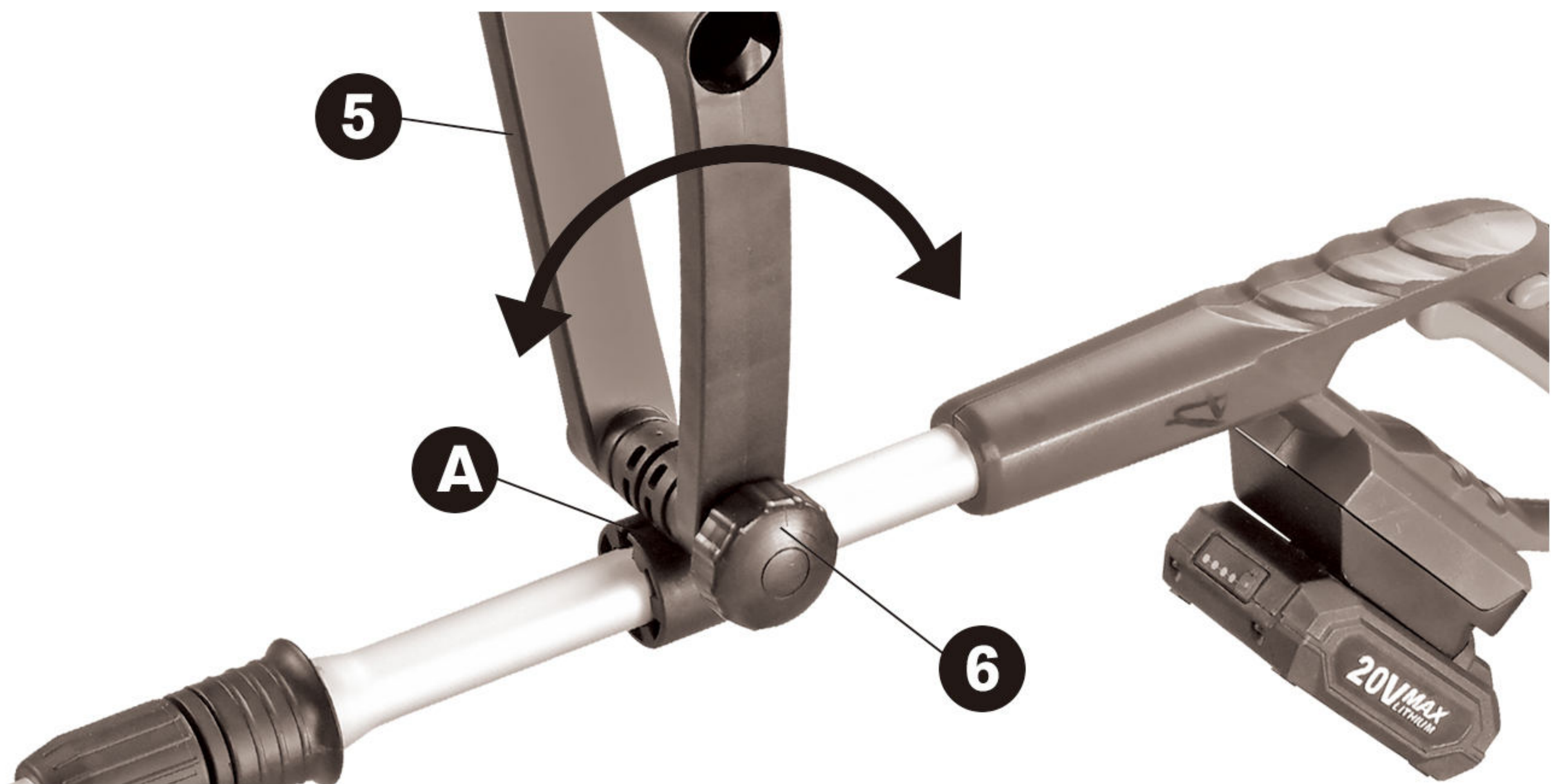

1. Open the locking knob (5)
2. Move the clamp (A) to the appropriate position.
3. Rotate the front handle (6) to the desired angle.
4. Re-tighten the locking knob (5).

Adjusting the Cutting Width



NOTE: Before starting the grass trimmer for the first time, check that the nylon line touches or passes over the wire cutting blade. If it is not long enough:

1. Remove the battery pack before adjusting the cutting width.
2. Press the spool button (16).
3. Pull more nylon wires to lengthen.

NOTE: During use, the nylon line will become shortened or worn. To automatically lengthen or advance the nylon cutting line, tap the spool button lightly on ground (while the unit is running).

Switch On/Off

To Switch On the Trimmer:

1. Press and hold the safety lock-off button (1) and then press the on/off switch (3) on the operating handle.
2. Release the safety lock-off button (1) again.

To Switch Off the Trimmer:

3. Release the on/off switch (3) on the handle.



WARNING! Always allow 5 seconds or more for the cutting linespool to stop rotating after releasing the trigger switch. Do not invert the grass trimmer, or place your hands under the protective guard until the grass trimmer spool has come to a complete stop.

Operating the Trimmer



WARNING! Always wear eye protection. Never lean over the trimmer head. Rocks or debris might be thrown into eyes and face and cause blindness or other serious injury.



1. Hold front handle with one hand and auxiliary handles with the other hand.
2. Keep the trimmer below waist level. Work only from your right to your left to ensure debris is thrown away from you.
3. Keep line near and parallel to the ground.
4. Let the trimmer run for a few seconds to cut the line.
5. Use the trimmer at an angle of approximately 15 degree to the working area.
6. Swing the trimmer head from side to side.



7. If the grass is very long, do not overload your trimmer. Take several small cuts, and this will keep machine operating at high speed and will greatly improve cutting efficiency.

Charging Procedure

KIMO chargers are designed to charge KIMO battery packs in 60~90 minutes depending on the pack being charged.

To charge the battery:

1. Insert/Slide the battery pack into the charger as shown as below.



2. Plug the charger into an appropriate outlet after inserting the battery pack.

Recharge discharged batteries as soon as possible after use or battery life may be greatly diminished. for longest battery life, do not discharge batteries fully. It is recommended that the batteries be recharged after each use.

NOTE: Battery packs for this tool are shipped in a low charge condition to prevent possible problems.





NOTE: A battery that is new or has not been used for a longer period does not develop its full capacity until after approx. 5 charge/discharge cycles.

Charger:

Red Indicator	Green Indicator	Battery Pack	Status
ON	OFF	Charging	Charging
OFF	ON	Charged	Charged
OFF	OFF	Short Circuited	Short Circuited

Fuel Gauge Battery Packs:

KIMO 20V battery pack includes a fuel gauge which consists of four LED lights that indicate the level of charge remaining in the battery pack. The fuel gauge is an indication of approximate levels of charge remaining in the battery pack according to the following indicators:

Remaining Capacity	Indicator Lights	
≤ 20%		Red Flashing
20% — 40%		Red On
40% — 60%		Red & Yellow On
60% — 80%		Red, Yellow & Green On
80% — 100%		All Lights On



IMPORTANT SAFETY INSTRUCTIONS FOR BATTERY CARTRIDGE

- 1. If operating time has become excessively shorter, stop operating immediately. It may result in a risk of overheating, possible burns and even an explosion.**
- 2. Do not short the battery cartridge:**
 - (1) Do not touch the terminals with any conductive material.
 - (2) Avoid storing battery cartridge in a container with other metal objects such as nails, coins, etc.
 - (3) Do not expose battery cartridge to water or rain.

A battery short can cause a large current flow, overheating, possible burns and even a breakdown.
- 3. Do not incinerate the battery cartridge even if it is severely damaged or is completely worn out. The battery cartridge can explode in a fire.**
- 4. Be careful not to drop or strike battery.**
- 5. Follow your local regulations relating to disposal of battery.**

TROUBLE SHOOTING

Problems	Probable Causes	Solutions
Tool does not turn on	<ul style="list-style-type: none"> ● The battery is low or not charged. ● The battery is damaged. ● The battery terminals are dirty. ● Damaged internal electronics. ● The motor is damaged. 	<ul style="list-style-type: none"> ● Charge the battery. ● Replace the battery. ● Clean the battery terminals. ● Contact us directly for replacement or refund.
Tool does not cut	<ul style="list-style-type: none"> ● Line broken. ● The battery is not fully charged. ● Grass entangled around the cutting head. 	<ul style="list-style-type: none"> ● Replace the line. ● Recharge the battery. ● Remove grass. Be careful and turn off the tool first!
Excessive vibration	<ul style="list-style-type: none"> ● Tool defective. ● Line spool is not wound well. 	<ul style="list-style-type: none"> ● Contact us directly for replacement of refund. ● Wind the line as shown on "Refill the Line".
Cutting time per battery charge too short	<ul style="list-style-type: none"> ● The battery has not been used for long period or only charge for short term. ● Grass too high. ● The battery defective. 	<ul style="list-style-type: none"> ● Recharge the battery. ● Cut in stages. ● Replace the battery.
No Charging procedure possible	<ul style="list-style-type: none"> ● The battery defective. ● The battery contacts contaminated. ● The battery is not properly inserted. 	<ul style="list-style-type: none"> ● Replace the battery. ● Clean the battery contacts. ● Properly insert the battery into the charger as shown in the above instructions.
Battery charger indicator does not light up.	<ul style="list-style-type: none"> ● The charger is not properly plugged in. ● Socket outlet, cable or battery charger defective. 	<ul style="list-style-type: none"> ● Insert the charger fully into the socket. ● Check the main voltage; have the battery charger checked by an authorized electrician.

MAINTENANCE

Replace the Spool



WARNING! Before replacing the spool, always switch off the machine and take off the battery pack.

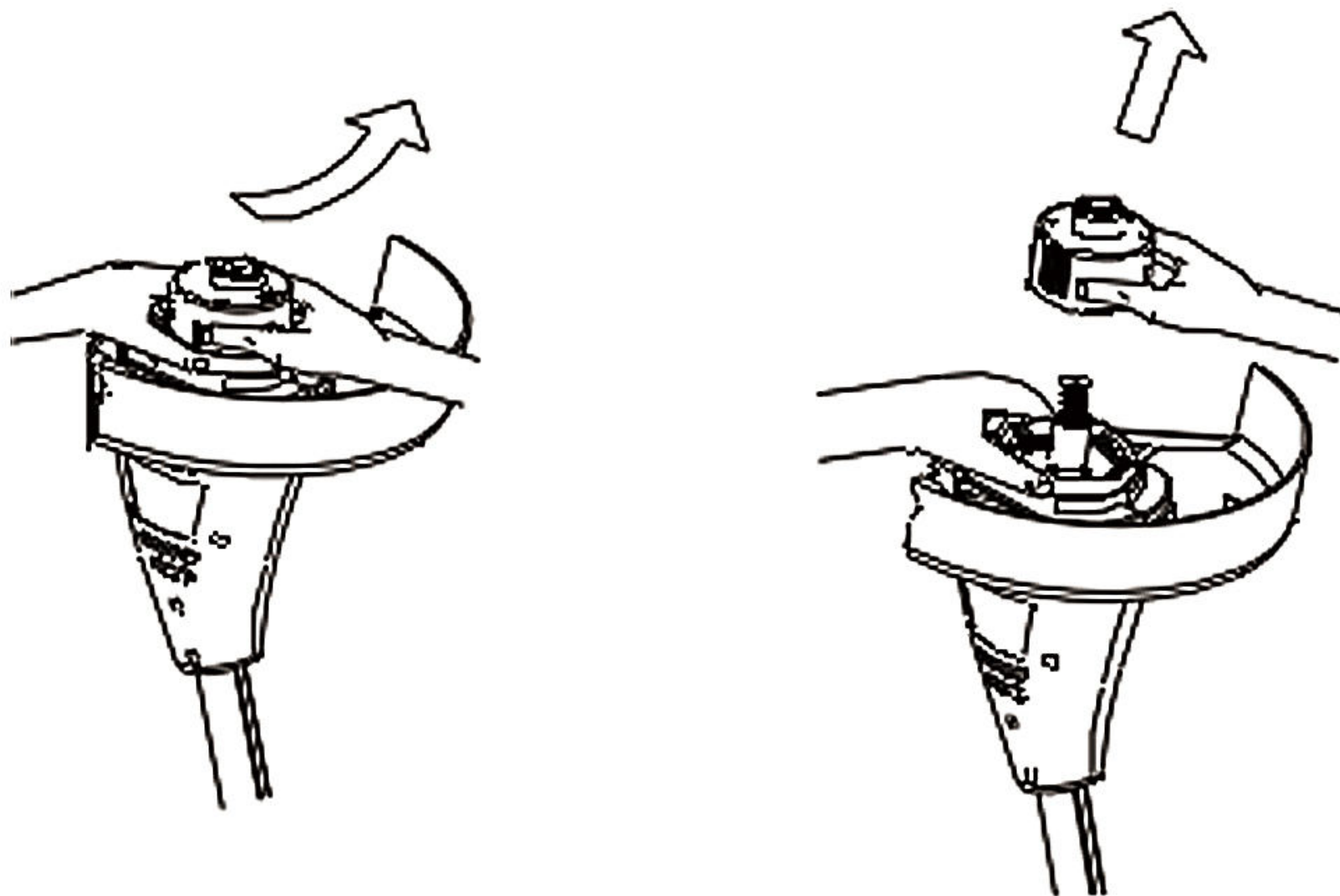

- 1.** To remove the spool, hold the outer ribbed part with one hand, while pushing down and turning the spool head with the other to unlock it. The spool carrier and spool will now disassemble easily.

NOTE: There is a spring inside the head that could easily be lost. Be careful when disassemble.

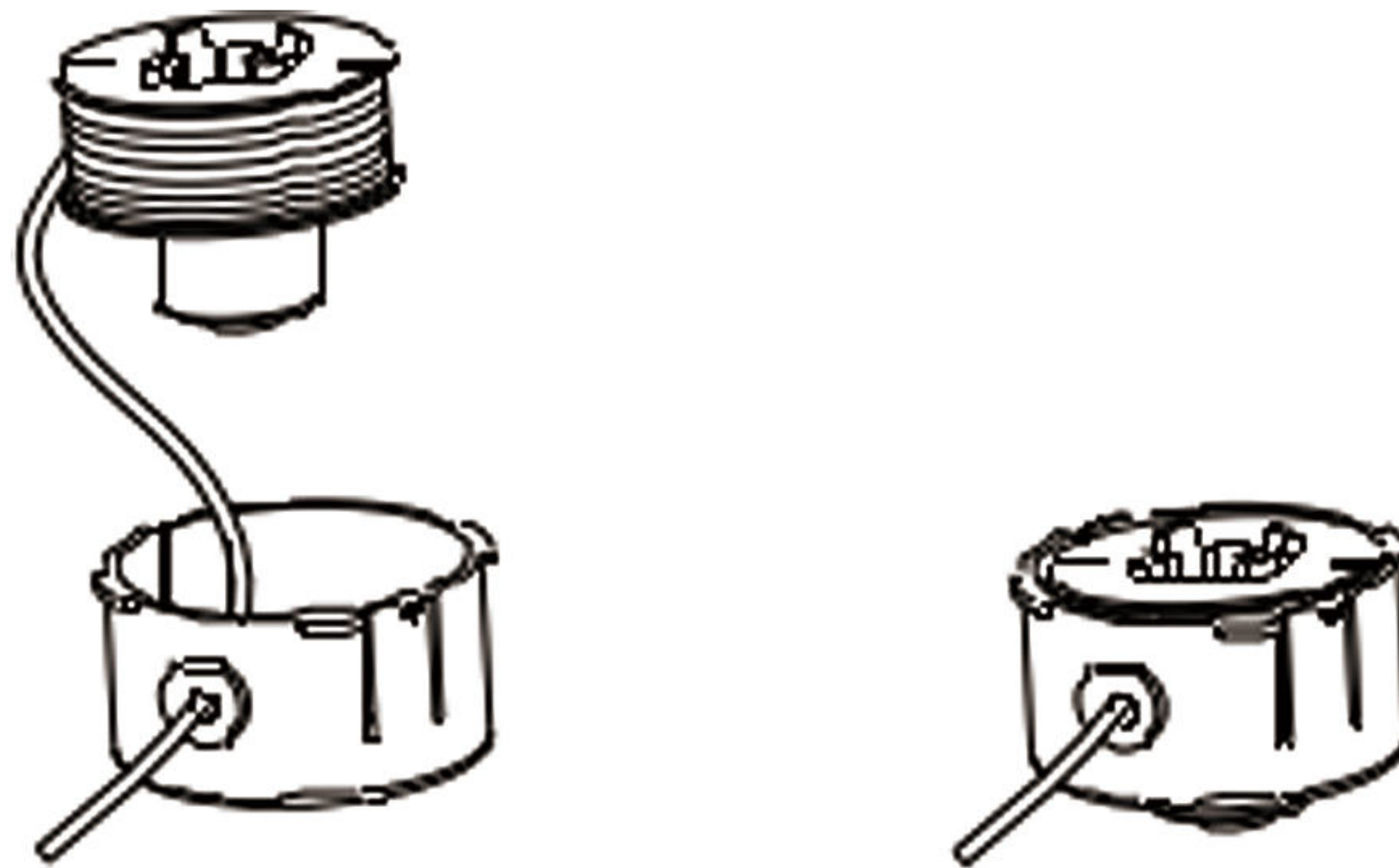

- 2.** Insert the line through the eyelet in the spool carrier and slide the spool into it.

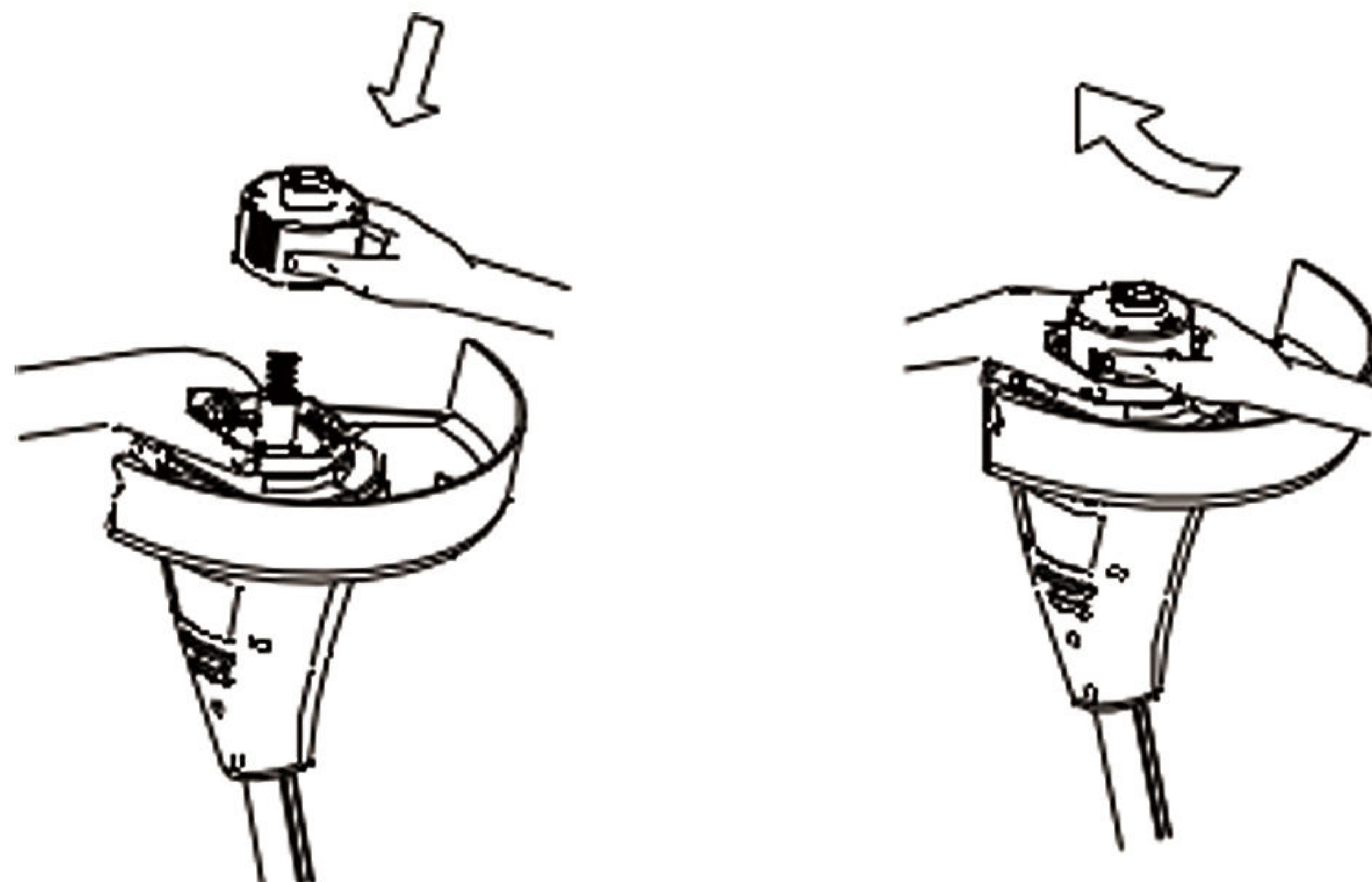

- 3.** Insert the spring, assemble the spool and spool carrier back onto the trimmer. Then push the head on and turn it clockwise until it locks.
- 4.** To test if the line is advancing properly, push down the spool button with your thumbs while pulling the line. The line should advance freely.

Refill the Line

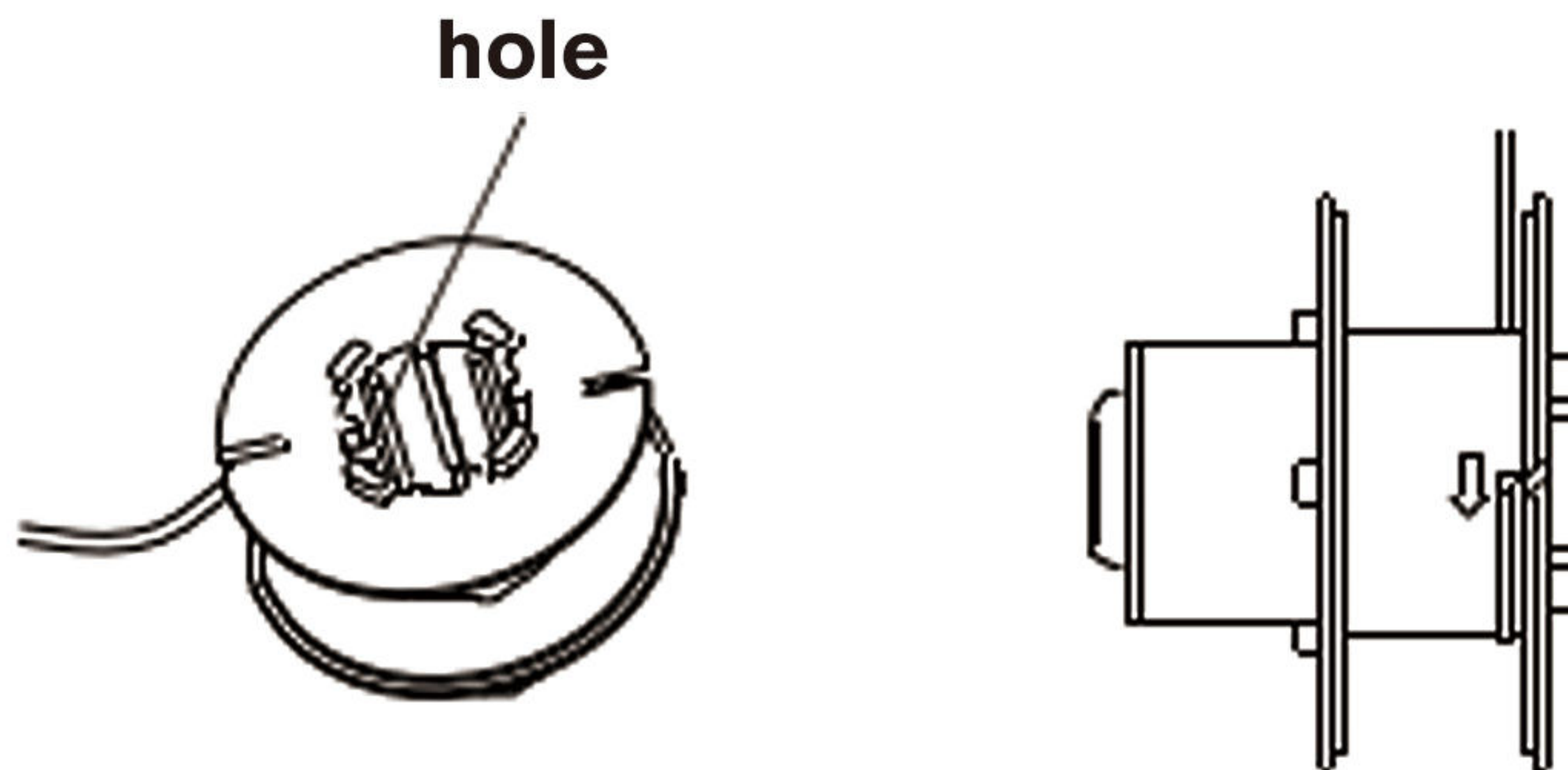

1. Insert one end of line into the hole in the spool as shown above.
2. Snugly and evenly wind the line onto the spool in the direction of the arrow on the spool, until the line builds up to the notches in the spool rim.

NOTE: Do not overfill spool. The spool holds about 21.3 ft of line.

Clean and Storage

1. Remove the battery pack after use;
2. Store the tool out of the reach of children when not in use;
3. Use only damp cloth to clean the tool, and do not let any liquid get inside.

WARRANTY

Every KIMO power tool is warranted to the original purchaser only to be free from defects in material and workmanship. Subject to certain exceptions, KIMO will replace any part on an electric power tool that is defective in material or workmanship for a period of 2 years after the date of purchase unless otherwise noted. This warranty does not apply to damage from repairs made or attempted by anyone other than KIMO, misuse, alterations, abuse, normal wear and tear, lack of maintenance, or accidents.

Normal Wear: Many power tools need periodic parts replacement and service to achieve best performance. This warranty does not cover repair when normal use has exhausted the life of a part including, but not limited to, chucks, brushes, cords, saw shoes, blade clamps, o-rings, seals and driver blades.

Warranty Registration is not necessary to obtain the applicable warranty on a KIMO power tool product.

This warranty applies to product sold in the U.S.A. only.

EXTENDED WARRANTY REGISTRATION

Dear Customer,

Thank you very much for choosing KIMO. At KIMO, customer satisfaction is our highest priority. In order to provide the best services, we would like to offer you an extra 6-month limited warranty. Below is the free registration process.

To register our extended warranty for your KIMO product, please send your name, your email AND your Amazon order number to **Service@kimotools.com**. Our customer services representative will help you register within 24 hours.

Disclaimer: This policy is at the manufacturer's discretion.

Best Regards,
KIMO Customer Support