



MODEL TS1914

TAV-LINK™ MULTI-SENSOR

Multi-Sensor contains both an infrared remote sensor and a passive infrared motion sensor.

OVERVIEW

The TAV-Link Multi-sensor detects IR remote control signals and motion. It features an intelligent logic algorithm that first considers IR remote signals and then looks for both IR remote signals and motion. If no IR remote control activity or motion is detected within the countdown timer period, the AV APS+ powers down the TV and peripheral AV electronics plugged into the switched outlets.

KEY FEATURES

- LED notification that flashes when IR activity or motion is detected
- Continuous dual-color (red/blue) flashing LED alert notification that activates ten minutes prior to shutdown
- Optional soft-chirping piezo buzzer that alerts user of a pending shutdown ten minutes and three minutes prior to shutdown
- Manual on/off button
- Supports high-level CEC commands via optional TAV-Link cable that allow “smart” TVs to safely store their data and settings prior to powering down
- TAV-Link functionality that allows gaming consoles to enter an energy-saving mode earlier and without any corruption of data
- Selectable countdown timer 30/60/120 minutes for IR + motion and 60/120 minutes for IR sensing

APPLICATION DIAGRAM (4 OUTLET ADVANCED POWER TAP)

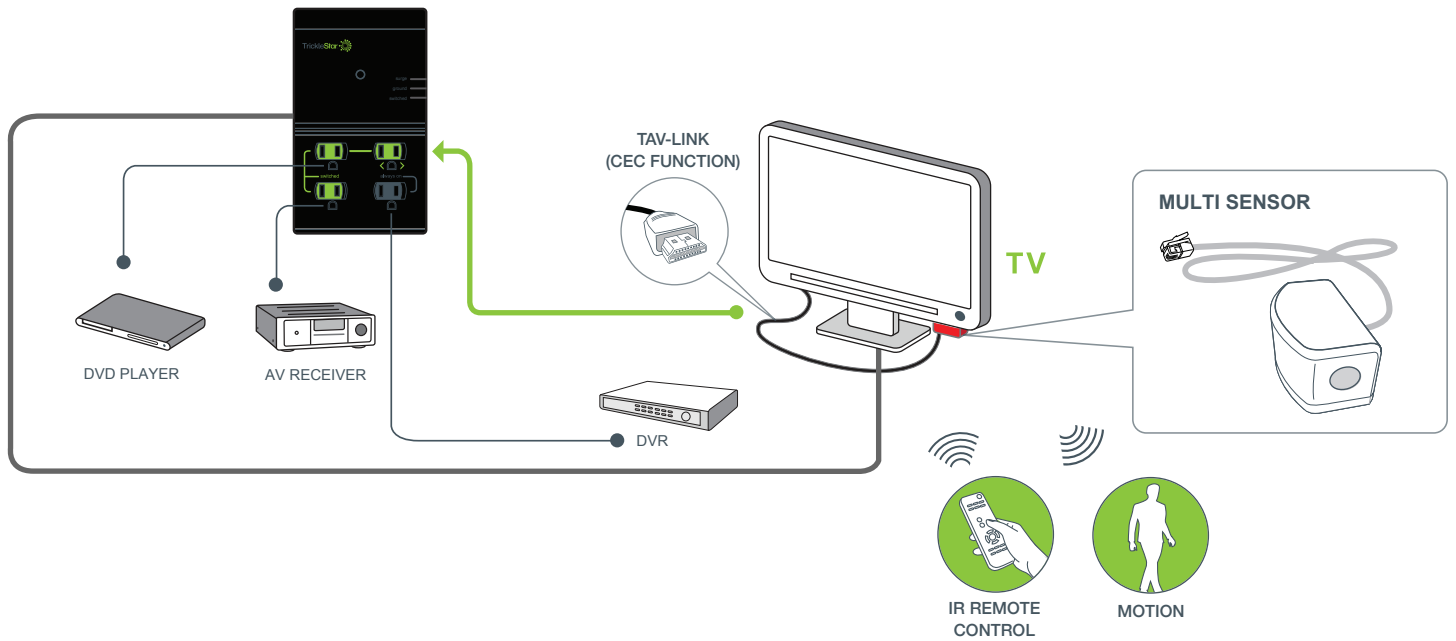

APPLICATION DIAGRAM (7 OUTLET ADVANCED POWER STRIP)

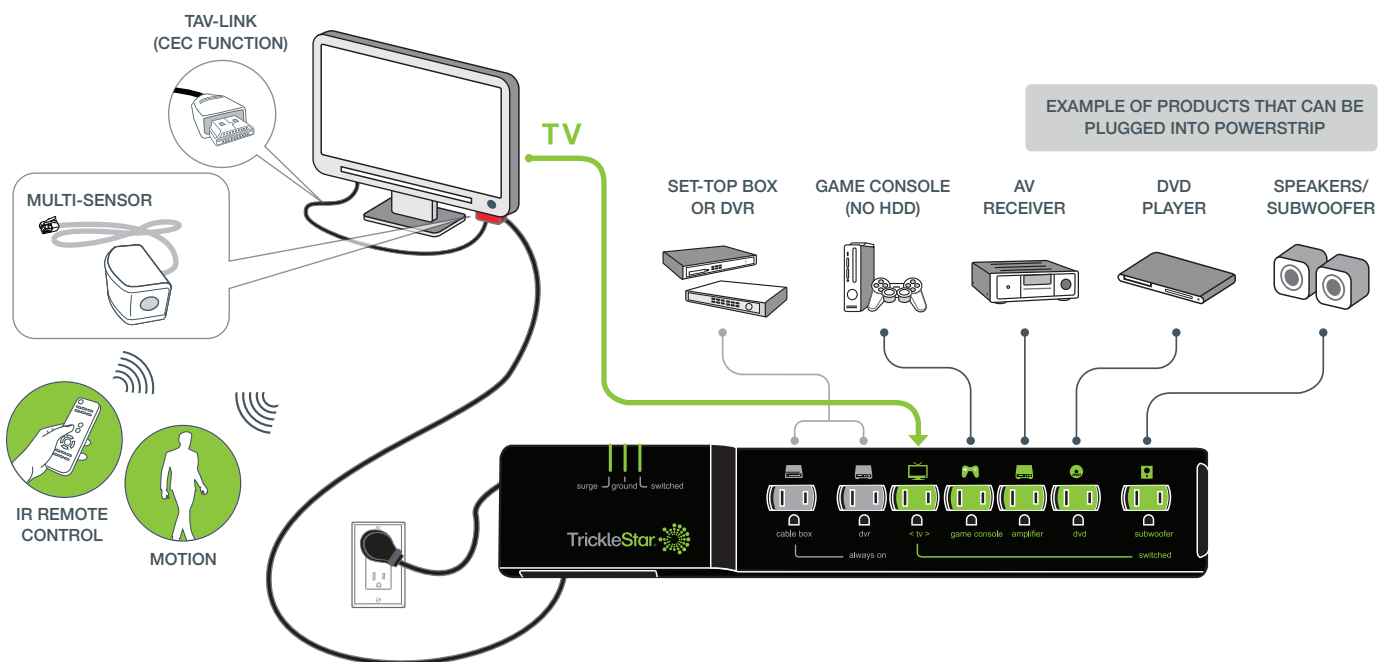

APPLICATION DIAGRAM (12 OUTLET ADVANCED POWERSTRIP)

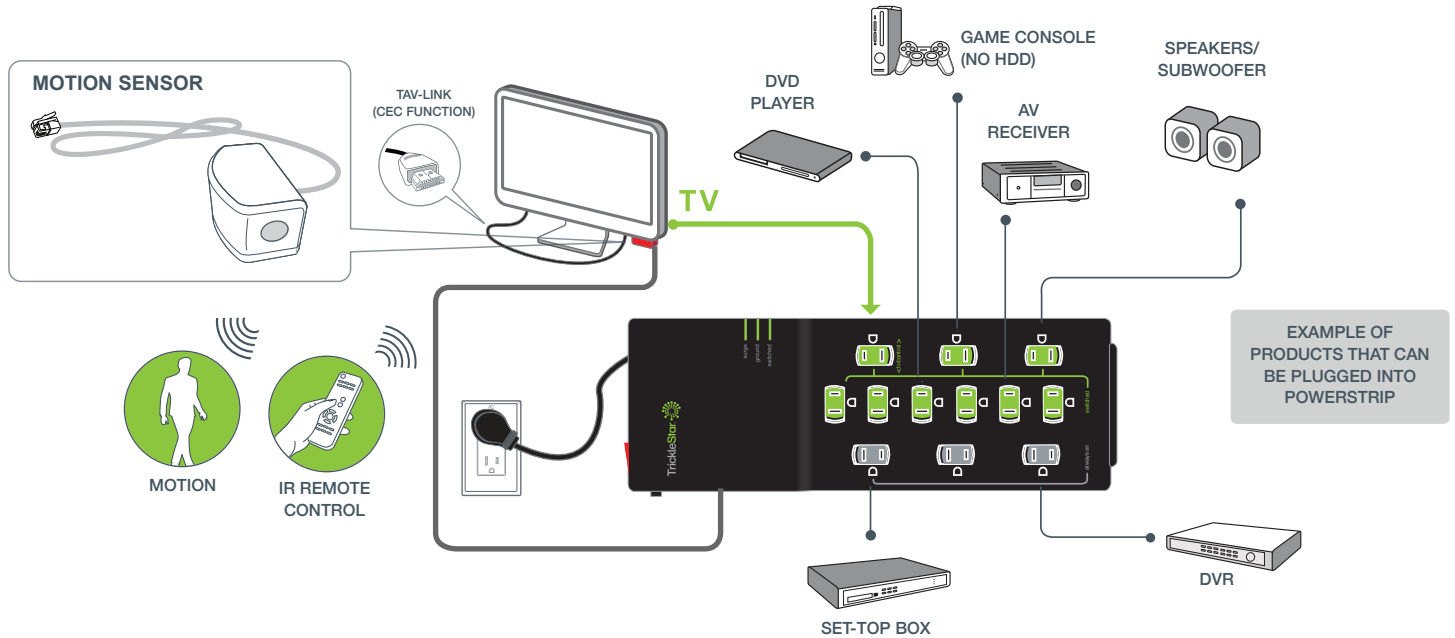

ELECTRICAL SPECIFICATIONS

TAV-LINK™ MULTI SENSOR

FOR INDOOR USE

Voltage	3.3 VDC
IR Detection Range	Up to 16.4 ft
IR Detection Angle	60°
Cord Length	8 ft
Movement Detection Range	Up to 16.4 ft.
Movement Detection Angle	90°

PIR & IR DETECTION PATTERN

SENSOR OPTICAL VIEW PATTERN

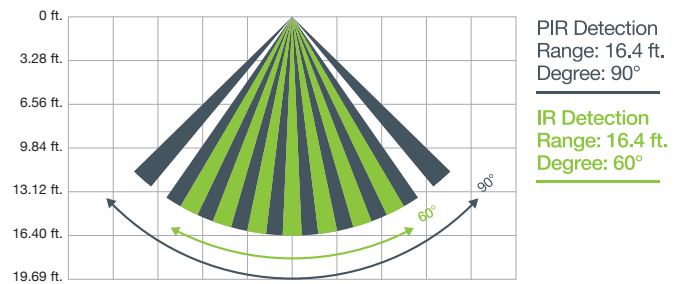

ORDERING INFORMATION

TS1914 TAV Link™ Multi-sensor,
8 ft. Cord

* TAV Link cable is not included