



# FDV451

FREE STANDING **DIRECT VENT** GAS STOVE



THE ULTIMATE IN DESIGN, ENGINEERING & QUALITY

Model FDV451N Free Standing Direct Vent Gas Stove (Natural Gas), F450FBL Door Front (Charcoal with Flat Black Posts), F451SDSBL Side Doors with Flat Black Frame and Charcoal Solid Panel, LOGF451 Oak Log Set, F451RLT Traditional Brick Liner, F45FK Fan Kit.



# FDV451

FREE STANDING DIRECT VENT GAS STOVE

## A SAFE AND EFFICIENT HEATING APPLIANCE WITH THE CONVENIENCE OF GAS

<b>Model</b>	FDV451N / NE2	FDV451LP / LPE2
<b>Gas Control</b>	Millivolt / IPI	Millivolt / IPI
<b>Fuel</b>	Natural	Propane
<b>Input Low</b>	34,500 BTU	31,000 BTU
<b>Input High</b>	23,750 BTU	24,500 BTU
<b>FE (P.4.1-15)</b>	65.89% / 67.72%	72.14% / 74.06%



Model FDV451N Free Standing Direct Vent Gas Stove (Natural Gas), F450FBL Door Front (Charcoal with Black Posts), F451SDSBL Side Doors with Black Frame and Charcoal Solid Panel, Z5GC Bronze Glass (x3), F45LG Log Grate, F451PL Reflective Porcelain Liner, F45FK Fan Kit.

### STANDARD FEATURES\*

- Millivolt or IPI valve system allows operation during a power failure with Hi-Low heat and flame adjustment
- Proflame II Models include Remote Control – Features flame, fan, thermostat, and smart thermostat (FDV451NE2, FDV451LPE2 Models only).
- Dual burner system, with Realistic Flame Pattern
- Heat radiating ceramic glass
- Mobile home approved – (Direct Vent Model Only)
- Approved for installation in a bedroom or bed sitting room
- Safety Screen Barrier



Safety Screen Barrier

### OPTIONAL FEATURES

#### Fan Kit

Heat activated with variable speed control

#### Front Color Choices

Charcoal with Accent colors of Flat Black or Stainless Steel

#### Side Panels

Charcoal Panels with Trim colors of Flat Black or Stainless Steel

#### Log Sets

Oak

#### Brick Refractory Liner

Traditional or Herringbone

#### Reflective Porcelain Liner

#### Media Types

Bronze Glass or Cannonballs

#### Thermostat

Wall Mount Millivolt Thermostat or Programmable Thermostat



PF2



PF1 or MV



PF1 or MV

#### Remote Control

On/Off, Thermostat On/Off, Thermostat On/Off modulating, Thermostat On/Off modulating and fan control

#### B-Vent Adapter

Convert Stove to 4" B-Vent



THE ULTIMATE IN DESIGN, ENGINEERING & QUALITY

The FDV451 Direct Vent Model provides sealed combustion where it draws outside air for combustion. This model can be vented either horizontally or vertically.



Unit illustrated is a FDV451N Free Standing Direct Vent Gas Stove (Natural Gas), F450FBL Door Front (Charcoal with Black Posts), F451SDSBL Side Doors with Black Frame and Charcoal Solid Panel, Z5GC Bronze Glass (x3), RBCB1 Cannonballs, F45LG Log Grate, F45FK Fan Kit.



Stainless Steel and Flat Black Vent Lid

### SIZING AND DIMENSIONS

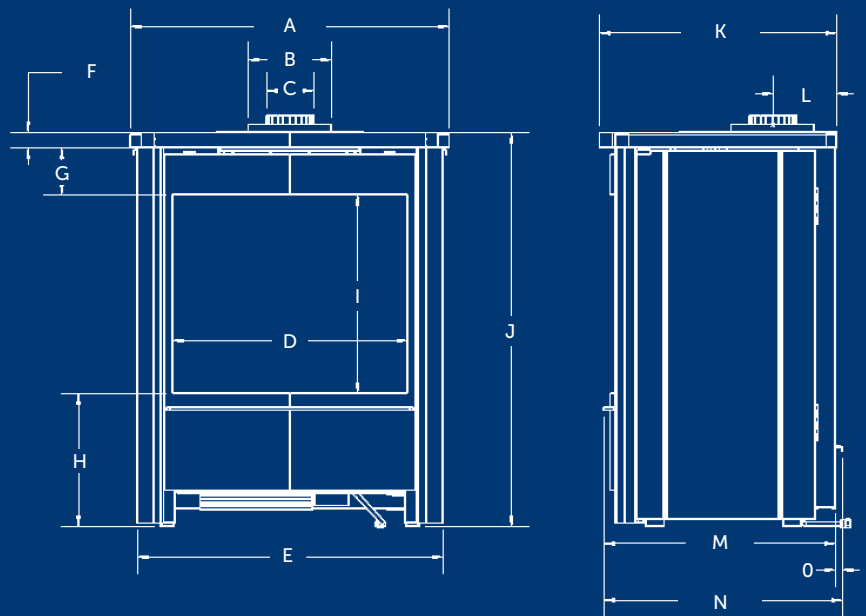

A	27 1/8"	I	16 15/16"
B	7"	J	33 1/2"
C	4"	K	20 1/8"
D	20"	L	5 3/8"
E	26"	M	19 3/4"
F	1 1/4"	N	20 5/16"
G	4"	O	9/16"
H	11 5/16"	P	20 5/8"

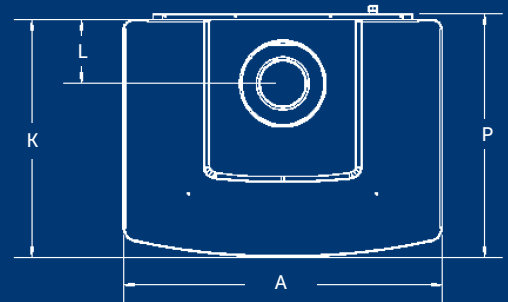

### STYLING

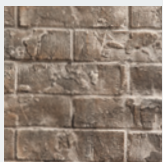

Traditional  
Brick Liner RLT

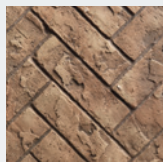

Herringbone  
Brick Liner RLH

### MINIMUM CLEARANCES TO COMBUSTIBLES:

36" from front of unit  
15 1/2" from side of unit  
2 1/2" from back of unit

### ALCOVE INSTALLATION:

48" depth (max.)  
71 1/2" height (min.)  
58" width (min.)



2340 Logan Avenue  
Winnipeg, Manitoba, Canada R2R 2V3  
Phone: (204) 632-1962 Fax: (204) 632-1960  
[www.kingsmanfireplaces.com](http://www.kingsmanfireplaces.com)

# FDV451

FREE STANDING DIRECT VENT GAS STOVE



Model FDV451N Free Standing Direct Vent Gas Stove (Natural Gas), F450FSS Door Front (Charcoal with Stainless Steel Posts), F451SDSSS Side Doors with Stainless Frame and Charcoal Solid Panel, LOGF451 Oak Log Set, F451RLT Traditional Brick Liner, F45FK Fan Kit.

Canada  
**ENERGUIDE**  
Look for the **EnerGuide**  
Gas Fireplace Energy  
Efficiency Rating in this brochure  
Based on CSA P.4.1-15



\*Components may have to be ordered separately to create a complete unit. Discuss with your local Kingsman dealer for clarification.  
Kingsman Industries maintains a program of continuous testing, refinement and improvements of all its products. Some aspect of units shown here may be changed at any time without notice or obligation. Certified for USA and Canada to: ANSI Z21.88-2017 / CSA 2.33-2017, CSA 2.17-2017 as a Vented Gas Fireplace Heater.



CRAFTED ENTIRELY IN CANADA, EACH KINGSMAN FIREPLACE IS BUILT TO THE HIGHEST STANDARDS AND MADE TO LAST.

Printed in Canada  
09/2020 – B087



**FOR CALIFORNIA RESIDENTS ONLY:**  
**WARNING!** This product can expose you to chemicals including Carbon Monoxide, that is an externally vented by-product of fuel consumption, which is [are] known to the State of California to cause birth defects or other reproductive harm. For more information, visit [www.P65Warnings.ca.gov](http://www.P65Warnings.ca.gov).