



OFF-ROAD

JKGM

G'DAY LEGEND !

At JKSM OFFROAD, we're not just passionate about all things automotive, we're downright obsessed! From cars to trucks and bikes, we live and breathe everything that's got wheels and an engine. But, let us tell you, there's nothing quite like the rush of hitting the trails and exploring the great outdoors.

We know how important it is to have gear you can rely on when you're off the beaten path. That's why we're dedicated to providing the off-road community with top-quality products that not only perform great but also look amazing on your rig.

Ready to join us on this incredible off-road adventure?
Let's hit the road and get muddy!

THANK YOU

Everyones experience is different, and we are all about improving and growing. Leave a review or get in contact with us and let us know how we can do just that.



+ 61 481 197 540



info@jksm.com.au



34° 54' 42.372" S
138° 33' 57.24" E

WINDOW SIDE MOUNT

JEEP WRANGLER JL

The JKSM Window Mount is a multipurpose mounting solution for the side of your vehicle. The slot pattern on the side allows you the freedom to attach whatever you may need for your off-road adventure, as well as specific mounting support for the RotopaX fuel and water containers, and the MAXTRAX minis.

JKSM



01 INSTALL

Allow a professional to assemble and install this product correctly. Damage to the body could occur if not installed properly.

02 PROTECT

If you are worried about scratching the paint on the car during install, put some automotive tape down.

03 CHECK

Before every adventure, double check everything is secure and all bolts are tightened.

000 ASSEMBLY

Ensure you have all the parts listed on the previous page. It's advised that any mounts for RotopaX, MAXTRAX, or anything else you plan on installing on the Window Mount should be installed prior to assembly.

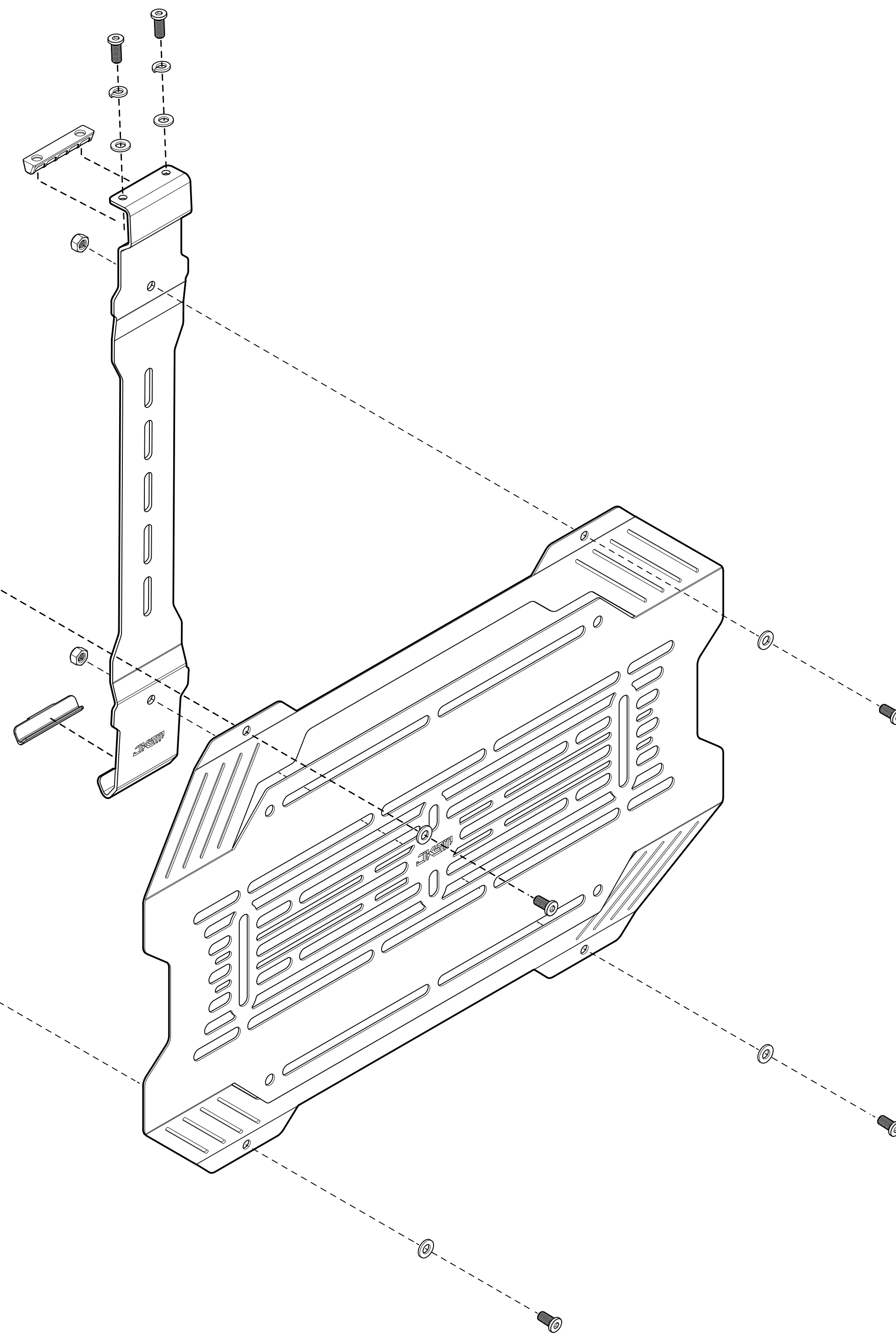
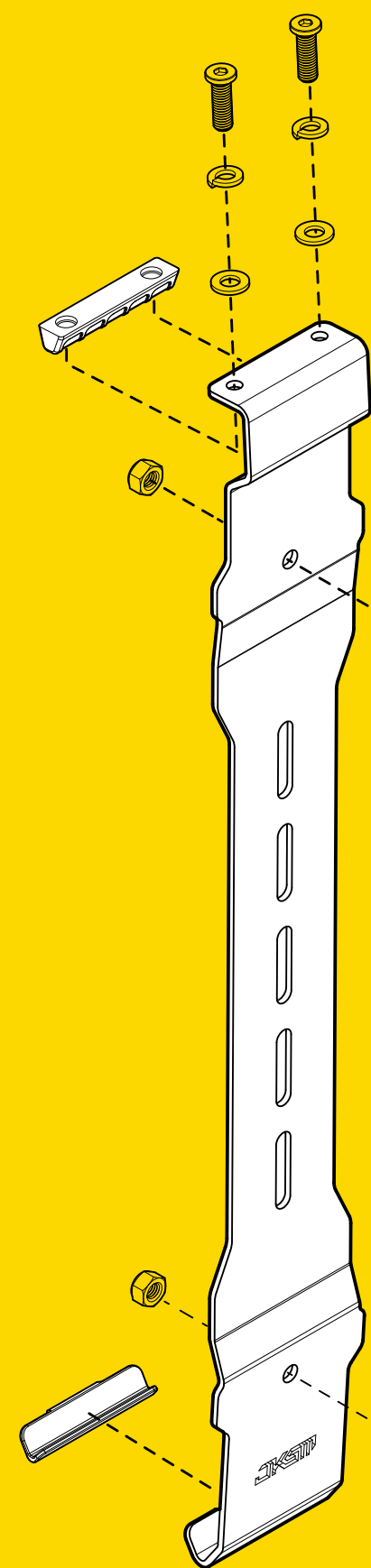

PARTS LIST

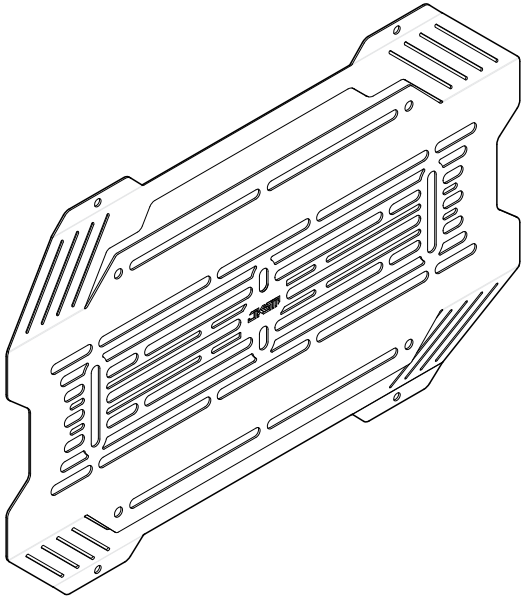

x1 Window Side Mount

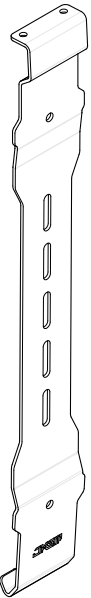

x2 Window Side Rail

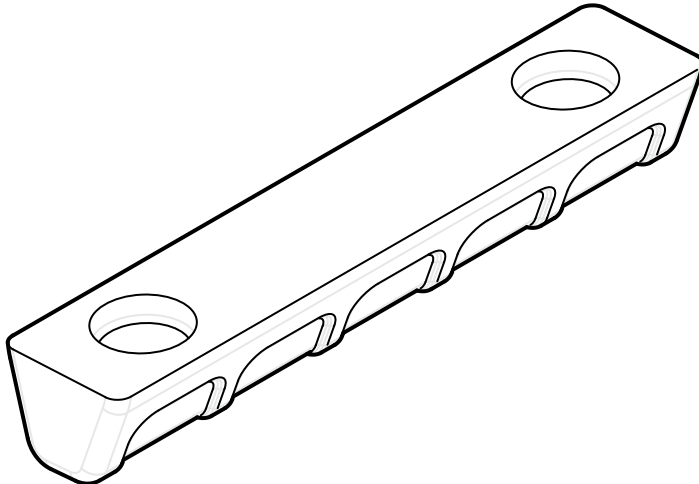

x2 Clamping Pads

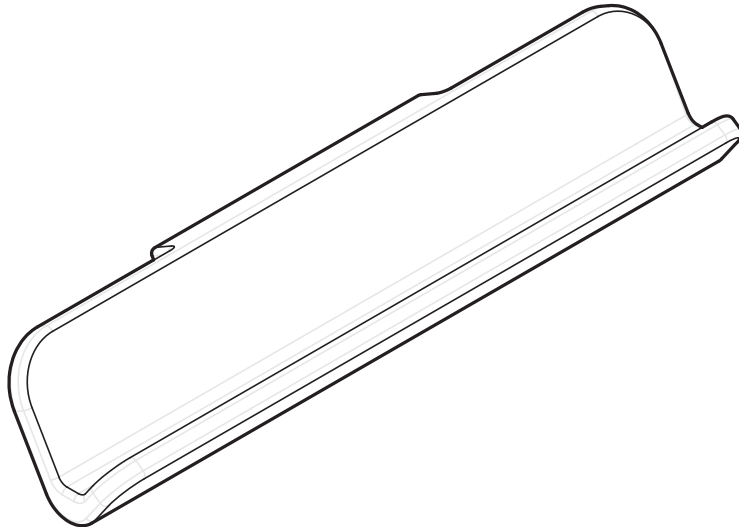

x2 Hook Pads

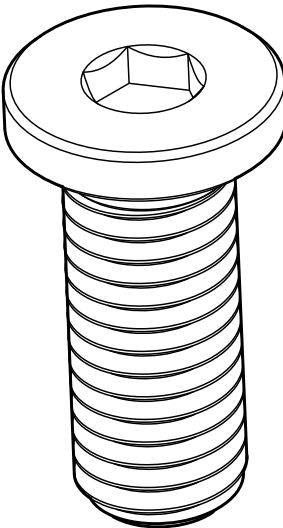

x2 M8 x 20mm Bolts

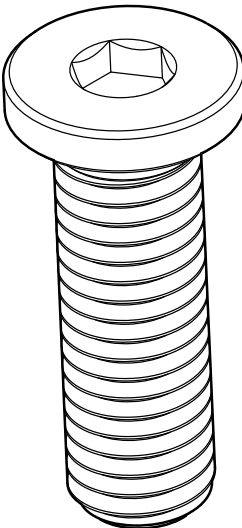

x2 M8 x 25mm Bolts

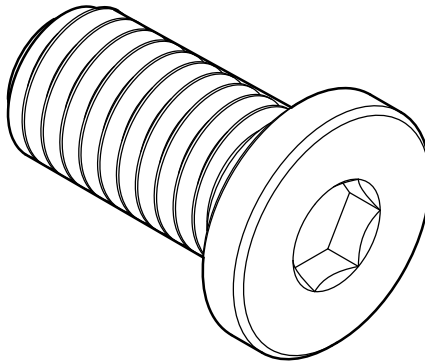

x4 M8 x 16mm Bolts

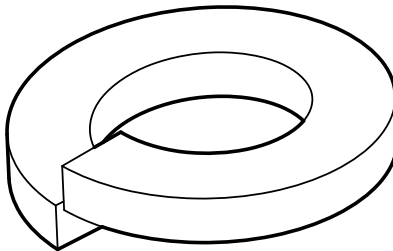

x4 M8 Spring Washer

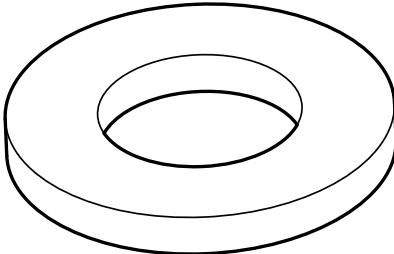

x8 M8 Washer

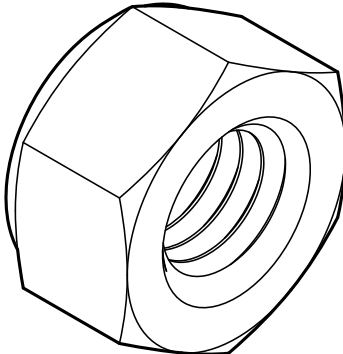

x4 M8 Lock Nut

01 INSTALLATION

Attach the Window Mount to the two Window Rails using the M8 x 16mm bolts, M8 washers, and M8 Locknuts. Make sure your bolts are seated on washers and your lock nuts are tightened.



PARTS REQUIRED

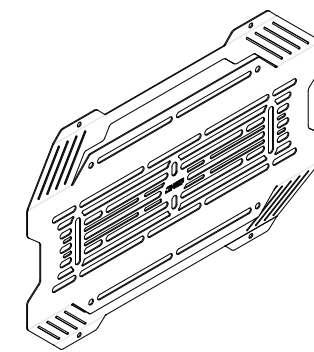

x1 Window Side Mount



x2 Window Side Rail

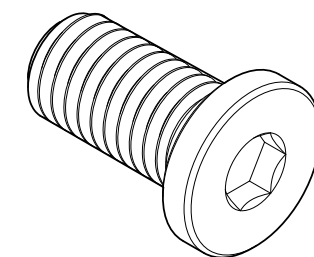

x4 M8 x 16mm Bolts

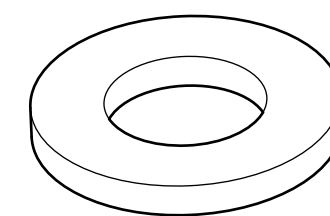

x4 M8 Washer

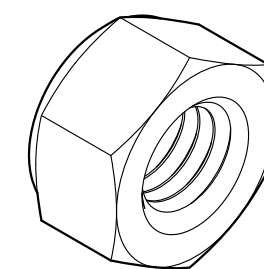

x4 M8 Lock Nut

ASSEMBLY

If you are planning to use the Window Mount with MAXTRAX or RotopaX, make sure you install their mounts first, then install the whole Window Mount on your car. It will be much easier to install at this point.

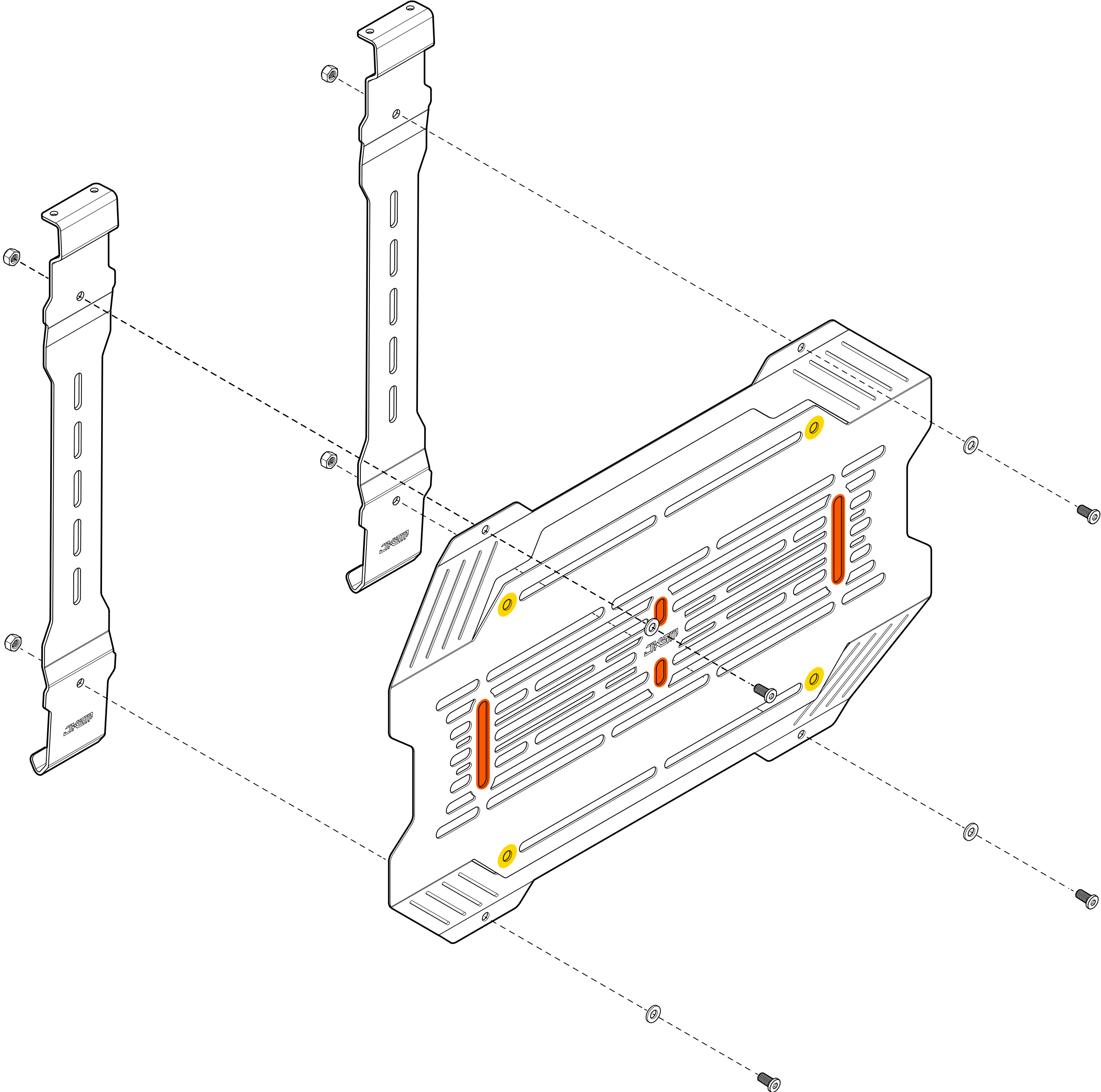

- MAXTRAX Mini mounting holes
- RotopaX mounting slots

02 INSTALLATION

Thread the bolts through the holes at the top of the Rails. Depending on the side you are installing on, the shorter bolts should be used on the side that is closest to the front of the car.

JKSTP

PARTS REQUIRED

x2 M8 x 25mm Bolt

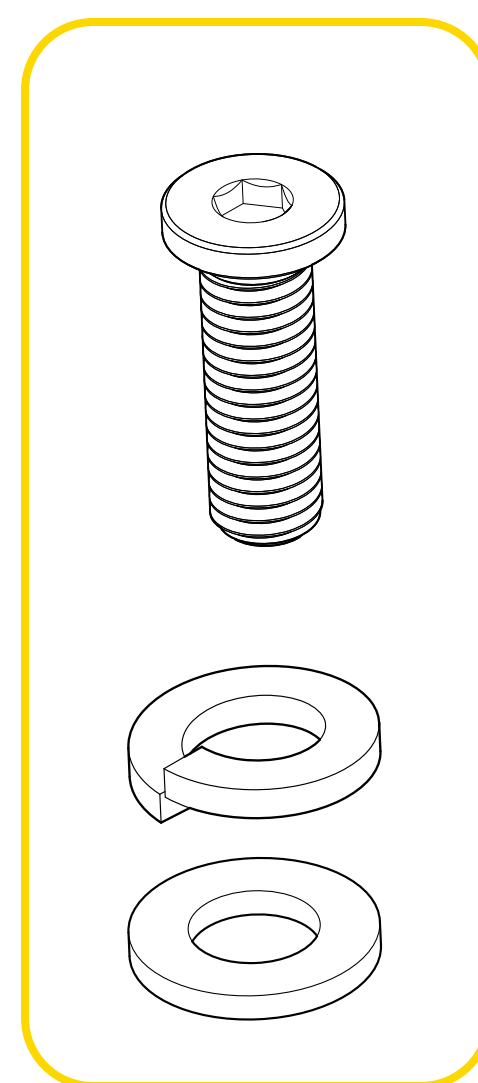

x2 M8 x 20mm Bolt

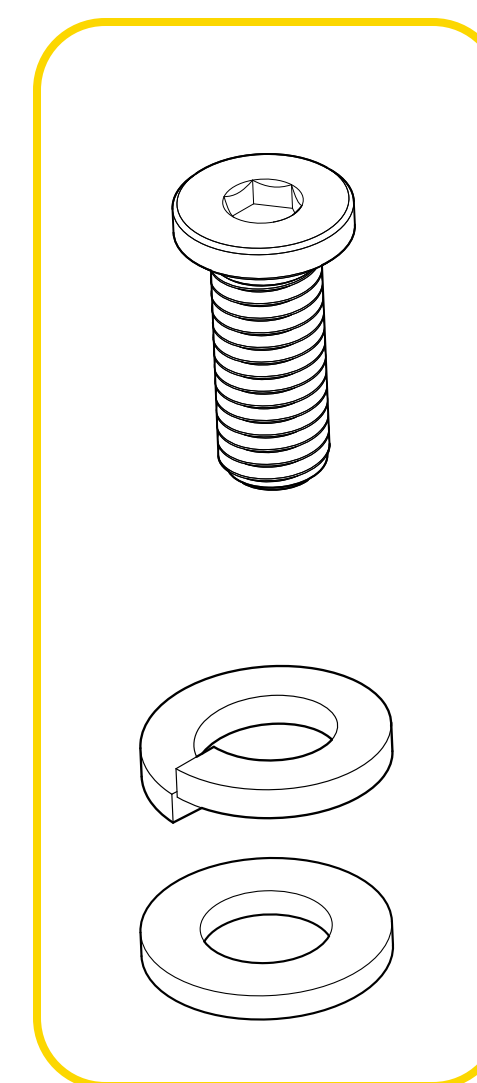

x4 M8 Spring Washer

x4 M8 Washer

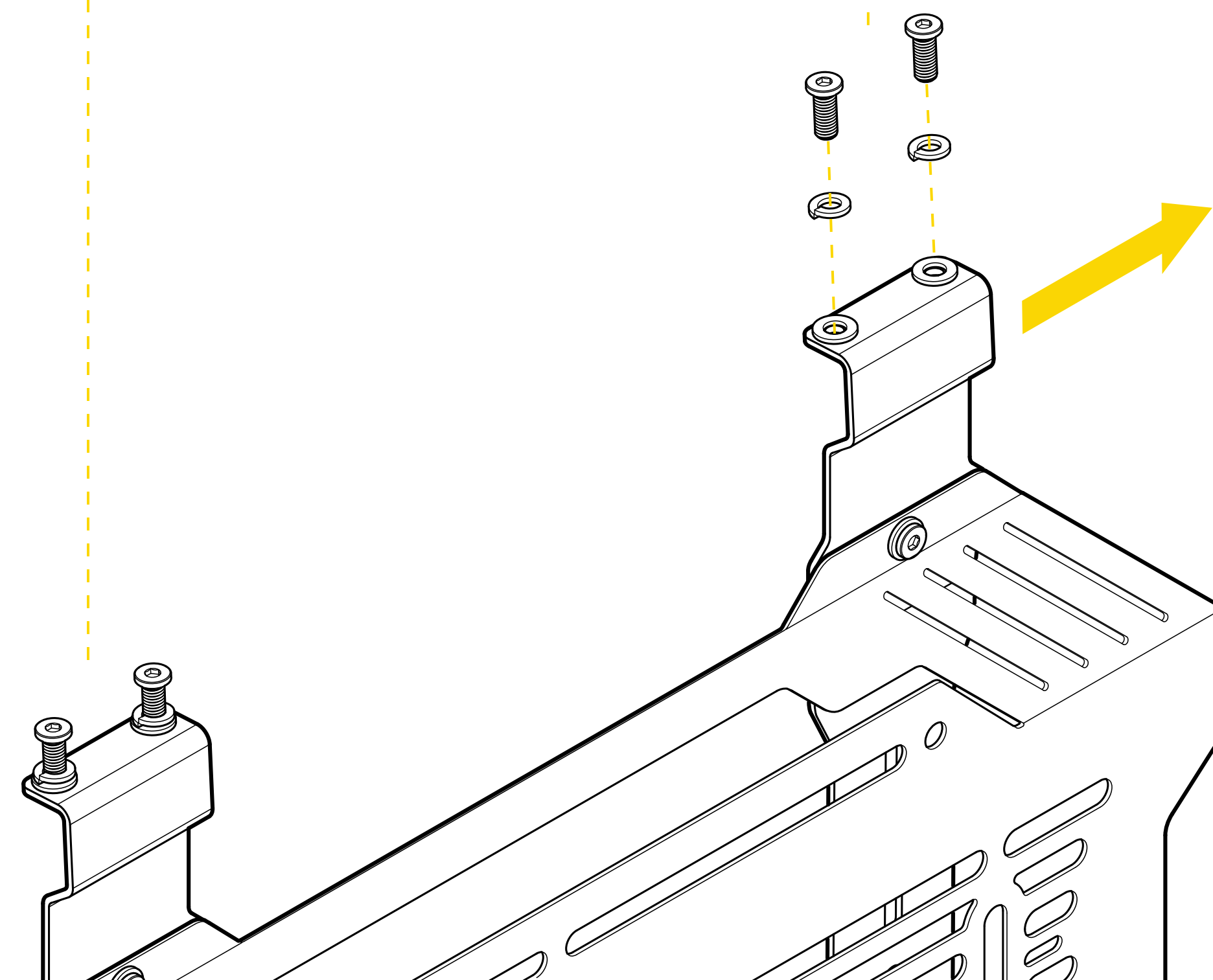

04 INSTALLATION

Place the Hook Pads in the bottom fold of the rails, making sure the tab on the end sits in the slot.



PARTS REQUIRED

x2 Hook Pads

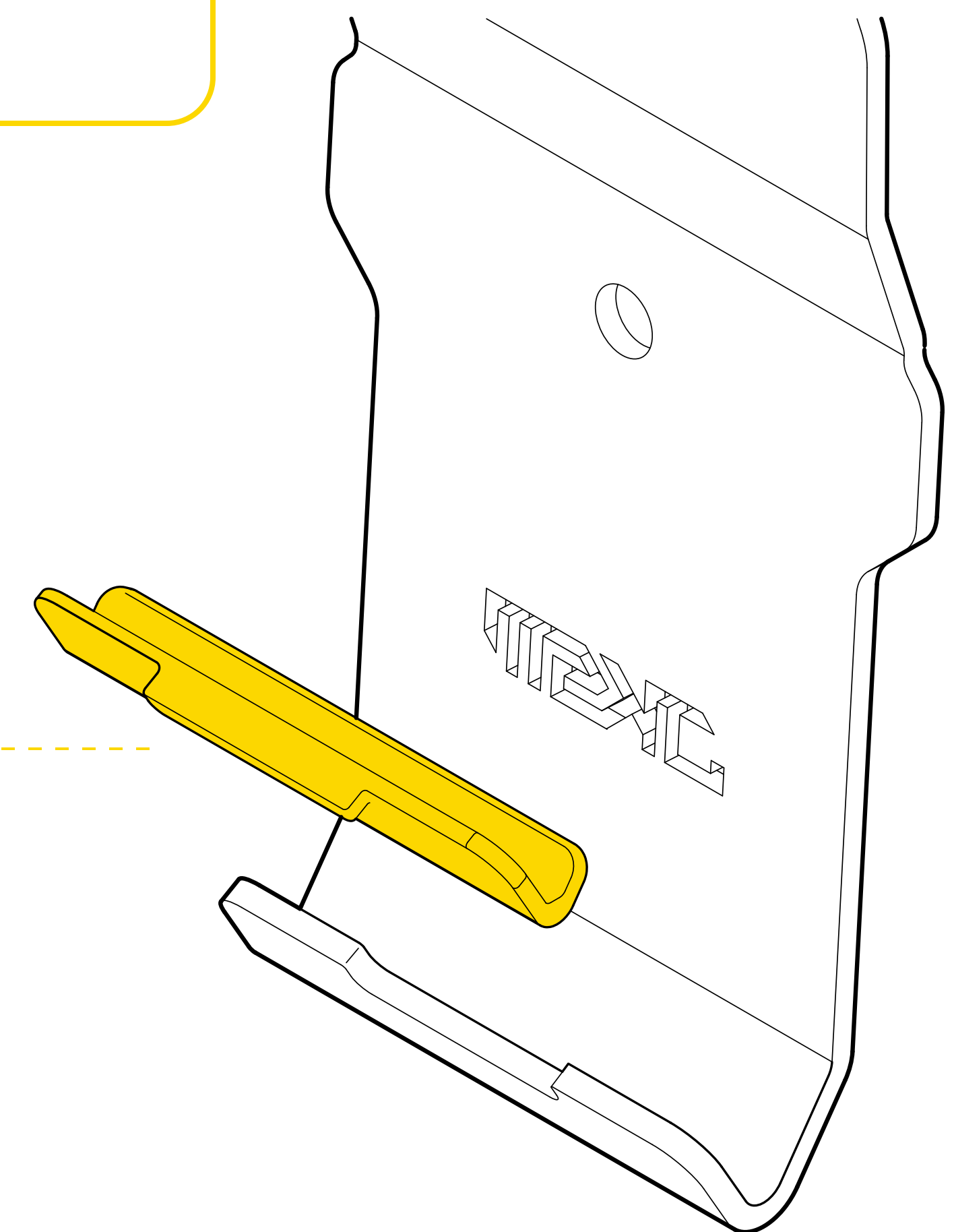
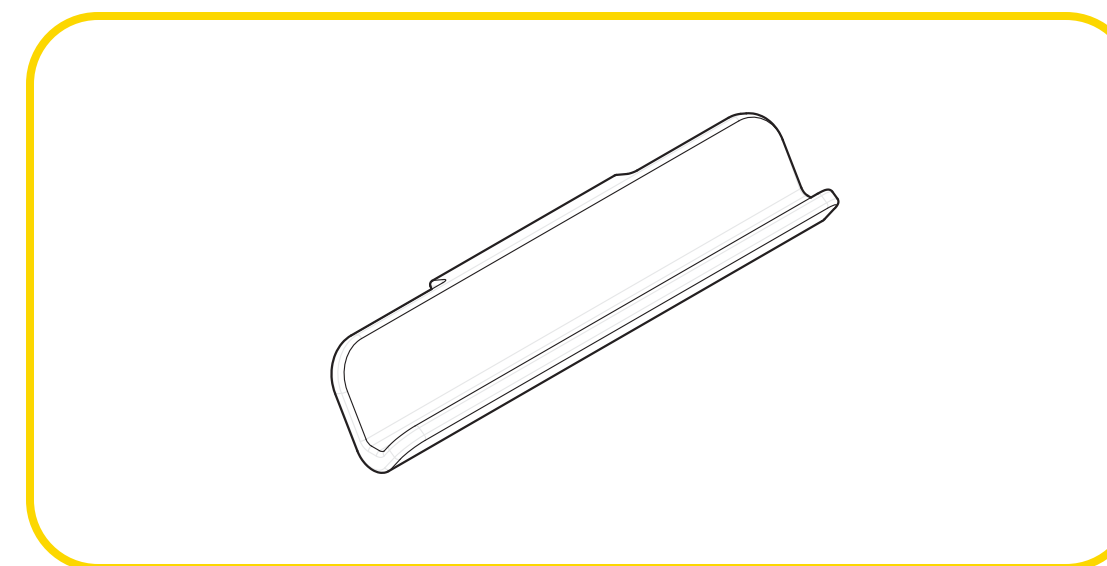

05 INSTALLATION

Place the Clamping Pads in the gutter so the Window Mount sits central. Seat the tabs so they sit at an angle with the sharper edge pointing away from the car (as shown).

PARTS REQUIRED

x2 Clamping Pads

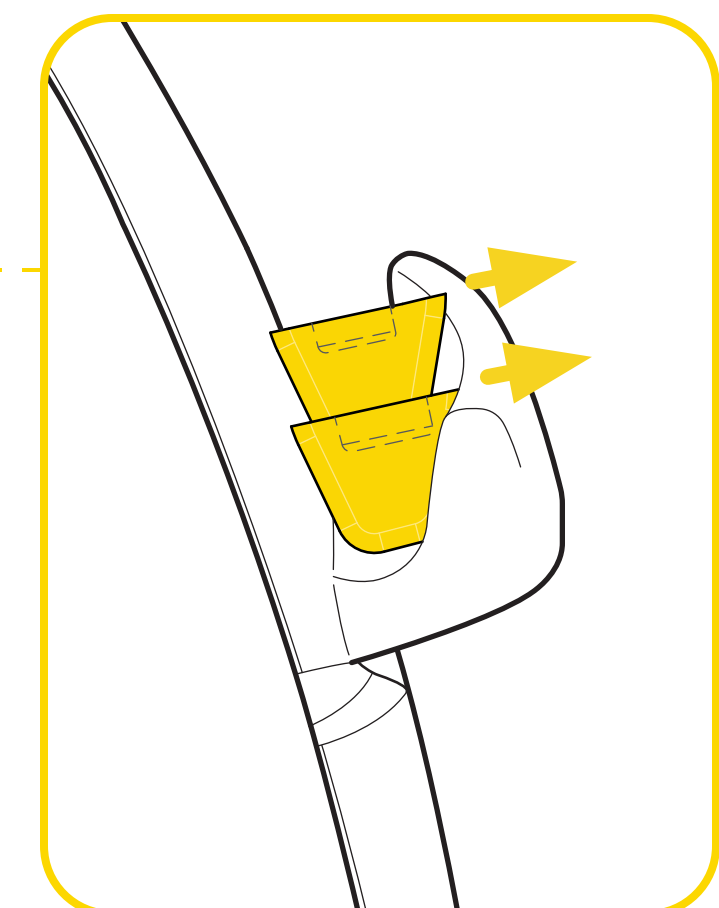
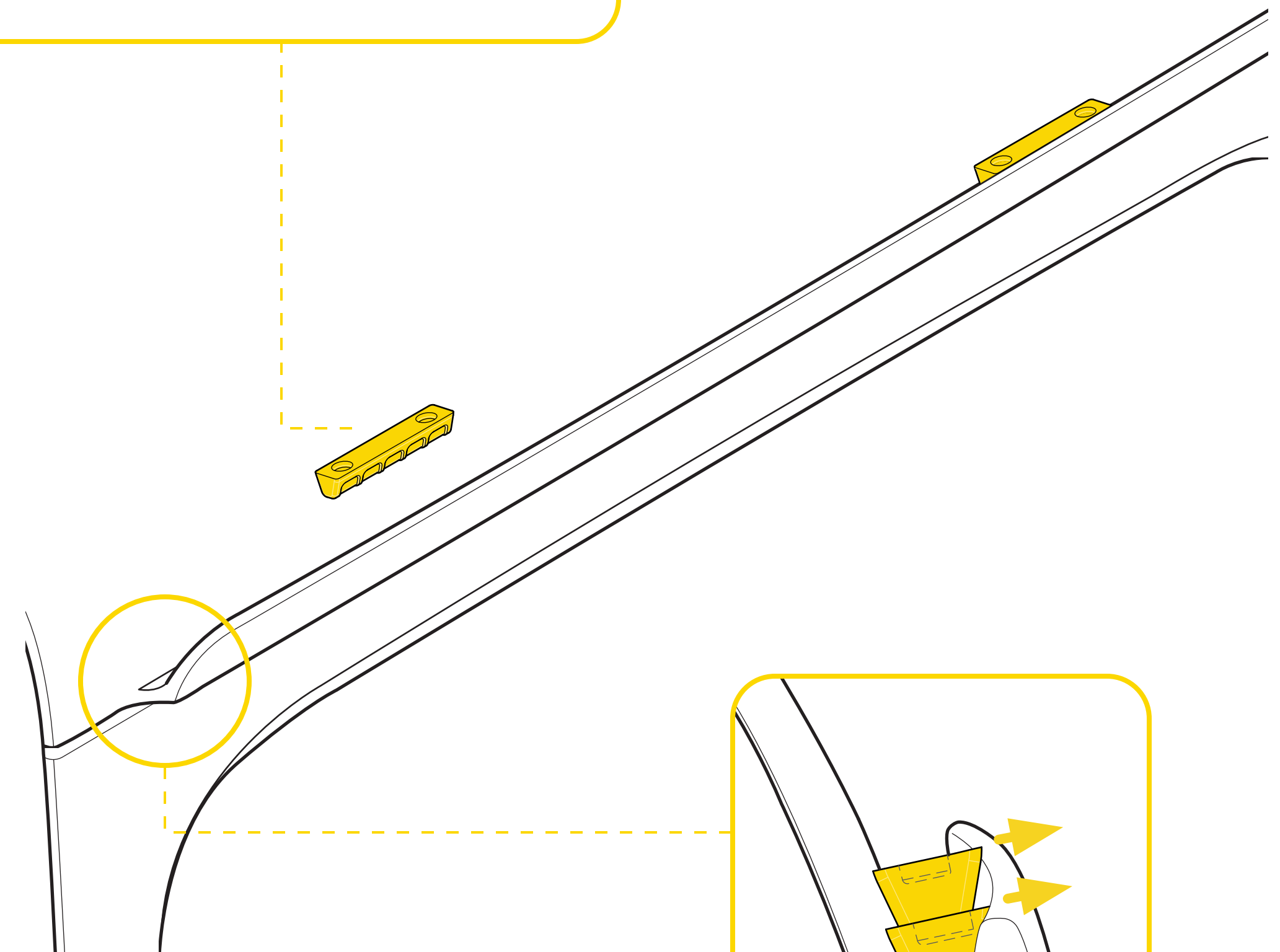
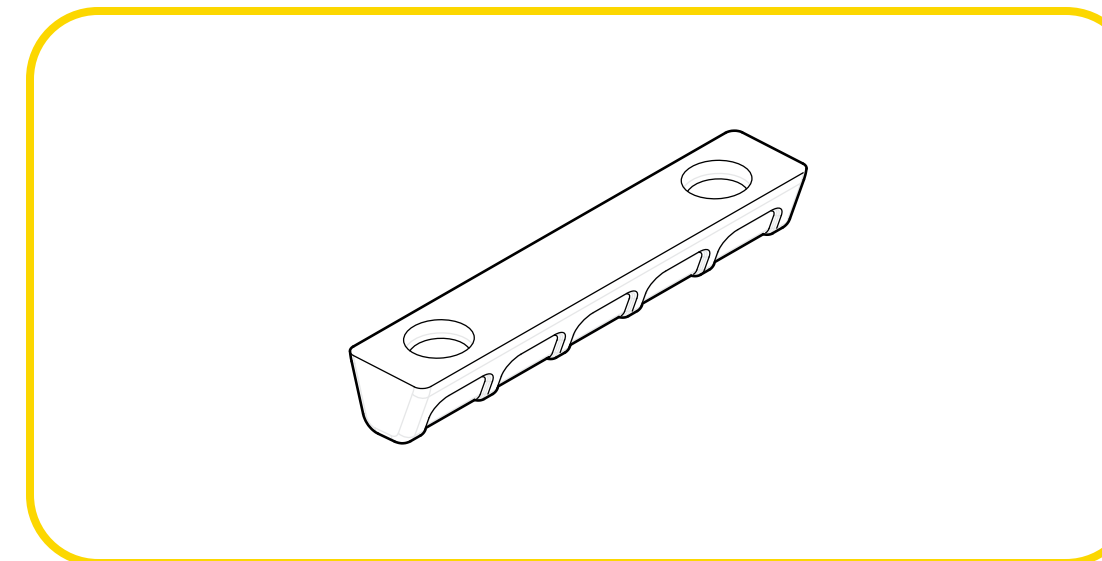

06 INSTALLATION

Hook the bottom of the Window Mount to the underside of the roof and lean it onto the car. Make sure your bolts are still loosened so they don't catch on the rain gutter.

Note: For 2 Door Wranglers you will need to slide the mount from the rear.

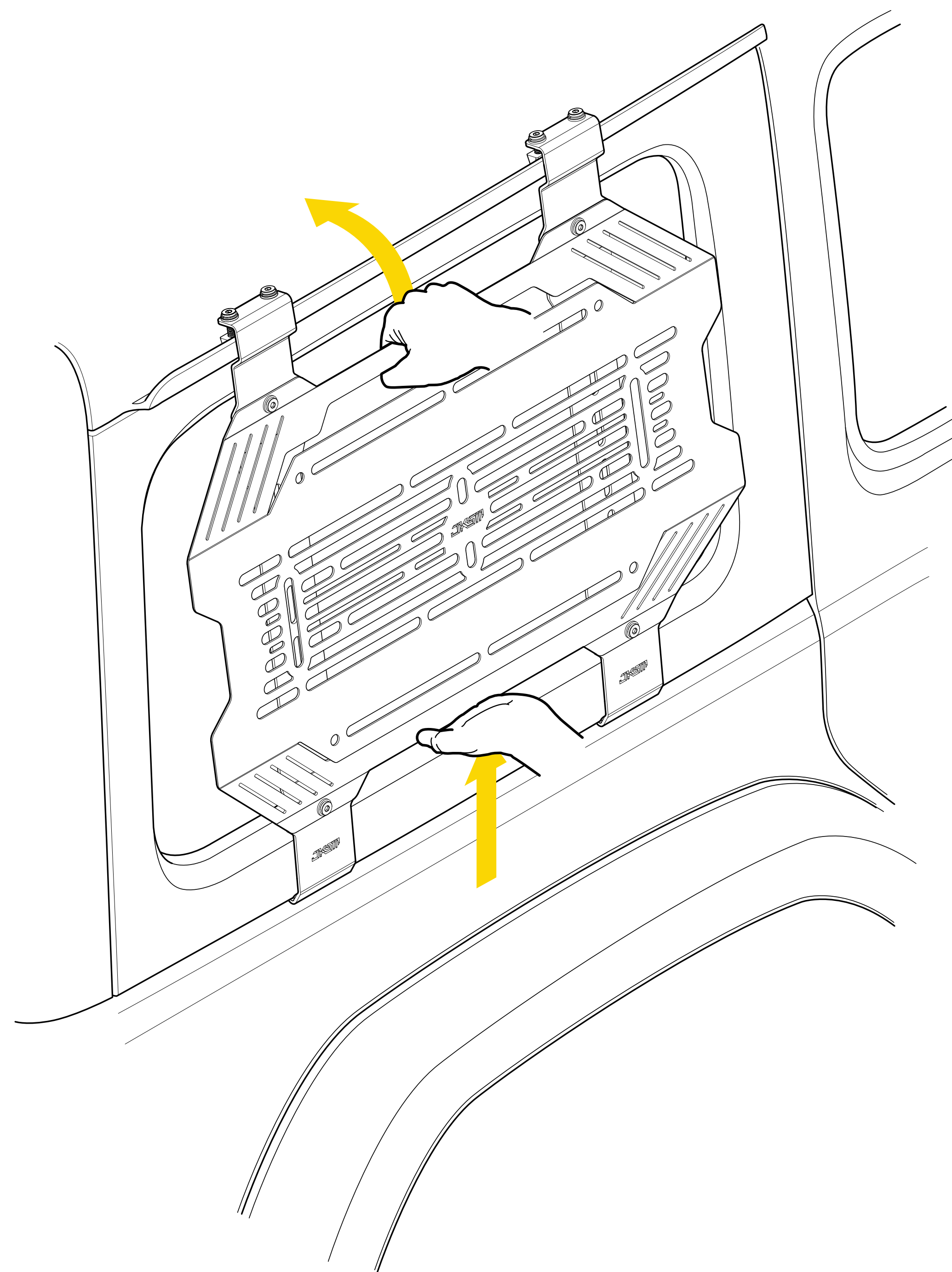

02 INSTALLATION

Finish tightening the bolts with an Allen Key, alternating between bolts each few rotations until the spring washers are locked, and the mount feels like it's on tightly.

** Do not use power tools.

JKSTP

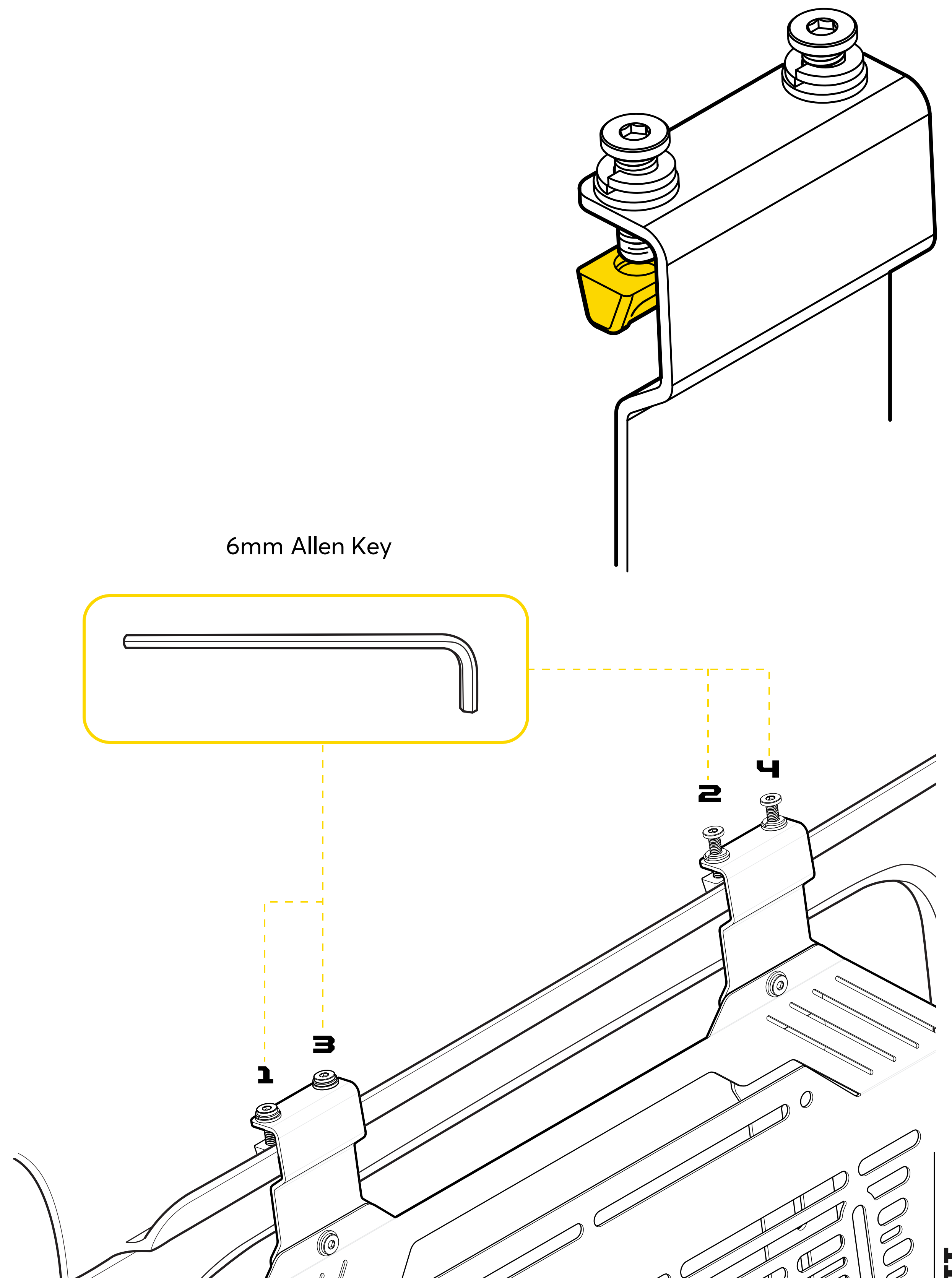

08 COMPLETE

Give it a few firm test shakes to make sure
it's on properly and be on your way!

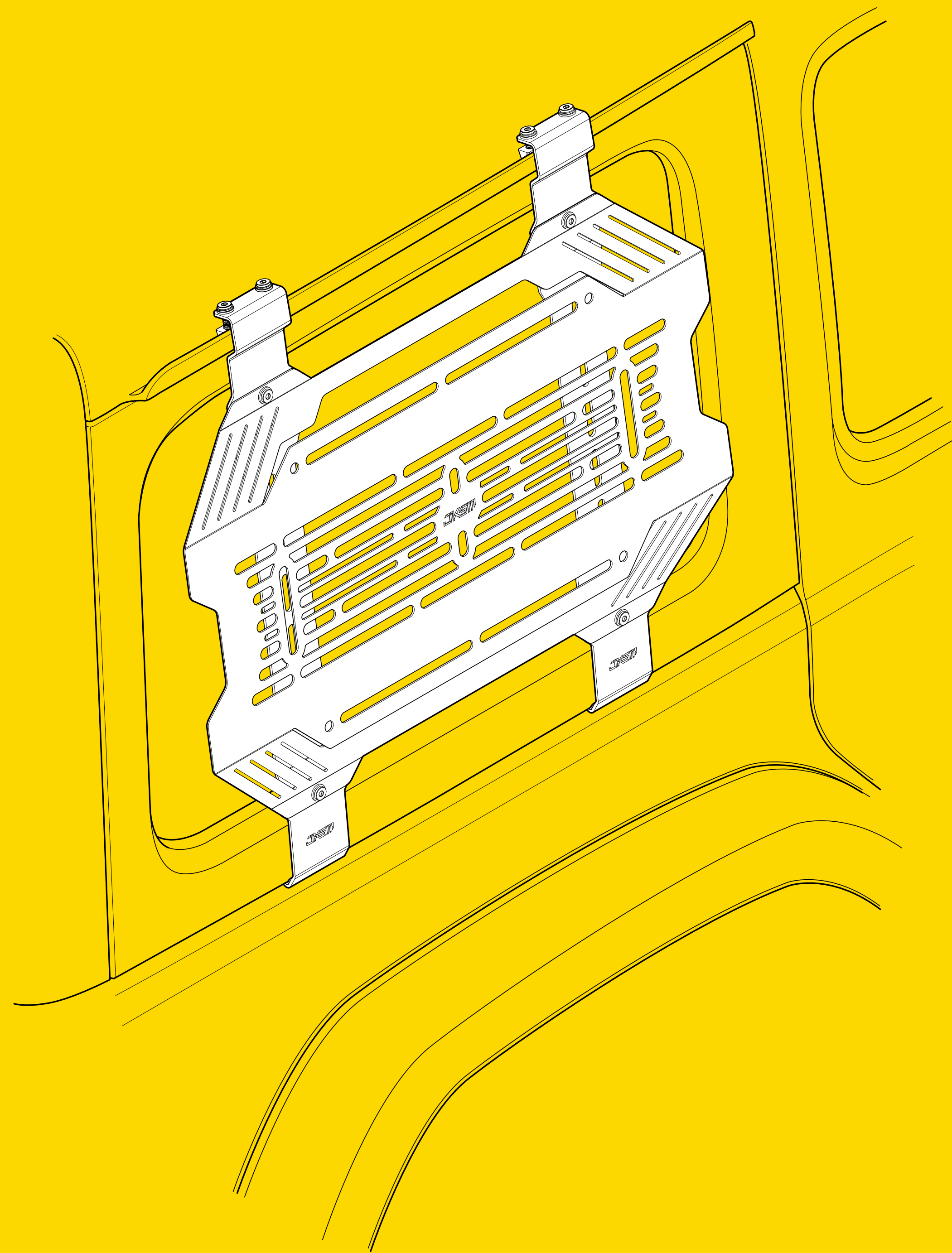

JKSM



hello@jksm.com.au

Unit 8 / 22 Ware St, Thebarton 5031 SA

jksm.com.au

 [JKSM.OFFROAD](https://www.instagram.com/jksm.offroad)