

# PET FRIENDLY PIR MOTION SENSOR

## P910

## Instructions

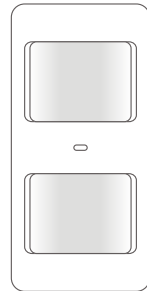

### CONTENTS

- 1 x Pet Friendly PIR Motion Sensor
- 2 x AA 1.5V LR6 Batteries
- 1 x Instruction Guide

### Congratulations on your purchase of the miGuard Pet Friendly PIR Motion Sensor

#### Before Installation

- Read the instructions thoroughly
- Remove the contents from their packaging
- Consider the most appropriate positioning of the PIR
- Avoid mounting the Sensor near metal objects or electrical wiring

#### Features

Two Lens PIR : pet tolerant to 25 kgs, with a vertical and horizontal detection range of 110°.

Digital dual-core fuzzy logic control chip and intelligent analysis: effectively identifies signal interference and body movement.

Automatic temperature compensation and anti-air turbulence technology/control: automatically adapts to environmental changes, thereby saving energy.

Automatic SMS notification of a low battery condition when connected to a miGuard GSM Alarm System.

#### Appearance

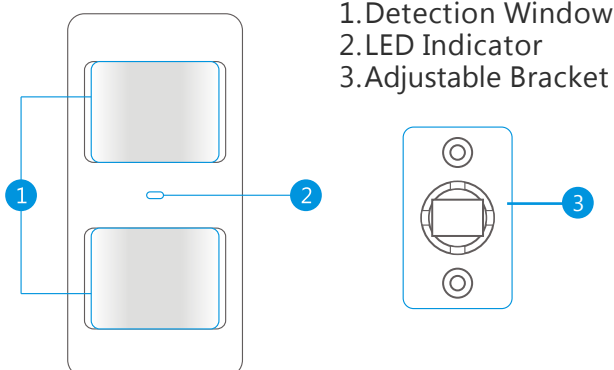

### LED Indication

**Flashes every 2 seconds:** self-testing state

**Flashes twice:** self-testing is finished, enters working mode

**Flashes once:** movement is detected

**Flashes once every 3 seconds:** low battery indication (immediate battery change recommended). If the PIR is connected to a miGuard GSM Alarm System, an SMS alert will automatically be sent to the registered user.

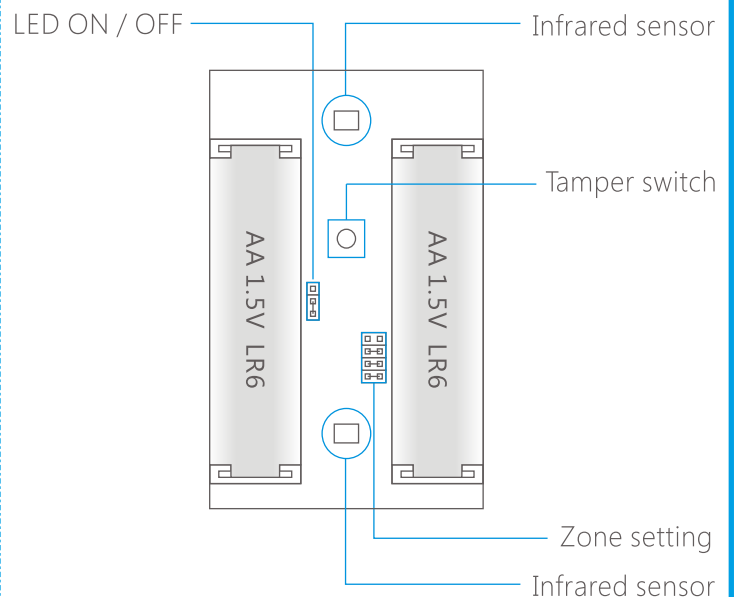

**Infrared Sensor:** Detects movement and triggers alarm signal when the system is armed.

**Tamper Switch:** If the casing is opened when in 'working state' the tamper switch will be triggered and generate an alarm signal.

## Test Mode

1. Remove the activation strip. Fit the retaining screw supplied.
2. Self-testing will commence for 1 minute, indicated by the LED flashing every 2 seconds.
3. To enter Test Mode press the Test Button at the back of the PIR. The LED will then flash once when movement is detected, for up to 3 minutes.

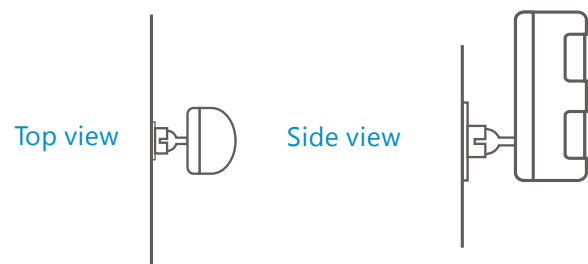
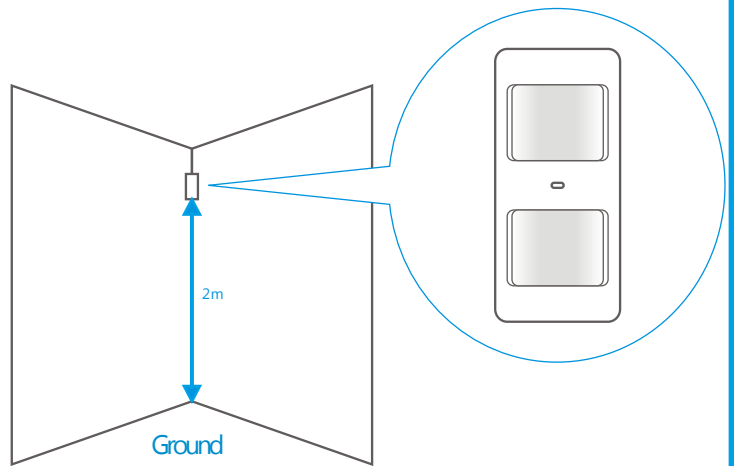
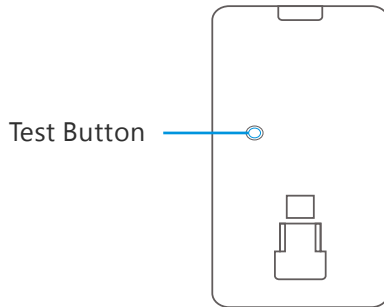

\*Note: Please refer to the full System Instructions for pairing a Motion Sensor.

## Working Mode

1. To test in Working Mode, walk in front of the Sensor - the LED should illuminate once when movement is detected.
2. If the Sensor is triggered twice in 3 minutes it will enter into power saving (sleep mode). If no movement is detected within the next 3 minutes, the Sensor will return to normal working mode.

## Installation

1. Avoid mounting the Sensor in areas where draughts may be present or where the temperature may fluctuate greatly, such as near to: windows, air conditioning, heating, refrigeration units, cooking appliances and direct sunlight.
2. Where possible, mount the Sensor in the corner of the room so that the logical path of an intruder would cut across the fan detection pattern. A PIR responds more effectively to movement across the device than to movement directly towards it.
3. Fit the Sensor in a position that will cover your desired protection area:
  - a. Fix the bracket to the wall with the fixings kit supplied. For optimum performance set the height of the bracket to 2 metres above ground level.
  - b. Adjust angle of the PIR Sensor to cover the required detection area.

## Specification

Power Supply	DC 3V (AA 1.5V LR6 Battery x 2)
Static Current	≤ 90uA
Alarm Current	≤ 9.5mA
Detection Area	8m/110°
Transmitting Distance	≤80m (in open area)
Pet Immunity	≤ 25kg
Radio Frequency	433 MHz
Housing Material	ABS Plastic
Operating Temperature	-10°C~50°C
Relative Humidity	≤ 80% (non-condensing)
PIR Sensor Dimensions (L x W x D)	108 x 52 x 36.8 mm
Bracket Dimensions (L x W x D)	52 x 30 x 26.5 mm

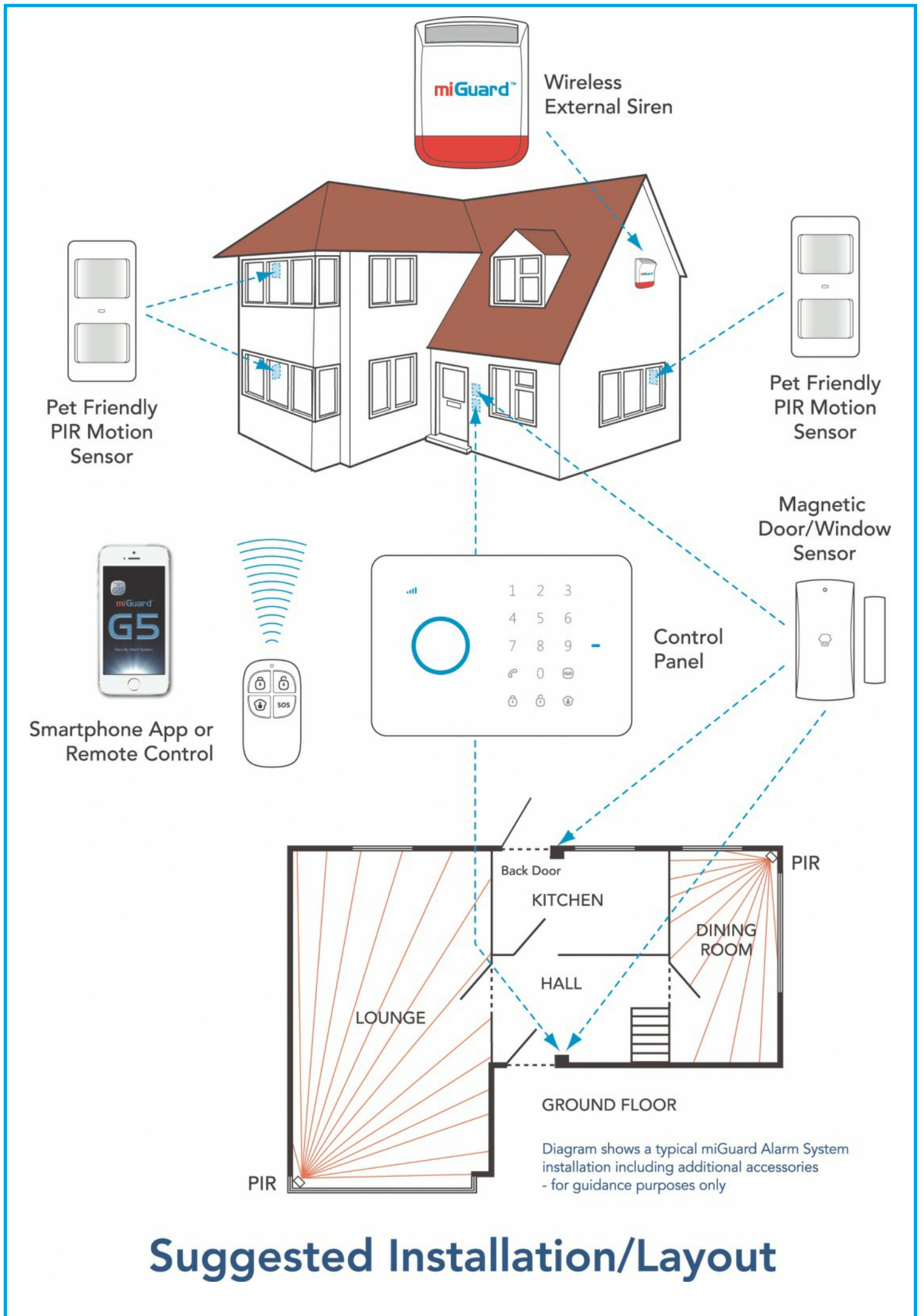

## Suggested Installation/Layout

## GUARANTEE

The product is guaranteed for one year from the date of purchase against faulty materials and workmanship. No liability can be accepted for any problems caused by fair wear and tear, buyer's negligence, improper fitting or use, wilful or accidental damage, or any consequential loss or damage howsoever caused. This guarantee does not affect your statutory rights and is valid for UK and EIRE only.

If you believe the product to be faulty or in the unlikely event of the product developing a fault during the warranty period, then please contact our Technical Support Team (contact details shown below) for product assistance. Product repair or replacement will be offered for faulty products only with our prior agreement. Should you need to return a product then:

1. Contact the Helpline on the number below to obtain a Return Authorisation Number
2. Return your product adequately packaged, ideally in its original packaging to prevent damage in transit, and include the following:
  - a. A copy of your original invoice/receipt
  - b. A covering letter giving your full contact details, including email address (if applicable)
  - c. A description of the fault or problem

## Disposal and Recycling

Disposal of this product is covered by the Waste Electrical or Electronic Equipment (WEEE) Directive. It should not be disposed of with other household or commercial waste.

At the end of its useful life the packaging and product should be disposed of via a suitable recycling centre. Please contact your local authority or the retailer from where the product was purchased for information on available facilities.



## Customer Helpline

# 0345 257 1000

*" whatever your question, we're just a phone call away "*

lines open 0900 to 1700 Monday to Friday

[www.responseelectronics.com](http://www.responseelectronics.com)

**Response Electronics Limited**

Roman House, Lysons Avenue, Ash Vale, Surrey, GU12 5QF

email: [info@responseelectronics.com](mailto:info@responseelectronics.com)

