



Security Alarm System

Features

PSTN/LCD/RFID Touch Alarm System



Please read this user manual carefully before using
Please kindly keep this user manual for your reference
when necessary.

- 100% wireless configuration, D.I.Y. installation
- Fashion design with digital touch keypad
- LCD display with guide menu, easy for programming
- ARM + Auror high quality CPU
- Built-in 1, 000, 000 RF codes combination maintains high reliability
- Support 10 remote controls, 50 wireless sensors and 50 RFID tags
- Store 6 alarm phone numbers and 2 ADEMCO CID CMS numbers
- 10 seconds voice memo and alarm voice message recordable
- Disarm the system by RFID tags and unlock the electronic door lock
- Support low power feedback and tamper alarm for wireless sensors
- Support maximum 150 alarm event logs
- Control panel can dial calls directly
- Remote arm, disarm and monitor by phone operation
- Duress code enables sending out alarm notification mutely
- One group of timing arm and disarm
- Support exit/entry delay
- Rename all zones and RIFD tags
- Voice prompt during phone remote control

Table of Contents

Included Accessories 1~2

Control Panel Layout 3~4

Preparation before Use 5~6

Power on
Connect PSTN Land Line
Installation

Control Panel Operation 7~9

Alarm Control
Access Control System
Dialing Calls
Voice Memo
Function Setting

LCD Display Contents 10

LCD Display Menu 11~13

Settings 14~28

Alarm Phone Number Setup
Add/Delete /Edit Accessories
System Settings
Date and Time
Entry/Exit Delay
Backlight Time
Timed Arm / Disarm
Edit Greeting Message
Remote Phone Control
Linecut Alarm

Keypad Tones
Access Code
Ringing Times for Phone Remote Control
Alarm Message
Siren Setup
User ID for CMS
Upload Arm Report
Upload Disarm Report
Reset
Check Event Logs

Connect to Electronic Lock 29

Connect to CMS Center 29~30

Add CMS Phone Number
Delete CMS Phone Number
User ID
Upload Arm/Disarm Report
Contact ID Reports

Precautions 31

FAQ 32

Specifications 33

Wireless Remote Control 34~36

Wireless Door/Window Contact 37~40

Pet-Immune PIR Motion Detector 41~49

Included Accessories

CG-A11 Control Panel x1

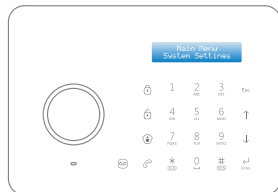

The control panel is known as the "heart and brain" for alarm system, which is used for receiving and processing signals from wireless sensors and remote controls. Users can make settings freely with the keypad and LCD display. In case of emergency, the panel hoots on site and dials the pre-stored alarm phone numbers automatically. When users pick up the phone, they are able to hear alarm voice message and choose to monitor on site or disarm the system.

Pet-Immune PIR Motion Detector x 1

The wireless PIR Motion Detector is an intelligent passive infrared motion sensor, designed to detect human movements within an approximate range of 6 to 8 meters from the detector. The detector includes fuzzy logic to minimize false alarms from unwanted heat sources. With power saving feature, the detector will enter sleeping mode after the second activation within 3 minutes to save power.

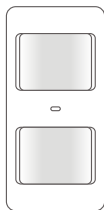

RFID Tag x 2

The RFID tag is for disarming The system and unlocking the electronic door lock (if connected).

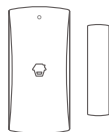

Wireless Door/Window Contact x 1

The Door/window contact can be installed on doors, windows and any other objects that open and close. The sensor transmits signals to the control panel when a magnet mounted near the sensor is moved away.



Wireless Remote Control x 2

The remote control is compact and portable; it is convenient to carry it to arm, disarm, part arm the alarm system and also make an emergency call.

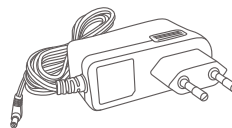

AC Adapter x 1

Supply power to the control panel. In case of power failure, two built-in backup batteries in the panel will support 5-hour standby.



Telephone Cable x 1

Connect PSTN land line to the control panel. In case of emergency, the panel will hoot on site and call the pre-stored alarm phone number to notify users.

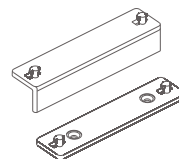

Brackets (wall-mounted and desktop) for control panel x 2



Bracket for PIR Motion Detector x 1



Screws x 4

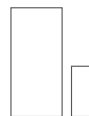

Double-sided tape for Door/Window Contact x 1

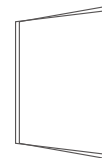

User Manual x 1

Control Panel Layout

Front Side

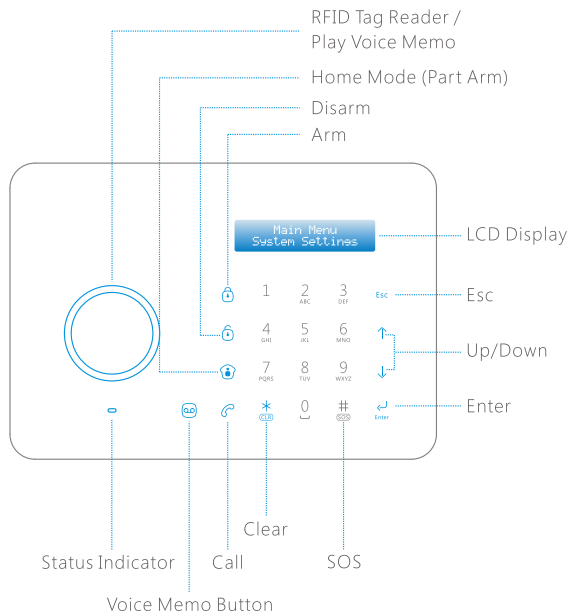

Rear Side

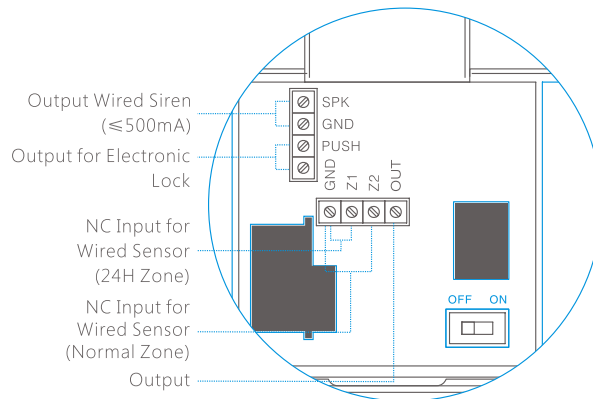
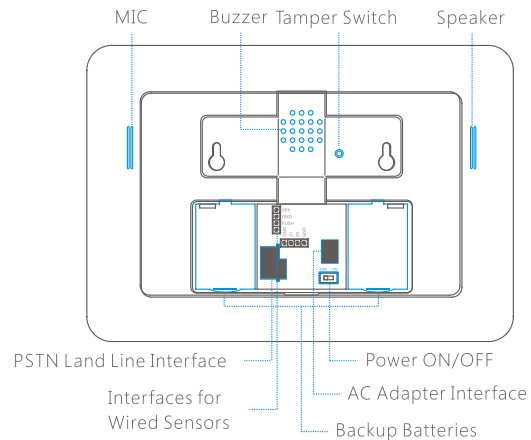

Preparation before Use

1. Power on

- 1 Plug the output connector of AC adapter into the adapter interface of control panel.
- 2 Plug the AC adapter to wall power socket.
- 3 Turn the power switch from OFF to ON.

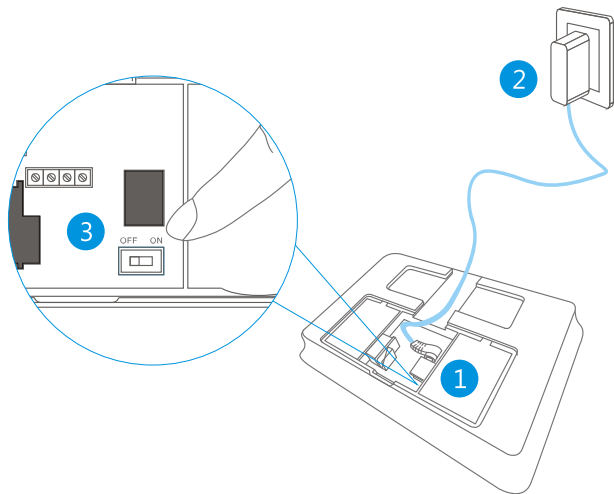

2. Connect PSTN Land Line

A11 is a PSTN alarm system which will auto dial the pre-stored phone number when the system detects intruders. Please make sure the panel has been connected to PSTN land line to ensure safety.

- 1 Connect the smaller connector of provided telephone cable to the PSTN land line interface at the back side of the panel.
- 2 Connect the other end of the telephone cable to the signal output provided by PSTN land line operator.

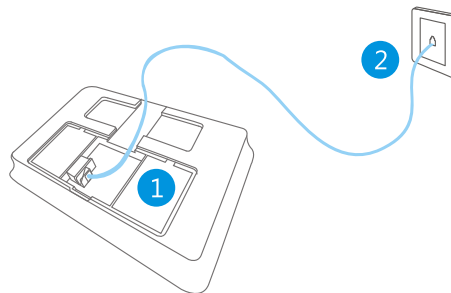

3. Installation

1) Wall Mounting

Fix the wall mounting bracket on the wall with screws.
Wedge the panel on the bracket, make sure they fit well.

2) Standing on the Desk

Mount the desktop bracket, and then put it on the desk.

Control Panel Operation

1. Alarm Control

Arm (Away Arm)



Press the [Arm] button on the control panel, the system enters Arm state when one beep is heard and the Arm LED Indicator lights on.

Note!

If Entry/Exit Delay is activated, all zones except the 24-hour zone will enter Arm state after the set delay time.

The Delay Sensors will enter Arm state after the set delay time.

Home Mode (Part Arm)

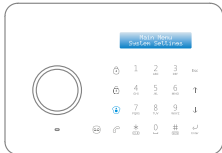

Press the [Home Mode] button on the control panel, the system enters Home Mode when one beep is heard and the Home Mode LED Indicator lights on. All the Normal Sensors are armed except the Home Mode Sensors which are disarmed so that users can move freely at home.

Disarm



Input user code or admin code first, then press the [Disarm] button, the system enters Disarm state when one beep is heard and the Disarm LED Indicator lights on.

Emergency Call

SOS



Hold the [#] button for 3 seconds when the LCD display is activated, the system goes into emergent alarming state with siren hooting, meanwhile the panel will auto dial pre-stored alarm phone numbers.

2. Access Control System

The control panel has a RFID reader for unlocking the electronic door lock by disarming the system. Just place the RFID tag close to the RFID reader, the green LED indicator flashes once.

The system is disarmed and the electronic door lock is open (If connected)

3. Dialing Calls

The control panel has a built-in call module. Make sure the PSTN land line is connected and the credit is enough, you can use the panel to make calls. When the control panel is in Disarm or Home Mode state, press [Call] button, input the phone number and press [Call] button again, the line will get through. If you input wrong numbers, press [Esc] button and input again. Press [Esc] button to cancel dialing or press [Call] button to end a conversation.

4. Voice Memo

Press the [Record Voice Memo] button to record 10 seconds voice message. The Play Voice Memo circle will be flashing in blue to remind you. Users can touch the center of circle to listen to the voice memo. The LED indicator blacks out when the voice memo has been played. Replay by touching it again.

5. Function Setting

Input the admin code, and then press [Enter] to enter setting menu.

- ↑ Up Enter Confirm
- ↓ Down Esc Back to last step

LCD Display Contents

System Status	Display content
Stand-by	Line Disconnect
	AC Power Failure
	Panel Low Battery
	Sensor 1-50(Sensor Name) Low Battery
Arm or Disarm	System Arm
	System Disarm
	System Home Arm
	Remote Arm
	Remote Disarm
	Remote Home Arm
	RFID 1-50(RFID Name) Disarm
Alarm	Alarm SOS
	Alarm Linecut
	Alarm Panel Tamper
	Alarm Sensor Tamper
	Alarm Wired Sensor
	Alarm Sensor 1-50(Sensor Name)

LCD Display Menu

When LCD is activated, input the admin code, and then press **[Enter]** to enter setting menu.

Main Menu	Sub Menu 1	Sub Menu 2	Sub Menu 3
Phone Numbers	Add Phone Number	Alarm Number1-6	-
		CMS Number1-2	-
	Del Phone Number	Alarm Number1-6	-
		CMS Number1-2	-
Accessories	Remote & Keypad	Add	-
		Delete	ALL
			Remote (01-10)
	RFID Tag	Add	-
		Delete	ALL
			RFID (01-50)
		Edit Name	RFID (01-50)
	Wireless Sensors	Add	-
		Delete	ALL
			Sensor (01-50)
		Edit	Sensor (01-50) Edit Sensor Type (Normal Sensor, 24 Hour Sensor, Delay Sensor, Home Sensor) Edit Sensor Name
	Test Mode	-	-

System Settings	Date And Time	Date	-
		Date Format	-
		Time	-
	Entry Exit Delay	Entry Delay <000S>	-
		Exit Delay <000S>	-
	Backlight Time <20S>		-
	Auto Arm/ Disarm	Auto Arm Time <00:00:00>	-
		Auto Disarm Time <00:00:00>	-
	Edit Welcome		-
	Control by Phone	On Off	-
	Linecut Alarm	On Off	-
	Keypad Tones	On Off	-
	Access Code	Admin Code	Input 6 Digits <Default Code 123456>
User Code		Input 4 Digits <Default Code 1234>	
Duress Code		Input 4 Digits <Default Code 1111>	
Ringin g Times	-	-	
Alarm Message	Record	-	

System Settings	Siren Setup	Wired Siren	Siren On/Off <On/Off>
			Arm/Disarm Tone <On/Off>
		Wireless Siren	Siren On/Off <On/Off>
			Arm/Disarm Tone <On/Off>
		Built-in Siren	Siren On/Off <On/Off>
			Arm/Disarm Tone <On/Off>
	Siren Alert Time <300S>	-	
	User ID<1234>	Input 4 Digits	-
	Arm Upload	On Off	-
	Disarm Upload	On Off	-
Reset	-	-	
History	-	-	-

Settings

When LCD is activated, input the admin code, and then press **[Enter]** to enter setting menu.

1. Alarm Phone Number Setup

User can set 6 user phone numbers and 2 CMS phone numbers. When connecting to CMS, system will dial CMS phone number to upload Contact ID reports while alarming and then dial 6 user phone numbers in sequence one by one. System will dial all the user phone numbers in 3 cycles until the phone is answered or any press on phone buttons.

Add Alarm Phone Number

- ① Log on the menu, choose "Phone Numbers", press **[Enter]**.
- ② Press **[↓]** or **[↑]**, choose "Add Phone Number", press **[Enter]**.
- ③ Press **[↓]** or **[↑]**, choose "Alarm Number1~6", press **[Enter]**.
- ④ Input alarm phone numbers in order, press **[Enter]**. If group extended telephone number is used, 0# or 9# need to be added in front of the phone number.

Note!

If user want to check or edit the stored phone number, enter "Alarm Number1~6" to check and edit.

Delete Alarm Phone Number

- ① Log on the menu, choose "Phone Numbers", press **[Enter]**.
- ② Press **[↓]** or **[↑]**, choose "Delete Phone Number", press **[Enter]**.
- ③ Press **[↓]** or **[↑]**, choose "Alarm Number1~6", press **[Enter]**.
- ④ Delete the alarm phone numbers in order, press **[Enter]** again

Note!

If user wants to set CMS center phone number, please refer to "Connect to CMS Center".

2. Add/Delete/Edit Accessories

The control panel only receives signal from accessories after they are connected to the control panel.

Add/Delete Remote Controls or Wireless Keypads

Add

- ① Log on the menu, press [↓] or [↑], choose "Accessories", press [Enter].
- ② Press [↓] or [↑], choose "Remote & Keypad", press [Enter].
- ③ Press [↓] or [↑], choose "Add", press [Enter].
- ④ LCD display will show "Please connect", press any button from the remote control to enable signal transmitting to the control panel. When a beep is heard, LCD display will show "Remote (01-10)", connection succeeded.

Note!

When adding wireless keypad to control panel, please enter access code and then press "arm" or "disarm" button on the wireless keypad. When a "beep" is heard, the system is connected to the panel successfully.

Delete

If user wants to delete the added remote controls or RFID wireless keypads, please choose "Delete" in the step③ as above and press [Enter]. Then choose to delete all or specific remote controls or wireless keypads, press [Enter] again.

Note!

If two beeps is heard when coding , the accessory is coded already.

Add/Delete/Edit RFID Tags

Add

- ① Log on the menu, press [↓] or [↑], choose "Accessories", press [Enter].
- ② Press [↓] or [↑], choose "RFID Tag", press [Enter].
- ③ Press [↓] or [↑], choose "Add", press [Enter].
- ④ LCD display will show "Please connect", put the RFID tag close to the RFID reader on the control panel. When a beep is heard, LCD display will show "RFID (01-50)", connection succeeded.

Delete

If user wants to delete the added RFID cards or tags, please choose "Delete" in the step③ as above and press [Enter]. Then choose to delete all or specific RFID cards or tags, press [Enter] again.

Edit

If user wants to rename the added RFID cards or tags, please choose "Edit Name" in the step③ as above and press [Enter], then input the name.

Add/Delete/Edit Wireless Sensors

Add

- ① Log on the menu, press [↓] or [↑], choose "Accessories", press [Enter].
- ② Press [↓] or [↑], choose "Wireless Sensors", press [Enter].
- ③ Press [↓] or [↑], choose "Add", press [Enter].
- ④ LCD display will show "Please connect", trigger the detector once to make it send wireless signal to the control panel. When a beep is heard, LCD display will show "Sensor (01-50)", connection succeeded.

Delete

If user wants to delete the added sensors, please choose "Delete" in the step③ as above and press [Enter]. Then choose to delete all or specific wireless sensors, press [Enter] again.

Edit

Type of Sensors

- ① Log on the menu, press [↓] or [↑], choose "Accessories", press [Enter].
- ② Press [↓] or [↑], choose "Wireless Sensors", press [Enter].
- ③ Press [↓] or [↑], choose "Edit", press [Enter].
- ④ Press [↓] or [↑], choose "Sensor 01-50", press [Enter].
- ⑤ Press [↓] or [↑], choose "Edit Sensor Type", press [Enter].
- ⑥ Press [↓] or [↑], choose one type of "Normal Sensor/ 24 Hour Sensor/ Delay Sensor/ Home Sensor", press [Enter].

Normal Sensor: In armed mode, when normal sensors are triggered, alarm system will alarm. In disarmed mode, when normal sensors are triggered, alarm system will not alarm.

24 Hour Sensor: Under any circumstances, when 24 Hour Sensors are triggered, alarm system will alarm at once.

Delay Sensor: If user wants to use the entry and exit delay, related sensors need to be set in entry and exit delay zone. When set is done, after set delay time, those sensors will make system alarm. Refer to Entry and Delay Setup for details.

Home Sensor: In home mode, only normal sensors will be triggered for alarming while home sensors will not be triggered. This will allow user to move freely at home.

Names of Sensors

If user wants to rename the sensors, please choose "Edit Sensor Name" in the step ③ and press **[Enter]**. Then input the sensor name.

Test Mode

Test if the sensors are connected successfully to the control panel.

- ① Log on the menu, press **[↓]** or **[↑]**, choose "Accessories", press **[Enter]**.
- ② Press **[↓]** or **[↑]**, choose "Test Mode", press **[Enter]**. LCD display will show "Yes?", Press **[Enter]** again to start testing mode for 10 minutes.
- ③ Please trigger coded sensors in order, the sensors will transmit signals to control panel. When 3 beeps are heard, LCD display will collect the triggering time of the sensors. Then you can count the connected sensors based on the numbers displayed on the LCD screen. Exit by pressing **[Esc]** button.

3. System Settings

3.1 Date and Time

Date

- ① Log on the menu, press **[↓]** or **[↑]**, choose "System Settings", press **[Enter]**.
- ② Press **[↓]** or **[↑]**, choose "Date and Time", press **[Enter]**.
- ③ Press **[↓]** or **[↑]**, choose "Date", press **[Enter]**.
- ④ Input date, press **[Enter]**.

Date Format

- ① Log on the menu, press **[↓]** or **[↑]**, choose "System Settings", press **[Enter]**.
- ② Press **[↓]** or **[↑]**, choose "Date and Time", press **[Enter]**.
- ③ Press **[↓]** or **[↑]**, choose "Date Format", press **[Enter]**.
- ④ Press **[↓]** or **[↑]**, choose format, press **[Enter]**.

Time

The default time is on 24 hours standard.

- ① Log on the menu, press **[↓]** or **[↑]**, choose "System Settings", press **[Enter]**.
- ② Press **[↓]** or **[↑]**, choose "Date and Time", press **[Enter]**.
- ③ Press **[↓]** or **[↑]**, choose "Time", press **[Enter]**.
- ④ Input current time, press **[Enter]**.

3.2 Entry and Exit Delay

If user is not used to taking along with the remote control, entry and exit delay could be set in the system. Following is the operation instruction for arming and disarming.

When entry and exit delay is set, user could exit the house in set time period, then system will be armed automatically; when user is back without disarming the system, entry delay will allow time for user to disarm the system. Otherwise, the system will treat this as an intrusion and it will be triggered and send out alarming alert.

Note!

The entry and exit delay is only for delay sensors.

Entry Delay

Entry delay is set to leave time for user to disarm the system before the sensors send signal to control panel after triggering after the set time.

- ① Log on the menu, press [↓] or [↑], choose "System Settings", press [Enter].
- ② Press [↓] or [↑], choose "Entry Exit Delay", press [Enter].
- ③ Press [↓] or [↑], choose "Entry Delay", press [Enter].
- ④ Input time for entry delay; press [Enter] for confirmation.

Entry delay time is calculated on seconds; default is 0 second (off); setup range is 0-999 seconds.

Exit Delay

Exit delay is set to leave time for user to exit and then arm the system within the set time.

- ① Log on the menu, press [↓] or [↑], choose "System Settings", press [Enter].
- ② Press [↓] or [↑], choose "Entry Exit Delay", press [Enter].
- ③ Press [↓] or [↑], choose "Exit Delay", press [Enter].
- ④ Input time for exit delay; press [Enter] for confirmation.

Exit delay time is calculated on seconds; default is 0 second (off); setup range is 0-999 seconds.

Once delay time is set, when arm the system, one beep will be heard every second to remind the user to leave, the reminding rhythm will speed up in the last 15 seconds.

3.3 Backlight Time

User can set standby time for the backlight on the blue LCD display accordingly.

- ① Log on the menu, press [↓] or [↑], choose "System Settings", press [Enter].
- ② Press [↓] or [↑], choose "Backlight Time", press [Enter].
- ③ Input time for backlight time; press [Enter].
- ④ Backlight time is calculated on seconds; default is 20 seconds; setup range is 01-99 seconds.

3.4 Timed Arm / Disarm

User can set timed arm and disarm according to daily schedule to avoid repeated operation.

Timed Arm

- ① Log on the menu, press [↓] or [↑], choose "System Settings", press [Enter].
- ② Press [↓] or [↑], choose "Auto Arm/Disarm", press [Enter].
- ③ Press [↓] or [↑], choose "Auto Arm Time", press [Enter].
- ④ Input exact time for arming; press [Enter].

Timed Disarm

- ① Log on the menu, press [↓] or [↑], choose "System Settings", press [Enter] for confirmation.
- ② Press [↓] or [↑], choose "Auto Arm/Disarm", press [Enter].
- ③ Press [↓] or [↑], choose "Auto Disarm Time", press [Enter].
- ④ Input exact time for disarming; press [Enter].

3.5 Edit Greeting Message

When greeting message is set; turn on the alarm system or activate the touch keyboard; the greeting message will be shown on LCD display.

- ① Log on the menu, press [↓] or [↑], choose "System Settings", press [Enter].
- ② Press [↓] or [↑], choose "Edit Welcome", press [Enter] to define the greeting message.
[*] means to delete, [#] means to space, [↑] means to move backward, [↓] means to move forward.

3.6 Remote Phone Control

Users can set to turn on/off remote phone control to get free access to the alarm system for arming, disarming and on site monitoring by dialing telephone no. of the system

Turn On/Off Remote Phone Control

- ① Log on the menu, press [↓] or [↑], choose "System Settings", press [Enter].
- ② Press [↓] or [↑], choose "Control by Phone", press [Enter].
- ③ Press [↓] or [↑], choose "On" or "Off", press [Enter].

"On" is to turn on phone remote control; "Off" is to turn off phone remote control.

Default setting is "off", Remote Phone Control off.

Remote Phone Control Operation

Method 1

When alarm system is triggered, the control panel will dial pre-stored user phone numbers. When pick up the phone, users can follow the prompt voice to control the panel remotely after recorded voice is heard. (See Instruction Table Below)

Method 2

- ① User dials alarm system telephone no.; after getting through, alarm system will guide you to input access code.
- ② Input access code (user code or admin code); Press [#].
- ③ Alarm system plays the voice prompt twice to explain the functions.
- ④ User chooses the related instruction to make remote control operation. (See Instruction Table Below)

Note!

Alarm system will hang up after 30 seconds with no operation.

Remote Phone Control Instruction Table

Phone Buttons	Function	Explanation
Press [1]	Arm the system	Phone voice prompt "Arm Succeed"
Press [0]	Disarm the system	Phone voice prompt "Disarm Succeed"
Press [*]	Monitor on site	Press [*] to prolong monitor time
Press [9]	Turn on siren	Deter the intruders
Press [6]	Turn off siren	Siren stops ringing
Press [8]	Turn on relay	Available for the system with RS-1000 relay module
Press [5]	Turn off relay	
Press [#]	To exit Remote Phone Control	Or hang up the phone

3.7 Linecut Alarm

When linecut alarm function is on, the control panel will alarm once the PSTN land line is cut or pulled out.

Turn On/Off Line Cut Alarm

- ① Log on the menu, press [↓] or [↑], choose "System Settings", press [Enter].
- ② Press [↓] or [↑], choose "Linecut Alarm", press [Enter].
- ③ Press [↓] or [↑], choose "On" or "Off", press [Enter].
"On" is to turn on the linecut alarm; "Off" is to turn off the linecut alarm.
Default setting is "On", the linecut alarm is on.

3.8 Keypad Tone

User can turn on/off keypad tone accordingly.

Turn On/Off Keypad Tone

- ① Log on the menu, press [↓] or [↑], choose "System Settings", press [Enter].
- ② Press [↓] or [↑], choose "Keypad Tone", press [Enter].
- ③ Press [↓] or [↑], choose "On" or "Off", press [Enter].
- ④ "On" is to turn on the keypad tone; "Off" is to turn off the keypad tone.
Default setting is "On", keypad tone is on.

3.9 Access Code

All the alarm panels are with default user code, admin code and duress code. Please change all codes before using and keep your codes secret.

Admin Code

With admin code, user can arm and disarm, make system settings as well as reset codes etc.

- ① Log on the menu, press [↓] or [↑], choose "System Settings", press [Enter].
- ② Press [↓] or [↑], choose "Access Code", press [Enter].
- ③ Press [↓] or [↑], choose "Admin Code", press [Enter].
- ④ LCD display will show "Input 6 Digits", then input 6 digits for code, press [Enter].(Default Admin Code: 123456)
- ⑤ Input the new admin code, press [Enter].

User Code

With user code, user can set arm, home mode and disarm the alarm system.

- ① Log on the menu, press [↓] or [↑], choose "System Settings", press [Enter].
- ② Press [↓] or [↑], choose "Access Code", press [Enter].
- ③ Press [↓] or [↑], choose "User Code", press [Enter].
- ④ LCD display will show "Input 4 Digits", then input 4 digits for code, press [Enter].(Default User Code: 1234)
- ⑤ Input the new user code, press [Enter].

Duress Code

In case of emergency, when user is violently requested to disarm the system, it's recommended to use the duress code to disarm the alarm system. The panel will silently dial alarm telephone numbers stored.

- ① Log on the menu, press [↓] or [↑], choose "System Settings", press [Enter].
- ② Press [↓] or [↑], choose "Access Code", press [Enter].
- ③ Press [↓] or [↑], choose "Duress Code", press [Enter].
- ④ LCD display will show "Input 4 Digits", then input 4 digits for code, press [Enter].(Default Duress Code: 1111)
- ⑤ Input the new duress code, press [Enter].

3.10 Ringing Times for Remote Phone Control

After the set ringing times, user can make system settings from remote calling, such as arming/disarming the system.

- ① Log on the menu, press [↓] or [↑], choose "System Settings", press [Enter].
- ② Press [↓] or [↑], choose "Ringing Times", press [Enter].
- ③ Input 5~9 for ring times, press [Enter].
Default setting is 5 times.

3.11 Alarm Message

User can leave 10 seconds voice message when control panel makes call to user's stored phone number, voice record will be repeatedly played to notify the intrusion.

Record Alarm Voice

- ① Log on the menu, press [↓] or [↑], choose "System Settings", press [Enter].
- ② Press [↓] or [↑], choose "Alarm Message", press [Enter].
- ③ Press [↓] or [↑], choose "Record", press [Enter].
- ④ LCD display will show "Record 10s Voice" to remind you of the 10 seconds voice recording, press [Enter].
- ⑤ Start voice recording for 10s until the system stops automatically, or press [Enter] to stop recording.

3.12 Siren Setup

Users can turn on/off wired siren, wireless siren, built-in siren as well as arm/disarm beep, and set siren ringing time.

Wired Siren

Wired siren is connected to the control panel by wire.

Turn On/Off Wired Siren

- ① Log on the menu, press [↓] or [↑], choose "System Settings", press [Enter].
- ② Press [↓] or [↑], choose "Siren Setup", press [Enter].
- ③ Press [↓] or [↑], choose "Wired Siren", press [Enter].
- ④ Press [↓] or [↑], choose "Siren On/Off", press [Enter].
- ⑤ Press [↓] or [↑], choose "On" or "Off", press [Enter]
"On" is to turn on the wired siren; "Off" is to turn off the wired siren.
Default setting is "On"; the wired siren is on.

Turn On/Off Arm/Disarm Beep for Wired Siren

- ① Log on the menu, press [↓] or [↑], choose "System Settings", press [Enter].
- ② Press [↓] or [↑], choose "Siren Setup", press [Enter].
- ③ Press [↓] or [↑], choose "Wired Siren", press [Enter].
- ④ Press [↓] or [↑], choose "Arm/Disarm Beep", press [Enter].
- ⑤ Press [↓] or [↑], choose "On" or "Off", press [Enter]
"On" is to turn on arm/disarm beep for wired siren; "Off" is to turn off arm/disarm beep for wired siren.
Default setting is "On"; arm/disarm beep is on.

Wireless Siren

Wireless siren is connected to control panel through wireless connection.

Turn on/off wireless siren

- ① Log on the menu, press [↓] or [↑], choose "System Settings", press [Enter].
- ② Press [↓] or [↑], choose "Siren Setup", press [Enter].
- ③ Press [↓] or [↑], choose "Wireless Siren", press [Enter].
- ④ Press [↓] or [↑], choose "Siren On/Off", press [Enter].
- ⑤ Press [↓] or [↑], choose "On" or "Off", press [Enter]
"On" is to turn on the wireless siren; "Off" is to turn off the wireless siren.
Default setting is "On"; the wireless siren is on.

Turn On/Off Arm/Disarm Beep for Wireless Siren

- ① Log on the menu, press [↓] or [↑], choose "System Settings", press [Enter].
- ② Press [↓] or [↑], choose "Siren Setup", press [Enter].
- ③ Press [↓] or [↑], choose "Wireless Siren", press [Enter].
- ④ Press [↓] or [↑], choose "Arm/Disarm Beep", press [Enter].
- ⑤ Press [↓] or [↑], choose "On" or "Off", press [Enter]
"On" is to turn on arm/disarm beep for wireless siren; "Off" is to turn off arm/disarm beep for wireless siren.
Default setting is "On"; arm/disarm beep is on.

Built-in Siren

Built-in siren is the siren inside the control panel

Turn On/Off Built-in Siren

- ① Log on the menu, press [↓] or [↑], choose "System Settings", press [Enter].
- ② Press [↓] or [↑], choose "Siren Setup", press [Enter].
- ③ Press [↓] or [↑], choose "Built-in Siren", press [Enter].
- ④ Press [↓] or [↑], choose "Siren On/Off", press [Enter].
- ⑤ Press [↓] or [↑], choose "On" or "Off", press [Enter]
"On" is to turn on the built-in siren; "Off" is to turn off the built-in siren.
Default setting is "On"; the built-in siren is on.

Turn On/Off Arm/Disarm Beep for Built-in Siren

- ① Log on the menu, press [↓] or [↑], choose "System Settings", press [Enter].
- ② Press [↓] or [↑], choose "Siren Setup", press [Enter].
- ③ Press [↓] or [↑], choose "Built-in Siren", press [Enter].
- ④ Press [↓] or [↑], choose "Arm/Disarm Beep", press [Enter].
- ⑤ Press [↓] or [↑], choose "On" or "Off", press [Enter]
"On" is to turn on arm/disarm beep for built-in siren; "Off" is to turn off arm/disarm beep for built-in siren. Default setting is "On"; arm/disarm beep is on.

Siren Ringing Time

Set Ringing Time for All Sirens

- ① Log on the menu, press [↓] or [↑], choose "System Settings", press [Enter].
- ② Press [↓] or [↑], choose "Siren Setup", press [Enter].
- ③ Press [↓] or [↑], choose "Siren Alert Time", press [Enter].
- ④ Input the ringing time, press [Enter].
Siren ringing time is calculated as seconds, default setting is 300 seconds.
If 0 second is set, siren will not ring

3.13 User ID for CMS

Please see details at Page 29: Connect to CMS

3.14 Upload Arm Report

Please see details at Page 29: Connect to CMS

3.15 Upload Disarm Report

Please see details at Page 29: Connect to CMS

3.16 Reset

- ① Log on the menu, press [↓] or [↑], choose "System Settings", press [Enter].
- ② Press [↓] or [↑], choose "Reset", press [Enter] to reset the system to default setting.

Note!

All system settings will be restored to default setting. Reset will not delete the accessories that has already coded to the control panel.

If user forgot the admin code and cannot setup the system, please contact local distributors.

Check Event Logs

Users can check the event logs freely. 150 event logs are traceable.

- ① Log on the menu, press [↓] or [↑], choose "History", press [Enter].
- ② Press [↓] or [↑], choose the event log you need to track, press [Enter].
- ③ Relevant event log time and alarm way will be shown.

Note!

Hold [↓] or [↑] to skip the event logs.

Connect to Electronic Lock

Please ignore this if user is not intended to put this alarm as access control. This alarm only sends on/off signal to electronic door lock, please refer to related electronic door lock manual for details.

Connect to CMS Center

Please ignore this step if users don't need to connect to CMS center. When connected to CMS center, control panel will upload contact ID to CMS center automatically once intrusion is detected.

Add CMS Phone Number

When CMS center phone no. is stored, the control panel will auto dial to CMS center automatically when alarm.

- ① Log on the menu, choose "Phone Numbers", press **[Enter]**.
- ② Press **[↓]** or **[↑]**, choose "Add Phone Number", press **[Enter]**.
- ③ Press **[↓]** or **[↑]**, choose "CMS Number1" or "CMS Number2", press **[Enter]**.
- ④ Input CMS phone no, press **[Enter]**. If group extension telephone no. is used to connect to the CMS center, please add 0# or 9# before the phone no. you plan to store.

Note!

If user wants to check or edit the pre-stored phone no., enter "CMS Number1~2" to check or edit.

Delete CMS Phone Number

- ① Log on the menu, choose "Phone Numbers", press **[Enter]**.
- ② Press **[↓]** or **[↑]**, choose "Del Phone Number", press **[Enter]**.
- ③ Press **[↓]** or **[↑]**, choose in order "CMS Number1~2", press **[Enter]**.
- ④ Delete stored CMS phone no., Press **[Enter]**.

User ID

It is supplied by CMS center. After it is stored, CMS center can exactly know user's location according to the ID number.

- ① Log on the menu; press **[↓]** or **[↑]**, choose "System Settings", press **[Enter]**.
- ② Press **[↓]** or **[↑]**, choose "User ID", press **[Enter]**.
- ③ LCD display will show "Input 4 Digits", input 4 digits user ID, press **[Enter]**.

Upload Arm/ Disarm Report to CMS Center

When this function is enabled, all arm/disarm reports will be uploaded automatically to CMS center, so that CMS center can know the status of the alarm system.

- ① After the User ID is set, press **[↓]** or **[↑]** to choose "Arm Upload" or "Disarm Upload", press **[Enter]**.
- ② Press **[↓]** or **[↑]**, Choose "On", press **[Enter]**.
- ③ When choosing "Off" during setup, press **[Enter]**, arm/ disarm report will not be uploaded to CMS center.

Contact ID Reports

Event Code	Event	Event Code	Event
3401	Arm	1137	Control panel tamper alarm
1401	Disarm	1144	Sensor tamper alarm
1409	Disarm by RFID tag	1140	Normal zone alarm
1132	PIR detector alarm	1133	24H zone alarm
1131	Door contact alarm	1384	Sensor low battery
1100	Emergency call	1302	Control panel low battery
1120	Duress alarm	1301	Control panel AC failure
3456	Home mode (part arm)		

Precautions

To prevent harm to users or other people during usage of the product and to extend the lifespan of the product, please follow the precautions below:

General Instruction
The wireless accessories should be connected to the control panel before use.
Low power voltage would affect transmitting distance range.
2 cells of 3.7V/800mAh battery backup or standard power adapter for power supply.
All accessories from our company are compatible with this control panel.
Do not press SOS key if there is no emergency to avoid disturbing neighborhood.
Check the system regularly to ensure the system works properly in case of emergency.
The control panel is neither waterproof nor moisture-proof, please install it in a shady, cool and dry place.
The case of the control panel is made of ABS. Please keep it away from strong light for a longer lifespan.
Forbiddance
The control panel is non explosion-proof. Please keep it away from fire, flame sources.
Install the control panel away from objects such as heater, air conditioner, microwave oven etc. that produces heat or electric-magnetic.
Forbiddance of Decomposition
Take the control panel for disposal of recycling according to the local regulation.
Disassembly for this product can not be done by non-professionals.

FAQ

Phenomena	Cause of Malfunction	Troubleshoot Method
No response from control panel operation	Power switch is off	Open battery compartment, turn on the power
	A/C Power failure	Contact local main power supply bureau
	Lithium battery backup power exhausted	Connect to main power with adapter
Accessories cannot connect to control panel	Panel not in learning status	Make sure the panel set in learning status
	Accessories not triggered for learning	Make sure the triggered accessories transmitting signal to panel for learning
	When learning, 2 beeps are heard from panel	This means accessory has been coded already
No response from the control panel by operating remote control	Remote control is not learned to control panel	Follow the manual and connect the remote control to panel
	Out of range between remote control and panel	No more than 80 meters in open area (no interference)
		Signal repeater could be added
RFID card/tag fail to disarm	RFID car/tag not connected to the panel	Follow the work manual and code RFID card/tag to the panel
Touch keyboard fail to make related setting	Not logged onto the setting menu.	Input the correct admin code, press [Enter] and log on menu setting

Specifications

Product Name

PSTN/LCD/RFID Touch Alarm System

Model No.

CG-A11

Power Supply

Input: DC 12V 500mA, 6Wh

Standby Current

≤ 90mA

Alarm Current

≤ 300mA

Backup Battery

2 Cells of 3.7V 800mAh Li-ion Battery(BL-5B)

Internal Siren Volume

95dB

Radio Frequency

315MHz or 433.92MHz (±75KHz)

Maximum Stored Phone No.

6 alarm Phone No. and 2 CMS No.

Maximum Remote Controls

10 pcs

Maximum Sensors

50 pcs

Maximum RFID Tags

50 pcs

Maximum Event Logs

150 events

Housing Material

ABS plastic

Operation Condition

Temperature : -10°C ~ +55°C

Relative Humidity : ≤ 80% (non-condensing)

Dimension (L x W x H)

185x130x27mm

Wireless Remote Control

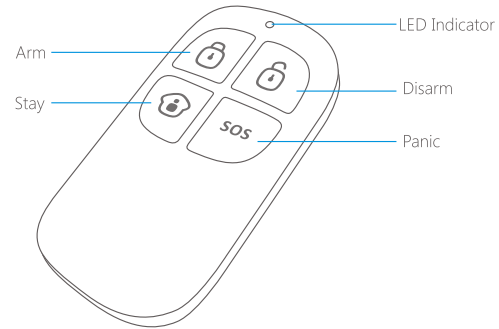

Arm





Press [Arm ] button on the remote control, the system enters Arm state when one beep is heard and the Arm LED Indicator lights on.

Note! If Exit Delay is activated, all zones except the 24-hour zone will enter Arm state after the set delay time.

The delay sensors will be armed after delay time.

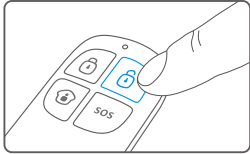
Disarm





Press the [Disarm ] button on the remote control, the system enters Disarm state when two beeps are heard and the Arm LED Indicator goes out.

When alarm is activated, the siren will hoot. Press the [Disarm ] button, the system is disarmed after two beeps are heard, and the Disarm LED Indicator lights on. But the LED indicator of triggered zone keeps flashing for further checking.

Press [Disarm ] button again, the alarming zone indicator goes out.

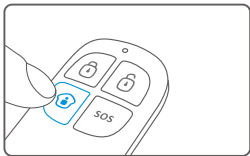
Home Mode



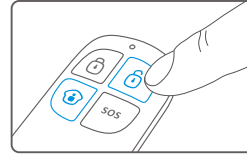

Press [Stay ] button on the remote control, the system enters Home Mode when one beep is heard and the Home Mode LED Indicator lights on. All the Normal Sensors are armed except the Home Mode Sensors which are disarmed so that users can move freely at home.

Mute Mode



When arm or disarm the system, the control panel will beep once or twice. If siren beep is not needed, operation as follows:

Press and hold the [Stay ] button on the remote control for 1 second, then press [Arm ] or [Disarm ] button within 3 seconds. The system is armed or disarmed in mute without disturbing other people.

Emergency Call

SOS

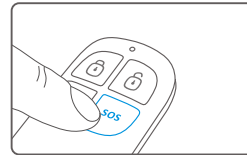

In any condition, once the [SOS] button on the remote control is pressed, the system goes into emergent alarming state with siren hooting, meanwhile the panel will auto dial pre-stored alarm phone numbers.

Wireless Door/Window Contact

Features

The DWC-102 is a Door/Window Contact that can be installed on doors, windows, and any other objects that open and close. The sensor transmits signals to the control panel when a magnet mounted near the sensor is moved away. External input for wired accessory is available at the N/C interface. The tamper protection ensures that sabotage attempts to move the contact will result in an alarm activation.

Appearance

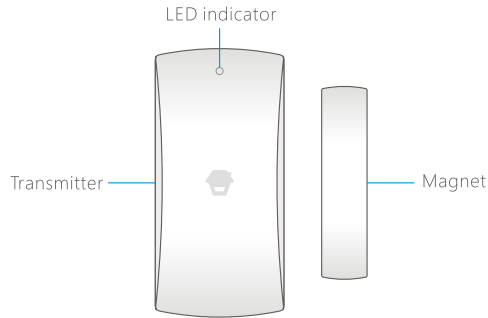

LED Indication

LED flashes once: Door/window is opened and transmitter sends signal to the control panel.

Flash once per 3 seconds: Low power indication, please change battery as soon as possible.

PCB Layout

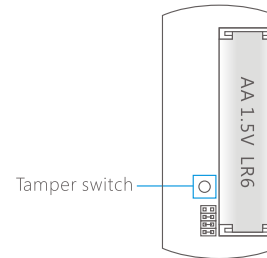

Installation & Notice

- Remove the battery activation strip, the sensor will enter working state immediately.
- Mount the sensor on the door frame and the magnet on the door.
- Make sure the magnet is on the right side of the transmitter
- Place the transmitter in the desired location, mount the magnet no more than 1cm away from the transmitter and secure the transmitter and magnet with double-sided tapes or screws.
- Avoid mounting sensors in areas with a large quantity of metal or electrical wiring, such as a furnace or utility room.

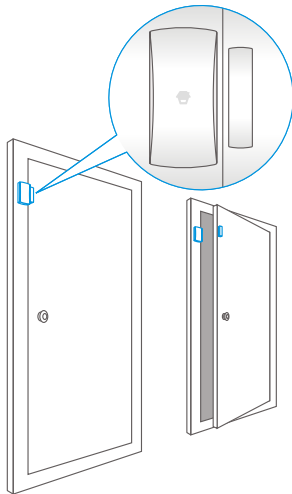

Specifications

Power supply

DC 1.5V (AA 1.5V LR6 Battery x 1pc)

Static current

$\leq 35\mu\text{A}$

Alarm current

$\leq 40\text{mA}$

Transmitting distance

$\leq 80\text{m}$ (in open area)

Radio frequency

315MHz or 433.92MHz ($\pm 75\text{KHz}$)

Housing material

ABS plastic

Operating Condition

Temperature $-10^{\circ}\text{C} \sim +55^{\circ}\text{C}$

Relative humidity $\leq 80\%$ (non-condensing)

Transmitter dimensions (L x W x H)

71 x 34 x 17.5mm

Magnet dimensions (L x W x H)

51 x 12 x 13.5mm

Pet-Immune PIR Motion Detector

Features

PIR-910 is a high performance wireless P.I.R. motion detector. It consists of digital dual-core fuzzy logic infrared control chip and intelligent analysis which effectively identify interference signals from body movement signals and reduce false alarm rate. With automatic temperature compensation and anti-air turbulence technology, it easily adapts to environmental changes. The detector also has the advantages of energy saving, reliability and easy installation. The detector features pet immunity for small animals up to 25kgs.

Appearance

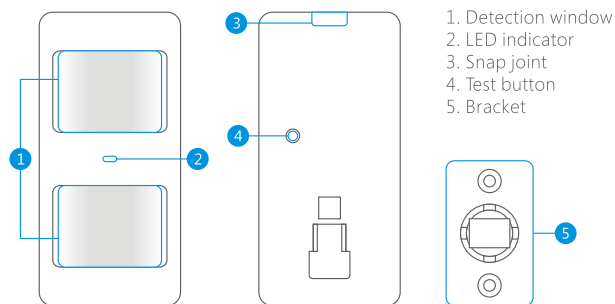

LED Indication

Display	Meaning
Blink continuously	Self testing
Blink once	Intrusion detected
Blink twice	Testing mode is finished, the detector enters power-saving mode
Blink once every 3 seconds	Low battery, please replace the battery as soon as possible

PCB Layout

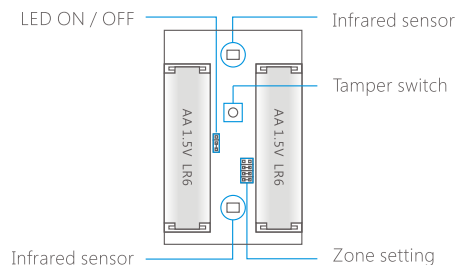

Infrared sensor: It detects the infrared rays released by human body motion, please don't touch the surface and always keep it clean.

Tamper switch: Once the case is opened in working state, the tamper switch will be triggered and then generates an alarm signal.

Working Mode

Testing mode

After self-testing, the detector enters testing mode, and detects once every 10 seconds. After 3 minutes, the LED blinks twice, and the detector enters power saving mode.

Hold the test button and load the battery, then release the test button, the detector stands in testing mode, it keeps detecting once every 10 seconds. Exits this status by reloading the battery without holding the test button.

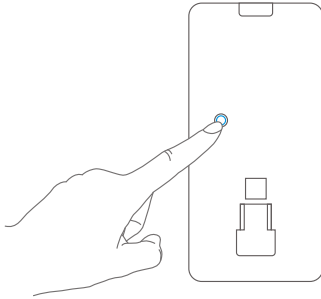

Power saving mode

The product features power-saving design. If the detector detects human movement twice in 3 minutes, it will switch to the sleeping state to save power. At this time, the LED will not blink even human movement is detected, and no alarm. After no movement within the next 3 minutes, the detector switches back to the working state automatically.

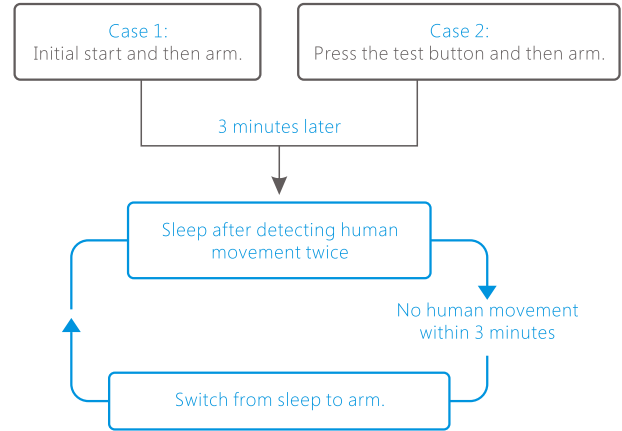

Note: After the detector is in the sleeping state, ensure no human movement within 3 minutes; otherwise, the detector remains sleeping.

In the sleeping state, it is recommended that you leave the room after arming the system. Ensure no human movement in 3 minutes. Then, go into the room, the system alarms immediately.

Installation

Choose a suitable installation location

It is recommended to mount it at the height of 2m from the ground.

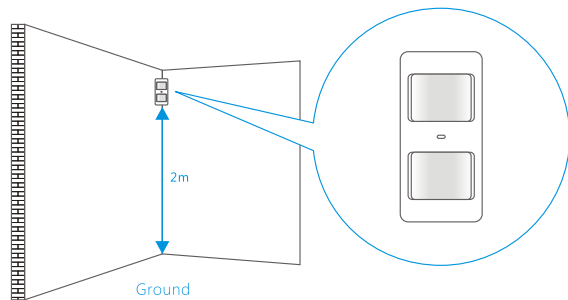

Fix the detector

Fix the bracket on the wall with screws and attach the detector to the bracket.

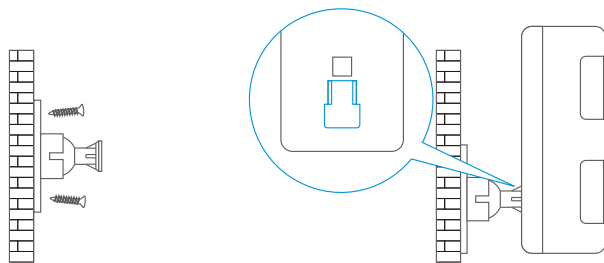

Test the PIR motion detector

Press the test button at the back. It switches to the testing mode and sustains for 3 minutes. Walk in the detection scope and observe the LED. When body movement is detected, the LED blinks once.

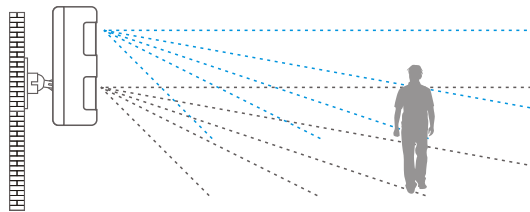

Adjust the angle

Adjust the bracket angle to achieve the best detection effect.

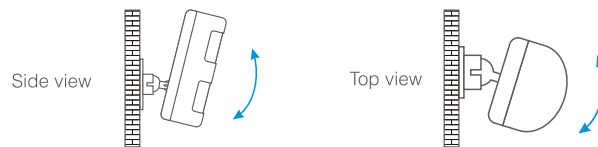

Note! If pet-immune function is applied, please do not adjust the angle up or down, but keep it parallel with the wall

Detection Scope

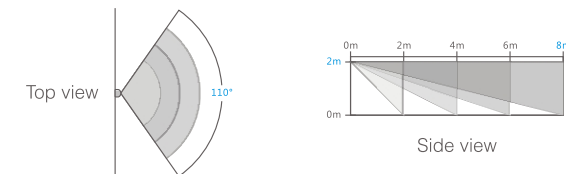

Installation Notices

Mount the detector to a location close to the entry or exit

The detector aims at preventing intrusion. Detecting human movement at the entry or exit is critical for security.

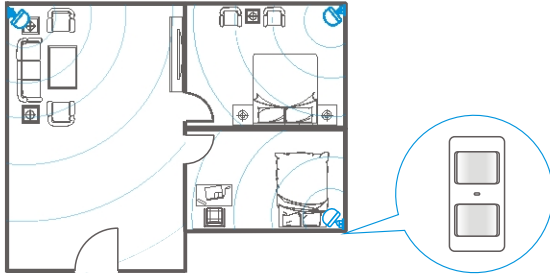

Mount the detector in a proper angle

The installation angle affects detection sensitivity. The sensitivity is optimal when the walk direction is vertical to the infrared direction. Choose the best location and angle according to the actual situation and detection scope diagram.

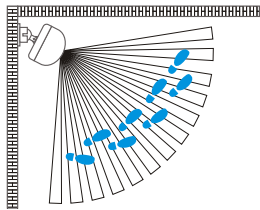

Don't face to glass windows or doors

Strong light interferes with detection sensitivity. In addition, complicated situations, such as traffic flow, stream of people, also should be avoided.

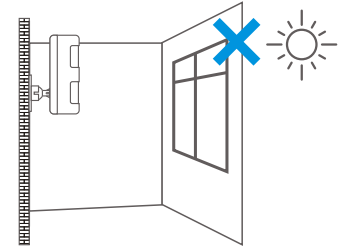

Don't face to or position close to heat sources

Heat and cold sources, such as heat extraction units, heaters, air conditioner, microwave oven, refrigerator, which may cause false alarm, should be avoided.

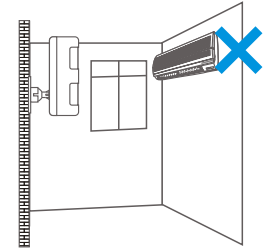

Don't face to swinging objects

Swinging objects may also trigger false alarm. Besides, if there are two detectors covering the same scope, adjust the locations to prevent cross-interference.

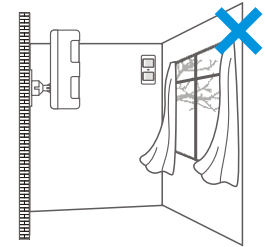

Specifications

Power Supply

DC 3V (AA 1.2V LR6 Battery x 2 pcs)

Static Current

≤ 90uA

Alarm Current

≤ 9.5mA

Detection Scope

8m/110°

Pet Immunity

≤ 25kg

Transmitting Distance

≤ 80m (in open area)

Radio Frequency

315MHz or 433.92MHz (± 75KHz)

Housing Material

ABS plastic

Operation Condition

Temperature: -10°C~+55°C

Relative Humidity: ≤80% (non-condensing)

Detector Dimensions (L x W x H)

108 x 52 x 36.8 mm

Bracket Dimensions (L x W x H)

52 x 30 x 26.5 mm

CHUANGO®

产品型号	CG-A11	部件名称	说明书
设计	林寿	材料	80克书写纸
印刷尺寸	210X142mm	成品尺寸	105X142mm
工艺	骑马钉-56P	版本	PA: OI-A11-EN-1403-V1.4-2

注:
双色、双面印刷