



Virga, brushed aluminum



Virga, black anodized aluminum

A clean, minimal fixture executed without compromise. The very simple and sleek down light bar can be installed in very close proximity to its user – and withstand close scrutiny.

Nick Sheridan
Designer

Virga linear pendant

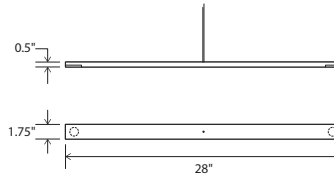

Dimensions: 28" x 1.75", 0.5"
 Materials: aluminum, polymer
 Product weight: 6 lb
 Light source: integrated LED
 Light output: 1126 Lumens (source)
 Light color: 2700 K or 3500 K
 Color accuracy: 90+ CRI
 Power usage: 13 W
 Dimmable (see driver below)
 Extended-profile square canopy included, required to house LED driver (3.25" x 2.25" x 1.25")
 Canopy dimensions: 4.5" x 4.5", 1.63"
 Canopy finishes Brushed Aluminum (CM-006) and Textured Black (CM-049)
 See website for more canopy information
 48" suspension tube (can be shortened in field)
 Swivel option available for sloped ceilings, see drawing below
 Specifications subject to change



MATERIAL & FINISH OPTIONS

Virga part # 06-130-

Metal Finish	Code
brushed aluminum (CM-006)	A
black anodized aluminum (CM-007)	B

Lamping	Code
2700 K LED	27
3500 K LED	35

Driver	Code
AC Input Voltage Range: 120-277 V 120 V input: TRIAC, ELV & 0-10 V dimmable 240 & 277 V input: only 0-10 V dimmable	P1

Includes
 polymer shade (CM-052)

Available for sloped ceilings:
 Sloped Extended-Profile Square Canopy

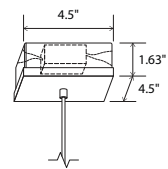

extended-profile square canopy
 brushed aluminum



brushed aluminum (CM-006)



black anodized aluminum (CM-007)

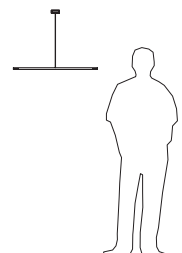
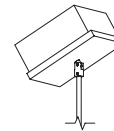

⚠ WARNING. California Proposition 65 Warning for California Consumers. This product can expose you to chemicals including wood dust and lead which are known to the State of California to cause cancer or birth defects or other reproductive harm. For more information go to www.P65Warnings.ca.gov