



—Orseolo  
Ceiling lamp 213 D GR.A

## —Orseolo

Design Sylcom LAB

— La luce si fa geometria cristallizzandosi in forme essenziali che garantiscono un pacato valore estetico e una pratica funzionalità progettuale. Il minimalismo delle superfici si anima di matericità e le infinite gradazioni sono intensificate per mezzo dell'applicazione della graniglia di vetro tono su tono. Le caratteristiche sfumature opache sono ottenute per mezzo della sabbiatura che riveste di pigmenti vitrei la superficie trasparente del diffusore.

— The light becomes an essential geometric element that combines versatility of design with serene aesthetics. The minimalist surfaces are enhanced by infinite nuances whose effect is achieved by applying tone-on-tone glass grit. The distinctive opaque hues are achieved with a sandblasting process, which involves coating the diffuser's clear surface with glass pigments.



—Orseolo  
Wall lamp 210 D ORO

Orseolo

Finitura Metallo / Metal Finishes

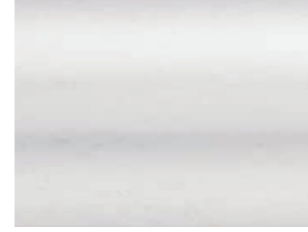

**B**  
Bianco  
White

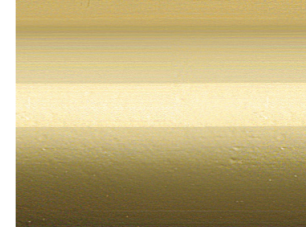

**D**  
Dorato lucido  
Polish gold

Finitura Vetro / Glass Finishes

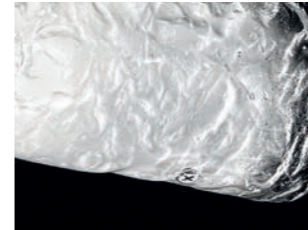

**CO**  
Cristallo Opaco  
Opaque Clear

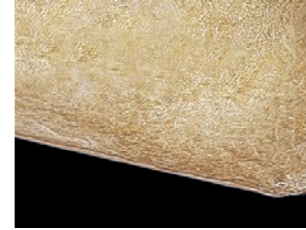

**GR.A**  
Graniglia Ambra  
Amber Graniglia



**ORO**  
Oro 24 Kt  
24Kt Gold



**210**  
1 x MAX 42W E14



**211**  
2 x MAX 70W E27

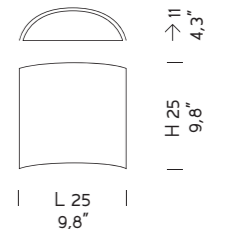

**212**  
2 x MAX 42W E14

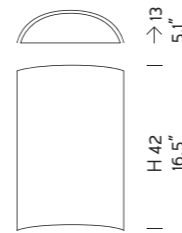

**213**  
2 x MAX 70W E27

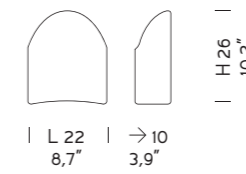

**214**  
1 x MAX 70W E27

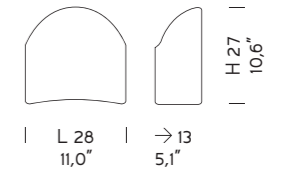

**215**  
2 x MAX 70W E27