

**B370**



HUBBARDTON FORGE®

---

ASSEMBLY & INSTALLATION INSTRUCTIONS

# ASSEMBLY & INSTALLATION INSTRUCTIONS

Umbra Sconce 302810 & 30812

**B370**

## CONTENTS

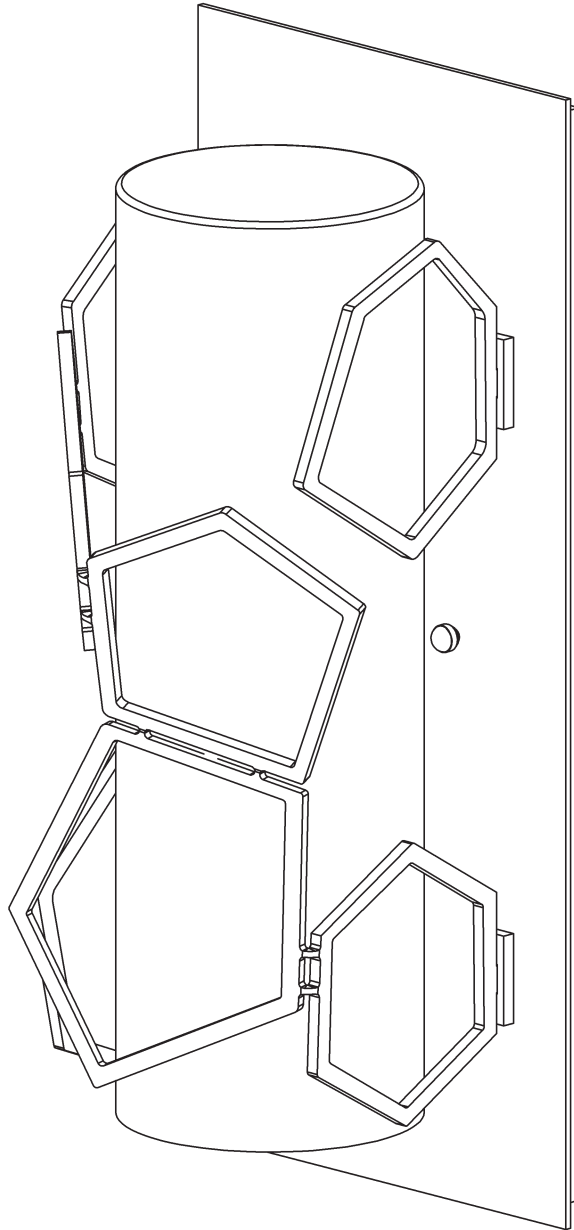

HUBBARDTON FORGE.

MODERN AMERICAN BLACKSMITHS | FINE, HAND CRAFTED LIGHTING  
CASTLETON, VERMONT USA | HUBBARDTONFORGE.COM

37292

## Component Parts

- A Fixture**
- B Crossbar**
- C Ground Screw**
- D Threaded Stud (2)**
- E Knurled Ball (2)**
- F Glass**
- G Bulb (not included)**



# ASSEMBLY & INSTALLATION INSTRUCTIONS

B370

Umbra Sconce 302810 & 30812

**CAUTION: FAILURE TO INSTALL THIS FIXTURE PROPERLY MAY RESULT IN SERIOUS PERSONAL INJURY OR DEATH AND PROPERTY DAMAGE.** We recommend installation by a licensed electrician. This product must be installed in accordance with applicable installation code(s), by a person familiar with the construction and operation of the product and the hazards involved.\*

Caution: Do not exceed maximum wattage noted on fixture. Use only recommended bulbs with fixture.

Please Note: After installation extra hardware and accessories are possible due to our kits are used on multiple products and options.

## To Install Fixture (Figures 1 & 2)

**CAUTION: BE SURE POWER IS OFF AT THE MAIN BREAKER BOX PRIOR TO INSTALLATION.**

1. Carefully unpack the fixture (A) from the carton.
2. Thread two studs (D) into the appropriate holes in the crossbar (B) that align with fixture (A) and will allow fixture to be vertical when installed.
3. Using two machine screws (not provided) attach crossbar (B) to the electric box using outer oval holes to orient fixture.

**Note:** A new electric box comes with screws. When replacing a fixture, retain the existing screws for use with the new fixture.

4. Adjust the studs (D) to proper length to ensure the fixture (A) will fit snugly against the wall.
5. Using suitable wire connectors (not provided) connect fixture wires to supply (white to white and black to black). Attach a pigtail lead to the crossbar ground screw (C). Connect all ground wires (bare copper or green to bare copper or green).

**CAUTION: MAKE SURE WIRE CONNECTORS ARE TWISTED ON SECURELY AND NO BARE WIRES ARE EXPOSED**

6. Apply a generous bead of a suitable caulking material to caulking lip on the fixture (A). (Figure 2).
7. Carefully tuck all wires behind fixture (A), push fixture (A) firmly against the wall and fasten by threading knurled balls (E) on to studs (D).
8. Install light bulb (G) (not included).
9. Slip glass (F) over bulb (G) until it rests on fixture.
10. Restore electricity at main breaker.

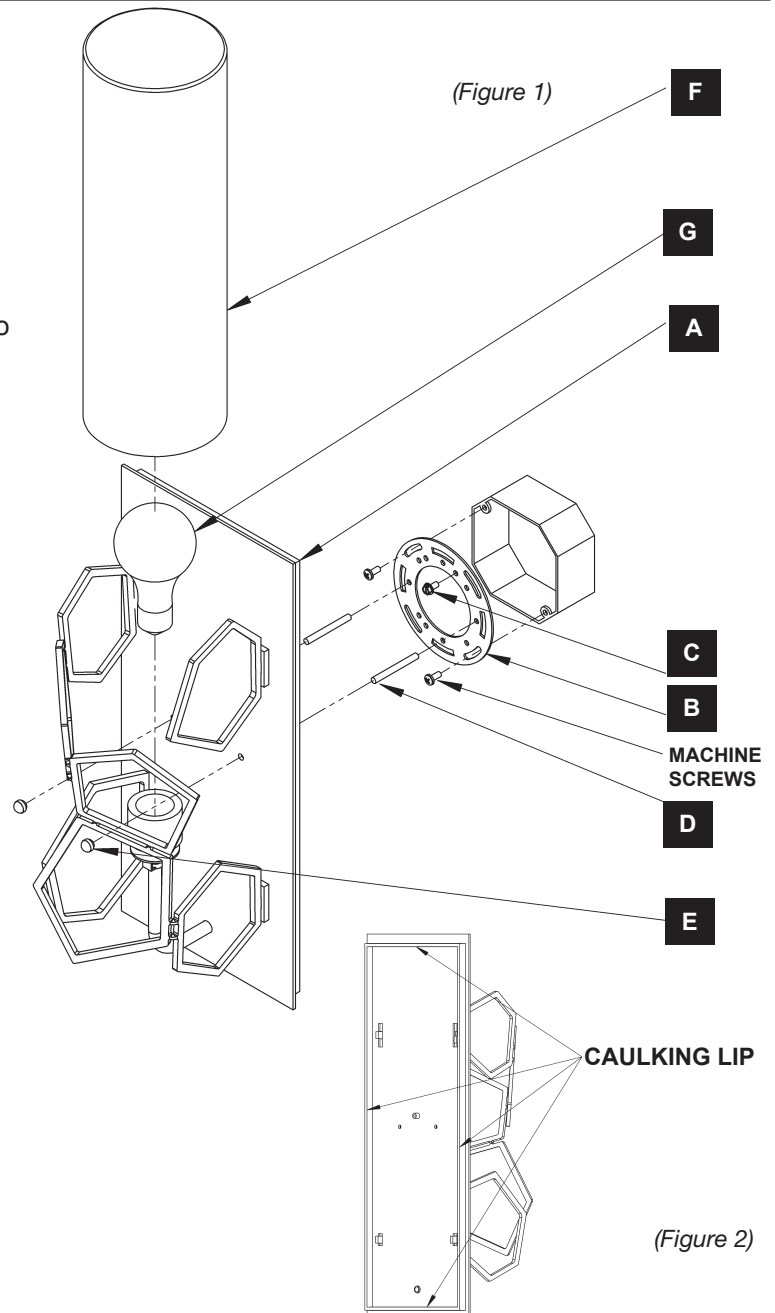

If you need further assistance, or find that you are missing any parts, please contact the dealer from which you purchased this product. We hope you enjoy your fixture!

\* Hubbardton Forge will not be liable for injury or damage caused by improper installation, lamping or use of this fixture.

**HF** HUBBARDTON FORGE.

MODERN AMERICAN BLACKSMITHS | FINE, HAND CRAFTED LIGHTING  
CASTLETON, VERMONT USA | HUBBARDTONFORGE.COM

37292