

**UPUL1120**  
**UPUL2120**

Design by Timo Ripatti

Collection consisting of wall lamps, ceiling lamps and suspended lamps in aluminum.  
Available in several colors and sizes.

Typology: WALL, CEILING LAMP

**Ratings**

- Built in **LED** module
- CCT 3000 K
- Uplight (towards surface)
- Installs over 4 in. octagonal J-box (support independently)
- Power supply 120/277V AC
- Switch mode: on-off
- Dimmable 1-10V LED driver
- Painted aluminum profile 23 x 23 mm
- Opalescent diffuser

**UP UL 1 120 h10 cm canopy**  
**UP UL 2 120 h25 cm canopy**

*h10cm lb 14.55 ft³ 6.35*  
*h25cm lb 15.43 ft³ 6.35*

**Product code composition**

U-LIGHT / h10 cm - 3 7/8" or h25 cm - 9 7/8" ceiling lamp with canopy / DRIVER INCLUDED

Type	Article	Colours	Version	Source
UP	UL 1 120 LED (h10 cm)	AN anthracite grey	XX standard canopy	LED 86.2W - diffused beam <b>3000K*, 2700K</b> other CCT available upon request
	UL 2 120 LED (h25 cm)	RU rust brown		

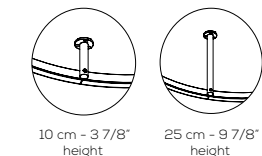
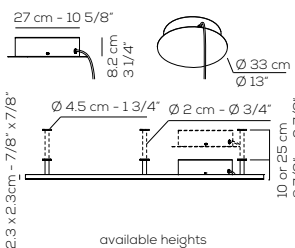
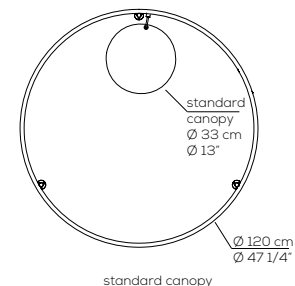

DRY LOCATION CRI90 120/277VAC
 
 ~ 7354 lm 85 lm/W

Application: both as ceiling (downlight or uplight mounting) or wall lamp (only wallward light).

example composition code **UP UL1120LED RU XX**

sound absorbing option - see page xxx

**Available colors**

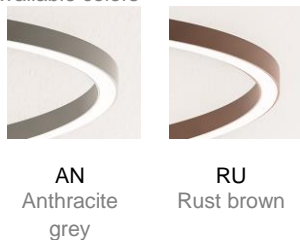

UPUL \_ 120LED \_ \_ XX      CUSTOMER \_\_\_\_\_      NOTES \_\_\_\_\_

\_\_\_\_\_

Luminous flux for all built-in LED luminaires is shown at source level.  
Technical data could be subject to alteration without notice. Axo Light does not provide legal guarantee for the accuracy of this data sheet.