

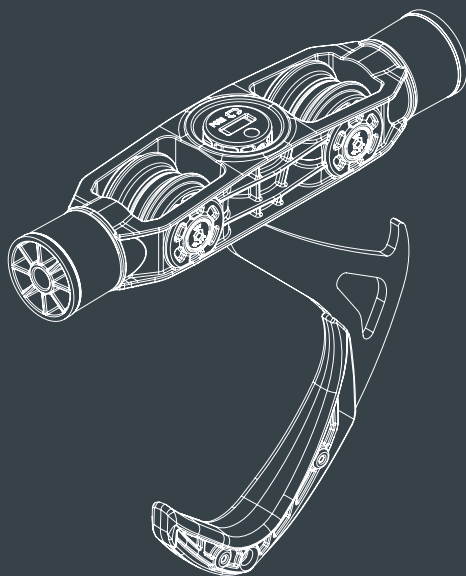

STASHED



SPACERAIL BIKE HOOK

INSTRUCTION MANUAL

—
VERSION .02





LIFE

Great kit helps us to live
the lifestyle we choose

STORED

We create space saving storage
and access for your kit

BETTER

Innovative, effective and well
designed storage systems



➔ STASHED

Thank you for purchasing this product.

Stashed Products was established to improve the lives of people just like you and me.

Our vision is to save you space by giving you a system to store your precious kit and keep it secure.

We believe in quality products that are built to last. Our hardware is designed, tested and manufactured in Wales. It is assembled by people who care about life balance, your kit and the environment.

Stashed has a passion for quality engineering, innovation and beautiful aesthetics.

We hope you enjoy using your product as much as we did making it.

Stashed Products Team





QUICK START

① 1. MEASURE BIKE WIDTH AT FRONT AXLE

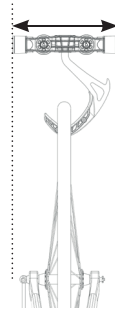
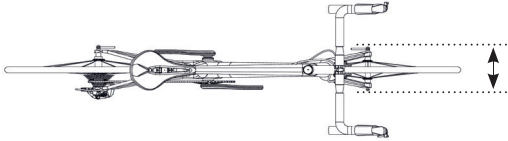

② 2. ADD SPACERS IF REQUIRED

BIKE WIDTH	CENTRAL HOOK	FIRST/LAST HOOK
<150mm →	 No Spacer	 No Spacer
>150mm →	 2 x Spacers	 1 x Spacer (side to other bike)

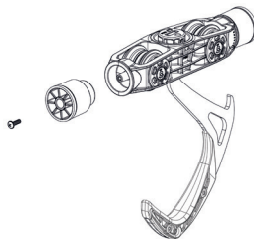



➔ 3. REMOVE END CAP FROM SPACERAIL

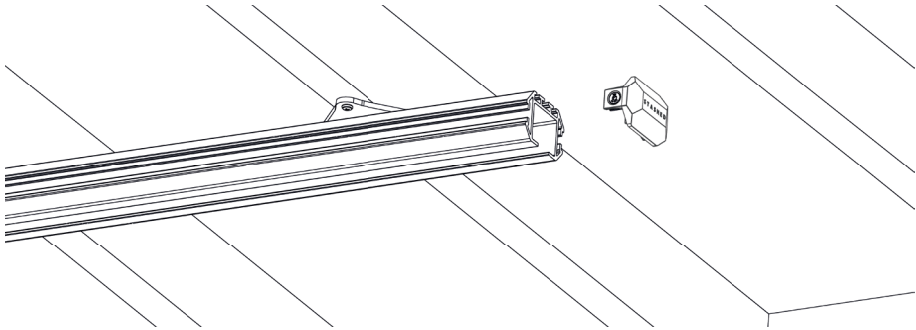

➔ 4. INSERT BIKE HOOK INTO RAIL AND REPLACE END CAP

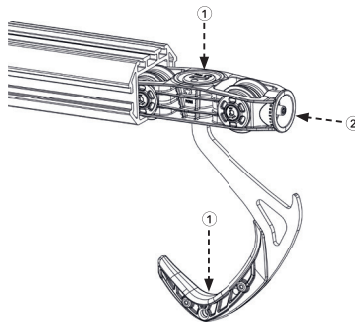

➔ 5. HANG BIKE, COAT AND HELMET - MAX LOAD 30KG

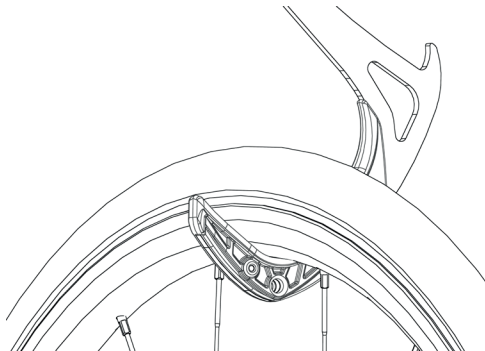



④ 6. ROTATE AND SLIDE BIKES

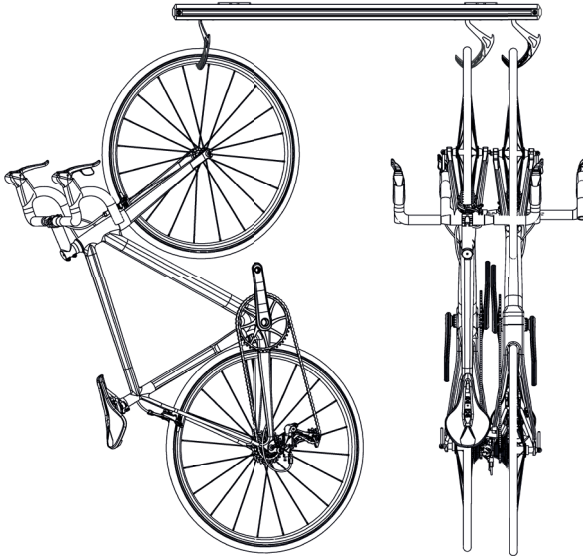

④ 7. OVERLAP BIKES - BE AWARE OF PEDALS AND HANDLEBARS

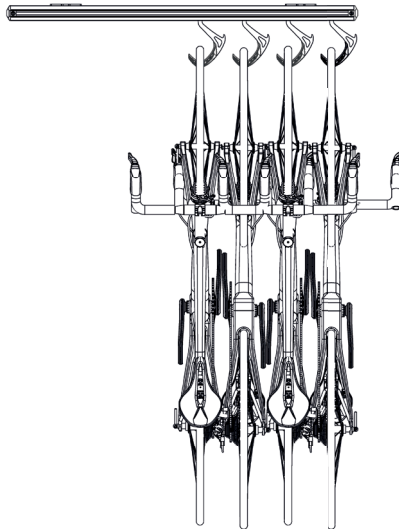



CONTENTS

Stashed Products	1
Quick Start	2
General Notes	6
Tools required	6
Technical Specification	7
Warnings	8
Parts Identification	9
Key Features	10
Adjust Trolley Width	12
⌚ Measure bike width	12
Install Spacers if required	13
⌚ Central bikes	13
⌚ First/last bikes	13
Fit Trolley to Rail	15
Storing Your Bike	16
⌚ Mechanism unlock	16
⌚ Mechanism lock	17
⌚ Moving with a bike	17
⌚ Moving without a bike	18
⌚ Best hanging method	18
FAQ	20
Warranty>Returns	20
Maintenance	21
Periodic Checks	21



GENERAL NOTES

These instructions are for the SpaceRail Bike Hook only. Please refer to your other products for their own instructions.

Your Bike Hook can be fitted in just a few minutes, however please take time to fit it correctly and understand its function, best use methods and limitations.

Ensure the SpaceRail is fitted according to the SpaceRail instructions. If this is done incorrectly, it will stop the Bike Hook running correctly and reduce the performance of the system. This could potentially lead to the system not holding the loads stated.

If you are unsure on how to fit or use this product, please ask our experts or look for fitting examples and instruction videos on our website.

We are always here to help.

www.stashedproducts.co.uk

TOOLS REQUIRED

As part of our sustainability policy we do not supply low-quality single use tools with our products. We anticipate you will already have the majority of the tools you need to install this product, but if you don't then you can buy tools from our website.

Tools Required for Spacers:

- No.2 Pozi Screwdriver

Tools required for SpaceRail access:

- 4mm Hex Key



TECHNICAL SPECIFICATION





- Min Load Rating to unlock mechanism = 5kg
- Max Load Rating = 30kg
- Width spacing from 150mm to 200mm
- Can also be used to hang spare components such as wheels and frames or other sports equipment such as backpacks and child carriers.
- Two bikes can be hung in series if vertical space allows, but observe the maximum loadings of the Bike Hook and SpaceRail.
- Suitable for internal or external installation. All fasteners are stainless steel, so will not rust and will look like new for years to come.
- Materials: Stainless Steel, Acetal, Nylon

⊕ SUITABLE FOR ALL BIKES:

- Any bike frame size
- Tyre size up to 3"
- Rim with tyre combined depth up to 95mm
- Any tyre type such as road, gravel, hybrid, mountain bike, children's and E-bikes
- All brake types
- All rim materials
- With or without mudguards
- Hung from the front or rear wheels.



WARNINGS

- Objects can fall from the Bike Hook if not correctly hung.
- Be careful when moving your bikes! The Bike Hook is tuned to have some friction to reduce the chances of accidental movement; but be aware that bikes may move unintentionally
- If you are concerned with contact between bikes when stored then we recommend our Pedal Wraps products. Please see our website.
- Observe the minimum and maximum load ratings for the Bike Hook and the SpaceRail system.
- Do not hang your bike with the tyre valve next to the hook as this could cause damage to the valve.
- Bikes are heavy awkward objects. Before attempting to use this product ensure you are physically able to lift and control the bike during hanging and un-hanging.
- Never move the Bike Hook without loading and unlocking the mechanism, as this will cause damage.
- The Bike Hook is not suitable for shock loading. Gently place objects on to the Bike Hook; do not drop them on.
- Check bike is safe for use and all hanging adapters have been removed every time it is taken off the SpaceRail.
- Not to be used by Children or as a toy.
-  NEVER USE FOR HUMAN SUSPENSION!
-  ALTHOUGH THE BIKE HOOKS ARE SELF-SPACING, CARE IS STILL NEED TO MOVE AND OVERLAP BIKES TOGETHER
-  WARNING: ONLY HANG BIKES ON THE CENTRELINE OF THE HOOK. DO NOT HANG HEAVY OBJECTS ON THE HANGER (OFF CENTRELINE), AS THIS CAN DAMAGE THE RAIL DURING HOOK MOVEMENT.
-  WARNING: CANCER AND REPRODUCTIVE HARM. SEE WWW.P65WARNINGS.CA.GOV

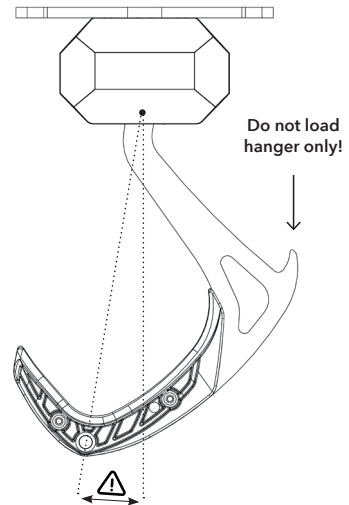



PARTS IDENTIFICATION

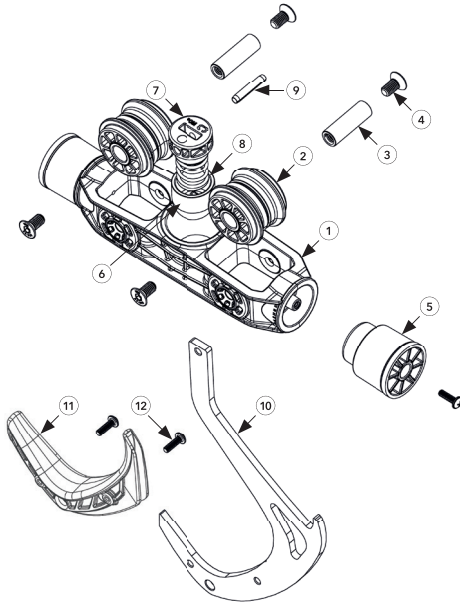

1. Trolley Body
2. Wheel
3. Axle
4. Axle Bolt
5. Spacer
6. Bullet
7. Top Cap
8. Spring
9. Roll Pin
10. Hook
11. Hook Cover
12. 3.5mm x 12mm Screw

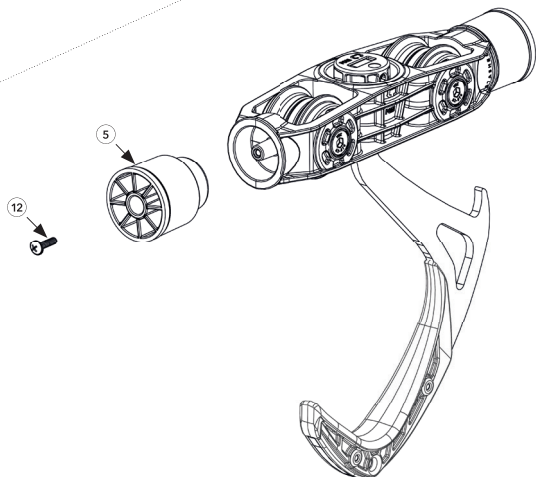



KEY FEATURES

⊕ BIKE INTERLOCKING

- The SpaceRail Bike Hook enables bikes to be hung, slid and rotated so they can be overlapped together to significantly increase storage space.
- Most bike storage systems suspend bikes at 300-500mm centrelines. With the SpaceRail system, centrelines down to 150mm are possible to reduce storage volume.
- The bikes can be moved apart to allow access to take them out of storage and brought back together for improved security options.

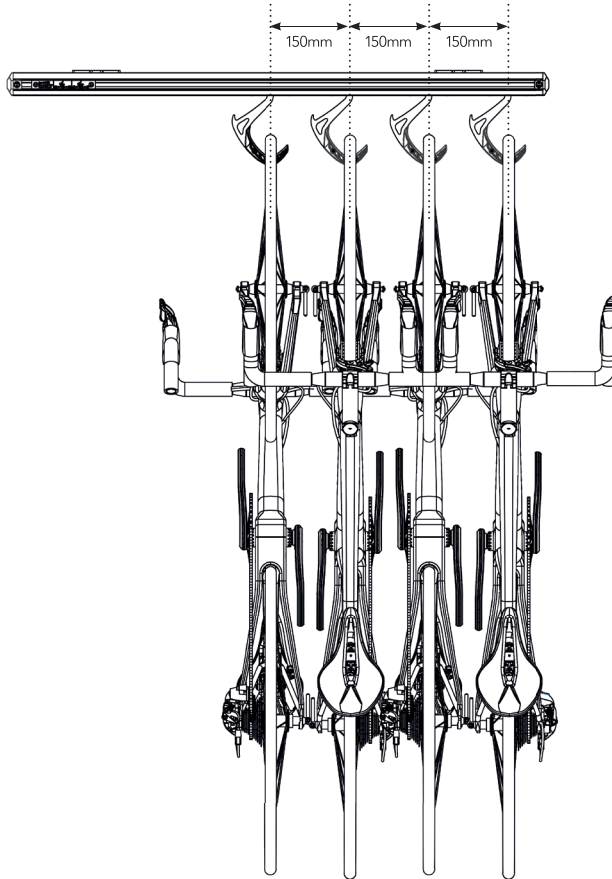



⊕ HOOK AUTO-LOCK

- To increase the ease of hanging and reduce the chances of fumbling, the Hook will auto-lock when load is removed and will stay stationary until you hang your bike.
- When loaded above 5kg the Hook will slide and rotate freely 360°.

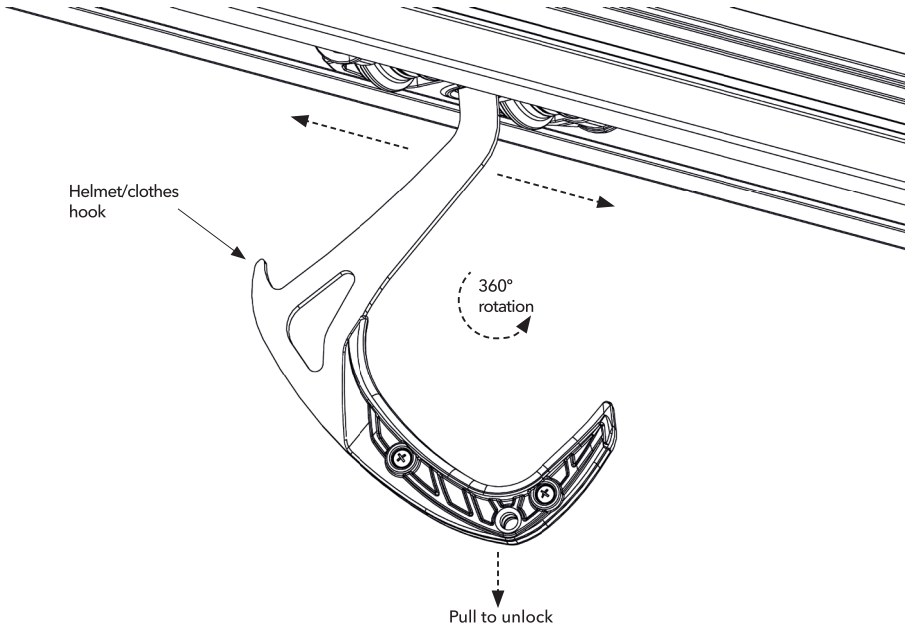

⊕ HOOK ARTICULATION

- To ensure Rail or Trolley damage does not occur during loading, the hook is able to move away from impact forces.

⊕ HELMET AND CLOTHES HOOK

- The back of the hook can be used to hang coats, helmets and accessories.

⊕ TROLLEY SPACERS

- To reduce the chance of contact and damage between your bikes, the width of the trolley can be adjusted to ensure a suitable spacing.



ADJUST TROLLEY WIDTH

→ Your Trolley can be configured in width to suit each bike and reduce the chances of damage from compact storage.

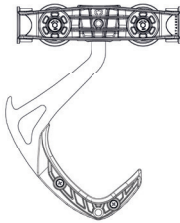

**150MM
SYMMETRIC**

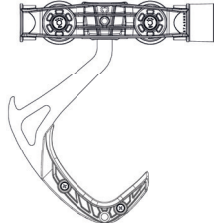

**175MM
ASYMMETRIC**

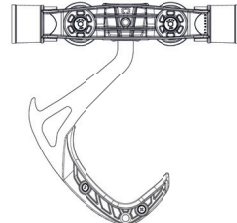

**200MM
SYMMETRIC**

⊕ MEASURE BIKE WIDTH

→ Measure the widest point of your bike at the front wheel axle, as this will determine if the Trolley requires Spacers to keep it apart from other bikes during storage.

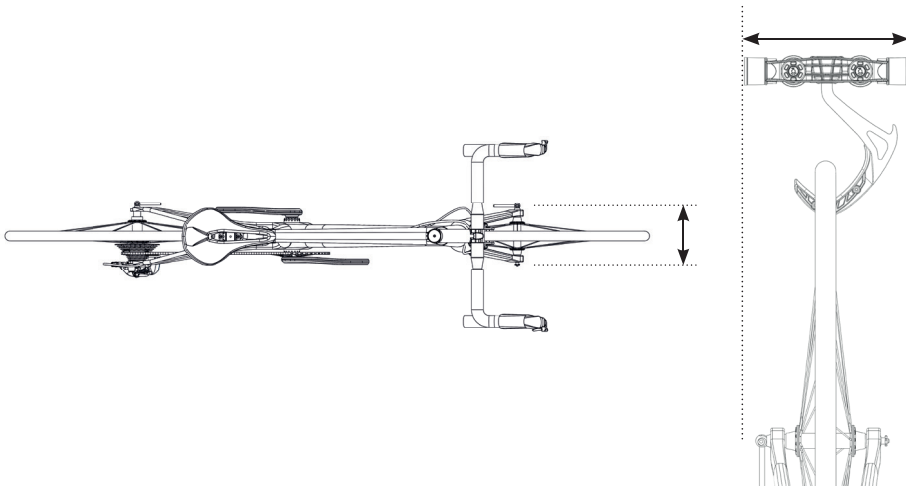



INSTALL SPACERS IF REQUIRED

→ CENTRAL BIKES

If the Trolley is to be used in a central position i.e. with a Trolley either side, then it is recommended:

- No spacers are used if bike width is less than 150mm.
- Spacers be used on both ends if bike width is above 150mm.

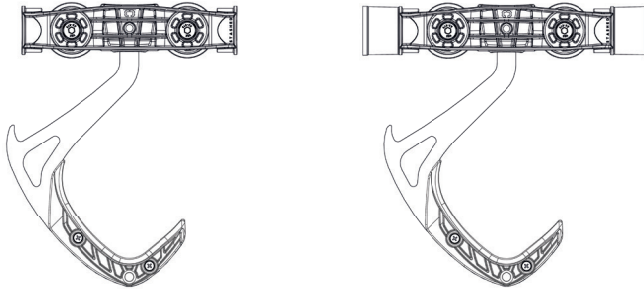



→ FIRST/LAST BIKES

If the Trolley is to be used in the first or last positions i.e. with a Trolley on one side only, then:

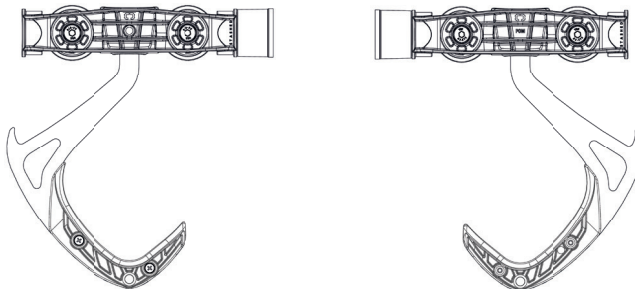
- No spacer is required on the side against the **End Cap** as this will maximise the usable length of the **Rail**.
- One **Spacer** should be installed on the side facing another Trolley if bike width is above 150mm.



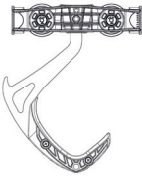

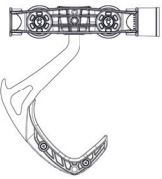
BIKE WIDTH		CENTRAL HOOK	FIRST/LAST HOOK
<150mm	→	 No Spacer	 No Spacer
> 150mm	→	 2 x Spacers	 1 x Spacer (side to other bike)

→ Attach Spacers using the 3.5mm x 12mm Screw with a No.2 Pozi screwdriver.

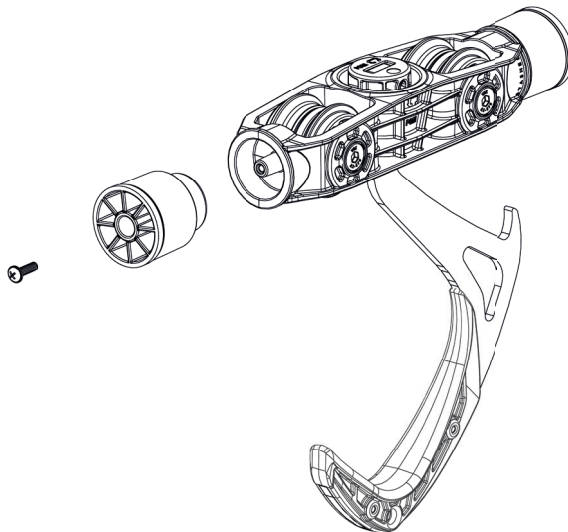



FIT TROLLEY TO RAIL

- Remove Rail End Caps from Rail using a 4mm Hex Key.
- Insert Trolley into the Rail by aligning and inserting the first wheel into the opening in the Rail. Pull down on the Hook mechanism whilst supporting the Trolley and push the remainder of the Trolley in whilst continuing to hold the Hook down.
- If the Trolley will not go in then the mechanism is not pulled down fully and the Top Cap is blocking entry.

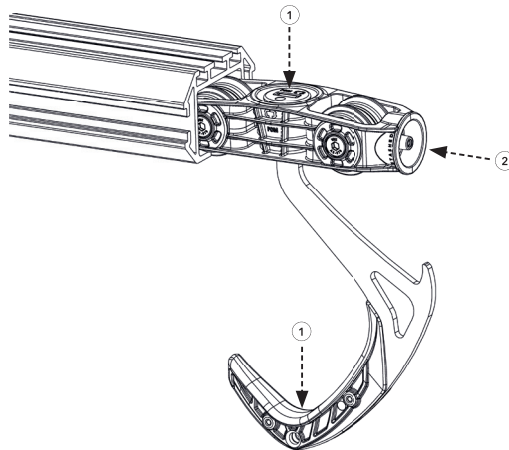

- Pull hook down and ensure the Trolley runs freely and smoothly the whole length of the Rail.
- Refit the Rail Ends Cap. Slide End cap into rail end and equally tighten Bolts to 2.5Nm.

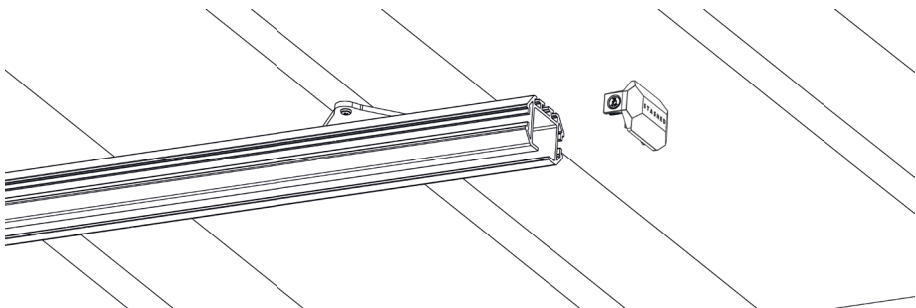



STORING YOUR BIKE

The Trolley is auto-locking to ensure it is stable when bikes are being loaded on to it. When the Hook is unloaded it is sprung against the inside of the Rail to stop rotation and sliding. Without this mechanism the Trolley would move when touched with the bike wheel and be considerably harder to use.

⚠ Warning: Do not hang your bike with the tyre valve near the hook as this could cause damage to the valve.

- Before hanging your bike, ensure the Hook is orientated in a direction that makes it easiest to hang by pulling down on the Hook and rotating it to the desired position. Ensure the area around the Hook is clear so nothing obstructs hanging.
- Make sure the wheel is secured properly in the bottom of the Hook once loaded.

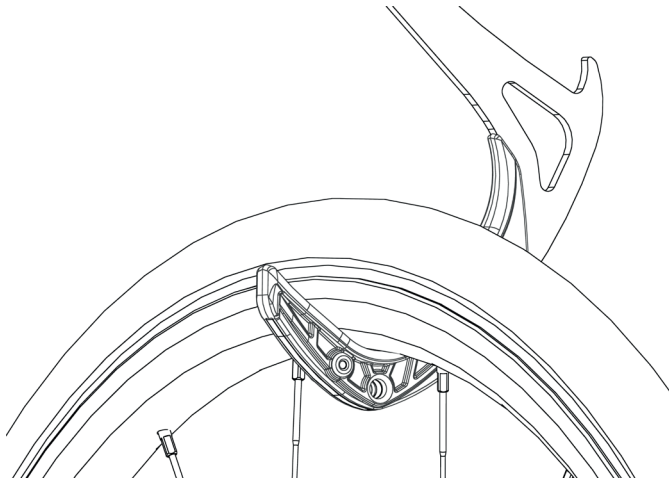

⊖ MECHANISM UNLOCK

- To unlock the mechanism simply load your Bike on to the Hook and it will become free to slide and rotate. The minimum bike weight is 5kg; any bikes below this will not activate the automatic release.

⚠ WARNING: DO NOT MOVE THE BIKE HOOK ALONG THE RAIL WITH LESS THAN 5KG LOAD APPLIED!



➔ MECHANISM LOCK

- The Hook will automatically lock when the bike is removed, preventing it from sliding and rotating. When locked it will still maintain some degree of articulation to stop damage through fumbled loading.

➔ MOVING WITH A BIKE

- Move your bike by sliding it gently sideways. You can rotate and angle your bike once hung to allow it to overlap to the bikes around it.

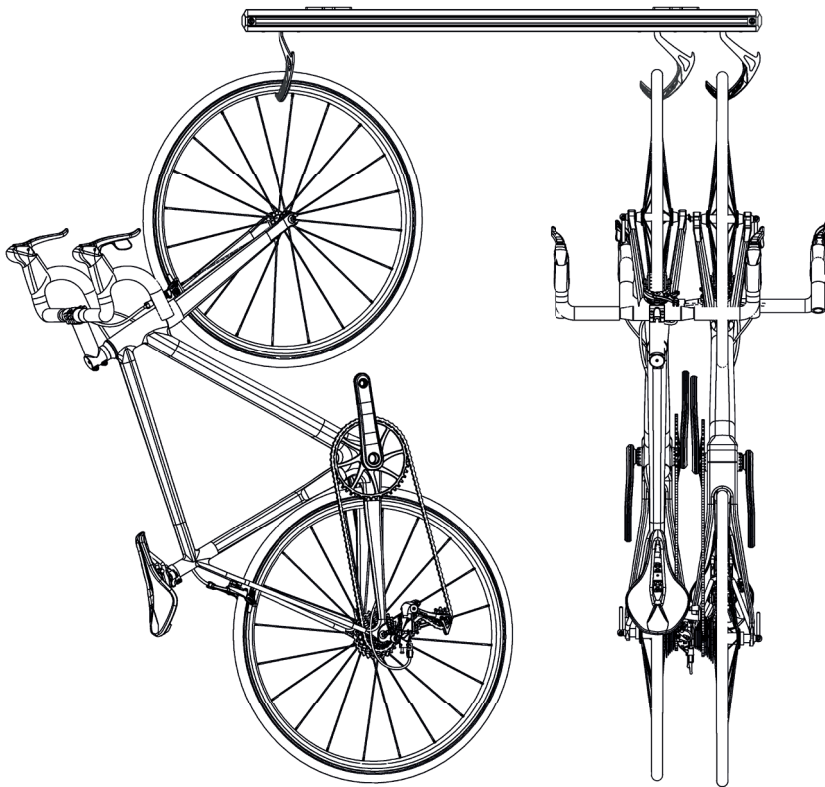



➔ MOVING WITHOUT A BIKE

- To move the Trolley without a bike on then you must pull down on the Hook to release the mechanism. If this is not done, damage can occur to the mechanism.
- If the Hook is out of reach then a cord (not included) can be added to the lower hole in the hook, to enable remote unlocking.

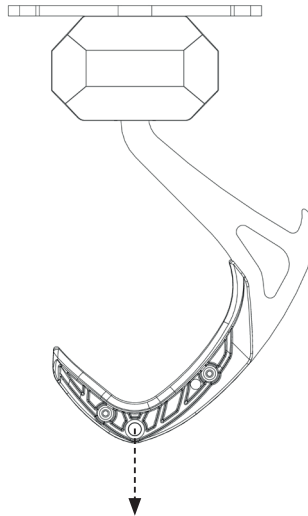

➔ BEST HANGING METHOD

For the best hanging and interlocking of bikes we suggest hanging from the front wheel, but try different variations to see what works for you and your bikes.

- To achieve the best space utilisation, your bikes should be interlocked by rotating and sliding them together.
- Storage volume can be reduced by around 50% by bringing the centre lines of the bikes to 150mm to 200mm. This is a significant saving over traditional hanging methods whilst maintaining access and security.
- Small bikes can be hung in series, but the maximum hook load should be observed.
- Once your bikes are compacted it is far easier to secure them together.
- **⚠ WARNING: ONLY HANG BIKES ON THE CENTRELINE OF THE HOOK. DO NOT HANG HEAVY OBJECTS ON THE HANGER (OFF CENTRELINE), AS THIS CAN DAMAGE THE RAIL DURING HOOK MOVEMENT.**



Traditional System

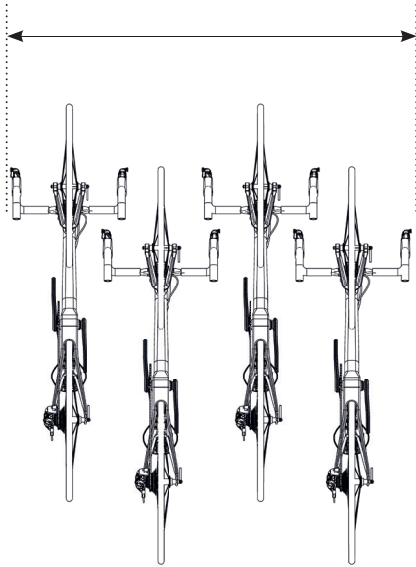

SpaceRail

50% less space

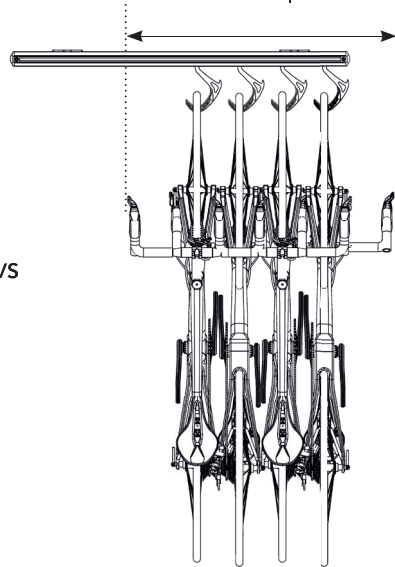

VS



FAQ

My Bike Hook keeps rolling on its own

- Check your Rail is level. Adjust with shims or packing components if necessary.

My trolley will not move when hung

- Your bike is not heavy enough to unlock the mechanism. Ensure you have applied enough load to the Trolley to disengage the auto-lock mechanism and check it is clear of debris.

My bikes hit each other when I slide them next to each other

- Add Spacers to increase Trolley width. Move bikes more gently to reduce chances of impact.

Will I damage my bike hanging it from its wheel?

- No! The SpaceRail puts a very low load on your bike compared to the forces put through your bike during normal cycling.

Will I damage my rims?

- No! The Hook has a wide contact area and the Hook Cover is made from plastic so will not damage or scratch your rims.

Can I get spare parts for my Bike Hook?

- Yes! All parts are available separately on our website.

The Bike Hook is scraping the cut out in the Rail during movement

- Bike Hook is being loaded unevenly and is angled too far. Remove load and reposition to centralise load.

Can I recycle Stashed Products packaging at home?

- Yes! Absolutely! All our packaging is biodegradable in normal home composting or can be recycled in household recycling collections.

WARRANTY/RETURNS

All hardware from Stashed Products is covered under a 2-year no quibble warranty. Please see our website for full details.

If any issues arise outside of the warranty period, then we have designed our products to be easily serviceable to ensure they have a long life in service. All parts are available separately from our website.

If you have problems with your product or questions, please contact us for support.



MAINTENANCE

Your Trolley is generally very low maintenance, manufactured from high quality materials and should give years of use. Some basic maintenance tips:

- Ensure the Bike Hook is kept clean and free from debris, this is especially important in all moving areas. Clean your Trolley with a soft cloth or use compressed air to remove debris from hard-to-reach areas.
- Apply a small amount of silicone based grease to the moving components such as the ball joint in the Trolley/Bullet and between the Wheels and Axles.
- **⚠ WARNING: DO NOT GREASE THE TOP CAP AS THIS WILL REDUCE MECHANISMS PERFORMANCE!**

Apply grease here
(ball joint only)

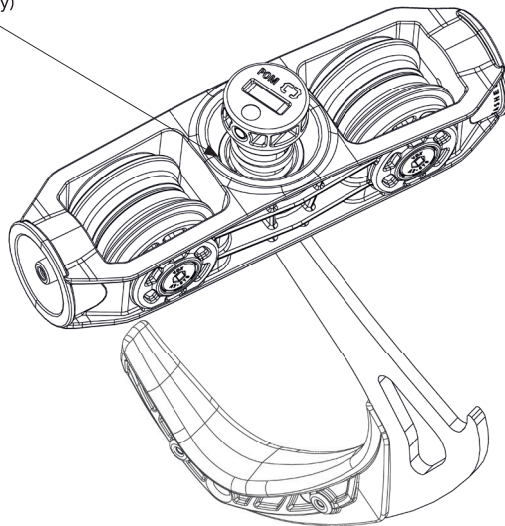

PERIODIC CHECKS:

1. Presence and tightness of all bolts and screws
2. Wear to any components such as wheels or impact areas
3. Ensure free movement of trolleys and mechanisms function correctly.



STASHED

LIFE STORED BETTER

MADE IN WALES by STASHED PRODUCTS

Unit 1, Y-Glyn, Llanberis, Caernarfon, Gwynedd, LL55 4EL, UK

www.stashedproducts.co.uk
sales@stashedproducts.co.uk

+44 (0) 3301 334 836

—

Got a great install? Share it at
@STASHEDPRODUCTS

