

WATER
PURIFIER

USER MANUAL

CP-QN1401SW

CUCKOO



CUCKOO

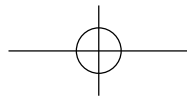

To our customers! Thank you for choosing Cuckoo Water Purifier.

Please keep this User Manual (including the Warranty) for your reference. This manual will guide you when you have any questions or when the product does not work properly.



Merits of CUCKOO Water Purifier

- **4-Step Filtration System**
The 4 - step filtration system of CUCKOO Water Purifier makes clean and healthy water.
- **Stainless Steel Water Tank**
Using a stainless steel water tank improves the water quality and cleanliness.
- **Economical Eco-Friendly Water Filtration System**
The Eco-friendly CUCKOO Nano Positive filter helps filter out contaminants but does not waste any water during the filtration process.
- **External Valve (for separate sale)**
The external valve allows for an additional connection to the filtered water supply.
- **Operation Status Indicator**
For added convenience, you are able to check the operation status through the operation status indicator.
- **Child Lock Button**
The child lock button prevents children or others from the burn hazards associated with hot water.
- **Individual Power Switches for Hot and Cold Water**
Energy efficient design with individual "hot" & "cold" power switches.

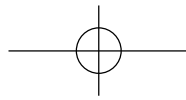

CONTENTS

Before Use	● Warnings for Safe Use	4 ~ 7
	Cautions for Safe Use	8
	Name of Parts/Components Information	9
How to Use	● Filtration Circuit/ Water Filtration System	10
	Details to Check before Installation	11
	How To Install the Product	12 ~ 13
	Details To Check before Use	14 ~ 15
	How To Use	15 ~ 18
	How To Clean the Cold Water Tank	19 ~ 21
	How To Clean Tray	22
	How To Replace the Filter	23 ~ 25
	Expected Filter Replacement Cycle /	26
	Recommendations / Filter Arrangement	
Before Asking for Support	● Please check before asking for support	27 ~ 28
	Service Guide	
	● Product Specifications	29

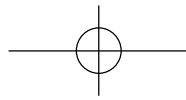

Warnings for Safe Use



- Please comply with the 'Warnings for Safe Use' as they are provided to ensure safe and proper use of the product and prevent accidents and dangerous situations.
- The 'Warnings for Safe Use' section is divided into 'Warning' and 'Caution' which are defined as follows.

Warning

Potentially dangerous situation that can cause serious injuries or death if not avoided.

Caution

Potentially dangerous situation that can cause minor injuries if not avoided.

- This symbol is to remind you to be cautious about a potentially dangerous situation under special circumstances.
- Please read the details carefully and follow the instructions to avoid dangerous situations.
-  • This symbol is used to indicate actions that are prohibited.
-  • This symbol is used to indicate 'instructed' actions.

About Power Supply

Warning **Do not**

Use Plug the power plug into a 120V outlet with at least a rating of 10A and power surge protection. Do not plug multiple products into the same power outlet or extension cord simultaneously.

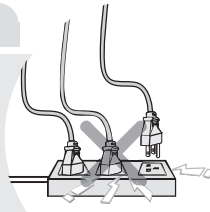

- When multiple products are plugged into the same power outlet or if the product is plugged into an inappropriate power input, it may cause heating, fire and electric shock. Please check the condition of the power outlet frequently.
- If there is a foreign substance or water on the power plug, please wipe it clean before plugging it into the socket.
- Use only an extension cord of 10A or higher.

Stop the use and contact Customer Service when the power cord or plug is damaged or the power outlet is loose.

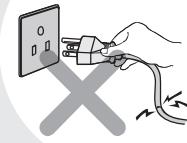

- If the sheath of the power cord is peeled off or bent due to negligence, it may cause fire or electric shock. Please check the state of the power cord, plug and outlet frequently.
- To replace the damaged power cord or plug, please visit CUCKOO website and contact Customer Service to prevent dangerous situations.
- We strongly recommend that the damaged parts be repaired or replaced. Otherwise, this may cause electric shock or fire due to a short circuit.

Do not bend, tie or pull the power cord by force.

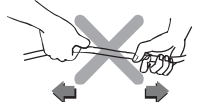

- This may cause electric shock or fire due to a short circuit. Please check the state of the power cord frequently.

Wipe off any foreign substance on the power plug with a dry cloth.



- This may cause electric shock or fire.
- Please check the state of the power plug frequently.

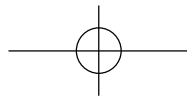

Warnings for Safe Use

About Power Supply



Warning



Do not

Do not pull the power cord when unplugging the product.

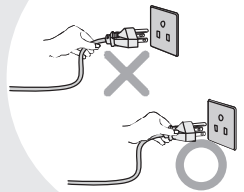

- Force applied to the power cord may cause electric shock or fire. Please check the state of the power cord and plug frequently.

Use 120V power input only.

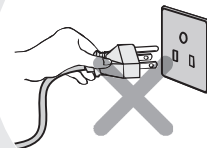

- This may cause electric shock or fire.
- The product will not operate properly.
- Please check the state of the power cord and plug frequently.

In case of water leak or cleaning, please unplug the power plug first.

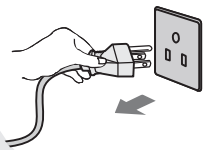

- This may cause electric shock or malfunction. Please check the state of the power cord and plug frequently.

Do not plug or unplug the power plug with wet hands.

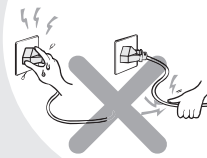

- Unplugging the power plug with wet hands may cause electric shock.
- Pulling the power cord by force can damage the cord and may cause a short circuit or electric shock. Please check the state of the power cord and plug frequently.

Make sure the power cord is not under a heavy object or near sharp objects. Please ensure that it is not damaged by your pet.

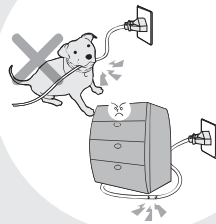

- If the power cord is damaged, it may cause electric shock or fire. Please check the state of the power cord frequently.

If the power supply area is wet, unplug the product and let it dry completely before use.

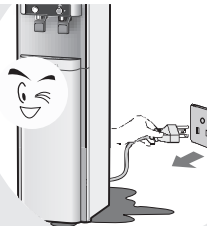

- This may cause electric shock or fire. Please check the state of the power cord and plug frequently.

Please turn off the product by pressing the power button. Also, unplug the product before inspection, repair or replacement of its components.

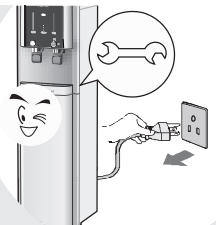

- This may cause electric shock or breakdown. Please check the state of the power cord frequently.

When you do not use the product for a long time, close the tap water supply valve, drain the remaining water from the tank by pressing the "Out Flow" button and unplug the power plug.

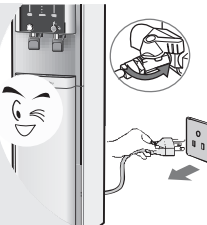

- This may cause electric shock or fire. Please check the state of the power cord and plug frequently.
- Before using the product again, please refer to the 'Details to Check before Use.'

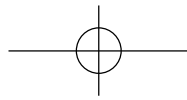

Warnings for Safe Use

Installation Issues

Warning **Do not**

Do not place the product in a place with high moisture or dust.

- This may cause electric shock or fire.

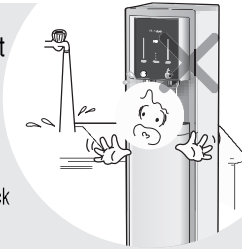

Do not install the product near the bathroom.

Do not place it in a bumpy or inclined area. Do not place it on a rug, cushion or laminated floor.

- This may cause malfunction, unwanted noise or injury. Please check the state of the product frequently.
- This fixed type product should be fixed when you use.

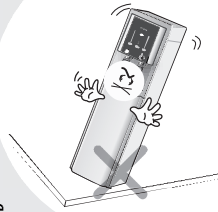

Avoid direct sunlight and high temperature.

- This may cause color changes.
- Please check the state of the power cord frequently.

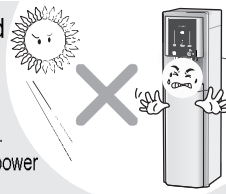

This Product is not intended for use by people (including children) who lack physical or mental abilities, or lack experience and knowledge to be able to use the product safely without supervision or instruction.

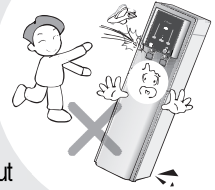

Make sure the distance of the tap water supply tube connecting the product to the tap water supply valve is less than 200 inch.

- This may cause reduced performance.

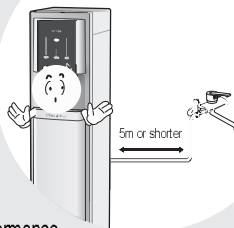

Do not place it in an area with potential for gas leak or near a heating product.

- This may cause fire or explosion.

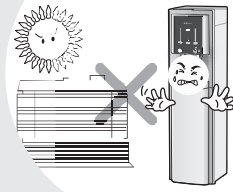

Use tap water as the supplying water, and install the Tap water supply valve to the "Cold" water pipe.

- Do not use underground water or any other water than tap water.
- The replacement cycle of the filter will vary according to the region and the amount of water use.
- Connecting the water supply valve to the hot water pipe may cause damage to the filter or malfunction of the product.



Do not place the product in an area that falls below 0°C.

- This may cause the filter or the internal components to freeze, causing malfunction.

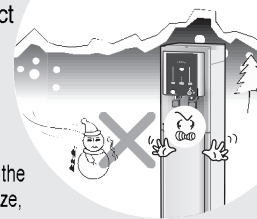

If the surrounding temperature falls below 0°C, it may cause the water inside the filter and / or tubing to freeze, causing malfunction of the product. Thus, please ensure that the surrounding temperature does not fall below 0°C.

- In case that tap water is frozen and cannot be supplied to the product because of lower than freezing temperature of the surroundings, please turn off the hot water power for safety.

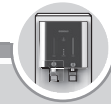
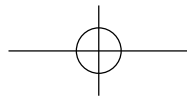

Warnings for Safe Use

Warning Do not

Do not place any heating product, such as a microwave, electric oven or toaster, or flammable materials such as candles or gas containers, on top of the product.

- There is a risk of fire, electric shock or accidents.

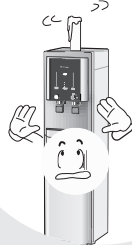

Do not place any chemicals, water bottles or small metal materials on top of the product.

- This may cause fire or damage the product when it enters into the product.



Do not pull the power cord or the connecting tube or grab the water faucet when moving the product.

- This may cause damage to the product. Please check the state of the power cord frequently.

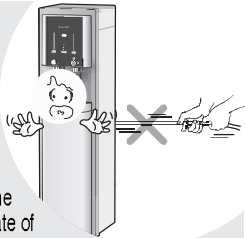

Do not disassemble or modify the product.

- This may cause fire or electric shock.
- Do not allow anyone other than a professional to disassemble or repair the product.
- Visit CUCKOO website and contact customer service for repair and warranty service information.



In order to prevent accidents and injury, make sure that your hands or other parts of the body do not touch the condenser (radiator) at the back of the product, as it gets hot during use.

- This may lead to burns or accidents.

Do not turn on the "Cold" & "Hot" buttons when the tank is empty.

- This may cause malfunction of the product.
- First open the tap water valve to check if the water is cut off. Do not press the "Cold" & "Hot" buttons when the tank is empty. Fill the tank fully with water before pressing "Cold" & "Hot" buttons.
- If the "Hot" button is pressed when the tank is empty, the safety product will be turned on automatically to prevent the heater from running. This will cause lukewarm water to be extracted. Please contact Cuckoo website or certified distributor.

Warning Caution

If there is a water leak or water is collected around the product, close the Tap Water Supply Valve, turn OFF the Power Supply Button, pull out the Power Plug, and then contact your approved Cuckoo service provider.

- There is a risk of electric shock.

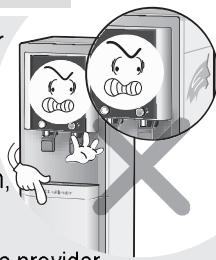

If you smell burning or see smoke from the product, unplug the product immediately and close the tap water supply valve. After that please contact Cuckoo website or certified distributor.

- This may cause fire.

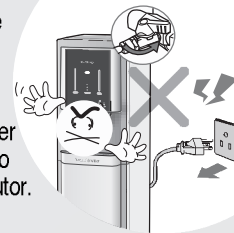

Please be cautious when using hot water.

- Make sure you do not come into direct contact with the hot water as it is extremely hot with risk of burn. Make sure seniors and children take special precautions.



For optimal performance, secure the unit 8" distance from the wall.

- It may cause fire or discolouration of the product.

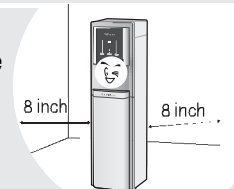

Installation and disassembly of the product should be completed by an approved Cuckoo service partner.

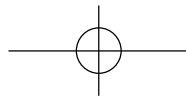

Cautions for Safe Use

! Caution

! Caution

Make sure tank cover inside the product and the lid cover of the product are completely closed before use.

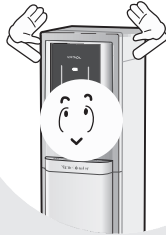

- This may allow foreign substances to enter.

Replace the filter according to the replacement cycle.

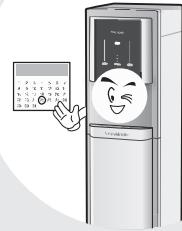

- This may reduce the purification function or cause bad odor.
- Please refer to Page 26 for the filter replacement cycle.

After a long discontinued use, drain out water completely from the tank, and fill it with water and drain it out again before use.



- Approximately 10.1L of water will be drained from the cold water tank.
- Approximately 4.0L of water (Stand Type) will be drained from the hot water tank. Approximately 14.1L of water will be drained when hot water is drained before cold water. Drain cold water before draining hot water.

Please use only genuine Cuckoo Filter.

- Use of any filter other than a genuine Cuckoo filter may cause a decrease in water filtration performance, an abnormal taste of water, water leak, or a malfunction.

! Caution

⊘ Do not

Do not clean the product using benzene and thinner.

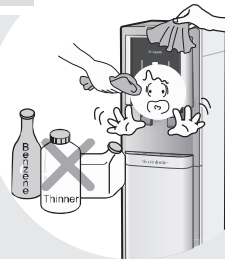

- This may damage the product.

Do not move the product during operation.

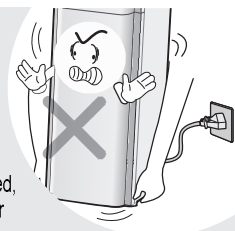

- Do not shake or move the product when the power is on. The tube could be disconnected, causing product malfunction or water leak.

Do not disconnect the tube at the back of the product during the operation.

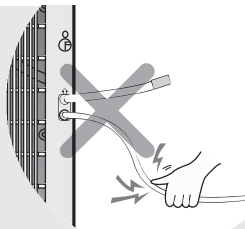

- This will lead to water leak, causing product malfunction.

If you have not used the external faucet for an extended period (longer than a day), it is recommended to open the spigot to allow the still water to flow to clean out the water line.

Do not use the purified water for a fish tank, an aquarium etc.

- The purified water may not be suitable for fish causing to death.

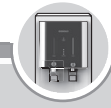
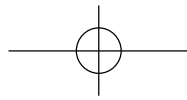

Name of Parts / Components Information

Name of Parts

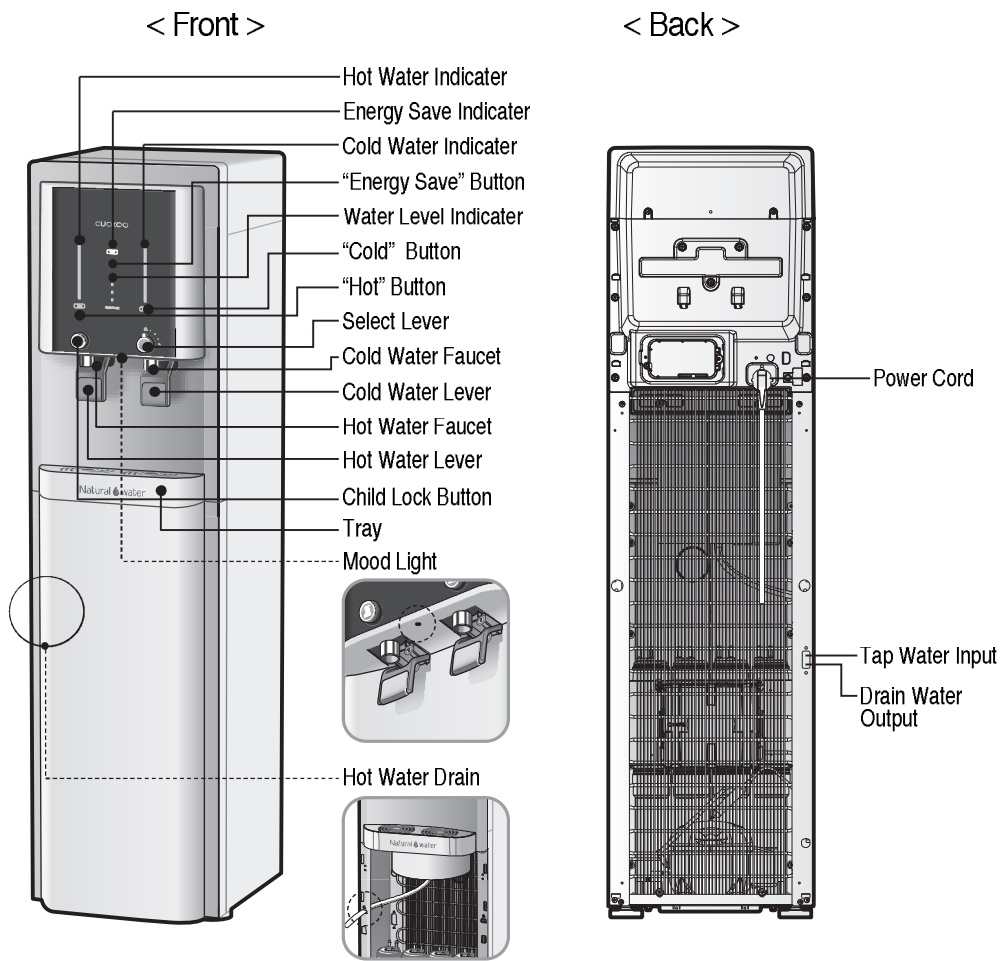

Components Information

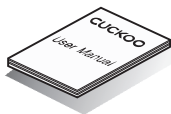

User Manual



Service Card



External Valve (Optional)

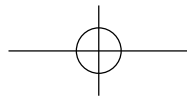

Filtration Circuit / Water Filtration System

Filtration Circuit

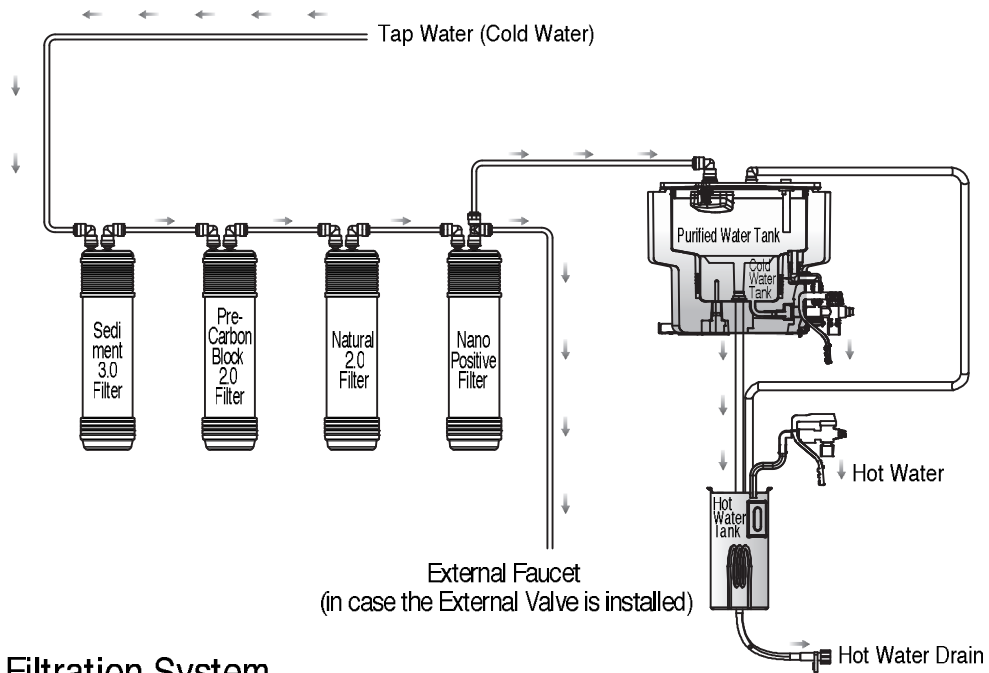

Filtration System

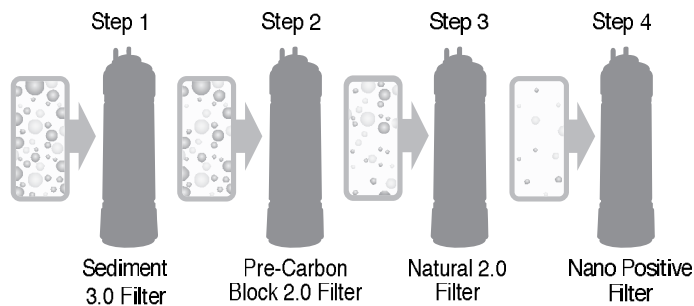

Steps	Filter Name	Filter Function
Step 1	Sediment 3.0 Filter	Helps filter out suspended particles and floating matter as well as residual chlorine and VOCs that may remain in the water.
Step 2	Pre-Carbon Block 2.0 Filter	Helps filter out residual chlorine and organic substances.
Step 3	Natural 2.0 Filter	Contains properties that helps filter out the smell of gases and organic material.
Step 4	Nano Positive Filter	Helps filter out general germs, viruses, minute particles, and some sorts of heavy metal (iron, aluminum).

※ If CUCKOO Filter (genuine) is not used or if the filter is used for a prolonged period, its performance could decrease.

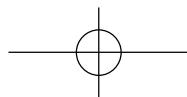

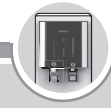
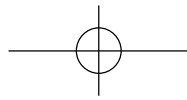

Details to Check before Installation

Details to Check before Installation

⚠ Cautions when installing the Product

- 1 Do not place the product in direct sunlight or near a heating product.
▶ This may cause color changes or fire.
- 2 Allow installation space.
▶ To allow convenient replacement of the filters, make sure the product is placed 8 inch away from the wall and that the distance of the water supply hose connecting the product to the water supply valve is less than 200 inch.
- 3 Avoid areas with high moisture/humidity, dust or water splash.
▶ This may cause a malfunction.
- 4 Avoid areas that are uneven, inclined or not solid.
▶ This may cause fire or a damage to the product.
- 5 Avoid areas where the temperature falls below 0 °C.
▶ This product is for indoor use. If the surrounding temperature falls below 0°C, it may cause the filters and/or the internal components to freeze, causing breakdown of the product.

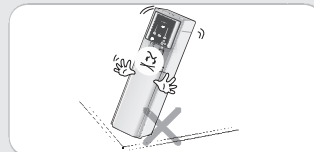
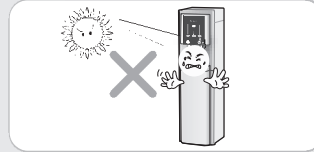

⚠ Cautions on Moving the Product

- Please be careful when moving the product.
▶ Do not tilt the product at an angle over 45°. Wait at least 30 minutes before plugging the power cord after moving the product.



⚠ Cautions on Connecting the Tube

- Connect the tube to the cold water pipe.
▶ Connecting the hose to the hot water pipe may cause damage to the filter or breakdown of the product.
▶ Refer to How to Install the Product (Page 12) for how to connect the tube.

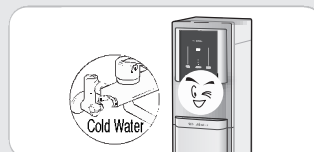

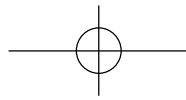

How To Install the Product

How To Install the Product

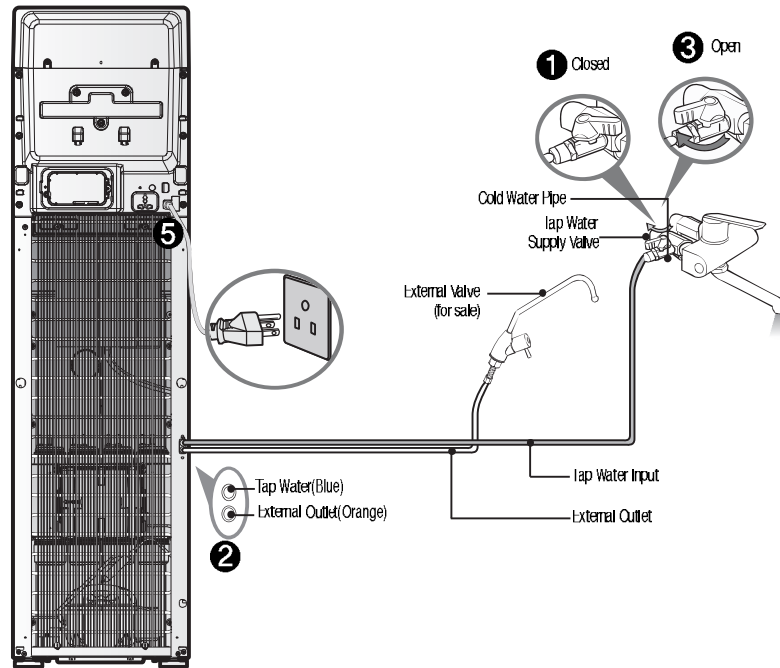

1 Turn off cold water supply to the sink

- Look under the sink, locate the cold water shut off valve for the cold water inlet supply to the faucet. Turn the shut off valve clockwise to close the water flow from cold water inlet water supply to faucet.

2 Release Faucet Pressure

- After closing the cold water supply (no water should be able to flow to the faucet), open the faucet handle as if to dispense cold water. This will release any existing pressure in the line. Some water may drip out. Make sure to open the faucet as if dispensing COLD WATER.

3 Disconnect water feed line from under sink cold water inlet to faucet

- Spin the riser nut counter clockwise to disconnect the faucet feedline from the cold water shut off valve and cold water inlet source.

4 Attach T-Valve to cold water inlet

- With the cold water inlet remaining closed, screw the T-valve onto the cold water inlet source (same location that the faucet feedline was removed from). Screw the T-valve on tight with a wrench and ensure proper connection.

5 Re-Connect the faucet feed line to the newly attached T-valve

- Connect the riser nut (from faucet feedline) to the open end of the T-valve and tighten with a wrench. Make sure this connection is secure.

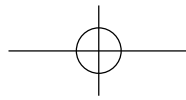

How To Install the Product

⑥ Connect 1/4" Water Line to T-valve

- Attached 1/4" water line to the quick connect adapter on the T-valve, push the 1/4" line fully onto the quick connect fitting nub. After pressing the water line fully onto the quick connect nub, make sure to use the locking nut properly to secure the 1/4" water line in place on the quick connect fitting.

⑦ Connect 1/4" Water Line to Water Purifier

- Locate the "tap water inlet" on the water filtration unit and insert the other end of the 1/4" water line (same line connected to the T-valve quick connect nub) into the quick connect valve at the back of the water filtration unit. Ensure you attach to the inlet line and have a secure connection by lightly tugging on the water line to ensure it remains locked into the fitting at back of the filtration unit.

⑧ Double Check all connections

- Check all water lines to ensure the connections are secure

⑨ Turn on Cold Water Supply

- Open the cold water inlet supply by turning the handle counter clockwise (this is the same valve that was turned off in step 1). This will allow water to flow through the newly attached T-valve, to the sink faucet and to the water purifier. Check all water connections to ensure there are no leaks.

⑩ Flush Filters

- Allow the hot and cold water tanks to fill completely and empty the tanks through the hot/cold dispense handles on the front of the water purifier. Complete this process three times.

⑪ Turn on the Hot/Cold Function

- After flushing the filters, allow the hot and cold tanks to fill completely. Once full, turn on the Hot/Cold buttons on the back of the machine to activate the hot tank and the cold tanks. It is especially important the hot tank is full before turning on the hot function.

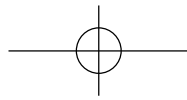

Details to Check before Use

Caution

Do not turn on the “Cold” & “Hot” buttons without water in the tank. (It may cause malfunction of the product.)

- Turn on the “Cold” & “Hot” buttons after filling the tank with water up to the limit.
- If you press the power button without water in the tank, the safety feature will activate, so the hot water heater will not be heated. This will cause lukewarm water to flow. Then, visit CUCKOO website for more information.
- Frequently check if the water supply is cut off and if the tap water supply valve is closed. Do not turn on the “Cold” & “Hot” buttons without water in the tank.

Details to Check before Use

1 Open the Tap Water Supply Valve.

- ▶ First, open the Tap Water Valve and check if the water supply is cut off. Then, open the Tap Water Supply Valve.

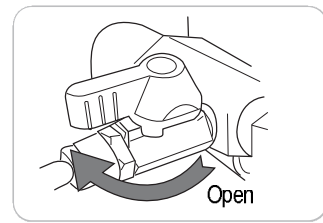

2 Connect the power supply.

- ▶ The product is exclusively use for 120V 60Hz. Connect it to the exclusive power outlet.
- ▶ After checking if the water supply is cut off, connect to the power supply.
- ▶ Before connecting the power, check if the “Cold” & “Hot” buttons are turned off.

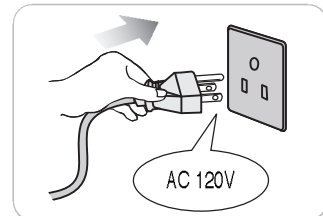

3 Press the “Hot” and “Cold” buttons to turn them on.

- ▶ If you want to use hot/cold water, press and hold the hot/cold button for 3 seconds until the unit lights display the appropriate color (Hot water LED display : Red / Cold water LED display : Blue)
- ▶ Purified water will be supplied, unless you press any button.

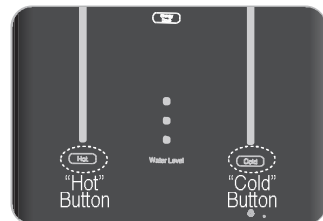

4 After long discontinued use or upon installation, completely drain out the tank. Fill it with water and drain it again before use.



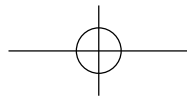

Details to Check before Use/How To Use

Details to Check before Use

- 5 Empty the tray regularly.

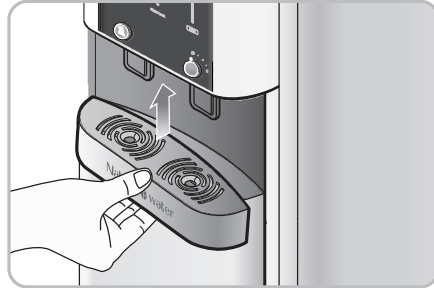

- 6 Replace and manage the Filter regularly.

- ▶ You need to regularly replace the filters to ensure clean water.
- ▶ Refer to page 26 for the filter replacement cycle.

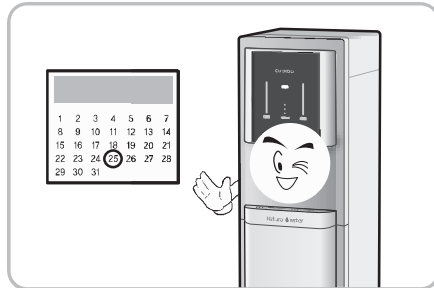

How To Get Hot Water

- 1 Press the "Hot" button for 3 seconds to turn it on. It takes about 30 minutes for the heater to heat the water. (The red lamp will be turned on)
- ▶ Before turning on the "Hot" button, make sure the water supply is available and the tap water supply valve is open.

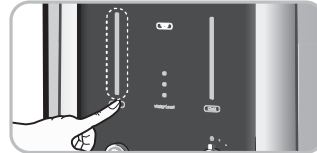

- 2 Gently push the Hot Water Lever, and then press the Child Lock Button.

Do not press the hot water lever while pressing the Child Lock button. This may create a splash and potential burn.



- 3 Lift the Hot Water Lever up at a 90° angle and press the Child Lock Button for a continuous extraction of hot water.

After the discharge of hot water, slowly return the lever to its original position. (If this is done too quickly, you may be burnt by splashing hot water)



If you no longer want to get hot water while the hot water operation is activated, press the "Hot" button for 3 seconds to stop the hot water function.

- ▶ The hot water Red LED will turn off.

The first glass may be lukewarm. This is due to the outflow of cold water and hot water through the same pipe. After the first glass, hot water will be extracted at a normal temperature.

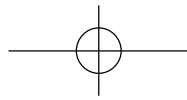

How to Use

How to Get Cold Water

- 1 Press the "Cold" button for about 3 seconds to turn it on. It takes 60 minutes for the cooler (condenser) to cool the water. (The blue lamp will be turned on)
 - ▶ Before turning on the "Cold" button, make sure the water supply is available and the tap water supply valve is open.
- 2 Turn the Select lever towards the Cold Water.
- 3 Gently push the Cold Water Lever.
- 4 Lift the cold water lever up at a 90° angle, then continuous extraction of cold water is available.

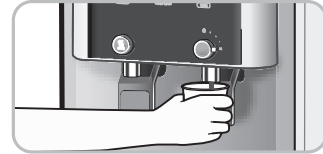
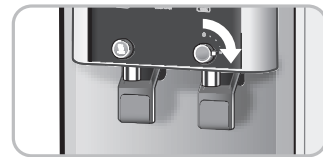
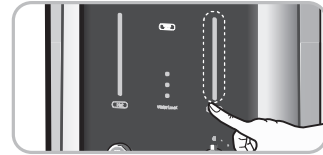

If you no longer want to get cold water while the cold water operation is activated, press the "Cold" button for 3 seconds to stop the cold water function.

▶ The cold water Blue LED will turn off.

The first glass may be lukewarm. This is due to the outflow of cold water and hot water through the same pipe. After the first glass, cold water will be extracted at a normal temperature.

How to Get Purified (Room Temp.) Water

- 1 Turn the Select lever towards the room water.
 - 2 Gently push the cold Water Lever.
 - 3 Lift the cold water lever up at a 90° angle, then continuous extraction of purified water is available.
- ※ Please be cautious that if the Hot water or Cold water button is turned off, the temperature of purified (room temperature) water could be become a bit hot or a bit cold.

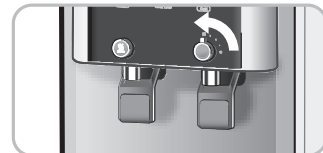

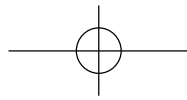

How to Use

How to Use Energy Save Function

This function saves energy by reducing the standby power and the brightness of the indicator.

- 1 While the [Energy Save] indicator is off, press the [Energy Save] button.
 - ▶ The [Energy Save] indicator lights up, and after 1 second all the indicators are dimmed.
 - ▶ The power saving function turns off all indicator lights except the [Energy Save] when the light sensor detects darkness for a certain period of time.
 - ※ [Mood Lamp] On / Off is irrelevant to [Energy Save] function.
 - ※ Please refer to the following [Mood Lamp] on/off set-up method.
 - ▶ When the power saving function is activated, the indicator lights up when the button is pressed. (If there is no button input for a certain period of time, the indicator becomes dark again.)
- 2 When the [Energy Save] light is on, pressing the [Energy Save] button turns off the power function.
 - ▶ The [Energy Save] indicator turns off and all indicator lights are turned on.



[Mood Lamp] On/Off Set-up Method

It is a method to set the mood light function during darkness.

- 1 Press the [Hot] button and the [Energy Save] button simultaneously for 2 seconds in the standby mode.
 - ▶ Pressing the [Hot] button and [Mood Lamp] simultaneously activates On/Off Set-up (Initial Setting : Light)
 - ※ If there is no operation for 7 seconds, it returns to standby mode without saving settings.
 - ▶ Press [Energy Save] button to save the change.
 - ※ Setting Turn On : Level indicator lamp On and [Mood lamp] On
 - Setting Turn off : Level indicator lamp Flickering and [Mood lamp] Off

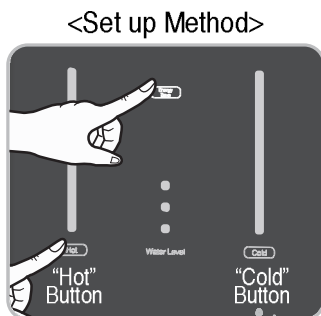

Press for 2 seconds



Level indicator lamp and [Mood lamp] On



Level indicator lamp Flickering and [Mood lamp] Off

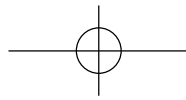

How to Use

Setting the temperature

- Setting the temperature of hot water: Press the [Energy Save] button for 3 seconds.
 - ▶ Enter the hot and cold water temperature setting mode. [Initial Setting : Level 3]
 - ▶ Press the hot water button to set the temperature. [The higher Level means the higher temperature]
 - ※ If there is no operation for 7 seconds, it returns to standby mode without saving settings.
 - ▶ Press the [Energy Save] button to save the setting.

<Set up Method>

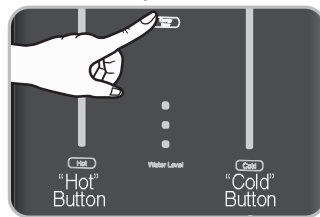

Press for 3 seconds

<Initial Setting Check>

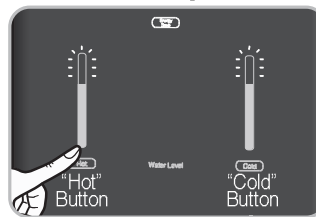

- Setting the temperature of Cold water : Press the [Energy Save] button for 3 seconds.
 - ▶ Enter the hot and cold water temperature setting mode. [Initial Setting : Level 3]
 - ▶ Press the cold water button to set the temperature. [The higher Level means the lower temperature]
 - ※ If there is no operation for 7 seconds, it returns to standby mode without saving settings.
 - ▶ Press the [Energy Save] button to save the setting.

<Set up Method>

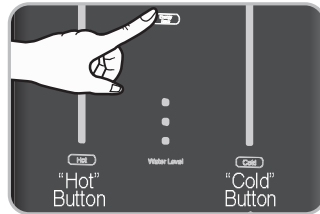

Press for 3 seconds

<Initial Setting Check>

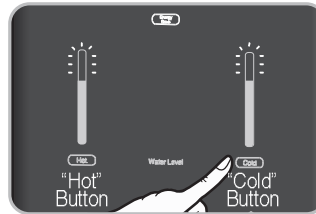

How To Use External Faucet (Optional)

- Move the Lever of the External Valve connected to the sink down, and then you can use the External Faucet.
 - ▶ If you have not used the External Faucet for a long time with the power connected, the water of the External Valve may be warm because of the inside heat caused by the operation of the Heater and the Compressor.
 - ※ If you rub the external valve with a brush or sponge, it may damage the plating of the valve's outer surface and may cause the mineral scale to the inside of the external valve.

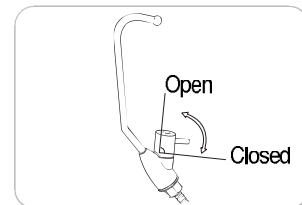

If you have not used the external faucet for an extended period (longer than a day), it is recommended to open the spigot to allow the still water to flow to clean out the water line.

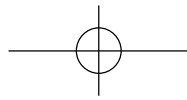

How to Clean the Cold Water Tank



How to Clean the Cold Water Tank

- 1 First, close the Tap Water Supply Valve.

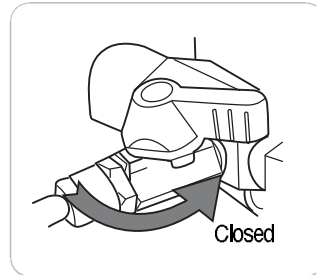

- 2 Press the "Hot" & "Cold" button for 3 seconds to turn them off.

- ▶ Make sure that the "hot" and "cold" lights are turned off.

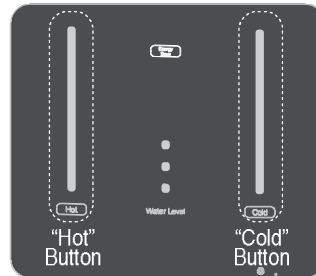

- 3 Unplug the power plug for safety.

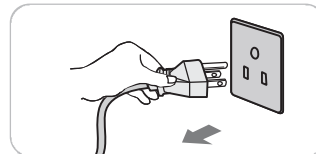

- 4 Drain the cold water tank through the cold water faucet.

- ▶ Drain water into a clean bowl as it will be used to clean the tank.
- ▶ Approximately 10.1L of water will be drained, so use a bowl in an appropriate size.



- 5 Connect the hot water drain tube to the hot water faucet and the hot water drain in order to drain out all the hot water from the hot water tank.

- ▶ Beware as the hot water is very hot.
- ▶ Approximately 4.0 L of water will come out, so prepare a bucket of a sufficient size.
- ▶ If you drain hot water before draining cold water, approximately 11.6 L of water will come out. Drain cold water before draining hot water. (After hot water is completely drained, close the stopper of the Hot Water Drain.)

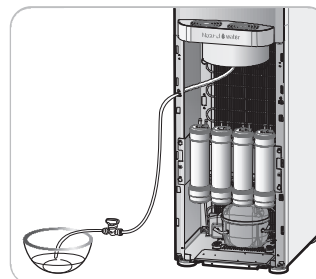

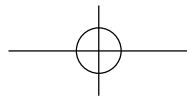

How to Clean the Cold Water Tank

How to Clean the Cold Water Tank

- 6 Remove the lid cover of the product.
▶ Requires a phillips head "+" screwdriver.

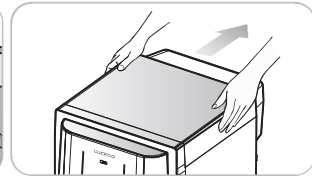
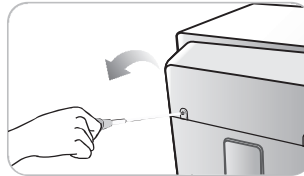

- 7 Remove the cover from the cold water tank.
▶ The upper part of cold water tank is slightly warm because it contains ambient water and hot water steam.

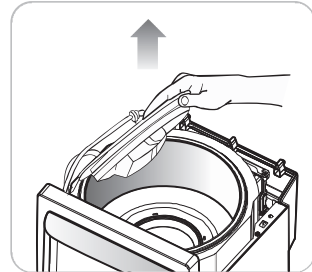

- 8 Remove separator from the cold water tank by pulling the separator.
▶ When you remove the separator and clean the inside of the tank, please wear gloves to ensure it is properly sanitized.

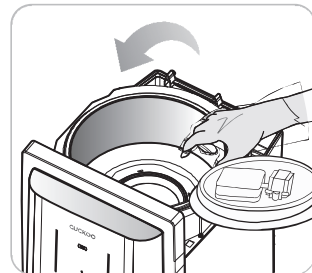

- 9 Wipe out the inside of the Tank with a clean and soft cloth.
▶ Make sure no foreign substances are left inside the tank.

Scale may form inside the tank due to minerals melted in the water. When you use the water purifier infrequently, drain water through the cold / hot water faucet once every two to three days. Then you can prevent scale from forming. (It is best to use the purified water within a short period of time.)

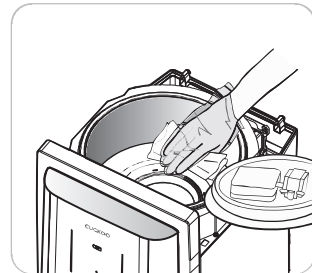

- 10 Pour the drained water (refer to Step. 4) into the tank and wash it.
▶ Completely drain the used water through the cold water faucet.
▶ Remove the hot water drain ball valve (end cap) and completely drain the water that flowed into the hot water tank. Then close the cap.

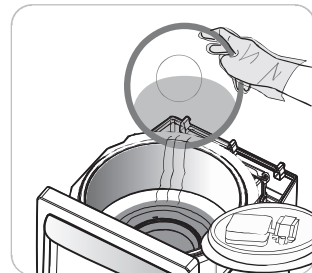

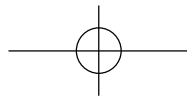

How to Clean the Cold Water Tank



How to Clean the Cold Water Tank

- 11 Reassemble the Separator to the Cold Water Tank.

▶ Cautiously press the separator into place.

If it is not placed properly, the operation of the compressor will be effected, which can cause noise. Please make sure place the separator properly.

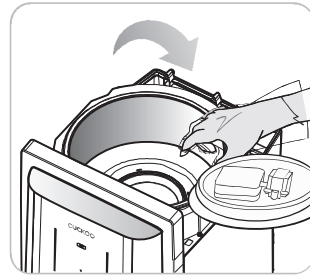

- 12 Please install the cover on the cold water tank.

▶ Make sure the cover of cold water tank is completely closed. Otherwise, foreign substances may enter into the tank.

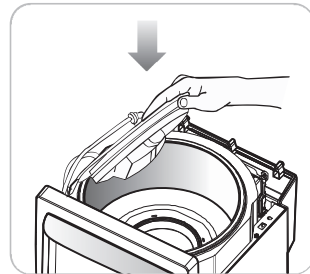

- 13 Place the lid cover on the product and fasten it with screws. Open the tap water supply valve and check whether water flows from the hot/cold water faucets.

▶ Tighten the screw with a phillips head '+' screwdriver.

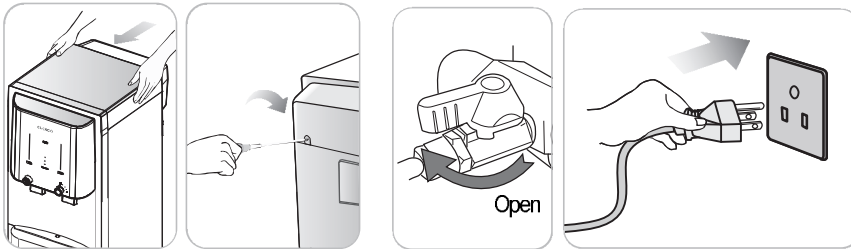

- 14 Check the water flow through the cold water faucet and hot water faucet, and plug power plug and press the "Cold" & "Hot" buttons to turn them on.



▶ After checking water flow through the hot water faucet, turn on the "Hot" button.
※ Clean the Tank regularly in order to drink clean and healthy water.

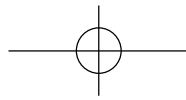

How to Clean Tray

How to Clean Tray

1 Separation of Tray

- ▶ Hold and move the tray upwards to separate the tray.



2 Separation of Tray Cover

- ▶ After removing the tray, pull from the hole of the cover on the top of the tray to separate the tray cover.

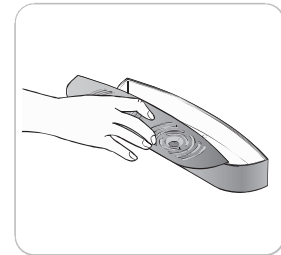

3 Cleaning of Tray

- ▶ Throw away the stagnant water in the tray, and remove the remaining with a soft cloth, etc.

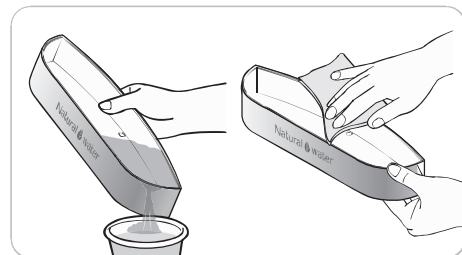

4 Assembly of Tray

- ▶ After finishing the cleaning of the tray, assemble it in the reverse order of dismantling.

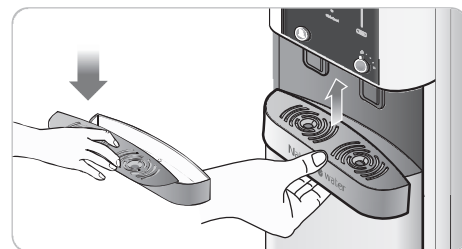

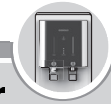
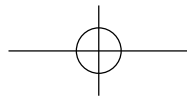

How To Replace the Filter

How To Replace the Filter (CUCKOO Filter (genuine) must be used)

- 1 Close the Tap Water Supply Valve.

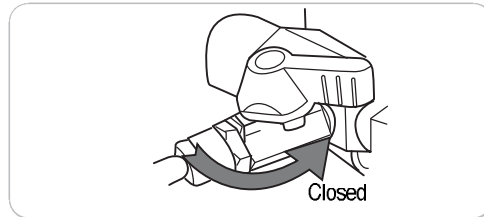

- 2 Remove the remaining pressure inside the pipe.
 - ▶ Drain approximately 3~4 cups (500cc) of water from the cold water faucet.



- 3 Turn off the "Hot" & "Cold" buttons, and unplug the product.

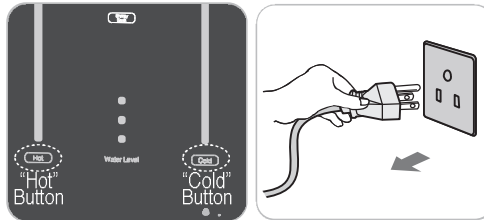

- 4 Drain out all the water remaining in the purifier.

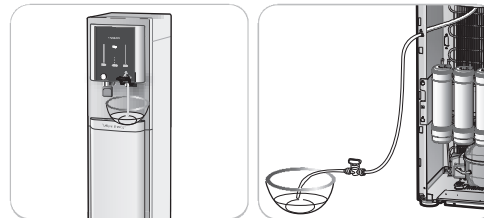

- 5 Remove the lower front cover for filter replacement.
 - ▶ Requires a phillips head "+" screwdriver.



※ When removing screws, please make water purifier fully drained before leaning it. Leaning it with residual water inside may cause spillover.

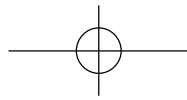

How To Replace the Filter

How To Replace the Filter (CUCKOO Filter (genuine) must be used)

- 6 Before replacing the filter, detach the connecting tube of the filter you wish to replace.
- ▶ Detach the connecting tube using an appropriate tool (fitting separator). Damage to the fitting and/or connecting tube may cause water leak.

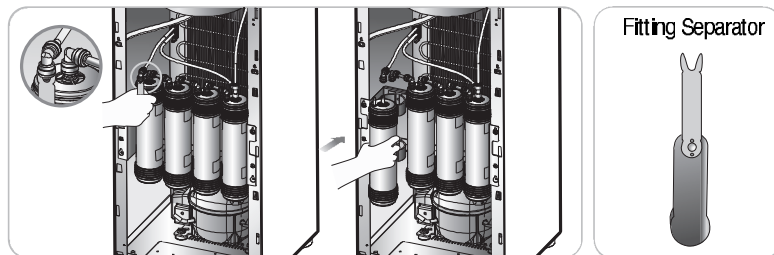

- 7 Connect the outlet of the previous filter to the inlet of the replaced filter and connect a separate water extraction tube to the outlet of the replaced filter. Then, open the tap water supply valve to allow water to pass through.
- ▶ Especially for the Sediment 3.0 Filter, allow water to pass through for about 5 minutes.
 - ▶ Connect the Pre-Carbon Block 2.0 Filter and the Natural 2.0 Filter to the previous filters, and allow water to pass through for about 7 minutes.
 - ▶ Connect the Nano Positive Filter to the previous filters, and allow water to pass through for about 10 minutes.
 - ▶ Allow plenty of water to pass through or else it will affect the taste and quality of water.
 - ▶ It is important to supply the purifier with water to check for any water leakage after filter replacement. Use a dry cloth.
 - ▶ When each filter is connected to fitting hose, filters' labels should be facing to the right side for 10mm.

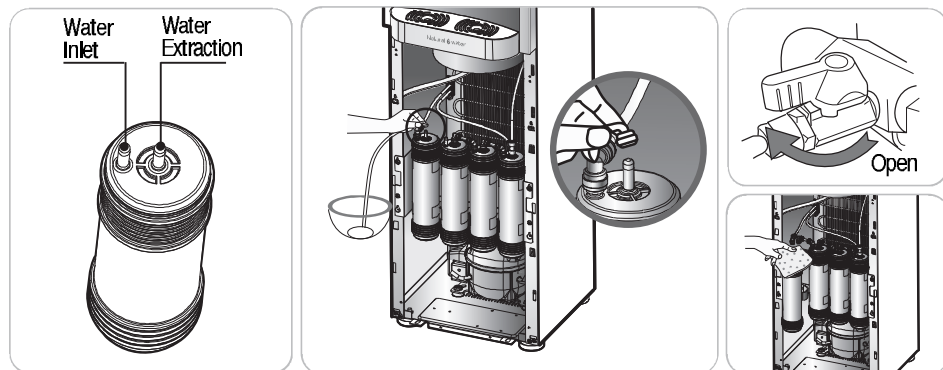

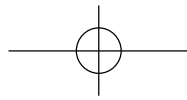

How To Replace the Filter

How To Replace the Filter (CUCKOO Filter (genuine) must be used)

- 8 Place the lower front cover again and fasten it with screws.
- ▶ Find the accurate place of the screws to ensure the cover to be fastened properly.
 - ▶ Requires a phillips head "+" screwdriver.

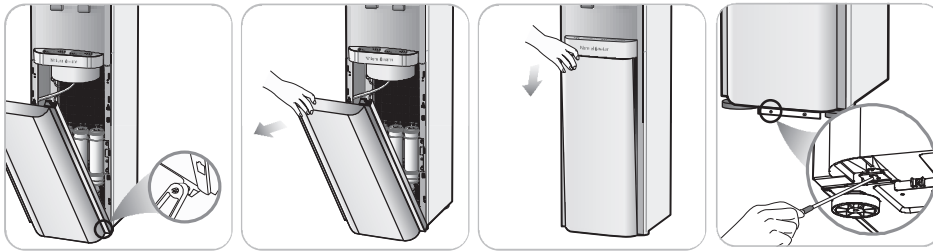

- 9 Turn on the tap water supply valve and fill the tank with water up to the limit then drain it out. Repeat twice.

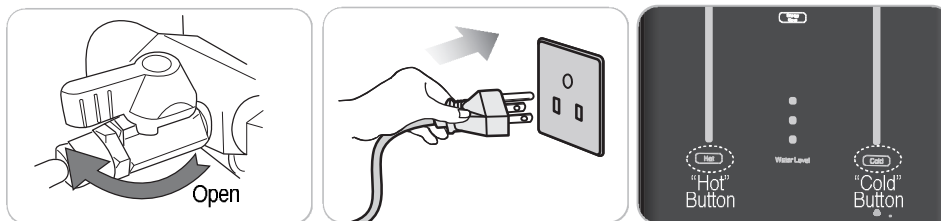

- 10 After filling the tank with water, connect the power plug.

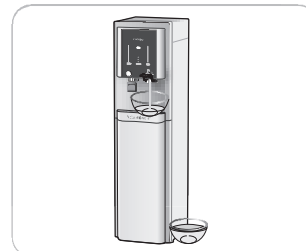

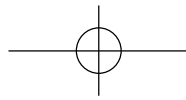

Expected Filter Replacement Cycle / Recommendations / Filter Arrangement

Recommended Filter Replacement Cycle

- ▶ The filter replacement cycle is determined with the use of 10 L per day at home as the standard, and may be affected by the condition of tap water.

	Filter Name	Expected Filter Replacement Cycle
CP-QN1401SW	Sediment 3.0 Filter	1800~2400L / 6~8 months
	Pre-Carbon Block 2.0 Filter	1800L / 6 months
	Natural 2.0 Filter	3600L / 12 months
	Nano Positive Filter	3600L / 12 months

- ※ Note: the above replacement cycles are estimates only and may vary depending on feed water condition.

Recommendations

▶ Filtration Capacity

Filtration Capacity is the recommended amount of usage for each filter. This is to make sure the filters are used to their fullest potential.

▶ Filter Replacement Cycle

The filter replacement cycle means the expected cycle (period) that the filters can perform properly. The filter replacement cycle may vary based on usage. Its standard cycle has been set under condition that the supply is tap water with about 10L (drinking water (for four people) used per day.

Filter Arrangement

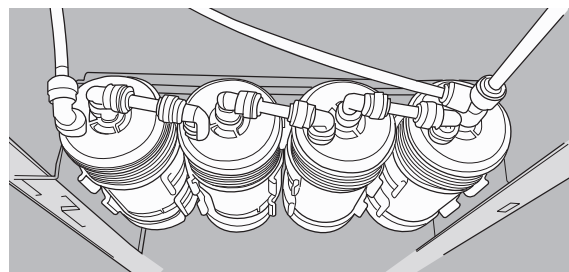
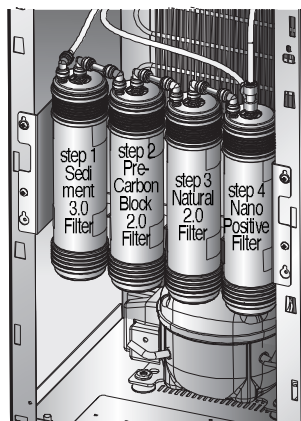

- ▶ When each filter is connected to fitting hose, filters' labels should be facing to the right side for 10mm.

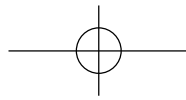

Please check before asking for support

▼ When the Water Purifier is not used properly, in compliance with the User Manual, the product may operate abnormally even if it is not broken down. In such case, please take the following instructions accordingly. If you cannot solve the problem, please visit CUCKOO website and contact customer service.

Problem	Checklist	Recommendation
The water has an unpleasant taste or odor.	<ul style="list-style-type: none"> • Have you not used the Water Purifier for a long time? • Is it the time to replace the Filter? • Have you not used hot water for a long time? 	<ul style="list-style-type: none"> • Drain the water from the hot and cold water tanks and clean the cold water tank. • Replace the filter (with a genuine filter of CUCKOO). • Drain the water from the hot water tank through the hot water drain tube from the back. Discharge hot water through the hot water faucet frequently.
There is no water coming out.	<ul style="list-style-type: none"> • Is the tap water connected properly? • Is your household water pressure low? • Are you getting cold water but not hot water? • Do you think there is a problem with the Hot/Cold Water Lever? 	<ul style="list-style-type: none"> • Open the tap water supply valve. • Check if the feed tube is bent. • Check if the water supply is cut off. • Attach External Pump (Optional) or Contact Customer service. • Push the hot water lever as you press the Child Lock button. • Check whether the hot water indicator is on. • Check if the power is on. ※ If you still don't get any hot water after checking the above, please visit CUCKOO website and contact our customer service. • Contact our Customer Service Center.
The hot water temperature is too low.	<ul style="list-style-type: none"> • Is the hot water indicator on? • Did you already extract a lot of hot water? • Is the temperature of purified water at room temperature? 	<ul style="list-style-type: none"> • Turn the "Hot" button "ON" and make sure the hot water indicator is on. • If you extracted all of the hot water from the hot water tank, you need to wait 30 minutes to re-heat the water. • Turn the "Hot" button "OFF" and contact Customer Service.

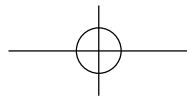

Please check before asking for support

▼ When the Water Purifier is not used properly, in compliance with the User Manual, the product may operate abnormally even if it is not broken down. In such case, please take the following instructions accordingly. If you cannot solve the problem, please visit CUCKOO website and contact customer service.

Problem	Checklist	Recommendation
The cold water temperature is too high.	<ul style="list-style-type: none"> • Is the cold water indicator on? • Did you already use a lot of cold water? • Is the back of the product properly ventilated? 	<ul style="list-style-type: none"> • Turn the "Cold" button "ON" and make sure the cold water indicator is on. • If you used all the cold water in the cold water tank, you need to wait approximately one hour to re-cool the water. • Check if the radiator at the back of the product is blocked. Remove any objects blocking the radiator. Move the product to a well-ventilated area. (Contact customer service before moving and re-installing the product)
There is a sudden decrease in the amount of purified water.	<ul style="list-style-type: none"> • Did you close the tap water supply valve? • Is it time to replace the filter? 	<ul style="list-style-type: none"> • Open the tap water supply valve. • Replace the filter with Cuckoo Filter (genuine).
There is a loud noise coming from the purifier.	<ul style="list-style-type: none"> • Did you place the product on a flat area? • Is it in contact with other products? • Does it happen when you extract water from the faucet? 	<ul style="list-style-type: none"> • Place the product on an even and sturdy area. • Make sure the product is not in contact with other products. • Because the water purifier is directly connected to tap water, the water immediately flows when water is extracted. The noise is caused by the water flow which is normal.
There are floating substances in the water.	<ul style="list-style-type: none"> • Is it time to replace the filter? 	<ul style="list-style-type: none"> • Replace the filter with Cuckoo Filter (genuine).
Water is leaking from the purifier.	<ul style="list-style-type: none"> • Is the assembled (connecting) part defective? • Is your home or the external environment humid? 	<ul style="list-style-type: none"> • Close the tap water supply. Unplug the product and contact customer service. • When moisture in the air comes in contact with the cold part of the purifier, it'll condense on the purifier like dew. A similar phenomenon can be seen with water droplets forming on glass.

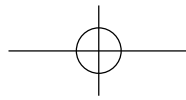

Product Specification

Product Name		Drinking Water Coolers
Category		Stand Type
Model		CP-QN1401SW
Rated Voltage		Single Phase. AC 120V / 60Hz
Power Consumption		Hot : 465W(3.9A)/ Cold : 107W(1.8A) / TOTAL : 572W(5.7A)
Water Filtration Method		Nano Positive Filter System
Filter Types (Materials/Replacement Cycle)		Sediment 3.0 Filter Materials : Polypropylene, Activated Carbon (Replacement : 6~8 months)
		Pre-Carbon Block 2.0 Filter Materials: Compressed Activated Carbon (Replacement : 6 months)
		Natural 2.0 Filter Materials: Charcoal, Ceramicball, Activated Carbon (Replacement : 12 months)
		Nano Positive Filter Materials: Polypropylene, Polyamine, Polyester (Replacement : 12 months)
Capacity	Cold Tank	10.1L
	Hot Tank	4.0L
	Total Capacity	14.1L
Types of Refrigerants		R-134a
Climate Class		T (For Tropical Climate regions)
Usage		For indoors
Product	Weight	About 63.1 lbs
	Size (WxDxH)	14.2" (W) x 19.5" (D) x 53.1" (H)
Normal Operation Pressure		0.05 MPa~ 0.39MPa(0.5bar~ 3.9bar)

* The details indicated in this User Manual (exterior, design, and specifications) may be changed without previous notice for improvement of quality of the product.

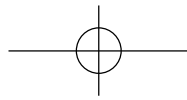

MEMO

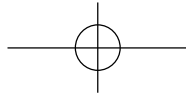

MEMO



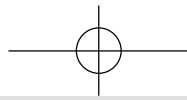

CUCKOO

<http://www.cuckooamerica.com>

We provide satisfying consultation and services concerning your complaints, suggestions, and recommendations upon receiving your troubled product model name, status, and contact information.

- ♣ After reading this manual, keep it in a place easily accessible to the user for future reference.
- ♣ This manual includes the warranty.
- ♣ Caution : Please read this manual carefully to ensure safety and a longer product lifespan.

10384-0008C0 Rev.1