

Jura Impressa Xs9 OT

Operating & cleaning instructions



My Coffee Shop Pty Ltd
ACN 102 850 037

390 Johnston St
Abbotsford VIC 3067
ph: 03 9946 4160

97/1-5 Harwood St
Pymont NSW 2009
ph: 02 9034 6580

Control elements

Control elements

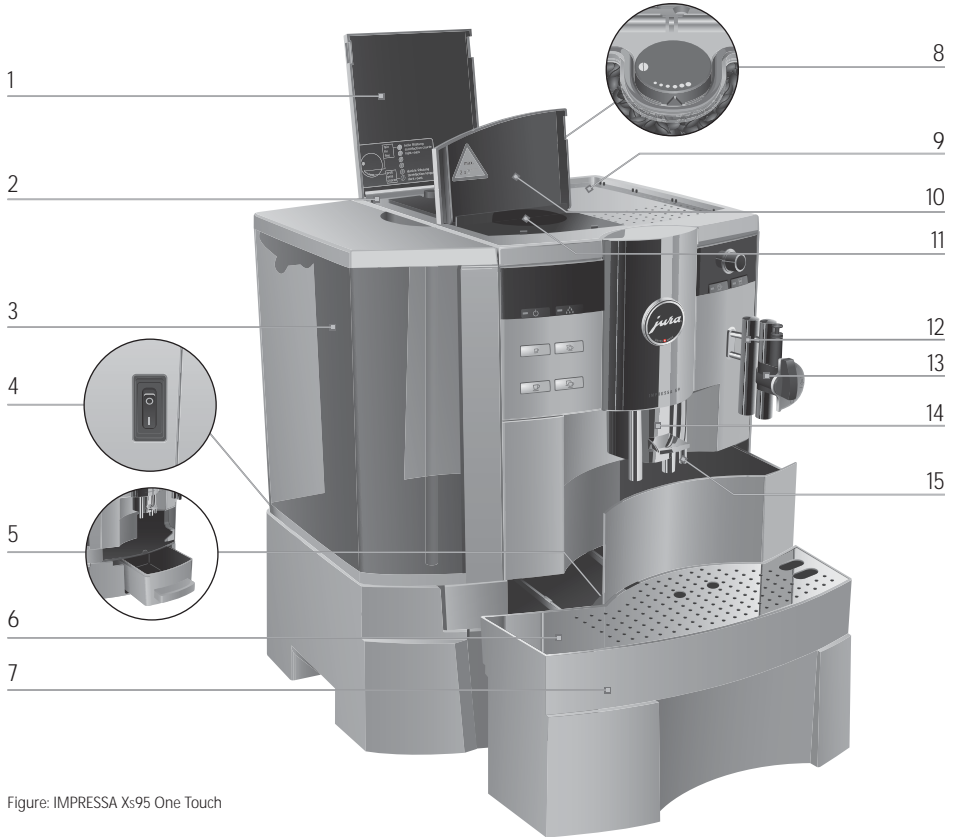





Figure: IMPRESSA Xs95 One Touch







- | | | | |
|---|--|----|--|
| 1 | Bean container cover | 8 | Fineness of grind switch |
| 2 | Bean container with aroma preservation cover | 9 | Cup tray |
| 3 | Water tank with handle | 10 | Cover of filler funnel for pre-ground coffee |
| 4 | Power switch and power cable (back of machine) | 11 | Filler funnel for pre-ground coffee |
| 5 | Coffee grounds container | 12 | Connector System [®] for removable frothers |
| 6 | Cup platform | 13 | Professional Cappuccino Frother |
| 7 | Drip tray | 14 | Height-adjustable coffee spout |
| | | 15 | Hot water spout |



Front left

- 1 Display
- 2 Rotary Switch cover
- 3  Rotary switch
-  On/off button
-  Maintenance button
-  1 Espresso button
-  2 Espresso button
-  1 Coffee button
-  2 Coffees button
-  Coffee à la Carte button
-  Pre-ground coffee button

Front right

- 4  Selector switch
- 5 Professional Cappuccino Frother
- 6 Easy Cappuccino Frother
-  Hot water portion symbol
-  Hot water symbol
-  Cappuccino button
-  Milk portion symbol
-  Milk symbol
-  Latte Macchiato button

The Connector System® permits the use of different frothers. These are available from stockists.

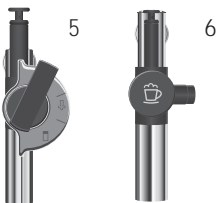

Operating Instructions – Jura Impressa Xs9

Cappuccino

1. Place your cup / mug under the milk / coffee spout on the right.
2. Turn the milk selector to the foam milk position – See diagram below.



3. Press the cappuccino key. Your cappuccino will now be poured

Flat white

1. Place your cup/mug under the spout on the right.
2. Turn the milk selector to the flat milk position – See diagram below.



3. Press the Latte macchiato key. Your flat white will now be poured

Café Latte

1. Follow the procedure for making a cappuccino.
2. When your cup or glass 1/3 full of foam milk, turn the milk selector to the flat milk position.

Espresso or Long Black

1. Place your cup / mug under the middle spouts and press espresso or coffee key. Your drink will now be poured. Press the button twice for a double espresso or two long blacks.

Note: Each key is fully programmed however you can stop the milk and coffee flow short by pressing any key while it is pouring. Adjustments to suit personal preference can also be made using the rotary dial. These changes do not affect the programmed settings.



Cleaning Products – Jura Impressa Xs9

Daily

See procedure – Daily milk system clean

Must be performed at the end of each day just before the machine is turned off

Purpose: To ensure the milk system is clean overnight so milk does not go off blocking the pathways



Use Cafetto daily milk cleaner 1 litre bottle (Prod no. 71144)
or Jura Milk System Cleaner Mini Tabs 180g (Prod no. 71150)

Weekly

See procedure – Weekly milk system clean

Performed once per week

Purpose: To remove any build up of milk fats to ensure the milk frother works correctly



Use Cafetto weekly milk cleaner – 1 litre bottle (Prod no. 71145)

When prompted

Clean machine – See procedure (Coffee system clean)

Performed only when prompted (Every 220 coffees)

Purpose: Removes coffee oil from the brewing unit and coffee path to maintain the quality of the coffee



Use Jura cleaning tablets - 6 pk (Prod no. 71111)
- 25 pk (Prod no. 71112)

See procedures – Changing the filter or Descaling the machine

Perform a filter change or descale only when prompted.

Purpose: Protects against lime scale build up inside the machine maintaining water & steam paths



Prod no.71131



9 pk – Prod no. 71121

36 pk – Prod no. 71122



My Coffee Shop Pty Ltd
ACN 102 850 037

390 Johnston St
Abbotsford Vic 3067
ph: 03 9946 4160

97/1-5 Harwood St
Pymont NSW 2009
ph: 02 9034 6580

IMPRESSA Xs9 Classic

Daily milk system clean

Cafetto daily milk cleaner 1 litre bottle (Prod no. 71144)
or Jura Milk System Cleaner Mini Tabs 180g (Prod no. 71150)



These short instructions do not replace the 'IMPRESSA Xs9 Classic Instructions for Use'. Make sure you read and observe the safety information and warnings first in order to avoid hazards.

Precondition: COFFEE READY



MAINTENANCE

CLEAN CAPPUCCINO

CLEANER FOR CAPPU.

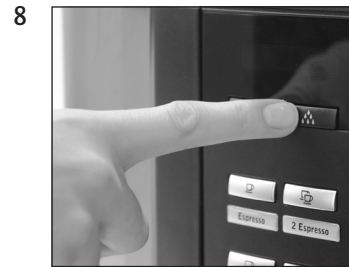
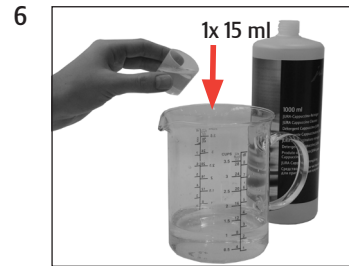

CAPPUCCINO / CLEANS
WATER FOR CAPPUCCINO

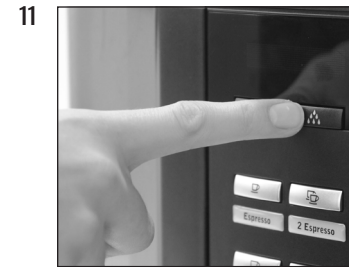
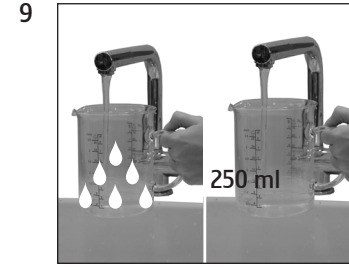

CAPPUCCINO / CLEANS
COFFEE READY

Weekly milk system clean

Complete this procedure once a week after the daily milk system clean

1. Remove the automatic milk frother from the machine. (Fig 1 - 2)
2. Separate the automatic milk frother into 4 parts. (Fig 3)
3. Soak plastic / rubber parts in 250ml of warm water & 15ml of Cafetto red weekly solution for 20 min.
4. Remove the parts from the solution and rinse them under cold tap water.
5. Re-assemble the auto frother and refit onto the machine.

Important: Do not soak metal / chrome parts to avoid possible damage.



Figure 1



Figure 2



Figure 3



My Coffee Shop Pty Ltd
ACN 102 850 037

390 Johnston St
Abbotsford Vic 3067
ph: 03 9946 4160

97/1-5 Harwood St
Pymont NSW 2009
ph: 02 9034 6580

IMPRESSA Xs9 Classic

Cleaning the machine

Approximate duration 20 min.

3-phase cleaning tablets
 Prod no. 71112 25pcs
 Prod no. 71111 6pcs



These short instructions do not replace the 'IMPRESSA Xs9 Classic Instructions for Use'. Make sure you read and observe the safety information and warnings first in order to avoid hazards.

Precondition: COFFEE READY / CLEAN MACHINE



DURATION 20 MIN. / START YES



EMPTY TRAY

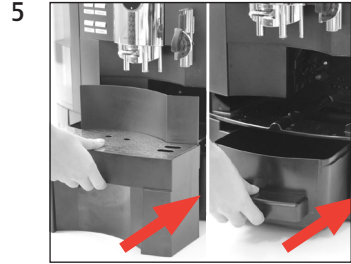
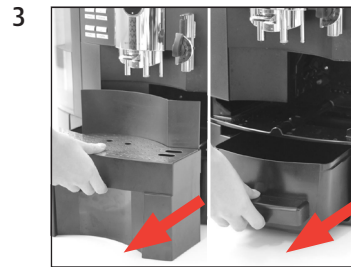

PRESS RINSE

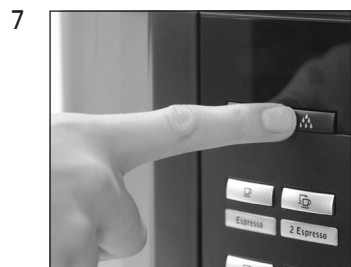

CLEANS
ADD TABLET / PRESS RINSE

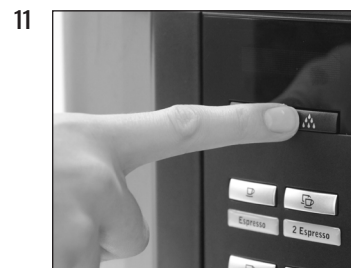

REINIGT
EMPTY TRAY

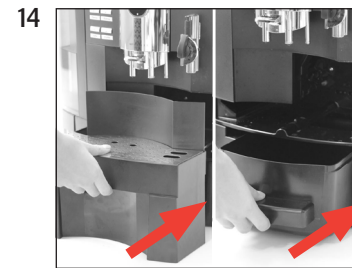
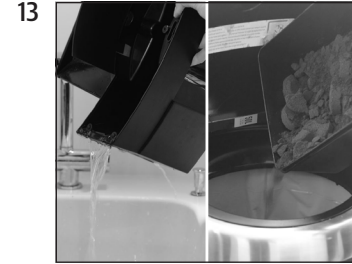
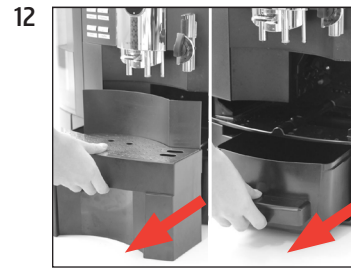

COFFEE READY

IMPRESSA Xs9 Classic



Descaling the machine

Approximate duration 45 min.

Descaling tablets
 Prod no. 71122 36pcs
 Prod no. 71121 9pcs



These short instructions do not replace the 'IMPRESSA Xs9 Classic Instructions for Use'. Make sure you read and observe the safety information and warnings first in order to avoid hazards.

**Precondition: COFFEE READY /
 DECALCIFY MACHINE**



**DURATION 45 MIN. /
 START YES**

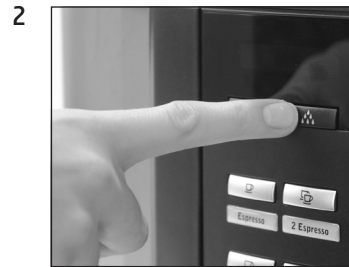

EMPTY TRAY

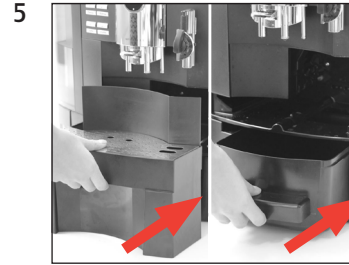
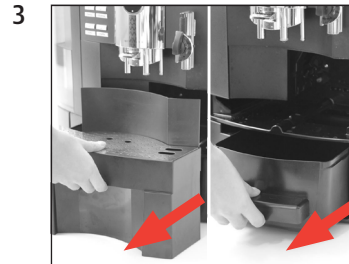

SOLVENT IN TANK

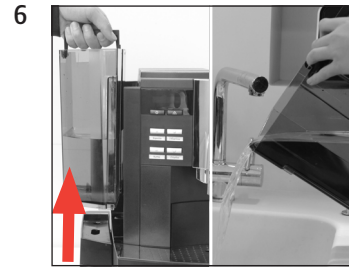

**SOLVENT IN TANK /
 PRESS RINSE**

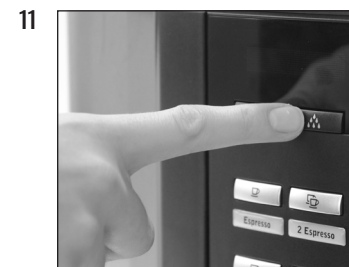

**DECALCS
 EMPTY TRAY**

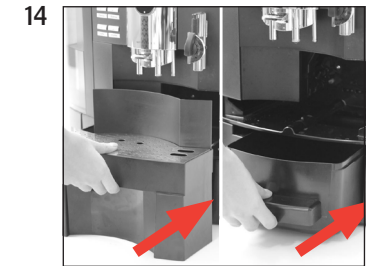
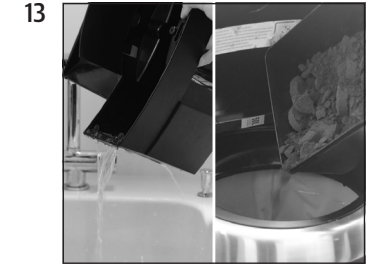
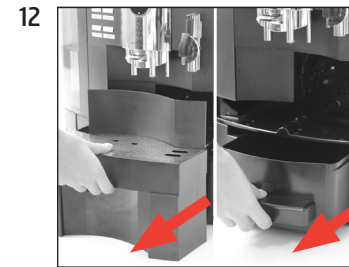

**RINSE WATER TANK /
 FILL WATER TANK**

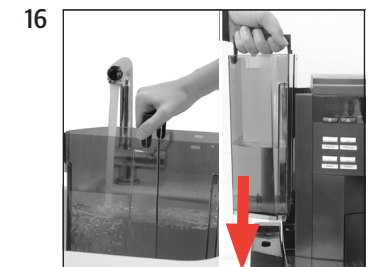
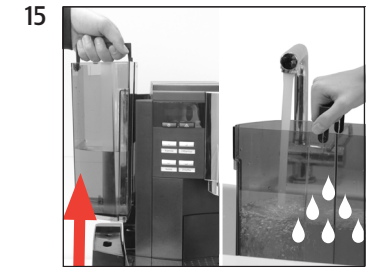

PRESS RINSE

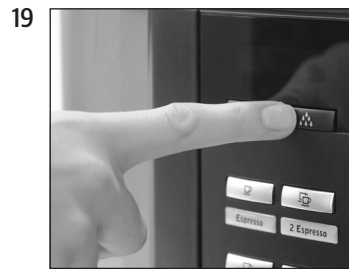
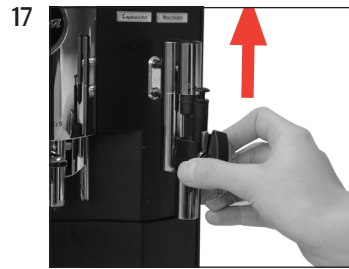

DECALOS
HEATING UP
MACHINE RINSING
EMPTY TRAY

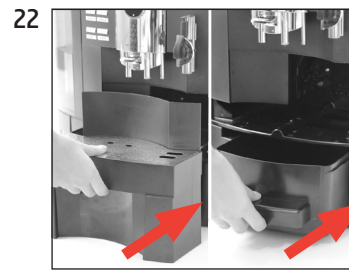
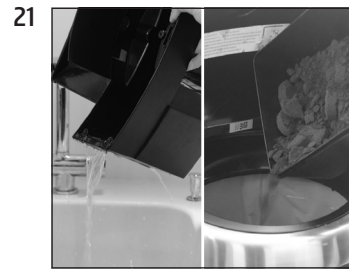
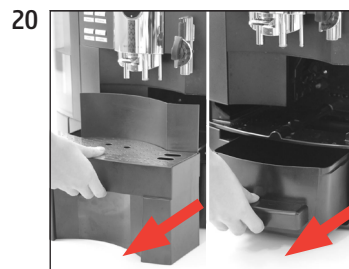

COFFEE READY

6 Display messages

Message	Cause/Result	Action
FILL WATER TANK	The water tank is empty. You cannot prepare any coffee products, hot water or milk products.	▶ Fill the water tank (see Chapter 1, 'Preparing and using for the first time – Filling the water tank').
EMPTY GROUNDS	The coffee grounds container is full. You cannot prepare any coffee products, but you can prepare hot water or milk.	▶ Empty the coffee grounds container and the drip tray.
EMPTY TRAY	The drip tray is full. You cannot prepare any coffee products, hot water or milk products.	▶ Empty the drip tray.
TRAY MISSING	The drip tray is not inserted correctly or is not inserted at all. You cannot prepare any coffee products, hot water or milk products.	▶ Insert the drip tray. ▶ Clean the metal contacts on the back of the drip tray.
FILL BEANS	The bean container is empty. You cannot prepare any coffee products, but you can prepare hot water or milk.	▶ Fill the bean container (see Chapter 1, 'Preparing and using for the first time – Filling the bean container').
PRESS RINSE	The IMPRESSA is prompting you to start a rinse operation or continue a started maintenance programme.	▶ Press the maintenance button to start rinsing or to continue the maintenance programme.
COFFEE READY / RINSE CAPPUCCINO	The IMPRESSA is prompting you to start cappuccino rinsing.	▶ Press the maintenance button to start cappuccino rinsing.
COFFEE READY / CLEAN MACHINE	After 220 preparations or 80 switch-on rinses, the IMPRESSA will prompt you to clean it.	▶ Clean the machine (see Chapter 5, 'Maintenance – Cleaning the machine').

Message	Cause/Result	Action
COFFEE READY / CLEAN NOW	After 250 preparations the IMPRESSA will prompt you to clean it.	► Clean the machine (see Chapter 5, 'Maintenance – Cleaning the machine').
COFFEE READY / DECALCIFY MACHINE	The IMPRESSA is prompting you to descale it.	► Descale the machine (see Chapter 5, 'Maintenance – Descaling the machine').
COFFEE READY / DECALCIFY NOW	The IMPRESSA is prompting you to descale it.	► Descale the machine (see Chapter 5, 'Maintenance – Descaling the machine').
COFFEE READY / CHANGE FILTER	After 50 litres of water have flowed through, or after two months, the filter will cease to work.	► Replace the CLARIS filter cartridge (see Chapter 5 'Maintenance – Changing the filter').
COFFEE READY / CHANGE NOW	After 55 litres of water have flowed through, the filter will cease to work.	► Replace the CLARIS filter cartridge (see Chapter 5 'Maintenance – Changing the filter').
NOT ENOUGH PRE-GROUND	There is too little pre-ground coffee in the filler funnel. The IMPRESSA stops the operation.	► The next time you make coffee use more pre-ground coffee (refer to Chapter 3, 'Preparation at the touch of a button – Pre-ground coffee').

Troubleshooting:

Milk flow

- No milk flow
- Milk spluttering
- Not filling cups
- Froth milk is flat & cool

Solution:

1. Remove the air suction. (Fig 1)
2. Check the valve on the tip of the air suction is clean and is able to open and close freely. Squeeze the valve between your fingers, it should open, release it and it should close. (Fig 2)
3. Refit the air suction. Turn the milk selector to the froth position (Fig 3), and test the milk. If the problem is still occurring replace the air suction and test again. If the problem has been solved, order in a spare air suction (Part no. 71866) otherwise go to step 4.
4. Remove the auto frother from the machine. (Fig 4)
5. Separate the auto frother into 4 parts. (Fig 5)
6. Soak plastic / rubber parts in 250ml of warm water and 15 ml of Cafetto red weekly cleaner for 30 min.
7. Clean the milk and air paths with the cleaning brush (Part no. 71161) (Fig 6 – 9)
8. Rinse parts under tap water, re-assemble the auto frother and refit onto the machine.
9. Test the milk. If the problem has not been solved contact customer support on 1300 365 487.

Important: Do not soak metal / chrome parts to avoid possible damage.



Figure 1



Figure 2



Figure 3 – Froth



Figure 4



Figure 5



Figure 6 - Milk

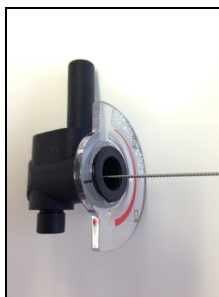

Figure 7 - Milk



Figure 8 - Air



Figure 9 - Milk



My Coffee Shop Pty Ltd
ACN 102 850 037

390 Johnston St
Abbotsford Vic 3067
ph: 03 9946 4160

97/1-5 Harwood St
Pyrmont NSW 2009
ph: 02 9034 6580

Welcome to My Coffee Shop!

Our hours of operation are Monday – Friday 9am to 5pm. Visit us at your convenience at www.mycoffeeshop.com.au. Orders and service requests can be placed by:

Phone: 1300 365 487
E-mail: clientservices@mycoffeeshop.com.au
Online: www.mycoffeeshop.com.au
Remittances: accountsreceivable@mycoffeeshop.com.au
Service enquiries: servicecentre@mycoffeeshop.com.au

Next business day delivery via courier to:

Adelaide Canberra Melbourne Sydney

for product orders placed by 1.30pm

Please note you will be advised when ordering if delivery charges apply to your order.

Once again, welcome to My Coffee Shop and remember we are here to help. If you have any questions please don't hesitate to contact us.

We look forward to exceeding your expectations and making your day easier and more enjoyable.

Kind regards,

My Coffee Shop
Client Services
My Coffee Shop Pty Ltd



My Coffee Shop Pty Ltd
ACN 102 850 037

390 Johnston St
Abbotsford VIC 3067
Ph: 03 9946 4160

97 / 1-5 Harwood St
Pymont NSW 2009 Ph:
02 9034 6580