

SMDSO



SUMO

Waterproof diaper cover, available in 3 different sizes and colours.

✧ **Pre-wash before first use**

UFO

Super absorbent inlays, with a two part design for quicker drying time.

✧ **Pre-wash before first use**

DREAMLINER

Liners that catch the big business and keep the baby's bum dry.

✧ **Dispose in household waste, or flush if your plumbing allows**

SCHLEPP

Store used diapers and inlays for up to 3 days, then open and throw directly into the washing machine.

✧ **No need to get your hands dirty**

PREP

①

Open your SUMO diaper and lie it out flat, with the inner pocket facing upwards.



②

Take a pair of UFO inlays and tuck them into the waterproof pocket.



③

If using our DREAMLINER, tear off a sheet.

✦ **Recommended to use once your baby is on solids.**



④

Place the liner on top and tuck inside the pocket.



WEAR

5

Slide the SUMO under the baby's bum and fold it up between the legs.



6

Pull the front up, fold the first strap over and fasten with the adjustable velcro tape.



7

Repeat the same on the other side and secure the two straps into a bow.



8

Tuck in any excess fabric and make sure there are no gaps between the baby's legs.



CLEAN & CHANGE

1

Remove the used DREAMLINER and dispose it in your household waste.

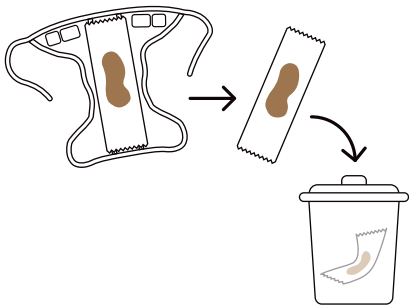

2

Remove the used UFO inlays, and store in your SCHLEPP bag.

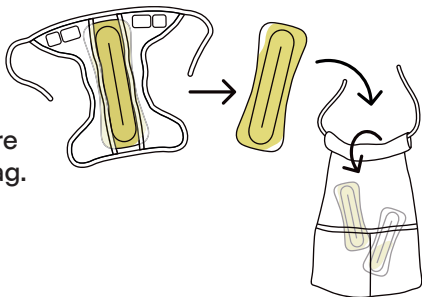

3

If clean, you can reuse the outer SUMO diaper several times.

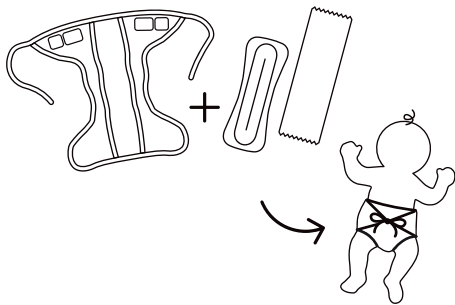

4

If soiled, fold back and secure the laundry tabs and add to your SCHLEPP bag.

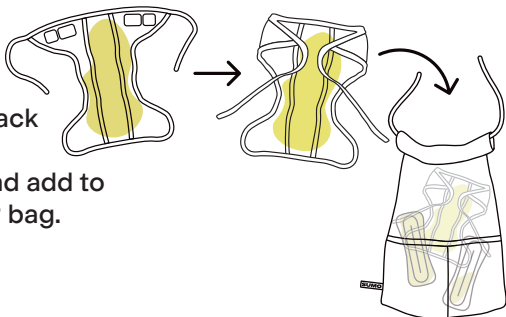

STORE & WASH

5

Store diapers and inlays for up to 3 days in your SCHLEPP bag. Open and place your bag directly in the washing machine. During washing everything will fall out automatically.

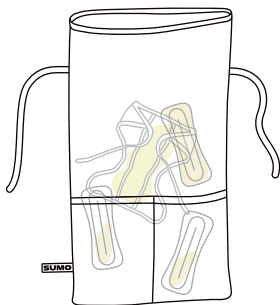

6

Wash on a 40°-60°C program with prewash, spin speed set to 1200 rpm.

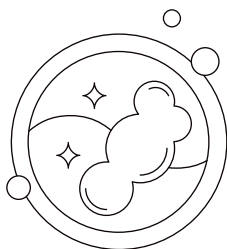

7

We recommend using a sensitive all-purpose washing powder, which usually cleans cloth diapers hygienically, even at low temperatures.



✦ **Do not use fabric conditioner**

8

Its best to line dry your inlays and diapers

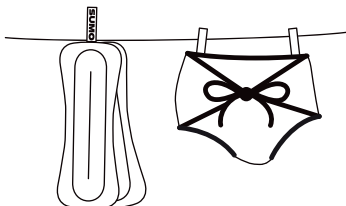

MATERIALS

Starting with fibre, our products are made of custom engineered materials that are specifically developed to be kind to your baby's skin and the environment.

SUMO Shell

Sumotex™ Lyocell (Tencel™) & Organic Cotton (GOTS)

Origin: Developed & produced in Portugal

Properties: soft, silky, durable, great stretch & drape

SUMO Straps

Cotton

Origin: Produced & sourced in Germany

Properties: stretchy, durable

SUMO Membrane

SmartCell™ & PU membrane

Origin: Produced & sourced in Spain

Properties: waterproof, breathable, odor-repelling

UFO Lining

Sumotex™ Lyocell (Tencel™)

Origin: Developed & produced in Portugal

Properties: soft, wicking, skin-caring, anti-bacterial

UFO Core

Kelheim Bramante & patented Galaxy® fibre

Origin: Developed & produced in Germany

Properties: distribution, absorption, retention

We'd love to hear from you!

hello@sumobaby.com

sumobaby.com

@sumobaby



Sumo GmbH

Brüsseler Straße 32

13353 Berlin, Germany

Photo: Valeria Mitelman
mitelman.de

Design: Amira Prescott
amiraprescott.com

© 2023 Sumo GmbH