

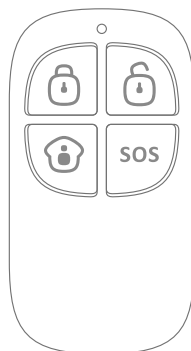

Wireless Remote Control

RC-80

User Manual



LED Indication

LED flashes once: sends the transmitting signal.

Dim light: Low battery, please replace the battery immediately.

Overview

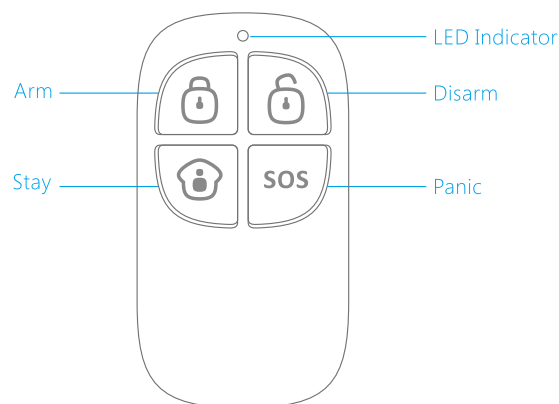

Specifications

Power supply DC 3V (CR2025 Lithium Battery x 1pc)

Working current <7mA

Transmitting distance ≤ 80m (in open area)

Radio frequency 315MHz or 433.92MHz (± 75KHz)

*Only 433.92MHz is available for Europe

Housing material ABS plastic

ERP(dBm) Max. -14.81

Operation Condition

Temperature 0°C ~ +50°C

Relative humidity <90% (non-condensing)

Dimensions (L x W x H) 58 x 31 x 9.5mm

Introduction

The remote control enables you to turn the alarm system on and off before entering the home or after exiting. If there is an emergency, press SOS button on the remote control to trigger the panel. RC-80, compact and portable, is designed to fit on a keychain, in a pocket, or in a purse.

Usage

	Arm	Press to arm the alarm panel and all of the accessories. (Away Mode)
	Disarm	Press to disarm the alarm system.
	Stay/ Home Mode	Press to arm all sensors except the ones in zone A or Home Mode Zone, sensors in zone A or Home Mode Zone will not activate an alarm.
	Panic	Press to activate a panic alarm and the control panel auto-dials the pre-set phone numbers immediately.
	Mute Arm	Press to arm the system in mute.
	Mute Disarm	Press to disarm the system in mute.

CE Declaration of Conformity

Hereby, Chuango AIoT GmbH declares that the radio equipment type RC-80 Wireless Remote Control is in compliance with Directive 2014/53/EU. The full text of the EU declaration of conformity is available at the following internet address:
https://www.chuango.com/english/compliance_RC-80

INFORMATION FOR THE USERS

At the end of its life, the device has to be separated from the other waste. Consign the device and all its components together to a center of electronical and electrotechnical waste recycling center, designated by your local authorities.

2006/66/EC and its amendment 2013/56/EU (battery directive): This product contains a battery that cannot be disposed of as unsorted municipal waste in the European Union. See the product documentation for specific battery information. The battery is marked with this symbol, which may include lettering to indicate cadmium (Cd), lead (Pb), or mercury (Hg). For proper recycling, return the battery to your supplier or to a designated collection point. For more information see: www.recyclethis.info.