



Wireless Door/Window Contact

DWC-102

User Manual



PCB Layout

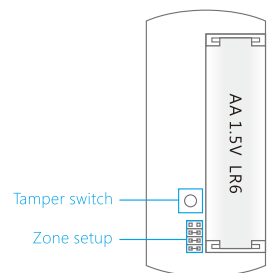

NOTE: When tamper switch is triggered, it will send out alarm signal immediately.

LED Indication

LED flashes once: Door/window is opened and transmitter sends signal to the control panel.

Flash once per 3 seconds: Low power indication, please change battery as soon as possible. (User will get alert about the low battery if the door contact is connected to the alarm system.)

Installation & Notice

- Open the case and remove the battery activation strip.
- Mount the sensor on the door frame and the magnet on the door.
- Make sure the magnet is on the right side of the transmitter
- Place the transmitter in the desired location, mount the magnet no more than 1cm away from the transmitter and secure the transmitter and magnet with double-sided tapes or screws.
- Avoid mounting sensors in areas with a large quantity of metal or electrical wiring, such as a furnace or utility room.

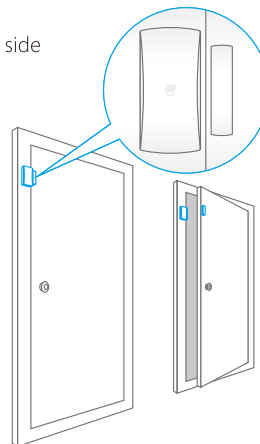

Specifications

Power supply: DC 1.5V (AA 1.5V LR6 Battery x 1 pc)

Static current: < 56uA

Alarm current: < 82mA

Transmitting distance: < 80m (in open area)

Radio frequency: 315MHz/433.92MHz (±75KHz)

**Only 433.92MHz is available for Europe&Australia*

Housing material: ABS plastic

ERP(dBm) Max.: -12.06

Operating temperature: 0°C to 50°C

Relative humidity: < 80% (non-condensing)

Transmitter dimensions (LxWxH): 71 x 34 x 17.5mm

Magnet dimensions (LxWxH): 51 x 12 x 13.5mm

Introduction

The DWC-102 is a Door/Window Contact that can be installed on doors, windows, and any other objects that can be open and close. The sensor transmits signals to the control panel when a magnet mounted near the sensor is moved away. It will also transmit alert signal to the control panel in case of low battery. The tamper protection ensures that sabotage attempts to move the contact will result in an alarm activation.

Product Overview

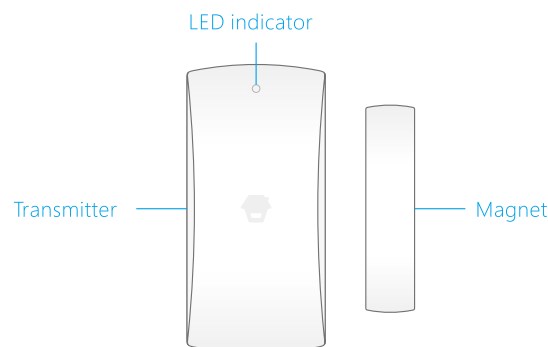

CE Declaration of Conformity

Hereby, Chuango A IoT GmbH declares that the radio equipment type DWC-102 Door/Window Contact is in compliance with Directive 2014/53/EU. The full text of the EU declaration of conformity is available at the following internet address:
https://www.chuango.com/english/compliance_DWC-102

INFORMATION FOR THE USERS

At the end of its life, the device has to be separated from the other waste. Consign the device and all its components together to a center of electronical and electrotechnical waste recycling center, designated by your local authorities.



2006/66/EC and its amendment 2013/56/EU (battery directive): This product contains a battery that cannot be disposed of as unsorted municipal waste in the European Union. See the product documentation for specific battery information.
The battery is marked with this symbol, which may include lettering to indicate cadmium (Cd), lead (Pb), or mercury (Hg). For proper recycling, return the battery to your supplier or to a designated collection point. For more information see: www.recyclethis.info.