



# leaf shield

Introducing a NEW addition to the **rain elements** family of products

Designed and manufactured in Canada specifically for our half-round Zambelli european eavestroughs, **Rain element's aluminum leaf shield utilizes our eavestrough hooks for easy installation.** The result? A durable and stylish leaf-shield solution for our new or previously existing eavestroughs.

#### AVAILABLE COLOURS:

Natural  
Aluminum

Black

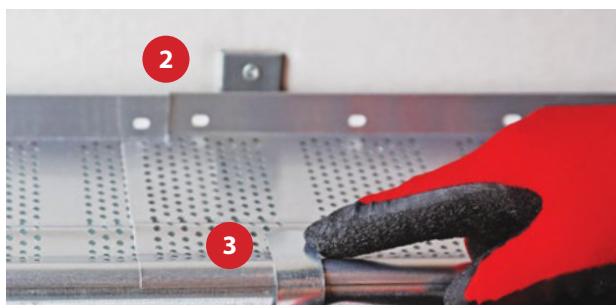

- (1) Open the tab on the eavestrough hooks (for most applications, every second one is sufficient). Place the leaf shield on the eavestrough.  
(2) Overlap the leaf shield lengths (or corner pieces) using the pre-cut notches. (3) Close the eavestrough hooks back over the leaf shield.  
(4) Secure the back lip with screws every 2 feet.

#### COMPONENTS

**Individual length** (7 feet)

**Box** (30 lengths/210 linear feet)

**Corner** (inside or outside 90° angle)



**Rain elements**  
EUROPEAN EAVESTROUGHS

Call 866.724.6607 or email [info@rainelements.ca](mailto:info@rainelements.ca)

[rainelements.ca](http://rainelements.ca)