

rock4d

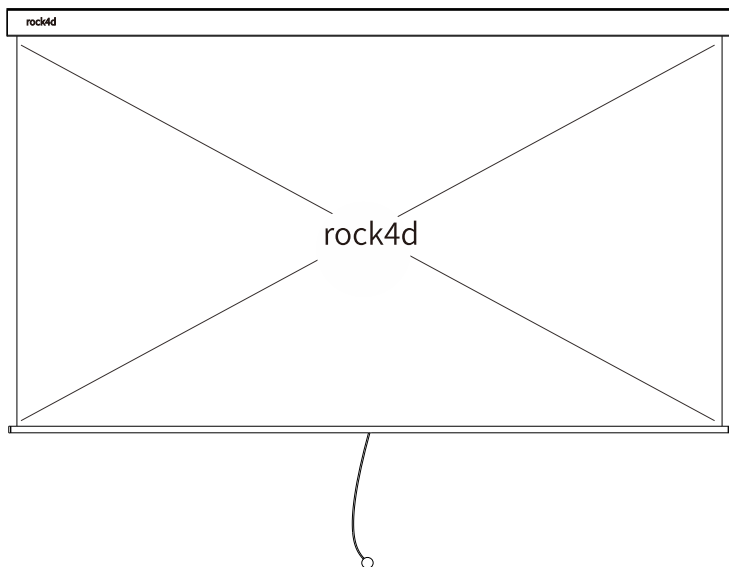

Projector Screen

Instruction Manual

(Please read this instruction manual carefully
before using and keep it for future reference)

Need any help?

Email: service@rockhomelife.com

Warnings

1. Be careful and gentle when unrolling the screen. Pull down and retract the screen vertically;
2. Do not poke or touch the screen surface with sharp objects to avoid surface damage;
3. To prevent dust from building up, please retract the screen back into its case when not in use;
4. Use only soft cloth with water to remove stains on the surface of the screen.

Make sure the screen is dry before use or storage.

What's in the box?

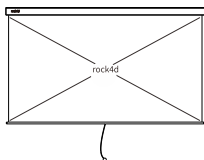

Projector screen x1

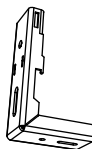

Wall mount bracket x2

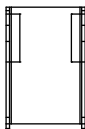

Ceiling mount bracket x2



Expansion drywall anchor x4



Screw x4

Installation Instructions

Ceiling Mounting

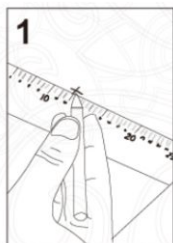

1. Measure the distance between the top and bottom screw holes from the ceiling mount bracket accurately and mark the location with a pencil.



2. Drill a hole in the marked areas.

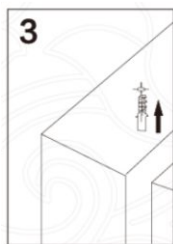

3. Insert an expansion drywall anchor into each drilled hole.



4. Secure the brackets to the ceiling with the screws.

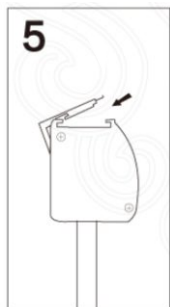

5. Attach the screen to the brackets by first inserting the back of the case into the slot, and then securing the outer edge with the spring hook. Make sure your screen is securely attached to the mount bracket.

Flush Wall Mounting

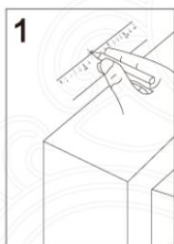

1. Measure the distance between the top and bottom screw holes from the wall mount bracket accurately and mark the location with a pencil.



2. Drill a hole in the marked areas.

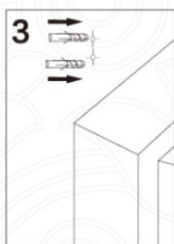

3. Insert an expansion drywall anchor into each drilled hole.

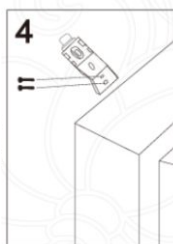

4. Secure the brackets to the wall with the screws.

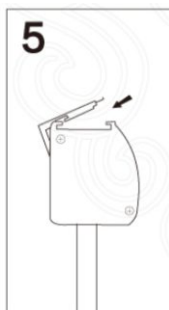

5. Attach the screen to the brackets by first inserting the back of the case into the slot, and then securing the outer edge with the spring hook. Make sure your screen is securely attached to the mount bracket.

Screen Operation

To get the most out of the screen, we recommend projectors with 1,000 ANSI lumens or more.

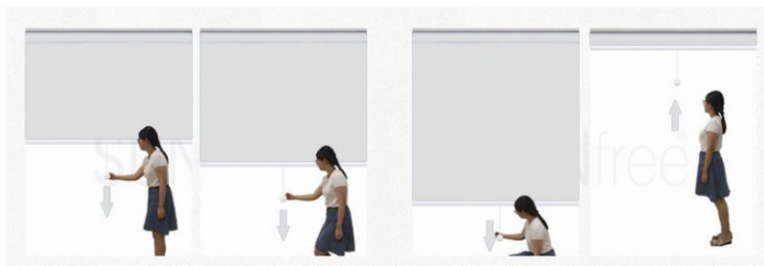

To pull the screen down:

Grasp the handle and pull straight down. The screen will lock automatically when you stop pulling.

To retract the screen:

Simply pull the screen down and let go. The screen rolls back up automatically.

Names and Contents of Hazardous Substances

Category	Toxic and Hazardous Substances					
	Lead (Pb)	Mercury (Hg)	Cadmium (Cd)	Hexavalent chromium (Cr ⁶⁺)	Polybrominated biphenyls (PBB)	Polybrominated diphenyl ethers (PBDE)
Screen	O	O	O	O	O	O
Housing and accessories	O	O	O	O	O	O

O : Indicates that the content of the toxic and hazardous substance in all homogeneous materials of the part is below the concentration limit requirement as described in SJ/T 11363-2006 standard.

X : Indicates that the content of the toxic and hazardous substance in at least one homogeneous material of the part exceeds the concentration limit requirement as described in SJ/T 11363-2006 standard.

Warranty

In case of any quality failures caused by non-human factors within the warranty period, the product can be returned replaced, or repaired:

- Within 7 days from the date of receipt, you can request a refund or a replacement product of the same model and specification for any quality failures caused by non-human factors.
- Within 15 days from the date of receipt, you can request a replacement product of the same model and specification for any quality failures caused by non-human factors.
- Within 1 year from the date of receipt, you can ship the product to us for repair for any quality failures caused by non-human factors.

No Warranty

The following situations will not be covered under the warranty, including but limited to:

- Unauthorized maintenance, misuse, crash, negligence, abuse, liquid ingress, accident, alteration; or tearing or altering product labels and seals.
- Damages not within the effective warranty period.
- Damages caused by force majeure events such as fire, flood, and lightning.
- Quality failures attributable to human reasons.
- Damages caused by failure to comply with this Instruction Manual.