

VIELIGHT
NeURO 2 Alpha α **USER**
 2 Gamma γ **GUIDE**

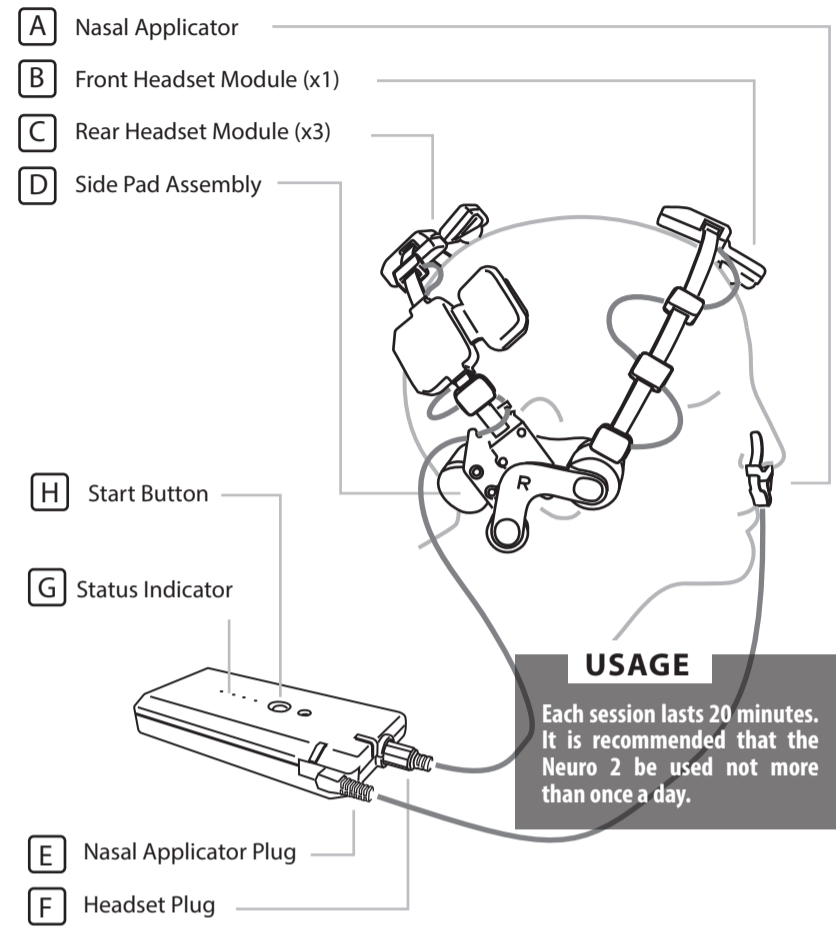

USAGE
 Each session lasts 20 minutes. It is recommended that the Neuro 2 be used not more than once a day.

- 1 Charge the battery before using the Neuro 2 for the first time. The battery is completely charged when the status indicator goes off.
- 2 Place the headset as illustrated. Ensure that the headset modules [B, C] are in contact with the skin, and that the side pad assembly [D] is sitting comfortably around the ears. When priority is given to the correct placements of the headset modules, the side pad assembly will settle between the ear and cheek. On smaller heads, the assembly may sit lower.
- 3 Insert the nasal applicator [A] into either the right or the left nostril with the clip on the outside and the lens in the nostril.
- 4 Insert the headset plug [F] and the nose applicator plug [E] into the controller as shown in the diagram on the first page.
- 5 Press the start button [H] to begin. The status Indicators [G] will show remaining application time. The unit switches off automatically after 20 minutes.
- 6 The Neuro 2 will automatically shut down when the battery charge level is too low to maintain performance specification. The beeper will sound and the controller will indicate fault status 1, 4. Please proceed to charge the device.

USING THE NASAL APPLICATOR

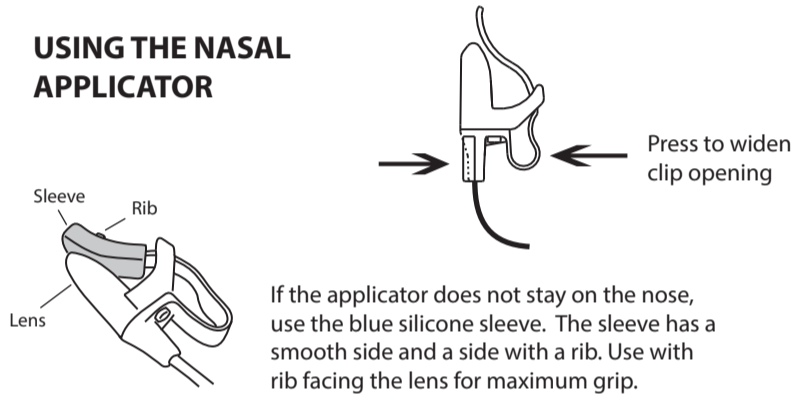

POSITIONING THE HEADSET MODULES

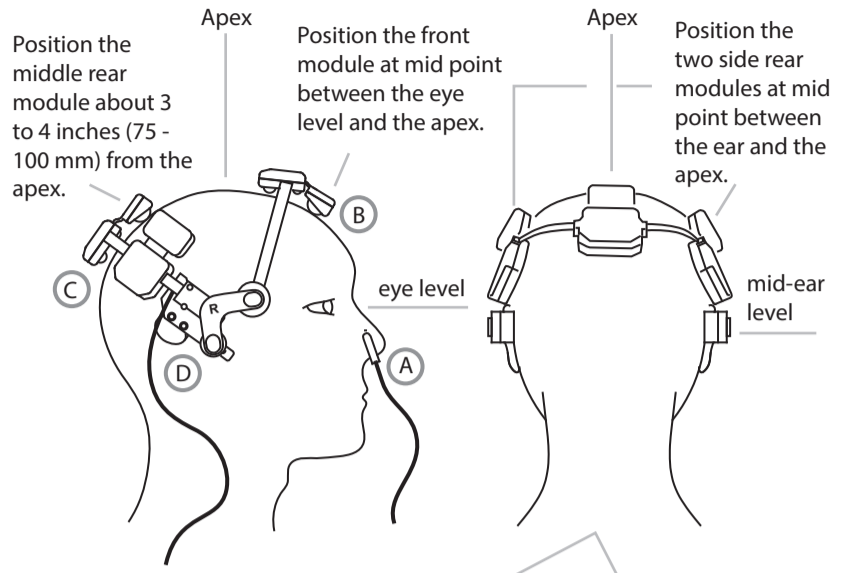

ADJUSTING THE SIDE PADS

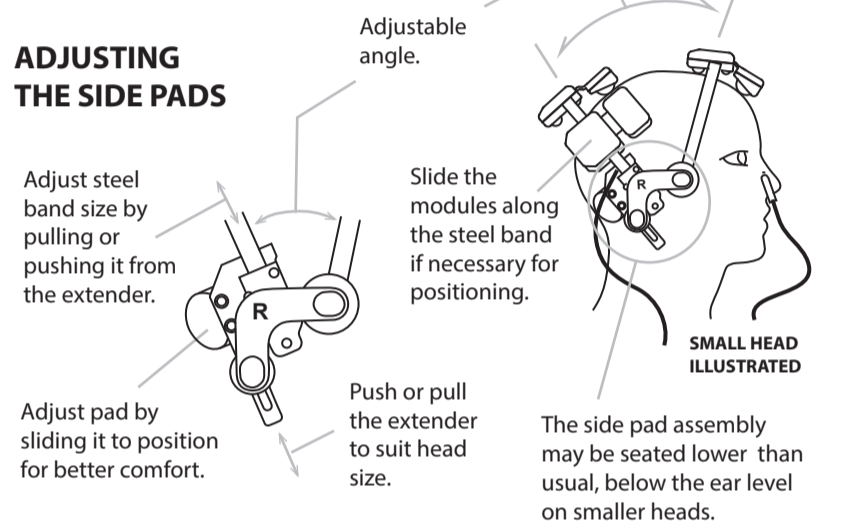

CHARGING THE BATTERY

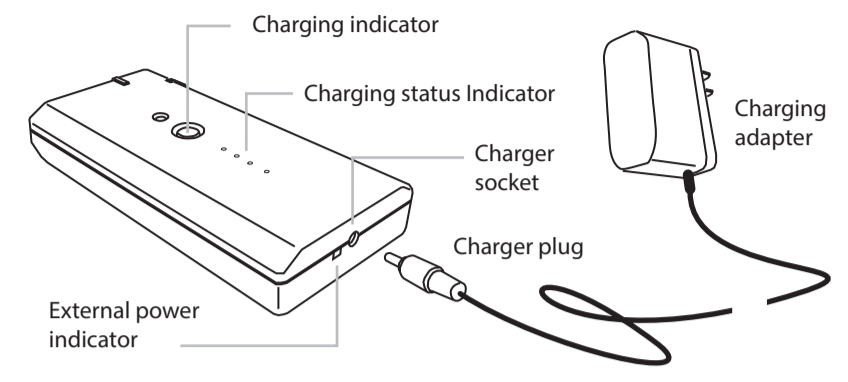

Insert the charger plug completely into the charging socket of the controller and connect the charging adapter to the mains power. The external power indicator light up and charging starts. If this indicator does not light up, check power connections.

When charging starts, the status indicator displays the charging progress. If the charging lights do not come on, power off and on to restart the charging process

Complete charging takes a maximum of six hours and stops automatically.

A fully charged Neuro 2 is sufficient for about five applications.

Note: 1. If the battery power is exhausted, it will not charge normally and the status indicator remains inactive when the power supply is plugged in. Leave the power plugged in overnight to allow for trickle charging. Thereafter, press the start button to reset the system and to resume normal charging.
 2. The battery will not charge when the device is in test mode.

USING THE NEURO 2 WHILE CHARGING

The Neuro 2 can be used while charging. Please note the following:

1. The charging adapter provides power for charging the battery only and does not provide power to run the device.
2. If the battery reserve is low, connecting the charger adapter to the unit will not enable a full application. Please allow the Neuro 2 to charge for at least 1 hour before use.

SIDE A

MAINTAINING BATTERY PERFORMANCE

1. Before using the Neuro 2 for the first time, charge the controller with the Vielight charging adapter until it stops automatically.
2. Do not allow the battery in the controller to be completely discharged as it may affect its lifespan.
3. Use only the charging adapter provided with your Neuro 2. Using charging adapters belonging to other electronic devices may damage your Vielight controller and void your warranty.
4. Keep the Neuro 2 fully charged as often as possible as such, it is recommended to charge it after every use. It is safe to keep the Neuro 2 connected to the charging adapter as the charging process will automatically stop when it is completed.

CARE AND CLEANING

1. To clean the Nasal Applicator, wipe gently with alcohol or antiseptic wipe. As an option for added hygiene, use a UV sanitizer.
2. Use a soft, dry cloth to clean the other surfaces. Do not use abrasive cleaners. Do not submerge any component in liquid.
3. Store the equipment in a dry location, free from dust, away from direct sunlight. The storage temperature should be within 10° C to 40° C.

SAFETY ADVICE - INFRARED LIGHT SOURCE

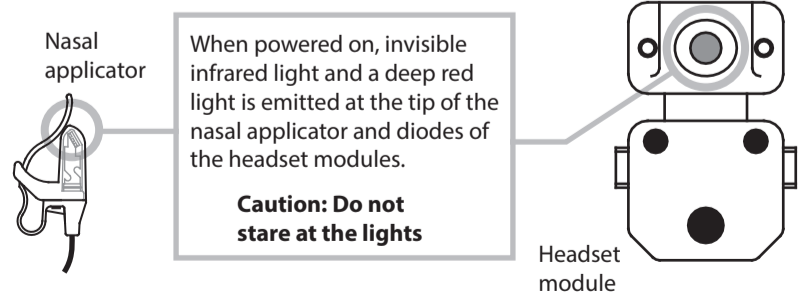

Most people do not experience physical discomfort while using the Neuro 2, although some feeling of warmth is expected.

DEVICE SELF TEST

The device should be checked for proper functioning periodically by following the steps below.

1. Plug the headset, nasal applicator, and the charging adapter to the controller.
2. Plug the charging adapter to the mains power.
3. Press the start button for 5 seconds, until you hear a beep and the result of the test will be displayed by the status indicator. To test again, press the start button.
4. The device will exit test mode automatically after 30 seconds, or press the start button again until the beep sounds.

Test results:
 1. If all the light indicators on the controller blink, the system is in order.
 2. If a fault is detected, the main fault light will blink, and the status light will identify the fault as described below.

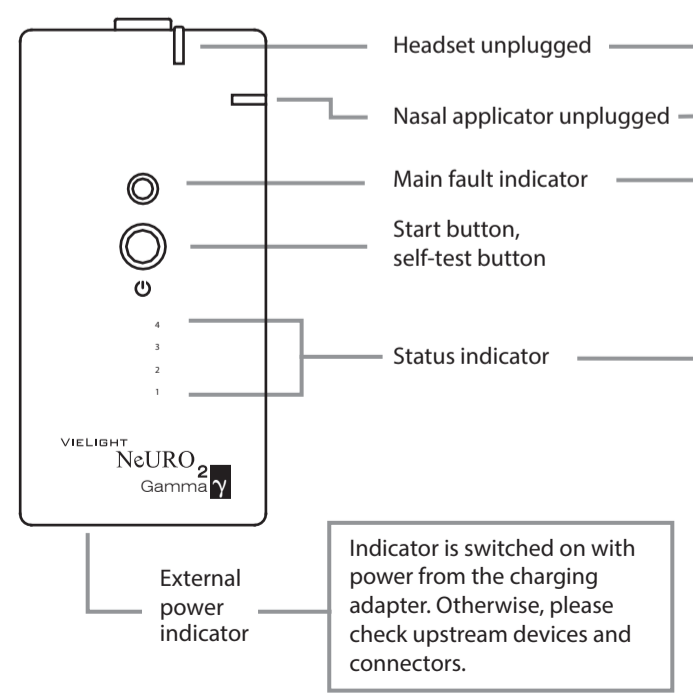

SPECIFICATION

Light source, headset: 810 nm LED x 4
 Light source, nasal applicator: 810 nm LED x 1
 Output power (Alpha): Regulated, pulsed at 10 Hz, synchronised
 Output power (Gamma): Regulated, pulsed at 40 Hz, synchronised 20 minutes
 Auto off timer: Built in, auto boost & trickle charge, auto shut off 20 minutes
 Battery charger: LED, sounder, fault code, auto system shut off
 System health check: 7 parameters, LED indicators, sounder
 Battery Low Indicator: Sequential light indicator
 Fault Indicators: LED, fault code, sounder
 External power indicator: LED with independent circuit
 Treatment timer: Sequential light indicator
 Charging Status: Sequential light indicator
 Battery Type: NiMH 1900 mAh, 3.6 V
 Power Adapter: AC Input: 100-240 V, 0.35 A, 50/60 Hz
 DC Output: 7.5 V, 1.0 A

SELF TEST INDICATIONS

IND	DESCRIPTION	ACTION
1, 2, 3, 4	Device is functioning normally	None. No fault detected
1, 2	System error 1	Contact Vielight support / reseller
1, 3	System error 2	
1, 2, 4	Battery charger fault	Charge the battery
1, 4	Battery level low	
2, 3	Headset front module fault	Check that the plugs are inserted completely and test again. If error persist, contact Vielight support/dealer.
2, 4	Headset rear module fault	
3, 4	Nasal applicator fault	

Follow the instructions in the user guide.

Note important cautionary information such as warnings or cautions before using the device.

Alpha V2
 Gamma V2

Vielight Inc.,
 346A Jarvis Street,
 Toronto, ON M4Y 2G6, Canada

(North America) +1-877-355-8012
 (International) +1 647 201 5499

CE
 CISPR 32:2012/
 EN 55032:2012
 CISPR 24:2012/
 EN 55024:2010

LIMITED ONE - YEAR WARRANTY

Your Vielight Neuro 2 is warranted to be free of defect in material and workmanship under normal use.

This warranty is limited to a period of one year from the purchase date. Within this period, repairs or exchange of parts that are deemed necessary by the company will be made free of charge.

This warranty does not cover damage by the following:
 a. Misuse, abuse or alteration to the product
 b. Damage caused by accident or neglect
 c. Service or repairs made by unauthorized persons

WE SHALL NOT BE RESPONSIBLE FOR ANY INCIDENTAL, SPECIAL, OR CONSEQUENTIAL DAMAGES RESULTING FROM THE USE OF THIS PRODUCT.

SIDE B