

## Installation Guide Classic Cable Rail System - Timber Post



Complete installation videos available at:  
[youtube.com/@gauthierdelaplante](https://www.youtube.com/@gauthierdelaplante)

---

### Material required

- Drill
- 1/2" Wrench
- 9/16" Wrench
- Cable cutter or Grinder
- Pliers

### Stainless steel wire rope

- Cut all but one plastic ties and unwind the cable. This will prevent the cable from tangling. To cut the cable, use either a stainless steel cable cutter or an angle grinder with a stainless steel cutting disc.

### Tensioning the cable runs

**IMPORTANT! Handrails must be attached to the posts before tensioning the cable!**

Begin the tensioning in the middle of the post, giving a minimum of tension. Once all of your cable runs are installed, adjust the tension on each line following the same sequence.

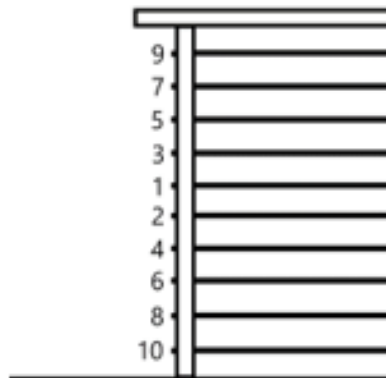

## Installation steps

1. Start with the swageless jaw terminal. In your end post, drill a  $\frac{1}{4}$ " diameter hole (about 1" deep). Insert the screw eye in the wood. Attach the swageless jaw terminal (with the clevis pin) to the screw eye.



2. To install the swageless threaded stud terminal, drill a  $\frac{11}{32}$ " diameter hole (M8) through the other end post. Install the stud, leaving  $\frac{1}{2}$ " of space between the inside of the post and the stud.



3. Unscrew the cone of the swageless jaw terminal and insert the cable into the cone and the wedge until it is fully seated in the terminal. Tighten securely using a  $\frac{9}{16}$ " wrench and pliers.

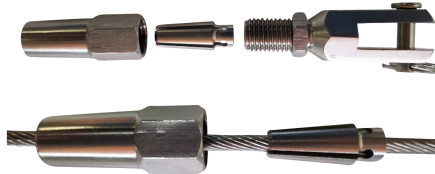

4. Measure the distance to the swageless threaded stud terminal. Cut the cable accordingly. Unscrew the cone of the stud terminal and insert the cable into the cone and the wedge until it is fully seated in the terminal. Tighten securely using a  $\frac{9}{16}$ " wrench and pliers.



5. For tensioning the cable, tighten the nut as much as possible with a  $\frac{1}{2}$ " wrench while holding the tensioner inside the post with pliers. When at full tension, the stud terminal should be almost fully retracted to the post.

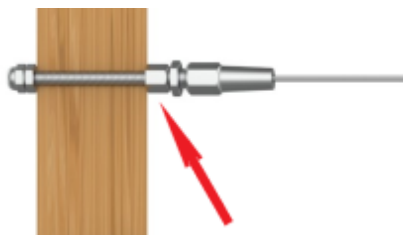

6. Once tensioning is complete, cut excess thread with a hacksaw. Make sure to leave at least a  $\frac{1}{4}$ " of rope exposed to install the acorn nut.

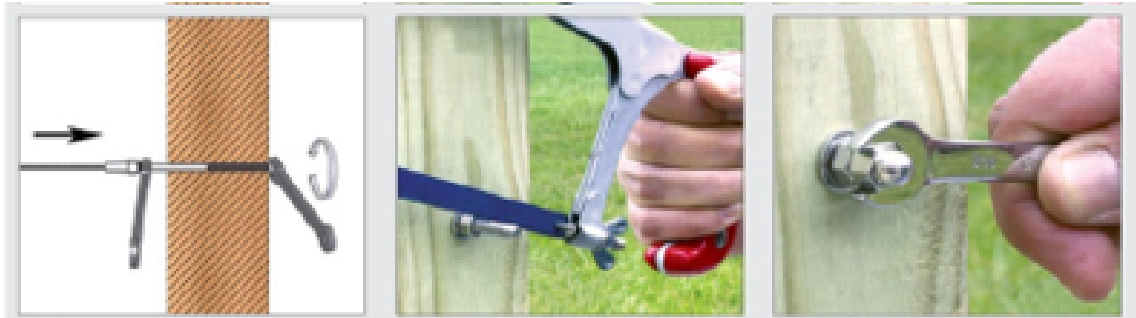

### **Notes :**

- The first cable run is THE most important. It is crucial to carefully measure the length of wire rope you will need (make sure to save enough for the following lines).
- If you have intermediate posts (posts where the wire rope passes through), pre-drill  $\frac{7}{32}$ " diameter holes ( $\frac{1}{4}$ " if you want to install protective sleeves).