

Technical Specifications (Technical specifications subject to change without notice!)

Nominal size	Pluto / size 1	Pluto / size 2
Weight (kg) / product	8.0*	8.5*
Weight (kg) / saddle seat unit	1,6	1,8
Maximum patient weight (kg)	60.0	80.0
Length (mm)	790	850
Width (mm)	640	670
Height of rests (mm) (Support height from – to)	450 - 810	550 - 910
Distance between mid-line-of the grip handles (mm)	240 - 460	260 - 480
saddle seat height (mm)	430 – 540**	510 – 630**
Max. turn radius (mm)	970	1000

*without saddle unit **see: 7. adjusting the saddle seat height

Spare Parts and Accessories

Art. No.	Name	Material
Spare parts		
282.23.54	Soft grip / handle cover	Coex black
288.00.45	Front wheel D=200 mm	Plastic
288.00.46	Rear wheel D=200 mm	Plastic
287.10.44	Directional locking (only)	Plastic/Aluminium
853.06.40	Star knob M6x40	Plastic, steel
287.10.45	Front wheels with directional locking / swivel lock	Plastic, steel
287.00.38	Saddle seat (only)	PU foam /fabric
Accessories		
287.20.10	Saddle seat unit for size 1	PU foam/Steel
287.20.20	Saddle seat unit for size 1	PU foam/Steel
280.10.48	Back cushion	PU foam /fabric

Care and Maintenance

The surface of the steel tubing has been provided with a paint coating. The Reverse Walker can be cleaned with a commercially available cleaning or disinfecting agent – always follow instructions for use. All moving parts are permanently lubricated. Carefully check over all screws and braking devices.

Allow your Reverse Walker to be checked over by specialised dealer once a year!

Reuse

The product is intended for reuse. The reuse (life) depends on the product state.

Before the re-use of the device maintenance must be carried out and the appropriate instructions to security, care and maintenance must be observed. This review shall exclude a possible improper use caused by obvious or invisible damage. Please refer to the Medical Device Directive (MDD) and the regulation for operator (MPBetreibV).

Life

The expected life of the products listed in this manual when used in accordance with safety instructions, maintenance intervals and care instructions is **3 years**.

Beyond this period, the product can be set used only in a safe condition. Maintenance should be done at least every six months. Specific requirements of the product, due to the use of the patient, causing shorter maintenance intervals.



User Instructions

BA No.: 02.05.013/2016-12



REBOTEC

REBOTEC® Rehabilitationsmittel GmbH



Reverse Walker

Pluto / size 1
187.00.10
Max. 60 kg

Serial Number



Pluto / size 2
187.00.20
Max. 80 kg

Serial Number

Picture showing
back cushion



Picture showing
Pluto / size 2 with
directional lock and saddle
seat unit



Intended Use / User Advisory

The Reverse Walkers are designed to train children and teens in walking:

- For therapeutic development of movement of impaired children,
- For central nervous system disorders,
- For post traumatic / post infection conditions involving physical impairment, if necessary with measured relief.

The tubular design provides security against tipping over. Its light weight makes the Reverse Walker easier to operate. The backrest may be outfitted with back padding (accessory). The seat and bow handle are height adjustable.

Have your specialised dealer or care provider advice you on using the Rollator and its adjustment for proper function!!

Instructions for Assembly and First-time Use

1. Unfolding the Reverse Walker

Place the Reverse Walker on its front wheels and pull up the rear wheel frame with the rear wheels apart (A) **Fig. 1**. The Reverse Walker clicks by itself into its final position (J).

2. Installation/adjusting the handle bracket

Remove the two star grip screws and insert the handle bracket into the tubes. Then choose the appropriate height (D) **Fig. 2** and adjust the grip handles to the next screw hole. Reinstall the star-grip screws (C) and tighten them firmly.

3. Installation/adjusting the handlebars

Insert the two handles (E) laterally into the inside opening (F) of the handle bracket. Adjust the handles to the desired handle position. Make sure not pulling the handle out of the bracket (F). The handle must rest against the stop. Then tighten the screws (E) with an Allen key firmly.

4. Disengaging the Reverse Motion Brake

To disengage the reverse motion brake pull the latch bolts (G) towards the unit's inside and turn the brakes a ways counter clockwise. Then allow the latch bolts (G) to click into the straight slot (see: **Fig. 5**). **Warning! The brakes are now disengaged!**

5. Engaging the Reverse Motion Brake

To engage the reverse motion brake pull the latch bolts (G) towards the unit's inside and turn the brakes a ways clockwise to the tires. Allow the latch bolts (G) to click into the curved slot. Then check the function of the reverse motion brake.

6. Directional locking/swivel lock (accessory)

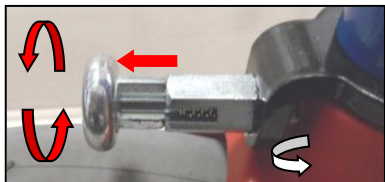

If the front wheels are equipped with directional lock, the engaged bolt is activating the steering stop and the fork is no longer rotatable.

Pulling out the bolt and turning the bolt 90 degrees, the swivel lock is deactivated and enabling the rotation of the wheel.

7. Adjusting the saddle seat height

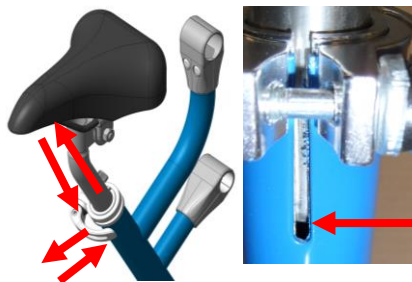

If the saddle seat unit is mounted to the walker, the saddle seat height can be adjusted continuously. To adjust the saddle seat height, loosen the quick release on the saddle pickup tube. Adjust the seat to the needed height (by pulling the seat out). Align the saddle seat parallel to the frame and clamp the seat tube with the quick release firmly.

Attention! Maximum setting height when the end of the pipe is visible in the slot.

Warranty

The products listed in this manual are provided with a warranty of **24 months**. Wear parts and damages of the products due to improper use are excluded.

Advisory!

Always keep the User Instructions in case of future use. Always bring a copy of the User Instructions with you whenever you leave the house so that in the case of an emergency another person will be able to operate the Reverse walker. The identical serial number in the User Instructions is also printed on the nameplate of the product.

The user instructions and the maintenance manual are downloadable on our homepage.

Safety Instructions and Inspection

After the first time set-up and before each use, always conduct a visual inspection of the Reverse Walker for deficiencies. If you have any doubt, then do not use the Reverse Walker. Contact a specialised dealer.

- The directional lock and the permanent brake, as well as the reverse motion brake for proper function (if necessary adjust the brakes or replace parts).
- The seat, handle bow and grip handles for firm arresting.
- Always look out for jamming when folding up or unfolding the Reverse Walk.
- Be sure the patient never exceeds the allowable weight when using the Reverse Walk.
- Never use the Reverse Walker on wet or slippery surfaces.
- For safe use, the surface must be solid and even.
- The Reverse Walker is not designed to overcome obstacles such as stairs, steps, and escalators.
- Do not leave children unsupervised when they are using the Reverse Walker.
- Do not grasp the handles with wet hands, you could slip and fall.
- When sitting on the saddle seat always take the whole seat (risk to fall).
- Always walk inside (central) the walker, limitations in stability (danger of tilting).
- Do not carry or hang any objects on the walker (danger of tilting).
- The walkers are intended only for interior use.
- **The Pluto Reverse Walker is designed only for indoor use!**

Figures

