



Expansion Unit RX1217/RX1217RP

Hardware Installation Guide

Table of Contents

Chapter 1: Before You Start

Package Contents.....	3
Expansion Unit at a Glance.....	4
Safety Instructions.....	6

Chapter 2: Hardware Setup

Tools and Parts for Drive Installation.....	7
Install Drives.....	7
Connect with Synology RackStation.....	9
Learn More.....	10

Chapter 3: Maintenance

Replace Malfunctioning Fan.....	11
Replace Malfunctioning PSU for RX1217RP.....	13

Appendix A: Specifications





Appendix B: LED Indicator Table

Before You Start

Thank you for purchasing Synology RX1217/RX1217RP expansion unit! Before setting up your new expansion unit, please check the package contents to verify that you have received the items below. Also, make sure to read the safety instructions carefully to avoid harming yourself or damaging your Synology product.

Note: All images below are for illustrative purposes only, and may differ from the actual product.

Package Contents

Expansion unit x 1		AC power cord (RX1217: x 1; RX1217RP: x 2)
		
Screws for 3.5" drives x 52	Screws for 2.5" drives x 52	Expansion cable (InfiniBand) x 1
		

Expansion Unit at a Glance

Front

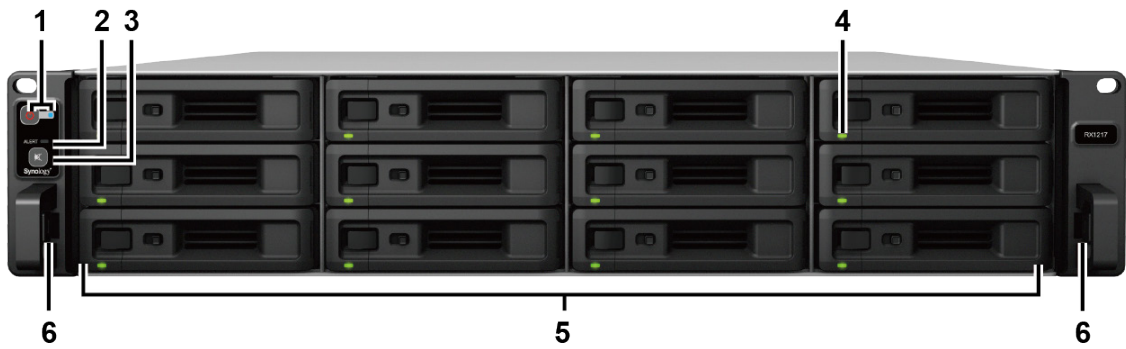

Back

RX1217

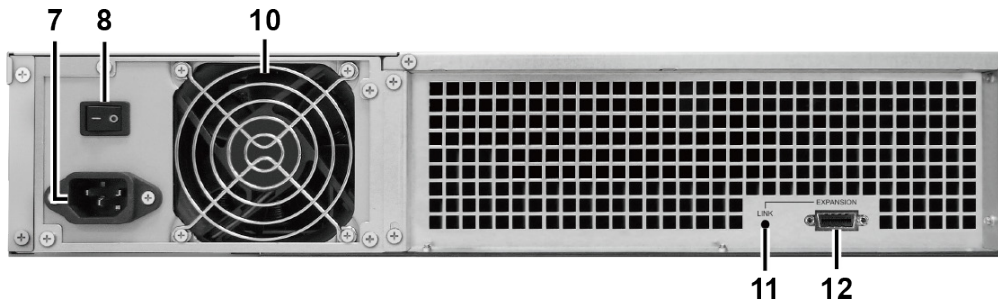

RX1217RP

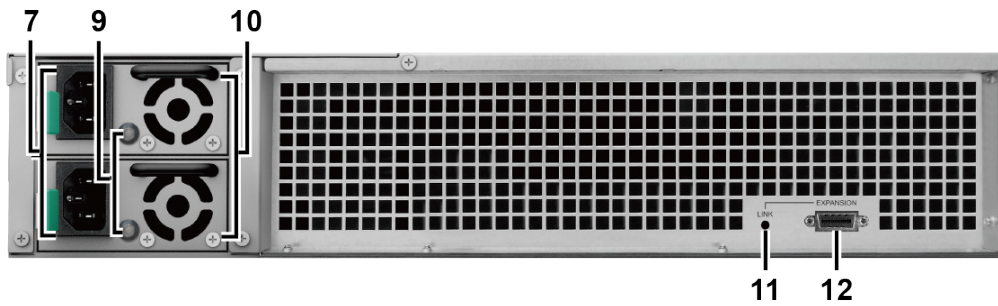







No.	Article Name	Location	Description
1	Power Button and Indicator	Front	Press to manually power on the expansion unit. For more information, please see "Appendix B: LED Indicator Table".
2	ALERT Indicator		Displays warnings regarding fan or temperature status. For more information, please see "Appendix B: LED Indicator Table".
3	Beep Off Button		Press to deactivate the beeping sound that is emitted when a malfunction occurs.
4	Drive Status Indicator		Displays the status of drives. For more information, please see "Appendix B: LED Indicator Table".
5	Drive Tray		Install drives here.
6	Rail Kit Release Tab		Push in and hold to release the RackStation from the rail kit lock. ¹
7	Power Port	Back	Connect power cords here.
8	PSU On/Off Switch		Press to switch the power supply unit (PSU) on or off.
9	PSU Indicator and Beep Off Button		Displays the status of the PSU. Press to deactivate the beeping sound that is emitted when a malfunction occurs. For more information, please see "Appendix B: LED Indicator Table". ²
10	PSU Fan		Disposes of excess heat and cools the PSU.
11	LINK Indicator		Displays the status of the link between the expansion unit and the main RackStation unit. For more information, please see "Appendix B: LED Indicator Table".
12	EXPANSION Port		Connect the expansion unit to a Synology RackStation here. For compatible models, please visit www.synology.com .

¹ For more information about the rail kit installation, please refer to the Quick Installation Guide that comes with the rail kit.

² When RX1217RP wakes up from the deep sleep mode, two beeping sounds will be emitted (one sound per PSU indicator).

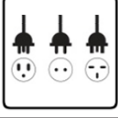
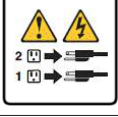
Safety Instructions

	<p>Keep away from direct sunlight and away from chemicals. Make sure the environment does not experience abrupt changes in temperature or humidity.</p>
	<p>Place the product right side up at all times.</p>
	<p>Do not place near any liquids.</p>
	<p>Before cleaning, unplug the power cord. Wipe with damp paper towels. Do not use chemical or aerosol cleaners.</p>
	<p>To prevent the unit from falling over, do not place on carts or any unstable surfaces.</p>
	<p>The power cord must plug in to the correct supply voltage. Make sure that the supplied AC voltage is correct and stable.</p>
	<p>To remove all electrical current from the device, ensure that all power cords are disconnected from the power source.</p>
	<p>Risk of explosion if battery is replaced with an incorrect type. Dispose of used batteries appropriately.</p>

Hardware Setup

Tools and Parts for Drive Installation

- A screwdriver
- At least one 3.5" or 2.5" SATA drive (please visit www.synology.com for compatible drive models)

Warning: If you install a drive that contains data, the system will format the drive and erase all existing data. Please back up any important data before installation.

Install Drives

- 1 Open the drive tray.

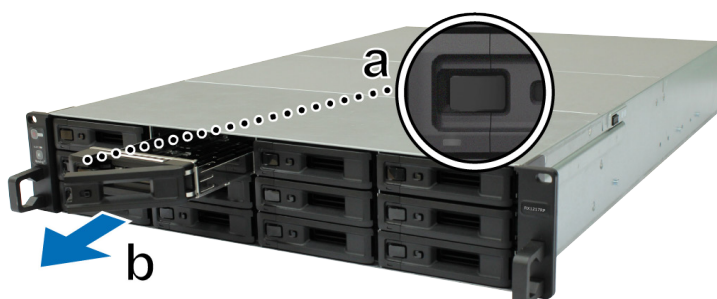

- a Find the small button located on the left side of the drive tray handle. Press the button down, and the drive tray handle will pop out.
- b Pull the drive tray handle out as illustrated above.

- 2 Load drives in the drive trays.

- **For 3.5" drives:** Place the drive in the drive tray. Turn the tray upside down and tighten screws into the four spots indicated below to secure the drive.

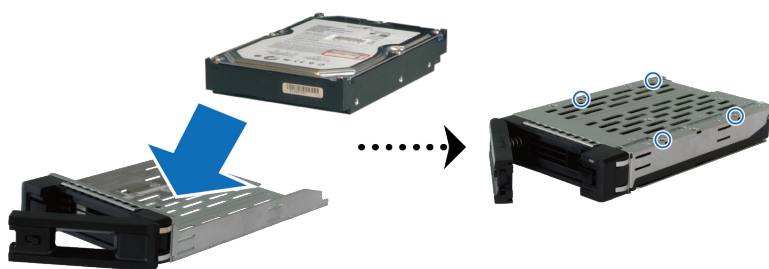

- **For 2.5" drives:** Place the drive in the drive tray. Turn the tray upside down and tighten screws into the four spots indicated below to secure the drive.

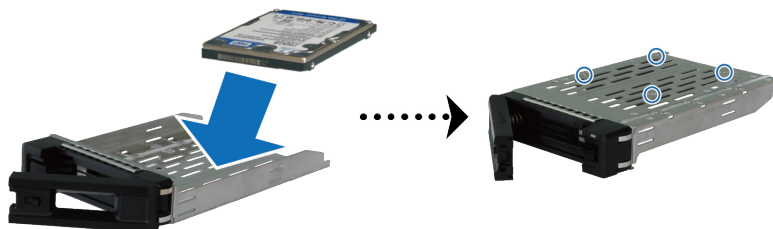

- 3 Insert the loaded drive tray into the empty drive bay.



Note: Make sure the tray is pushed in all the way. Otherwise, the drive might not be able to function properly.

- 4 Push the handle inward to secure the drive tray.
- 5 Push the switch on the drive tray handle to the left to lock the drive tray.



- 6 Repeat the steps above to assemble the other drives you have prepared.
- 7 Drives are numbered as shown below.



Note: If you want to create a RAID volume, we recommend that all installed drives are of the same size to make the best use of drive capacity.

Connect with Synology RackStation

- 1 Connect one end of the power cord to the power port of RX1217/RX1217RP, and the other to the power outlet.

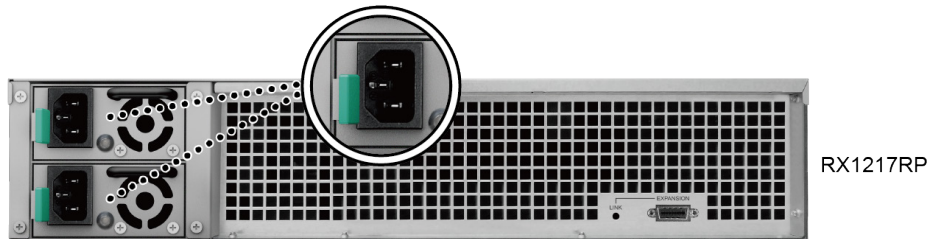
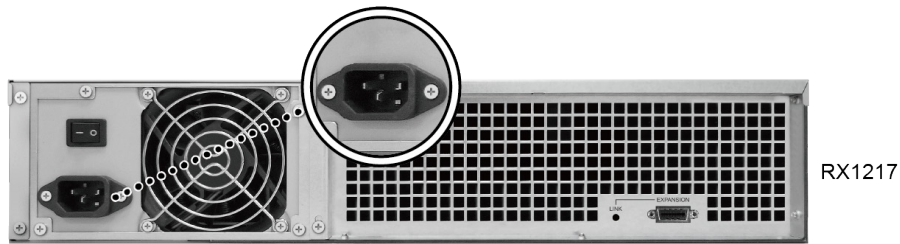

Note: RX1217RP comes equipped with a redundant power supply system, allowing two power cords to be connected. The system may be powered on with only one power cord, but we recommend using two power cords to avoid unexpected power failures.

- 2 Connect one end of the expansion cable to the expansion port of RX1217/RX1217RP and the other to the expansion port of the RackStation.

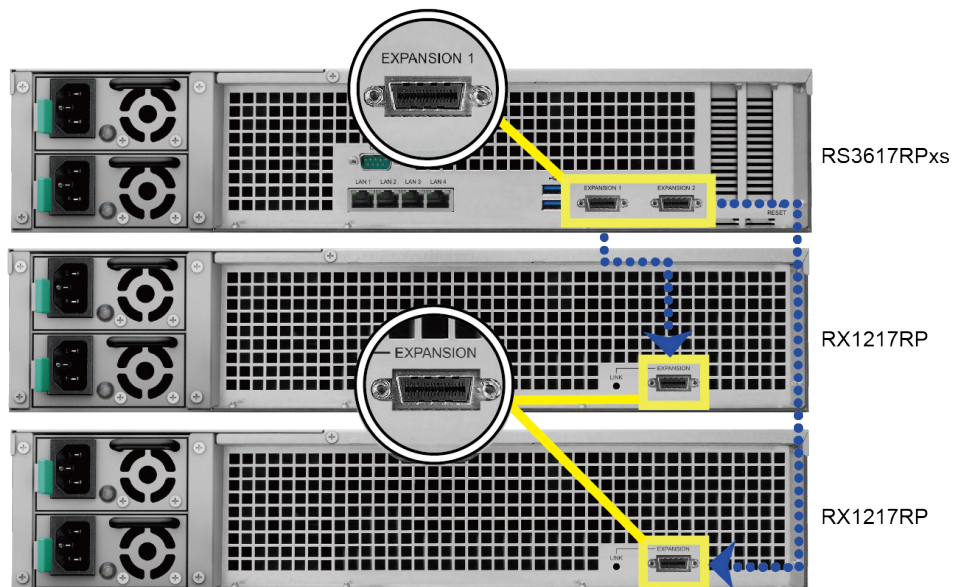

- 3 For RX1217, press the PSU on/off switch located on the back panel to switch the PSU on. Press the power buttons on the front panel to power on the RackStation and RX1217/RX1217RP.

Note:

1. Once you power on/off the RackStation unit, your expansion unit(s) will automatically power on/off one by one if they are correctly connected.
2. Even with the RackStation and expansion unit powered on, you can connect the RackStation to another RX1217/RX1217RP if needed. To do so, repeat step 1 and 2 above to connect the expansion cable and power cords of the other expansion unit. Your expansion unit will automatically power on if it is correctly connected.

Important: Do not remove the expansion cable while the host device is still powered on. Doing so may result in data loss.

Learn More

Congratulations! Your expansion unit is set up now. For more information or online resources, please visit www.synology.com.

Maintenance

Replace Malfunctioning Fan

If a system cooling fan malfunctions, please see the instructions below to open the expansion unit and replace the malfunctioning fan.

- 1 Press the small buttons located on the sides of the expansion unit.



- 2 Lift to remove the fan cover.



3 Cooling fans are numbered as below:



4 Remove the malfunctioning fan.

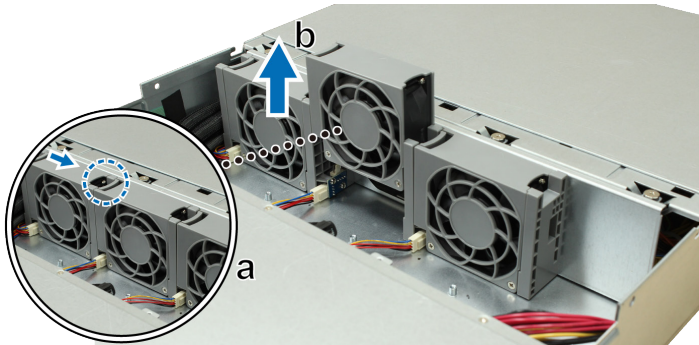

a Find the malfunctioning fan. Press and hold the tab located on the left of the fan.

b Lift the fan upward to remove it.

5 Slide the new cooling fan into the expansion unit. Make sure the fan is aligned properly as illustrated below.

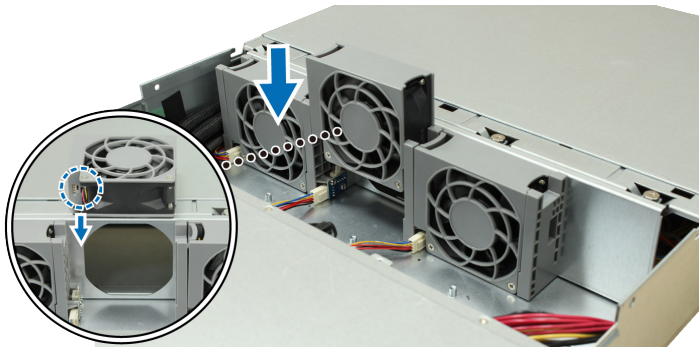

Replace Malfunctioning PSU for RX1217RP

If a PSU or its fan malfunctions, please see the instructions below to replace the malfunctioning PSU.

- 1 Unplug the power cord from the PSU to be replaced.

Note: By pressing the **Beep Off** button, you can silence the long beeping sound when you hear it.

- 2 Push the lever of the PSU at the back panel in the indicated direction.
- 3 Pull out the PSU from the expansion unit.

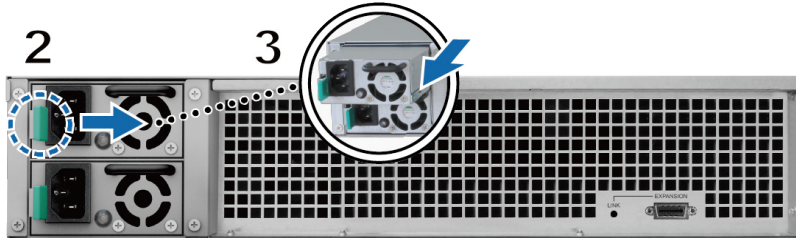

- 4 Prepare a new PSU, and push it back to the slot until you hear a click.

Specifications

Item	RX1217/RX1217RP
Compatible Drive Type	3.5" / 2.5" SATA III / SATA II x 12
Maximum Internal Raw Capacity	96TB (12 x 8TB HDD)
Expansion Port	1 x InfiniBand
Hot Swappable Drive	Yes
Size (H x W x D) (mm)	RX1217: 88 x 430.5 x 664; RX1217RP: 88 x 430.5 x 692
Weight (kg)	RX1217: 12.7; RX1217RP: 13.4
System Fan	3 x (80 x 80 x 32mm)
Power Fan	RX1217: 1 x (80 x 80mm); RX1217RP: 2 x (38 x 38mm)
Power Recovery	Synchronized with RackStation
Agency Certification	<ul style="list-style-type: none"> • FCC Class A • CE Class A • BSMI Class A
Environment Requirements	<ul style="list-style-type: none"> • Line voltage: 100V to 240V AC • Frequency: 50/60Hz • Operating Temperature: 40 to 95°F (5 to 35°C) • Storage Temperature: -5 to 140°F (-20 to 60°C) • Relative Humidity: 5% to 95% RH

Note: Model specifications are subject to change without notice. Please refer to www.synology.com for the latest information.

LED Indicator Table

LED Indicator	Color	Status	Description
Power	Blue	Static	Powered on
		Off	Powered off
ALERT	Orange	Blinking	Fan failure / Over temperature
		Off	System normal
Drive Status Indicator (on tray)	Green	Static	Drive ready and idle
		Blinking	Accessing drive
	Red	Static	Drive error
		Off	No internal drive
PSU Indicator*	Green	Static	Power supply unit normal
		Off	Power supply unit off
LINK	Green	Static	Connected to Synology RackStation
		Off	Not connected to Synology RackStation

* RX1217RP only.

Note: Model specifications are subject to change without notice. Please refer to www.synology.com for the latest information.