



## Diffuse Wall

### Acoustic wall panel

---

Diffuse screens are not limited to being used as freestanding screens, they can also be easily fixed to the wall to create texture and interest to otherwise smooth walls. The panels can be easily mounted to walls in a vertical position allowing creative control over the look and feel you want to create.

## FEATURES

- ◆ Designed and manufactured in the UK
- ◆ All screens are 8mm thick
- ◆ Made from 50% recycled PET
- ◆ Manufacturer's 5 year guarantee
- ◆ All screens pass BS 5852: 2006 Clause 12, Ignition Source 5 (Crib 5)
- ◆ No formaldehyde binders
- ◆ Low VOCs
- ◆ Unique curved ridged design enhances acoustic properties
- ◆ Choice of different sizes
- ◆ Unique hook allowing easy installation to walls
- ◆ Comes complete with steel rail and unique hook allowing easy installation



## Wall panel

CODE	DESCRIPTION	DIMENSIONS (mm)
DWP612	Wall panel with hooks	638 x 1250
DWP616	Wall panel with hooks	638 x 1650
DWP1012	Wall panel with hooks	1088 x 1250
DWP1016	Wall panel with hooks	1088 x 1650

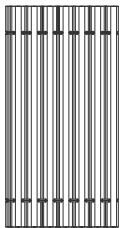

DWP612, short narrow

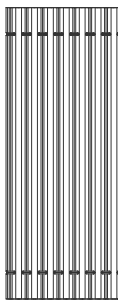

DWP616, long narrow

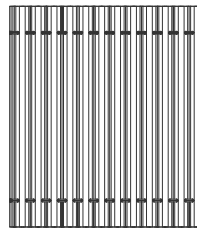

DWP1012, short wide

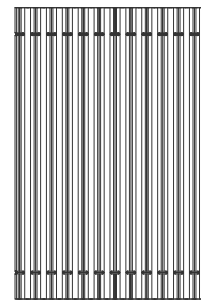

DWP1016, long wide

### SCREEN COLOURS

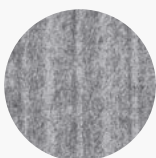

LIGHT GREY



DARK GREY

### STEEL FRAME COLOUR

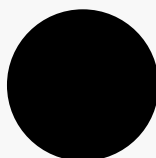

Other frame colours available for large quantities, please contact us for more information.

### WALL BRACKET AND HOOK

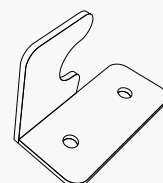

Four times wall bracket supplied with each panel





## GUARANTEES

AllSfär guarantee its products against material or manufacturing faults. At AllSfär's sole discretion, AllSfär will repair or replace with comparable materials any product or component which fails under normal use in a single shift environment as a result of a defect in the materials or workmanship. A five-year manufacturer's guarantee applies to ÖRA wall coverings and DIFFUSE acoustic furniture. AllSfär also offer a two-year guarantee on all moving parts. The full Warranty Policy is available on request from AllSfär Customer Services.

## SPECIFICATIONS

Whilst every care is taken to ensure accuracy, all dimensions are approximate and, as a consequence, AllSfär cannot be held responsible for errors. As part of our policy for continued improvement AllSfär reserve the right to make any changes, without notice, to specifications or designs that it considers reasonable. Any such changes will not affect the validity of the contract.

# Cleaning guide for felt only

Our products are extremely durable and require little attention to maintain their good looks. Light dusting on a regular basis will prevent dust build up and most marks can be cleaned with a mild detergent solution followed by rinsing and blotting. Stains should be dealt with according to the chart below.

Before carrying out a proposed cleaning method, apply to a concealed section to ensure it will not affect the product or adhesive. Avoid cleaning methods that create severe abrasion. NB: Solvent and mineral based cleaners should be used sparingly to avoid possible degradation of the adhesive adhering the product to the substrate.

## Professional Cleaning Methods

Stain	Treatment Guide
Blood	A, C
Burn/Scorch Mark	K
Chewing Gum	I, B, D, C
Chocolate	B, D, C
Cooking Oils	B, D, C
Crayon/Colour Markers	B, D, C
Drinks	A, C
Dust/Dirt	Vacuum, then J or C
Excrement	B, C
Grass	C
Grease	B, D, C
Ink (ballpoint)	D, E
Ink (fountain)	A, C
Lipstick	B, E, C, D
Mildew	C
Milk	A, E
Mud	B, C
Nail Polish	A, G
Oil	B, D, C
Paint (water based)	A, F, C
Paint (oil based)	A, H, D, C
Sauces	B, C, D
Shoe Polish	B, C, D
Urine	A, C
Vomit	A, C, D
Wine	A, Add Salt, C

## Key

- A** Mop up excess as soon as possible with a sponge or cloth.
- B** Remove surplus with a knife edge or appropriate instrument.
- C** Sponge with a solution of carpet shampoo working from well outside the stain in a circular motion towards the centre (this avoids spreading the stain). Sponge afterwards with clean warm water and mop excess moisture with a clean dry cloth or sponge. Allow to dry then brush gently with a soft brush. If any stain remains, sponge with a solution of one part household bleach to six parts clear water. Thoroughly rinse after treatment.
- D** Lightly sponge with household dry cleaning fluid and blot. Apply sparingly, as the substance may have an adverse effect on the adhesive.
- E** Sponge with methylated spirits and blot dry.
- F** Lubricate the stain with glycerine or petroleum jelly.
- G** Apply nail polish remover. The nail polish remover should not include lanolin or be of a greasy nature.
- H** Sponge with turpentine (or substitute).
- I** Freeze with ice cubes and scrape away while cold.
- J** Clean with regular extractive carpet cleaner (if possible).
- K** Use circular cutter and remove damaged portion. Re-glue new piece into place.

