

ACASIS

# NVME M.2 SSD DOCKING STATION



**M04**

**User Manual**

Thank you for choosing Acasis.

Please read the manual before you use this product.

## Product features

- Compatible with Windows XP/2000/7/8/10/Vista/  
Linux/Mac OS 10.3 or higher
- Support NVME M.2 PCIe M Key SSD
- Supports SSD dimensions: 2230, 2242, 2260, 2280
- High-speed transmission

- ① NVME M.2 SSD Slot
- ② Work Indicator Led
- ③ Type-c Interface
- ④ Power Switch

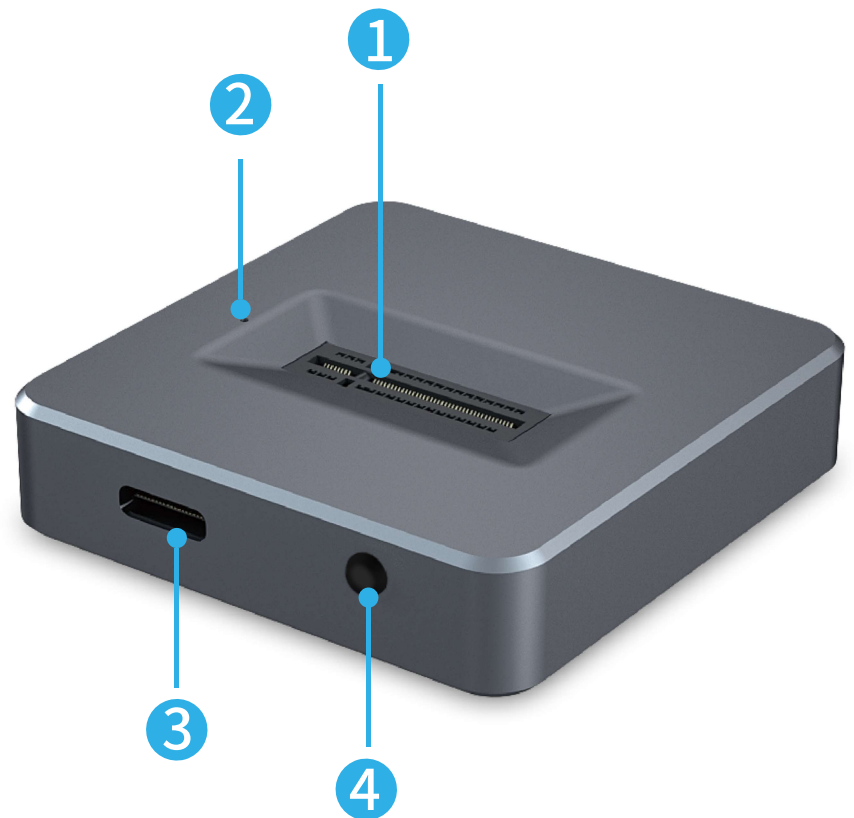

## Installation instructions

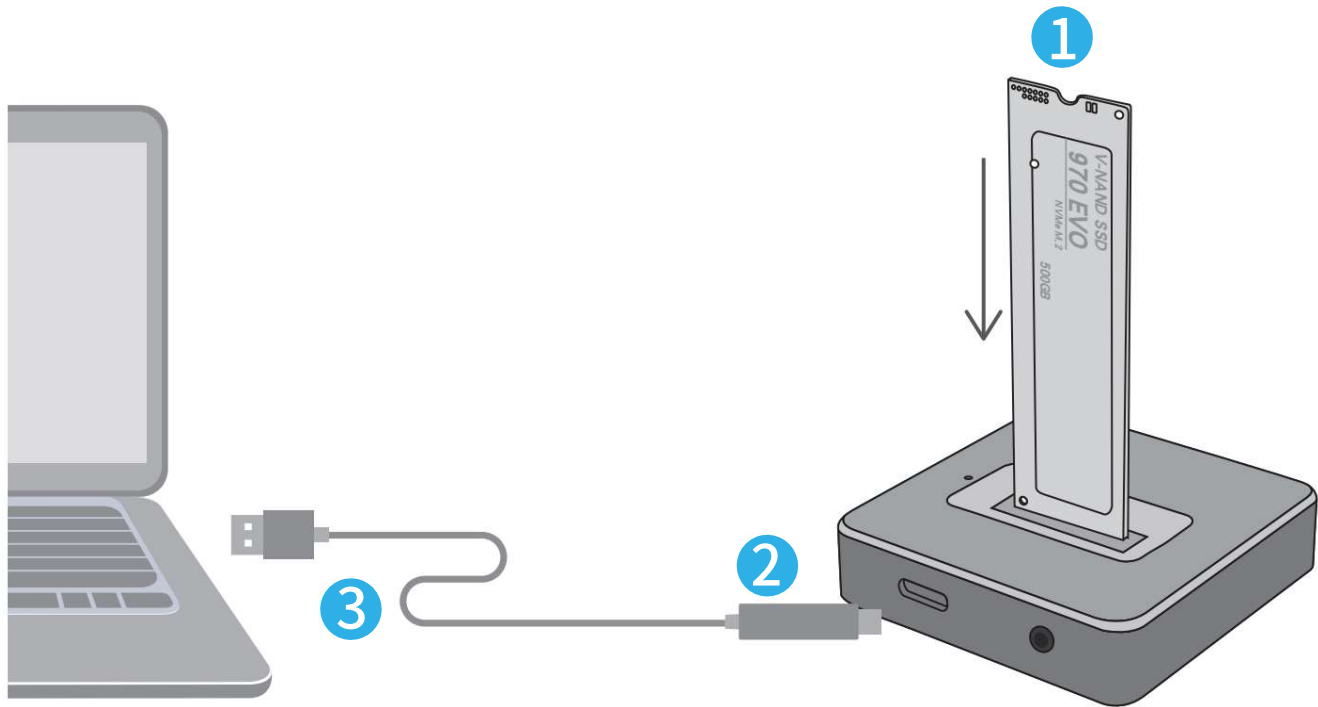

- 1 Insert the NVME SSD into Slot
- 2 Connect USB Cable to Dock
- 3 Connect USB Cable to Computer

## Package Contents

- NVME M.2 SSD Docking Station
- Type-C to Type-C cable
- Type-C to USB3.0 cable
- User Manual

NVME M.2 SSD Docking Station allows users to insert NVME M.2 devices vertically. No screws or accessories are required, just plug in your SSD and connect the USB cable, then you can start using it. If you have multiple NVME M.2 SSDs that need frequent reconnection or short-term use, this product is the ideal choice.

## Note

1. The Temperature of the entire operating SSD may exceed 60 °C. Please do not touch the SSD.
2. Do NOT support "Hot-Plugging". Please don't exchange the SSDs when docking station is powered or connected.
3. DO NOT support PCI-e M Key AHCI SSD, SATA based B+M key or B Key SSD.

Technical Support Email: [support@acasis.com](mailto:support@acasis.com)

[www.acasis.com](http://www.acasis.com)

