

'65 C & '67-69 A-Body B/RB Engine Left Side Mount Kit

Thank you for your purchase! We strongly recommend purchasing a Factory Service Manual for your vehicle. This will be an invaluable tool toward the success of your project.

Adjustability: All Chrysler motor mount bosses have 1/2" holes and 7/16" fasteners. In addition the K-member holes are oversized to aid in adjustability. By installing the motor mount assembly finger-tight (bracket to engine and rubber isolator to K-member) a hoist can then be used to shift the engine in place for optimal clearance and position. You will notice approximately 1/4" of movement. The transmission mount should also be loose to aid in adjustability. Once desired engine placement is obtained, torque all fasteners to factory specs.

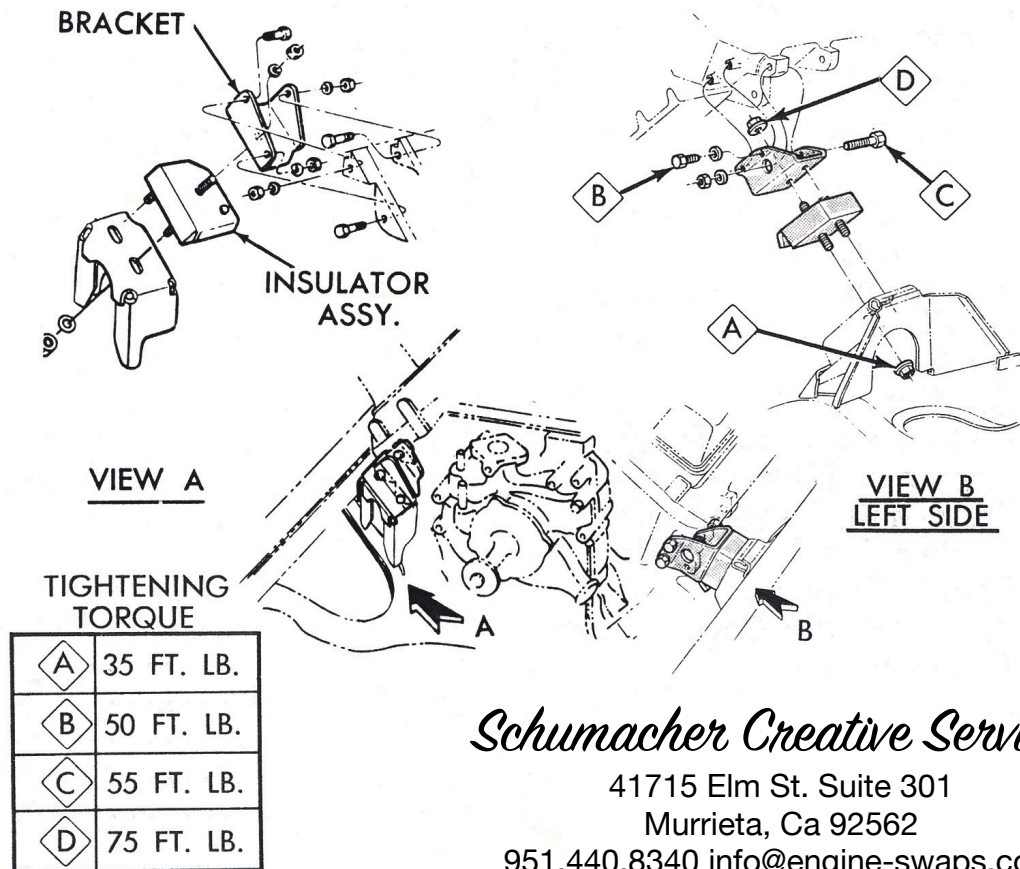

Schumacher Creative Services

41715 Elm St. Suite 301

Murrieta, Ca 92562

951.440.8340 info@engine-swaps.com