

TR MOVE

Assembly Instructions
TRMOVE-TRXP
TRMOVE-3

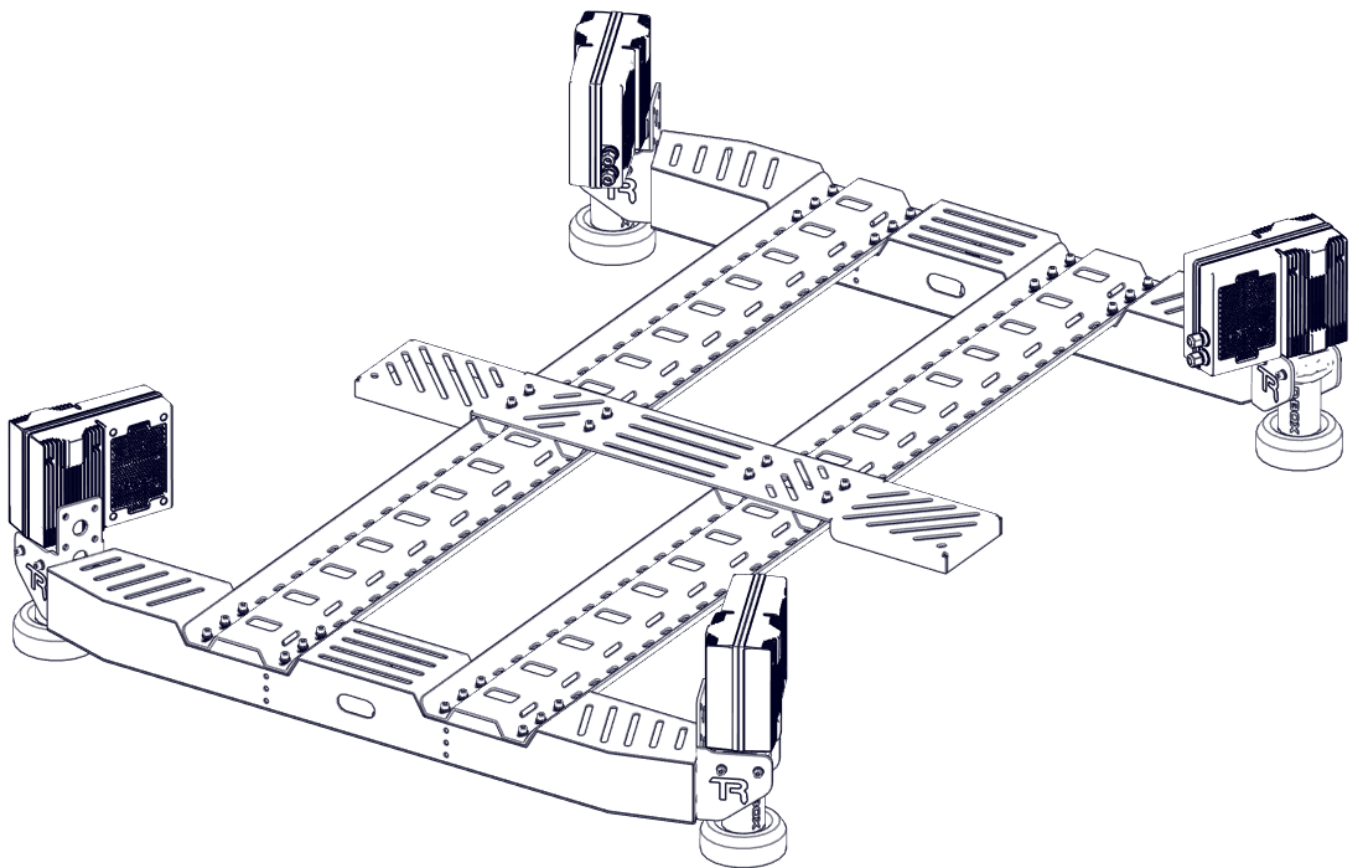

TABLE OF CONTENTS

3 Symbol Legend

4 Part list

7 Compatibility

8 Configurations

9 Assembly Instructions

Assembling the main chassis

4 Motors

3 Motors

2 Motors

18 Trak Racer TRX Mounting



IMPORTANT: As there are different versions of each rig depending on your region, please ensure that you are using the correct instruction set. The part number below should match the part number labeled on your box



IMPORTANT: Due to the nature of cut aluminium profile, some metal shavings may still be present after our extensive QA cleaning process. We recommend that boxes and packaging is opened on a hard floor.



NOTE: Some screws and washers are pre-installed. These will be part of the parts list and will need to be loosened and reattached according to the instructions.



Two people needed



Tighten hardware



Leave hardware loose for adjustment



Make Adjustment



Break tab off Corner bracket CB1



Safety glasses needed



Attention / Priority



Reserve for following step



Mirrored Components (Same on both sides)

Parts List

The main chassis parts

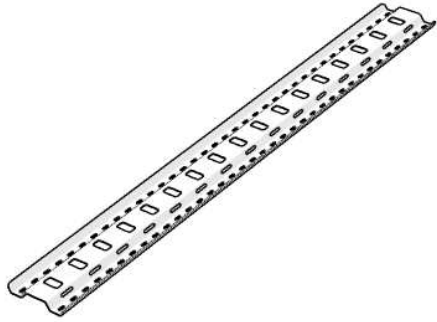

X2 Main A

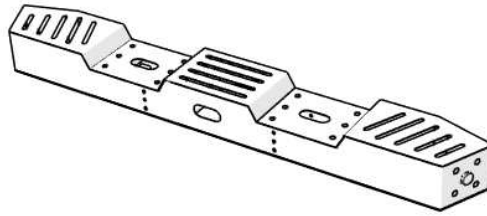

X2 Main B

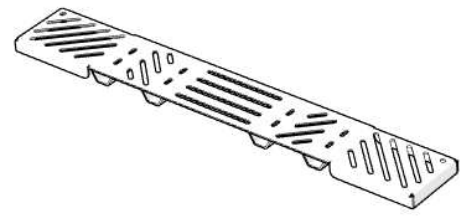

X1 Main C

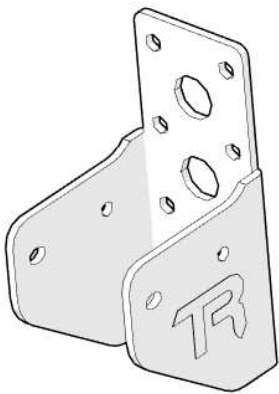

X2 or X3 or X4
Motor bracket

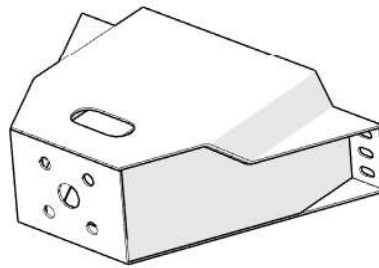

X1 Third Motor frame
(optional)

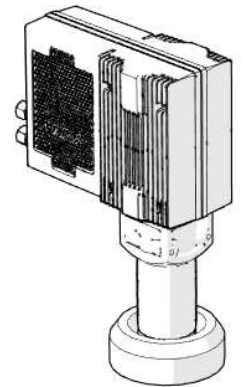

X2 or X3 or X4
Motor

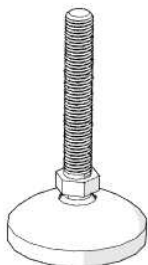

X1 Ball joint

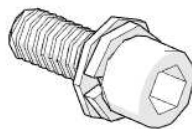

M8x16 + Plain washer
+ lock washer

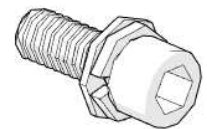

M6x16 + Plain washer
+ lock washer

Parts List

Trak Racer TRX Mounting Bracket

x3 Bracket A

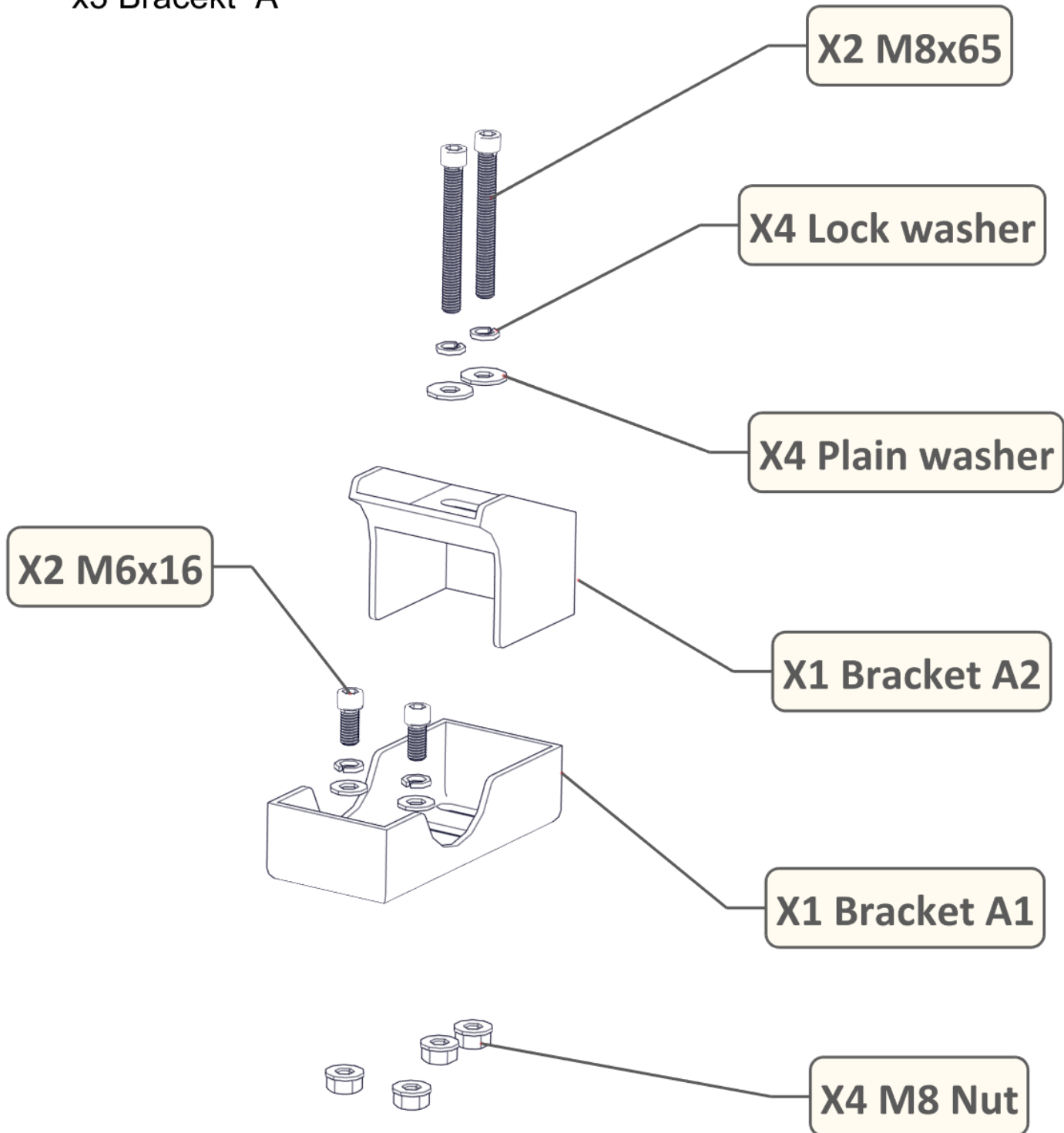

Parts List

TRX Brackets

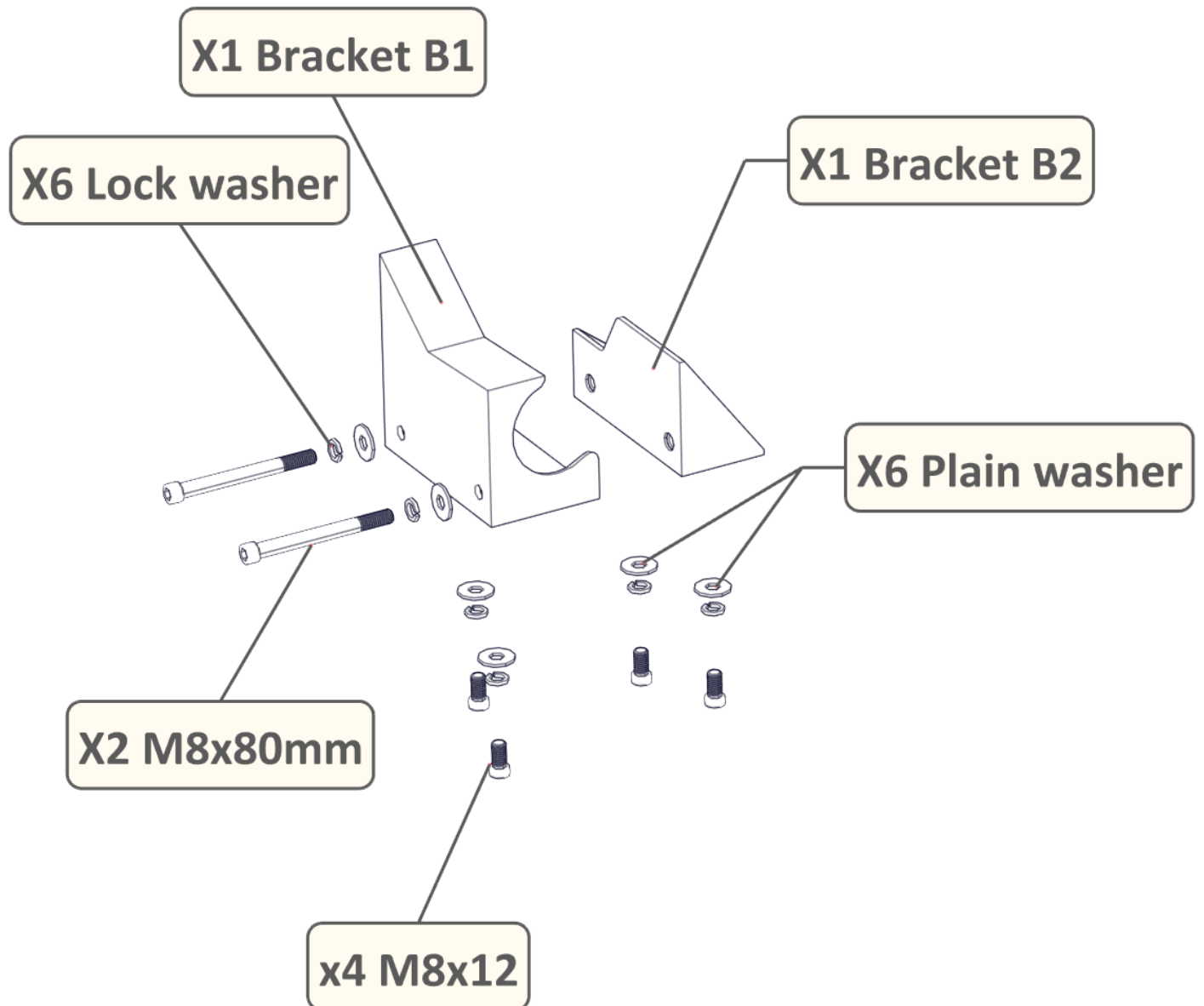

Compatibility & Options

The TR Move motion platform has been designed to fit all of Trak Racers frames including the TRX, TR8, TR8 Pro, RS6 as a large range of other branded rigs. Please contact our support for compatibility questions.

Note. For extruded aluminium frames, it's recommended that the motion motor is attached directly to your frame with the high-quality brackets from Trak Racer or others.

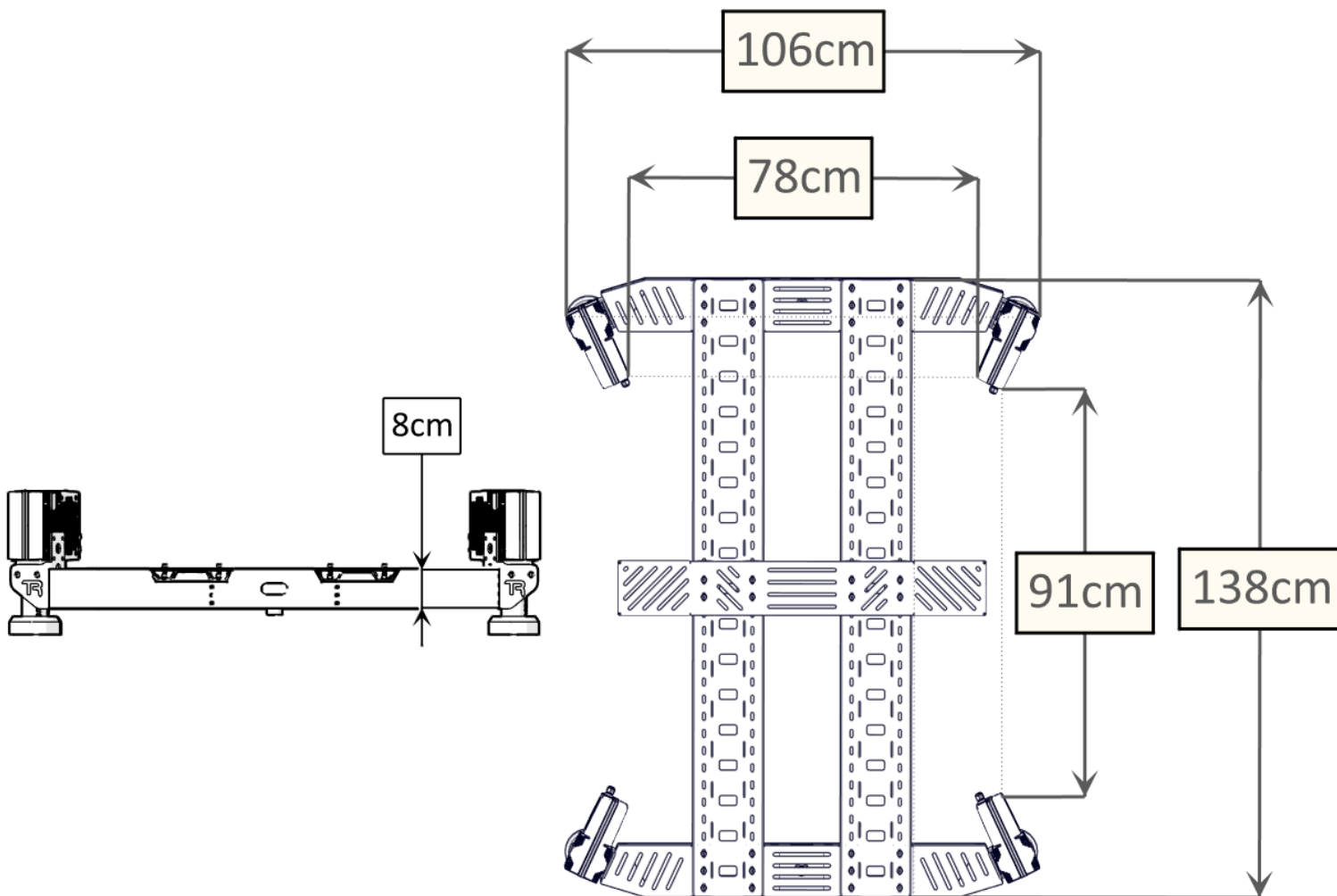

Configurations

The TR Move motion platform is available for 2, 3 and 4 motion motors.

SKU TRMOVE-TRXP is ready for 2 and 4 motors, while 3 motors requires SKU TRMOVE-3.

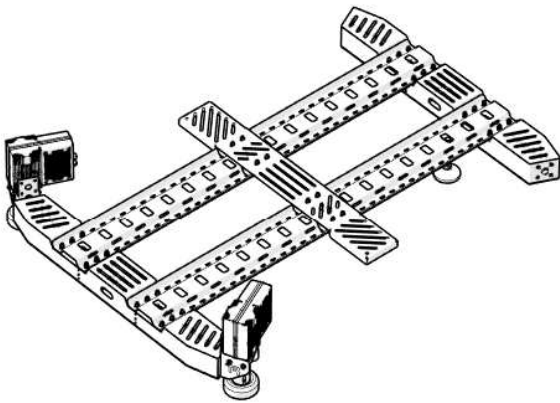

X2 Motors

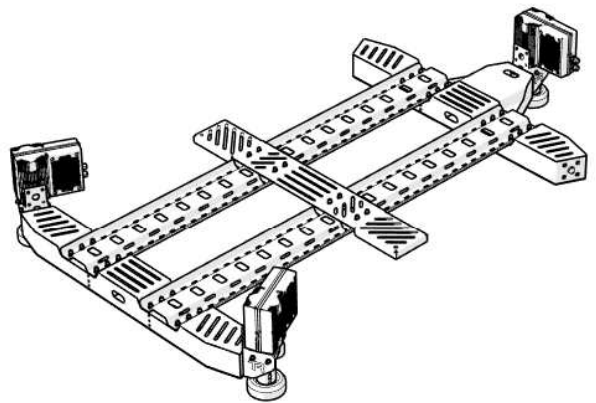

X3 Motors

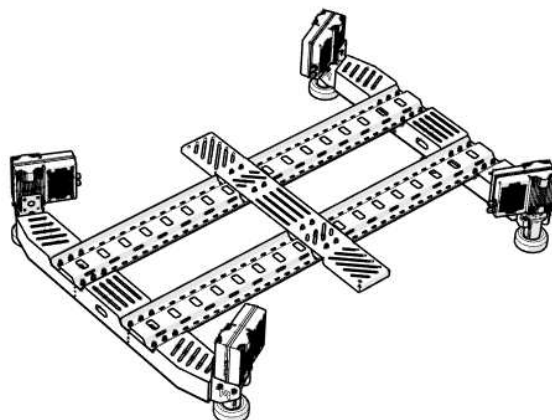

X4 Motors

Assembly Instructions

Assembling the main chassis for 3 motion motors.
SKU TRMOVE-3 required.

X24 M6x16mm+Plain washer + Lock washer

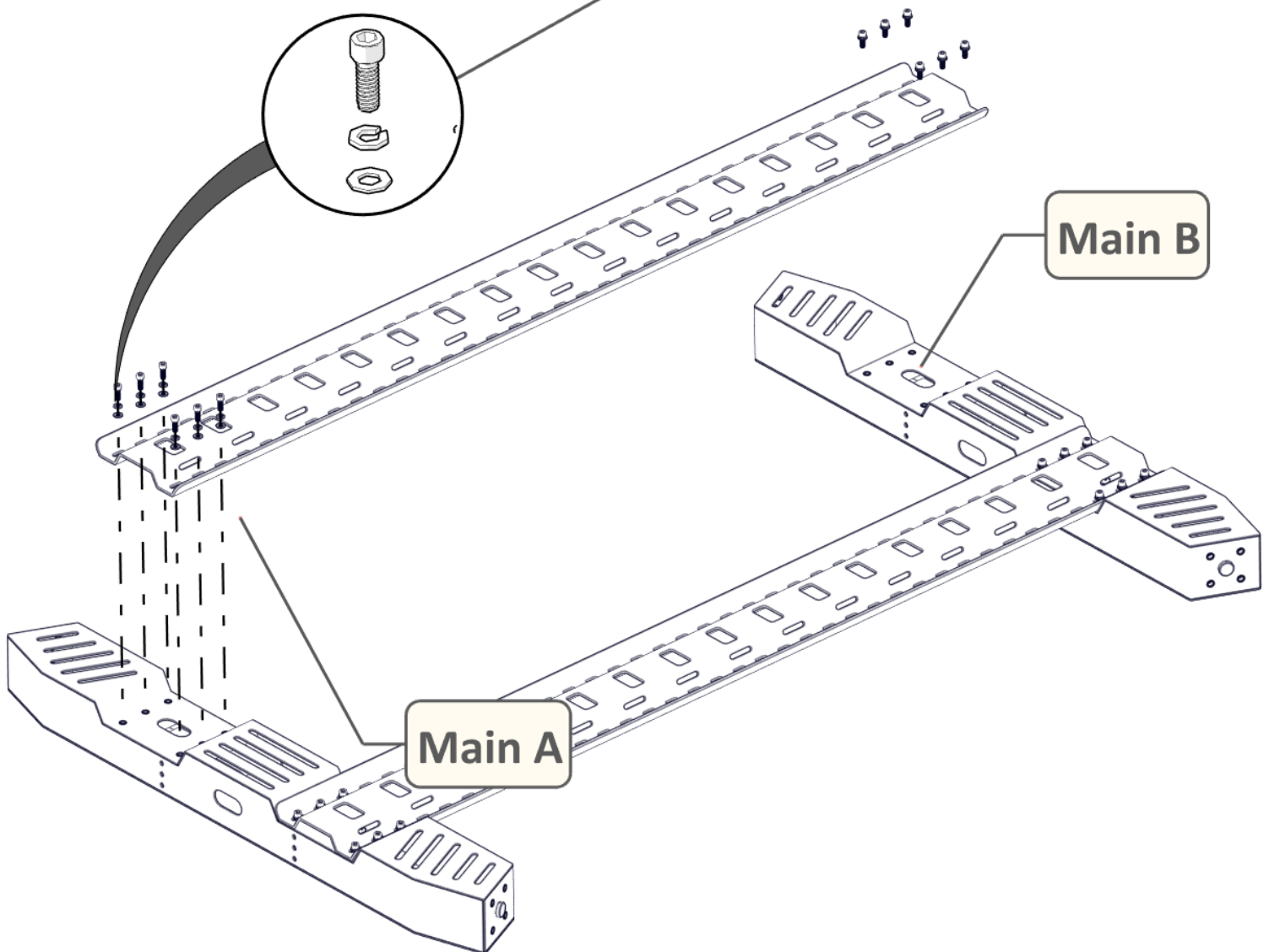

Assembly Instructions

Assembling the main chassis.

X8 M6x35mm+Plain washer + Lock washer

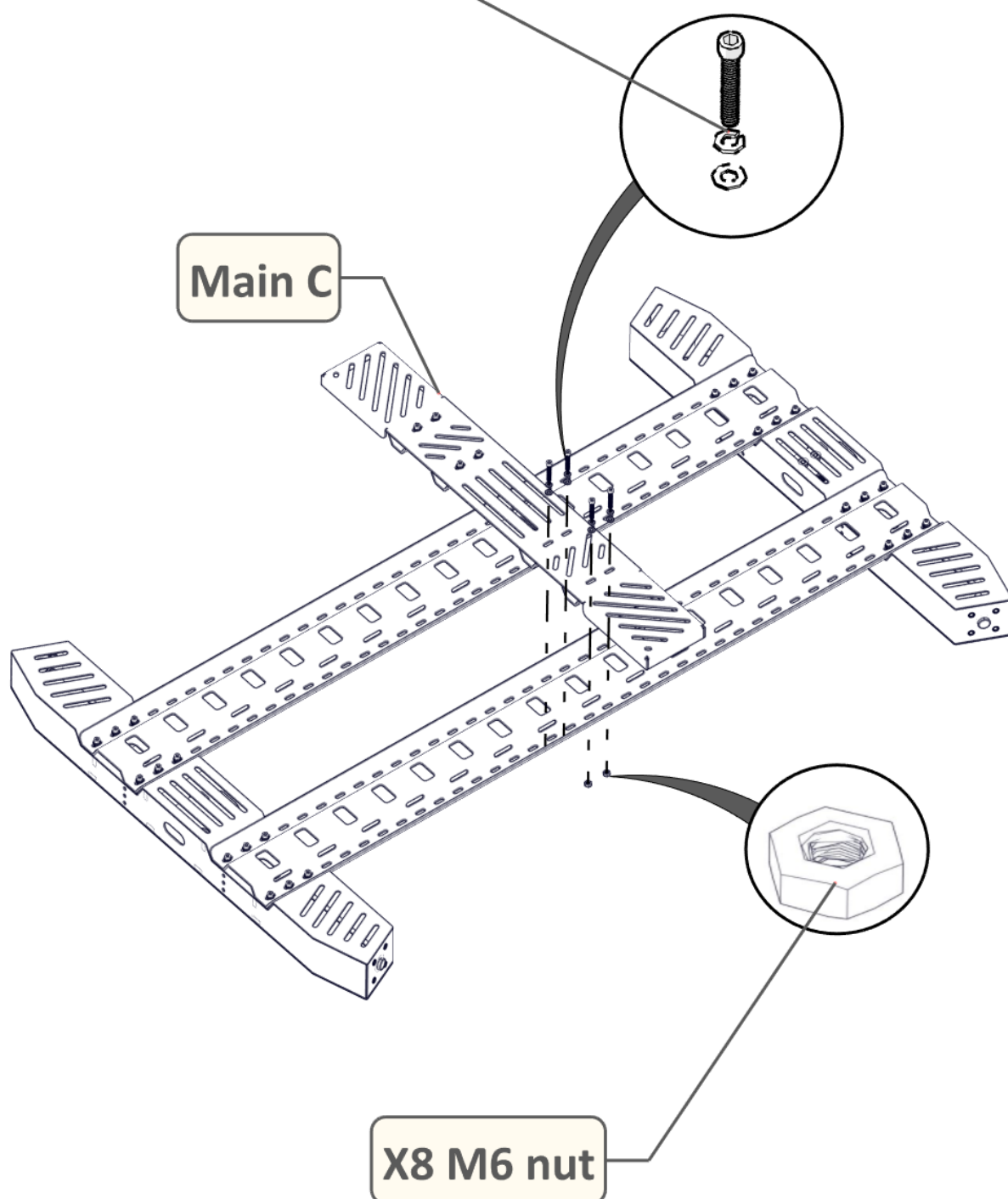

Assembly Instructions

Assembling the main chassis for 4 motion motors.

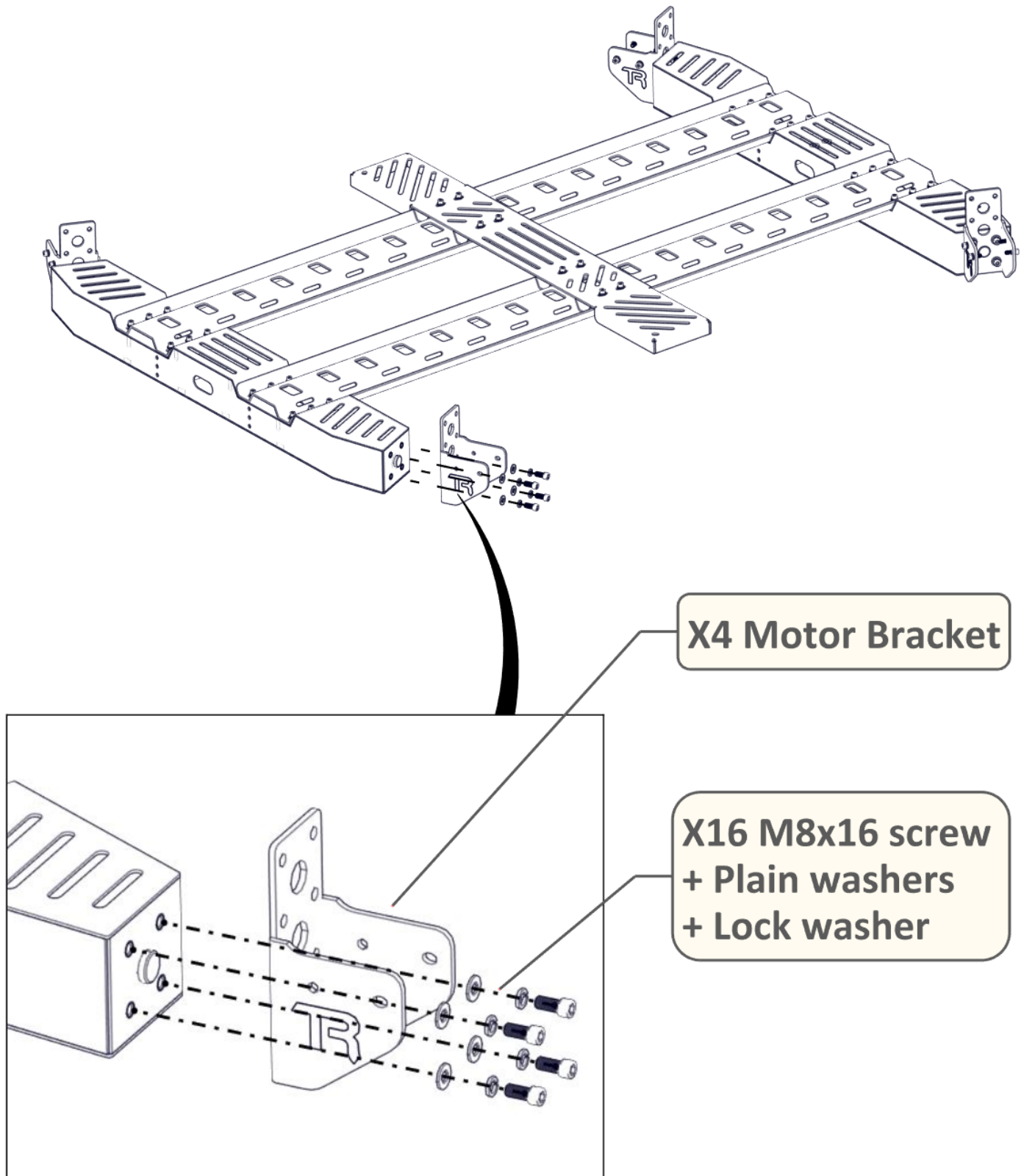

Assembly Instructions

Assembling the main chassis for 4 motion motors.

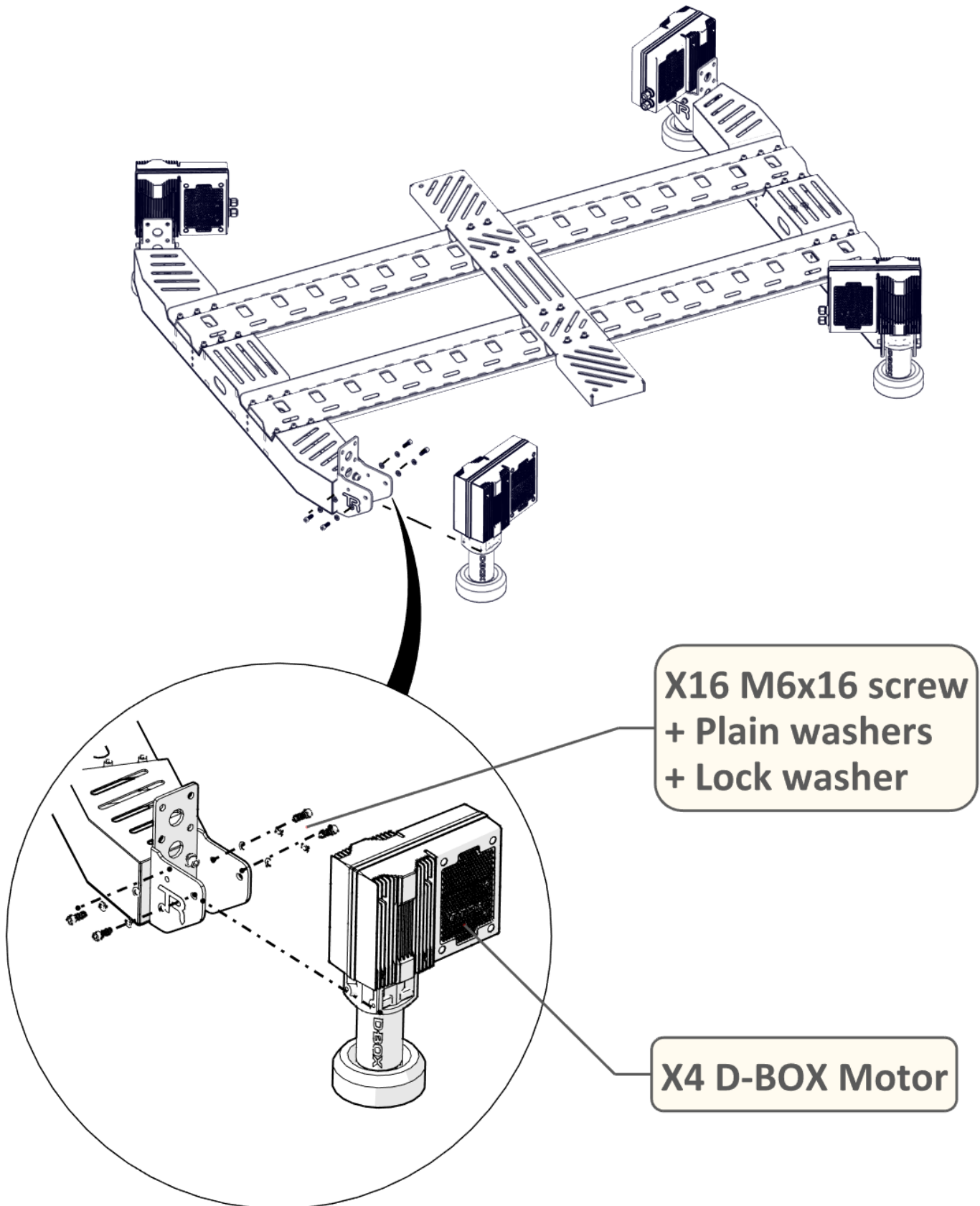

Assembly Instructions

Assembling the main chassis for 3 motion motors.
SKU TRMOVE-3 required.

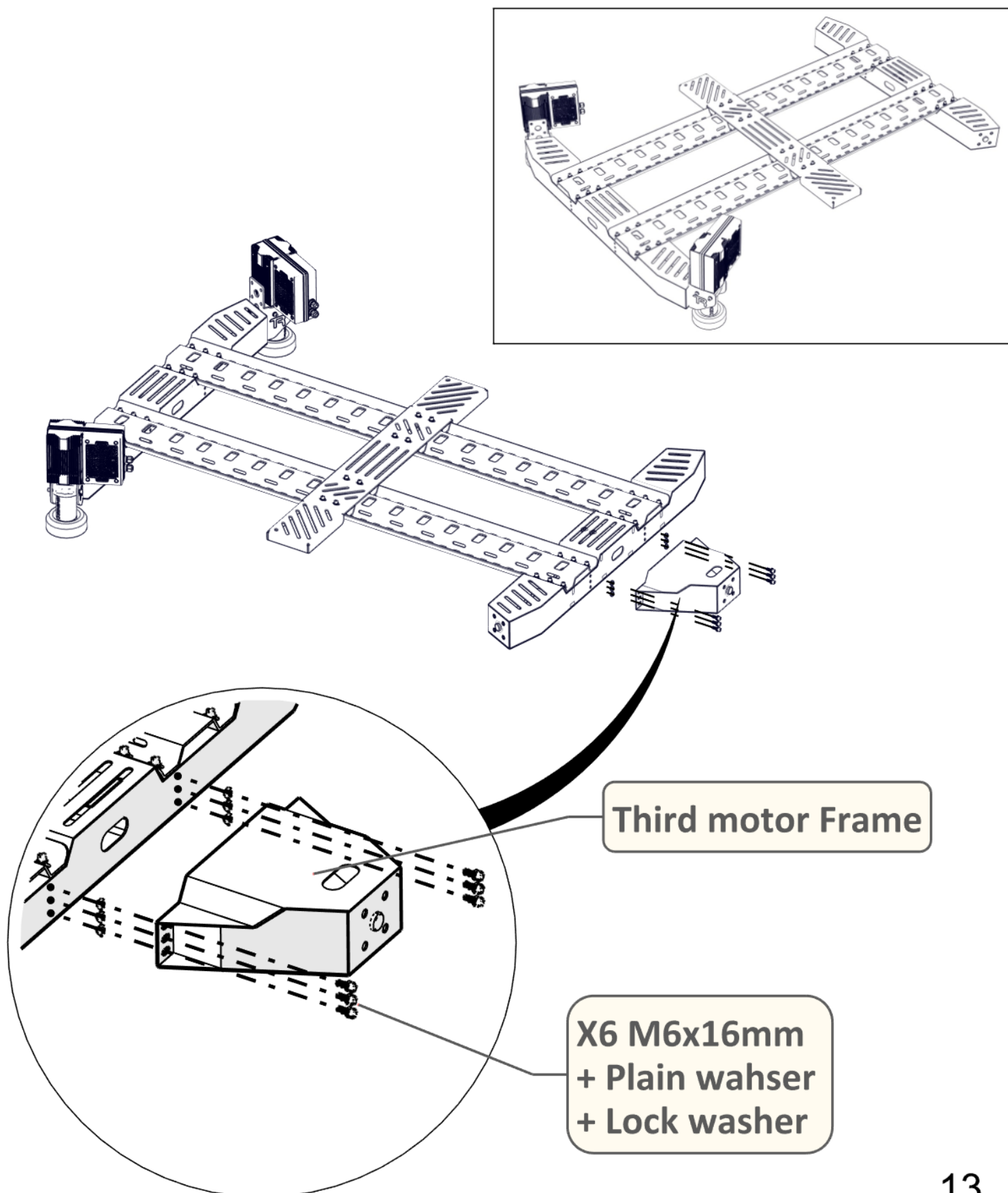

Assembly Instructions

Assembling the main chassis for 3 motion motors.

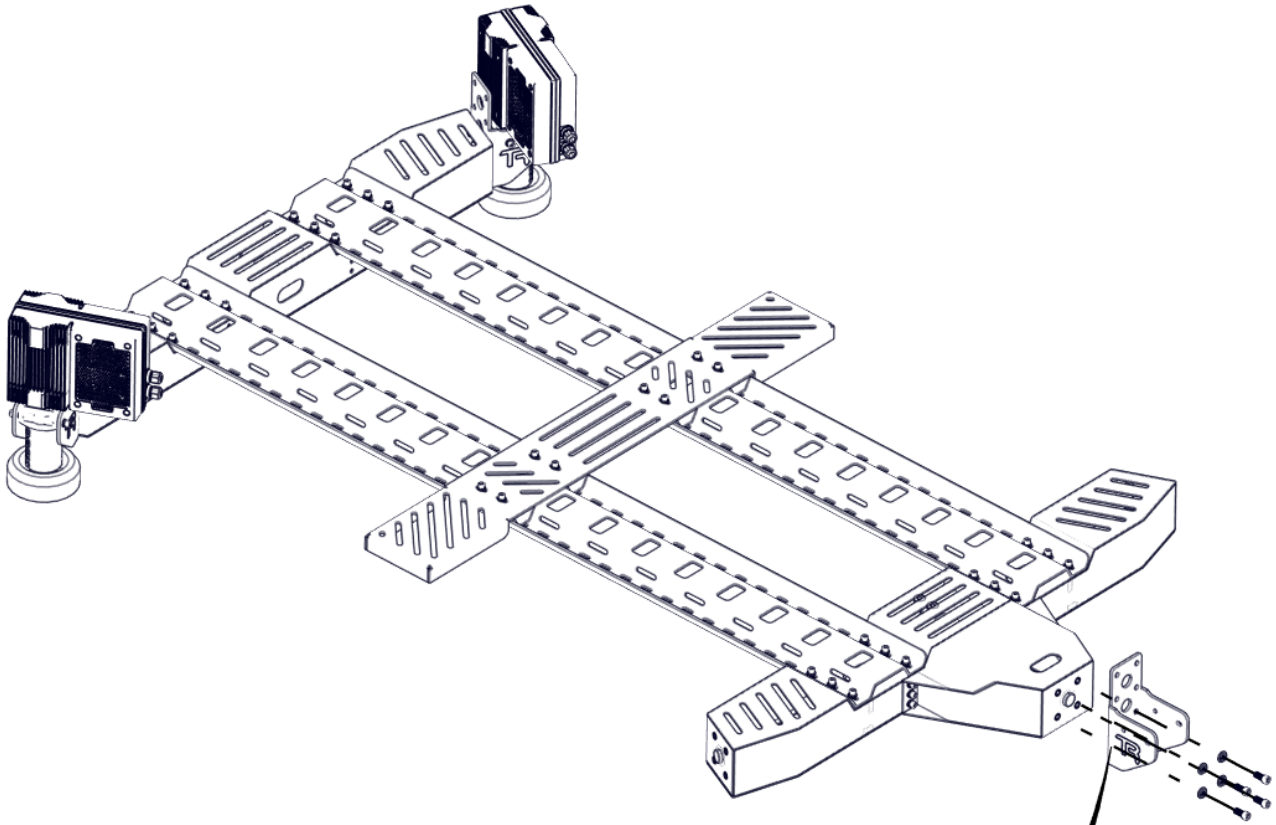

X1 Motor Bracket

**X4 M8x16 screw
+ Plain washers
+ Lock washer**

Assembly Instructions

Assembling the main chassis for 3 motion motors.

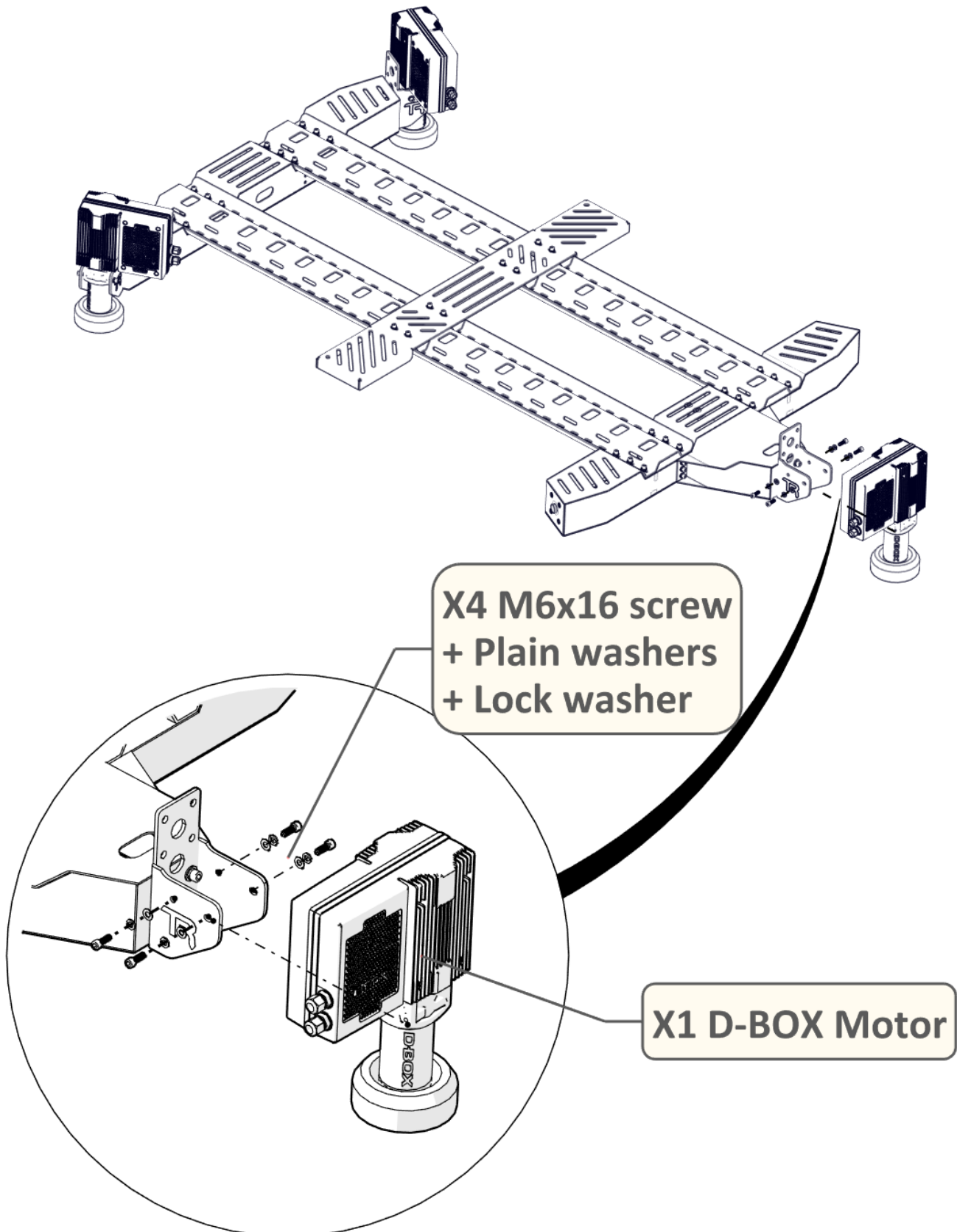

Assembly Instructions

Assembling the main chassis for 2 motion motors.

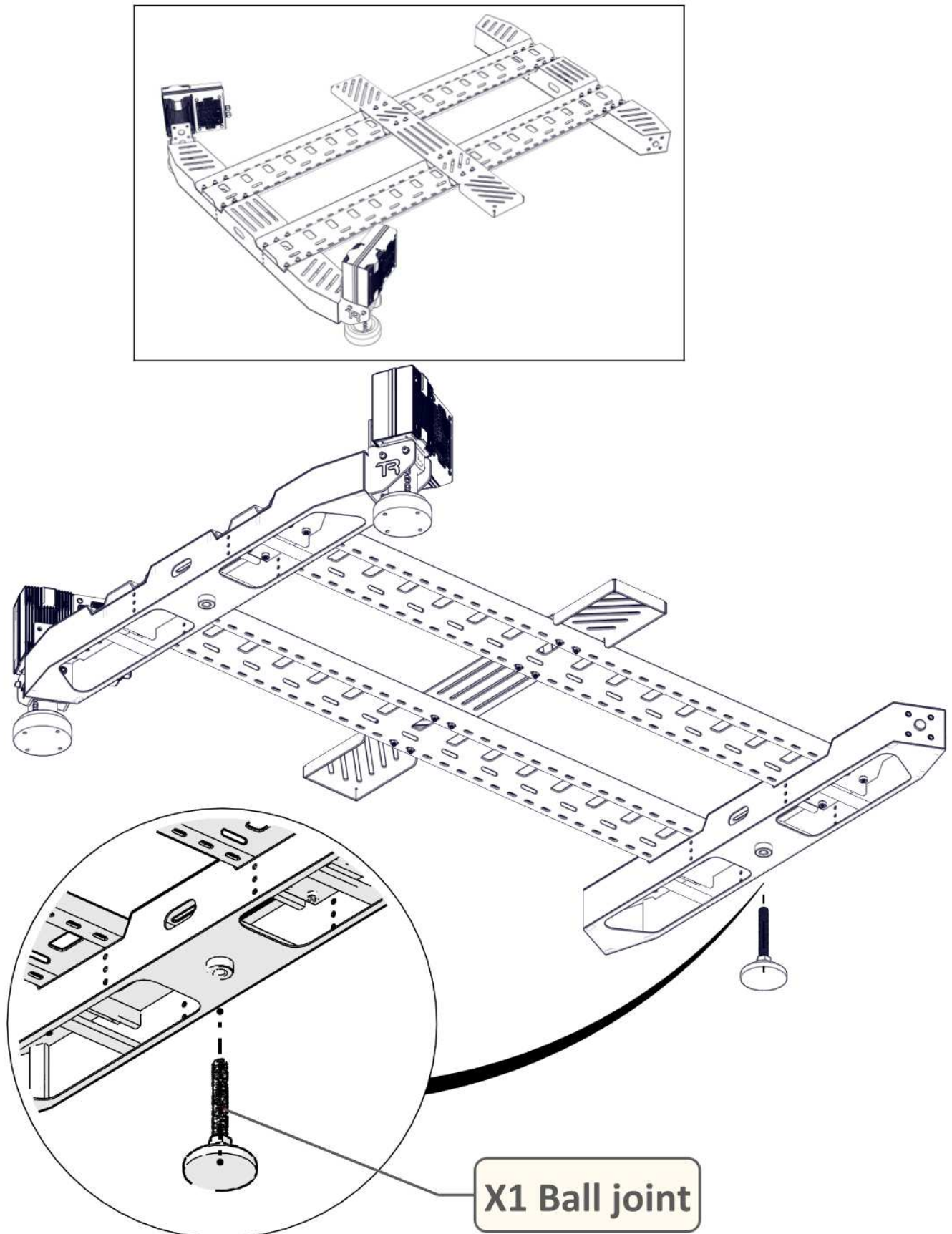

Assembly Instructions

Adjusting ball joint

- 1-Turn on the D-BOX Motor so it move to the neutral position.
- 2-Adjust the ball joint by rotating the lower nut until the chassis is parallel to the ground.
- 3-Secure the ball joint using the lock nut.

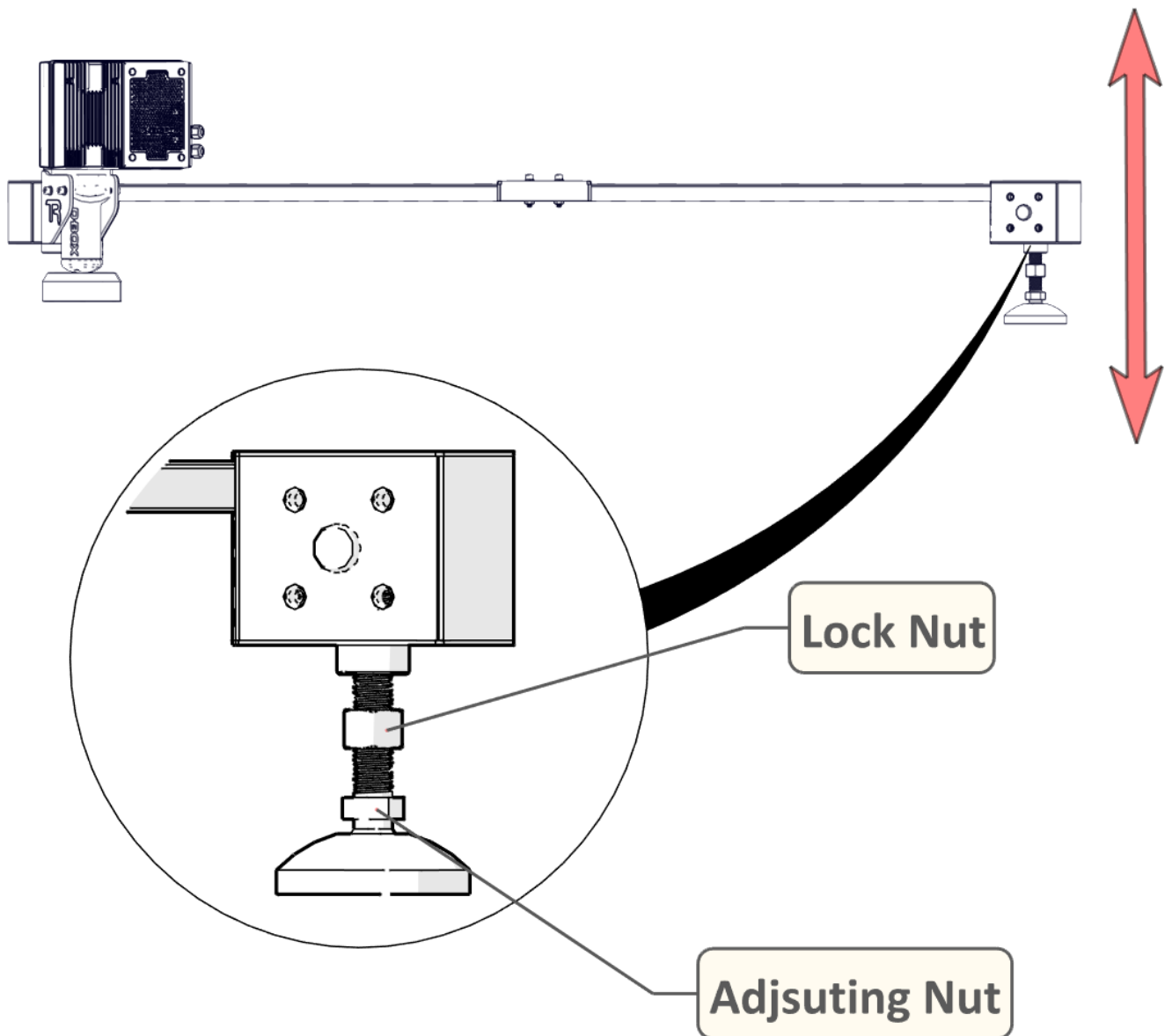

Trak Racer TRX Mounting

Adapting the TR Move Motion Base for Trak Racer TRX.

Loosely Secure Bracket A1 in the middle so it can be adjusted to fit the position of the cockpit.

X2 Bracket B1

X3 Bracket A1

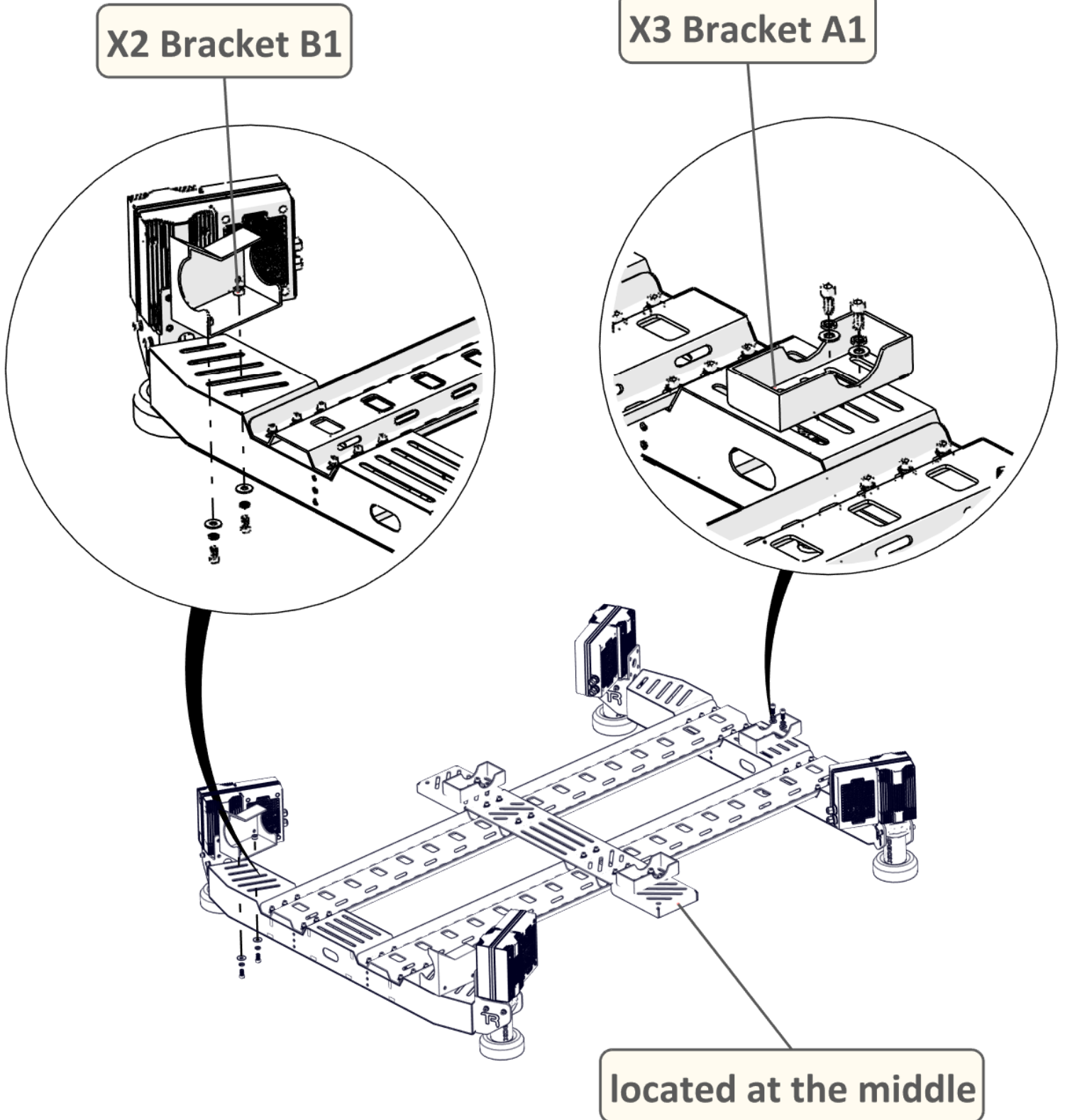

Trak Racer TRX Mounting

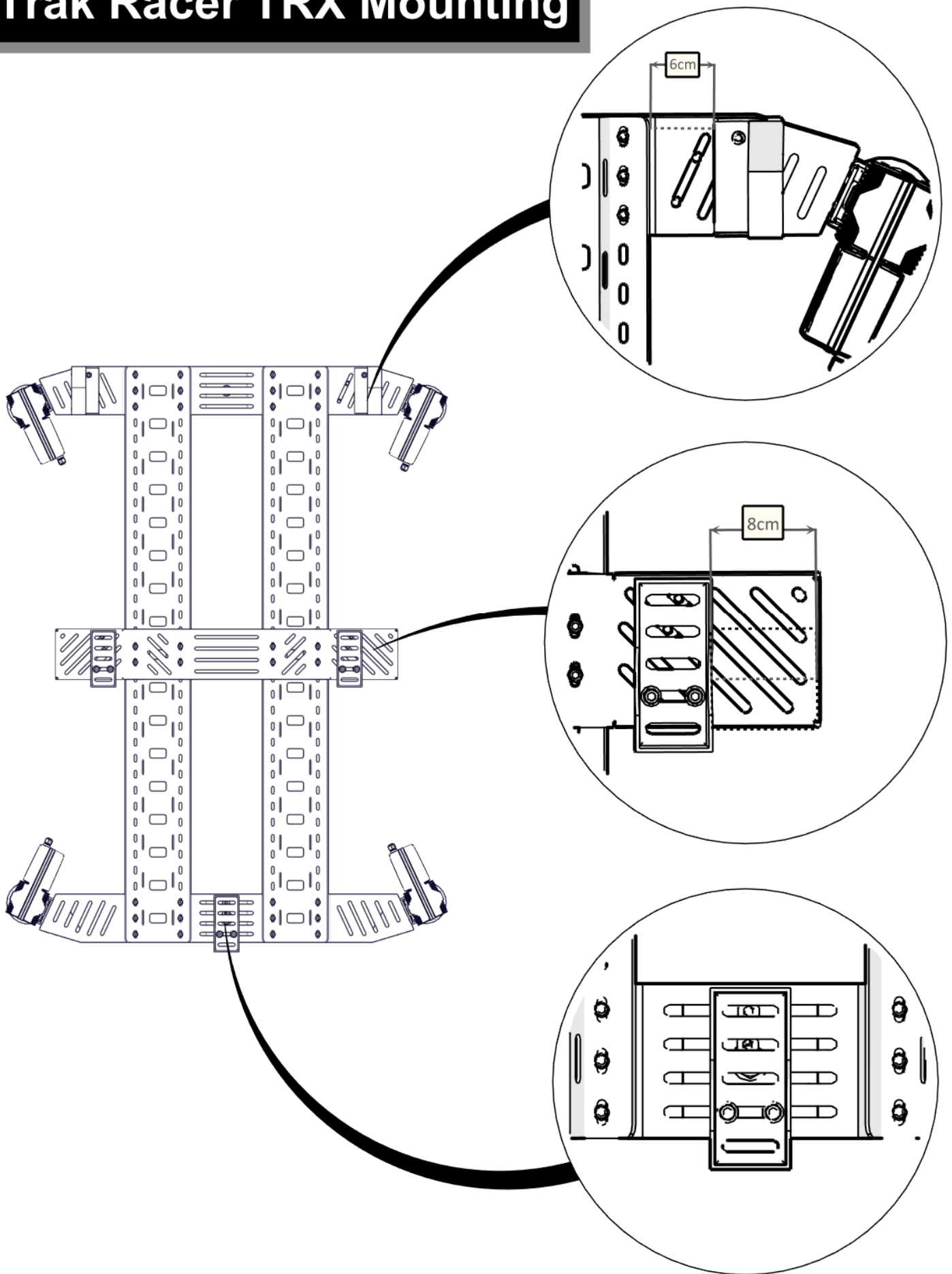

Trak Racer TRX Mounting

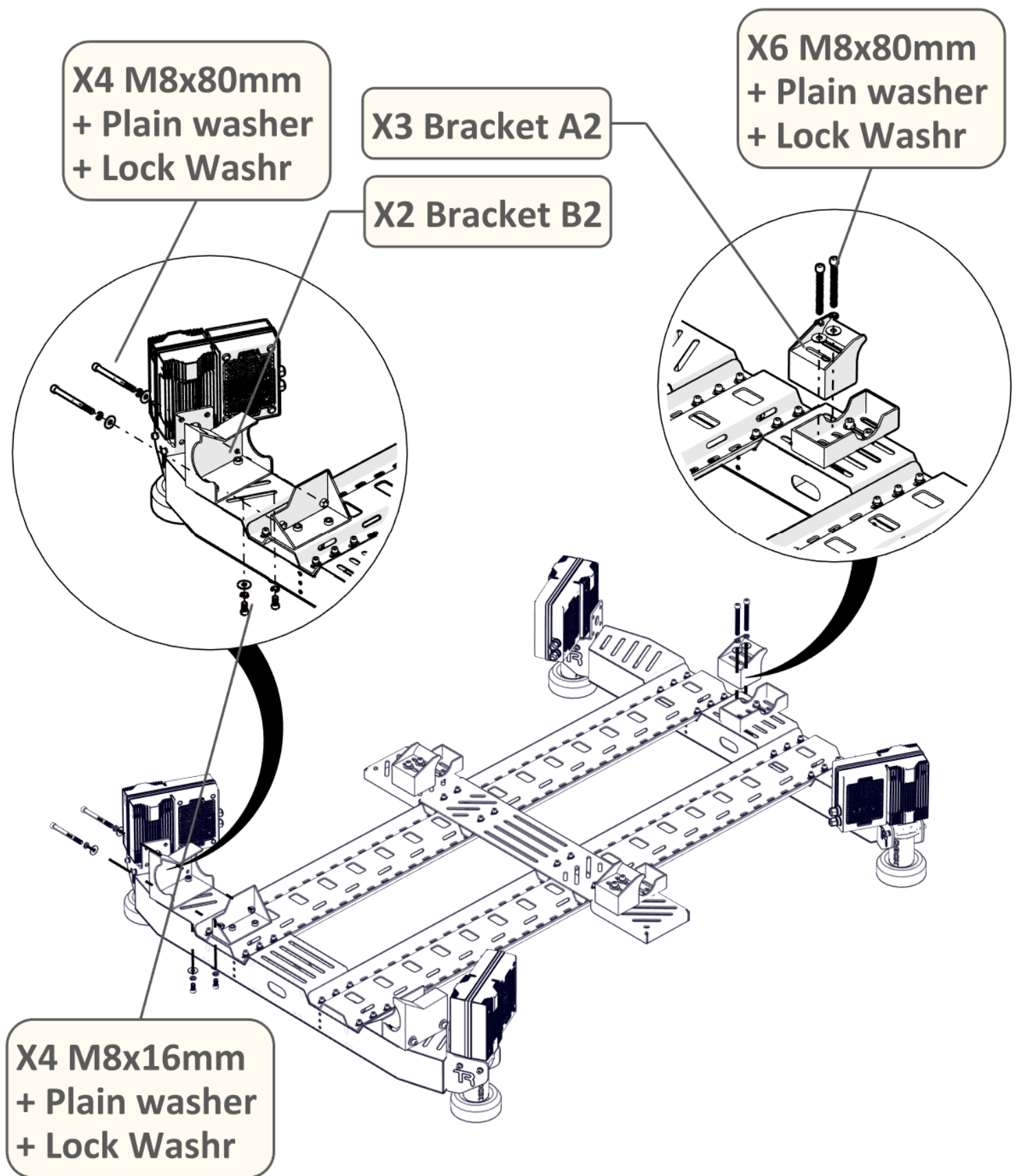

FINISHED

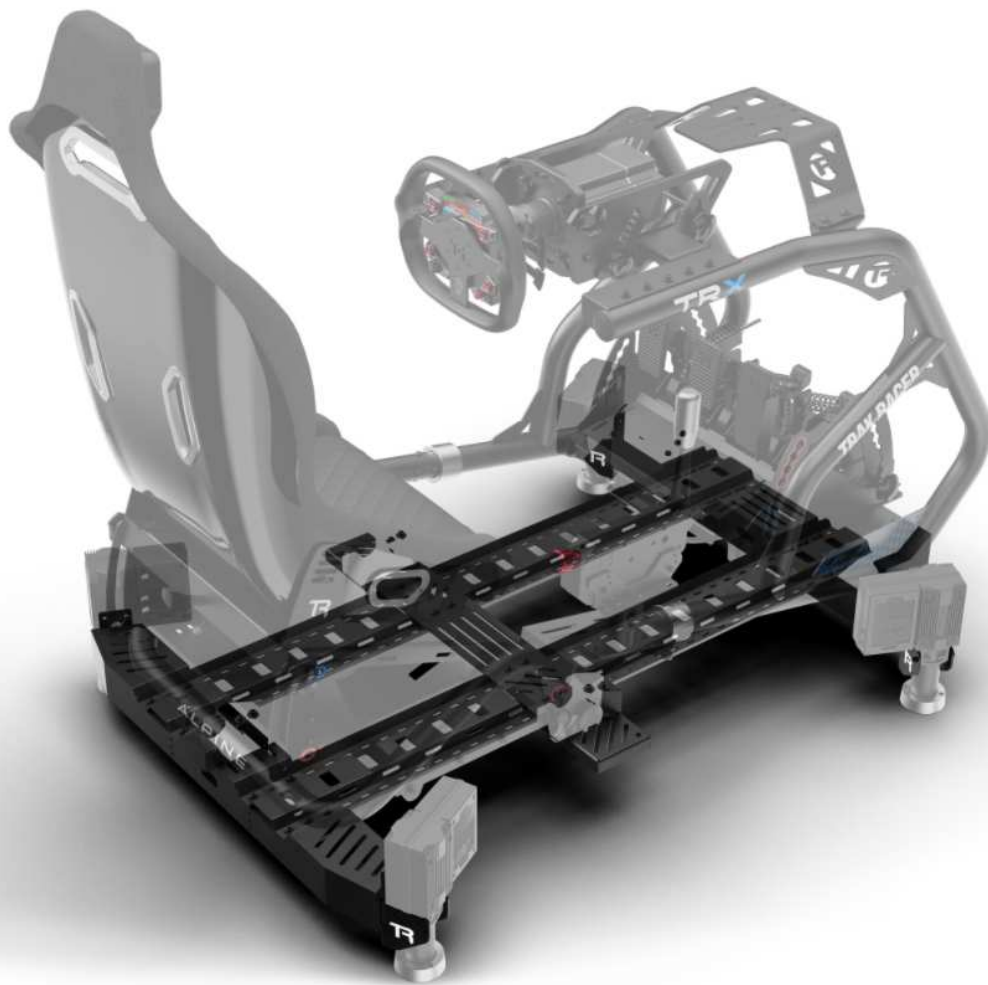

Share your build online and tag us to be featured!



@trakracer



@trakracer



@trak_racer