

EXTRA TRAVEL TRI-POST JIB - TJIB-20

APPROX WEIGHT: 297.99 lbs.
 DOES NOT INCLUDE WEIGHT OF POWER OR PACKAGING!!!

*** ANY ADDITIONS, DELETIONS, OR OMISSIONS MUST BE CORRECTED ON THIS DRAWING AS THIS DRAWING WILL BE CONSIDERED ALL INCLUSIVE ***

ALL GRAPHICS PROVIDED ARE FOR REFERENCE ONLY. IF CERTAIN DIMENSIONS ARE CRITICAL PLEASE VERIFY THOSE DIMENSIONS WITH YOUR SALESPERSON

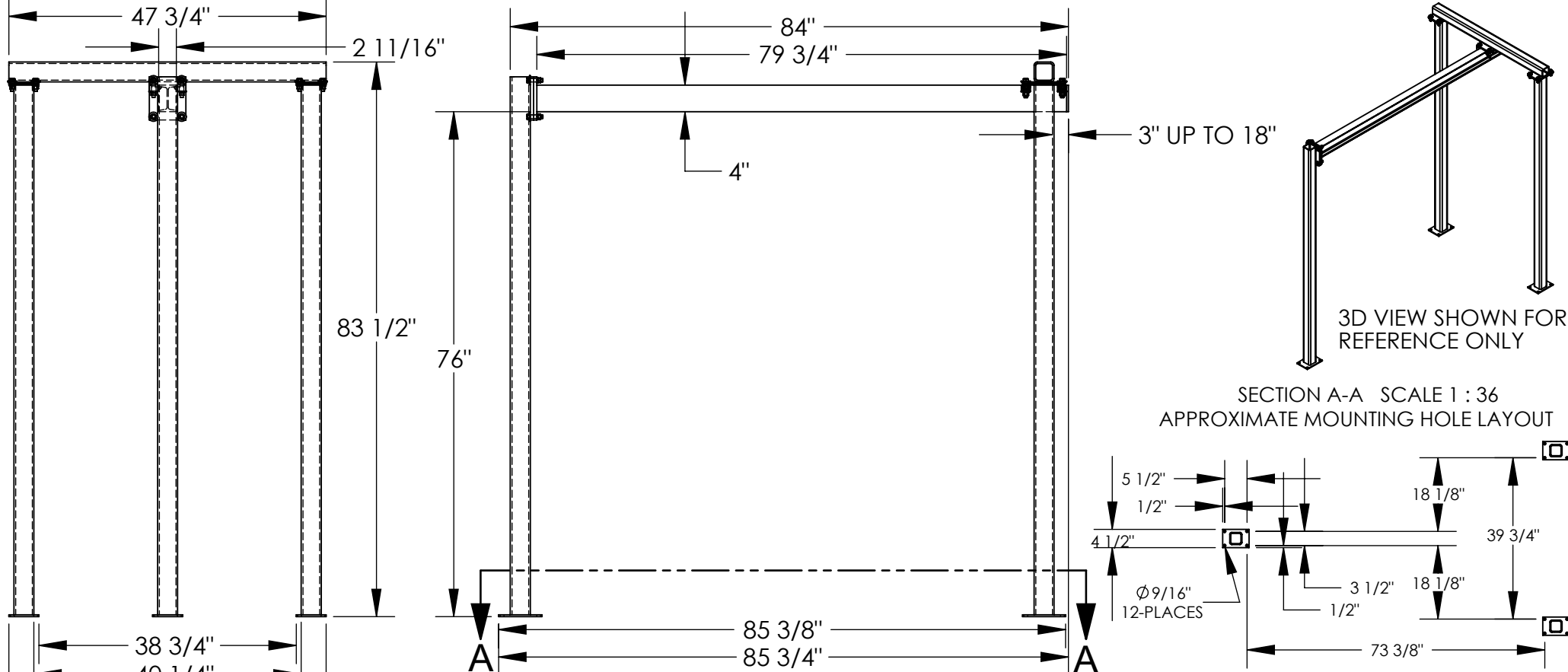

STANDARD FEATURES

- MODEL NUMBER IS TJIB-20
- CAPACITY IS 2000 LBS.
- OVERALL WIDTH IS 47 3/4"
- STRADDLE WIDTH (ID) IS 40 1/4"
- OVERALL LENGTH IS 85 3/4"
- USABLE I-BEAM LENGTH IS 79 3/4"
- OVERALL HEIGHT IS 83 1/2"
- UNDER I-BEAM CLEARANCE IS 76"
- I-BEAM SIZE IS 4" HEIGHT X 2 11/16" FLANGE WIDTH
- OVERHANG OF I-BEAM CAN BE SET FROM 3" UP TO 18"
- DURABLE LIQUID PAINT BLUE FINISH

SPECIAL FEATURES

NONE

NOTE:

SPECIAL FOUNDATION MAY BE REQUIRED: SEE OWNERS MANUAL FOR DETAILS

DIMENSION TOLERANCE ± 1/4"

APPROVAL

I, THE UNDERSIGNED, AGREE THAT THE PRODUCT AS REPRESENTED SATISFIES DESIGN AND DIMENSION REQUIREMENTS. I ALSO ACKNOWLEDGE MY DUTY TO CONFIRM PRODUCT AND INSTALLATION COMPLIANCE WITH ALL APPLICABLE FEDERAL, STATE AND LOCAL REGULATIONS AND STANDARDS.

ANY MODIFIED UNITS ARE NON-RETURNABLE

[] As drawn [] As marked

Signed: _____ Date: _____

Printed Name: _____

LEAD TIME WILL START UPON RECEIPT OF SIGNED APPROVAL DRAWING

| | |
|---|--|
| FOR INTERNAL USE ONLY PROJECT SIGN OFF | |
| SALES | |
| ENG. | |
| FAB. | |
| POWER | |

| | | |
|----------------------|----------------|------------|
| DISTRIBUTOR'S NAME: | | P.O.# |
| VESTIL MANUFACTURING | | X |
| DRAWN BY: ND | DATE: 2/9/2013 | W.O.# |
| REFERENCE: X | SCALE: 1:22 | X |
| QUOTED LEAD TIME: X | QUOTE # | FILE NAME: |
| | X | 28-007-041 |