

Instruction Manual

DRUM GRAB

MODEL NUMBER: DGS-A-PSD



Note: The Owner/Operator must read carefully and understand all the information presented here before operation.

Contents

1	Structure and relevant parts description.....	2
2	Specification.....	3
3	Unpacking.....	3
4	General safety information.....	3
5	Operation.....	4
6	Maintenance.....	6
7	For warranty service.....	6
8	For non-warranty service.....	6

THANK YOU FOR CHOOSING OUR DRUM GRAB. FOR YOUR SAFETY AND CORRECT OPERATION, PLEASE CAREFULLY READ THE MANUAL BEFORE USE.

NOTE: All of the information reported herein is based on data available at the time of printing. The factory reserves the right to modify its own products at any time without notice or incurring in any sanction. Please verify with the factory for possible updates.

1. STRUCTURE AND RELEVANT PARTS DESCRIPTION

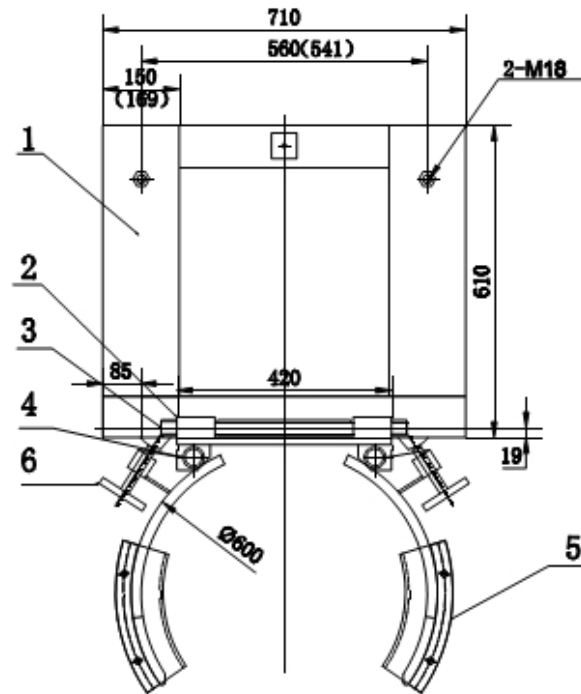

Item No.	Description	Remark
1	Supporting rack	
2	Axle base	
3	Axl	
4	Bol	
5	Clam	
6	M20X90 T-BOLT	
LOAD RATING: 1500lbs/per drum, drum diameter : 16 ³ / ₈ -24"		

2. SPECIFICATION

Model	Drum Type	Capacity (lbs / per drum)	Drum diameter (Inch)	Fork Pockets (Inch)	Net weight (lbs)
DGS-A-P SD	Single Drum	1500	16-23½	5½*2	121

3. UNPACKING

When unpacking your unit, check carefully for shipping damage. If damage has occurred, file a claim with the delivering carrier within 24 hours and notify the dealer from whom the unit was purchased.

4. GENERAL SAFETY INFORMATION

WARNING: The Drum Grabs are designed for specific functions. To insure proper use, the following instructions must be adhered to:

1. DO NOT USE YOUR UNIT FOR LOADS EXCEEDING THE RATED CAPACITY..
2. Adhere to all local codes regarding drum use and storage.
3. Before using this product, contact the manufacturer of your industrial truck and obtain their written approval that the truck has the capacity to be used with this attachment.
4. Don not use drum grabs with manually operated stackers.
5. Do not use to lift personnel or to carry loads over people.
6. Do not leave with a loads suspended in air unattended.
7. Do not remove or obscure capacity warning label.
8. Inspect unit daily before use. Remove unit from service immediately if damaged or malfunctioning until such time as repairs have been made.
9. Do not modify this product in any way.
10. Use only replacement parts with the manufacturer offered when servicing.

5. OPERATION (video clip of the operation for steel drums is available upon request)
The following outlines the general operation of Drum Grabs. Differences for specific models follow this section.

1. Place unit on floor or flat surface easily accessible to fork truck. Be sure that "T" bolts are sufficiently unthreaded to allow forks to enter pockets.
2. Adjust the hoop according to the drum diameter
3. Carefully slide forks (do not use fork extensions) into drum grab's fork pockets. Be sure forks are in pockets as far as possible.
4. Hand tighten "T" bolts to secure unit to forks (hand tool may be used but is not necessary). Recheck bolts periodically during use for tightness.
5. If not already done, unfold grab jaws.
6. Raise unit and approach drum so that the jaws come in contact with the drum just below the upper rolling rib of the drum. (Fig 1)

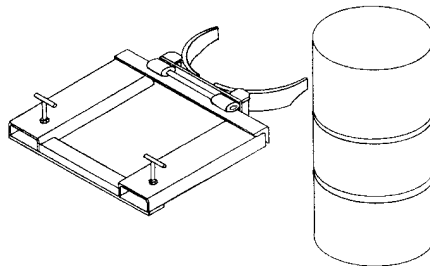

Figure 1

7. Move unit forward onto drum, lowering jaws slowly as you move. Jaws will open and close around drum. (Fig 2)

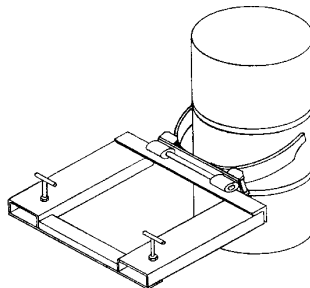

Figure 2

8. When jaws surround drum, raise forks until jaws rest under upper rolling rib. Drum can now be raised and moved where desired. (Fig.3)

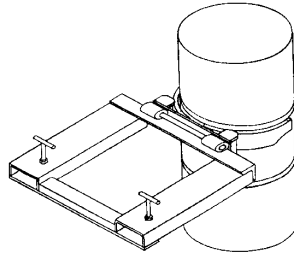

Figure 3

9. To release drums, return to floor, lowering drum grab slowly as you pull back.
10. Follow same procedure with tow drums at same time. For easier pickup, drums should touch each other. Be sure that drum weights are similar to insure balanced load.

6. MAINTENANCE

Lubricate moving parts periodically

7. FOR WARRANTY SERVICE

If unit does not work properly, contact your dealer or the factory for units less than ninety days old.

8. FOR NON-WARRANTY SERVICE

For units older than ninety days, repairs can be made easily with factory authorized parts.

NOTE: Do not send units to the factory for service without obtaining a “returned goods authorization number” from the service department. We will not be responsible for goods returned without proper authorization.

This needs to be updated with detail user instructions

1.How and when to adjust the T-bolt?

The T-Bolts are adjusted to the proper clamping angle because clamping different drum types requires different clamping angles and sometimes adjustments .



2. How to use with 30 & 55 gallon steel and plastic drums?

Lifting steel drum: Remove clamping brackets. Steel drums are lifted from middle of the drum. Lifting plastic drum, install the clamping brackets. Plastic drums are lifted from under the top ring.

3. What is the purpose of clamping brackets bolted on the gripper arms and when to use these brackets?

The function of the clamping brackets is to clamp the plastic drums. Since the plastic oil drum is clamped in the deep groove below the top ring, the clamping brackets must be installed.



LIMITED WARRANTY

Vestil Manufacturing Corporation (“Vestil”) warrants this product to be free of defects in material and workmanship during the warranty period. *Our warranty obligation is to provide a replacement for a defective original part if the part is covered by the warranty, after we receive a proper request from the warrantee (you) for warranty service.*

Who may request service?

Only a warrantee may request service. *You are a warrantee if you purchased the product from Vestil or from an authorized distributor AND Vestil has been fully paid.*

What is an “original part”?

An original part is a part used to make the product as shipped to the warrantee.

What is a “proper request”?

A request for warranty service is proper if Vestil receives: 1) a photocopy of the Customer Invoice that displays the shipping date; AND 2) a written request for warranty service including your name and phone number. Send requests by any of the following methods:

Mail
Vestil Manufacturing Corporation
2999 North Wayne Street, PO Box 507
Angola, IN 46703

Fax
(260) 665-1339
Phone
(260) 665-7586

Email
sales@vestil.com

In the written request, list the parts believed to be defective and include the address where replacements should be delivered.

What is covered under the warranty?

After Vestil receives your request for warranty service, an authorized representative will contact you to determine whether your claim is covered by the warranty. Before providing warranty service, Vestil may require you to send the entire product, or just the defective part or parts, to its facility in Angola, IN. The warranty covers defects in the following *original* dynamic components: motors, hydraulic pumps, electronic controllers, switches and cylinders. It also covers defects in *original* parts that wear under normal usage conditions (“wearing parts”): bearings, hoses, wheels, seals, brushes, batteries, and the battery charger.

How long is the warranty period?

The warranty period for original components is 30 days. The warranty period begins on the date when Vestil ships the product to the warrantee. If the product was purchased from an authorized distributor, the period begins when the distributor ships the product. Vestil may extend the warranty period for products shipped from authorized distributors by *up to 30 days* to account for shipping time.

If a defective part is covered by the warranty, what will Vestil do to correct the problem?

Vestil will provide an appropriate replacement for any *covered* part. An authorized representative of Vestil will contact you to discuss your claim.

What is not covered by the warranty?

1. Labor;
2. Freight;
3. Occurrence of any of the following, which automatically voids the warranty:
 - Product misuse;
 - Negligent operation or repair;
 - Corrosion or use in corrosive environments;
 - Inadequate or improper maintenance;
 - Damage sustained during shipping;
 - Collisions or other incidental contacts causing damage to the product;
 - Unauthorized modifications: DO NOT modify the product IN ANY WAY without first receiving written authorization from Vestil. Modification(s) might make the product unsafe to use or might cause excessive and/or abnormal wear.

Do any other warranties apply to the product?

Vestil Manufacturing Corp. makes no other express warranties. All implied warranties are disclaimed to the extent allowed by law. Any implied warranty not disclaimed is limited in scope to the terms of this Limited Warranty.

