

Instruction Manual

Drum Truck DE500 series

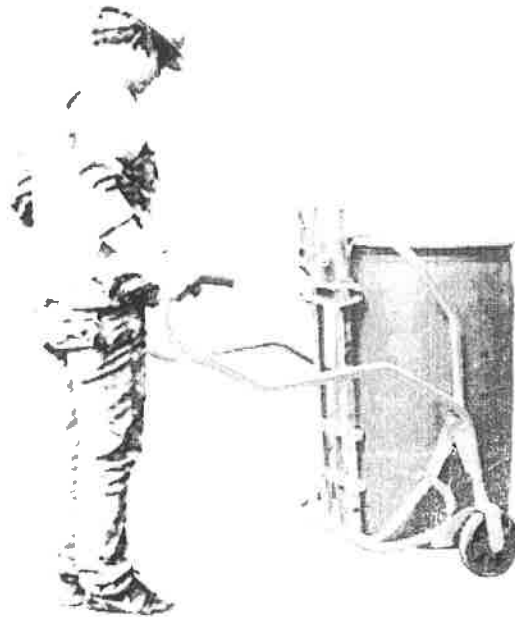

Note: Operator must read and understand this Instruction Manual
before using.

Feature

1. Automatic drum grip mechanism with 500kg capacity;
2. Leverage principle, safely operation;
3. Adjustable eagle-grip to suit for transporting all types of drums;
4. DE500- carbon steel and with galvanized surface treatment
DE500A/DE500B- stainless steel
5. Manufactured in whole stainless steel, this drum trolley has been well served in food, chemical, offshore and pharmaceutical industries.

Technical Data

Model	DE500	DE500A	DE500B
Load capacity	500 kg/ 1100 lbs	500 kg/ 1100 lbs	500 kg/ 1100 lbs
Material	Galvanized	Stainless steel 201	Stainless steel 304
Net weight	27.6 kg/ 61 lbs	25.3 kg/ 56 lbs	25.3 kg/ 56 lbs
Wheel size (nylon)	200 x 50 mm/ dia 8"	200 x 50 mm/ dia 8"	200 x 50 mm/ dia 8"

Dimensional drawing

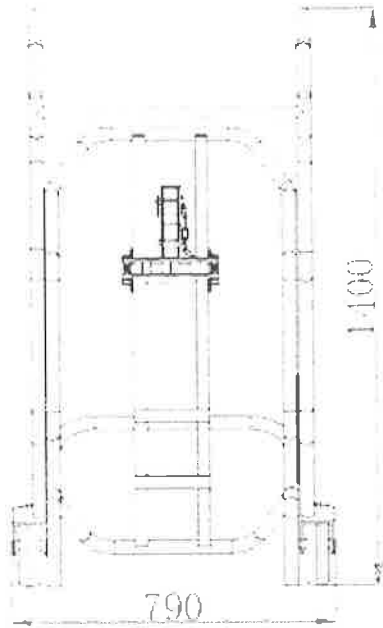

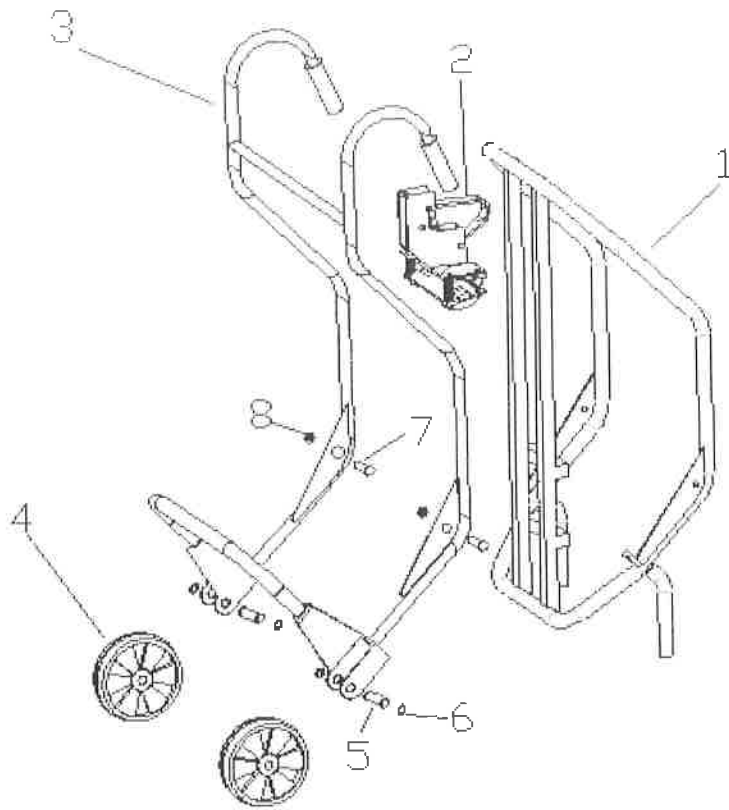

NO.	NAME	UNIT	Qty
1	Non-fixed eagle-grip stand	piece	1
2	eagle-grip assembly	piece	1
3	Frame	piece	1
4	Nylon wheel	piece	2
5	Wheel pin	piece	2
6	Wheel pin jump ring	piece	4
7	M12 bolt	piece	2
8	M12 nut	piece	2