

CYLINDER BRACKET STAND - CB-S-2S

APPROX WEIGHT: 34.74 lbs.
DOES NOT INCLUDE WEIGHT OF POWER OR PACKAGING!!!

ANY ADDITIONS, DELETIONS, OR OMISSIONS MUST BE CORRECTED ON THIS DRAWING AS THIS DRAWING WILL BE CONSIDERED ALL INCLUSIVE

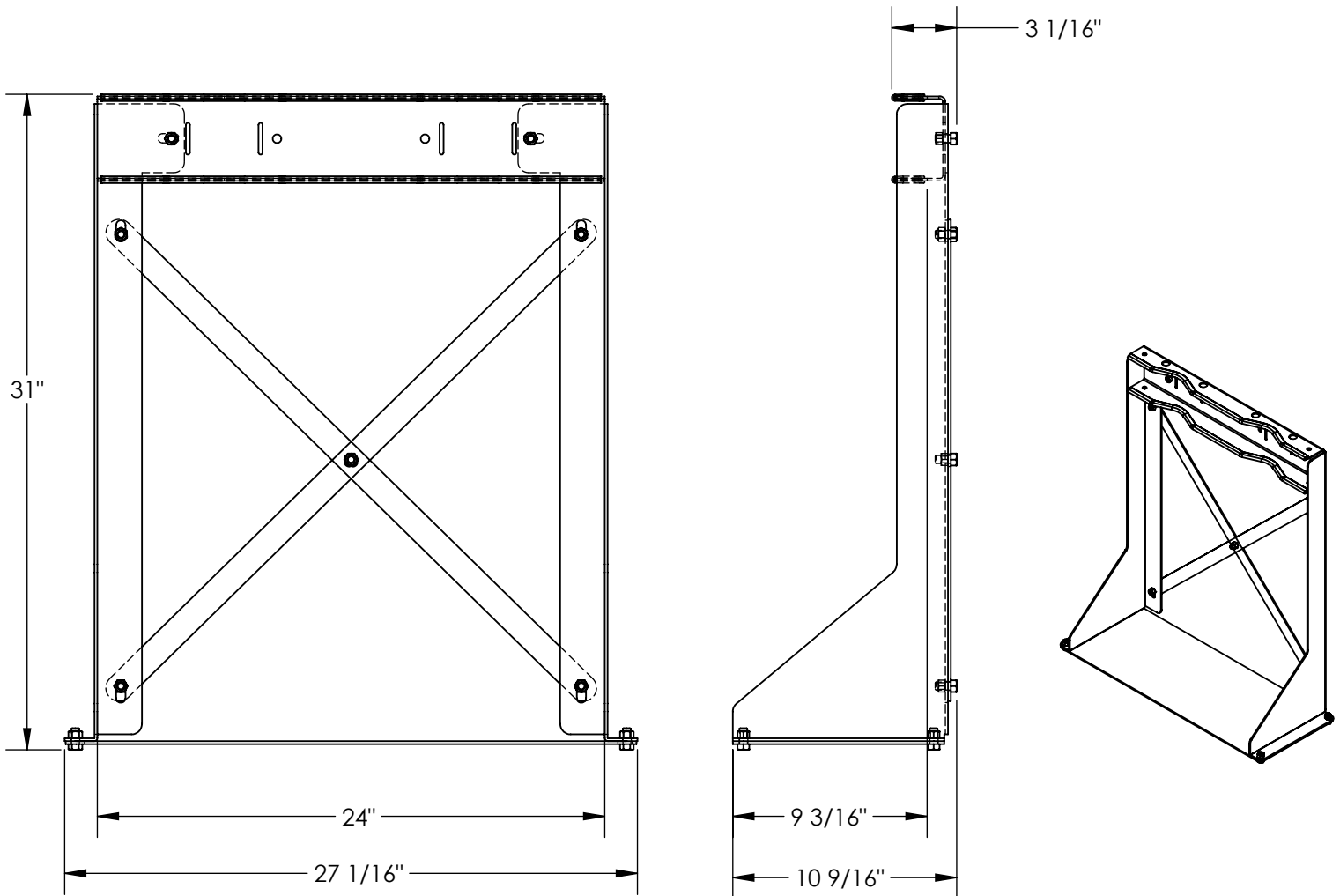

NOTE: CYLINDER SECURING STRAPS WITH TENSION LOCKS ALSO INCLUDED, BUT NOT SHOWN.

FOR INTERNAL USE ONLY PROJECT SIGN OFF	
SALES	
ENG.	
FAB.	
POWER	

ALL GRAPHICS PROVIDED ARE FOR REFERENCE ONLY. IF CERTAIN DIMENSIONS ARE CRITICAL PLEASE VERIFY THOSE DIMENSIONS WITH YOUR SALESPERSON

STANDARD FEATURES

- MODEL NUMBER IS CB-S-2S
- ACCOMMODATES TWO CYLINDERS
- OVERALL WIDTH IS 27 1/16"
- USABLE WIDTH IS 24"
- OVERALL LENGTH IS 10 9/16"
- USABLE LENGTH IS 9 3/16"
- OVERALL HEIGHT IS 31"
- TOUGH BAKED IN POWDER COATED BLUE FINISH ON FRAME
- DURABLE LIQUID PAINT GRAY FINISH ON STEEL BRACKETS

****ASSEMBLY IS REQUIRED****

SPECIAL FEATURES

NONE

APPROVAL	I, THE UNDERSIGNED, AGREE THAT THE PRODUCT AS REPRESENTED SATISFIES DESIGN AND DIMENSION REQUIREMENTS. I ALSO ACKNOWLEDGE MY DUTY TO CONFIRM PRODUCT AND INSTALLATION COMPLIANCE WITH ALL APPLICABLE FEDERAL, STATE AND LOCAL REGULATIONS AND STANDARDS.	
	ANY MODIFIED UNITS ARE NON-RETURNABLE	
	[] As drawn [] As marked	
	Signed: _____	Date: _____
Printed Name: _____		
LEAD TIME WILL START UPON RECEIPT OF SIGNED APPROVAL DRAWING		

DISTRIBUTOR'S NAME:		P.O.#
VESTIL MANUFACTURING		X
DRAWN BY: L. GARROW		DATE: 08/10/2011
REFERENCE: X		SCALE: 1:8
QUOTED LEAD TIME: X	QUOTE # X	FILE NAME: 16-007-299
		SALES: X
		W.O.# X