



**Vestil Manufacturing Corp.**  
 2999 North Wayne Street, P.O. Box 507, Angola, IN 46703  
 Telephone: (260) 665-7586 -or- Toll Free (800) 348-0868  
 Fax: (260) 665-1339  
 Web: [www.vestilmfg.com](http://www.vestilmfg.com) e-mail: [info@vestil.com](mailto:info@vestil.com)

# A-FRAME PANEL CARTS



**Receiving Instructions**

After delivery, remove the packaging from the product. Inspect the product closely to determine whether it sustained damage during transport. If damage is discovered, record a complete description of it on the bill of lading. If the product is undamaged, discard the packaging.

**NOTE:** The end-user is solely responsible for confirming that product design, use, and maintenance comply with laws, regulations, codes, and mandatory standards applied where the product is used.

**Technical Service & Replacement Parts**

For answers to questions not addressed in these instructions and to order replacement parts, labels, and accessories, call our Technical Service and Parts Department at (260) 665-7586. The Department can also be contacted online at <https://www.vestil.com/page-parts-request.php>.

**Electronic Copies of Instruction Manuals**

Additional copies of this instruction manual may be downloaded from <https://www.vestil.com/page-manuals.php>.

Table of Contents

	Page
<a href="#">Signal Words</a> .....	2
<a href="#">Safety Instructions</a> .....	2
<a href="#">Assembling the Panel Cart</a> .....	3
<a href="#">Using the Panel Cart</a> .....	3
<a href="#">Exploded View and Bill of Materials</a> .....	3
<a href="#">Record of Satisfactory Condition</a> .....	4
<a href="#">Inspections and Maintenance</a> .....	4
<a href="#">Labeling Diagram</a> .....	4
<a href="#">Limited Warranty</a> .....	5

## SIGNAL WORDS

This manual uses SIGNAL WORDS to draw attention to uses of the product that could result in personal injuries, as well as the probable seriousness of those injuries. Other signal words call attention to uses likely to cause property damage. Signal words used in this manual appear below along with the definition of each word.



Identifies a hazardous situation which, if not avoided, **WILL** result in DEATH or SERIOUS INJURY. Use of this signal word is limited to the most extreme situations.



Identifies a hazardous situation which, if not avoided, **COULD** result in DEATH or SERIOUS INJURY.



Indicates a hazardous situation which, if not avoided, **COULD** result in MINOR or MODERATE injury.



Identifies practices likely to result in product/property damage, such as operation that might damage the product.

## SAFETY INSTRUCTIONS

We strive to identify foreseeable hazards associated with the use of our products. However, material handling is inherently dangerous and no manual can address every risk. The end-user ultimately is responsible for exercising sound judgment at all times.



Improper or careless use of this product could result in death or serious personal injuries.

- ***Read and understand the entire manual before assembling, installing, using or servicing the product.***
- Read the manual to refresh your understanding of proper use and maintenance procedures.
- DO NOT attempt to resolve any problem(s) with the product unless you are qualified to perform maintenance on it.
- DO NOT modify the product in any way UNLESS you first obtain written approval from Vestil. Unapproved modifications automatically void the Limited Warranty and might make the product unsafe to use.
- DO NOT exceed the maximum rated load. See [LABELING DIAGRAM](#) on p. 4, specifically label 287 on product.
- DO NOT attempt to move a panel of material if the panel makes the cart unstable, i.e. if a panel is too tall it could cause the cart to tip. ONLY move stable loads with this cart.
- Inspect the product before each use. DO NOT use this product if the inspection reveals structural damage such as, but are not limited to, the following: 1) Cracked, broken or significantly deformed load-bearing members; 2) cracked welds; 3) significant corrosion, severe wear, or other condition that affects the ability of the product to support weight or itself. Replace each part that fails to pass an inspection, and DO NOT use the product until it is fully restored to satisfactory condition. See [RECORD OF SATISFACTORY CONDITION](#) on p. 4.
- Secure panel to cart, e.g. with ratchet straps.
- DO NOT travel up/down sloped surfaces. Only use on even, level ground.
- DO NOT apply unbalanced loads to the cart. Follow the loading procedure described in [USING THE PANEL CART](#) on p. 3.
- DO NOT use this device UNLESS all product labels are readable and undamaged. See [LABELING DIAGRAM](#) on p. 4.



Proper use, maintenance, and storage are essential for this product to function properly.

- Always use this product in accordance with the instructions in this manual and consistent with safe material handling practices.
- Keep the product clean & dry. Lubricate moving parts when necessary.

## ASSEMBLING THE PANEL CART

Refer to the **EXPLODED VIEW** on p. 3 to assemble the cart. If you encounter difficulties or need assistance with the assembly, contact **TECHNICAL SERVICE**.

## USING THE PANEL CART

Center all panels applied to the cart by aligning the centerlines of the panels with the vertical centerline of the panel supporting frame of the cart (dashed lines). Whenever more than 1 panel is placed on the cart, distribute the panels so that an equal number is applied to each side of the panel supporting frame.

Strap all panels to the supporting frame to prevent them from sliding. **DO NOT** use the cart to transport panels that cannot be stably loaded on it.

Apply both caster brakes whenever the cart is not in motion. To apply the brakes, press down on the brake levers. Release brakes by lifting the brake levers.

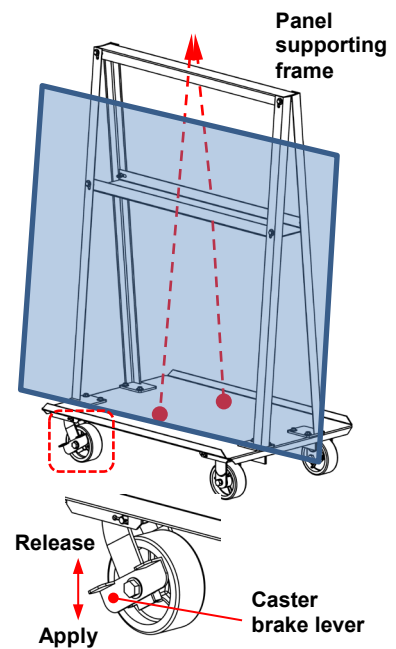

## EXPLODED VIEW AND BILL OF MATERIALS

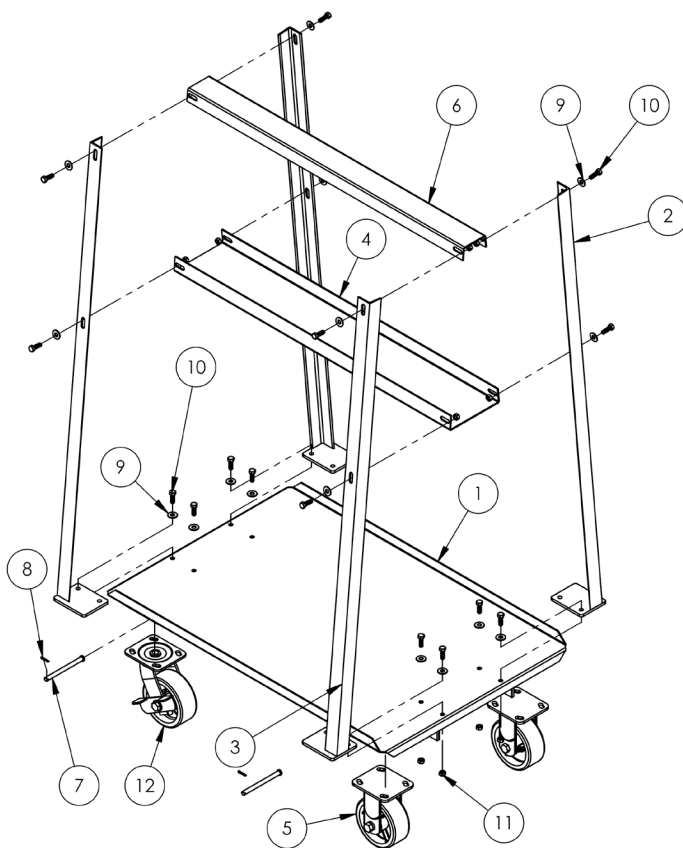

ITEM NO	PART NO	DESCRIPTION	QTY
1	16-514-104	BASE FRAME WELDMENT:	1
	16-514-105	AF-2436	1
	16-514-033	AF-2448	1
	16-514-106	AF-3048	1
	16-514-021	AF-3060	1
2	16-514-095	RIGHT LEG FRAME WELDMENT	2
3	16-514-096	LEFT LEG FRAME WELDMENT	2
4	16-032-014	MIDDLE STIFFENER:	1
	16-032-016	AF-2436	1
	16-032-018	AF-2448 & AF-3048	1
	16-032-001	AF-3060	1
5	16-132-022	RIGID CASTER, PU-5/2-R	2
6	16-032-013	TOP STIFFENER:	1
	16-032-015	AF-2436	1
	16-032-017	AF-2448 & AF-3048	1
	16-032-011	AF-3060	1
7	99-112-006	CLEVIS PIN	4
8	65073	COTTER PIN, ZINC FINISH, 1/8 X 5/8	4
9	33006	FLAT WASHER, ZINC PLATED, USS, 5/16	16
10	11055	HEX BOLT, GRADE A, ZINC PLATED, 5/16-18X1	16
11	36104	HEX NUT, GRADE A, ZINC PLATED, 5/16-18	16
12	16-132-053	SWIVEL CASTER WITH BRAKE, PU-5/2-S-SWB	2

## RECORD OF SATISFACTORY CONDITION

Before putting this product into service, make a record of its appearance and operation. Photograph the unit from multiple vantage points. Take close range photographs of all labeling applied to the unit. Photograph all casters and caster brakes, all 4 legs of and both stiffeners that comprise the panel supporting frame (items 2, 4, & 6), and all fasteners (pins, bolts, nuts, etc.). Describe the force necessary to move the cart. Describe the motion of the cart as it rolls on its casters, i.e. smoothly and evenly from side-to side without wobbling. Describe the sounds made by the cart as it rolls. Collate all photographs and writings into a file. Mark the file appropriately to identify it. This file is a record of the unit in satisfactory condition (the "RECORD"). Compare the results of all inspections to this **RECORD** to determine whether the unit is in satisfactory condition. Do not use the cart unless it is in satisfactory condition. Purely cosmetic changes, like damaged paint or powdercoat, are not changes from satisfactory condition. However, touchup paint should be applied as soon as damage occurs.

## INSPECTIONS AND MAINTENANCE

Regular inspections and maintenance are necessary to keep the device in satisfactory condition. Compare the results of each inspection to your **RECORD** to determine whether the unit is satisfactory condition or requires repairs or replacement parts. If you are uncertain whether a part requires repair or replacement, contact **TECHNICAL SERVICE** for assistance.

- Periodically lubricate casters/wheels, especially if they become squeaky.
- Keep the product clean and dry. Store the cart indoors.
- Only use manufacturer- approved replacement parts.

**Before each use: [Refer to **EXPLODED VIEW** on p. 3]**

1. Check the surface of the product for dirt or other matter. Clean the surfaces.
2. Examine hardware & fasteners, including but not limited to bolts, nuts, and pins. Replace damaged, worn, or corroded hardware.
3. Examine legs (item 2) and stiffeners (items 4 & 6), casters, and caster brakes for wear, breaks, corrosion/rusting, damage, and metal fatigue.
4. Check all labels. See **LABELING DIAGRAM** below. Replace labels that are damaged or not easily readable.
5. Examine the base frame for severe rusting/metal erosion, rot, thinned regions. If rusting is purely superficial, remove the rust/corrosion with a steel bristle brush or steel wool. Clean the affected area and apply touchup paint. If rusting, rot, or thinning has weakened the material, contact **TECHNICAL SERVICE** for advice.

## LABELING DIAGRAM

The unit should be labeled as shown in the diagram. Label content and locations are subject to change so your product might not be labeled exactly as shown. Replace all labels that are damaged, missing, or not easily readable (e.g. faded). To order replacement labels, contact the technical service and parts department online at [http://www.vestilmfg.com/parts\\_info.htm](http://www.vestilmfg.com/parts_info.htm). Alternatively, you may request replacement parts and/or service by calling (260) 665-7586 and asking the operator to connect you to the **PARTS DEPARTMENT**.

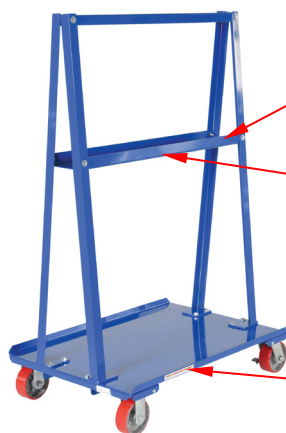

**Label 287**  
 MODEL/MODELO/MODELE \_\_\_\_\_  
 STATIC CAPACITY (evenly distributed) \_\_\_\_\_ lbs.  
 LA CAPACIDAD CONSTANTE (distribuida uniformemente) \_\_\_\_\_ kgs.  
 CAPACITÉ STATIQUE (distribuée régulièrement) \_\_\_\_\_ kgs.  
 SERIAL/SERIE/SÉRIE \_\_\_\_\_ 287 REV.001

**Label 658**

<b>WARNING</b>	<b>ADVERTENCIA</b>	<b>AVERTISSEMENT</b>
Donot operate or move with unstable loads DO NOT LOAD beyond rated capacity DISTRIBUTE LOAD EVENLY DO NOT sit or ride	No use a mueva con cargas inestables No cargue mas de la capacidad tasada DISTRIBUYA LA CARGA A NIVEL NO SE SIENTE o vaya en el carro	Ne pas utiliser avec une charge instable NE PAS CHARGER au-delà du débt nominal DISTRIBUER la charge régulièrement NE PAS VOUS ASSEoir OU VOUS PROMENER sur le chariot

**Label 212**

<b>WARNING</b>	<b>ADVERTENCIA</b>	<b>AVERTISSEMENT</b>
LOCK CASTERS and/or FLOOR LOCK when loading and unloading	La RUEDECILLA de la CERRADURA y/o el PISO CIERRAN al cargar y descargar	VERROUILLER LES ROULETTES et/ou VERROU DE SOL lors du chargement et de déchargement



## LIMITED WARRANTY

Vestil Manufacturing Corporation (“Vestil”) warrants this product to be free of defects in material and workmanship during the warranty period. Our warranty obligation is to provide a replacement for a defective, original part covered by the warranty after we receive a proper request from the Warrantee (you) for warranty service.

### Who may request service?

Only a warrantee may request service. You are a warrantee if you purchased the product from Vestil or from an authorized distributor AND Vestil has been fully paid.

### Definition of “original part”?

An original part is a part used to make the product as shipped to the Warrantee.

### What is a “proper request”?

A request for warranty service is proper if Vestil receives: 1) a photocopy of the Customer Invoice that displays the shipping date; AND 2) a written request for warranty service including your name and phone number. Send requests by one of the following methods:

<u>US Mail</u>	<u>Fax</u>	<u>Email</u>
Vestil Manufacturing Corporation	(260) 665-1339	<a href="mailto:info@vestil.com">info@vestil.com</a>
2999 North Wayne Street, PO Box 507	<u>Phone</u>	Enter “Warranty service request”
Angola, IN 46703	(260) 665-7586	in subject field.

In the written request, list the parts believed to be defective and include the address where replacements should be delivered. After Vestil receives your request for warranty service, an authorized representative will contact you to determine whether your claim is covered by the warranty. Before providing warranty service, Vestil will require you to send the entire product, or just the defective part (or parts), to its facility in Angola, IN.

### What is covered under the warranty?

The warranty covers defects in the following original, dynamic parts: motors, hydraulic pumps, motor controllers, and cylinders. It also covers defects in original parts that wear under normal usage conditions (“wearing parts”), such as bearings, hoses, wheels, seals, brushes, and batteries.

### How long is the warranty period?

The warranty period for original dynamic components is 90 days. For wearing parts, the warranty period is 90 days. Both warranty periods begin on the date Vestil ships the product to the Warrantee. If the product was purchased from an authorized distributor, the periods begin when the distributor ships the product. Vestil may, at its sole discretion, extend a warranty period for products shipped from authorized distributors by up to 30 days to account for shipping time.

### If a defective part is covered by the warranty, what will Vestil do to correct the problem?

Vestil will provide an appropriate replacement for any *covered* part. An authorized representative of Vestil will contact you to discuss your claim.

### What is not covered by the warranty?

The Warrantee (you) are responsible for paying labor costs and freight costs to return the product to Vestil for warranty service.

### Events that automatically void this Limited Warranty.

- Misuse;
- Negligent assembly, installation, operation or repair;
- Installation/use in corrosive environments;
- Inadequate or improper maintenance;
- Damage sustained during shipping;
- Collisions or other accidents that damage the product;
- Unauthorized modifications: Do not modify the product IN ANY WAY without first receiving written authorization from Vestil.

### Do any other warranties apply to the product?

Vestil Manufacturing Corp. makes no other express warranties. All implied warranties are disclaimed to the extent allowed by law. Any implied warranty not disclaimed is limited in scope to the terms of this Limited Warranty. Vestil makes no warranty or representation that this product complies with any state or local design, performance, or safety code or standard. Noncompliance with any such code or standard is not a defect in material or workmanship.