



GJIA

LED High Bay Light

100W~240W



GJIA

WWW.GGJIA-LED.COM

Tel: +1(626)977-6424 E-mail: sales@ggjia-led.com

Features:

- * Light Efficiency: 150lm/W;
- * High bright EVERLIGHT LEDs;
- * Optics of 60°/90°/120° available on request;
- * High-transmittance and anti-UV Polycarbonate lens;
- * Excellent thermal management design;
- * Die-casting aluminum with polyester powder coat finish;
- * IP65/IK08 rating for outdoor usage;
- * Hook hanging and U-bracket installation are available;
- * Energy savings, no UV and IR radiations, emits low heat;
- * 1-10V dimming for low power consumption;
- * DLC/ETL/cETL/SAA/C-TICK/FCC/CE/RoHS approval;
- * 5 years warranty



Specifications:

Model	RMS-L2204
Wattage	100W/150W/200W/240W
Luminous Flux	150LM/W
Beam Angle	60°/90°/120°
Color Temperature	3000K~6000K
Input Voltage	AC100-277V, 50-60Hz
LED Brand	Everlight
CRI	Ra>80
PF	>0.9
Life Hours	50,000
Operation Temperature	-35°C~55°C
IP Rating	IP65



Dimension:

Unit: mm

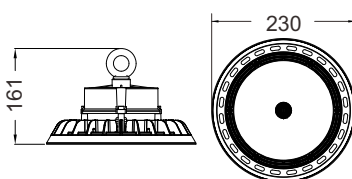

100W

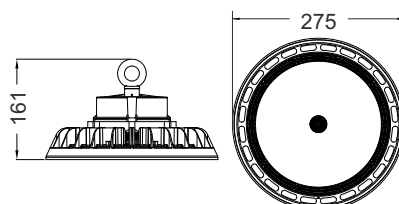

150W

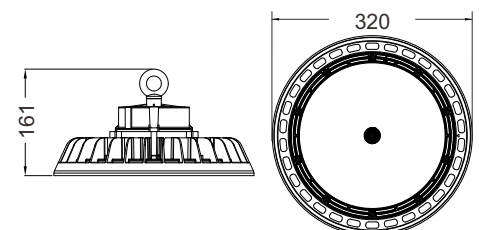

200W/240W

Details:



- High bright Everlight SMD2835, LM80 listed. Whole lamp is 150LPW



- MEANWELL/PHILIPS/SOSEN/FAHOLD/ROMANSO LED driver, 1-10V dimming, high reliable, offer 5 years warranty



- Die cast aluminum alloy body, cooling fins provide maximum heat dissipation.



- Die cast hook mount standard for ease of installation, surface mounted barcket optional.



- LED and heat sink are parallel, no dark area, no shadow.

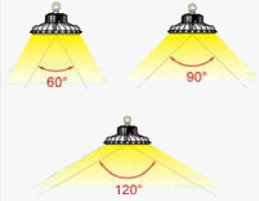

- 3 kinds of beam angle options to suit different lighting requirements in different areas.



- 60°/90° of PC/Aluminum Reflectors are optional.



- Ip65 waterproof for wet location

Mounting Height & Equivalence:

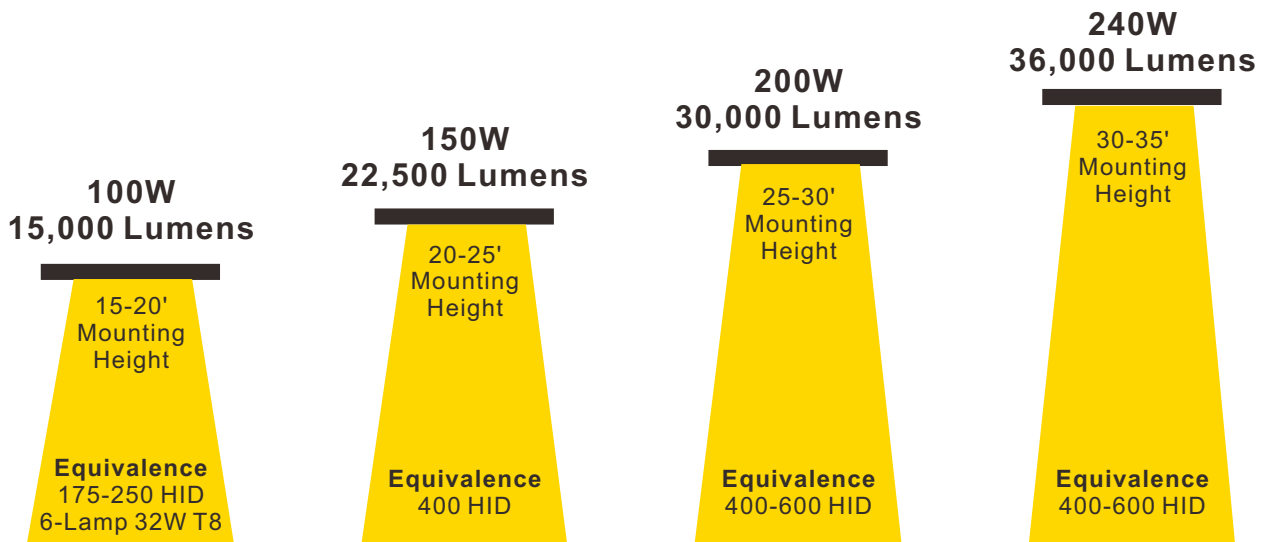

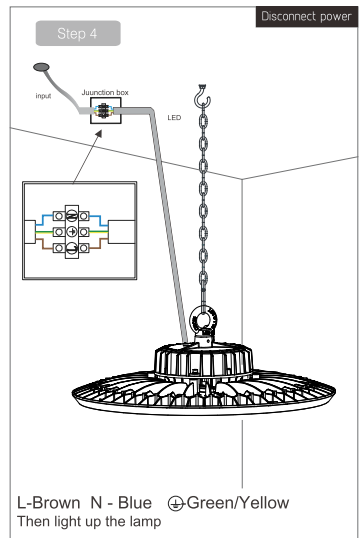
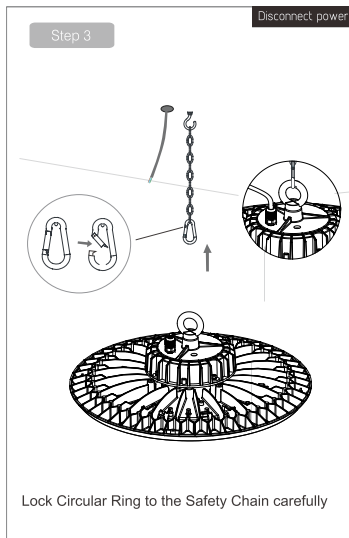
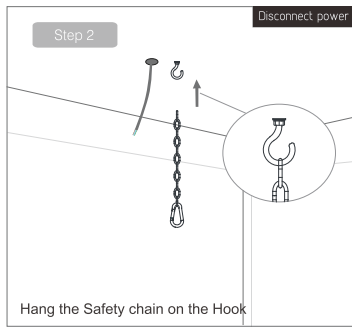
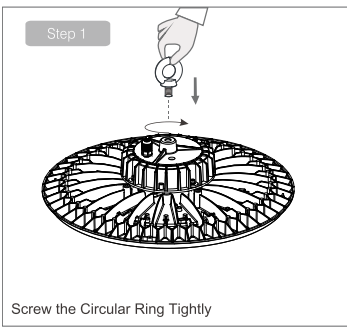

Installation Instruction:

1. Hook hanging Installation



Note:

① AC 100-277V
Cable

L	Brown	
N	Blue	
⊕	Green / Yellow	

Warning

- Please make sure the power off before operation