

USER GUIDE

PULSE MINI

SPEAKER



iTECHWORLD
THE POWER EXPERT

CONTENTS

1.	Overview	3
	Key Features	3
	Package Contents	3
	Unit Diagram	4
2.	Operation	5
	Powering On	5
	Button Functions	6
	Track Selection	7
	Mode Switching	7
	Surround Sound	8
3.	Charging Time & Power Display	8
	LED Status Indicator	9
4.	Specifications	10
5.	Troubleshooting	10
6.	Maintenance	11
7.	Safety Precautions	11
8.	Contact Us	Back Page

OVERVIEW

Introducing the iTechworld Pulse Mini speaker, designed specifically for Australia with cutting edge audio technology. Thanks to its thoughtful design, this portable speaker delivers exceptional sound quality, crystal clear highs and deep bass. Built for portability without compromising quality, it's ideal for outdoor adventures, camping trips or any situation requiring quality sound in a compact, rugged form. Its durable construction ensures it can withstand harsh environments, providing reliable, immersive audio wherever you go.

KEY FEATURES:

- IP67 water and dustproof rating
- Immersive high fidelity audio
- Surround sound capabilities
- Bluetooth device connectivity
- 360° RGB light show
- Over 8 hours of runtime
- Deep bass in all directions

PACKAGE CONTENTS

 <p>Pulse Mini</p>	 <p>USB - USB-C Cable</p>
--	--

UNIT DIAGRAM:

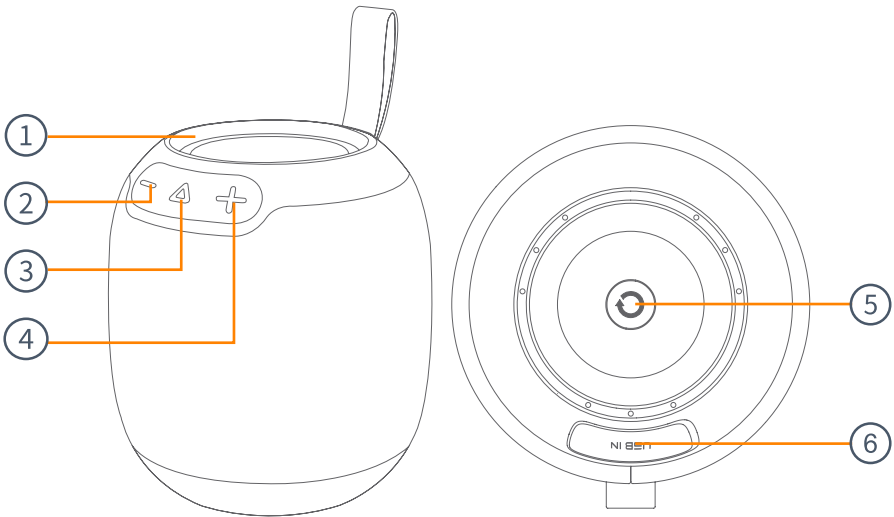

- ① RGB LIGHT
- ② VOLUME DOWN BUTTON
- ③ POWER CONTROL BUTTON





- ④ VOLUME UP BUTTON
- ⑤ MODE SWITCH BUTTON
- ⑥ USB-C INPUT PORT

OPERATION

POWERING ON

1. Press the power control button located between the volume buttons on the speaker for 2 seconds to turn it on. Then, press and hold to turn the speaker off.
2. The first time the speaker is used, the blue light will flash, indicating that it has entered Bluetooth pairing mode. Select "iTW Pulse Mini" from your device's Bluetooth list. A sound will play when a connection is successfully established, and the blue light will stay on.
3. To disconnect your device from the speaker, press the button on the bottom of the unit three times.

BUTTON FUNCTIONS

Icon	Function
	Press the button to reduce the volume.
	Hold the button to select the previous track
	Hold the button to power the unit on or off
	Press the button to play/pause/pick or hang up a call
	Press the button twice to reject a call or switch between sound modes
	Press the button to increase the volume
	Hold the button to select the next track.
	Press the button to turn on the light, switch between modes and turn it off
	Press the button twice to connect or disconnect TWS
	Press the button three times to disconnect the current Bluetooth connection

TRACK SELECTION

To select the next or previous track, hold the corresponding — or +. To pause or resume playback, press **Δ**.

MODE SWITCHING

With a device connected, press the **○** button located at the bottom of the unit to switch between lighting modes.

If the speaker is connected to Bluetooth, it will automatically enter hands-free mode when an incoming call comes in.

1. To reject a call, press the **Δ** twice.
2. While on a call in hands-free mode, press the **Δ** twice to switch audio back to your device.

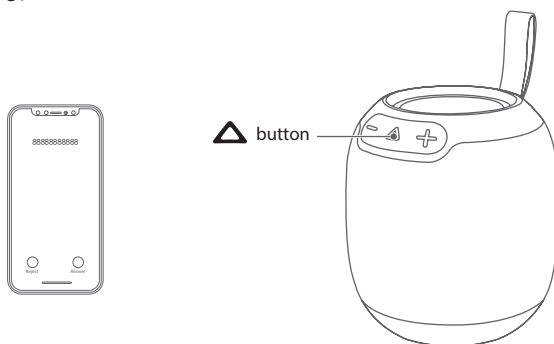

The unit supports two separate sound modes:

Balanced: Delivers an even mix of deep bass, clear vocals and crisp treble for all around listening.

High fidelity: Emphasises clarity with a treble boost and refined high-frequencies for crisp vocals and detailed sound.

Press the **Δ** button twice to switch between sound modes.

NOTE: The default setting is balanced.

SURROUND SOUND

This speaker supports True Wireless Stereo (TWS). TWS lets you wirelessly pair two speakers for surround sound, with no cables between them, via Bluetooth. To initiate TWS connection, simultaneously press the **Δ** buttons twice on the bottom of the two units you wish to connect together. A sound will play when a connection is successfully established.

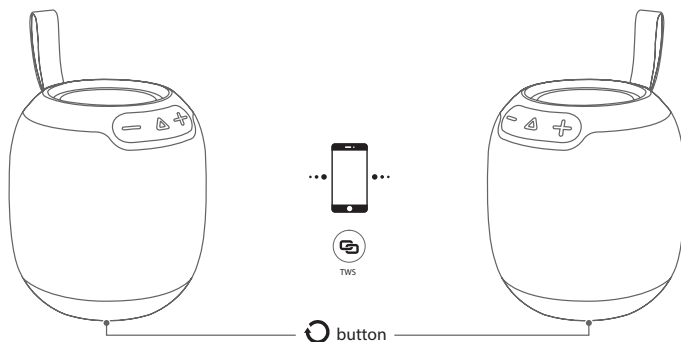

CHARGING TIME & POWER DISPLAY

Using the included 5V/1.5A adapter, the speaker will take around 3 hours to go from 0% to 100%. The device has four charge LED indicators that allow you to monitor the state of charge.

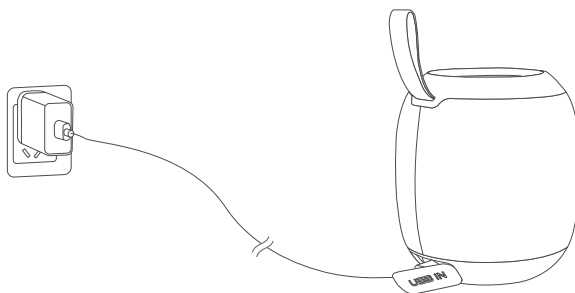

NOTE: The unit will automatically turn off after 10 minutes if no device is connected.

LED STATUS INDICATOR:



Charging Indicators	
State of Charge	LED
Full charge	Off
Charging	Constant red
Low battery warning	Flashing red
Bluetooth pairing	Flashing blue

Lighting Modes	
RGB Selection	LED
Mode 1	RGB Gradient
Mode 2	RGB Slow Fade
Mode 3	Sound Responsive
Mode 4	Colour Cycle
Off	N/A

SPECIFICATIONS

General	
Model Name:	iTechworld Pulse Mini
Dimensions (LxWxH):	95 x 95 x 105mm
Weight:	394g
Bluetooth Version:	5.3
Battery Capacity:	3.7V/3000mAh
Operation Time:	5-6 hours (50% volume, LED on) 8-9 hours (50% volume, LED off)
Talking Time:	7-8 hours
Charging Time:	3 hours
Charging Current:	5V/1.5A
Output Power:	2 x 8W
Operating Temperature:	0°C ~ 40°C

TROUBLE SHOOTING

Fault	Explanation	Solution
The unit is not charging	Using an incompatible or poor-quality charging cable.	All common 5V USB chargers can be used, however, the cable included is recommended.
Odd noises or dropouts	The unit is either out of range or there is an obstruction in the way.	The speaker's Bluetooth range is 10m with nothing in its way. Ensure you remain within these parameters.
Won't pair with previously paired device	Sometimes Bluetooth signals miscommunicate.	Forget the speaker from the device's Bluetooth device list and try pairing again.
The unit does not turn on	Battery is depleted or requires a reset.	Recharge the unit using an appropriate power source. Failing that, hold the Δ button down for 10-30 seconds to reset the unit.

MAINTENANCE

Your iTechworld speaker comes ready to use. If the unit becomes excessively dirty, we suggest using a clean cloth to wipe the exterior. If the unit does get wet, we recommend wiping it with a dry cloth and leaving it to dry. After use in chlorinated or salt water, rinse your speaker thoroughly with fresh water before drying.

- Do not use harsh cleaning chemicals. Only use warm water.
- Ensure the speaker is turned off while cleaning.
- Ensure all charging cables are disconnected before cleaning.

SAFETY PRECAUTIONS

For safety and optimal performance, the iTechworld Pulse Mini must be operated correctly. Please carefully read, understand, and follow all instructions and guidelines in this user guide. Failure to follow these instructions may result in damage to the unit, property, death, or serious injury.

Disclaimer: While iTechworld has taken every precaution to ensure the accuracy of this user guide, it assumes no responsibility for any errors or omissions.

Furthermore, all specifications and functionality are subject to change without notice at any time..

It is best to view our website for the most up-to-date information.

WARNING:

Do not disassemble or modify the speaker. Doing so may cause fire, electric shock, or permanent damage and will void your warranty.

WARNING:

Do not expose the speaker to excessive heat, including direct sunlight, fire, or other heat sources.

WARNING:

Never charge the speaker while it is wet or in a humid environment.

WARNING:

Use only the charging cable and power source specified in this user guide. Using an incompatible charger may result in overheating or battery damage.

WARNING:

Keep the speaker away from young children and pets. Small components or high volume output may pose safety risks.

WARNING:

Do not use the speaker and its accessories to connect equipment if there is a defect.

WARNING:

Do not drop, crush, or puncture the speaker. Avoid any strong physical impact.

HEARING SAFETY:

To prevent hearing damage, avoid listening at high volumes for extended periods. Start at a low volume and gradually increase as needed.

LONG TERM STORAGE:

For long-term storage, discharge the power from full to empty once every three months, and then recharge it back to full. Ensure the power is turned off completely.

iTECHWORLD

THE POWER EXPERT

CONTACT US



1300 483 249



service@itechworld.com.au



www.itechworld.com.au



At iTechworld, we proudly lead the way in pioneering innovative off-grid power and battery solutions that bring cutting-edge technology to adventure seekers, remote workers, and outdoor enthusiasts across Australia. Since we began our journey all the way back in 2006, our passion has been to develop high-performance lithium batteries, solar panels, power stations, generators, and battery management systems tailored to caravans, camping, 4WDs, and off-grid living.

We believe in empowering people with reliable, portable, and efficient energy solutions, giving them the power they need—wherever their journey takes them. Our commitment to quality is unwavering, with every product rigorously tested to meet Australian conditions and backed by our knowledgeable power experts.

Driven by innovation, reliability, and sustainability, iTechworld is your trusted partner in power solutions, helping you stay powered anywhere, anytime.

iTechworld. The Power Expert.

LOVE YOUR PULSE MINI SPEAKER? LEAVE A REVIEW

