

SET-UP INSTRUCTIONS

PANORAMIC TV STAND PM-07-70



1

CONTENTS:
x1 Portable TV stand + x1 wheeled bag



2

Align/join the 2 top and bottom profiles together while taking notice that the two orange labels are facing up and on the same side of the profiles. Slide and insert the joining connectors into the top & bottom profiles.

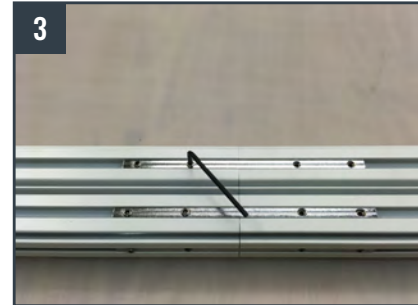

3

Use the allen key provided to tighten & secure the connectors into the profiles. Perform the same process for the connectors on the sides of the profiles. There will be 6 connectors total.



4

The top of the TV stand has 4 TV bracket connection plates. Rotate the profiles so that the TV bracket connection plates are facing the floor.



5

Insert the top corner of the fabric graphic into the correct profile groove as pictured above.



6

Insert a small portion of the fabric graphic and secure the velcro at the bottom of the base of the TV stand profile.





Insert the remainder of the top portion of the fabric graphic in the top profile as pictured above. Insert and push the edges of the fabric graphic down a small portion of the top/back side of the profile.



At the bottom of the profile, secure the velcro portion of the graphic to the velcro on the profile. Insert the remaining length of the fabric graphic into the back of the profiles by pushing down, working your way back up to the top of the profile.



Position the TV bracket and insert the 4 bolts with washers.

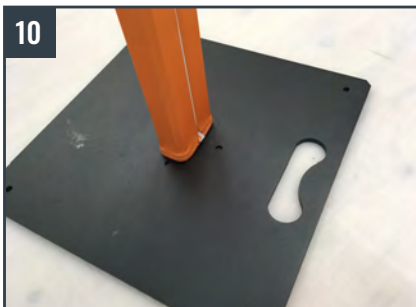

You are now able to place the tv stand upright on the floor.



OPTIONAL - If supplied, attach cord clips to the back of the profile where holes have been made in the fabric graphic.

