

## Complete guide to mirroring on P2000 with an Android phone

### **1. Install M-Link on your Android phone**

To mirroring an Android phone on the P2000, the following M-Link app must be installed on your Android phone.

[Download M-Link here](#)

### **2. Turn off Android Auto (AA) first**

To turn off AA, please go to the “Settings” of your phone and switch off Wi-Fi and Bluetooth respectively. And keep them “Off” throughout the whole process before starting mirroring.

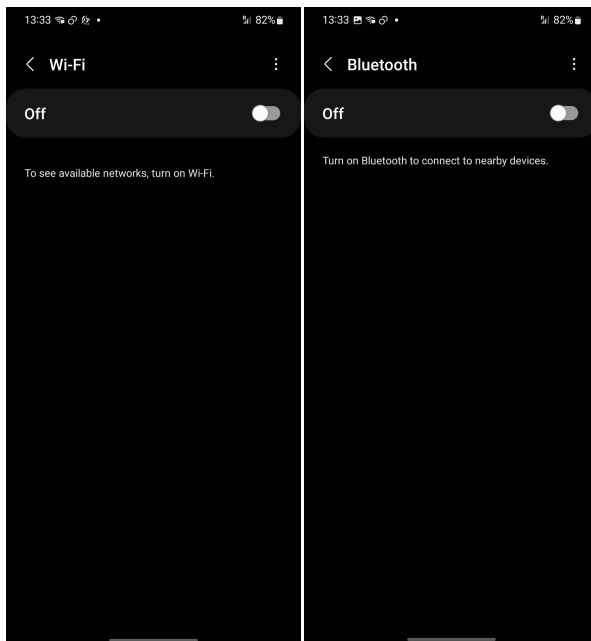

To avoid AA from auto connecting to your phone, please disable “Auto Connect” in the P2000>Bluetooth menu.

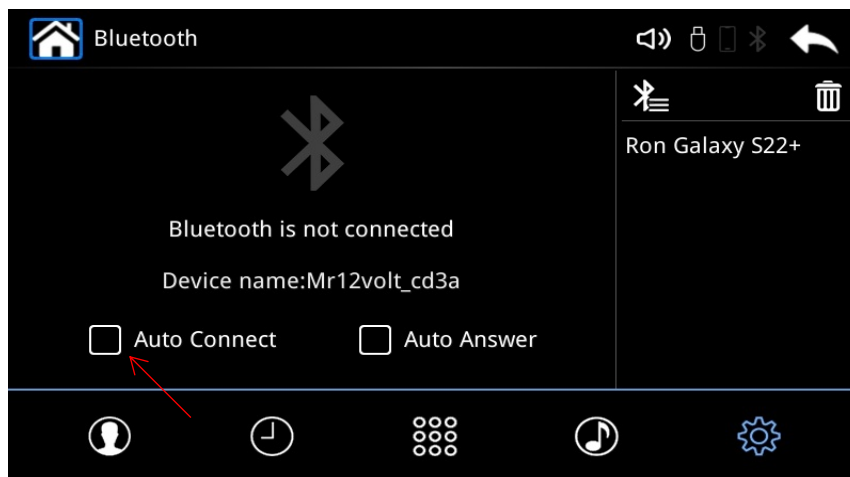

### 3. Preparing the “Hotspot” on your phone

To create a “Hotspot” on your phone, you will first need to obtain the SSID and Password (PSK) from the P200 at P2000>Mirroring>

Enable “Android”

In this case the SSID is **link\_2286** and the password is **b04a6af4**

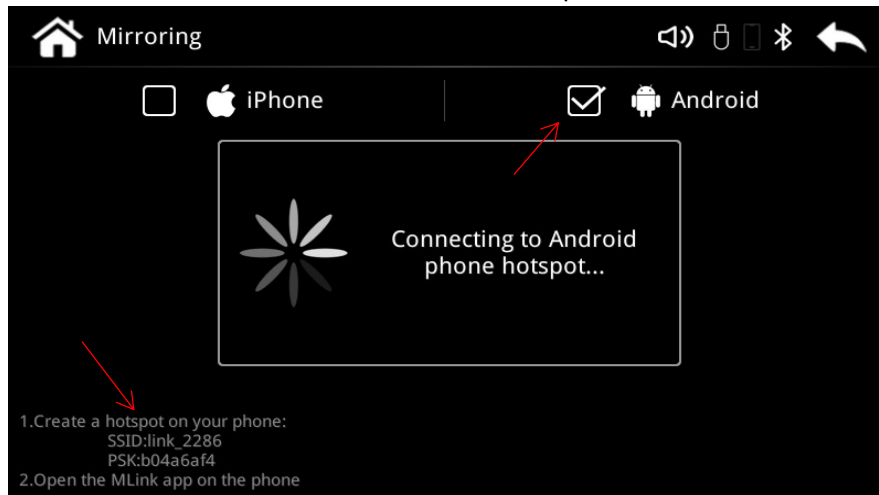

Go to Settings>Hotspot on your phone, and create a “Hotspot” with the SSID and Password given in the P2000

It is very important to input the SSID and Password with an English only keyboard

And 5GHz band must be enabled

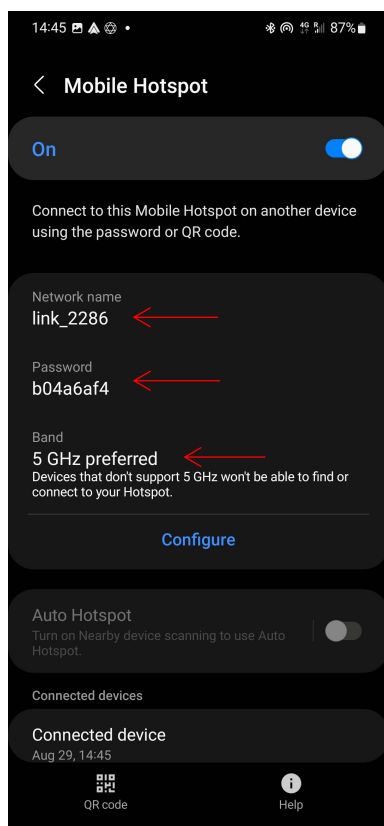

#### 4. Start mirroring from Android phone to P2000

On P2000 go to P2000>Mirroring

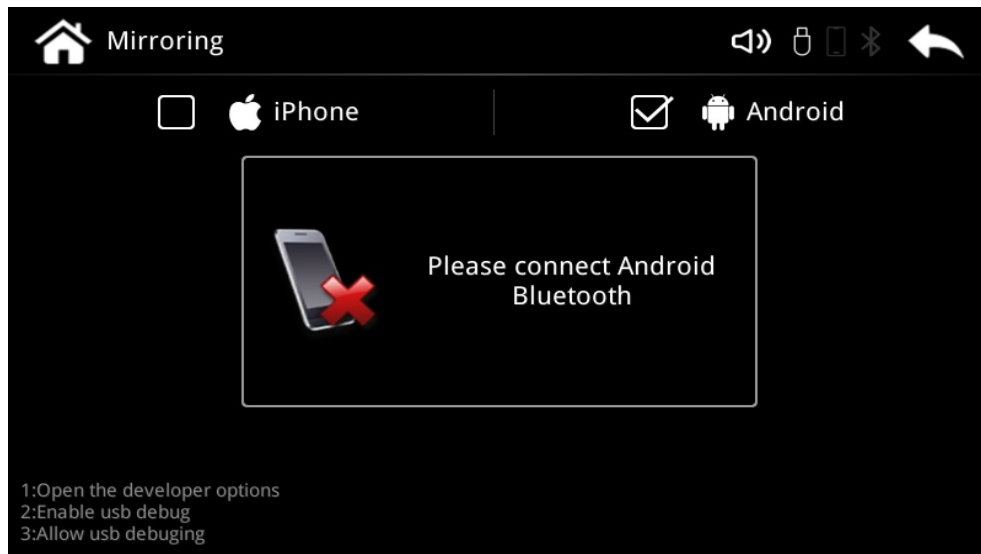

Start M-Link app on your phone

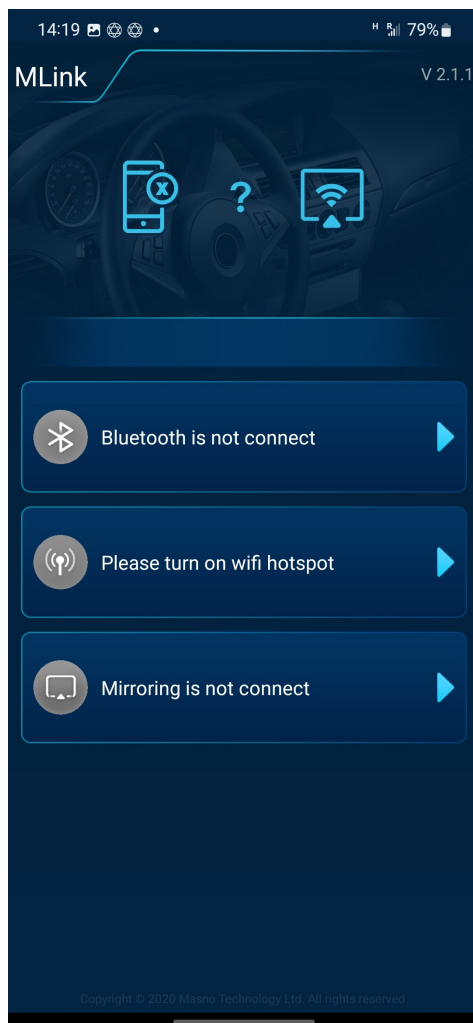

Turn on “Hotspot” first

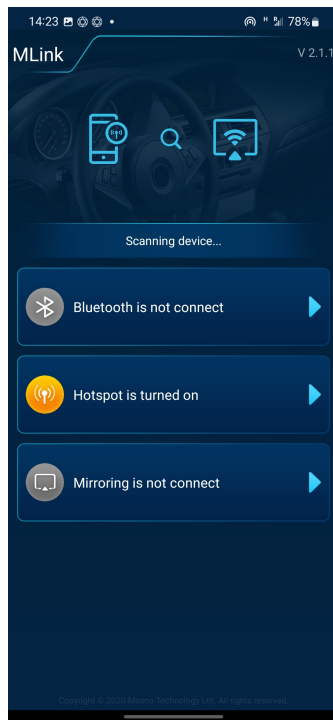

And then turn on “Bluetooth”  
(you may be prompted to pair Bluetooth again, hit “Pair” )

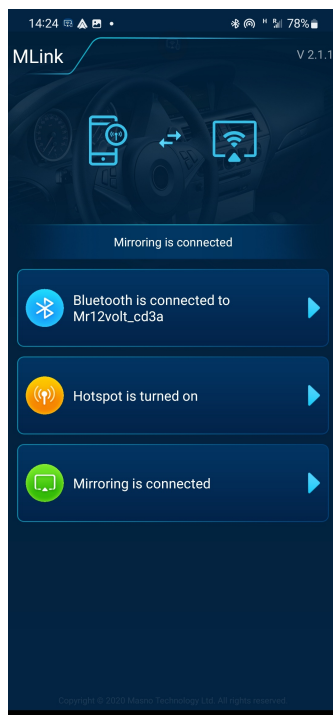

You will notice the P2000 showing “Connecting to Android phone hotspot...”

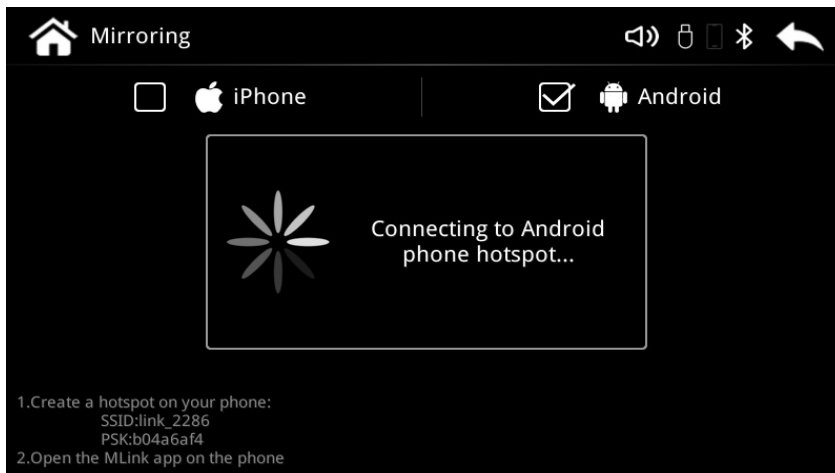

And in a short moment, mirroring will start.

