

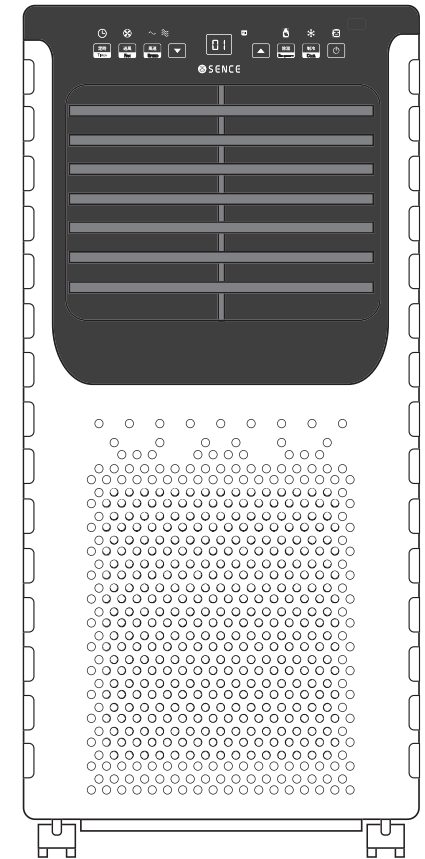

使用說明書 USER MANUAL

移動冷氣機(淨冷型)
PORTABLE AIR CONDITIONER
(COOLING)

PC-070WB



- 在使用之前請詳細閱讀「使用說明書」及「保用條款」，並妥為保存。
- Please read these instructions and warranty information carefully before use and keep them handy for future reference.

目錄

1. 注意事項	3
2. 產品功能和結構	4
3. 安裝說明	5
4. 操作說明	7
5. 排水說明	9
6. 維護保養	10
7. 故障排除	11
8. 技術規格	12
9. 產品保養須知及保養範圍	13

感謝您選擇這款移動空調。請妥善保存好說明書以便以後查閱，使用前請仔細閱讀使用說明書。

1. 注意事項

- 1) 本產品只適合室內使用，請勿將本機放置於潮濕環境下使用，如浴室或室外。
- 2) 所有電線接線必須符合當地及國家的用電規程，並由合資格的技術人員安裝。如你對以下說明書有任何疑問，請聯繫合資格技術人員。
- 3) 為確保用電安全，本機必須完全接地並與匹配的插座配合使用。如果你不確定家裡牆上的插頭是否有效接地，請諮詢技術人員。如果電源線出現損壞，應聯繫生產商，當地經銷商或相關合資格人士進行更換。
- 4) 本設備不適宜讓（包括兒童）身體、感官、心理能力欠佳人士或缺乏經驗和知識的人士使用。除非有負責他們安全的人員監護或指示下才可使用有關設備。
- 5) 兒童應受到監督以確保不會玩弄本設備。
- 6) 為了避免可能造成傷害用戶或損壞財產，請遵守所有的書面解釋。製造商不會因有缺陷或不足的安裝所造成的意外及傷而亡負責。
- 7) 請勿接近氣體爐具、有易燃氣體的地方、有雨淋或容易被滴水的地方、接近殺蟲劑的地方、油性的腐蝕性溶劑附近、高溫的地方、潮濕的地方、在化學品、多油、多塵的地方使用。請勿把本機直接暴露於太陽底下。
- 8) 請勿使用萬能插蘇或拖板與其他電器共用一個插座。
- 9) 請勿擅自拆卸、維修或組裝本產品，以免造成傷害或財產損失。若發現異常情況，如異常噪音、異味、煙霧、漏電等現象，應立即切斷電源開關，並聯繫製造廠商或其服務處或合資格的專業人員更換和維修。
- 10) 請勿在本機上放置物品。
- 11) 請勿遮蓋或堵塞進氣口和排氣口。
- 12) 請將本機置於平坦、乾燥的地方。使用本機時，確保空調處於直立狀態。保持本機與周圍的物件之間有50厘米的距離。確保本機適當地與周圍物件保持最少的空間距離。
- 13) 如長期不使用本機，請把插頭拔離電源。
- 14) 使用本機時應關好門窗。
- 15) 電源線應保持放置妥當以免有人被電源線絆倒。
- 16) 請勿過度用力調整出風口的水平百葉窗以免造成損壞。
- 17) 請勿長時間讓皮膚或眼睛直吹涼風。
- 18) 清潔前確保斷開本機電源，不要拉扯電源線斷電。不要拔下插頭來關機。
- 19) 不可讓本機沾水。手濕時切勿接觸電源插頭。
- 20) 請勿使用汽油或酒精等化學溶劑擦拭清潔本機，而應使用濕布或溫和清潔劑。
- 21) 保持排氣管或排水管完好無折彎情況後才安裝入本機。
- 22) 拆下或安裝過濾網時，請確保本機斷電。
- 23) 在高溫高濕環境下製冷時，建議使用連續排水。
- 24) 本機應在7°C至35°C (44°F and 95°F) 的溫度下使用。

2. 產品功能和結構

感謝你選購本產品。本機為移動冷氣機，具備製冷、除濕、送風功能，外表時尚和機身細小。兩級風速設定、LED顯示器、定時開關機功能和基本空氣過濾並配備搖控器。

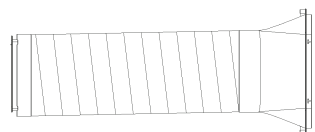
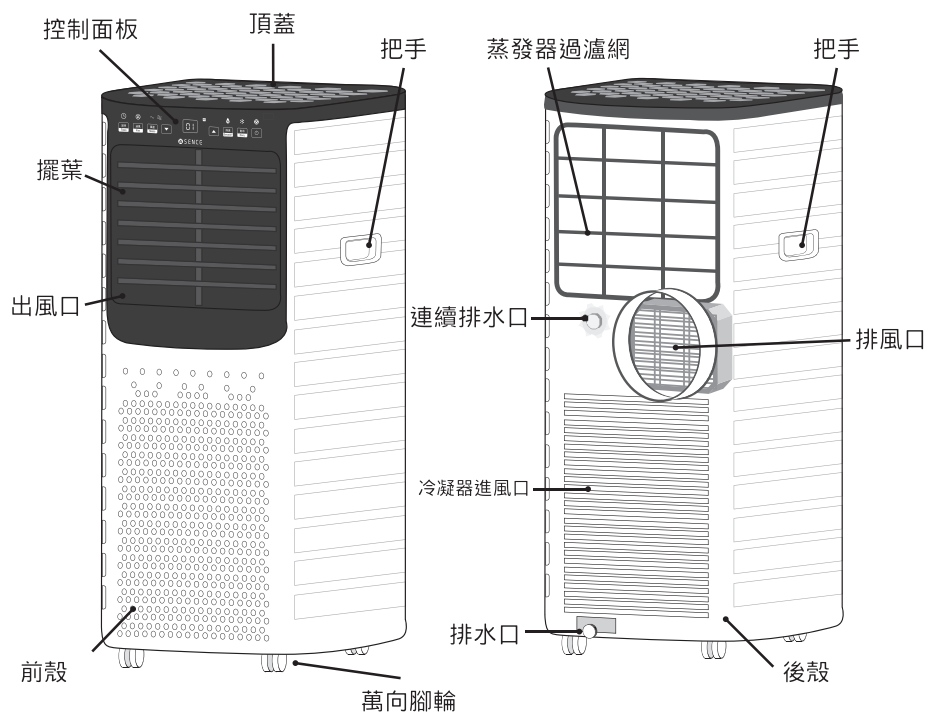

排風管組件



窗戶密封板組件

3. 安裝說明

警告！使用本機前請保持本機直立狀態至少兩小時。

本產品可以在房間內方便移動，在移動期間請確保本機一直處於直立狀態，並且應安放在平坦的地面上。不要在浴室或其他潮濕的地方安裝和使用本產品。

1 排風管組件的安裝

(如圖 1) 將排風管組件 (排風接頭端) 插入後面排氣口卡槽 (向左推進)。



圖 1

2 窗戶密封板組件的安裝

- 半開窗戶，將窗戶密封板組件安放到窗戶上，(如圖2，圖3)，組件可以水平和垂直放置。
- 拉開窗戶密封板組件的各部件，調整拉開的距離，使組件兩端接觸到窗戶邊框，固定組件的各部件。

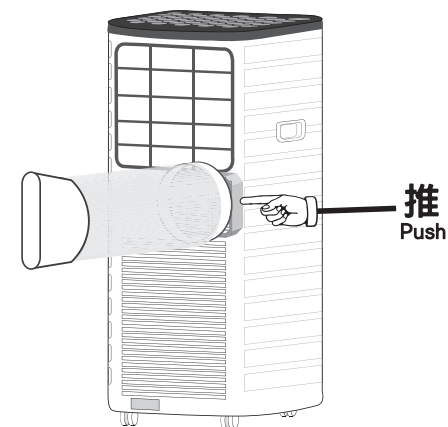

圖2



圖3

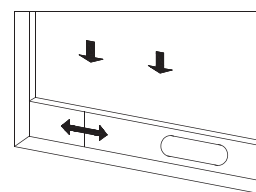

3 機體的安裝

- a). 將安裝好排風管與接頭的機器移動到窗戶前，機體離牆面或其他物體的距離至少在50cm。(如圖4)

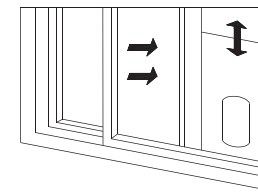

圖4

- b). 將排風管拉長，將排風管接頭的扁形端卡入窗戶密封板組件的橢圓孔內。(如圖5、圖6)

注：1、排風管接頭的扁形端一定要卡到位。

- 2、排風管不能打折，不能有大幅度(大於45°角度)的轉折，要保持排風管的通風順暢。

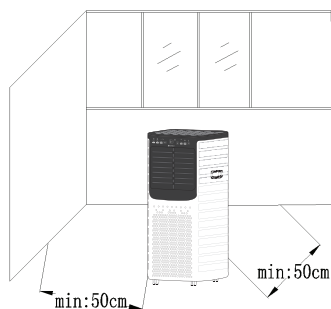

圖5



圖6

重要提示

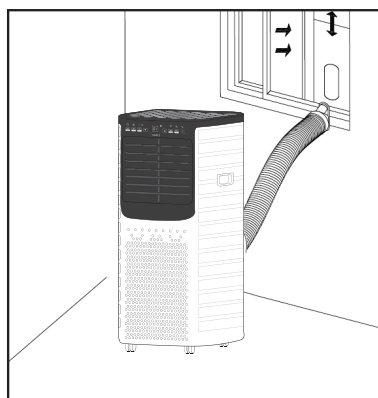
排風軟管長度在280mm到1500mm 之間，此長度是根據機體的規格特定的。不要使用加長的管子或用其它不同的軟管代替，這樣可能會引起故障。排風管必須通暢，如有阻滯可能會造成機體過熱。

4. 操作說明

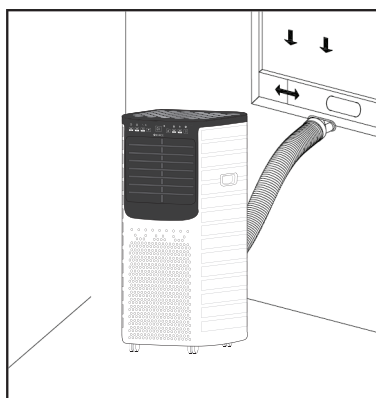
控制面板：

操作介面如下：

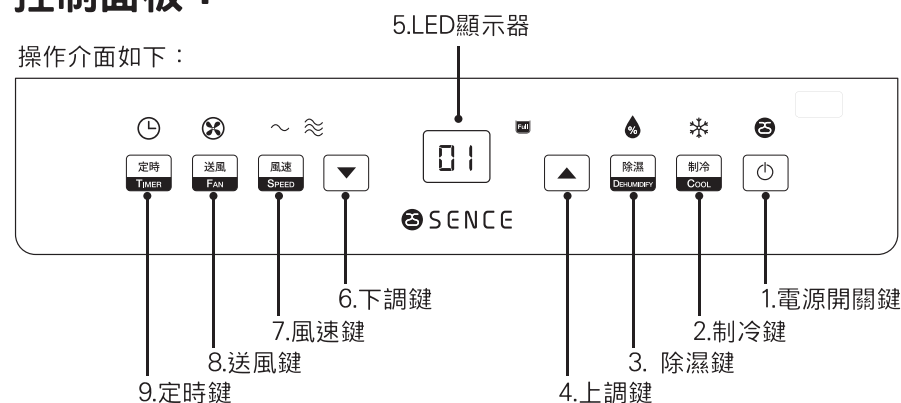

1. 電源開關鍵	按此鍵開啟和關閉本機。接通電源後紅色指示燈亮起，機器進入待機狀態；按下電源鍵開機，綠色指示燈亮起，機器發出「吽」一聲；在開機狀態時，按下電源鍵開機，紅色指示燈亮起，機器發出「吽」一聲進入待機狀態。
2. 製冷鍵	開機後按此鍵開始製冷模式。* 指示燈亮起。
3. 除濕鍵	開機後按此鍵開始除濕模式。% 指示燈亮起。
4. 上調鍵	按此鍵上調溫度或定時設定值。
5. LED顯示器	顯示當前出風口的溫度、溫度設定值或時間設定值。
6. 下調鍵	按此鍵下調溫度或定時設定值。
7. 風速鍵	按此鍵調校兩級風速設定。~ ≈ 指示燈亮起。
8. 送風鍵	開機後按此鍵開始送風模式。⊗ 指示燈亮起。
9. 定時鍵	本機正在運作時，按此鍵⌚ 指示燈亮起即可設定時間，再每按上調鍵或下調鍵可增減1小時。可設定時間由1至24小時，到時後本機將會停止運作。 本機待機狀態時，按此鍵⌚ 指示燈亮起即可設定時間，再每按上調鍵或下調鍵可增減1小時。可設定時間由1至24小時；設好時間後再按「製冷」、「除濕」或「送風」設定模式，到時後本機將依設定啟動運作。

遙控器操作說明

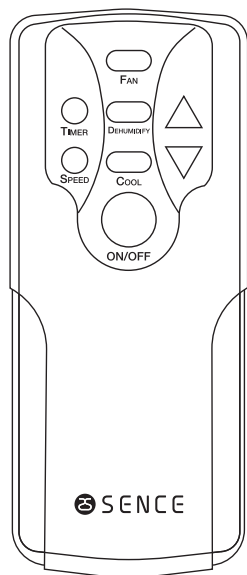

1. 電源開關鍵	按此鍵ON/OFF可進行開關本機。
2. 製冷鍵	開機後按此鍵COOL開始製冷模式。
3. 除濕鍵	開機後按此鍵DEHUMIDIFY開始除濕模式。
4. 上調鍵。	按此鍵△上調溫度或定時設定值。
5. 下調鍵。	按此鍵▽下調溫度或定時設定值。
6. 風速鍵。	按此鍵SPEED調校兩級風速設定。
7. 送風鍵	開機後按此鍵FAN開始送風模式。
8. 定時鍵。	按此鍵 TIMER 設定開機或關機時間。

其他功能

1. 記憶功能：

本機未斷電時會記住上次關機前的設定(模式、風速、設定溫度), 定時不記憶。當拔出插頭斷電後記憶會被清除。接電開機會按初始設定溫度26°C、製冷模式和低檔風速運行。

2. 防霜凍保護功能：

在製冷模式, 若管溫感測器偵測溫度過低時, 本機會自動進入防霜凍保護狀態; 若管溫感測器偵測回升溫度後, 本機會解除防霜凍保護回復正常運作。

3. 滿水提醒功能：

當機內水箱的水到達警戒線時會發出警報, **Full** 指示燈亮起。請關機並將本機出水口接上排水管將水排出。(詳情參見“排水說明”)完成後重新開機。

4. 壓縮機保護功能

壓縮機停止運作後需要3分鐘才能重啟以保護壓縮機的壽命。

5. 排水說明

1. 手動排水：

- 1) 本機水滿後停機, 請先關機, 拔出電源插頭。
注意！請小心移動本機, 以免機內水箱的水溢出。

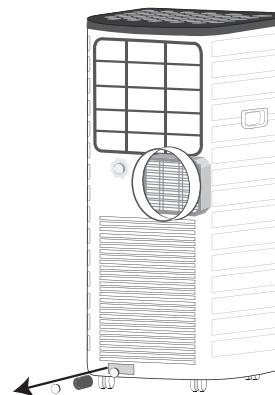

- 2) 將盛水容器放在機體後側排水口的下方。
- 3) 扭開排水口的放水蓋, 拔出水塞, 水會自動流入盛水容器裡。

注意！

- a) 排水時可將機體稍微向後傾側。
- b) 盛水容器將滿前, 盡快將水塞塞住出水口, 避免水流到地面或地毯上。

- 4) 當排水完成後, 重新裝好水塞和扭緊放水蓋。
注意！重新安裝好水塞和放水蓋後才可啟動本機。

2. 連續排水(只適用於製冷模式下)：

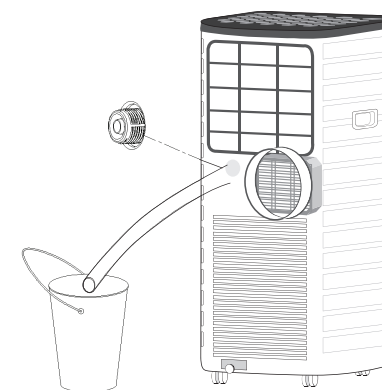

- a) 扭開連續排水口的放水蓋, 拔出水塞。
- b) 將排水管套入出水口。
- c) 將排水管連接水桶。(如圖)



6. 維護保養

清洗：清洗和維護前請關閉本機，拔出電源插頭。

1. 清洗表面

用潮濕的軟布清洗本機表面，勿用化學試劑，如苯，酒精，汽油等。否則空調表面會受損，甚至全機受損。

2. 過濾網的清洗

如果過濾網被灰塵堵塞，空調功效降低，務請每兩周清洗一次過濾網。

拆除固定螺絲網

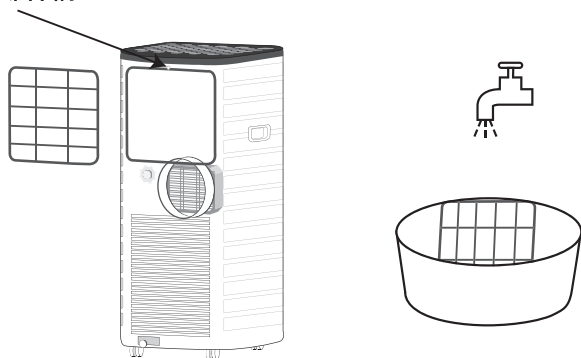

2.1：上過濾網框的清洗

- 1) 用螺絲刀擰開蒸發器過濾網與後殼固定的1顆螺絲，取出蒸發器過濾網。(如上圖)
- 2) 將蒸發器過濾網放入已加入中性洗滌劑的溫水（約40°C/104°F水溫）清洗乾淨，漂洗乾淨後在陰涼處晾乾。

換季後妥善收納保存：

- 1 旋開放水蓋，拔出水塞，將機內水箱的水排出至其他的盛水容器中，或直接傾斜機身將水完全排出至盛水容器中。
- 2 開啟本機並選「送風」模式的低風狀態，維持半天直至導管變乾以防止發霉。
- 3 關機及拔出電源插頭，將電源線收好；重新裝上水塞和放水蓋。
- 4 拆除排風管並妥善保管。
- 5 用塑膠袋套上本機，並放置於乾燥處和做好防塵措施。避免孩童接觸。
- 6 取出遙控器的電池並妥善保管。

注意！確保機體置於乾燥處，所有本機的附件要妥善收納存放。

7. 故障排除

不要自行修理或拆卸本機，不合格的修理將導致產品維修保養服務失效，並可能對使用者或其財產造成損害。

問題	原因	解決方法
空調機不運作	機身沒有連接電源。	接到有電的插座上後開機。
	水滿指示圖示點亮。	排掉內部貯水。
	環境溫度過低或過高。	建議在7-35°C(44°F-95°F)間使用本機器。
	製冷模式下房間溫度低於設定溫度。	改變設定溫度。
	除濕模式下環境溫度偏低。	放在環境大於17°C(62°F)的房間。
製冷效果不好	有陽光直射。	拉上窗簾。
	門窗打開，人較多或在製冷模式下有其它熱源。	增添製冷設備。
	過濾網很髒。	清洗或更換過濾網。
	進風口或出風口被堵塞。	清除障礙物。
	排風管彎折。	拉直排風管。
噪音大	機體未有放平。	將機體放在平坦堅硬處。(可減少噪音)
壓縮機不工作	過熱保護啟動。	等3分鐘直到溫度降下後再開機。
遙控器不工作	距離太遠。	讓遙控器靠近機體，確保正對機身上的遙控接收器。
	遙控器未對準遙控器接收頭方向。	
	電池沒電。	更換電池。
顯示E1	室溫感測器感知溫度異常。	請聯絡人員維修。
顯示E2	管溫感測器感知溫度異常。	



8. 技術規格

產品名稱	移動冷氣機
產品型號	PC-070WB
電壓 / 頻率	220-240~50Hz
額定功率	760W
製冷能力	7000BTU/h
製冷劑	R410A/310g
除濕量	20公升/日
風量	280m ³ /h



處理：勿將已廢棄的本產品與其他未經分類的廢棄物放置在一起。此種廢棄物應當單獨放置以備其他特殊用途。

9. 產品保養須知及保養範圍

- 本產品的保用期限自購買日開始計算，提供1年產品自攜維修保養。客戶必須自行保留購買收據及產品盒標籤以作紀錄。
- 本公司保養服務包括在保養期內正常使用情況下之零件故障，如因所須零件停產、缺貨或其他原因導致無法維修或即時更換，本公司有權以同級相近之產品代替。

基於以下條件，本產品將不獲保修

- 客戶未能提供產品有效購買發票/收據
- 機身編號曾被塗改、損毀或撕除。
- 產品曾被非本公司技術人員改裝、調較、修理或拆開檢查。
- 基於任何原因(包括意外)，人為損毀、跌撞、不正當之安裝或操作所造成之損壞。
- 因不可抗力造成損壞的，如火災、水災、地震、雷擊、颱風等自然災害。
- 所須零件停產、缺貨或其他原因導致無法維修
同時，本公司不負責承擔因本產品之品質問題所造成的其他間接損失、
- 花費及其它附帶損害，包括但不限於資訊遺失，預期利益損失等等。
- 產品存放在高溫或潮濕的位置、或經浸沒在水中所造成的損壞。

如有任何爭議，本公司保留最終決定權。

Content

1. Precautions	15
2. Product Feature and Structure	16
3. Installation Instructions	17
4. Operating Instructions	19
5. Drainage Instructions	21
6. Maintenance	22
7. Troubleshooting	23
8. Technical Specification	24
9. Warranty Coverage	25

Thank you for choosing the luxurious and elegant Portable Air Conditioner. Please read the manual carefully before use and keep the manual for further review.

1. Precautions

- 1.) The appliance is designed for domestic use only. Do not install or operate this air-conditioner in bathroom or other wet environments.
- 2.) The wiring must comply with local and national electrical codes and be installed by a qualified electrician. If you have any questions regarding the instructions in this manual, contact a qualified electrician.
- 3.) For your safety, this unit is grounded through the power cord plug when plugging into a matching wall outlet. If you are not sure whether the wall outlet in your home are properly grounded, please consult an electrician. If the power cord is damaged, it must be replaced by the manufacturer, its service agent or similarly qualified person in order to avoid any hazards.
- 4.) This appliance is not intended for use by anyone (including children) with reduced physical, sensory or mental capabilities, or lack of experience and knowledge, unless they have been given supervision or instruction concerning use of the appliance by a person responsible for their safety.
- 5.) Children should be supervised to ensure that they do not play with the appliance.
- 6.) To avoid injury to users or damage properties, please follow all the instructions written in this manual. The manufacturer is not responsible for accidents and injuries caused by defective or deficient installation.
- 7.) Do not use under the following situations: • Near gas cooker • Environment full of inflammable gas • Environment exposed to rain or moisture • Near insecticide • Oil corrosive solvent • High temperature • High humidity • Near chemicals, oil, dust area. Do not expose the unit under direct sun light.
- 8.) Do not use adapters or extension cords and share the socket outlet with other appliances.
- 9.) Never dismantle, repair or modify the unit without authorization to avoid body injury or property damage. If there is anything unusual, like unusual noise, smell, smoke or electric leakage, be sure it repaired by manufacturer or professionals.
- 10.) Do not place any objects on top of the unit.
- 11.) Do not cover or obstruct air inlet or outlet.
- 12.) Please place this unit in an even and dry surface. Make sure the air conditioner stay in upright position during the removal. Keep the unit at least 50cm away from walls or other objects. Ensure proper clearance of this unit including the minimum distance from surrounding objects.
- 13.) Unplug power cord if the unit will not be used for a long time.
- 14.) Make sure windows and doors are closed during usage.
- 15.) Power cord should be placed appropriately to avoid people being tripped over.
- 16.) Do not over push the louver of air outlet to avoid damaging it.
- 17.) Do not expose skin and eyes to the cool breeze directly for a long time.
- 18.) Unplug the appliance before maintenance, never pull the power cord. Do not turn off the appliance by unplugging.
- 19.) Do not contact with water. Never touch the main plug if your hands are wet.
- 20.) Do not wipe the appliance with chemical solvents such as gasoline or alcohol, use wet cloth or mild detergent instead.
- 21.) Make sure the exhaust hose or drain hose are in good condition without flexure when connecting with the unit.
- 22.) Make sure to cut off the power before disassembling or installing the filter.
- 23.) It is recommended in cooling mode with continuous drainage in high temperature and humidity environment.
- 24.) The unit shall be used at a temperature between 7°C and 35°C (44°F and 95°F).

2. Product Feature and Structure

Thank you for purchasing this product. The unit is a portable air conditioner with cooling, dehumidification and fan features. It is a fashionable and compactable design including two wind speed setting, LED display, timer with On/Off function and basic air filtration plus a remote control.

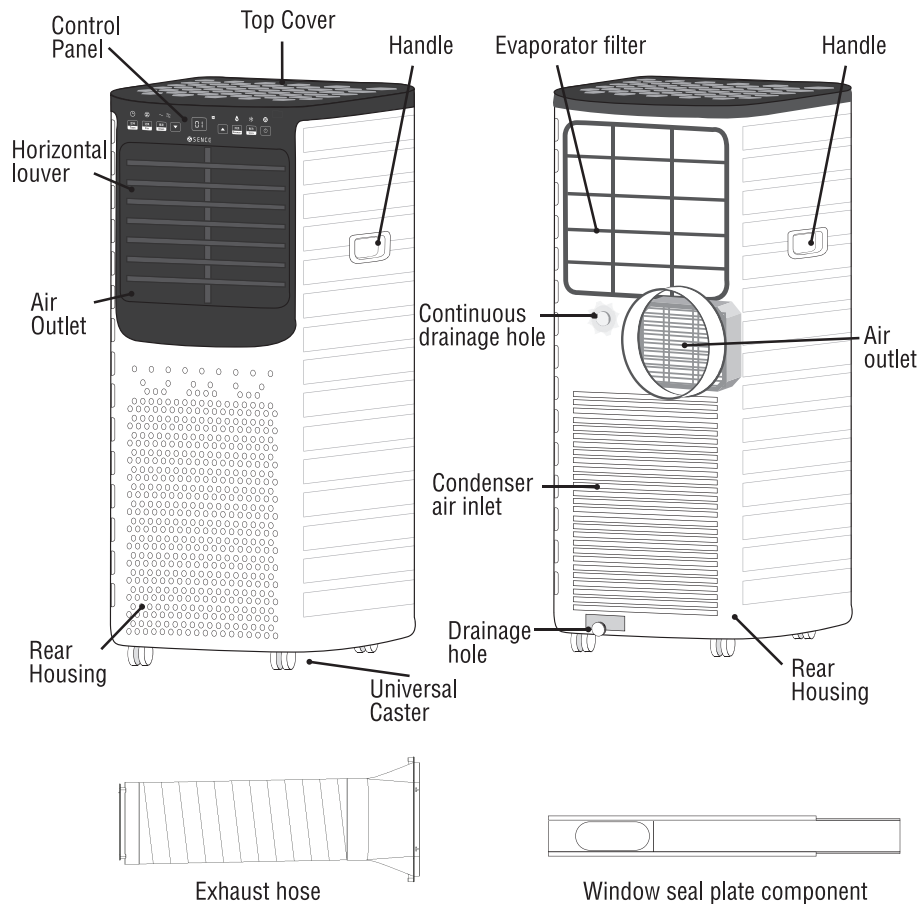

3. Installation Instructions

Warning! Keep the unit in upright position at least 2 hours before using for the first time.

This product can be moved in the room freely. Keep the unit in upright position while moving it. The appliance shall be placed on a flat surface. Do not install or operate this product in bathroom or other wet environments.

1 Installation of the exhaust hose (as shown in Figure 1): Connect the exhaust hose with the air outlet on the back (push on the left).

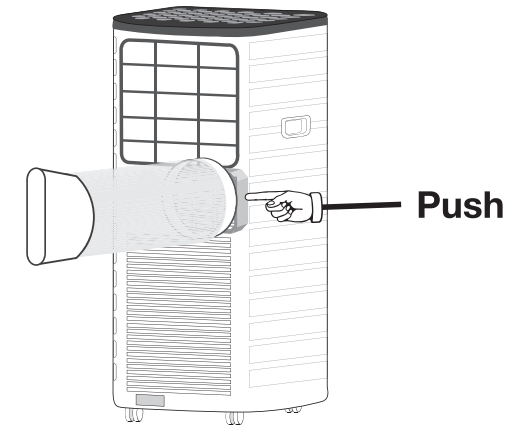

Figure 1

2 Installation of the window seal plate component

- Make the window half open; put the window seal plate component into the window (as shown in Figure 2 and Figure 3), either in vertical or horizontal position.
- Extend the window seal plate parts and adjust it to the length of the window, keep both ends to meet the window edges, fix the window seal plate component.

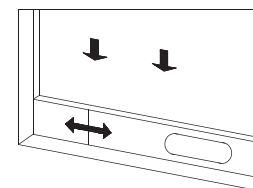

Figure 2

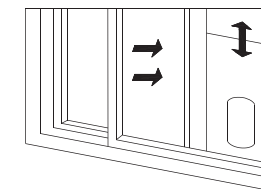

Figure 3



3 Installation of The Unit

a.) Move the unit with the exhaust hose assembly installed in front of the window and keep the unit at least 50cm away from walls or other objects.

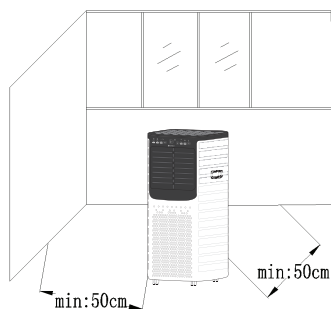

Figure 4

b.) Extend the exhaust hose. Install the elliptical end of exhaust hose assembly into the corresponding elliptical hole in window seal plate assembly (as shown in Figure 5 and Figure 6).

Remark:

- 1.) Slide the adapter downwards and ensure the adapter is installed in good position.
- 2.) Exhaust hose cannot be bent for more than 45°, in order to keep effective ventilation.

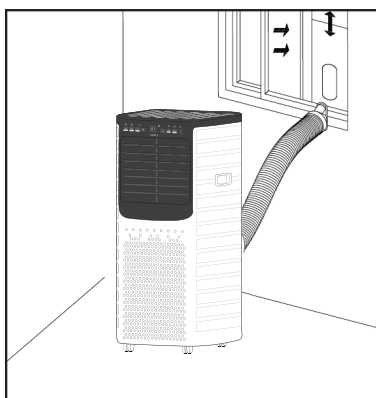

Figure 5

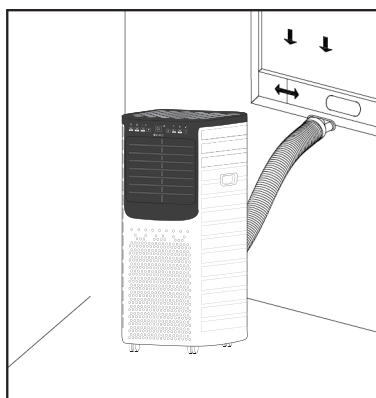

Figure 6







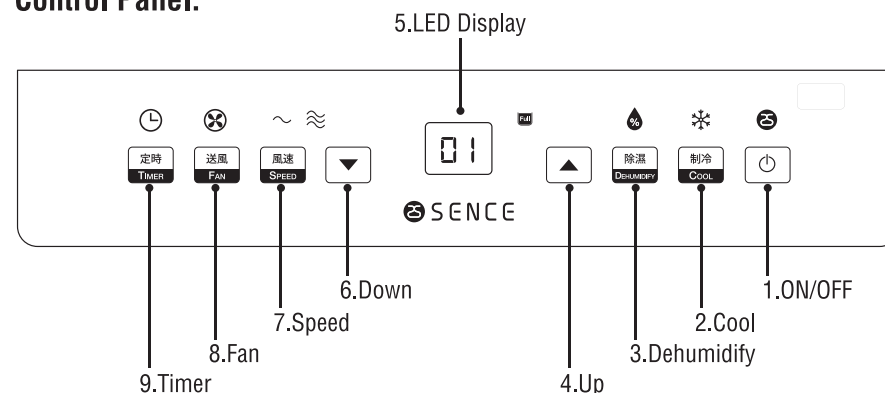

Important Notice

The length of the exhaust hose should be between 280 to 1,500mm which is based on the specifications of the air conditioner. Do not use extended hose or replace it with other different hoses, otherwise it may cause malfunction. Exhaust must be unobstructed; otherwise it may cause overheating.

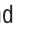
4. Operating Instructions

Control Panel:



1. ON/OFF	Press this button to turn the unit on or off. After plugging, the red indicator  lights up, the unit is in standby mode; Press this button to turn on the unit, the indicator  turns green and you will hear a beep sound ; When the unit is in operation, press this button to turn off the unit, the red indicator  lights up, and you will hear a beep sound confirming the unit has entered standby mode.
2. COOL	Press this button to start the cooling mode. The indicator  lights up.
3. DEHUMIDIFY	Press this button to start the dehumidification mode. The indicator  lights up.
4. Up	Press this button to increase the temperature or time setting.
5. LED Display	Displays the air outlet temperature, temperature setting or time setting.
6. Down	Press this button to decrease the temperature or time setting.
7. SPEED	Press this button to toggle between the 2 wind speed settings. The indicator  lights up.
8. FAN	Press this button to start the fan mode. The indicator  lights up.
9. TIMER	When the unit is in operation, press this button to set the timer, the indicator  lights up. Press the Up or Down buttons to increment an hour each time. Preset timer ranges from 1 to 24 hours. Once the set time is reached, the unit will stop. When the unit is in standby mode, press this button to set the timer, the indicator  lights up. Press Up or Down button to increment an hour each time. It can be set between 1 to 24 hours. Then press COOL, DEHUMIDIFY or FAN button to set the operation mode. Once the set time is reached, the unit will start operation according to the settings.

Remote Control:

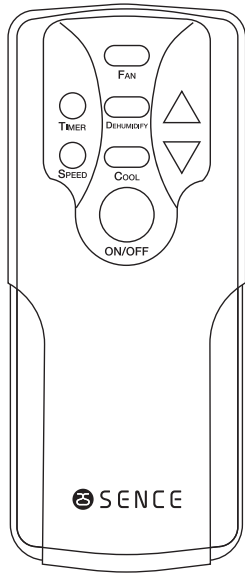

1. ON/OFF	Press this button to switch on or off the unit.
2. COOL	Press this button to start the cooling mode.
3. DEHUMIDIFY	Press this button to start the dehumidification mode.
4. Up	Press this button \triangle to increase the temperature or time setting.
5. Down	Press this button ∇ to decrease the temperature or time setting.
6. SPEED	Press this button to toggle between the 2 wind speeds.
7. FAN	Press this button to start the fan mode.
8. TIMER	Press this button to set the timer for starting up or shutting down the unit.

Multiple protection functions

1. Memory function:

The unit memorizes the settings (mode, wind speed, temperature) before it was switched off. However, Timer settings cannot be memorized. When main plug is pulled out, memories will be deleted. The factor default settings of the unit are 26°C, cooling mode and low wind speed.

2. Frost protection:

In the cooling mode, if the pipe temperature sensor detects low pipe temperature, the unit automatically enters frost protection; if the pipe temperature sensor detects the pipe temperature is restored, the unit will resume normal operation.

3. Water full safety alarm:

When the water in the chassis exceeds its alarm volume level, automatic warning alerts, the water full indicator **Full** lights up. Please switch off and unplug the unit, drain all the water (Refer to "Drainage Instructions" for details.). Connect the power to restart the unit again.

4. Compressor delay protection function:

This unit offers restart protection to compressor. There is 3-minute delay restart protection after compressor is shut down before it can be restart again.

5. Drainage Instructions

1. Manual drainage:

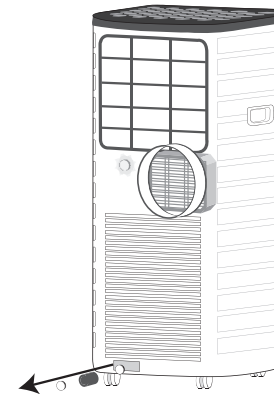

1) Once the unit shuts down upon water-full, turn off the unit and then unplug.

Note! Move the unit carefully to avoid the water spill out.

2) Put a tray below the water outlet at the back of the unit.
3) Screw off the drain cover, unplug the water stopper to let water flow into the tray.

Note!

a) Tilt the unit slightly backwards when draining.

b) Block the drain hole as soon as possible before the tray is full if it cannot hold all water in the unit to prevent the water leakage and wet the floor or carpet.

4) Plug in stopper and screw the drain cover tightly after drainage.

Note! Water stopper and drain cover must be tightly installed, to avoid wetting the floor or carpet when the unit re-starts working.

2. Continuous drainage (for cooling mode only):

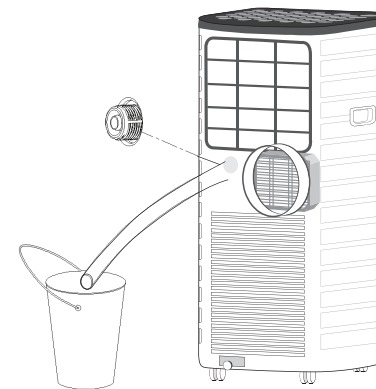

a) Screw off the drain-cover and unplug the water stopper.

b) Connect drain-hole with a drain hose.

c) Pull the drain hose to bucket (as shown in figure).



6. Maintenance

Cleaning: Turn off the machine and unplug the plug before cleaning and maintenance.

1. Clean the surface

Clean with surface of machine with a wet soft cloth. Don't use chemicals, such as benzene, alcohol, gasoline, etc.; otherwise, the surface of the air conditioning will be damaged or even the whole machine will be damaged.

2. Clean the filter screen

If the filter screen is clogged with dust, and the effectiveness of the air conditioning is reduced, be sure to clean the filter screen once in every two weeks.

Retaining screw

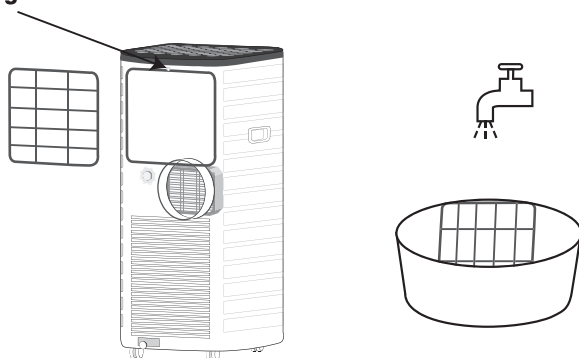

2.1 Cleaning the filtration mesh

- 1) Use screwdriver unscrewed the screw which fixed the filtration mesh and rear shell, then remove the filtration mesh. (Show as above figure)
- 2) Put filtration mesh in warm water with mild detergent (about 40°C/104°F degree) , after cleaning in a cool place to dry.

Off-season Storage::

- 1 Screw off the drain cover and pull out the stopper to drain condensate water completely. Or tilt the unit to drain water.
- 2 Keep unit running in fan mode for half day to dry inside of unit completely to prevent from going moldy.
- 3 Turn off the unit, unplug then wrap the power cord, install the water stopper and drain cover.
- 4 Remove the exhaust hose, clean and keep it properly.
- 5 Cover the unit with dustproof cover, store in a dry place. Keep the unit away from children.
- 6 Take out the batteries from remote control.

**Note! Assure the unit is stored in a dry place.
All accessories of the unit shall be stored together properly.**

7. Troubleshooting

Do not repair or disassemble the product by yourself. Warranty Service shall be automatically cancelled if the Product or any part(s) there are modified, tampered with, altered, converted or repaired in anyway by anybody other than our staff or authorized service providers, and may cause damage to users or their properties

Symptoms	Cause	Solutiont
The unit fails to start up	Power supply failure.	Connect the unit to a live socket and turn it on.
	Water-full and its indicator is on.	Drain the water cumulated in the unit.
	Ambient temperature too low or too high.	It is recommended to use this unit between 7-35°C (44°F-95°F)
	The room temperature is lower than the set temperature in cooling mode.	Change the set temperature.
	Ambient temperature too low in dehumidification mode.	Place the unit in the room temperature above 17°C (62°F).
Bad cooling	The unit is exposed to direct sunlight.	Close the window curtain.
	The doors and windows are open, the room is crowded or there are other heat sources.	Close the door and window, remove other heat sources, and add new air-conditioners.
	Dirty filter.	Clean or replace the filter mesh.
	Air inlet or air outlet blocked.	Remove the obstruction.
	Exhaust hose is clogged	Straighten the exhaust hose.
High noise level	The unit is being placed on uneven surface.	Place the unit on a flat and firm place (may reduce noise).
The compressor does not work	Initiation of overheat protection.	Wait for 3 minutes until the temperature decreases, the unit will restart automatically.
The remote control does not work	Distance too far.	Bring the remote control closer to the unit and ensure aim at signal receptor on unit.
	The remote control wasn't aiming at signal receptor on unit.	
	The batteries are dead.	Replace the batteries.
E1 code display	Room temperature sensor failure. .	Contact customer service & repair center.
E2 code display	Pipe temperature sensor failure.	

8. Technical Specification

Product Name	Portable Air Conditioner
Model	PC-070WB
Rated Voltage / Frequency	220-240~50Hz
Rated Power	760W
Cooling Capacity	7000BTU/h
Refrigerant	R410A/310g
Dehumidifying Capacity	20L/day
Air Flow	280m ³ /h

9. Warranty Coverage

- Warranty coverage started from the date customer purchased the product. Customers should retain their sales receipt and warranty label.
- Warranty would be valid under normal use for the applicable period. If the product cannot be repaired under the conditions of no stock, off production or any other reasons, Service Centre would replace the product with functionally equivalent model.

Exclusions to the warranty

- Customers could not present their sales receipt.
- The serial number has been altered, effaced and / or removed.
- Any modifications, adjustment, repair or disassemble to the products made by a third party or user without the written consent of SENCE.
- Any damage or defect due to misuse, negligence or use not in accordance with the user manual.
- Any damage or defect due to misuse, negligence or use not in accordance with the user manual.
- Limited life components or parts.
- At the same time, SENCE is not liable for any indirect loss, cost, or consequential damages caused by the quality problem of the product, including but not limited to loss of data, expected benefits and etc
- Damage by storing the product in a hot or humid location, or by submerging the product (water, coffee, beverage and etc.)

**In case of any dispute,
SENCE reserves the rights for any final decision.**



Treatment: Don't put the abandoned machine with other unsorted waste together. Such waste shall be placed separately for other special use.