

# SNOOC

LIGHTING CREATOR



## S600F0

A light, a world of possibilities

This full cut-off luminaire is made of a single section. Cast from A356 aluminum alloy with a minimum thickness of 3.2mm (1/8"), the enclosure houses the heat sinks and the converter module.

Our refractor panels, consisting of an array of lenses, offer five types of light distribution, IES classifications I through V. All our panels are precisely configured to maximize light distribution and uniformity. Our prismatic lenses are made of polymethylmethacrylate (PMMA), better known as acrylic or acrylic glass. They are also equipped with a one-piece molded silicone seal that can withstand temperatures above 287°C (550°F), meeting the IP66 standard for protection against dust and water.

# S600F0

## TYPE

1 : I      3 : III      5 : V  
2 : II      4 : IV

## SOURCE

Light-emitting diodes

Power	Color
<b>25W</b>	<b>AK</b> : Amber
<b>30W</b>	<b>3K</b> : 4000K
<b>50W</b>	<b>4K</b> : 3000K
<b>75W</b>	
<b>100W</b>	
<b>150W</b>	

## TYPE OF CONVERTER

**1S** : 120 to 277V, standard  
**5S** : 347 to 480V, standard  
**1D** : 120 to 277V, dimmable (0-10 volts DC)  
**5D** : 347 to 480V, dimmable (0-10 volts DC)

## FINISH

<b>AT</b> : Anthracite	<b>DZ</b> : Textured bronze
<b>BK</b> : Black	<b>FG</b> : Forest green
<b>BZ</b> : Brown	<b>PE</b> : Pewter
<b>DB</b> : Textured black	<b>PG</b> : Pine green
<b>DS</b> : Silver	<b>WH</b> : White
<b>DW</b> : Textured white	<b>XX</b> : On request

## ORDER EXAMPLE

**S600F03 75W4K 1S BK**  
 (S600F0, type III, 75W LED, 4000K, 120 to 277V, converter 100W, Black)

## WARRANTIES

- Lifetime warranty on cast aluminum components.
- 5-year warranty against paint peeling.
- 10-year warranty on LED lighting system and 5-year warranty on converter.
- Replacement parts available for a minimum of 20 years.

All our optical systems have been tested by an independent laboratory according to IESNA LM-79.

The LEDs used in our LED modules meet the IESNA LM-80 standard.

Our fixtures are certified and comply with applicable CSA and UL standards (suitable for wet environments)

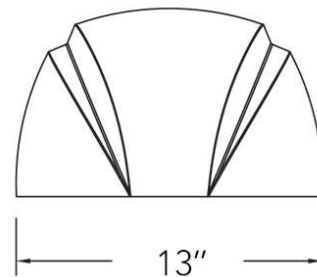
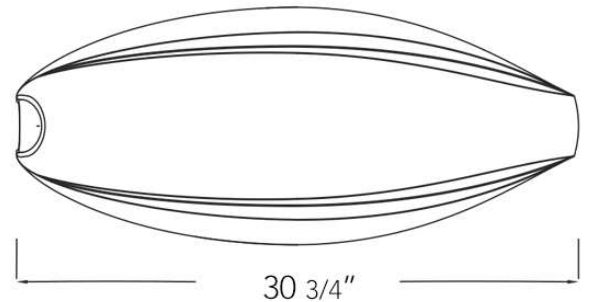
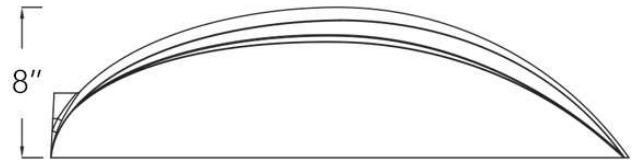

## MOUNTING

Always mounted on a horizontal stud that can be 1 7/8" to 2 3/8" long

Example:

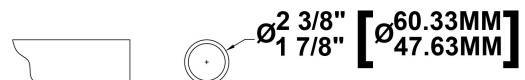

For other options, please refer to your representative