

REVISIONS				
ZONE	REV	DESCRIPTION	DATE	APPROVED

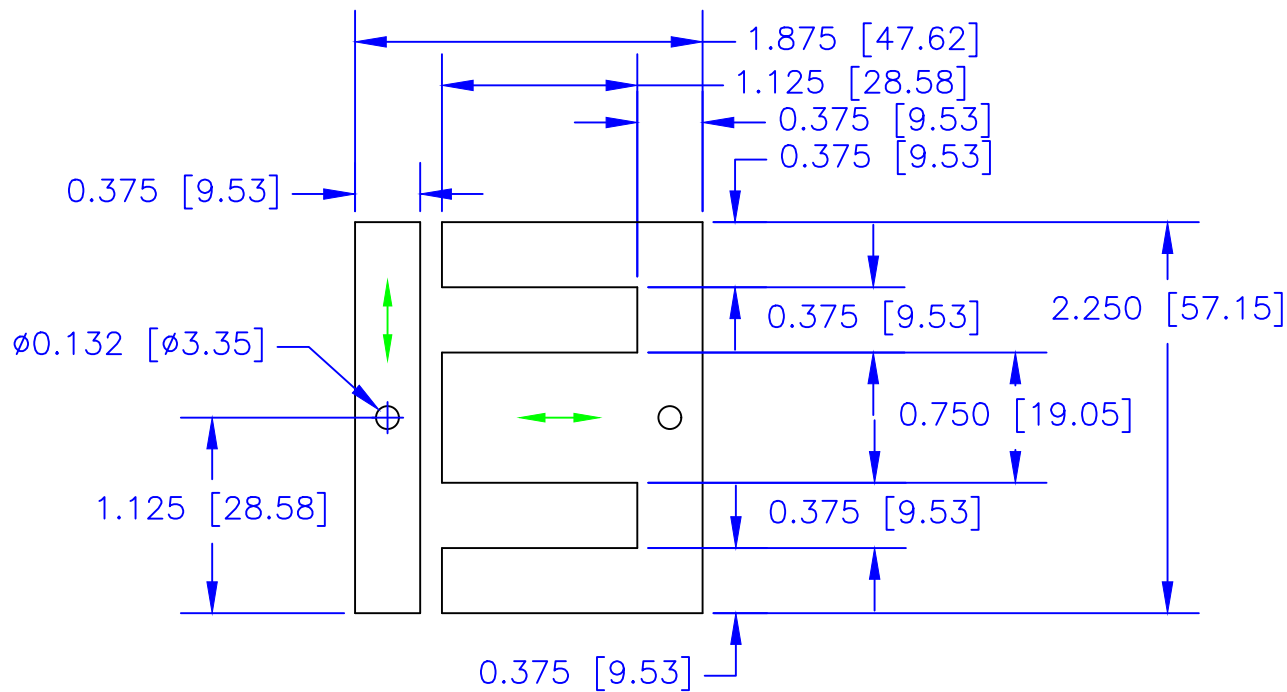

←→ Line grain orientation.

**General Application**

1. Audio amplifiers; current, output, power.
2. Transformers: chokes and saturable reactors.
3. Ferro-resonated regulators.

**Description:** Has directional electrical characteristics.  
Extreme high permeability and low core loss.

DIMENSIONS ARE IN INCHES [MILLIMETERS]. X.XXX = ±0.010 X.XX = ±0.03 ANGLES = ±0.05 UNLESS OTHERWISE SPECIFIED		<b>EDCOR Electronics</b> 7130 National Parks Highway, Carlsbad, NM 88220 Voice: (575) 887-6790 <a href="http://www.edcorusa.com">www.edcorusa.com</a>		
DRAWING BY <b>Brian Weston</b>		Date <b>9/2012</b>		
CHECKED BY <b>Brian Weston</b>		Date <b>9/2012</b>		SIZE <b>A</b>
APPROVED BY <b>Larry Weston</b>		Date <b>9/2012</b>		FSCM NO. DWG NO. <b>20000-EI075</b>
SCALE: 1:1		©2015 EDCOR Electronics		REV SHEET: 1 of 1

**EDCOR Electronics**

7130 National Parks Highway, Carlsbad, NM 88220  
Voice: (575) 887-6790

[www.edcorusa.com](http://www.edcorusa.com)

Single Phase EI-75 steel lamination  
M-6, 29 Gauge - 0.014" [0.355] thick.

SIZE  
**A**

DWG NO.  
**20000-EI075**

SCALE: 1:1

©2015 EDCOR Electronics

SHEET: 1 of 1