

REVISIONS				
ZONE	REV	DESCRIPTION	DATE	APPROVED

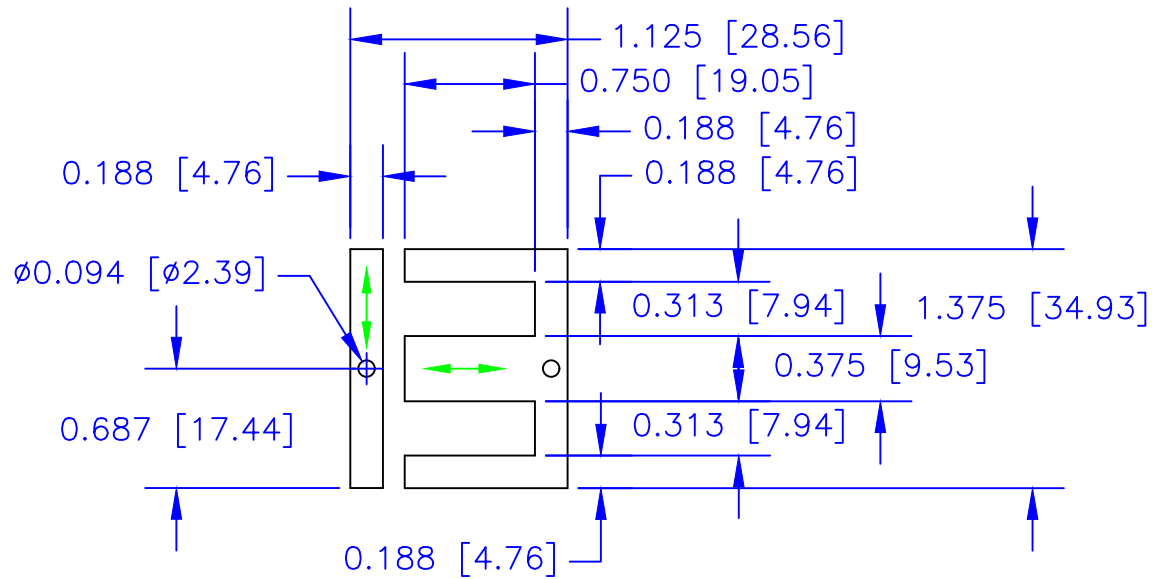

←→ Line grain orientation.

General Application

1. Audio amplifiers; current, output, power.
2. Transformers: chokes and saturable reactors.
3. Ferro-resonated regulators.

Description: Has directional electrical characteristics.
Extreme high permeability and low core loss.

DIMENSIONS ARE IN INCHES [MILLIMETERS]. X.XXX = ±0.010 X.XX = ±0.03 ANGLES = ±0.05 UNLESS OTHERWISE SPECIFIED		EDCOR Electronics 7130 National Parks Highway, Carlsbad, NM 88220 Voice: (575) 887-6790 www.edcorusa.com		
DRAWING BY Brian Weston		Date 9/2012		
CHECKED BY Brian Weston		Date 9/2012	SIZE A	FSCM NO.
APPROVED BY Larry Weston		Date 9/2012	DWG NO. 20000-EI038	
SCALE: 1:1		©2015 EDCOR Electronics	SHEET: 1 of 1	

Single Phase EI-38 steel lamination
M-6, 29 Gauge - 0.014" [0.355] thick.

REV