

## ADVANTAGE

### ► Features

#### LN-25 Pro

- 2/4 Step trigger interlock
- Analog Voltmeter with automatic polarity indicator
- Operates across the arc
- Wire feed speed control

#### LN-25 Pro Dual Power

- 2/4 Step trigger interlock
- Digital Volt and Ammeter showing either WFS or Amps
- Operates across the arc and 24/42V (control cable required)
- Wire feed speed and Voltage control with 24/42V control cable

### ► Excellent MAXTRAC wire drive system

Two large Ø rollers will guarantee consistent wire feed speed

### ► Lightweight and sturdy

Flame resistant Polycarbonate case

### ► Serviceable

easy to remove case

### ► Sturdy and rugged spindle

New spindle design with incorporated brake.

### ► Built-in flowmeter



# Portable Construction wire feeders

Built upon the tradition and success of the LN-25, the LN-25 PRO is designed to be simple, reliable and easy to service. The LN-25 PRO is ideal for field construction and fabrication, shipyards, and rental companies.

The MAXTRAC® wire drive enhances performance, while the replacement case—and many other upgrade options—can be installed in less than five minutes.

The LN-25 Pro, with its lightweight yet flame resistant polycarbonate case is portable and reliable. Internal components, such as potted and trayed PCB boards are highly protective against moisture, corrosion and dust.

Reliability is further enhanced via a reel locking mechanism which eliminates spindle cross-threading. A built in flow meter eliminates guess work when long gas hoses are used. A burn-back, pre-flow and post flow kit is also available as an option.

The Dual Power model features a voltage control knob for superior arc control, digital meters for increased monitoring, MIG-STT® capability, and can be powered with either a control cable or across the arc.

# LN-25 PRO & PRO DUAL POWER

## TECHNICAL SPECIFICATIONS

Product	Item number	Input voltage	Cooling	Drive rolls	WFS (m/min)	Wire size (mm)		Weight (kg)	Dimensions HxWxD (mm)
						Solid	Cored		
LN-25 PRO	K2613-5	15-110 V DC	Air	2	1.3-17.7	0.6-1.6	0.8-2.0	16	381 x 221 x 599
LN-25 PRO DUAL	K2614-8	15-110 V DC or 24-42 V AC							

## ACCESSORIES

Item number	Description
K10349-PG(W)-xM	Interconnection cables
K115-2	Innershield gun 450A - 82° - 3mm - 4,6m
K126-1/2	Innershield gun 350A - 62° - 1,6 mm - 3/4.6m
KP14017-x	Drive roll kit range (4R)
K14091-1	Remote control
K10343	Euroconnector / Innershield torch adaptor
K10158-1	Readi-reel mounting stand (15 kg)
K14042-1	Adaptor for 5kg (S200) spool

## MAXTRAC DRIVE ROLL KITS

Item number	Description
KP1696-030S	Drive Roll & Wire Guide Kit for Steel 0.6-0.8mm
KP1696-035S	Drive Roll & Wire Guide Kit for Steel 0.9mm
KP1696-045S	Drive Roll & Wire Guide Kit for Steel 1.2mm
KP1696-052S	Drive Roll & Wire Guide Kit for Steel 1.4mm
KP1696-1/16S	Drive Roll & Wire Guide Kit for Steel 1.6mm
KP1697-035C	Drive Roll & Wire Guide Kit for Cored Wire 0.8-0.9mm
KP1697-045C	Drive Roll & Wire Guide Kit for Cored Wire 1.0-1.2mm
KP1697-052C	Drive Roll & Wire Guide Kit for Cored Wire 1.4mm
KP1697-1/16C	Drive Roll & Wire Guide Kit for Cored Wire 1.6mm
KP1697-068	Drive Roll & Wire Guide Kit for Steel/Cored Wire 1.8mm
KP1697-5/64	Drive Roll & Wire Guide Kit for Steel/Cored Wire 2.0mm
KP1697-3/32	Drive Roll & Wire Guide Kit for Steel/Cored Wire 2.4mm

## KEY CONTROLS

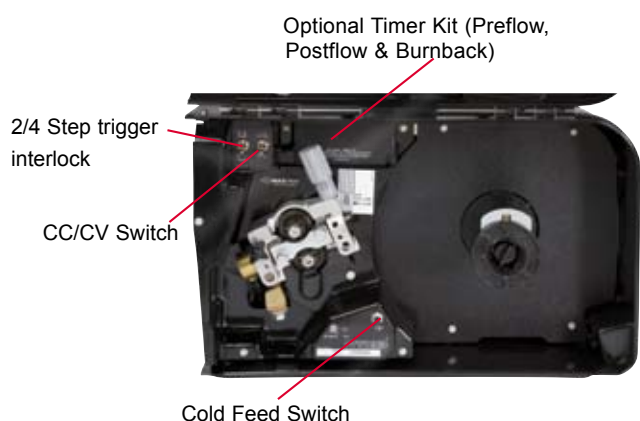

**Belgium:**  
Lincoln Smitweld Belgium  
Tel: +32 54 33 42 12  
e.mail: info@lincolnelectric.eu

**Denmark:**  
Lincoln Electric Nordic  
Tel: +45 86 26 51 00  
e.mail: jtimmer@lincolnelectric.eu

**Finland:**  
Lincoln Electric Nordic  
Tel: +35 8 10 52235 00  
e.mail: jtimmer@lincolnelectric.eu

**France:**  
Lincoln Electric France  
Tel: +33 2 32 11 40 40  
e.mail: info@lincolnelectric.eu

**Germany:**  
Lincoln Electric Deutschland  
Tel: +49 2102 713960  
e.mail: info@lincolnelectric.eu

**Italy:**  
Lincoln Electric Italia  
Tel: +39 010 754 111  
e.mail: info@lincolnelectric.eu

**The Netherlands:**  
Lincoln Smitweld  
Tel: +31 24 3522 911  
e.mail: info@lincolnelectric.eu

**Norway:**  
Sveiseeksperten AS  
Tel: +47 22 08 00 94  
e.mail: info@lincolnelectric.eu

**Poland:**  
Lincoln Electric Bester  
Tel: +48 74 64 61 100  
e.mail: info@lincolnelectric.eu

**Portugal:**  
Electro Arco  
Tel: +351 21 238 7300

**Russia:**  
Lincoln Electric Russia  
Tel: +7 (495) 6609404  
e.mail: russia@lincolnelectric.eu

**Spain:**  
Lincoln Electric Spain  
Tel: +34 93 685 96 00  
e.mail: info@lincolnelectric.eu

**Sweden:**  
Svetskompaniet AB  
Tel: +46 (0) 320 211710  
e.mail: info@lincolnelectric.eu

**UK/ Ireland:**  
Lincoln Electric UK  
Tel: +44 114 287 2401  
e.mail: info@lincolnelectric.eu