

# PLASMA CUTTING TORCHES

## SC80 Plasma Torch & Spares

Air Cooled 80 Amp



Rating: 80A Air/N<sub>2</sub> Gas, @ 60% duty cycle.

For use on KUPJRRW40 - KUPJRRW45 - KUPJRRW80

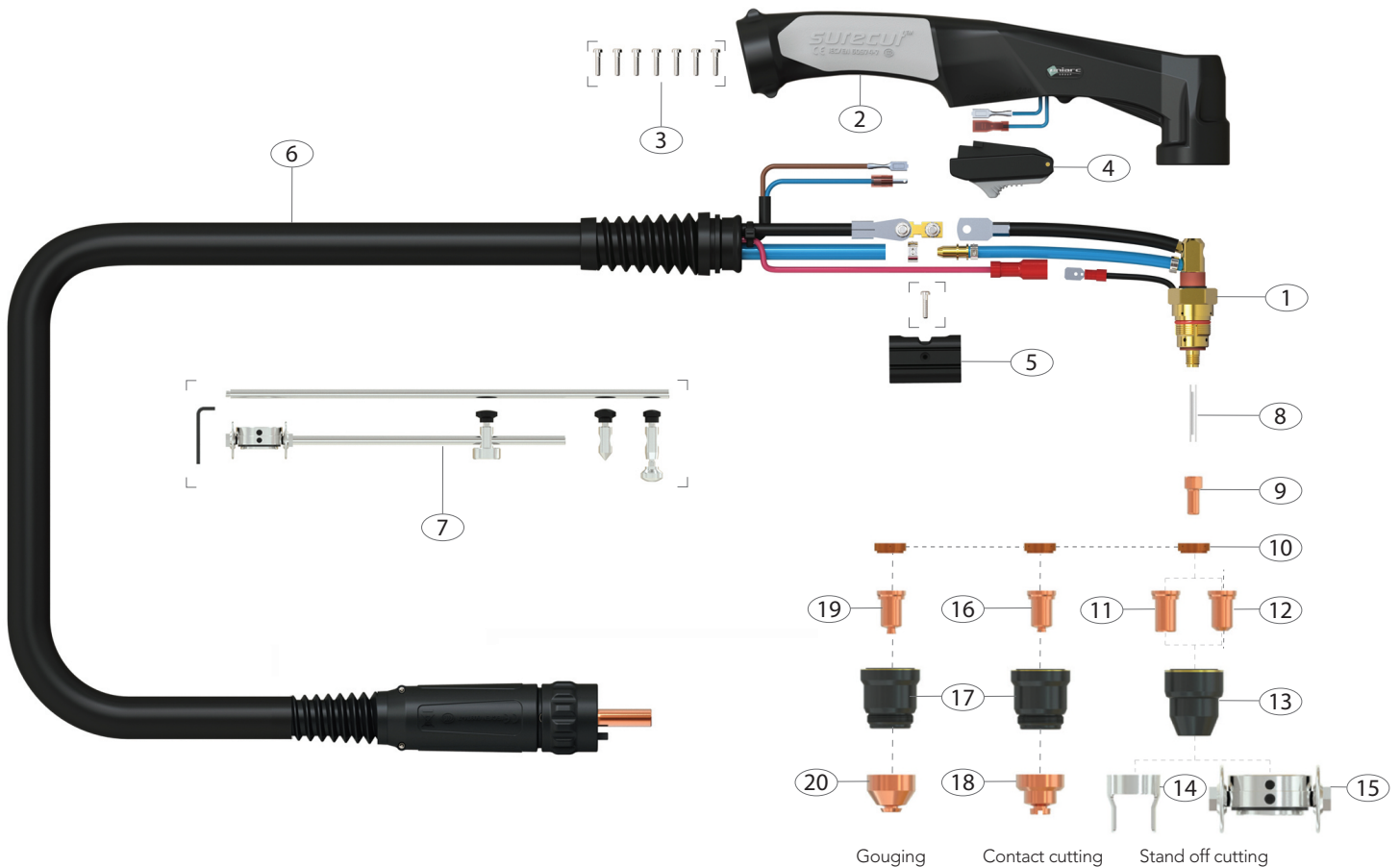

Gouging      Contact cutting      Stand off cutting

### Torch Model

Description

Part Number

6 Mt

Surecut™ Plasma Cutting Torch Package

WG-SC80-60-CC1

### Front end consumables

#### Torch Spare Parts

No	WGA Part No.	Description
1	SC8001	SC80 70 Torch Head Kit
2	SC8014	Plasma Handle Kit
3	SCSP1	Screw Pack
4	SC2516	Plasma Safety Trigger
5	SC8015	Location Block
6	SC8019-60-CF4	Cable Assembly Complete X 6mt
7	SC8050	Circle Cutting Attachment Kit

#### Wear Spare Parts

No	WGA Part No.	Description
8	SC8002	Cooling Tube
9	SC8004	Electrode
10	SC8006	Swirl Ring
11	SC8020-09	Cutting Tip 0.9mm
12	SC8020-10	Cutting Tip 1.0mm 40-50A
	SC8020-13	Cutting Tip 1.3mm 70-80A
13	SC8030	Retaining Cup
14	SC8040	Stand Off Guide
15	SC8051	Cutting Buggy
16	SC8026-10	Cutting Tip Contact 1.0mm
	SC8026-11	Cutting Tip Contact 1.1mm
	SC8026-12	Cutting Tip Contact 1.2mm
	SC8026-13	Cutting Tip Contact 1.3mm
17	SC8031	Shield Cap Body
18	SC8041	Shield Cap
19	SC8028-16	Gouging Tip 1.6mm
20	SC8043	Shield Cap Gouging