



Trailmate

www.trailmate.com

MINI PEEL



OWNER'S MANUAL

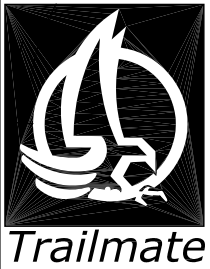

MINI PEEL ILLUSTRATED PARTS BREAKDOWN

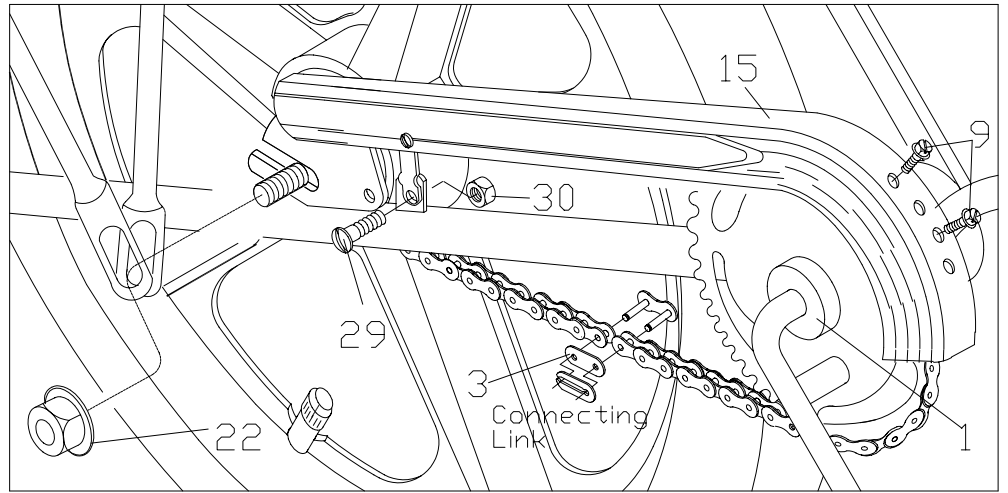

Fig. 4

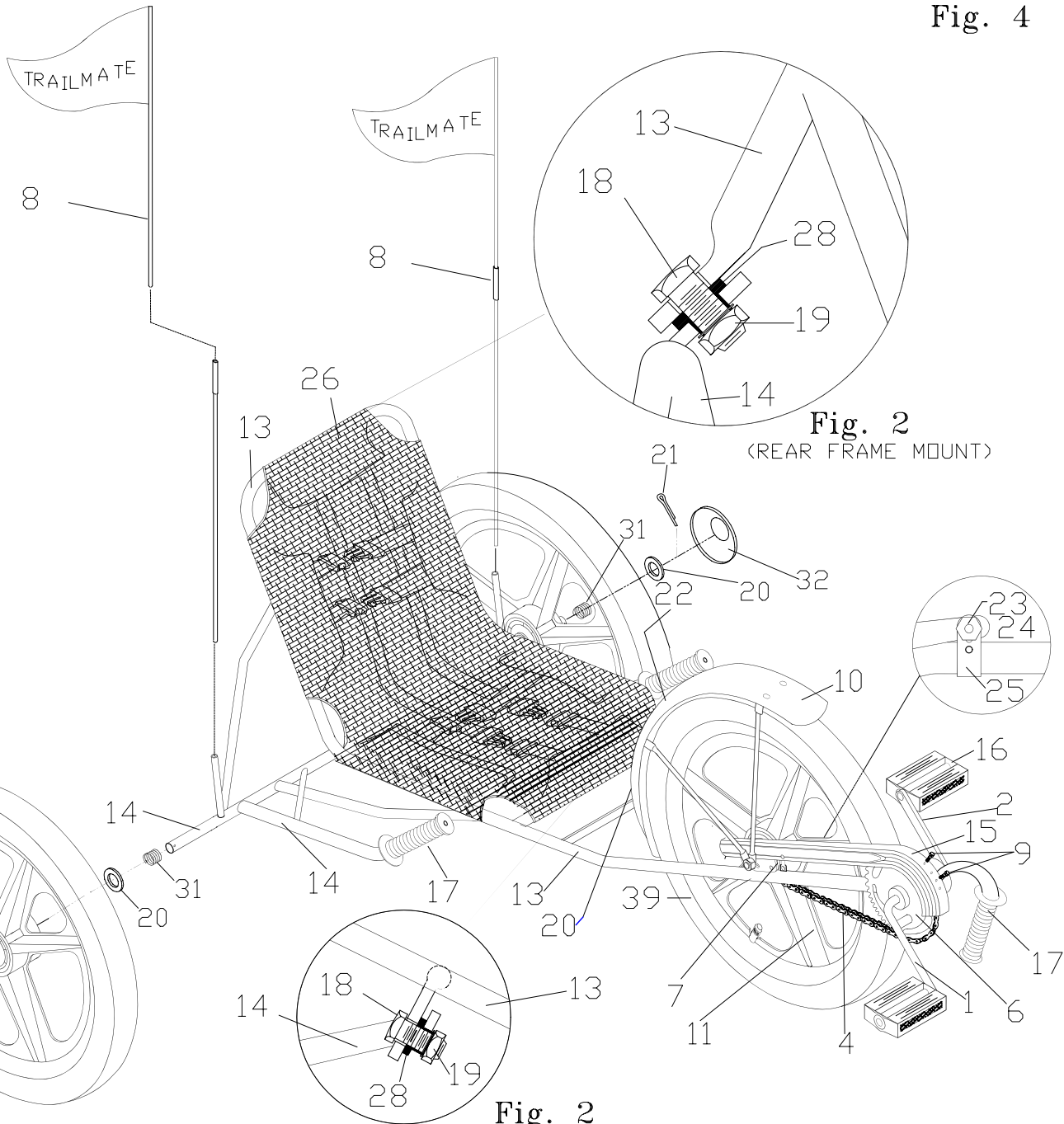



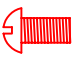





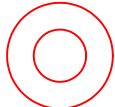

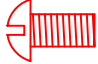
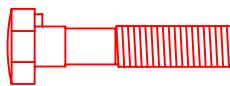



Fig. 2
(REAR FRAME MOUNT)

Fig. 2
(FRONT FRAME MOUNT)

MINI PEEL PARTS LIST

ITEM	PART	DESCRIPTION	QTY.	ITEM	PART	DESCRIPTION	QTY.
1.	19914	CRANK 3-1/2"	1	18.	12208	SCREW 5/16-18 x 3/4 HHCS	2
2.	11697	CRANK SET COMPLETE	1	19.	11065	NUT 5/16-18 NYLON INSERT	2
3.	11679	CHAIN CONNECTING LINK	1	20.	12240	WASHER SPACER 1x41/64x.062	4
4.	18729	CHAIN/CL M/P 59 PITCH	1	21.	11070	PIN COTTER 3/32x1	2
5.	11718	DECAL TM HEAD	1	22.	19153	NUT CB SHIMANO	2
6.	11934	SPROCKET 36T	1	23.	19169	SCREW BRAKE STRAP SHIMANO	1
7.	18909	SPROCKET 21T	1	24.	19168	NUT BRAKE STRAP SHIMANO	1
8.	12102	FLAG SAFETY W/O BRACKET	2	25.	12279	CLAMP BRAKE STRAP SHIMANO	1
9.	12188	SCREW 10-32 x 3/8 SLTD HWH	2	26.	19931	SEAT M/P YELLOW	1
10.	19947	FENDER 12" M/P ASSEMBLY	1	27.	19325	DECAL "DO NOT STAND ON CYCLE"	1
11.	19953	WHL. 12" MAG M/P W/CB & HDW.	1	28.	12236	WASHER 5/16 SAE	2
12.	19894	WHL 12" MAG REAR 5/8" BORE	2	29.	12197	SCREW 1/4-20x1/2	1
13.	19942	FRAME M/P FRONT ASSEMBLY	1	30.	12172	NUT 1/4-20 FLANGED	1
14.	19943	FRAME M/P REAR ASSEMBLY	1	31.	12260	SPRING AXLE	2
15.	19948	CHAINGUARD M/P ASSEMBLY	1	32.	19962	WHEEL CAP BLACK PLASTIC	2
16.	11857	PEDALS MINI PEEL	2				
17.	18175	GRIP HANDLE YLW & BLK	3				

ILLUSTRATED PARTS LIST (MINI CYCLE)

<p>ITEM #24 PART #19168 (1) NUT BRAKE STRAP</p> 	<p>ITEM # PART #12170 () NUT #10-32 HEX</p> 	<p>ITEM # PART #19171 () SCREW #10-32 X 3/8"</p> 	<p>ITEM # PART #12224 () SCREW #3/8-16 X 3/4"</p> 	<p>ITEM # 11340 () NUT #1/2-13 NYLON JAM</p> 
<p>ITEM #30 PART #12172 (1) NUT #1/4-20</p> 	<p>ITEM # PART #13227 () CLAMP NUT</p> 	<p>ITEM #23 PART #19169 (1) SCREW #10-32 X 1/2" SCREW FOR BRAKE STRAP</p> 	<p>ITEM # PART #18764 () SCREW #1/2-13 X 1 1/4"</p> 	<p>ITEM # PART #19640 () WASHER 5/8 SAE</p> 
<p>ITEM # PART #12178 () NUT #3/8-16</p> 	<p>ITEM # PART #13226 () WASHER (THICKER)</p> 	<p>ITEM #29 PART #12197 (1) SCREW #1/4-20 X 1/2"</p> 	<p>ITEM # PART #13225 () CLAMP BOLT</p> 	<p>ITEM #21 PART #11070 (2) COTTER PIN</p> 
<p>ITEM #22 PART #19153 (4) NUT AXLE</p> 	<p>ITEM #35 PART #12301 (2) WASHER</p> 	<p>ITEM #25 PART #12279 (1) CLAMP (BRAKE STRAP)</p> 		

1. PREPARATION

REMOVE ALL PARTS FROM THE CARTON. DO NOT REMOVE PROTECTIVE WRAPPING UNTIL NECESSARY. OPEN THE PARTS BAG AND VERIFY ALL PARTS PRESENT (REFER TO THE ILLUSTRATED PARTS LIST). CHECK TIRE AIR PRESSURE INFLATE TO 35 PSI. MAKE SURE TIRES ARE PROPERLY SEATED ON RIMS.

2. FRONT FRAME

LAY FRONT FRAME (13) FIG. 1 ON REAR FRAME ASSEMBLY (14) FIG 2.

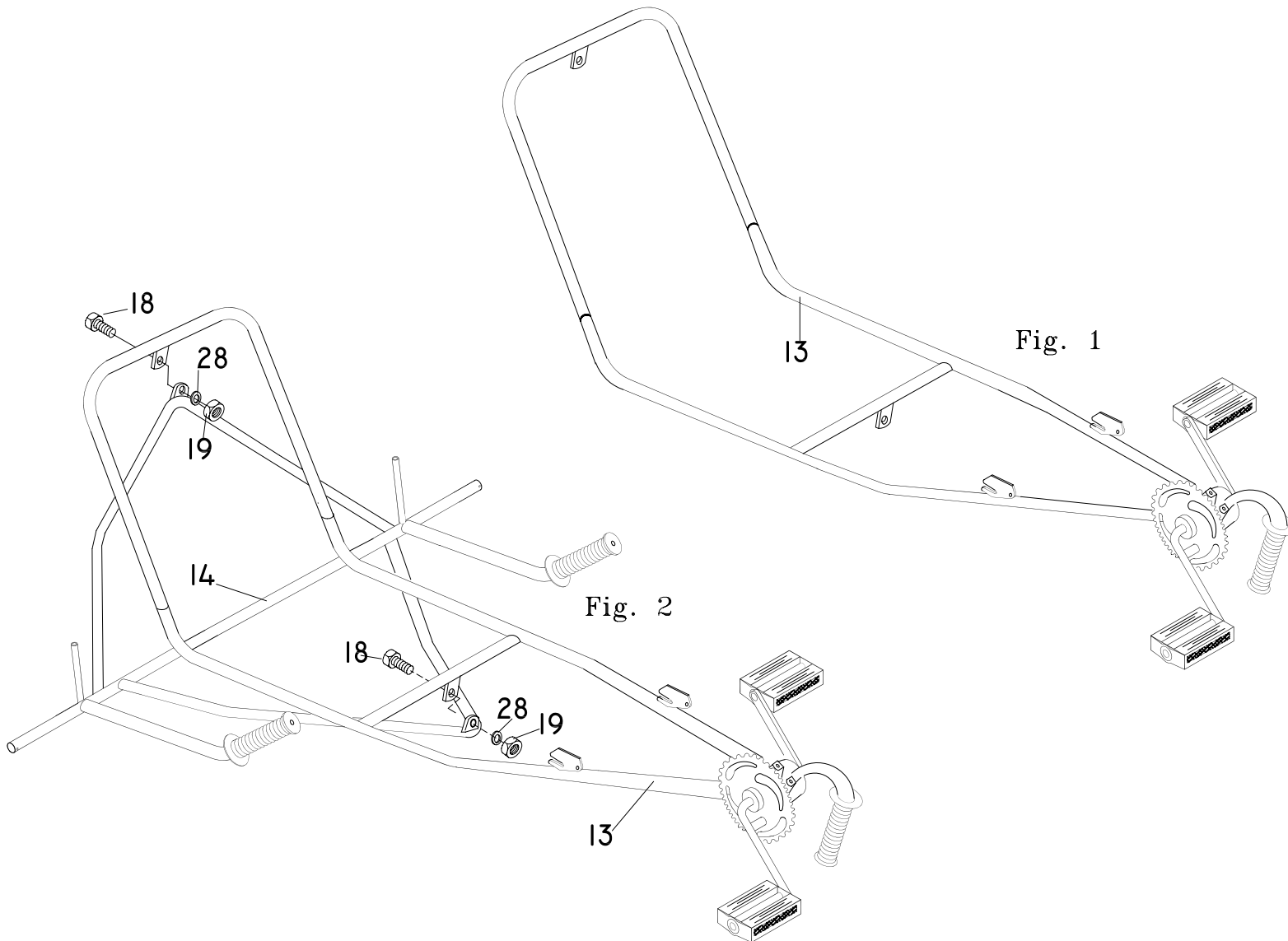

3. FRONT AND REAR FRAME. (SEE FIGURE 2).

INSERT SCREWS (18) INTO HOLES IN FRAME SECTIONS. SECURE WITH WASHERS (28) AND NYLON JAM NUTS (19). TIGHTEN NUTS SO THAT THE FRAME SECTIONS ARE SECURELY HELD TOGETHER, BUT NOT SO TIGHT TO CAUSE BINDING WHEN PIVOTED.

Fig. 3

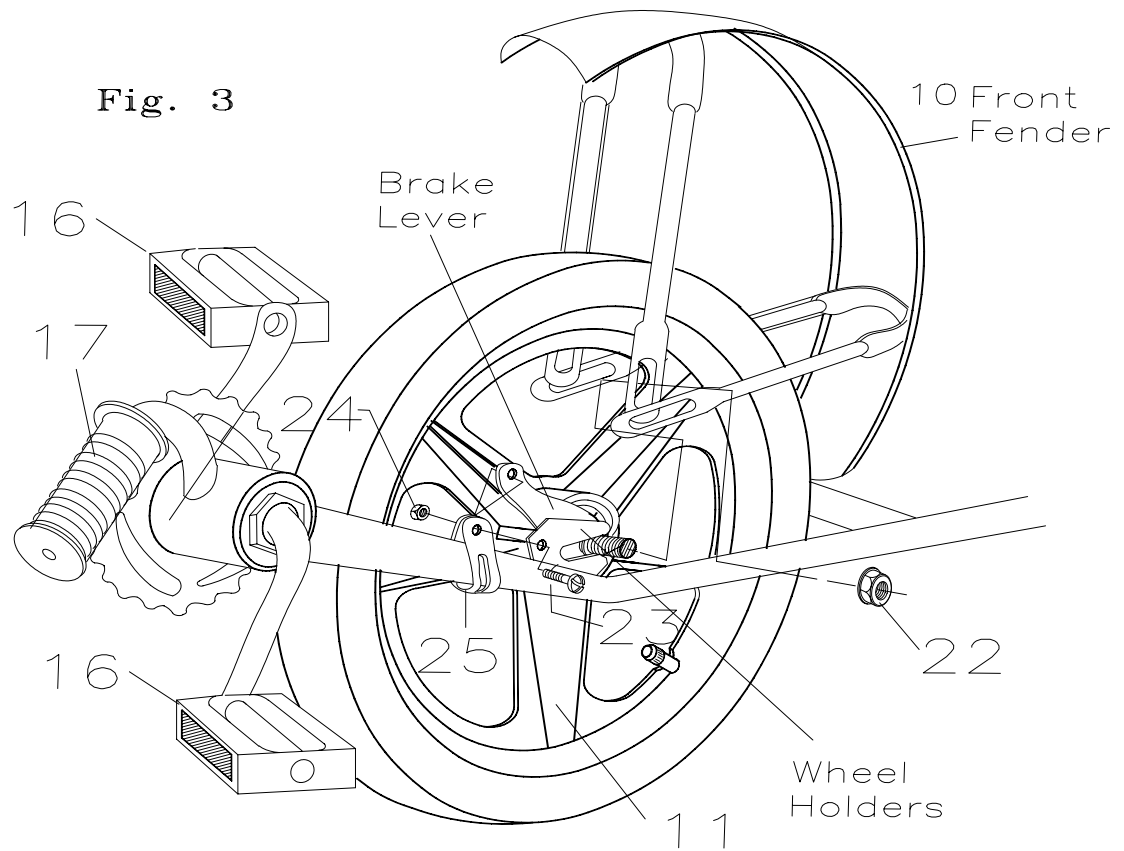

4. FRONT WHEEL ASSEMBLY

INSTALL FRONT WHEEL ASSEMBLY(II) WITH THE BRAKE LEVER POINTING FORWARD AND ABOVE THE LEFT FRAME TUBE (SEE FIGURE 3).

INSTALL THE FRONT FENDER (10) ONTO THE FRONT WHEEL AXLE (SEE FIGURE 3). NOTE: EITHER THE TOP OR BOTTOM BRACE MAY BE INSTALLED FIRST, BUT DO THE SAME FOR BOTH SIDES. INSTALL NUTS (22), LOOSELY TIGHTEN.(SEE FIGURE 3)

5. BRAKE STRAP

ATTACH THE BRAKE STRAP (25) TO THE FRAME BY BENDING IT INTO A "U" SHAPE AND SLIDING IT OVER THE LEFT FRAME TUBE, FROM THE BOTTOM UP (SEE FIGURE 3). ALIGN THE BRAKE STRAP AROUND THE BRAKE ARM AND INSERT SCREW (23) FROM THE OUTSIDE THROUGH THE STRAP AND ARM. IF NECESSARY, USE AN AWL TO ALIGN ALL THREE HOLES. SECURE WITH NUT (24). DO NOT TIGHTEN UNTIL CHAIN IS ADJUSTED.(SEE FIGURE 3)

6. CHAIN (SEE FIGURE 4)

PLACE CHAIN (4) AROUND SPROCKETS AND JOIN WITH CONNECTING LINK (3) (SEE FIGURE 4). SLIDE WHEEL ASSEMBLY BACK UNTIL CHAIN IS TIGHT (APPROXIMATELY 3/4" UP AND DOWN MOVEMENT IS PERMISSIBLE). WHILE HOLDING WHEEL ASSEMBLY CENTERED BETWEEN FRAME TUBES, GRADUALLY TIGHTEN AXLE NUTS (22) ALTERNATELY ON EACH SIDE. TIGHTEN BRAKE STRAP SCREW.

CRANK THE PEDAL SPROCKET AND CHECK FOR BINDING OR "CLICKING" NOISE. IF ANY IS NOTICED, VISUALLY CHECK THE CHAIN AND SPROCKET ALIGNMENT. CHECK THAT THE SPROCKET DOES NOT RUB ON THE FRAME TUBE AND THAT THE FRONT TIRE IS CENTERED PROPERLY.

7. Pedals

Install pedals (17) by threading the pedal marked "R" into the right side of the crank (clockwise) and the pedal marked "L" into the left side of the crank (counterclockwise).

8. Chainguard

Install chainguard (15) by removing the screws (9) in the front mounting brackets (see figure 4). Place the rear of the chainguard between the wheel and fender brace. Align hole in the rear chainguard mounting bracket with the hole in the frame tab. Insert screw (29) from the outside and secure with nut (30). Pull chainguard forward until front chainguard mounting brackets line up with the second and fourth hole in the front of the chainguard. Secure chainguard with screws (9). (see figure 4)

9. Rear Wheels (see figure 5)

Slide Spring (31) and Washer (20) onto ends of rear axle. Slide rear Wheels(11) onto rear axle (flat side inside.) NOTE: If wheels does not slide freely onto axle, lightly oil and try again. Do not force wheel onto axle; this may damage the hub. Secure with washer (20) and Cotter Pin (21) (wheel must rotate freely.) Install wheel caps (32). Push on center of cap to lock.

Rear Wheel Installation

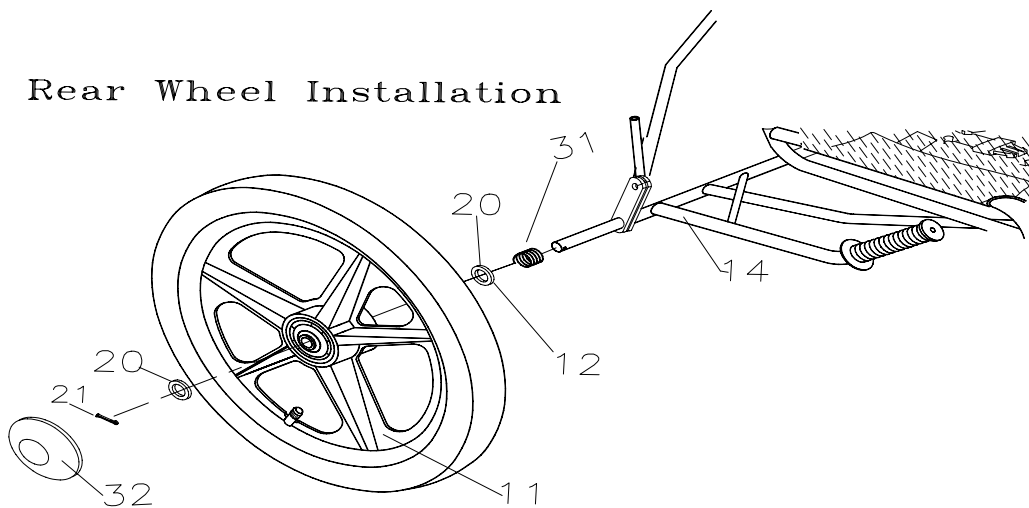

Fig. 5

10. Handlegrrips and Flag

Complete by installing handlegrrips (18) and placing safety flags (1) in holders.

REGULAR MAINTENANCE: Bi-Monthly

1. Keep all painted parts cleaned and waxed for a long-lasting luster.
 2. Spray all chrome parts with recommended protective spray coating (LPS-1, WD-40, etc.).
When spraying with protective coatings, it is recommended that you let parts set overnight so the coating will penetrate.
 3. Lubricate the following:
 - a. Pivot points at top and bottom of seat
 - b. Axle shafts
 - c. Inside bearings of both pedals
 - d. Chain – turn pedal crank forward and spray freely
 4. When storing over prolonged periods, turn upside down to prevent flat spots from occurring on the tires. If stored outside, cover to protect finish and moving parts.
-

PREVENTATIVE MAINTENANCE: Every Six Months

These are services that should be performed by your local bicycle shop. A fee may be charged.

1. Check tires for wear, rim cuts, and valve core alignment (usually caused by improper air pressure).
2. Check wheels for cracks and alignment.
3. Check brakes for proper operation.
4. Clean and repack all bearings and adjust all cones.
5. Check for worn bearings, cones, and cups.
6. Check chain for adjustment and clean as needed.
7. Check for loose bolts and nuts.

Attention: While your unit is new, some noises may occur when the unit is breaking in. Should they continue for more than 30 days, see your local bike shop.

INSPECTION

Check the following, as it applies to your cycle, on a regular basis:

1. Coaster brake – Make sure the brake engages, by pedaling backwards.
2. Wheels – Check wheels for alignment.
3. Pedals – Inspect pedal bearings and make sure pedal is tightly attached to crank.
4. Handle grips – Replace worn or loose grips.
5. Chain – Check for proper tightness. Replace damaged chain immediately.
6. Seat – Adjust seat for rider comfort and safety.
7. Tires – Keep tires inflated to the recommended tire pressure, as indicated on the tire's sidewall.
8. Chainguard – Replace damaged or missing chainguard immediately.
9. Frame – Replace damaged frame immediately.



Trailmate

1851 67th AVE East

Sarasota, FL 34243

Tel: (941) 755-5511

Fax: (941) 758-5141

Visit us @ www.trailmate.com

**For service or to order
replacement parts
please contact your
local Trailmate dealer.**

MINI PEEL

This is a recreational unit, not designed for excessive speeds or misuse.

Do not brake or turn at high speeds. This may cause cycle to roll over. Careless operation may cause rider to lose control and result in **serious injury**.

Things to know before riding your cycle:

1. Know your local bicycle laws and wear a helmet.
2. Do not exceed the recommended weight limit of 100 lbs.
3. No more than one rider at one time.
4. Do not stand on unit.
5. Be sure to install safety flags.
6. Wear light-colored clothing and protective gear.
7. Do not ride at night.
8. Children must be supervised by an adult at all times.

Trailmate Limited Warranty

Trailmate, Inc., guarantees each cycle product against all defects in materials and workmanship for a period of 90 days from date of purchase. Tires and tubes are not covered by this guarantee.

During this period, any part that is judged by the makers to be defective will be replaced free of charge. Any failure resulting from accident, abuse, neglect, normal wear, or improper assembly or maintenance by the owner is not covered.

Trailmate, Inc., further authorizes a lifetime frame guarantee and will replace any frame, at no cost to the buyer, providing that item has not been used for rental use and that:

- 1) The item has not been altered, repaired, or modified in any way.
- 2) The item has not been subject to misuse, negligence, and/or an accident.
- 3) Original ownership is established.

Any parts under this guarantee on which claims are entered shall be returned for inspection with transportation charges prepaid by the claimant. Replacement parts will be shipped F.O.B. factory.

There are no warranties or guarantee, expressed or implied, written or oral, which extend beyond the description on the face hereof.